



Lat40°, Inc. 1635 Foxtrail Drive, Suite 325 Loveland, CO 970-776-3321

HYDROLOGY MAP

FIVE RIVERS K09-67-1HN PAD

SECTION: 9
TOWNSHIP: 4N
RANGE: 66W

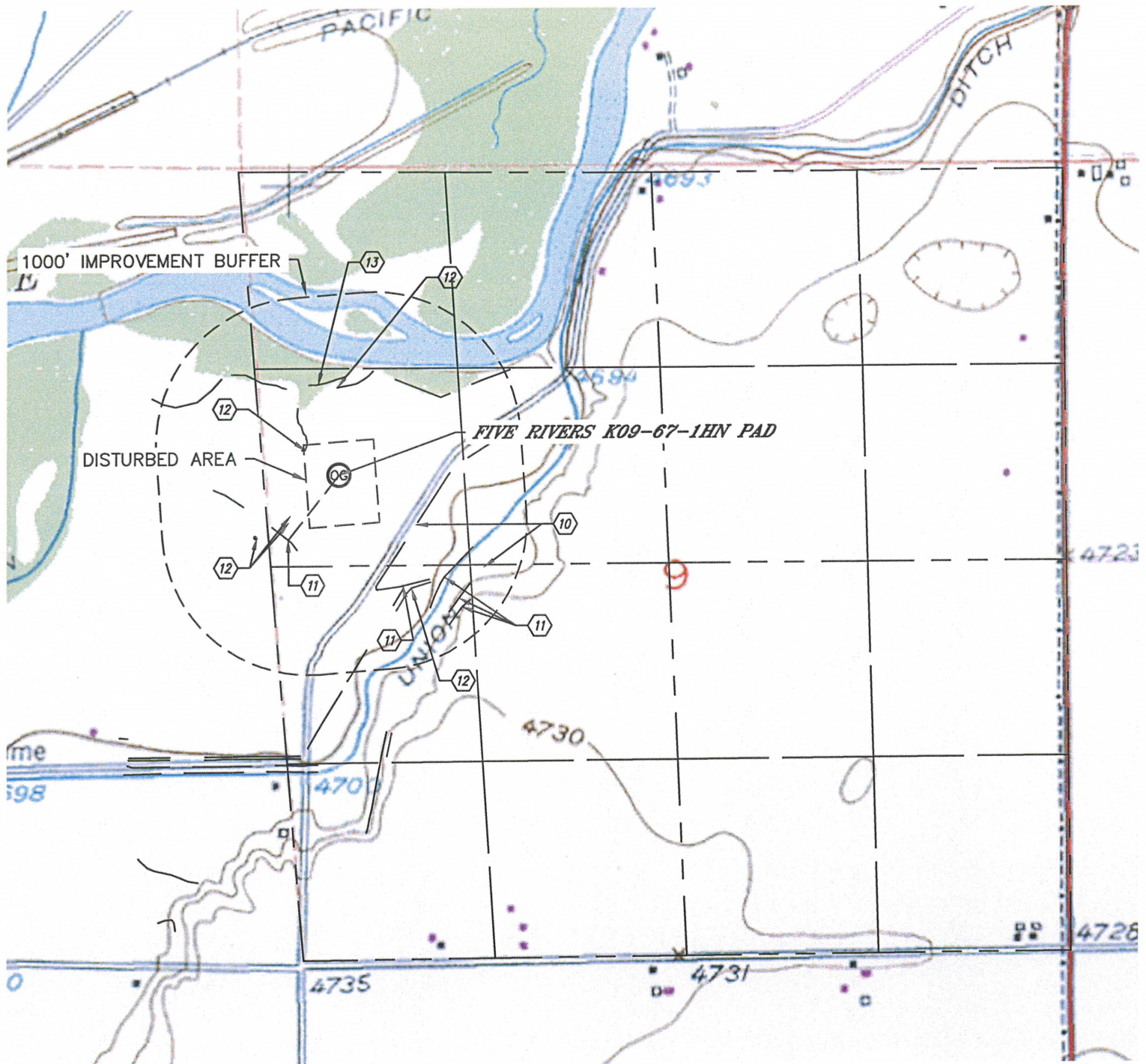

- ⑩ LAGOON 623' & 1167' SE
- ⑪ DITCH 556' SW, 867', 997', 1169' & 1225' SE
- ⑫ LOW AREA 697' SW, 286' NW, 595' N, 913' SE, WITH CATTAILS 432' & 470' SW
- ⑬ RIVER BANK 631' NW

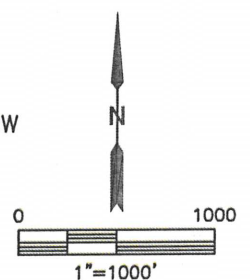

DATE: 11/27/2013
PROJECT#: 2013063