

# BILL BARRETT CORPORATION

RUH 6-62-11\_14 NENW PAD #6-62-11-0362CH2, 0461CH2 & 0461BH2

LOCATED IN WELD COUNTY, COLORADO  
SECTION 11, T6N, R62W, 6th P.M.

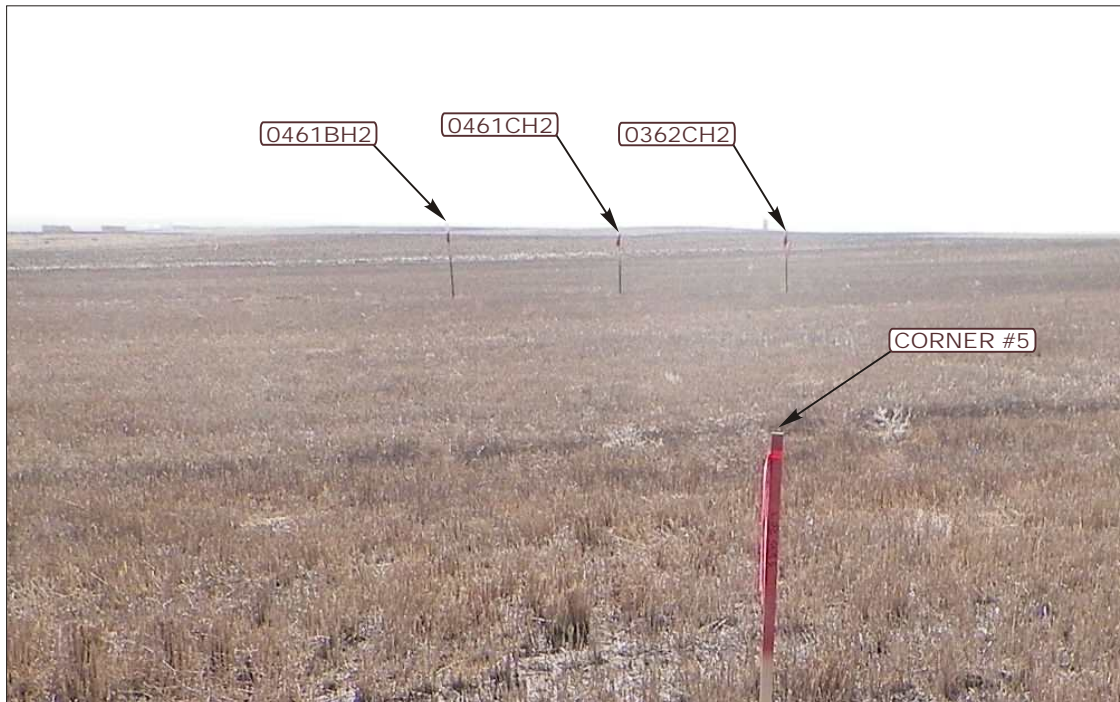

PHOTO: VIEW FROM CORNER #5 TO LOCATION STAKE

CAMERA ANGLE: SOUTHERLY



PHOTO: VIEW FROM BEGINNING OF PROPOSED ACCESS  
FOR RUH 6-62-11\_14 NWNW PAD

CAMERA ANGLE: WESTERLY



- Since 1964 -

U  
E  
S

Uintah Engineering & Land Surveying

85 South 200 East Vernal, Utah 84078  
(435) 789-1017 \* FAX (435) 789-1813

LOCATION PHOTOS

01 23 14  
MONTH DAY YEAR

PHOTO

P1

TAKEN BY: D.S.

DRAWN BY: J.L.G.

REVISED: 03-24-14



# BILL BARRETT CORPORATION

RUH 6-62-11\_14 NENW PAD #6-62-11-0362CH2, 0461CH2 & 0461BH2

LOCATED IN WELD COUNTY, COLORADO

SECTION 11, T6N, R62W, 6th P.M.

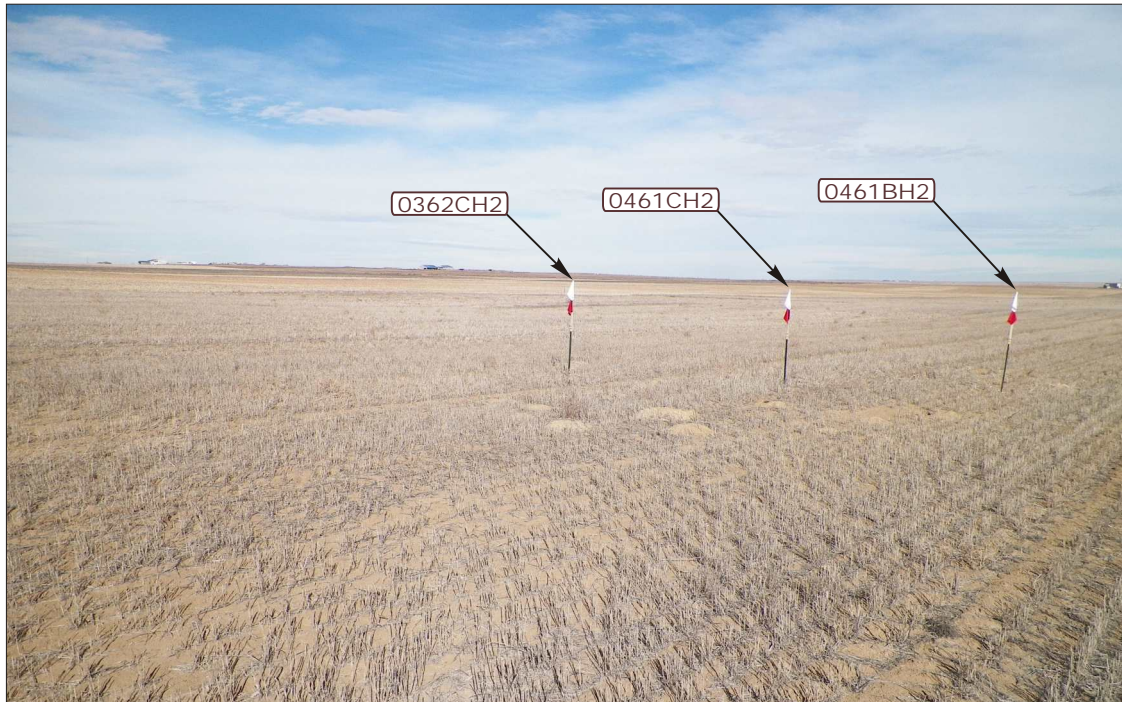

PHOTO: VIEW OF LOCATION STAKES

CAMERA ANGLE: NORTHERLY



PHOTO: VIEW OF LOCATION STAKE

CAMERA ANGLE: EASTERLY



- Since 1964 -

UELS

Uintah Engineering & Land Surveying

85 South 200 East Vernal, Utah 84078  
(435) 789-1017 \* FAX (435) 789-1813

LOCATION PHOTOS

01 23 14  
MONTH DAY YEAR

PHOTO

P2

TAKEN BY: D.S.

DRAWN BY: J.L.G.

REVISED: 03-24-14



# BILL BARRETT CORPORATION

RUH 6-62-11\_14 NENW PAD #6-62-11-0362CH2, 0461CH2 & 0461BH2

LOCATED IN WELD COUNTY, COLORADO

SECTION 11, T6N, R62W, 6th P.M.



PHOTO: VIEW OF LOCATION STAKES

CAMERA ANGLE: SOUTHERLY



PHOTO: VIEW OF LOCATION STAKES

CAMERA ANGLE: WESTERLY



- Since 1964 -

UELS

Uintah Engineering & Land Surveying

85 South 200 East Vernal, Utah 84078  
(435) 789-1017 \* FAX (435) 789-1813

LOCATION PHOTOS

01 23 14  
MONTH DAY YEAR

PHOTO

P3

TAKEN BY: D.S.

DRAWN BY: J.L.G.

REVISED: 03-24-14