

GREAT WESTERN OIL & GAS COMPANY
RAINDANCE FD 19-237HC, 19-239HN, 20-221HN,
20-222HN, 20-223HC & 20-226HN
LOCATED IN WELD COUNTY, COLORADO
SECTION 30, T6N, R67W, 6th P.M.



PHOTO: VIEW FROM CORNER #3 TO LOCATION STAKES

CAMERA ANGLE: NORTHWESTERLY

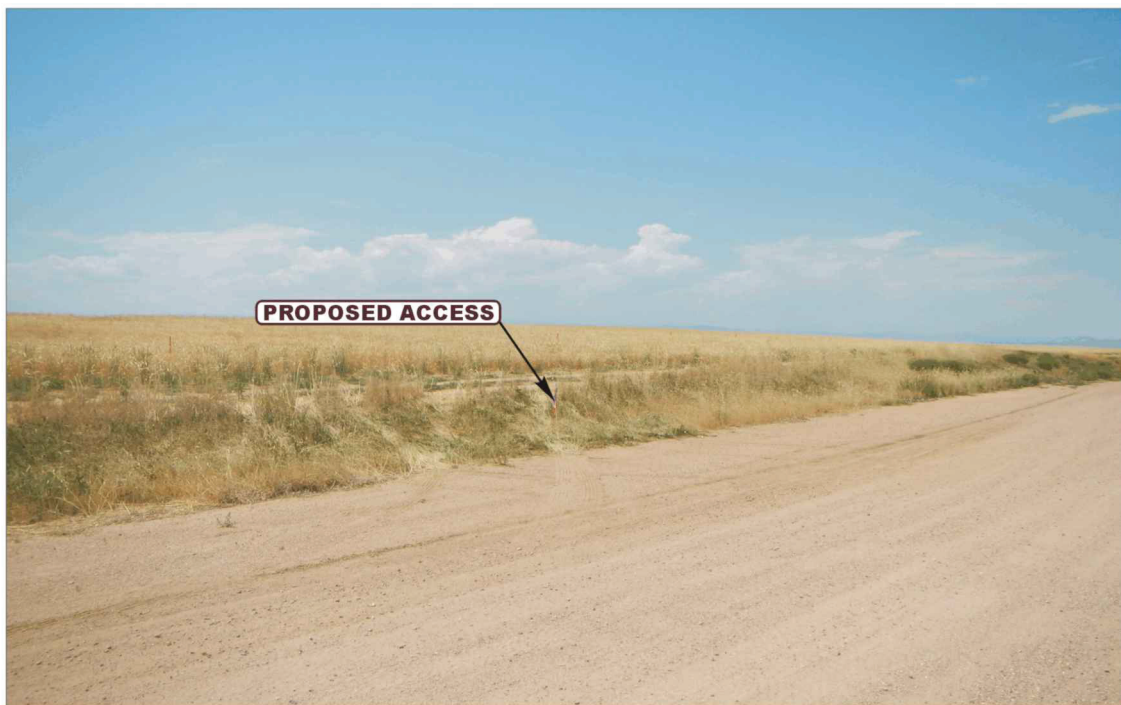

PHOTO: VIEW FROM BEGINNING OF PROPOSED ACCESS

CAMERA ANGLE: NORTHWESTERLY



- Since 1964 -

U&LS Uintah Engineering & Land Surveying
85 South 200 East Vernal, Utah 84078
(435) 789-1017 * FAX (435) 789-1813

LOCATION PHOTOS

07 **17** **13**
MONTH DAY YEAR

TAKEN BY: J.H.

DRAWN BY: J.L.H.

REV: 10-24-13 J.L.G.

PHOTO
P1

GREAT WESTERN OIL & GAS COMPANY
RAINDANCE FD 19-237HC, 19-239HN, 20-221HN,
20-222HN, 20-223HC & 20-226HN
LOCATED IN WELD COUNTY, COLORADO
SECTION 30, T6N, R67W, 6th P.M.



PHOTO: VIEW OF LOCATION STAKES

CAMERA ANGLE: NORTHERLY

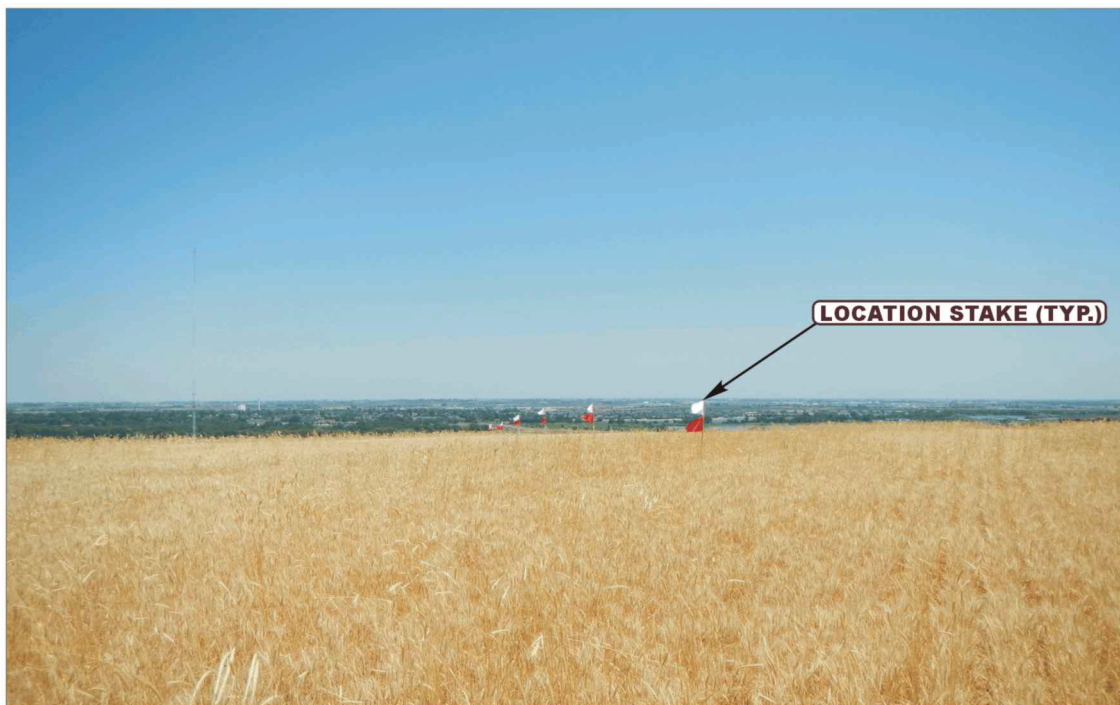

PHOTO: VIEW OF LOCATION STAKES

CAMERA ANGLE: EASTERLY



- Since 1964 -

UELS Uintah Engineering & Land Surveying
 85 South 200 East Vernal, Utah 84078
 (435) 789-1017 * FAX (435) 789-1813

LOCATION PHOTOS

07 **17** **13**
 MONTH DAY YEAR

TAKEN BY: J.H. DRAWN BY: J.L.H. REV:10-24-13J.L.G.

PHOTO
P2

GREAT WESTERN OIL & GAS COMPANY
RAINDANCE FD 19-237HC, 19-239HN, 20-221HN,
20-222HN, 20-223HC & 20-226HN
LOCATED IN WELD COUNTY, COLORADO
SECTION 30, T6N, R67W, 6th P.M.



PHOTO: VIEW OF LOCATION STAKES

CAMERA ANGLE: SOUTHERLY



PHOTO: VIEW OF LOCATION STAKES

CAMERA ANGLE: WESTERLY



- Since 1964 -

UELS Uintah Engineering & Land Surveying
85 South 200 East Vernal, Utah 84078
(435) 789-1017 * FAX (435) 789-1813

LOCATION PHOTOS

07 **17** **13**
MONTH DAY YEAR

TAKEN BY: J.H. DRAWN BY: J.L.H. REV:10-24-13J.L.G.

PHOTO
P3