

BILL BARRETT CORPORATION

RUH 6-62-11_14 NWNE PAD #6-62-11-0560CH2, 0560BH2, 0659CH2 & 0659BH2
LOCATED IN WELD COUNTY, COLORADO
SECTION 11, T6N, R62W, 6th P.M.

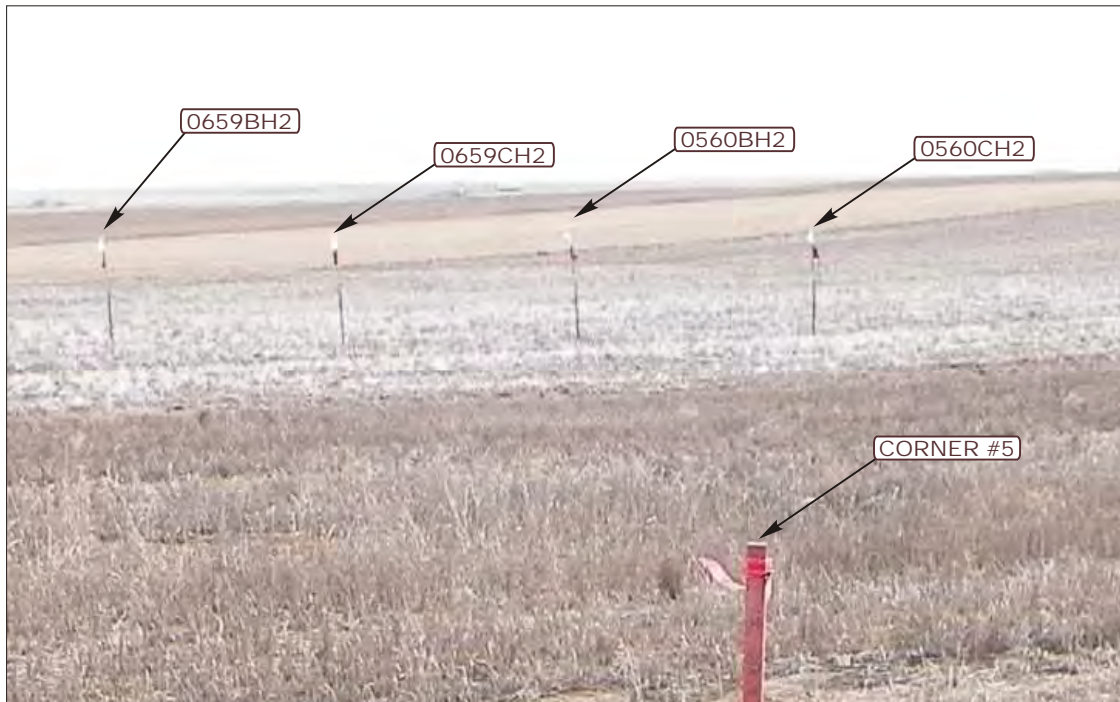

PHOTO: VIEW FROM CORNER #5 TO LOCATION STAKE

CAMERA ANGLE: SOUTHERLY



PHOTO: VIEW FROM BEGINNING OF PROPOSED ACCESS
FOR RUH 6-62-11_14 NWNW PAD

CAMERA ANGLE: WESTERLY



- Since 1964 -



Uintah Engineering & Land Surveying
85 South 200 East Vernal, Utah 84078
(435) 789-1017 * FAX (435) 789-1813

LOCATION PHOTOS

03 11 14
MONTH DAY YEAR

PHOTO
P1

TAKEN BY: D.S.

DRAWN BY: J.L.G.

REVISED: 03-20-14

BILL BARRETT CORPORATION

RUH 6-62-11_14 NWNE PAD #6-62-11-0560CH2, 0560BH2, 0659CH2 & 0659BH2

LOCATED IN WELD COUNTY, COLORADO

SECTION 11, T6N, R62W, 6th P.M.



PHOTO: VIEW OF LOCATION STAKES

CAMERA ANGLE: NORTHERLY



PHOTO: VIEW OF LOCATION STAKE

CAMERA ANGLE: EASTERLY



- Since 1964 -

UELS

Uintah Engineering & Land Surveying

85 South 200 East Vernal, Utah 84078
(435) 789-1017 * FAX (435) 789-1813

LOCATION PHOTOS

03
MONTH

11
DAY

14
YEAR

PHOTO

P2

TAKEN BY: D.S.

DRAWN BY: J.L.G.

REVISED: 03-20-14

BILL BARRETT CORPORATION

RUH 6-62-11_14 NWNE PAD #6-62-11-0560CH2, 0560BH2, 0659CH2 & 0659BH2

LOCATED IN WELD COUNTY, COLORADO

SECTION 11, T6N, R62W, 6th P.M.

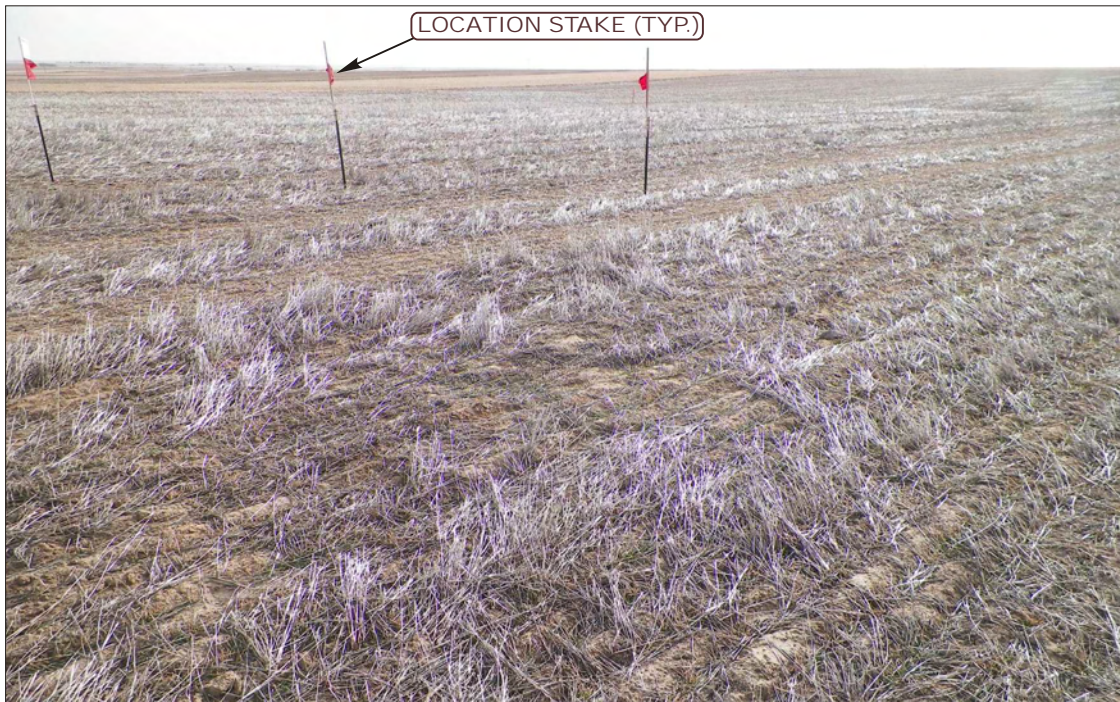

PHOTO: VIEW OF LOCATION STAKES

CAMERA ANGLE: SOUTHERLY

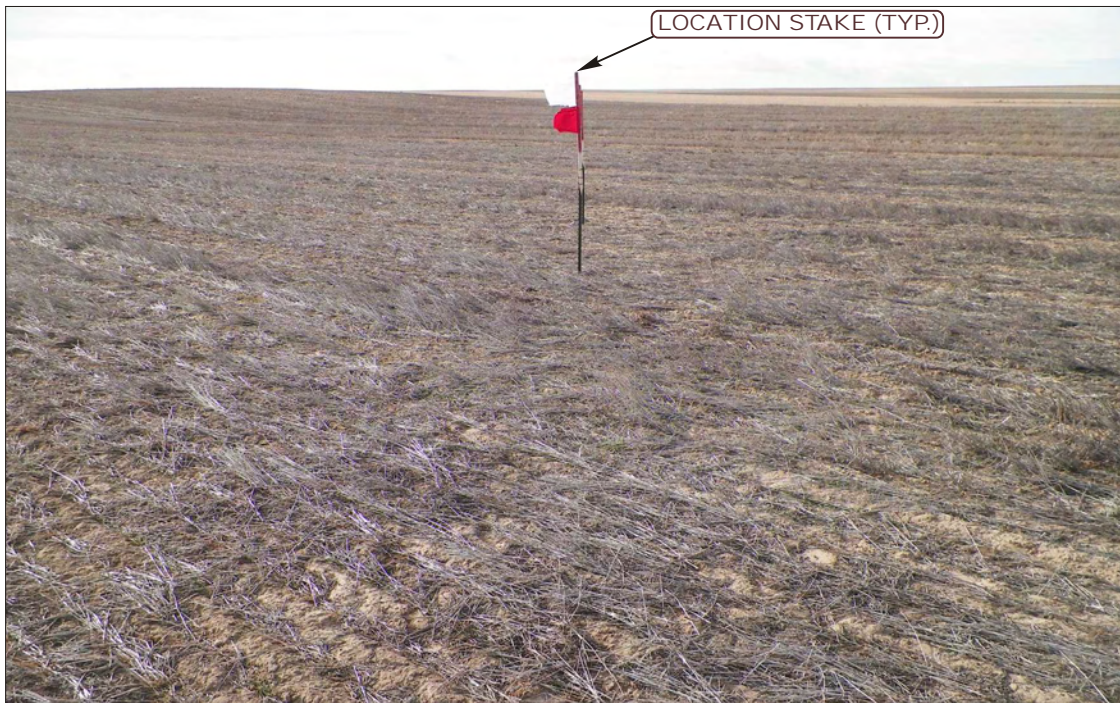

PHOTO: VIEW OF LOCATION STAKES

CAMERA ANGLE: WESTERLY



- Since 1964 -

UELS

Uintah Engineering & Land Surveying

85 South 200 East Vernal, Utah 84078
(435) 789-1017 * FAX (435) 789-1813

LOCATION PHOTOS

03
MONTH

11
DAY

14
YEAR

PHOTO

P3

TAKEN BY: D.S.

DRAWN BY: J.L.G.

REVISED: 03-20-14