

NOTE:

1. AFTER COMPLETION OF WELL PAD GRADING, PLATING MATERIAL WILL BE PLACED AT A DEPTH OF 4 INCHES AND COMPACTED USING MOBILE EQUIPMENT.
2. EXISTING UTILITIES DISPLAYED ON THE GRADING PLAN ARE FOR REFERENCE PURPOSES ONLY. PRIOR TO CONSTRUCTION OR EARTHWORK, CONTRACTOR WILL BE RESPONSIBLE TO CALL FOR LOCATES: (800) 922-1987
3. CENTER OF WELL PAD REFERENCED BELOW CORRESPONDS TO THE SURFACE LOCATION OF THE LATHAM 41-11-14HNB WELL.

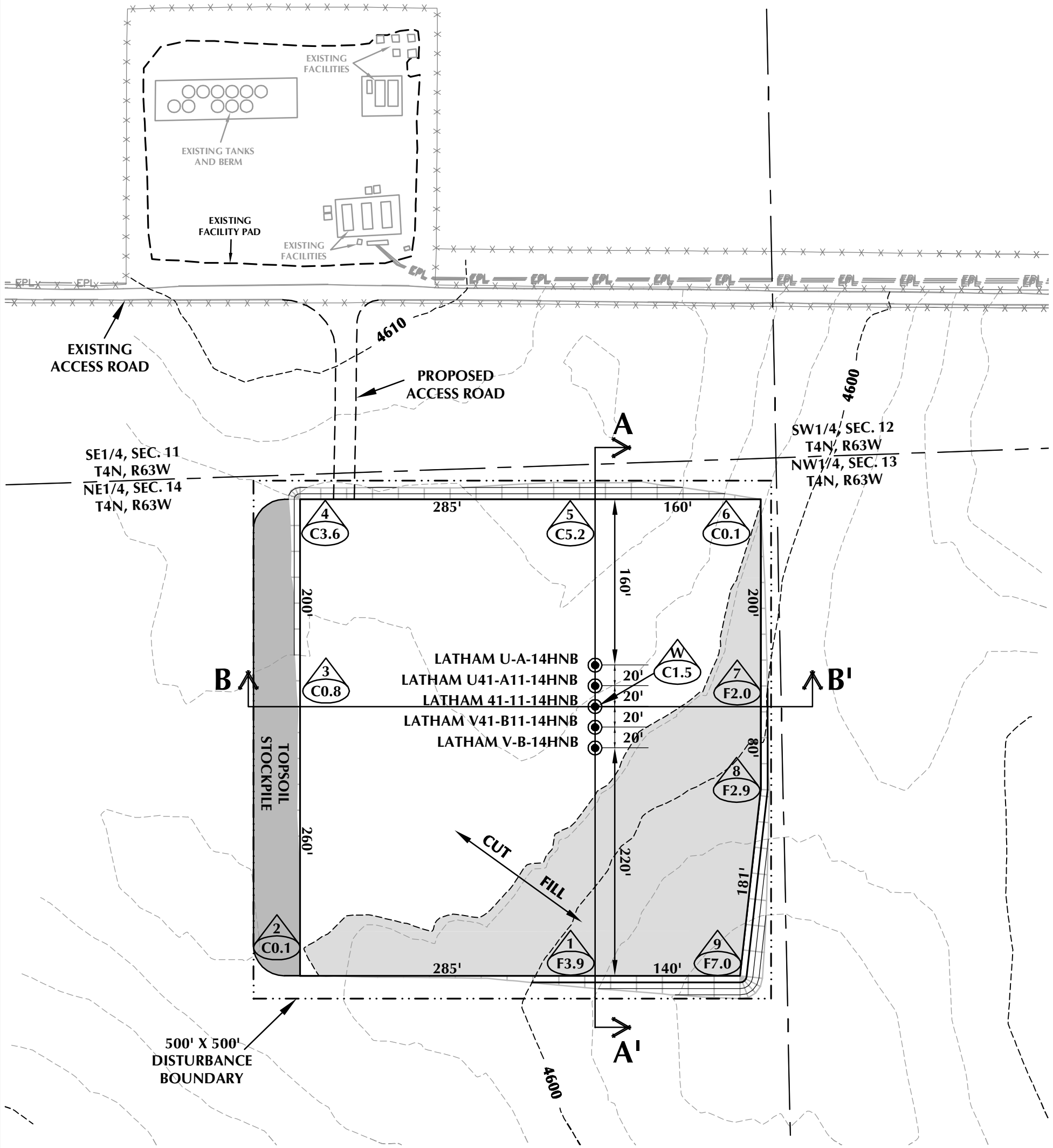

WELL PAD - LATHAM U-14 DESIGN SUMMARY

WELL PAD QUANTITIES AND DESIGN PARAMETERS

EXISTING GRADE @ CENTER OF WELL PAD = 4603.7'
FINISHED GRADE ELEVATION = 4602.2'
CUT SLOPES = 3:1
FILL SLOPES = 3:1
SHRINKAGE FACTOR = 1.10
SWELL FACTOR = 1.00
GRADED WELL PAD SURFACE AREA = 4.66 ACRES
TOTAL WELL PAD AREA = 5.01 ACRES
TOTAL DISTURBANCE AREA = 5.74 ACRES

WELL PAD QUANTITIES

TOTAL CUT FOR WELL PAD = 7,855 C.Y.
TOTAL FILL FOR WELL PAD = 7,855 C.Y.
TOPSOIL @ 6" DEPTH = 4,043 C.Y.
EXCESS MATERIAL = 0 C.Y.

PLATING MATERIAL VOLUME
TO BE ADDED TO WELL PAD = 2,500 C.Y.
(ASSUMING 4 INCHES DEPTH)

WELL PAD LEGEND

- EXISTING WELL LOCATION
- PROPOSED WELL LOCATION
- EXISTING CONTOURS (2' INTERVAL)
- PROPOSED CONTOURS (2' INTERVAL)
- EPL EXISTING PIPELINE
- PPL PROPOSED PIPELINE
- EXISTING FENCE



HORIZONTAL 0 50' 100' 1" = 100'
2' CONTOURS

SCALE: 1"=100' DATE: 1/16/14 SHEET NO:

REVISED:

1

1 OF 2

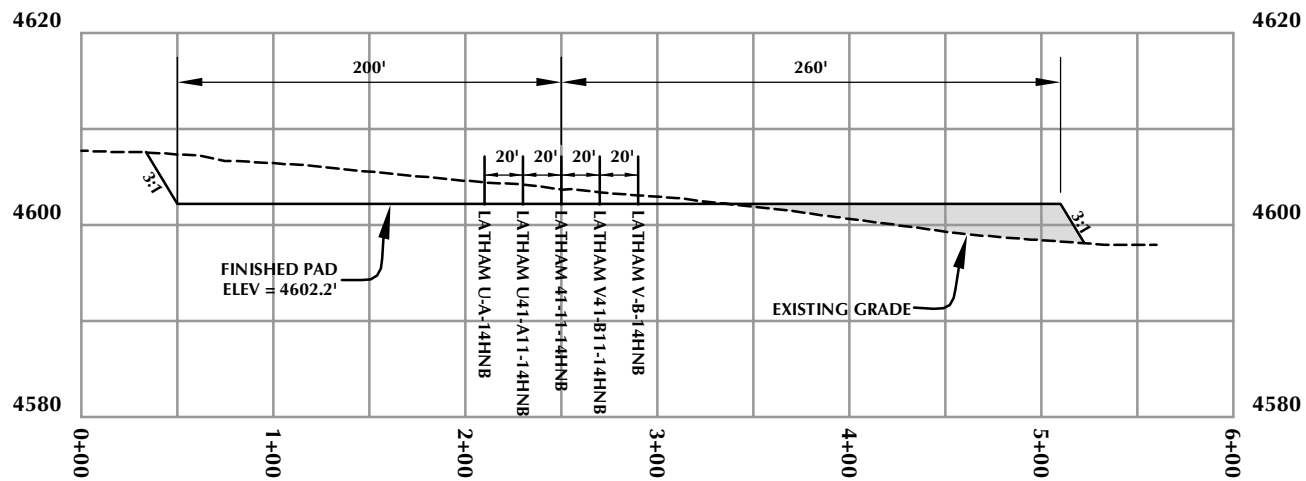

CROSS SECTION A-A'

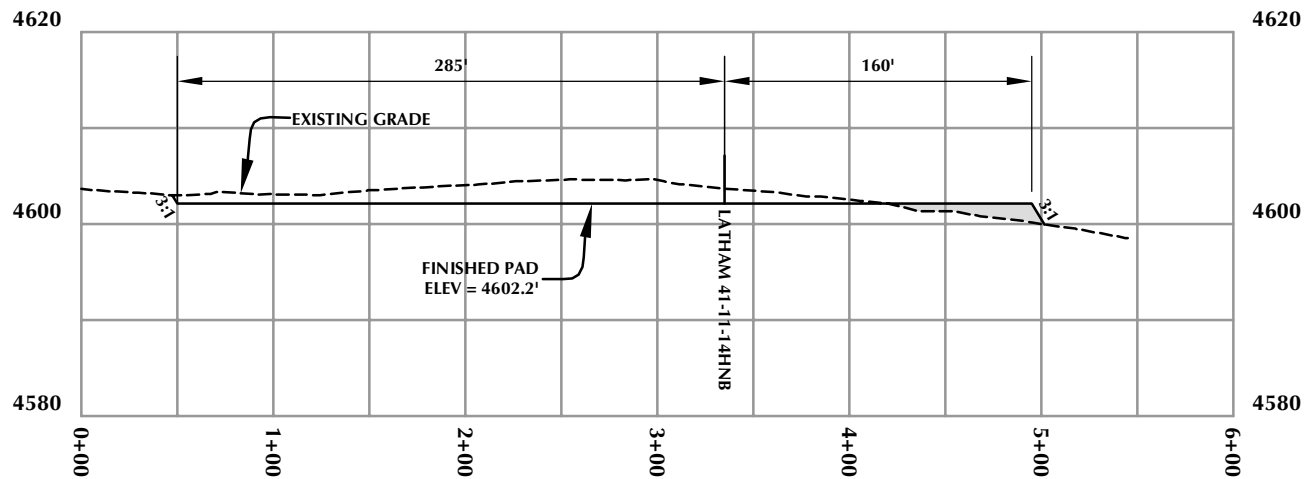

CROSS SECTION B-B'

WELL PAD - LATHAM U-14

WELL PAD - CROSS SECTIONS
LATHAM U-A-14HNB,
LATHAM U41-A11-14HNB, LATHAM 41-11-14HNB,
LATHAM V41-B11-14HNB & LATHAM V-B-14HNB
LOCATED IN SECTION 14, T4N, R63W, 6TH P.M.
WELD COUNTY, COLORADO

BONANZA CREEK
410 17th Street, Suite 1400
Denver, Colorado 80202



LOVELAND OFFICE
1635 Foxtrail Drive, Suite 204
Loveland, Colorado 80538
Phone 970-776-4331

SHERIDAN OFFICE
2155 North Main Street
Sheridan, Wyoming 82801
Phone 307-674-0609

HORIZONTAL 0 50' 100' 1" = 100'
VERTICAL 0 10' 20' 1" = 20'

Scale: 1"=100'	Date: 1/16/14	SHEET NO:
REVISED:		2 2 OF 2