

N.W. COR.
SEC. 14, T4N, R63W
FOUND ALUM. CAP
L.S. NO. 34995
LAT:40.319709
LON:-104.414918

T4N, R63W

LAT:40.319865
LON:-104.405399
S 88°04'02" W 5310.17' (M)

NE. COR.
SEC. 14, T4N, R63W
FOUND ALUM. CAP
L.S. NO. 4845
LAT:40.320021
LON:-104.395879

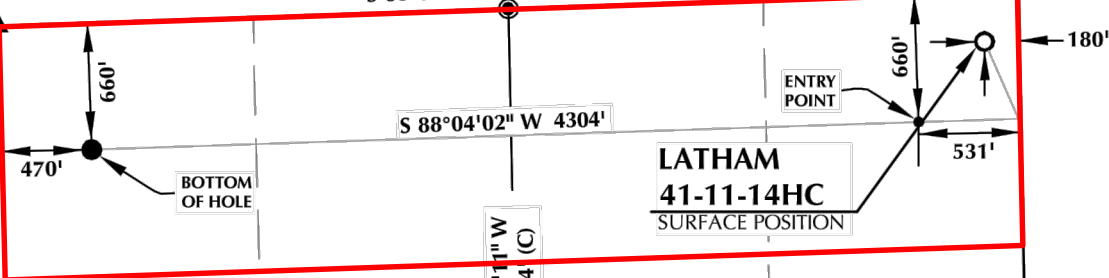

N 01°32'32" W 5275.21' (M)

LAT:40.312469
LON:-104.414779

S 88°02'32" W
2645.63' (C)

14

LAT:40.312628
LON:-104.405295

S 88°02'32" W
2645.63' (C)

LAT:40.312786
LON:-104.395810

N 01°07'50" W 5271.00' (M)

SURFACE LOCATION
GROUND ELEVATION= 4603.4'
LATITUDE= 40.319313°
LONGITUDE= -104.396518°
1/4 1/4: NE1/4 NE1/4

ENTRY POINT
LATITUDE= 40.318178°
LONGITUDE= -104.397766°
1/4 1/4: NE1/4 NE1/4

BOTTOM HOLE LOCATION
LATITUDE= 40.317925°
LONGITUDE= -104.413198°
1/4 1/4: NW1/4 NW1/4

N 01°20'11" W
2636.54' (C)

LAT:40.305391
LON:-104.405191

S 88°01'02" W 5272.35' (M)

SE. COR.
SEC. 14, T4N, R63W
FOUND ALUM. CAP
L.S. NO. 34995
LAT:40.305552
LON:-104.395741

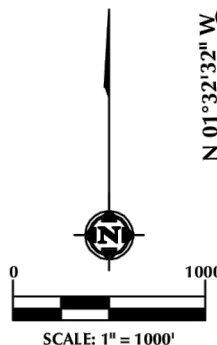

SW. COR.
SEC. 14, T4N, R63W
FOUND ALUM. CAP
L.S. NO. 34995
LAT:40.305230
LON:-104.414641

CERTIFICATE OF SURVEYOR:

THIS IS TO CERTIFY THAT THE ABOVE PLAT WAS PREPARED
FROM FIELD NOTES OF ACTUAL SURVEY MADE BY ME OR
UNDER MY SUPERVISION AND THAT THE SAME ARE TRUE AND
CORRECT.

NEAREST CULTURAL ITEMS:

BUILDING: ±5102' E
BUILDING UNIT: ±5102' E
HIGH OCCUPANCY BUILDING UNIT: 5280'+

NOTES:

1. ▲ INDICATES FOUND SECTION CORNER
2. ● INDICATES CALCULATED CORNER
3. DRAWING LATITUDE AND LONGITUDE COORDINATES ARE NAD 83 (CORS 96)(EPOCH:2002)
4. ELEVATION BASED ON NAVD88 (GEOID09)
5. BASIS OF BEARING DERIVED FROM COLORADO COORDINATE



**BONANZA
CREEK**

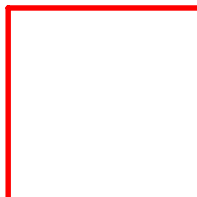

Wellbore Spacing Unit Outline



Wellbore Spacing Unit Map

26 December 2013 ksc

Latham 41-11-14HC
N/2N/2 Sec 14-T4N-R63W 6th PM
Weld County, Colorado