



March 21, 2014

Mr. Brandon Danforth
Environmental Specialist
WPX Energy Rocky Mountain LLC
1058 County Road 215
Parachute, Colorado 81635

RE: Status Report: Baseline Water Quality Sampling – RGU 33-24-198 Drill Pad

Dear Mr. Danforth,

Western Water & Land, Inc. (WWL) completed a hydrologic Water Source evaluation for the WPX Energy Rocky Mountain LLC (WPX) RGU 33-24-198 Drill Pad in accordance with Colorado Oil and Gas Conservation Commission (COGCC) Rule 609. Drill Pad RGU 33-24-198 is located in NW1/4, SE1/4, Section 24, Township 1 S, Range 98 W, 6th P.M. This status report addresses field revisions and the sampling location status as relevant to the original executed Baseline Water Quality Evaluation dated August 30, 2013.

The original evaluation considered all Water Sources as defined in Rule 609 within a 0.5-mile radius of the referenced drill pad. Water Sources located within a 0.5-mile radius of the RGU 33-24-198 Drill Pad are shown in Figure 1. Please see the original Baseline Water Quality Evaluation (August 30, 2013) for complete details on how the evaluation was conducted.

Water Source Identification

Water Sources as defined in Rule 609 include Colorado Division of Water Resources (DWR) registered water wells (water wells with existing valid well permits), permitted or adjudicated springs, and monitoring wells installed for baseline sampling and monitoring under COGCC Rules 318A.e(4), 608, or 609. Each Water Source identified within the 0.5-mile radius area is considered to be a potentially Available Water Source unless existing information suggests that the Water Source would not be suitable for the baseline water quality program. The original Baseline Water Quality Evaluation identified two potentially Available Water Sources located within 0.5 miles of the RGU 33-24-198 Drill Pad (see Figure 1). Well permits with the status “Permit issued; Completion status unknown” were not initially included as potentially Available Water Sources. However, because DWR databases are not always up to date, or may have errors, WWL has since revised this approach and includes permits with this status as potentially Available Water Sources.

The identified potentially Available Water Sources are summarized as follows:

- Water Well Permit No. 11529-F: permit held by White River Nahcolite Minerals, LTD; property owned by Bureau of Land Management (BLM)
- Water Well Permit No. 33372-F: permit held by Natec Mines, Ltd.; property owned by BLM

Preferred Water Sources

In accordance with Rule 609, all potentially Available Water Sources within a 0.5-mile radius of the drill pad are to be identified and up to a maximum of four sources must be included in the baseline and subsequent monitoring program. Each potentially Available Water Source identified was evaluated based on WWL's hydrologic knowledge of the region, general hydrologic rationale, and in accordance with the guidelines specified in Rule 609 to identify the preferred sources for the baseline program. Since only two potentially Available Water Sources were identified they are considered to be preferred Water Sources. The preferred potentially Available Water Sources are as follows:

- Water Well Permit No. 11529-F
- Water Well Permit No. 33372-F

Preferred Water Sources are incorporated into the baseline water quality monitoring program provided the structures exist, and the structure owner, or land owner if the structure owner is not known, grants approval to sample the source and inspection of the structure confirms that a representative sample can be obtained from the structure.

Access Request

All attempts requesting permission to sample potentially Available Water Sources from the well permit holders and from the property owners are recorded in the Correspondence Log below. Access request letters, certified mailing receipts, mailings that were returned to sender, mailed responses, and email correspondence are included in Attachment A.

No access was granted to sample the Preferred Water Sources and the Preferred Water Sources were the only water sources identified within the 0.5 mile radius of Drill Pad RGU 33-24-198.

Correspondence Log: RGU 33-24-198				
Contact Attempt Date	Contact Name	Contact Method	Responsible Person	Results
9/5/2013	Natec Mines, LTD	Certified Mail: Access Request Letter	NWS	Returned to Sender
9/5/2013	White River Nahcolite Minerals, LTD	Certified Mail: Access Request Letter	NWS	Returned to Sender
9/5/2013	White River Nahcolite Minerals, LTD	Certified Mail: Access Request Letter	NWS	Returned to Sender

Field Results

No baseline water quality sampling was conducted for Drill Pad RGU 33-24-198 because access was not granted to the identified Potential Available Water Sources.

Each identified potentially Available Water Source and its monitoring status is as follows:

- Water Well Permit No. 11529-F: permit held by White River Nahcolite Minerals, LTD; property owned by Bureau of Land Management (BLM)
 - Access was not granted to sample this water source
- Water Well Permit No. 33372-F: permit held by Natec Mines, Ltd.; property owned by BLM
 - Access was not granted to sample this water source

If you have any questions or concerns, please contact me at (970) 242-0170.

Sincerely,

A handwritten signature in black ink, appearing to read "Bruce D. Smith". The signature is fluid and cursive, with the first name "Bruce" being the most prominent.

Bruce D. Smith
Principal Hydrogeologist
WESTERN WATER & LAND, INC.

Attachments

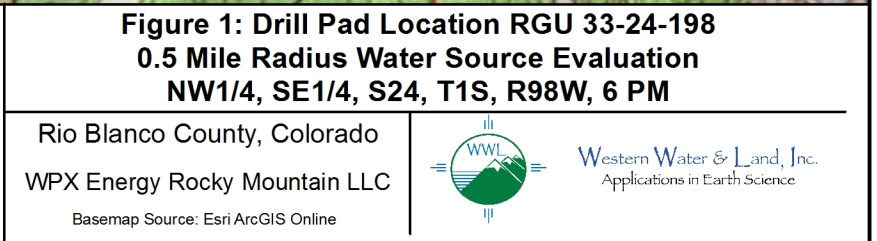
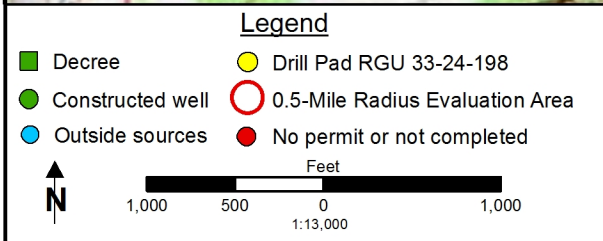
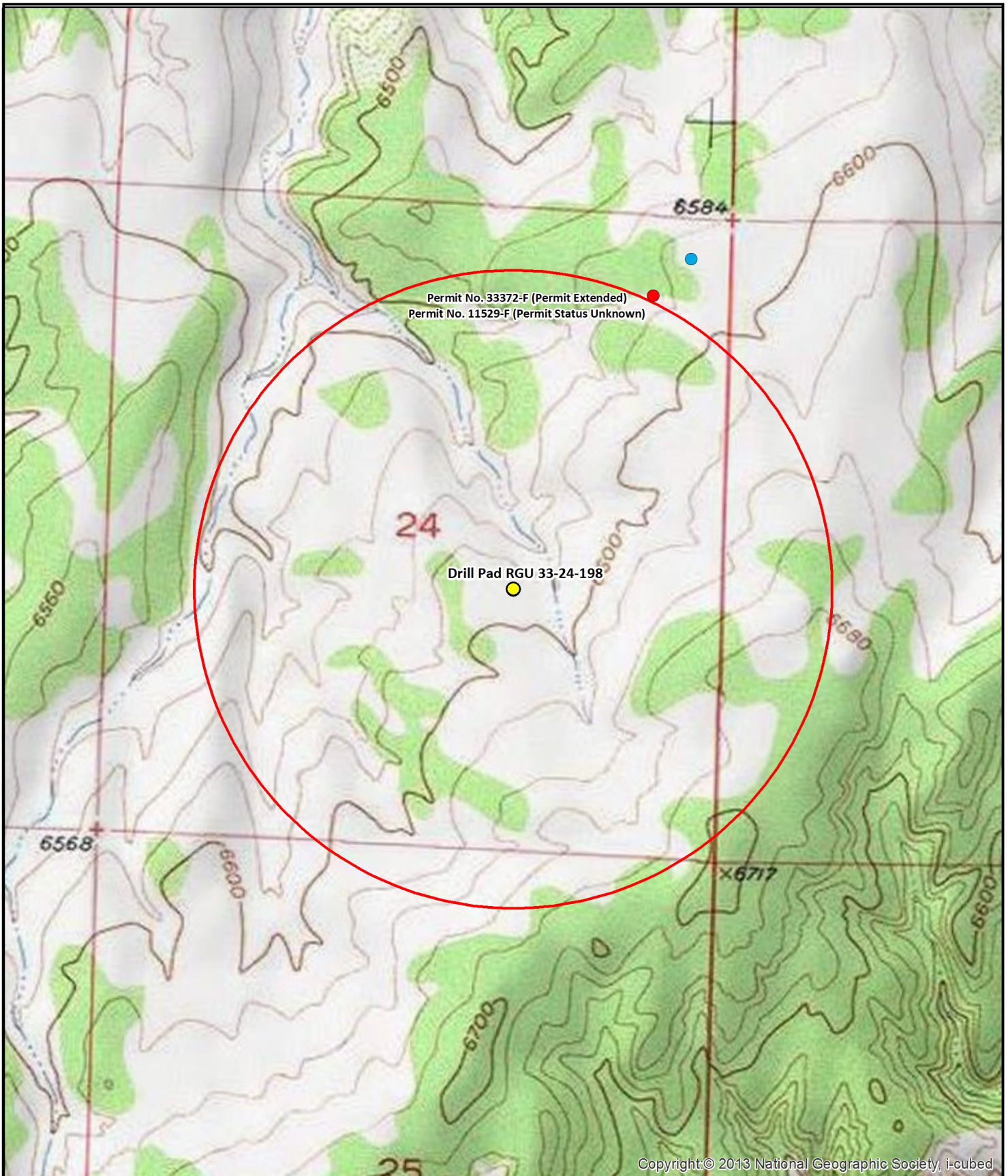

Attachment A

Access Request Documentation



September 5, 2013

Natec Mines, Ltd.
201 W Third Street #101
Rifle, CO 81650

RE: Baseline Groundwater Monitoring Program

To whom it may concern:

Under Colorado Oil and Gas Conservation Commission (COGCC) Rule 609, all oil and gas operators are required to conduct baseline groundwater sampling and monitoring within one-half mile of a well pad containing new production well(s) or injection well(s). The rule was promulgated to gather baseline water quality data prior to oil and gas development occurring within a particular area and to gather additional water quality data after drilling and completion operations.

WPX Energy Rocky Mountain, LLC (WPX) is planning on constructing a well pad in the NW1/4, SE1/4, Section 24, Township 1S, Range 98W, 6th P.M. Our research of state databases indicates that there may be one or multiple permitted wells or springs located on your property that could qualify for baseline sampling and monitoring under Rule 609. If you do not have a well or spring on your property, or if you choose not to have your well or spring sampled for baseline water quality under Rule 609, please indicate so in the signature section at the end of this letter.

If you are willing to include your well or spring in the Baseline Groundwater Sampling and Monitoring Program, please complete the attached questionnaire prepared by WPX to evaluate the groundwater source(s). The questionnaire is intended to assist WPX in the assessment of the best potential baseline groundwater monitoring sites. Up to four groundwater sampling sites will be included in the baseline sampling and monitoring program within the one-half mile radius of the well pad. Sampling of these groundwater sites will occur three times; once within 12 months prior to drilling the first well on the pad, once between 6 and 12 months after completion of the last well on the pad, and once between 60 and 72 months after completion of the last well on the pad. Final water quality results of each sample will be provided to the well or spring owner and to COGCC.

Sampling sites may be registered water wells or permitted or adjudicated springs. Final selection of sampling sites may be partially dependent on the results of the attached questionnaire. Completing this questionnaire does not guarantee that your well or spring will be selected for the baseline sampling and monitoring program, and completion of the form is not required for consideration of your well or spring for the program. Completed questionnaires will be confidential except for information that is required to be reported to the state.

If you agree to have your well or spring become a monitoring site for the program, and said well or spring is selected for sampling and monitoring, water quality data results will be provided to you and to COGCC within 3 months of sample collection. Please note that COGCC will make the results public by posting the results on the agency's public database and that by signing below agreeing to have your well sampled, you are also providing WPX permission to provide the data results to COGCC and COGCC's public database.

Please sign and date the attached Acknowledgment form indicating your choice of participation in the program and return using the included pre-addressed envelope. If WPX does not receive this executed letter within 30 days from the date above, WPX will consider that you do not want to participate in the program. Please contact your WPX land representative at 970-285-9377 with any questions you may have. We appreciate your time and cooperation.

Baseline Groundwater Quality Monitoring Program Acknowledgment

I _____(print name), acknowledge that I have been contacted by WPX regarding the possible qualification of my well or spring as a Water Source for baseline groundwater sampling and monitoring under COGCC Rule 609. If I agree to have my well or spring water sampled for water quality parameters, I understand that the resulting data will be submitted to the COGCC and will be part of a public database. I understand that if my well or spring is selected as an Available Water Source, I will be contacted by WPX representatives to schedule sample collection. I understand that the baseline groundwater program involves three separate sampling events over a period of time.

I DO / DO NOT (circle one) want my well or spring to be monitored for baseline groundwater quality in accordance with Rule 609 of the COGCC regulations.

Signature: _____ Date:_____

Print Name: _____

Address: _____

Phone: _____

English

Customer Service

USPS Mobile

Quick Tools
Track

Find

Ship a Package

Send Mail

Find USPS Locations
Buy Stamps
Schedule a Pickup
Calculate Postage
Find Mail Boxes
Hold Mail
Change of Address

USPS Tracking™

Tracking Number: 70123050000236558221

Scheduled Delivery Day: September 6, 2013

Product & Tracking Information

Postal Product:
First-Class Mail®

Features:
Certified Mail™

DATE & TIME	STATUS OF ITEM	LOCATION
September 30, 2013 , 12:35 pm	Delivered	GRAND JUNCTION, CO 81506
September 28, 2013 , 9:11 am	Notice Left (Business Closed)	GRAND JUNCTION, CO 81506
September 27, 2013 , 6:25 pm	Processed at USPS Origin Sort Facility	DENVER, CO 80266
September 26, 2013	Depart USPS Sort Facility	DENVER, CO 80266
September 26, 2013 , 8:25 pm	Processed at USPS Origin Sort Facility	DENVER, CO 80266
September 24, 2013 , 11:50 am	Addressee Unknown	RIFLE, CO 81650
September 24, 2013 , 11:48 am	Delivered	RIFLE, CO 81650
September 6, 2013 , 12:06 pm	Notice Left (Business Closed)	RIFLE, CO 81650
September 6, 2013 , 8:39 am	Arrival at Unit	RIFLE, CO 81650
September 5, 2013 , 6:03 pm	Dispatched to Sort Facility	GRAND JUNCTION, CO 81501
September 5, 2013 , 12:28 pm	Acceptance	GRAND JUNCTION, CO 81501

Track Another Package

What's your tracking (or receipt) number?

Track It

LEGAL
Privacy Policy ›

ON USPS.COM
Government Services ›

ON ABOUT.USPS.COM
About USPS Home ›

OTHER USPS SITES
Business Customer Gateway ›

U.S. Postal Service™ CERTIFIED MAIL™ RECEIPT (Domestic Mail Only; No Insurance Coverage Provided)

For delivery information visit our website at www.usps.com®

RIFLE CO 81650

OFFICIAL USE

Postage	\$	\$1.72	0501
Certified Fee		\$3.10	05
Return Receipt Fee (Endorsement Required)		\$1.25	
Restricted Delivery Fee (Endorsement Required)		\$0.00	
Total Postage & Fees	\$	\$6.07	09/05/2013



Sent To: Natec Mines, LTD
Street, Apt. No. or PO Box No.: 801 W Third St #101
City, State, ZIP: Rifle, CO 81650

PS Form 3800, August 2006

See Reverse for Instructions

Return Receipt Electronic

Email Updates

RGU 33-24-198
Access Request

Date: October 1, 2013

Bruce Smith:

The following is in response to your October 1, 2013 request for delivery information on your Certified Mail™ item number 70123050000236558221. The delivery record shows that this item was delivered on September 30, 2013 at 12:35 pm in GRAND JUNCTION, CO 81506. The scanned image of the recipient information is provided below.

Signature of Recipient :

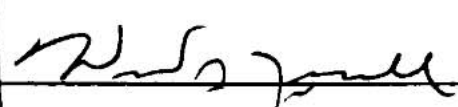
Delivery Section	
Signature	
Name	William C. Merriam

Address of Recipient :

Address	745 Horizon Ct. # 330
---------	-----------------------

Thank you for selecting the Postal Service for your mailing needs.

If you require additional assistance, please contact your local Post Office or postal representative.

Sincerely,
United States Postal Service

Western Water & Land, Inc.
743 Horizon Ct. - Suites 330
Grand Junction, CO 81506



Handwritten: 7/24/13

Natec Mines, Ltd.
201 W Third Street #101
Rifle, CO 81650

Handwritten: NL-CM
1) 9/16
2) 9-19
4) 9-29-13

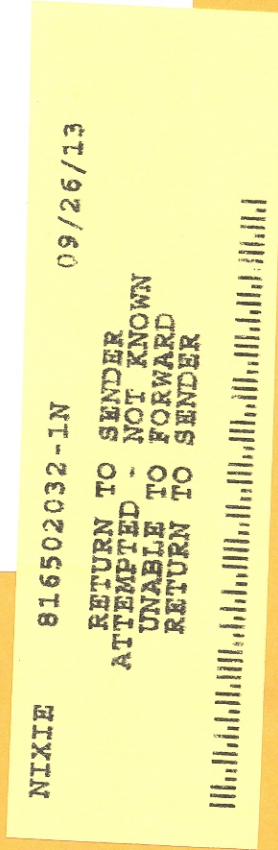



September 5, 2013

White River Nahcolite Minerals, LTD
3505 CR 83
Rifle, CO 81650

RE: Baseline Groundwater Monitoring Program

To whom it may concern:

Under Colorado Oil and Gas Conservation Commission (COGCC) Rule 609, all oil and gas operators are required to conduct baseline groundwater sampling and monitoring within one-half mile of a well pad containing new production well(s) or injection well(s). The rule was promulgated to gather baseline water quality data prior to oil and gas development occurring within a particular area and to gather additional water quality data after drilling and completion operations.

WPX Energy Rocky Mountain, LLC (WPX) is planning on constructing a well pad in the NW1/4, SE1/4, Section 24, Township 1S, Range 98W, 6th P.M. Our research of state databases indicates that there may be one or multiple permitted wells or springs located on your property that could qualify for baseline sampling and monitoring under Rule 609. If you do not have a well or spring on your property, or if you choose not to have your well or spring sampled for baseline water quality under Rule 609, please indicate so in the signature section at the end of this letter.

If you are willing to include your well or spring in the Baseline Groundwater Sampling and Monitoring Program, please complete the attached questionnaire prepared by WPX to evaluate the groundwater source(s). The questionnaire is intended to assist WPX in the assessment of the best potential baseline groundwater monitoring sites. Up to four groundwater sampling sites will be included in the baseline sampling and monitoring program within the one-half mile radius of the well pad. Sampling of these groundwater sites will occur three times; once within 12 months prior to drilling the first well on the pad, once between 6 and 12 months after completion of the last well on the pad, and once between 60 and 72 months after completion of the last well on the pad. Final water quality results of each sample will be provided to the well or spring owner and to COGCC.

Sampling sites may be registered water wells or permitted or adjudicated springs. Final selection of sampling sites may be partially dependent on the results of the attached questionnaire. Completing this questionnaire does not guarantee that your well or spring will be selected for the baseline sampling and monitoring program, and completion of the form is not required for consideration of your well or spring for the program. Completed questionnaires will be confidential except for information that is required to be reported to the state.

If you agree to have your well or spring become a monitoring site for the program, and said well or spring is selected for sampling and monitoring, water quality data results will be provided to you and to COGCC within 3 months of sample collection. Please note that COGCC will make the results public by posting the results on the agency's public database and that by signing below agreeing to have your well sampled, you are also providing WPX permission to provide the data results to COGCC and COGCC's public database.

Please sign and date the attached Acknowledgment form indicating your choice of participation in the program and return using the included pre-addressed envelope. If WPX does not receive this executed letter within 30 days from the date above, WPX will consider that you do not want to participate in the program. Please contact your WPX land representative at 970-285-9377 with any questions you may have. We appreciate your time and cooperation.

Baseline Groundwater Quality Monitoring Program Acknowledgment

I _____(print name), acknowledge that I have been contacted by WPX regarding the possible qualification of my well or spring as a Water Source for baseline groundwater sampling and monitoring under COGCC Rule 609. If I agree to have my well or spring water sampled for water quality parameters, I understand that the resulting data will be submitted to the COGCC and will be part of a public database. I understand that if my well or spring is selected as an Available Water Source, I will be contacted by WPX representatives to schedule sample collection. I understand that the baseline groundwater program involves three separate sampling events over a period of time.

I DO / DO NOT (circle one) want my well or spring to be monitored for baseline groundwater quality in accordance with Rule 609 of the COGCC regulations.

Signature: _____ Date:_____

Print Name: _____

Address: _____

Phone: _____

English

Customer Service

USPS Mobile

Register / Sign In



Search USPS.com or Track Packages

Quick Tools
Track

Find

Ship a Package

Send Mail

Manage Your Mail

Shop

Business Solutions

Find USPS Locations
Buy Stamps
Schedule a Pickup
Cash a Money Order
Find Mail
Hold Mail
Change of Address

USPS Tracking™



Customer Service >

Have questions? We're here to help.

Tracking Number: 70123050000236558238

Scheduled Delivery Day: September 6, 2013

Product & Tracking Information

Postal Product:
First-Class Mail®Features:
Certified Mail™

Available Options

Return Receipt Electronic

Email Updates

DATE & TIME	STATUS OF ITEM	LOCATION
September 13, 2013 , 11:03 am	Delivered	GRAND JUNCTION, CO 81506
September 11, 2013 , 5:14 pm	Processed at USPS Origin Sort Facility	DENVER, CO 80266
September 10, 2013	Depart USPS Sort Facility	DENVER, CO 80266
September 10, 2013 , 7:43 pm	Processed at USPS Origin Sort Facility	DENVER, CO 80266
September 6, 2013 , 4:14 pm	No Such Number	RIFLE, CO 81650
September 6, 2013 , 12:20 pm	Arrival at Unit	RIFLE, CO 81650
September 5, 2013 , 6:03 pm	Dispatched to Sort Facility	GRAND JUNCTION, CO 81501
September 5, 2013 , 12:28 pm	Acceptance	GRAND JUNCTION, CO 81501

RGU 33-24-198
Access Request

Track Another Package

What's your tracking (or receipt) number?

Track It

LEGAL

Privacy Policy >
Terms of Use >
FOIA >
No FEAR Act EEO Data >

ON USPS.COM

Government Services >
Buy Stamps & Shop >
Print a Label with Postage >
Customer Service >
Delivering Solutions to the Last Mile >
Site Index >ON /
About
News
USPS
Form
Care

Copyright© 2013 USPS. All Rights Reserved.

U.S. Postal Service™
CERTIFIED MAIL™ RECEIPT
(Domestic Mail Only; No Insurance Coverage Provided)

For delivery information visit our website at www.usps.com®

RIFLE CO 81650

Postage	\$ 1.72	0501
Certified Fee	\$3.10	05
Return Receipt Fee (Endorsement Required)	\$1.25	
Restricted Delivery Fee (Endorsement Required)	\$0.00	
Total Postage & Fees	\$6.07	

Postmark
Here
SEP 5 2013
09/05/2013Sent To
White River Walcolite Minerals, LTD
Street, Apt. No.
or PO Box No. 5505 CR 83
City, State, Zip+4 RIFLE, CO 81650

PS Form 3800, August 2006

See Reverse for Instructions

Date: October 1, 2013

Bruce Smith:

The following is in response to your October 1, 2013 request for delivery information on your Certified Mail™ item number 70123050000236558238. The delivery record shows that this item was delivered on September 13, 2013 at 11:03 am in GRAND JUNCTION, CO 81506. The scanned image of the recipient information is provided below.

Signature of Recipient :

Delivery section	
no	2127-
id	William C Moore

Address of Recipient :

my id	743 Horizon Ct. # 330
----------	-----------------------

Thank you for selecting the Postal Service for your mailing needs.

If you require additional assistance, please contact your local Post Office or postal representative.

Sincerely,
United States Postal Service

Western Water & Land, Inc.
743 Horizon Ct. - Suites 330
Grand Junction, CO 81506

PLACE STICKER AT TOP OF ENVELOPE TO THE RIGHT
OF THE RETURN ADDRESS, FOLD AT DOTTED LINE

CERTIFIED MAIL™



7012 3050 0002 3655 8245



U.S. POSTAGE
PAID
GRAND JUNCTION, CO
81501
SEP 05, 13
AMOUNT



1000

81650

\$6.07
00021981-05

White River Nahcolite Minerals, LTD
3505 CR 83
Rifle, CO 81650

NIXIE

816506039-1N

09/09/13

RETURN TO SENDER
NO SUCH NUMBER
UNABLE TO FORWARD
RETURN TO SENDER



September 5, 2013

White River Nahcolite Minerals, LTD
PO Drawer 72
Rifle, CO 81650

RE: Baseline Groundwater Monitoring Program

To whom it may concern:

Under Colorado Oil and Gas Conservation Commission (COGCC) Rule 609, all oil and gas operators are required to conduct baseline groundwater sampling and monitoring within one-half mile of a well pad containing new production well(s) or injection well(s). The rule was promulgated to gather baseline water quality data prior to oil and gas development occurring within a particular area and to gather additional water quality data after drilling and completion operations.

WPX Energy Rocky Mountain, LLC (WPX) is planning on constructing a well pad in the NW1/4, SE1/4, Section 24, Township 1S, Range 98W, 6th P.M. Our research of state databases indicates that there may be one or multiple permitted wells or springs located on your property that could qualify for baseline sampling and monitoring under Rule 609. If you do not have a well or spring on your property, or if you choose not to have your well or spring sampled for baseline water quality under Rule 609, please indicate so in the signature section at the end of this letter.

If you are willing to include your well or spring in the Baseline Groundwater Sampling and Monitoring Program, please complete the attached questionnaire prepared by WPX to evaluate the groundwater source(s). The questionnaire is intended to assist WPX in the assessment of the best potential baseline groundwater monitoring sites. Up to four groundwater sampling sites will be included in the baseline sampling and monitoring program within the one-half mile radius of the well pad. Sampling of these groundwater sites will occur three times; once within 12 months prior to drilling the first well on the pad, once between 6 and 12 months after completion of the last well on the pad, and once between 60 and 72 months after completion of the last well on the pad. Final water quality results of each sample will be provided to the well or spring owner and to COGCC.

Sampling sites may be registered water wells or permitted or adjudicated springs. Final selection of sampling sites may be partially dependent on the results of the attached questionnaire. Completing this questionnaire does not guarantee that your well or spring will be selected for the baseline sampling and monitoring program, and completion of the form is not required for consideration of your well or spring for the program. Completed questionnaires will be confidential except for information that is required to be reported to the state.

If you agree to have your well or spring become a monitoring site for the program, and said well or spring is selected for sampling and monitoring, water quality data results will be provided to you and to COGCC within 3 months of sample collection. Please note that COGCC will make the results public by posting the results on the agency's public database and that by signing below agreeing to have your well sampled, you are also providing WPX permission to provide the data results to COGCC and COGCC's public database.

Please sign and date the attached Acknowledgment form indicating your choice of participation in the program and return using the included pre-addressed envelope. If WPX does not receive this executed letter within 30 days from the date above, WPX will consider that you do not want to participate in the program. Please contact your WPX land representative at 970-285-9377 with any questions you may have. We appreciate your time and cooperation.

Baseline Groundwater Quality Monitoring Program Acknowledgment

I _____(print name), acknowledge that I have been contacted by WPX regarding the possible qualification of my well or spring as a Water Source for baseline groundwater sampling and monitoring under COGCC Rule 609. If I agree to have my well or spring water sampled for water quality parameters, I understand that the resulting data will be submitted to the COGCC and will be part of a public database. I understand that if my well or spring is selected as an Available Water Source, I will be contacted by WPX representatives to schedule sample collection. I understand that the baseline groundwater program involves three separate sampling events over a period of time.

I DO / DO NOT (circle one) want my well or spring to be monitored for baseline groundwater quality in accordance with Rule 609 of the COGCC regulations.

Signature: _____ Date:_____

Print Name: _____

Address: _____

Phone: _____

English

Customer Service

USPS Mobile

Register / Sign In



Search USPS.com or Track Packages

Quick Tools
Track

Find

Ship a Package

Send Mail

Manage Your Mail

Shop

Business Solutions

Find USPS Locations
Buy Stamps
Schedule a Pickup
Cancel a Package
Find a Retailer
Hold Mail
Change of Address

USPS Tracking™



Customer Service >

Have questions? We're here to help.

Tracking Number: 70123050000236558214

Scheduled Delivery Day: September 6, 2013

Product & Tracking Information

Postal Product:
First-Class Mail®Features:
Certified Mail™

Return Receipt Electronic

Email Updates

DATE & TIME	STATUS OF ITEM	LOCATION
September 13, 2013 , 11:03 am	Delivered	GRAND JUNCTION, CO 81506
September 11, 2013 , 5:14 pm	Processed at USPS Origin Sort Facility	DENVER, CO 80266
September 10, 2013	Depart USPS Sort Facility	DENVER, CO 80266
September 10, 2013 , 7:43 pm	Processed at USPS Origin Sort Facility	DENVER, CO 80266
September 6, 2013 , 12:20 pm	Moved, Left no Address	RIFLE, CO 81650
September 6, 2013 , 12:20 pm	Arrival at Unit	RIFLE, CO 81650
September 5, 2013 , 6:03 pm	Dispatched to Sort Facility	GRAND JUNCTION, CO 81501
September 5, 2013 , 12:28 pm	Acceptance	GRAND JUNCTION, CO 81501

RGU 33-24-198
Access Request

Track Another Package

What's your tracking (or receipt) number?

Track It

LEGAL

Privacy Policy >
Terms of Use >
FOIA >
No FEAR Act EEO Data >

ON USPS.COM

Government Services >
Buy Stamps & Shop >
Print a Label with Postage >
Customer Service >
Delivering Solutions to the Last Mile >
Site Index >

ON
Abr
Ne
US
For
Cal



Copyright© 2013 USPS. All Rights Reserved.

U.S. Postal Service™
CERTIFIED MAIL™ RECEIPT

(Domestic Mail Only; No Insurance Coverage Provided)

For delivery information visit our website at www.usps.com®

RIFLE CO 81650

Postage	\$ 1.72	0501
Certified Fee	\$ 3.10	05
Return Receipt Fee (Endorsement Required)	\$ 1.25	SEP 5 2013
Restricted Delivery Fee (Endorsement Required)	\$ 0.00	
Total Postage & Fees	\$ 6.07	09/05/2013

Sent To
White River Malcolite Minerals, LTD
Street, Apt. No.
or PO Box No. PO Drawer 72
City, State, ZIP+4
Rifle, CO 81650

PS Form 3800, August 2006

See Reverse for Instructions

Date: October 1, 2013

Bruce Smith:

The following is in response to your October 1, 2013 request for delivery information on your Certified Mail™ item number 70123050000236558214. The delivery record shows that this item was delivered on September 13, 2013 at 11:03 am in GRAND JUNCTION, CO 81506. The scanned image of the recipient information is provided below.

Signature of Recipient :

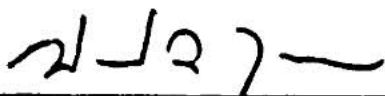
Delivery section	
Signature	
Name	William C Moore

Address of Recipient :

Address	743 Horizon Ct. # 330
---------	-----------------------

Thank you for selecting the Postal Service for your mailing needs.

If you require additional assistance, please contact your local Post Office or postal representative.

Sincerely,
United States Postal Service

Western Water & Land, Inc.
743 Horizon Ct. - Suites 330
Grand Junction, CO 81506

PLACE STICKER AT TOP OF ENVELOPE TO THE RIGHT
OF THE RETURN ADDRESS, FOLD AT DOTTED LINE

CERTIFIED MAIL™

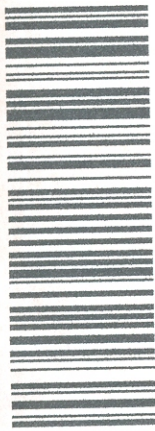

7012 3050 0002 3655 8252



1000



81650

U.S. POSTAGE
PAID
GRAND JUNCTION, CO
81501
SEP 05, 13
AMOUNT

\$6.07

00021981-05

WFF

White River Nahcolite Minerals, LTD
P O Drawer 72
Rifle, CO 81650

NIXIE

616506039-1N

09/09/13

RETURN TO SENDER
UNABLE TO FORWARD
RETURN TO SENDER