

EXTRACTION OIL & GAS

WELD COUNTY, COLORADO

SEC. 36 T6N R66W 6th P.M.

HINER 36NC-18W

ORIGINAL WELLBORE

01 March, 2014

Plan: PROPOSAL #1





Project: WELD COUNTY, COLORADO
Site: SEC. 36 T6N R66W 6th P.M.
Well: HINER 36NC-18W
Wellbore: ORIGINAL WELLBORE
Design: PROPOSAL #1



ANNOTATIONS										
TVD	MD	Inc	Azi	+N/-S	+E/-W	VSect	Dep	Annotation		
900.0	900.0	0.00	0.00	0.0	0.0	0.0	0.0	START NUDGE (2°/100ft BUR)		
1571.0	1577.2	13.54	69.89	27.4	74.8	-71.4	79.7	EOB TO 13.54° INC		
5511.4	5630.5	13.54	69.89	353.7	966.3	-921.4	1029.0	END OF TANGENT		
6182.4	6307.7	0.00	0.00	381.1	1041.1	-992.8	1108.7	EOD TO VERTICAL		
6212.4	6337.7	0.00	0.00	381.1	1041.1	-992.8	1108.7	KOP (9°/100ft BUR)		
6849.0	7337.7	90.00	270.59	387.7	404.5	-359.3	1745.3	ICP - HINER 36NC-18W *NEW*		
6849.0	11641.3	90.00	270.59	432.0	-3898.9	3922.7	6048.9	BHL - HINER 36NC-18W		

WELLBORE TARGET DETAILS (LAT/LONG)						
Name	TVD	+N/-S	+E/-W	Latitude	Longitude	
BTV - HINER 36NC-18W	6212.4	381.1	1041.1	40° 27' 2.232 N	104° 42' 55.282 W	
ICP - HINER 36NC-18W *NEW*	6849.0	387.7	404.5	40° 27' 2.297 N	104° 43' 3.517 W	
BHL - HINER 36NC-18W	6849.0	432.0	-3898.9	40° 27' 2.732 N	104° 43' 59.182 W	

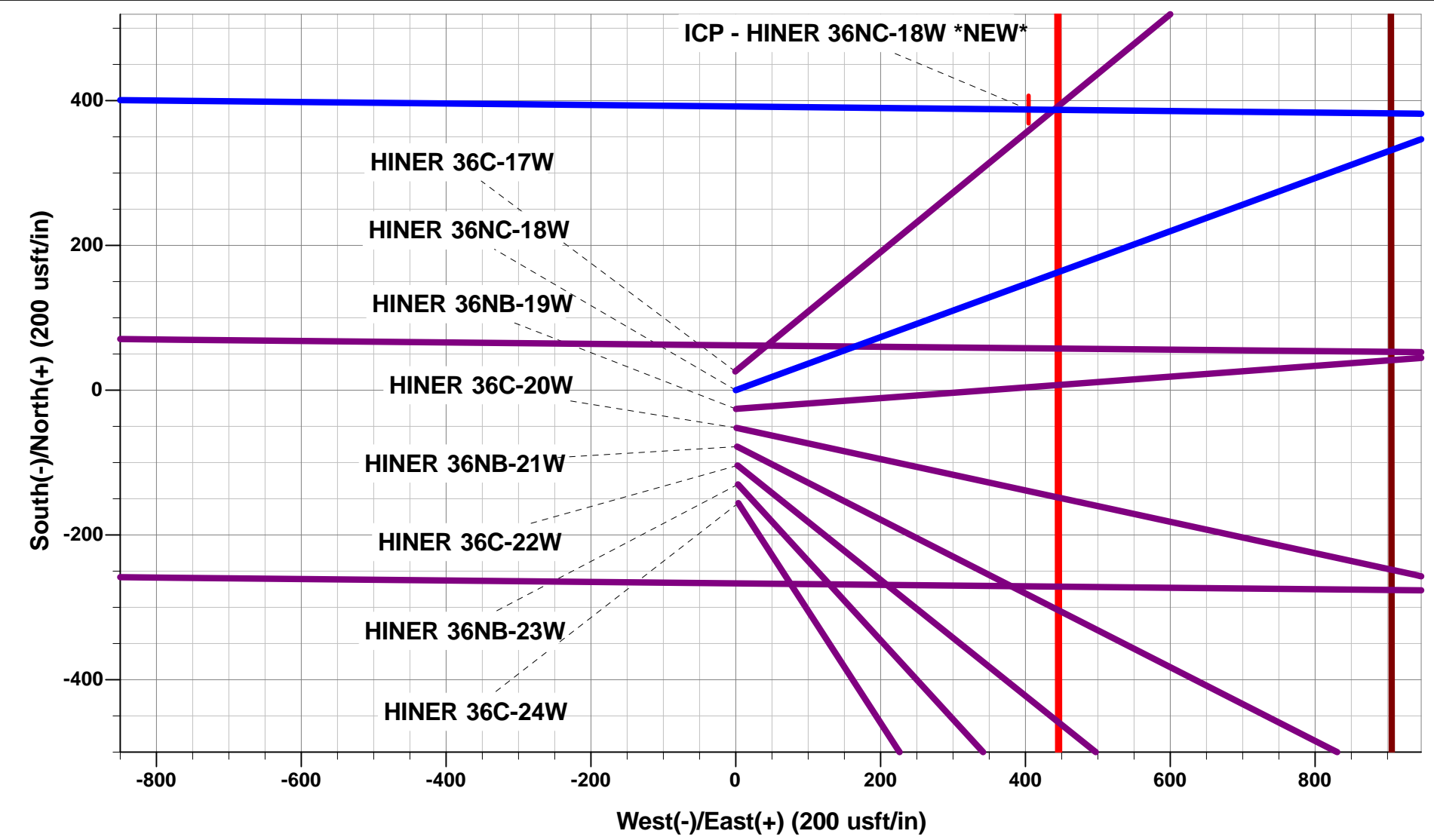

FORMATION TOP DETAILS		
TVDPath	MDPath	Formation
4405.0	4492.4	SUSSEX
4829.0	4928.5	SHANNON
6849.0	7337.7	NIOBARRA

Azimuths to True North
Magnetic North: 8.48°

Magnetic Field
Strength: 52877.8snT
Dip Angle: 67.00°
Date: 01/03/2014
Model: IGRF2010

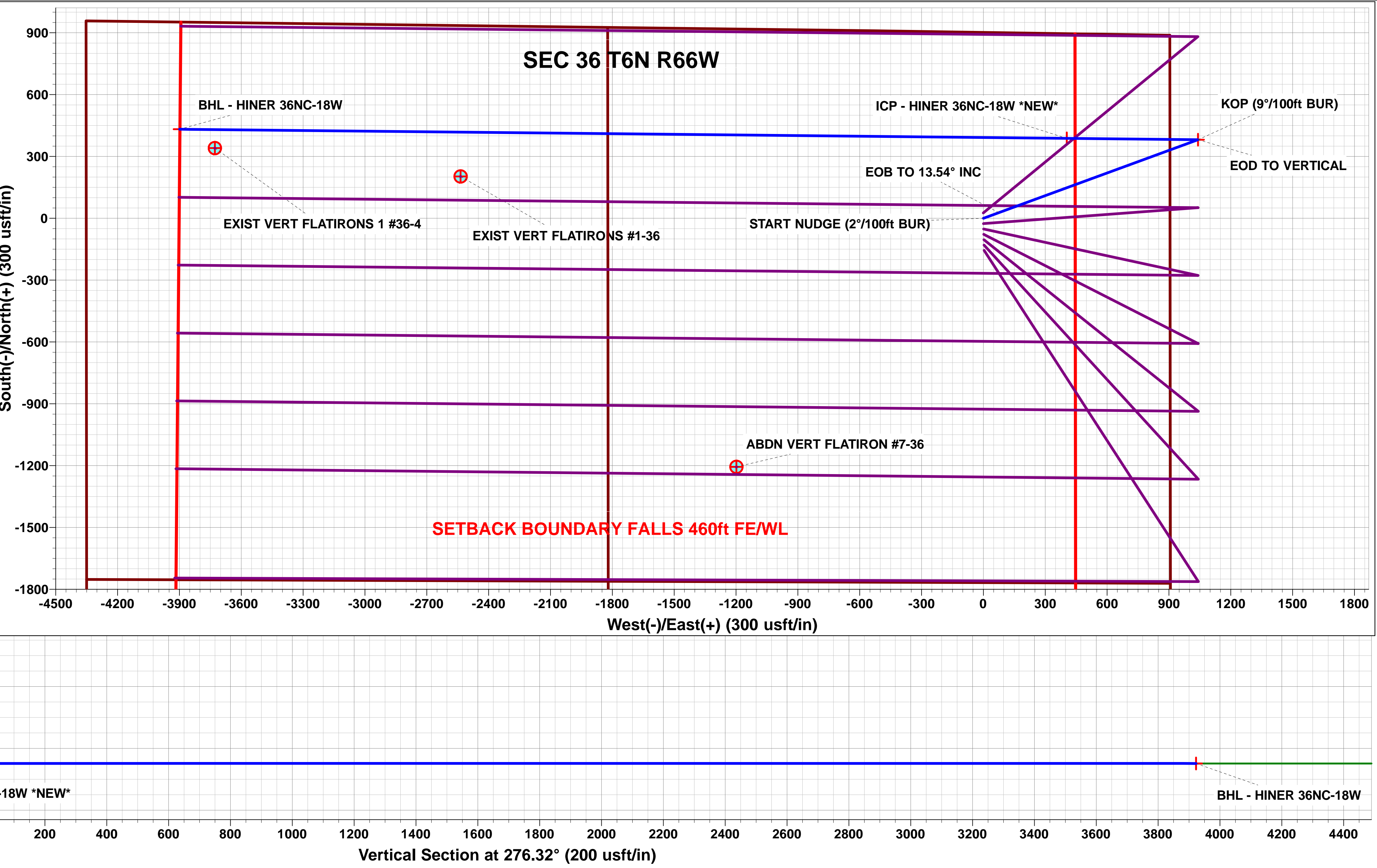
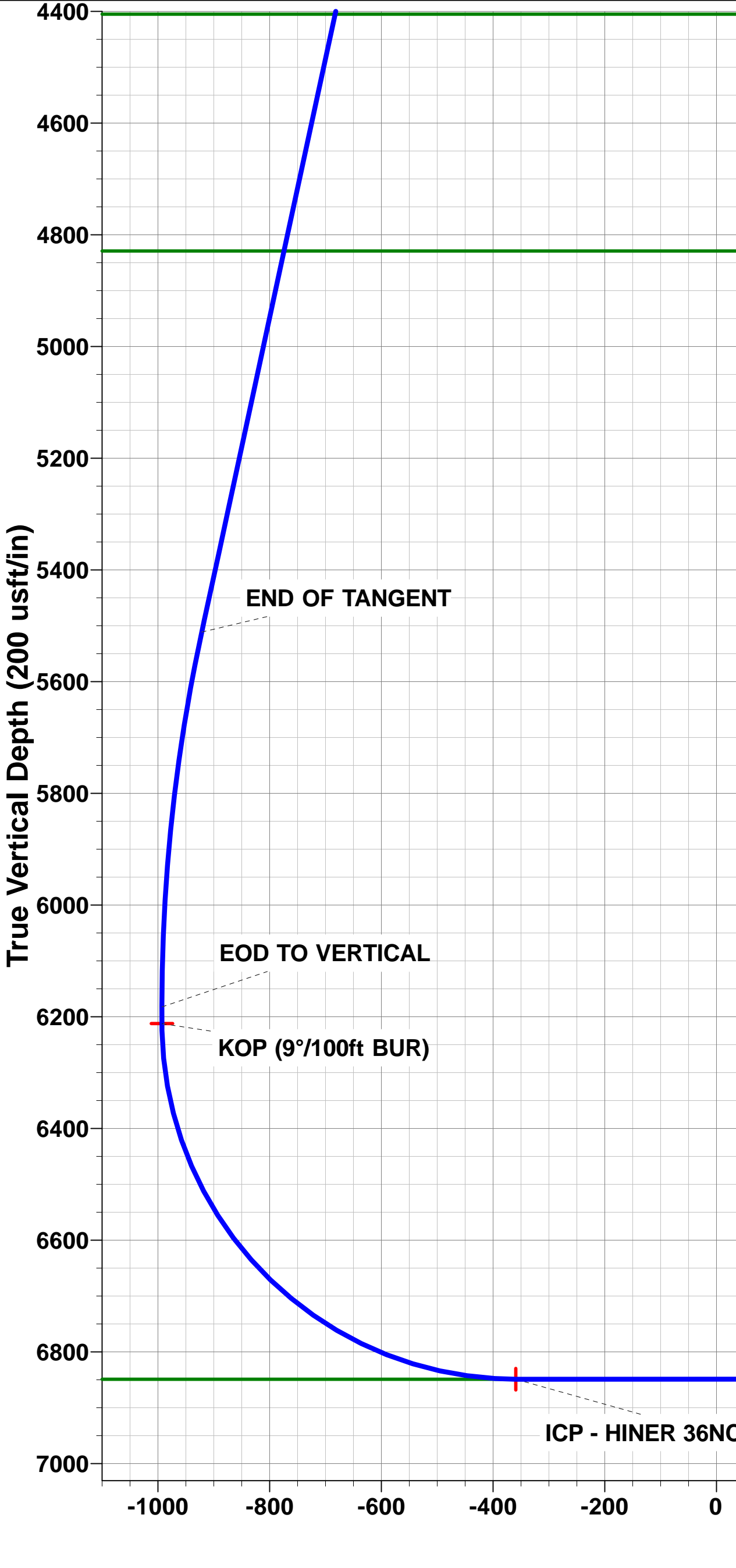
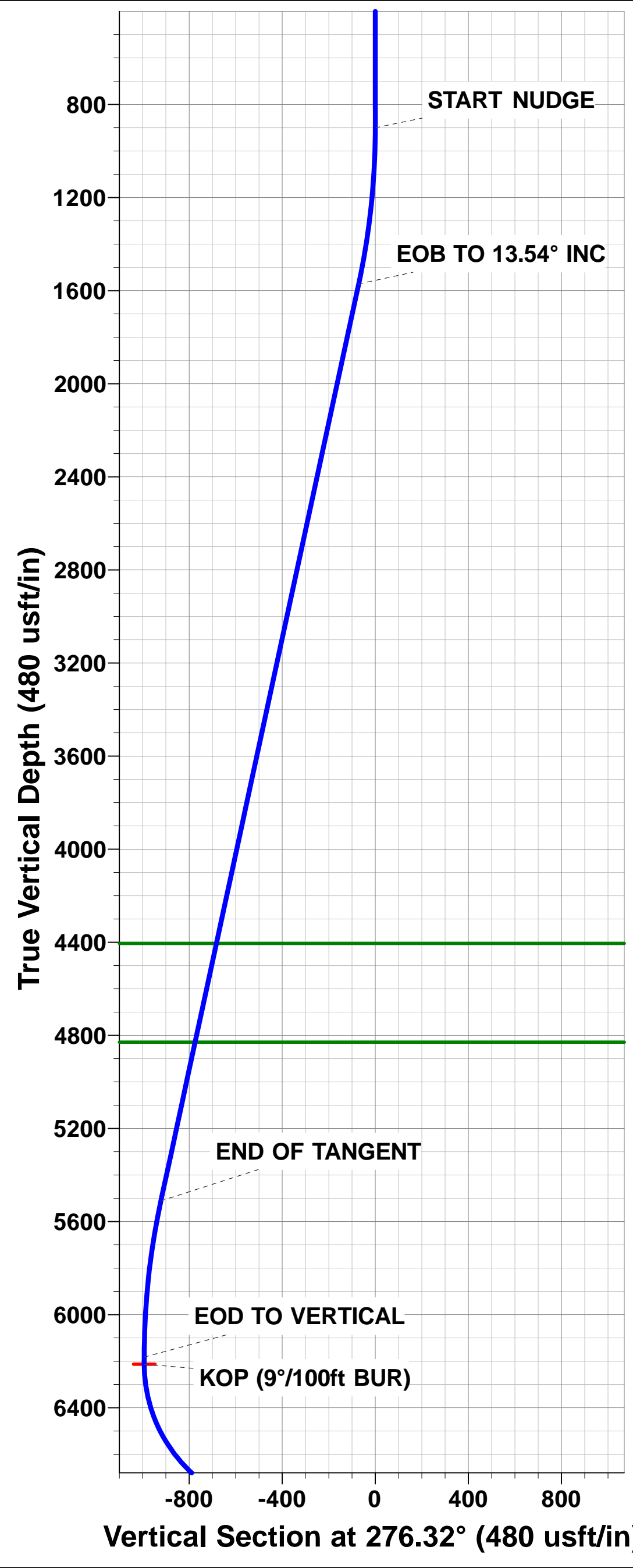

Planning Report



Database:	EDM 5000.1 Single User Db	Local Co-ordinate Reference:	Well HINER 36NC-18W
Company:	EXTRACTION OIL & GAS	TVD Reference:	KB-EST @ 4686.0usft (H&P 319)
Project:	WELD COUNTY, COLORADO	MD Reference:	KB-EST @ 4686.0usft (H&P 319)
Site:	SEC. 36 T6N R66W 6th P.M.	North Reference:	True
Well:	HINER 36NC-18W	Survey Calculation Method:	Minimum Curvature
Wellbore:	ORIGINAL WELLBORE		
Design:	PROPOSAL #1		

Project	WELD COUNTY, COLORADO		
Map System:	US State Plane 1983	System Datum:	Mean Sea Level
Geo Datum:	North American Datum 1983		
Map Zone:	Colorado Northern Zone		Using geodetic scale factor

Site	SEC. 36 T6N R66W 6th P.M.		
Site Position:		Northing:	1,407,602.94 usft
From:	Lat/Long	Easting:	3,217,326.94 usft
Position Uncertainty:	0.0 usft	Slot Radius:	13-3/16"
		Latitude:	40° 26' 58.722 N
		Longitude:	104° 43' 8.756 W
		Grid Convergence:	0.50 °

Well	HINER 36NC-18W		
Well Position	+N/-S	-25.9 usft	Northing:
	+E/-W	0.6 usft	Easting:
Position Uncertainty		0.0 usft	Wellhead Elevation:
			Latitude:
			Longitude:
			Ground Level:

Wellbore	ORIGINAL WELLBORE				
Magnetics	Model Name	Sample Date	Declination (°)	Dip Angle (°)	Field Strength (nT)
	IGRF2010	01/03/2014	8.48	67.00	52,878

Design	PROPOSAL #1			
Audit Notes:				
Version:	Phase:	PROTOTYPE	Tie On Depth:	0.0
Vertical Section:	Depth From (TVD) (usft)	+N/-S (usft)	+E/-W (usft)	Direction (°)
	6,849.0	0.0	0.0	276.32

Plan Sections											
MD (usft)	Inc (°)	Azi (°)	Vertical Depth	SS (usft)	+N/-S (usft)	+E/-W (usft)	Dogleg Rate (°/100usf)	Build Rate (°/100usf)	Turn Rate (°/100usf)	TFO (°)	Target
0.0	0.00	0.00	0.0	-4,686.0	0.0	0.0	0.00	0.00	0.00	0.00	
900.0	0.00	0.00	900.0	-3,786.0	0.0	0.0	0.00	0.00	0.00	0.00	
1,577.2	13.54	69.89	1,571.0	-3,115.0	27.4	74.8	2.00	2.00	0.00	69.89	
5,630.5	13.54	69.89	5,511.4	825.4	353.7	966.3	0.00	0.00	0.00	0.00	
6,307.7	0.00	0.00	6,182.4	1,496.4	381.1	1,041.1	2.00	-2.00	0.00	180.00	
6,337.7	0.00	0.00	6,212.4	1,526.4	381.1	1,041.1	0.00	0.00	0.00	0.00	BTV - HINER 36NC
7,337.7	90.00	270.59	6,849.0	2,163.0	387.7	404.5	9.00	9.00	-8.94	270.59	ICP - HINER 36NC
11,641.3	90.00	270.59	6,849.0	2,163.0	432.0	-3,898.9	0.00	0.00	0.00	-128.89	BHL - HINER 36NC

Planning Report



Database:	EDM 5000.1 Single User Db	Local Co-ordinate Reference:	Well HINER 36NC-18W
Company:	EXTRACTION OIL & GAS	TVD Reference:	KB-EST @ 4686.0usft (H&P 319)
Project:	WELD COUNTY, COLORADO	MD Reference:	KB-EST @ 4686.0usft (H&P 319)
Site:	SEC. 36 T6N R66W 6th P.M.	North Reference:	True
Well:	HINER 36NC-18W	Survey Calculation Method:	Minimum Curvature
Wellbore:	ORIGINAL WELLBORE		
Design:	PROPOSAL #1		

Planned Survey

MD (usft)	Inc (°)	Azi (°)	TVD (usft)	SS (usft)	+N/-S (usft)	+E/-W (usft)	Vertical Section (usft)	Dogleg Rate (°/100usft)	Build Rate (°/100usft)	Turn Rate (°/100usft)
0.0	0.00	0.00	0.0	4,686.00	0.0	0.0	0.0	0.00	0.00	0.00
100.0	0.00	0.00	100.0	4,586.00	0.0	0.0	0.0	0.00	0.00	0.00
200.0	0.00	0.00	200.0	4,486.00	0.0	0.0	0.0	0.00	0.00	0.00
300.0	0.00	0.00	300.0	4,386.00	0.0	0.0	0.0	0.00	0.00	0.00
400.0	0.00	0.00	400.0	4,286.00	0.0	0.0	0.0	0.00	0.00	0.00
500.0	0.00	0.00	500.0	4,186.00	0.0	0.0	0.0	0.00	0.00	0.00
600.0	0.00	0.00	600.0	4,086.00	0.0	0.0	0.0	0.00	0.00	0.00
700.0	0.00	0.00	700.0	3,986.00	0.0	0.0	0.0	0.00	0.00	0.00
800.0	0.00	0.00	800.0	3,886.00	0.0	0.0	0.0	0.00	0.00	0.00
START NUDGE (2°/100ft BUR)										
900.0	0.00	0.00	900.0	3,786.00	0.0	0.0	0.0	0.00	0.00	0.00
1,000.0	2.00	69.89	1,000.0	3,686.02	0.6	1.6	-1.6	2.00	2.00	0.00
1,100.0	4.00	69.89	1,099.8	3,586.16	2.4	6.6	-6.2	2.00	2.00	0.00
1,200.0	6.00	69.89	1,199.5	3,486.55	5.4	14.7	-14.1	2.00	2.00	0.00
1,300.0	8.00	69.89	1,298.7	3,387.30	9.6	26.2	-25.0	2.00	2.00	0.00
1,400.0	10.00	69.89	1,397.5	3,288.53	15.0	40.9	-39.0	2.00	2.00	0.00
1,500.0	12.00	69.89	1,495.6	3,190.38	21.5	58.8	-56.1	2.00	2.00	0.00
EOB TO 13.54° INC										
1,577.2	13.54	69.89	1,571.0	3,115.04	27.4	74.8	-71.4	2.00	2.00	0.00
1,600.0	13.54	69.89	1,593.1	3,092.92	29.2	79.8	-76.1	0.00	0.00	0.00
1,700.0	13.54	69.89	1,690.3	2,995.70	37.3	101.8	-97.1	0.00	0.00	0.00
1,800.0	13.54	69.89	1,787.5	2,898.49	45.3	123.8	-118.1	0.00	0.00	0.00
1,900.0	13.54	69.89	1,884.7	2,801.27	53.4	145.8	-139.0	0.00	0.00	0.00
2,000.0	13.54	69.89	1,982.0	2,704.05	61.4	167.8	-160.0	0.00	0.00	0.00
2,100.0	13.54	69.89	2,079.2	2,606.83	69.5	189.8	-181.0	0.00	0.00	0.00
2,200.0	13.54	69.89	2,176.4	2,509.61	77.5	211.8	-202.0	0.00	0.00	0.00
2,300.0	13.54	69.89	2,273.6	2,412.39	85.6	233.8	-222.9	0.00	0.00	0.00
2,400.0	13.54	69.89	2,370.8	2,315.17	93.6	255.8	-243.9	0.00	0.00	0.00
2,500.0	13.54	69.89	2,468.0	2,217.96	101.7	277.8	-264.9	0.00	0.00	0.00
2,600.0	13.54	69.89	2,565.3	2,120.74	109.7	299.8	-285.9	0.00	0.00	0.00
2,700.0	13.54	69.89	2,662.5	2,023.52	117.8	321.8	-306.8	0.00	0.00	0.00
2,800.0	13.54	69.89	2,759.7	1,926.30	125.8	343.8	-327.8	0.00	0.00	0.00
2,900.0	13.54	69.89	2,856.9	1,829.08	133.9	365.7	-348.8	0.00	0.00	0.00
3,000.0	13.54	69.89	2,954.1	1,731.86	141.9	387.7	-369.7	0.00	0.00	0.00
3,100.0	13.54	69.89	3,051.4	1,634.64	150.0	409.7	-390.7	0.00	0.00	0.00
3,200.0	13.54	69.89	3,148.6	1,537.43	158.0	431.7	-411.7	0.00	0.00	0.00
3,300.0	13.54	69.89	3,245.8	1,440.21	166.1	453.7	-432.7	0.00	0.00	0.00
3,400.0	13.54	69.89	3,343.0	1,342.99	174.1	475.7	-453.6	0.00	0.00	0.00
3,500.0	13.54	69.89	3,440.2	1,245.77	182.2	497.7	-474.6	0.00	0.00	0.00
3,600.0	13.54	69.89	3,537.4	1,148.55	190.2	519.7	-495.6	0.00	0.00	0.00
3,700.0	13.54	69.89	3,634.7	1,051.33	198.3	541.7	-516.6	0.00	0.00	0.00
3,800.0	13.54	69.89	3,731.9	954.11	206.3	563.7	-537.5	0.00	0.00	0.00
3,900.0	13.54	69.89	3,829.1	856.89	214.4	585.7	-558.5	0.00	0.00	0.00
4,000.0	13.54	69.89	3,926.3	759.68	222.4	607.7	-579.5	0.00	0.00	0.00
4,100.0	13.54	69.89	4,023.5	662.46	230.5	629.7	-600.5	0.00	0.00	0.00
4,200.0	13.54	69.89	4,120.8	565.24	238.5	651.7	-621.4	0.00	0.00	0.00
4,300.0	13.54	69.89	4,218.0	468.02	246.6	673.7	-642.4	0.00	0.00	0.00
4,400.0	13.54	69.89	4,315.2	370.80	254.6	695.7	-663.4	0.00	0.00	0.00
SUSSEX										
4,492.4	13.54	69.89	4,405.0	281.00	262.1	716.0	-682.7	0.00	0.00	0.00
4,500.0	13.54	69.89	4,412.4	273.58	262.7	717.6	-684.3	0.00	0.00	0.00
4,600.0	13.54	69.89	4,509.6	176.36	270.7	739.6	-705.3	0.00	0.00	0.00
4,700.0	13.54	69.89	4,606.9	79.15	278.8	761.6	-726.3	0.00	0.00	0.00

Planning Report



Database:	EDM 5000.1 Single User Db	Local Co-ordinate Reference:	Well HINER 36NC-18W
Company:	EXTRACTION OIL & GAS	TVD Reference:	KB-EST @ 4686.0usft (H&P 319)
Project:	WELD COUNTY, COLORADO	MD Reference:	KB-EST @ 4686.0usft (H&P 319)
Site:	SEC. 36 T6N R66W 6th P.M.	North Reference:	True
Well:	HINER 36NC-18W	Survey Calculation Method:	Minimum Curvature
Wellbore:	ORIGINAL WELLBORE		
Design:	PROPOSAL #1		

Planned Survey

MD (usft)	Inc (°)	Azi (°)	TVD (usft)	SS (usft)	+N/-S (usft)	+E/-W (usft)	Vertical Section (usft)	Dogleg Rate (°/100usft)	Build Rate (°/100usft)	Turn Rate (°/100usft)
4,800.0	13.54	69.89	4,704.1	-18.07	286.9	783.6	-747.3	0.00	0.00	0.00
4,900.0	13.54	69.89	4,801.3	-115.29	294.9	805.6	-768.2	0.00	0.00	0.00
SHANNON										
4,928.5	13.54	69.89	4,829.0	-143.00	297.2	811.9	-774.2	0.00	0.00	0.00
5,000.0	13.54	69.89	4,898.5	-212.51	303.0	827.6	-789.2	0.00	0.00	0.00
5,100.0	13.54	69.89	4,995.7	-309.73	311.0	849.6	-810.2	0.00	0.00	0.00
5,200.0	13.54	69.89	5,092.9	-406.95	319.1	871.6	-831.2	0.00	0.00	0.00
5,300.0	13.54	69.89	5,190.2	-504.17	327.1	893.6	-852.1	0.00	0.00	0.00
5,400.0	13.54	69.89	5,287.4	-601.38	335.2	915.6	-873.1	0.00	0.00	0.00
5,500.0	13.54	69.89	5,384.6	-698.60	343.2	937.6	-894.1	0.00	0.00	0.00
5,600.0	13.54	69.89	5,481.8	-795.82	351.3	959.6	-915.1	0.00	0.00	0.00
END OF TANGENT										
5,630.5	13.54	69.89	5,511.4	-825.44	353.7	966.3	-921.4	0.00	0.00	0.00
5,700.0	12.15	69.89	5,579.2	-893.23	359.0	980.8	-935.3	2.00	-2.00	0.00
5,800.0	10.15	69.89	5,677.3	-991.34	365.7	999.0	-952.6	2.00	-2.00	0.00
5,900.0	8.15	69.89	5,776.1	-1,090.06	371.1	1,013.9	-966.9	2.00	-2.00	0.00
6,000.0	6.15	69.89	5,875.3	-1,189.28	375.4	1,025.6	-978.0	2.00	-2.00	0.00
6,100.0	4.15	69.89	5,974.9	-1,288.87	378.5	1,034.0	-986.1	2.00	-2.00	0.00
6,200.0	2.15	69.89	6,074.7	-1,388.71	380.4	1,039.2	-991.0	2.00	-2.00	0.00
6,300.0	0.15	69.89	6,174.7	-1,488.68	381.1	1,041.1	-992.8	2.00	-2.00	0.00
EOD TO VERTICAL										
6,307.7	0.00	0.00	6,182.4	-1,496.40	381.1	1,041.1	-992.8	2.00	-2.00	0.00
KOP (9°/100ft BUR)										
6,337.7	0.00	0.00	6,212.4	-1,526.40	381.1	1,041.1	-992.8	0.00	0.00	0.00
6,400.0	5.61	270.59	6,274.6	-1,588.58	381.1	1,038.1	-989.8	9.00	9.00	0.00
6,500.0	14.61	270.59	6,372.9	-1,686.93	381.3	1,020.5	-972.3	9.00	9.00	0.00
6,600.0	23.61	270.59	6,467.3	-1,781.33	381.7	987.8	-939.8	9.00	9.00	0.00
6,700.0	32.61	270.59	6,555.4	-1,869.44	382.1	940.8	-893.0	9.00	9.00	0.00
6,800.0	41.61	270.59	6,635.1	-1,949.11	382.8	880.5	-833.0	9.00	9.00	0.00
6,900.0	50.61	270.59	6,704.4	-2,018.37	383.5	808.5	-761.4	9.00	9.00	0.00
7,000.0	59.61	270.59	6,761.5	-2,075.52	384.4	726.6	-679.8	9.00	9.00	0.00
7,100.0	68.61	270.59	6,805.1	-2,119.14	385.3	636.7	-590.4	9.00	9.00	0.00
7,200.0	77.61	270.59	6,834.2	-2,148.17	386.3	541.1	-495.3	9.00	9.00	0.00
7,300.0	86.61	270.59	6,847.9	-2,161.88	387.3	442.2	-396.8	9.00	9.00	0.00
ICP - HINER 36NC-18W *NEW* - NIOBRARA										
7,337.7	90.00	270.59	6,849.0	-2,163.00	387.7	404.5	-359.3	9.00	9.00	0.00
7,400.0	90.00	270.59	6,849.0	-2,163.00	388.3	342.2	-297.4	0.00	0.00	0.00
7,500.0	90.00	270.59	6,849.0	-2,162.99	389.4	242.2	-197.9	0.00	0.00	0.00
7,600.0	90.00	270.59	6,849.0	-2,162.99	390.4	142.2	-98.4	0.00	0.00	0.00
7,700.0	90.00	270.59	6,849.0	-2,162.98	391.5	42.2	1.1	0.00	0.00	0.00
7,800.0	90.00	270.59	6,849.0	-2,162.98	392.5	-57.8	100.6	0.00	0.00	0.00
7,900.0	90.00	270.59	6,849.0	-2,162.97	393.5	-157.8	200.1	0.00	0.00	0.00
8,000.0	90.00	270.59	6,849.0	-2,162.97	394.6	-257.7	299.6	0.00	0.00	0.00
8,100.0	90.00	270.59	6,849.0	-2,162.97	395.6	-357.7	399.1	0.00	0.00	0.00
8,200.0	90.00	270.59	6,849.0	-2,162.96	396.6	-457.7	498.6	0.00	0.00	0.00
8,300.0	90.00	270.59	6,849.0	-2,162.96	397.7	-557.7	598.1	0.00	0.00	0.00
8,400.0	90.00	270.59	6,849.0	-2,162.96	398.7	-657.7	697.6	0.00	0.00	0.00
8,500.0	90.00	270.59	6,849.0	-2,162.95	399.7	-757.7	797.1	0.00	0.00	0.00
8,600.0	90.00	270.59	6,849.0	-2,162.95	400.8	-857.7	896.6	0.00	0.00	0.00
8,700.0	90.00	270.59	6,848.9	-2,162.95	401.8	-957.7	996.1	0.00	0.00	0.00
8,800.0	90.00	270.59	6,848.9	-2,162.95	402.8	-1,057.7	1,095.6	0.00	0.00	0.00
8,900.0	90.00	270.59	6,848.9	-2,162.95	403.9	-1,157.7	1,195.1	0.00	0.00	0.00
9,000.0	90.00	270.59	6,848.9	-2,162.95	404.9	-1,257.7	1,294.6	0.00	0.00	0.00
9,100.0	90.00	270.59	6,848.9	-2,162.94	405.9	-1,357.7	1,394.1	0.00	0.00	0.00



Database:	EDM 5000.1 Single User Db	Local Co-ordinate Reference:	Well HINER 36NC-18W
Company:	EXTRACTION OIL & GAS	TVD Reference:	KB-EST @ 4686.0usft (H&P 319)
Project:	WELD COUNTY, COLORADO	MD Reference:	KB-EST @ 4686.0usft (H&P 319)
Site:	SEC. 36 T6N R66W 6th P.M.	North Reference:	True
Well:	HINER 36NC-18W	Survey Calculation Method:	Minimum Curvature
Wellbore:	ORIGINAL WELLBORE		
Design:	PROPOSAL #1		

Planned Survey

MD (usft)	Inc (°)	Azi (°)	TVD (usft)	SS (usft)	+N/-S (usft)	+E/-W (usft)	Vertical Section (usft)	Dogleg Rate (°/100usft)	Build Rate (°/100usft)	Turn Rate (°/100usft)
9,200.0	90.00	270.59	6,848.9	-2,162.94	407.0	-1,457.7	1,493.6	0.00	0.00	0.00
9,300.0	90.00	270.59	6,848.9	-2,162.94	408.0	-1,557.7	1,593.1	0.00	0.00	0.00
9,400.0	90.00	270.59	6,848.9	-2,162.94	409.0	-1,657.7	1,692.6	0.00	0.00	0.00
9,500.0	90.00	270.59	6,848.9	-2,162.94	410.0	-1,757.7	1,792.1	0.00	0.00	0.00
9,600.0	90.00	270.59	6,848.9	-2,162.94	411.1	-1,857.7	1,891.6	0.00	0.00	0.00
9,700.0	90.00	270.59	6,848.9	-2,162.94	412.1	-1,957.7	1,991.1	0.00	0.00	0.00
9,800.0	90.00	270.59	6,848.9	-2,162.94	413.1	-2,057.6	2,090.6	0.00	0.00	0.00
9,900.0	90.00	270.59	6,848.9	-2,162.94	414.2	-2,157.6	2,190.1	0.00	0.00	0.00
10,000.0	90.00	270.59	6,848.9	-2,162.95	415.2	-2,257.6	2,289.6	0.00	0.00	0.00
10,100.0	90.00	270.59	6,848.9	-2,162.95	416.2	-2,357.6	2,389.1	0.00	0.00	0.00
10,200.0	90.00	270.59	6,848.9	-2,162.95	417.2	-2,457.6	2,488.6	0.00	0.00	0.00
10,300.0	90.00	270.59	6,849.0	-2,162.95	418.3	-2,557.6	2,588.1	0.00	0.00	0.00
10,400.0	90.00	270.59	6,849.0	-2,162.95	419.3	-2,657.6	2,687.6	0.00	0.00	0.00
10,500.0	90.00	270.59	6,849.0	-2,162.95	420.3	-2,757.6	2,787.1	0.00	0.00	0.00
10,600.0	90.00	270.59	6,849.0	-2,162.96	421.4	-2,857.6	2,886.6	0.00	0.00	0.00
10,700.0	90.00	270.59	6,849.0	-2,162.96	422.4	-2,957.6	2,986.1	0.00	0.00	0.00
10,800.0	90.00	270.59	6,849.0	-2,162.96	423.4	-3,057.6	3,085.6	0.00	0.00	0.00
10,900.0	90.00	270.59	6,849.0	-2,162.97	424.4	-3,157.6	3,185.1	0.00	0.00	0.00
11,000.0	90.00	270.59	6,849.0	-2,162.97	425.5	-3,257.6	3,284.6	0.00	0.00	0.00
11,100.0	90.00	270.59	6,849.0	-2,162.97	426.5	-3,357.6	3,384.1	0.00	0.00	0.00
11,200.0	90.00	270.59	6,849.0	-2,162.98	427.5	-3,457.6	3,483.6	0.00	0.00	0.00
11,300.0	90.00	270.59	6,849.0	-2,162.98	428.5	-3,557.6	3,583.1	0.00	0.00	0.00
11,400.0	90.00	270.59	6,849.0	-2,162.99	429.6	-3,657.6	3,682.6	0.00	0.00	0.00
11,500.0	90.00	270.59	6,849.0	-2,162.99	430.6	-3,757.6	3,782.1	0.00	0.00	0.00
11,600.0	90.00	270.59	6,849.0	-2,163.00	431.6	-3,857.6	3,881.6	0.00	0.00	0.00
BHL - HINER 36NC-18W										
11,641.3	90.00	270.59	6,849.0	-2,163.00	432.0	-3,898.9	3,922.7	0.00	0.00	0.00

Formations

MD (usft)	TVD (usft)	Name	Lithology	Dip (°)	Dip Direction (°)
4,492.4	4,405.0	SUSSEX		0.00	
4,928.5	4,829.0	SHANNON		0.00	
7,337.7	6,849.0	NIOBRARA		0.00	

Plan Annotations

MD (usft)	TVD (usft)	Local Coordinates		Comment
		+N/-S (usft)	+E/-W (usft)	
900.0	900.0	0.0	0.0	START NUDGE (2°/100ft BUR)
1,577.2	1,571.0	27.4	74.8	EOB TO 13.54° INC
5,630.5	5,511.4	353.7	966.3	END OF TANGENT
6,307.7	6,182.4	381.1	1,041.1	EOD TO VERTICAL
6,337.7	6,212.4	381.1	1,041.1	KOP (9°/100ft BUR)
7,337.7	6,849.0	387.7	404.5	ICP - HINER 36NC-18W *NEW*
11,641.3	6,849.0	432.0	-3,898.9	BHL - HINER 36NC-18W