

Caerus Oil & Gas LLC
TYPICAL RIG LAYOUT FOR
ISLAND RANCH #13-796
SECTION 13, T7S, R96W, 6th P.M.
LOT 10 & LOT 11

FIGURE #3A

SCALE: 1" = 50'
DATE: 03-04-14
DRAWN BY: M.D.

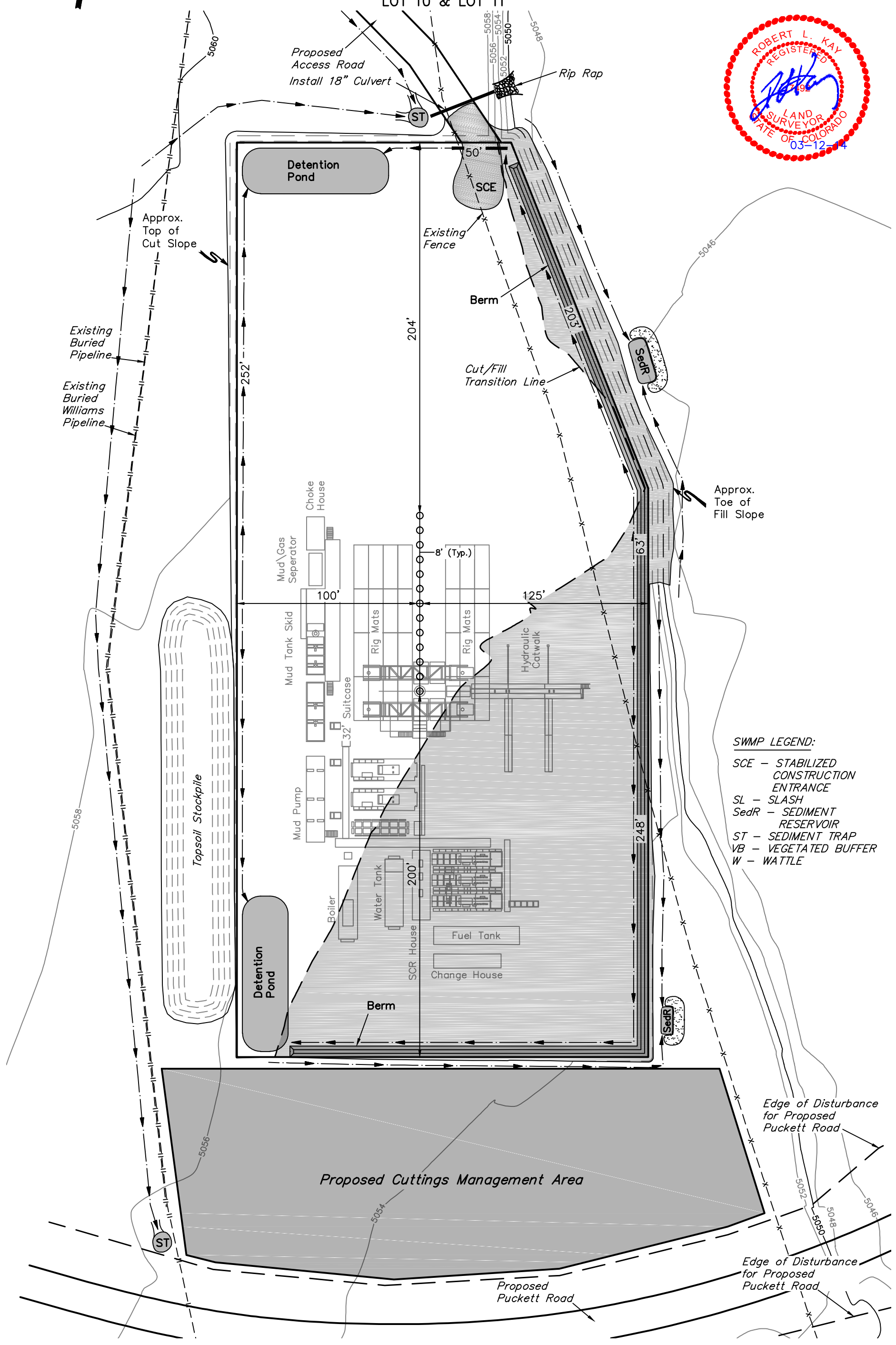

- SWMP LEGEND:**
- SCE - STABILIZED CONSTRUCTION ENTRANCE
 - SL - SLASH
 - SedR - SEDIMENT RESERVOIR
 - ST - SEDIMENT TRAP
 - VB - VEGETATED BUFFER
 - W - WATTLE