

**Caerus Oil & Gas LLC**  
**CONSTRUCTION LAYOUT FOR**  
**ISLAND RANCH #13-796**  
**SECTION 13, T7S, R96W, 6th P.M.**  
**LOT 10 & LOT 11**

**FIGURE #1**

SCALE: 1" = 50'  
 DATE: 02-21-14  
 DRAWN BY: A.R.  
 REVISED: 03-04-14 M.D.

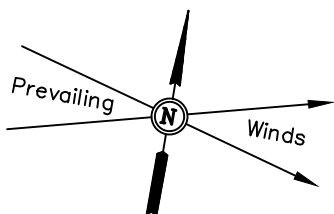

1.14 Ac. to Deten. Pond #1  
 4,000 cu.ft./Ac. Pad  
 Vol. = 4,560 cu.ft.  
 L= 76', W=25', D=6'



RUN-ON DIVERSION

C-4.2'  
 El. 59.7'

C-2.7'  
 El. 58.2'

F-4.5'  
 El. 51.0'

Sta. 5+00

Detention Pond

Install 18" Culvert

Cut Slope Diversion

Approx. Top of Cut Slope

Existing Buried Pipeline

Existing Buried Williams Pipeline

Berm

Cut/Fill Transition Line

-3.0% Slope

-3.0% Slope

C-1.3'  
 El. 56.8'

#23A-13  
 #23B-13  
 #23C-13  
 #23D-13  
 #24A-13  
 #24B-13  
 8' (Typ.)

C-2.1'  
 El. 57.6'

100'

125'

C-0.7'  
 El. 56.2'

#24C-13  
 #24D-13  
 #11D-24  
 #21A-24  
 #21B-24  
 #21C-24  
 #21D-24

C-0.3'  
 El. 55.8'

Cut Slope Diversion

-3.0% Slope

-3.0% Slope

Topsoil Stockpile

Detention Pond

Berm

3.08 Ac. to Deten. Pond #2  
 4,000 cu.ft./Ac. Pad  
 Vol. = 5,120 cu.ft.  
 L= 85', W=25', D=6'

0.08 Ac. to Sed. Res. #1  
 3,600 cu.ft./Ac. Drainage  
 Vol. = 288 cu.ft.  
 L= 24', W=10', D=3'

Approx. Toe of Fill Slope

Sta. 2+96

Sta. 2+48

Sta. 2+00

SWMP LEGEND:

SCE - STABILIZED CONSTRUCTION ENTRANCE  
 SL - SLASH  
 SedR - SEDIMENT RESERVOIR  
 ST - SEDIMENT TRAP  
 VB - VEGETATED BUFFER  
 W - WATTLE

0.02 Ac. to Sed. Res. #2  
 3,600 cu.ft./Ac. Drainage  
 Vol. = 72 cu.ft.  
 L= 15', W=6', D=2'

RUN-ON DIVERSION

C-0.3'  
 El. 55.8'

F-1.0'  
 El. 54.5'

F-1.9'  
 El. 53.6'

Sta. 0+00

Edge of Disturbance for Proposed Puckett Road

Proposed Cuttings Management Area

Proposed Puckett Road

Edge of Disturbance for Proposed Puckett Road

Elev. Ungraded Ground At #24C-13 Loc. Stake = 5056.2'  
 FINISHED GRADE ELEV. AT #24C-13 LOC. STAKE = 5055.5'

UINTAH ENGINEERING & LAND SURVEYING  
 85 So. 200 East \* Vernal, Utah 84078 \* (435) 789-1017

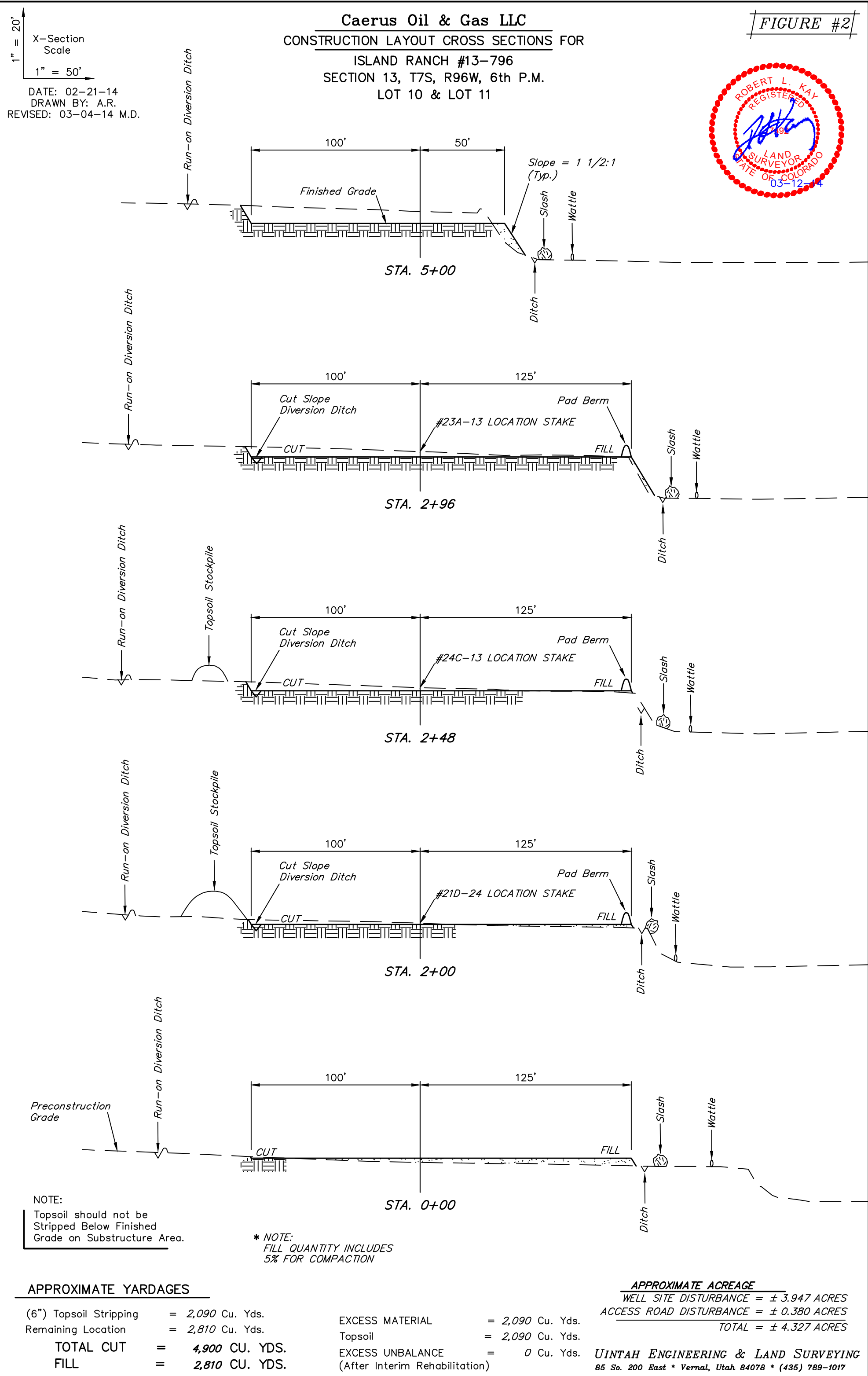

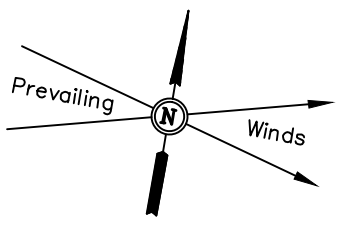

Caerus Oil & Gas LLC  
CONSTRUCTION LAYOUT FOR  
ISLAND RANCH #13-796  
SECTION 13, T7S, R96W, 6th P.M.  
LOT 10 & LOT 11

FIGURE #3B

SCALE: 1" = 50'  
DATE: 03-04-14  
DRAWN BY: M.D.

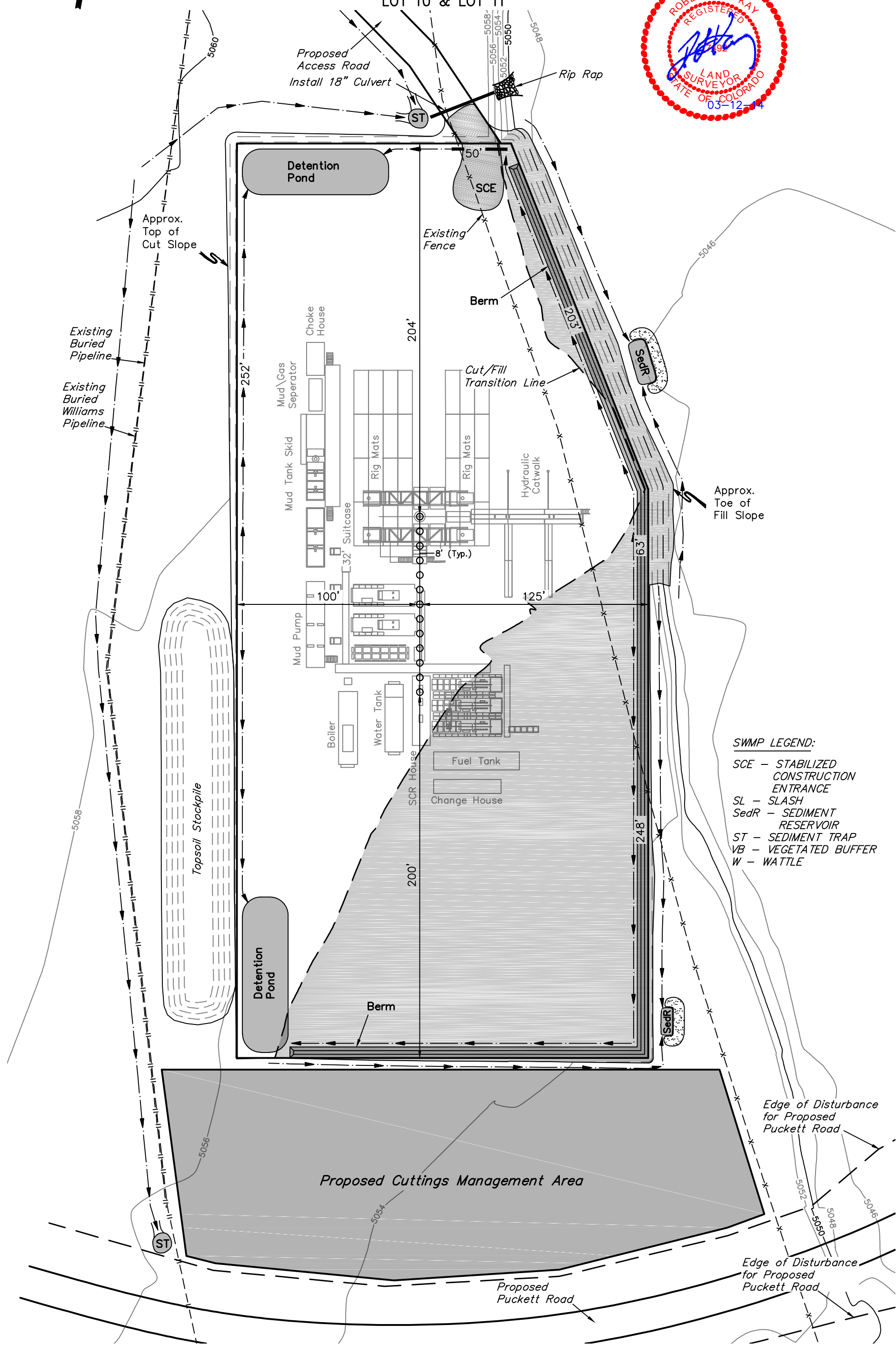

- SWMP LEGEND:
- SCE - STABILIZED CONSTRUCTION ENTRANCE
  - SL - SLASH
  - SedR - SEDIMENT RESERVOIR
  - ST - SEDIMENT TRAP
  - VB - VEGETATED BUFFER
  - W - WATTLE