

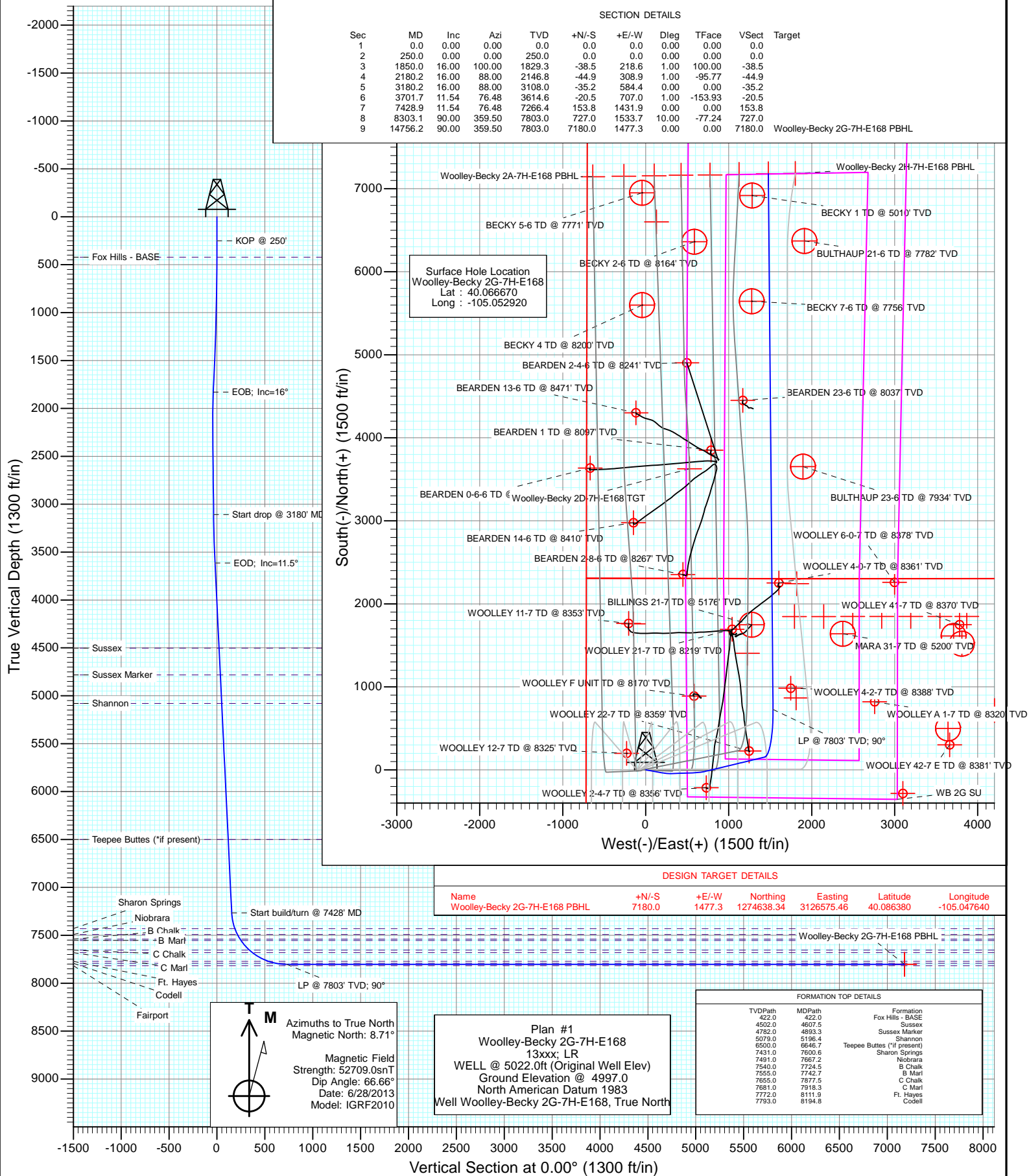

Project: DJ Wattenberg
Site: S7-T1N-R68W (Woolley-Sosa/Becky)
Well: Woolley-Becky 2G-7H-E168
Wellbore: Hz
Design: Plan #1



Cathedral Energy Services

Planning Report

Database:	USA EDM 5000 Multi Users DB	Local Co-ordinate Reference:	Well Woolley-Becky 2G-7H-E168
Company:	EnCana Oil & Gas (USA) Inc	TVD Reference:	WELL @ 5022.0ft (Original Well Elev)
Project:	DJ Wattenberg	MD Reference:	WELL @ 5022.0ft (Original Well Elev)
Site:	S7-T1N-R68W (Woolley-Sosa/Becky)	North Reference:	True
Well:	Woolley-Becky 2G-7H-E168	Survey Calculation Method:	Minimum Curvature
Wellbore:	Hz		
Design:	Plan #1		

Project	DJ Wattenberg		
Map System:	US State Plane 1983	System Datum:	Mean Sea Level
Geo Datum:	North American Datum 1983		
Map Zone:	Colorado Northern Zone		

Site		S7-T1N-R68W (Woolley-Sosa/Becky)			
Site Position:		Northing:	1,265,219.42 ft	Latitude:	40.060530
From:	Lat/Long	Easting:	3,126,139.27 ft	Longitude:	-105.049370
Position Uncertainty:	0.0 ft	Slot Radius:	13.200 in	Grid Convergence:	0.29 °

Well	Woolley-Becky 2G-7H-E168					
Well Position	+N/-S	0.0 ft	Northing:	1,267,451.02 ft	Latitude:	40.066670
	+E/-W	0.0 ft	Easting:	3,125,134.34 ft	Longitude:	-105.052920
Position Uncertainty		0.0 ft	Wellhead Elevation:	ft	Ground Level:	4,997.0 ft

Wellbore	Hz				
Magnetics	Model Name	Sample Date	Declination (°)	Dip Angle (°)	Field Strength (nT)
	IGRF2010	6/28/2013	8.71	66.66	52,709

Design	Plan #1			
Audit Notes:				
Version:	Phase:	PLAN	Tie On Depth:	0.0
Vertical Section:	Depth From (TVD) (ft)	+N/-S (ft)	+E/-W (ft)	Direction (°)
	0.0	0.0	0.0	0.00

Plan Sections										
Measured Depth (ft)	Inclination (°)	Azimuth (°)	Vertical Depth (ft)	+N/-S (ft)	+E/-W (ft)	Dogleg Rate (°/100ft)	Build Rate (°/100ft)	Turn Rate (°/100ft)	TFO (°)	Target
0.0	0.00	0.00	0.0	0.0	0.0	0.00	0.00	0.00	0.00	
250.0	0.00	0.00	250.0	0.0	0.0	0.00	0.00	0.00	0.00	
1,850.0	16.00	100.00	1,829.3	-38.5	218.6	1.00	1.00	0.00	100.00	
2,180.2	16.00	88.00	2,146.8	-44.9	308.9	1.00	0.00	-3.63	-95.77	
3,180.2	16.00	88.00	3,108.0	-35.2	584.4	0.00	0.00	0.00	0.00	
3,701.7	11.54	76.48	3,614.6	-20.5	707.0	1.00	-0.86	-2.21	-153.93	
7,428.9	11.54	76.48	7,266.4	153.8	1,431.9	0.00	0.00	0.00	0.00	
8,303.1	90.00	359.50	7,803.0	727.0	1,533.7	10.00	8.98	-8.81	-77.24	
14,756.2	90.00	359.50	7,803.0	7,180.0	1,477.3	0.00	0.00	0.00	0.00	Woolley-Becky 2G-7H

Cathedral Energy Services

Planning Report

Database:	USA EDM 5000 Multi Users DB	Local Co-ordinate Reference:	Well Woolley-Becky 2G-7H-E168
Company:	EnCana Oil & Gas (USA) Inc	TVD Reference:	WELL @ 5022.0ft (Original Well Elev)
Project:	DJ Wattenberg	MD Reference:	WELL @ 5022.0ft (Original Well Elev)
Site:	S7-T1N-R68W (Woolley-Sosa/Becky)	North Reference:	True
Well:	Woolley-Becky 2G-7H-E168	Survey Calculation Method:	Minimum Curvature
Wellbore:	Hz		
Design:	Plan #1		

Planned Survey									
Measured Depth (ft)	Inclination (°)	Azimuth (°)	Vertical Depth (ft)	+N/-S (ft)	+E/-W (ft)	Vertical Section (ft)	Dogleg Rate (°/100ft)	Build Rate (°/100ft)	Comments / Formations
0.0	0.00	0.00	0.0	0.0	0.0	0.0	0.00	0.00	
100.0	0.00	0.00	100.0	0.0	0.0	0.0	0.00	0.00	
200.0	0.00	0.00	200.0	0.0	0.0	0.0	0.00	0.00	
250.0	0.00	0.00	250.0	0.0	0.0	0.0	0.00	0.00	KOP @ 250'
300.0	0.50	100.00	300.0	0.0	0.2	0.0	1.00	1.00	
400.0	1.50	100.00	400.0	-0.3	1.9	-0.3	1.00	1.00	
422.0	1.72	100.00	422.0	-0.4	2.5	-0.4	1.00	1.00	Fox Hills - BASE
500.0	2.50	100.00	499.9	-0.9	5.4	-0.9	1.00	1.00	
600.0	3.50	100.00	599.8	-1.9	10.5	-1.9	1.00	1.00	
700.0	4.50	100.00	699.5	-3.1	17.4	-3.1	1.00	1.00	
800.0	5.50	100.00	799.2	-4.6	26.0	-4.6	1.00	1.00	
900.0	6.50	100.00	898.6	-6.4	36.3	-6.4	1.00	1.00	
1,000.0	7.50	100.00	997.9	-8.5	48.3	-8.5	1.00	1.00	
1,100.0	8.50	100.00	1,096.9	-10.9	62.0	-10.9	1.00	1.00	
1,200.0	9.50	100.00	1,195.7	-13.6	77.4	-13.6	1.00	1.00	
1,300.0	10.50	100.00	1,294.1	-16.7	94.5	-16.7	1.00	1.00	
1,400.0	11.50	100.00	1,392.3	-20.0	113.3	-20.0	1.00	1.00	
1,500.0	12.50	100.00	1,490.1	-23.6	133.8	-23.6	1.00	1.00	
1,600.0	13.50	100.00	1,587.5	-27.5	155.9	-27.5	1.00	1.00	
1,700.0	14.50	100.00	1,684.6	-31.7	179.7	-31.7	1.00	1.00	
1,800.0	15.50	100.00	1,781.2	-36.2	205.2	-36.2	1.00	1.00	
1,850.0	16.00	100.00	1,829.3	-38.5	218.6	-38.5	1.00	1.00	EOB; Inc=16°
1,900.0	15.96	98.19	1,877.4	-40.7	232.2	-40.7	1.00	-0.09	
2,000.0	15.92	94.55	1,973.5	-43.8	259.4	-43.8	1.00	-0.04	
2,100.0	15.94	90.91	2,069.7	-45.1	286.8	-45.1	1.00	0.02	
2,180.2	16.00	88.00	2,146.8	-44.9	308.9	-44.9	1.00	0.08	
2,200.0	16.00	88.00	2,165.8	-44.7	314.4	-44.7	0.00	0.00	
2,300.0	16.00	88.00	2,261.9	-43.7	341.9	-43.7	0.00	0.00	
2,400.0	16.00	88.00	2,358.1	-42.7	369.5	-42.7	0.00	0.00	
2,500.0	16.00	88.00	2,454.2	-41.8	397.0	-41.8	0.00	0.00	
2,600.0	16.00	88.00	2,550.3	-40.8	424.5	-40.8	0.00	0.00	
2,700.0	16.00	88.00	2,646.4	-39.9	452.1	-39.9	0.00	0.00	
2,800.0	16.00	88.00	2,742.6	-38.9	479.6	-38.9	0.00	0.00	
2,900.0	16.00	88.00	2,838.7	-37.9	507.2	-37.9	0.00	0.00	
3,000.0	16.00	88.00	2,934.8	-37.0	534.7	-37.0	0.00	0.00	
3,100.0	16.00	88.00	3,031.0	-36.0	562.3	-36.0	0.00	0.00	
3,180.2	16.00	88.00	3,108.0	-35.2	584.4	-35.2	0.00	0.00	Start drop @ 3180' MD
3,200.0	15.82	87.68	3,127.1	-35.0	589.8	-35.0	1.00	-0.90	
3,300.0	14.93	85.96	3,223.5	-33.6	616.3	-33.6	1.00	-0.89	
3,400.0	14.06	84.02	3,320.3	-31.4	641.2	-31.4	1.00	-0.87	
3,500.0	13.20	81.84	3,417.5	-28.5	664.6	-28.5	1.00	-0.86	
3,600.0	12.36	79.36	3,515.0	-24.9	686.4	-24.9	1.00	-0.84	
3,700.0	11.55	76.53	3,612.9	-20.6	706.7	-20.6	1.00	-0.81	
3,701.7	11.54	76.48	3,614.5	-20.5	707.0	-20.5	1.00	-0.80	EOD; Inc=11.5°
3,800.0	11.54	76.48	3,710.8	-15.9	726.1	-15.9	0.00	0.00	
3,900.0	11.54	76.48	3,808.8	-11.3	745.6	-11.3	0.00	0.00	
4,000.0	11.54	76.48	3,906.8	-6.6	765.0	-6.6	0.00	0.00	
4,100.0	11.54	76.48	4,004.8	-1.9	784.5	-1.9	0.00	0.00	
4,200.0	11.54	76.48	4,102.8	2.8	803.9	2.8	0.00	0.00	
4,300.0	11.54	76.48	4,200.7	7.4	823.4	7.4	0.00	0.00	
4,400.0	11.54	76.48	4,298.7	12.1	842.8	12.1	0.00	0.00	
4,500.0	11.54	76.48	4,396.7	16.8	862.3	16.8	0.00	0.00	

Cathedral Energy Services

Planning Report

Database:	USA EDM 5000 Multi Users DB	Local Co-ordinate Reference:	Well Woolley-Becky 2G-7H-E168
Company:	EnCana Oil & Gas (USA) Inc	TVD Reference:	WELL @ 5022.0ft (Original Well Elev)
Project:	DJ Wattenberg	MD Reference:	WELL @ 5022.0ft (Original Well Elev)
Site:	S7-T1N-R68W (Woolley-Sosa/Becky)	North Reference:	True
Well:	Woolley-Becky 2G-7H-E168	Survey Calculation Method:	Minimum Curvature
Wellbore:	Hz		
Design:	Plan #1		

Planned Survey									
Measured Depth (ft)	Inclination (°)	Azimuth (°)	Vertical Depth (ft)	+N/-S (ft)	+E/-W (ft)	Vertical Section (ft)	Dogleg Rate (°/100ft)	Build Rate (°/100ft)	Comments / Formations
4,600.0	11.54	76.48	4,494.7	21.5	881.7	21.5	0.00	0.00	
4,607.5	11.54	76.48	4,502.0	21.8	883.2	21.8	0.00	0.00	Sussex
4,700.0	11.54	76.48	4,592.6	26.2	901.2	26.2	0.00	0.00	
4,800.0	11.54	76.48	4,690.6	30.8	920.6	30.8	0.00	0.00	
4,893.3	11.54	76.48	4,782.0	35.2	938.8	35.2	0.00	0.00	Sussex Marker
4,900.0	11.54	76.48	4,788.6	35.5	940.1	35.5	0.00	0.00	
5,000.0	11.54	76.48	4,886.6	40.2	959.5	40.2	0.00	0.00	
5,100.0	11.54	76.48	4,984.6	44.9	979.0	44.9	0.00	0.00	
5,196.4	11.54	76.48	5,079.0	49.4	997.7	49.4	0.00	0.00	Shannon
5,200.0	11.54	76.48	5,082.5	49.5	998.4	49.5	0.00	0.00	
5,300.0	11.54	76.48	5,180.5	54.2	1,017.9	54.2	0.00	0.00	
5,400.0	11.54	76.48	5,278.5	58.9	1,037.3	58.9	0.00	0.00	
5,500.0	11.54	76.48	5,376.5	63.6	1,056.8	63.6	0.00	0.00	
5,600.0	11.54	76.48	5,474.5	68.2	1,076.2	68.2	0.00	0.00	
5,700.0	11.54	76.48	5,572.4	72.9	1,095.7	72.9	0.00	0.00	
5,800.0	11.54	76.48	5,670.4	77.6	1,115.1	77.6	0.00	0.00	
5,900.0	11.54	76.48	5,768.4	82.3	1,134.6	82.3	0.00	0.00	
6,000.0	11.54	76.48	5,866.4	86.9	1,154.0	86.9	0.00	0.00	
6,100.0	11.54	76.48	5,964.3	91.6	1,173.5	91.6	0.00	0.00	
6,200.0	11.54	76.48	6,062.3	96.3	1,192.9	96.3	0.00	0.00	
6,300.0	11.54	76.48	6,160.3	101.0	1,212.4	101.0	0.00	0.00	
6,400.0	11.54	76.48	6,258.3	105.6	1,231.8	105.6	0.00	0.00	
6,500.0	11.54	76.48	6,356.3	110.3	1,251.3	110.3	0.00	0.00	
6,600.0	11.54	76.48	6,454.2	115.0	1,270.7	115.0	0.00	0.00	
6,646.7	11.54	76.48	6,500.0	117.2	1,279.8	117.2	0.00	0.00	Teepee Buttes (*if present)
6,700.0	11.54	76.48	6,552.2	119.7	1,290.1	119.7	0.00	0.00	
6,800.0	11.54	76.48	6,650.2	124.4	1,309.6	124.4	0.00	0.00	
6,900.0	11.54	76.48	6,748.2	129.0	1,329.0	129.0	0.00	0.00	
7,000.0	11.54	76.48	6,846.2	133.7	1,348.5	133.7	0.00	0.00	
7,100.0	11.54	76.48	6,944.1	138.4	1,367.9	138.4	0.00	0.00	
7,200.0	11.54	76.48	7,042.1	143.1	1,387.4	143.1	0.00	0.00	
7,300.0	11.54	76.48	7,140.1	147.7	1,406.8	147.7	0.00	0.00	
7,400.0	11.54	76.48	7,238.1	152.4	1,426.3	152.4	0.00	0.00	
7,428.9	11.54	76.48	7,266.4	153.8	1,431.9	153.8	0.00	0.00	Start build/turn @ 7428' MD
7,500.0	14.81	48.29	7,335.7	161.5	1,445.6	161.5	10.00	4.60	
7,600.0	22.57	28.09	7,430.4	187.0	1,464.3	187.0	10.00	7.76	
7,600.6	22.62	28.01	7,431.0	187.2	1,464.4	187.2	10.00	8.62	Sharon Springs
7,667.2	28.55	20.95	7,491.0	213.4	1,476.1	213.4	10.00	8.90	Niobrara
7,700.0	31.57	18.39	7,519.4	228.9	1,481.6	228.9	10.00	9.21	
7,724.5	33.85	16.75	7,540.0	241.5	1,485.6	241.5	10.00	9.32	B Chalk
7,742.7	35.57	15.65	7,555.0	251.4	1,488.5	251.4	10.00	9.39	B Marl
7,800.0	41.00	12.73	7,600.0	285.8	1,497.1	285.8	10.00	9.49	
7,877.5	48.45	9.65	7,655.0	339.3	1,507.6	339.3	10.00	9.61	C Chalk
7,900.0	50.62	8.90	7,669.6	356.2	1,510.4	356.2	10.00	9.67	
7,918.3	52.40	8.31	7,681.0	370.4	1,512.5	370.4	10.00	9.68	C Marl
8,000.0	60.34	6.01	7,726.2	437.8	1,520.9	437.8	10.00	9.72	
8,100.0	70.10	3.63	7,768.1	528.2	1,528.4	528.2	10.00	9.77	
8,111.9	71.26	3.37	7,772.0	539.3	1,529.1	539.3	10.00	9.78	Ft. Hayes
8,194.8	79.39	1.64	7,793.0	619.4	1,532.6	619.4	10.00	9.79	Codell
8,200.0	79.89	1.53	7,793.9	624.5	1,532.7	624.5	10.00	9.80	
8,300.0	89.70	359.56	7,803.0	724.0	1,533.7	724.0	10.00	9.81	
8,303.1	90.00	359.50	7,803.0	727.1	1,533.7	727.1	9.86	9.67	LP @ 7803' TVD; 90°

Cathedral Energy Services

Planning Report

Database:	USA EDM 5000 Multi Users DB	Local Co-ordinate Reference:	Well Woolley-Becky 2G-7H-E168
Company:	EnCana Oil & Gas (USA) Inc	TVD Reference:	WELL @ 5022.0ft (Original Well Elev)
Project:	DJ Wattenberg	MD Reference:	WELL @ 5022.0ft (Original Well Elev)
Site:	S7-T1N-R68W (Woolley-Sosa/Becky)	North Reference:	True
Well:	Woolley-Becky 2G-7H-E168	Survey Calculation Method:	Minimum Curvature
Wellbore:	Hz		
Design:	Plan #1		

Planned Survey

Measured Depth (ft)	Inclination (°)	Azimuth (°)	Vertical Depth (ft)	+N/-S (ft)	+E/-W (ft)	Vertical Section (ft)	Dogleg Rate (°/100ft)	Build Rate (°/100ft)	Comments / Formations
8,400.0	90.00	359.50	7,803.0	824.0	1,532.8	824.0	0.00	0.00	
8,500.0	90.00	359.50	7,803.0	924.0	1,531.9	924.0	0.00	0.00	
8,600.0	90.00	359.50	7,803.0	1,024.0	1,531.1	1,024.0	0.00	0.00	
8,700.0	90.00	359.50	7,803.0	1,124.0	1,530.2	1,124.0	0.00	0.00	
8,800.0	90.00	359.50	7,803.0	1,224.0	1,529.3	1,224.0	0.00	0.00	
8,900.0	90.00	359.50	7,803.0	1,324.0	1,528.4	1,324.0	0.00	0.00	
9,000.0	90.00	359.50	7,803.0	1,424.0	1,527.6	1,424.0	0.00	0.00	
9,100.0	90.00	359.50	7,803.0	1,524.0	1,526.7	1,524.0	0.00	0.00	
9,200.0	90.00	359.50	7,803.0	1,624.0	1,525.8	1,624.0	0.00	0.00	
9,300.0	90.00	359.50	7,803.0	1,724.0	1,525.0	1,724.0	0.00	0.00	
9,400.0	90.00	359.50	7,803.0	1,823.9	1,524.1	1,823.9	0.00	0.00	
9,500.0	90.00	359.50	7,803.0	1,923.9	1,523.2	1,923.9	0.00	0.00	
9,600.0	90.00	359.50	7,803.0	2,023.9	1,522.3	2,023.9	0.00	0.00	
9,700.0	90.00	359.50	7,803.0	2,123.9	1,521.5	2,123.9	0.00	0.00	
9,800.0	90.00	359.50	7,803.0	2,223.9	1,520.6	2,223.9	0.00	0.00	
9,900.0	90.00	359.50	7,803.0	2,323.9	1,519.7	2,323.9	0.00	0.00	
10,000.0	90.00	359.50	7,803.0	2,423.9	1,518.8	2,423.9	0.00	0.00	
10,100.0	90.00	359.50	7,803.0	2,523.9	1,518.0	2,523.9	0.00	0.00	
10,200.0	90.00	359.50	7,803.0	2,623.9	1,517.1	2,623.9	0.00	0.00	
10,300.0	90.00	359.50	7,803.0	2,723.9	1,516.2	2,723.9	0.00	0.00	
10,400.0	90.00	359.50	7,803.0	2,823.9	1,515.4	2,823.9	0.00	0.00	
10,500.0	90.00	359.50	7,803.0	2,923.9	1,514.5	2,923.9	0.00	0.00	
10,600.0	90.00	359.50	7,803.0	3,023.9	1,513.6	3,023.9	0.00	0.00	
10,700.0	90.00	359.50	7,803.0	3,123.9	1,512.7	3,123.9	0.00	0.00	
10,800.0	90.00	359.50	7,803.0	3,223.9	1,511.9	3,223.9	0.00	0.00	
10,900.0	90.00	359.50	7,803.0	3,323.9	1,511.0	3,323.9	0.00	0.00	
11,000.0	90.00	359.50	7,803.0	3,423.9	1,510.1	3,423.9	0.00	0.00	
11,100.0	90.00	359.50	7,803.0	3,523.9	1,509.2	3,523.9	0.00	0.00	
11,200.0	90.00	359.50	7,803.0	3,623.9	1,508.4	3,623.9	0.00	0.00	
11,300.0	90.00	359.50	7,803.0	3,723.9	1,507.5	3,723.9	0.00	0.00	
11,400.0	90.00	359.50	7,803.0	3,823.9	1,506.6	3,823.9	0.00	0.00	
11,500.0	90.00	359.50	7,803.0	3,923.9	1,505.8	3,923.9	0.00	0.00	
11,600.0	90.00	359.50	7,803.0	4,023.9	1,504.9	4,023.9	0.00	0.00	
11,700.0	90.00	359.50	7,803.0	4,123.9	1,504.0	4,123.9	0.00	0.00	
11,800.0	90.00	359.50	7,803.0	4,223.9	1,503.1	4,223.9	0.00	0.00	
11,900.0	90.00	359.50	7,803.0	4,323.9	1,502.3	4,323.9	0.00	0.00	
12,000.0	90.00	359.50	7,803.0	4,423.8	1,501.4	4,423.8	0.00	0.00	
12,100.0	90.00	359.50	7,803.0	4,523.8	1,500.5	4,523.8	0.00	0.00	
12,200.0	90.00	359.50	7,803.0	4,623.8	1,499.6	4,623.8	0.00	0.00	
12,300.0	90.00	359.50	7,803.0	4,723.8	1,498.8	4,723.8	0.00	0.00	
12,400.0	90.00	359.50	7,803.0	4,823.8	1,497.9	4,823.8	0.00	0.00	
12,500.0	90.00	359.50	7,803.0	4,923.8	1,497.0	4,923.8	0.00	0.00	
12,600.0	90.00	359.50	7,803.0	5,023.8	1,496.2	5,023.8	0.00	0.00	
12,700.0	90.00	359.50	7,803.0	5,123.8	1,495.3	5,123.8	0.00	0.00	
12,800.0	90.00	359.50	7,803.0	5,223.8	1,494.4	5,223.8	0.00	0.00	
12,900.0	90.00	359.50	7,803.0	5,323.8	1,493.5	5,323.8	0.00	0.00	
13,000.0	90.00	359.50	7,803.0	5,423.8	1,492.7	5,423.8	0.00	0.00	
13,100.0	90.00	359.50	7,803.0	5,523.8	1,491.8	5,523.8	0.00	0.00	
13,200.0	90.00	359.50	7,803.0	5,623.8	1,490.9	5,623.8	0.00	0.00	
13,300.0	90.00	359.50	7,803.0	5,723.8	1,490.0	5,723.8	0.00	0.00	
13,400.0	90.00	359.50	7,803.0	5,823.8	1,489.2	5,823.8	0.00	0.00	
13,500.0	90.00	359.50	7,803.0	5,923.8	1,488.3	5,923.8	0.00	0.00	

Cathedral Energy Services

Planning Report

Database:	USA EDM 5000 Multi Users DB	Local Co-ordinate Reference:	Well Woolley-Becky 2G-7H-E168
Company:	EnCana Oil & Gas (USA) Inc	TVD Reference:	WELL @ 5022.0ft (Original Well Elev)
Project:	DJ Wattenberg	MD Reference:	WELL @ 5022.0ft (Original Well Elev)
Site:	S7-T1N-R68W (Woolley-Sosa/Becky)	North Reference:	True
Well:	Woolley-Becky 2G-7H-E168	Survey Calculation Method:	Minimum Curvature
Wellbore:	Hz		
Design:	Plan #1		

Planned Survey									
Measured Depth (ft)	Inclination (°)	Azimuth (°)	Vertical Depth (ft)	+N/-S (ft)	+E/-W (ft)	Vertical Section (ft)	Dogleg Rate (°/100ft)	Build Rate (°/100ft)	Comments / Formations
13,600.0	90.00	359.50	7,803.0	6,023.8	1,487.4	6,023.8	0.00	0.00	
13,700.0	90.00	359.50	7,803.0	6,123.8	1,486.6	6,123.8	0.00	0.00	
13,800.0	90.00	359.50	7,803.0	6,223.8	1,485.7	6,223.8	0.00	0.00	
13,900.0	90.00	359.50	7,803.0	6,323.8	1,484.8	6,323.8	0.00	0.00	
14,000.0	90.00	359.50	7,803.0	6,423.8	1,483.9	6,423.8	0.00	0.00	
14,100.0	90.00	359.50	7,803.0	6,523.8	1,483.1	6,523.8	0.00	0.00	
14,200.0	90.00	359.50	7,803.0	6,623.8	1,482.2	6,623.8	0.00	0.00	
14,300.0	90.00	359.50	7,803.0	6,723.8	1,481.3	6,723.8	0.00	0.00	
14,400.0	90.00	359.50	7,803.0	6,823.8	1,480.4	6,823.8	0.00	0.00	
14,500.0	90.00	359.50	7,803.0	6,923.8	1,479.6	6,923.8	0.00	0.00	
14,600.0	90.00	359.50	7,803.0	7,023.8	1,478.7	7,023.8	0.00	0.00	
14,700.0	90.00	359.50	7,803.0	7,123.7	1,477.8	7,123.7	0.00	0.00	
14,756.2	90.00	359.50	7,803.0	7,179.9	1,477.3	7,179.9	0.00	0.00	TD at 14756.2

Targets									
Target Name									
- hit/miss target	Dip Angle (°)	Dip Dir. (°)	TVD (ft)	+N/-S (ft)	+E/-W (ft)	Northing (ft)	Easting (ft)	Latitude	Longitude
- Shape									
Woolley-Becky 2G-7H-E	0.00	0.00	7,803.0	7,180.0	1,477.3	1,274,638.34	3,126,575.46	40.086380	-105.047640
- plan hits target center									
- Point									

Formations						
Measured Depth (ft)	Vertical Depth (ft)	Name	Lithology	Dip (°)	Dip Direction (°)	
422.0	422.0	Fox Hills - BASE				
4,607.5	4,502.0	Sussex				
4,893.3	4,782.0	Sussex Marker				
5,196.4	5,079.0	Shannon				
6,646.7	6,500.0	Teepee Buttes (*if present)				
7,600.6	7,431.0	Sharon Springs				
7,667.2	7,491.0	Niobrara				
7,724.5	7,540.0	B Chalk				
7,742.7	7,555.0	B Marl				
7,877.5	7,655.0	C Chalk				
7,918.3	7,681.0	C Marl				
8,111.9	7,772.0	Ft. Hayes				
8,194.8	7,793.0	Codell				

Cathedral Energy Services

Planning Report

Database:	USA EDM 5000 Multi Users DB	Local Co-ordinate Reference:	Well Woolley-Becky 2G-7H-E168
Company:	EnCana Oil & Gas (USA) Inc	TVD Reference:	WELL @ 5022.0ft (Original Well Elev)
Project:	DJ Wattenberg	MD Reference:	WELL @ 5022.0ft (Original Well Elev)
Site:	S7-T1N-R68W (Woolley-Sosa/Becky)	North Reference:	True
Well:	Woolley-Becky 2G-7H-E168	Survey Calculation Method:	Minimum Curvature
Wellbore:	Hz		
Design:	Plan #1		

Plan Annotations				
Measured Depth (ft)	Vertical Depth (ft)	Local Coordinates		Comment
		+N/-S (ft)	+E/-W (ft)	
250.0	250.0	0.0	0.0	KOP @ 250'
1,850.0	1,829.3	-38.5	218.6	EOB; Inc=16°
3,180.2	3,108.0	-44.9	308.9	Start drop @ 3180' MD
3,701.7	3,614.6	-35.2	584.4	EOD; Inc=11.5°
7,428.9	7,266.4	-20.5	707.0	Start build/turn @ 7428' MD
8,303.1	7,803.0	153.8	1,431.9	LP @ 7803' TVD; 90°
14,756.2	7,803.0	727.0	1,533.7	TD at 14756.2

EnCana Oil & Gas (USA) Inc

DJ Wattenberg

S7-T1N-R68W (Woolley-Sosa/Becky)

Woolley-Becky 2G-7H-E168

Hz

Plan #1

Anticollision Report

28 June, 2013

Cathedral Energy Services

Anticollision Report

Company:	EnCana Oil & Gas (USA) Inc	Local Co-ordinate Reference:	Well Woolley-Becky 2G-7H-E168
Project:	DJ Wattenberg	TVD Reference:	WELL @ 5022.0ft (Original Well Elev)
Reference Site:	S7-T1N-R68W (Woolley-Sosa/Becky)	MD Reference:	WELL @ 5022.0ft (Original Well Elev)
Site Error:	0.0ft	North Reference:	True
Reference Well:	Woolley-Becky 2G-7H-E168	Survey Calculation Method:	Minimum Curvature
Well Error:	0.0ft	Output errors are at	2.00 sigma
Reference Wellbore	Hz	Database:	USA EDM 5000 Multi Users DB
Reference Design:	Plan #1	Offset TVD Reference:	Offset Datum

Reference	Plan #1		
Filter type:	NO GLOBAL FILTER: Using user defined selection & filtering criteria		
Interpolation Method:	MD Interval 100.0ft	Error Model:	Systematic Ellipse
Depth Range:	Unlimited	Scan Method:	Closest Approach 3D
Results Limited by:	Maximum center-center distance of 500.0ft	Error Surface:	Elliptical Conic
Warning Levels Evaluated at:	2.00 Sigma		

Survey Tool Program	Date	6/28/2013		
From (ft)	To (ft)	Survey (Wellbore)	Tool Name	Description
0.0	14,908.5	Plan #1 (Hz)	Geolink MWD	Geolink MWD

Cathedral Energy Services

Anticollision Report

Company:	EnCana Oil & Gas (USA) Inc	Local Co-ordinate Reference:	Well Woolley-Becky 2G-7H-E168
Project:	DJ Wattenberg	TVD Reference:	WELL @ 5022.0ft (Original Well Elev)
Reference Site:	S7-T1N-R68W (Woolley-Sosa/Becky)	MD Reference:	WELL @ 5022.0ft (Original Well Elev)
Site Error:	0.0ft	North Reference:	True
Reference Well:	Woolley-Becky 2G-7H-E168	Survey Calculation Method:	Minimum Curvature
Well Error:	0.0ft	Output errors are at	2.00 sigma
Reference Wellbore	Hz	Database:	USA EDM 5000 Multi Users DB
Reference Design:	Plan #1	Offset TVD Reference:	Offset Datum

Summary

Site Name	Reference Measured Depth (ft)	Offset Measured Depth (ft)	Distance Between Centres (ft)	Distance Between Ellipses (ft)	Separation Factor	Warning
Offset Well - Wellbore - Design						
S7-T1N-R68W (Woolley-Sosa/Becky)						
BEARDEN 0-6-6 (EXISTING) - ENCANA WELL - SURVE						Out of range
BEARDEN 1 (EXISTING) - ENCANA WELL - SURVEYS	11,109.2	7,760.4	480.9	402.4	6.122	CC, ES
BEARDEN 1 (EXISTING) - ENCANA WELL - SURVEYS	11,200.0	7,762.3	489.4	409.3	6.109	SF
BEARDEN 13-6 (EXISTING) - ENCANA WELL - SURVEY						Out of range
BEARDEN 14-6 (EXISTING) - ENCANA WELL - SURVEY						Out of range
BEARDEN 23-6 (EXISTING) - ENCANA WELL - NO SUR	11,927.5	7,750.0	208.7	116.2	2.257	CC, ES, SF
BEARDEN 24-6 (EXISTING) - ENCANA WELL - PLAN ON						Out of range
BEARDEN 2-4-6 (EXISTING) - ENCANA WELL - PLAN O						Out of range
BEARDEN 2-8-6 (EXISTING) - ENCANA WELL - SURVE						Out of range
BECKY 1 (EXISTING) - FOUNDATION WELL - NO SURV						Out of range
BECKY 2-6 (EXISTING) - NOBLE WELL - NO SURVEYS						Out of range
BECKY 4 (EXISTING) - MARTIN EXP WELL - NO SURVE						Out of range
BECKY 5-6 (EXISTING) - FOUNDATION WELL - NO SUR						Out of range
BECKY 7-6 (EXISTING) - NOBLE WELL - NO SURVEYS	13,222.2	7,742.0	213.7	98.7	1.859	CC, ES, SF
BILLINGS 21-7 (EXISTING) - KPK WELL - SURVEYS						Out of range
Sosa 11-18 - DD - DD						Out of range
Sosa 11-18 - DD - Plan #1						Out of range
Sosa 12-18 - DD - DD						Out of range
Sosa 12-18 - DD - Plan #3						Out of range
Sosa 21-18 - DD (Gyro) - DD						Out of range
Sosa 21-18 - DD (MWD) - DD						Out of range
Sosa 21-18 - DD (MWD) - Plan #2						Out of range
Sosa 22-18 - DD - DD						Out of range
Sosa 22-18 - DD - Plan #2						Out of range
Sosa A #1 (Existing) - DD - DD						Out of range
THOMAS 14-7(EXISTING) - EXISTING - NO SURVEY						Out of range
THOMAS 24-7 (EXISTING) - ENCANA WELL - SURVEYS						Out of range
THOMAS 24-7 (Existing) - Existing - NO SURVEYS						Out of range
THOMAS 2-8-7 (EXISTING) - ENCANA WELL - SURVEY						Out of range
THOMAS 33-7 (EXISTING) - ENCANA WELL - SURVEYS						Out of range
Thomas 7-12 (Existing) - Existing - NO SURVEYS						Out of range
Thomas 7-14 (Existing) - Existing - NO SURVEYS						Out of range
THOMAS E UNIT 1 (EXISTING) - Existing - NO SURVEY						Out of range
THOMAS K UNIT 1 (EXISTING) - EXISTING - NO SURVE						Out of range
WOOLLEY 11-7 (EXISTING) - ENCANA WELL - SURVEY						Out of range
WOOLLEY 12-7 (EXISTING) - ENCANA WELL - NO SUR	200.0	273.0	303.7	302.9	388.268	CC
WOOLLEY 12-7 (EXISTING) - ENCANA WELL - NO SUR	300.0	373.0	303.9	302.7	268.620	ES
WOOLLEY 12-7 (EXISTING) - ENCANA WELL - NO SUR	1,800.0	1,854.2	494.3	487.8	76.020	SF
WOOLLEY 21-7 (EXISTING) - ENCANA WELL - NO SUR	9,223.5	7,837.0	435.6	388.8	9.312	CC, ES
WOOLLEY 21-7 (EXISTING) - ENCANA WELL - NO SUR	9,300.0	7,837.0	442.2	394.2	9.211	SF
WOOLLEY 22-7 (EXISTING) - ENCANA WELL - SURVEY	6,603.1	6,716.8	114.4	77.1	3.068	CC, ES
WOOLLEY 22-7 (EXISTING) - ENCANA WELL - SURVEY	6,700.0	6,812.0	115.9	77.4	3.012	SF
WOOLLEY 2-4-7 (EXISTING) - ENCANA WELL - SURVE	4,444.1	4,729.0	53.6	14.8	1.383	Level 3, CC, ES, SF
WOOLLEY 4-0-7 (EXISTING) - ENCANA WELL - SURVE	9,816.1	7,920.2	80.2	20.4	1.342	Level 3, CC, ES, SF
WOOLLEY F UNIT 1 (EXISTING) - ENCANA WELL - NO						Out of range
Woolley-Becky 2A-7H-E168 - Hz - Plan #1	200.0	198.0	39.2	38.6	64.512	CC, ES
Woolley-Becky 2A-7H-E168 - Hz - Plan #1	600.0	594.3	61.8	59.8	30.813	SF
Woolley-Becky 2B-7H-E168 - Hz - Plan #1	200.0	198.0	34.4	33.8	56.582	CC
Woolley-Becky 2B-7H-E168 - Hz - Plan #1	300.0	298.0	34.6	33.6	36.161	ES
Woolley-Becky 2B-7H-E168 - Hz - Plan #1	600.0	596.4	49.2	47.2	24.468	SF
Woolley-Becky 2C-7H-E168 - Hz - Plan #1	200.0	199.0	30.8	30.2	50.543	CC
Woolley-Becky 2C-7H-E168 - Hz - Plan #1	300.0	299.0	31.0	30.0	32.355	ES
Woolley-Becky 2C-7H-E168 - Hz - Plan #1	900.0	900.9	59.6	56.5	19.535	SF

CC - Min centre to center distance or covergent point, SF - min separation factor, ES - min ellipse separation

Cathedral Energy Services

Anticollision Report

Company:	EnCana Oil & Gas (USA) Inc	Local Co-ordinate Reference:	Well Woolley-Becky 2G-7H-E168
Project:	DJ Wattenberg	TVD Reference:	WELL @ 5022.0ft (Original Well Elev)
Reference Site:	S7-T1N-R68W (Woolley-Sosa/Becky)	MD Reference:	WELL @ 5022.0ft (Original Well Elev)
Site Error:	0.0ft	North Reference:	True
Reference Well:	Woolley-Becky 2G-7H-E168	Survey Calculation Method:	Minimum Curvature
Well Error:	0.0ft	Output errors are at	2.00 sigma
Reference Wellbore	Hz	Database:	USA EDM 5000 Multi Users DB
Reference Design:	Plan #1	Offset TVD Reference:	Offset Datum

Summary

Site Name Offset Well - Wellbore - Design	Reference Measured Depth (ft)	Offset Measured Depth (ft)	Distance		Separation Factor	Warning
			Between Centres (ft)	Between Ellipses (ft)		
S7-T1N-R68W (Woolley-Sosa/Becky)						
Woolley-Becky 2D-7H-E168 - Hz - Plan #1	200.0	199.0	26.2	25.6	43.048	CC
Woolley-Becky 2D-7H-E168 - Hz - Plan #1	300.0	299.0	26.4	25.5	27.593	ES
Woolley-Becky 2D-7H-E168 - Hz - Plan #1	1,000.0	1,001.9	54.0	50.6	15.861	SF
Woolley-Becky 2E-7H-E168 - Hz - Plan #1	200.0	199.0	8.4	7.8	13.784	CC
Woolley-Becky 2E-7H-E168 - Hz - Plan #1	300.0	299.0	8.6	7.7	8.987	ES
Woolley-Becky 2E-7H-E168 - Hz - Plan #1	700.0	699.6	18.2	15.9	7.748	SF
Woolley-Becky 2F-7H-E168 - Hz - Plan #1	200.0	200.0	9.2	8.6	15.040	CC
Woolley-Becky 2F-7H-E168 - Hz - Plan #1	300.0	300.0	9.3	8.4	9.740	ES
Woolley-Becky 2F-7H-E168 - Hz - Plan #1	14,756.2	14,367.7	434.0	224.4	2.070	SF
Woolley-Becky 2H-7H-E168 - Hz - Plan #1	200.0	200.0	9.2	8.6	15.040	CC, ES
Woolley-Becky 2H-7H-E168 - Hz - Plan #1	14,756.2	14,742.8	411.5	207.0	2.012	SF
Woolley-Sosa 2A-7H-E168 - Hz - Plan #1	200.0	197.0	106.0	105.4	174.955	CC, ES
Woolley-Sosa 2A-7H-E168 - Hz - Plan #1	900.0	881.2	173.4	170.3	56.231	SF
Woolley-Sosa 2B-7H-E168 - HZ - Plan #1	200.0	197.0	101.1	100.5	166.884	CC
Woolley-Sosa 2B-7H-E168 - HZ - Plan #1	300.0	297.0	101.3	100.3	106.096	ES
Woolley-Sosa 2B-7H-E168 - HZ - Plan #1	1,000.0	987.8	168.0	164.5	48.242	SF
Woolley-Sosa 2C-7H-E168 - HZ - Plan #1	200.0	197.0	96.0	95.4	158.444	CC
Woolley-Sosa 2C-7H-E168 - HZ - Plan #1	300.0	297.0	96.2	95.2	100.739	ES
Woolley-Sosa 2C-7H-E168 - HZ - Plan #1	1,100.0	1,094.8	154.8	150.9	39.862	SF
Woolley-Sosa 2D-7H-E168 - HZ - Plan #1	200.0	197.0	91.1	90.5	150.394	CC
Woolley-Sosa 2D-7H-E168 - HZ - Plan #1	300.0	297.0	91.3	90.3	95.635	ES
Woolley-Sosa 2D-7H-E168 - HZ - Plan #1	1,300.0	1,298.7	164.8	160.1	35.284	SF
Woolley-Sosa 2E-7H-E168 - HZ - Plan #1	200.0	197.0	76.0	75.4	125.423	CC
Woolley-Sosa 2E-7H-E168 - HZ - Plan #1	300.0	297.0	76.2	75.2	79.791	ES
Woolley-Sosa 2E-7H-E168 - HZ - Plan #1	3,200.0	3,183.5	487.6	473.7	35.068	SF
Woolley-Sosa 2F-7H-E168 - HZ - Plan #1	200.0	197.0	71.1	70.5	117.432	CC
Woolley-Sosa 2F-7H-E168 - HZ - Plan #1	300.0	297.0	71.3	70.4	74.724	ES
Woolley-Sosa 2F-7H-E168 - HZ - Plan #1	8,000.0	7,850.0	443.9	410.8	13.405	SF
Woolley-Sosa 2G-7H-E168 - HZ - Plan #1	620.2	621.4	63.9	61.8	30.573	CC
Woolley-Sosa 2G-7H-E168 - HZ - Plan #1	7,865.3	7,922.1	68.5	38.8	2.307	ES, SF

Cathedral Energy Services

Anticollision Report

Company:	EnCana Oil & Gas (USA) Inc	Local Co-ordinate Reference:	Well Woolley-Becky 2G-7H-E168
Project:	DJ Wattenberg	TVD Reference:	WELL @ 5022.0ft (Original Well Elev)
Reference Site:	S7-T1N-R68W (Woolley-Sosa/Becky)	MD Reference:	WELL @ 5022.0ft (Original Well Elev)
Site Error:	0.0ft	North Reference:	True
Reference Well:	Woolley-Becky 2G-7H-E168	Survey Calculation Method:	Minimum Curvature
Well Error:	0.0ft	Output errors are at	2.00 sigma
Reference Wellbore	Hz	Database:	USA EDM 5000 Multi Users DB
Reference Design:	Plan #1	Offset TVD Reference:	Offset Datum

Offset Design S7-T1N-R68W (Woolley-Sosa/Becky) - BEARDEN 1 (EXISTING) - ENCANA WELL - SURVEYS												Offset Site Error:	0.0 ft
Survey Program: 100-MWD												Offset Well Error:	0.0 ft
Reference		Offset		Semi Major Axis			Distance						Warning
Measured Depth	Vertical Depth	Measured Depth	Vertical Depth	Reference	Offset	Highside Toolface	Offset Wellbore Centre +N/-S	+E/-W	Between Centres	Between Ellipses	Total Uncertainty Axis	Separation Factor	
(ft)	(ft)	(ft)	(ft)	(ft)	(ft)	(°)	(ft)	(ft)	(ft)	(ft)			
11,000.0	7,803.0	7,758.2	7,755.6	68.6	13.8	-89.84	3,528.8	1,028.2	493.2	416.5	76.68	6.432	
11,100.0	7,803.0	7,760.3	7,757.7	70.2	13.8	-90.09	3,528.8	1,028.2	481.0	402.6	78.40	6.136	
11,109.2	7,803.0	7,760.4	7,757.9	70.3	13.8	-90.11	3,528.8	1,028.2	480.9	402.4	78.56	6.122 CC, ES	
11,200.0	7,803.0	7,762.3	7,759.8	71.8	13.8	-90.34	3,528.9	1,028.2	489.4	409.3	80.12	6.109 SF	

Cathedral Energy Services

Anticollision Report

Company:	EnCana Oil & Gas (USA) Inc	Local Co-ordinate Reference:	Well Woolley-Becky 2G-7H-E168
Project:	DJ Wattenberg	TVD Reference:	WELL @ 5022.0ft (Original Well Elev)
Reference Site:	S7-T1N-R68W (Woolley-Sosa/Becky)	MD Reference:	WELL @ 5022.0ft (Original Well Elev)
Site Error:	0.0ft	North Reference:	True
Reference Well:	Woolley-Becky 2G-7H-E168	Survey Calculation Method:	Minimum Curvature
Well Error:	0.0ft	Output errors are at	2.00 sigma
Reference Wellbore	Hz	Database:	USA EDM 5000 Multi Users DB
Reference Design:	Plan #1	Offset TVD Reference:	Offset Datum

Offset Design													S7-T1N-R68W (Woolley-Sosa/Becky) - BEARDEN 23-6 (EXISTING) - ENCANA WELL - NO SURVEYS		Offset Site Error:		0.0 ft
Survey Program:													8405-Geolink MWD		Offset Well Error:		0.0 ft
Reference		Offset		Semi Major Axis			Distance							Warning			
Measured Depth	Vertical Depth	Measured Depth	Vertical Depth	Reference	Offset	Highside Toolface	Offset Wellbore Centre	Between Centres	Between Ellipses	Total Uncertainty Axis	Separation Factor						
(ft)	(ft)	(ft)	(ft)	(ft)	(ft)	(°)	+N/-S (ft)	+E/-W (ft)	(ft)	(ft)							
11,500.0	7,803.0	7,750.0	7,750.0	76.6	13.5	-90.00	4,349.5	1,293.4	475.7	390.6	85.08	5.591					
11,600.0	7,803.0	7,750.0	7,750.0	78.2	13.5	-90.00	4,349.5	1,293.4	388.3	301.5	86.80	4.473					
11,700.0	7,803.0	7,750.0	7,750.0	79.8	13.5	-90.00	4,349.5	1,293.4	308.7	220.1	88.53	3.487					
11,800.0	7,803.0	7,750.0	7,750.0	81.4	13.5	-90.00	4,349.5	1,293.4	244.5	154.3	90.26	2.709					
11,900.0	7,803.0	7,750.0	7,750.0	83.0	13.5	-90.00	4,349.5	1,293.4	210.5	118.5	91.99	2.288					
11,927.5	7,803.0	7,750.0	7,750.0	83.5	13.5	-90.00	4,349.5	1,293.4	208.7	116.2	92.46	2.257	CC, ES, SF				
12,000.0	7,803.0	7,750.0	7,750.0	84.7	13.5	-90.00	4,349.5	1,293.4	220.9	127.2	93.72	2.357					
12,100.0	7,803.0	7,750.0	7,750.0	86.3	13.5	-90.00	4,349.5	1,293.4	270.7	175.3	95.45	2.837					
12,200.0	7,803.0	7,750.0	7,750.0	88.0	13.5	-90.00	4,349.5	1,293.4	343.2	246.1	97.18	3.532					
12,300.0	7,803.0	7,750.0	7,750.0	89.6	13.5	-90.00	4,349.5	1,293.4	427.0	328.1	98.91	4.317					

CC - Min centre to center distance or convergent point, SF - min separation factor, ES - min ellipse separation

Cathedral Energy Services

Anticollision Report

Company:	EnCana Oil & Gas (USA) Inc	Local Co-ordinate Reference:	Well Woolley-Becky 2G-7H-E168
Project:	DJ Wattenberg	TVD Reference:	WELL @ 5022.0ft (Original Well Elev)
Reference Site:	S7-T1N-R68W (Woolley-Sosa/Becky)	MD Reference:	WELL @ 5022.0ft (Original Well Elev)
Site Error:	0.0ft	North Reference:	True
Reference Well:	Woolley-Becky 2G-7H-E168	Survey Calculation Method:	Minimum Curvature
Well Error:	0.0ft	Output errors are at	2.00 sigma
Reference Wellbore	Hz	Database:	USA EDM 5000 Multi Users DB
Reference Design:	Plan #1	Offset TVD Reference:	Offset Datum

Offset Design													S7-T1N-R68W (Woolley-Sosa/Becky) - BECKY 7-6 (EXISTING) - NOBLE WELL - NO SURVEYS		Offset Site Error:		0.0 ft
Survey Program:													7756-Geolink MWD		Offset Well Error:		0.0 ft
Reference		Offset		Semi Major Axis			Distance										
Measured Depth	Vertical Depth	Measured Depth	Vertical Depth	Reference	Offset	Highside Toolface	Offset Wellbore Centre		Between Centres	Between Ellipses	Total Uncertainty	Separation	Warning				
(ft)	(ft)	(ft)	(ft)	(ft)	(ft)	(°)	+N/-S (ft)	+E/-W (ft)	(ft)	(ft)	Axis	Factor					
12,800.0	7,803.0	7,742.0	7,742.0	97.9	13.5	-90.00	5,644.1	1,277.1	473.2	365.6	107.58	4.399					
12,900.0	7,803.0	7,742.0	7,742.0	99.6	13.5	-90.00	5,644.1	1,277.1	386.6	277.3	109.31	3.537					
13,000.0	7,803.0	7,742.0	7,742.0	101.3	13.5	-90.00	5,644.1	1,277.1	308.3	197.2	111.05	2.776					
13,100.0	7,803.0	7,742.0	7,742.0	102.9	13.5	-90.00	5,644.1	1,277.1	246.1	133.3	112.79	2.182					
13,200.0	7,803.0	7,742.0	7,742.0	104.6	13.5	-90.00	5,644.1	1,277.1	214.8	100.3	114.53	1.876					
13,222.2	7,803.0	7,742.0	7,742.0	105.0	13.5	-90.00	5,644.1	1,277.1	213.7	98.7	114.92	1.859	CC, ES, SF				
13,300.0	7,803.0	7,742.0	7,742.0	106.3	13.5	-90.00	5,644.1	1,277.1	227.4	111.1	116.27	1.956					
13,400.0	7,803.0	7,742.0	7,742.0	108.0	13.5	-90.00	5,644.1	1,277.1	278.0	159.9	118.01	2.355					
13,500.0	7,803.0	7,742.0	7,742.0	109.7	13.5	-90.00	5,644.1	1,277.1	350.5	230.7	119.75	2.927					
13,600.0	7,803.0	7,742.0	7,742.0	111.3	13.5	-90.00	5,644.1	1,277.1	434.0	312.5	121.49	3.572					

Cathedral Energy Services

Anticollision Report

Company:	EnCana Oil & Gas (USA) Inc	Local Co-ordinate Reference:	Well Woolley-Becky 2G-7H-E168
Project:	DJ Wattenberg	TVD Reference:	WELL @ 5022.0ft (Original Well Elev)
Reference Site:	S7-T1N-R68W (Woolley-Sosa/Becky)	MD Reference:	WELL @ 5022.0ft (Original Well Elev)
Site Error:	0.0ft	North Reference:	True
Reference Well:	Woolley-Becky 2G-7H-E168	Survey Calculation Method:	Minimum Curvature
Well Error:	0.0ft	Output errors are at	2.00 sigma
Reference Wellbore	Hz	Database:	USA EDM 5000 Multi Users DB
Reference Design:	Plan #1	Offset TVD Reference:	Offset Datum

Offset Design S7-T1N-R68W (Woolley-Sosa/Becky) - WOOLLEY 12-7 (EXISTING) - ENCANA WELL - NO SURVEYS													Offset Site Error:	0.0 ft
Survey Program: 8325-Geolink MWD													Offset Well Error:	0.0 ft
Reference		Offset		Semi Major Axis		Highside Toolface (°)	Distance		Total Uncertainty Axis	Separation Factor	Warning			
Measured Depth (ft)	Vertical Depth (ft)	Measured Depth (ft)	Vertical Depth (ft)	Reference (ft)	Offset (ft)		Offset Wellbore Centre +N/-S (ft)	+E/-W (ft)						
0.0	0.0	73.0	73.0	0.0	0.1	-49.17	198.5	-229.8	303.7					
100.0	100.0	173.0	173.0	0.1	0.3	-49.17	198.5	-229.8	303.7	303.2	0.43	701.243		
200.0	200.0	273.0	273.0	0.3	0.5	-49.17	198.5	-229.8	303.7	302.9	0.78	388.268 CC		
227.8	227.8	300.8	300.8	0.4	0.5	-149.18	198.5	-229.8	303.7	302.8	0.88	345.454		
300.0	300.0	373.0	373.0	0.5	0.7	-149.19	198.5	-229.8	303.9	302.7	1.13	268.620 ES		
400.0	400.0	473.0	473.0	0.7	0.8	-149.35	198.5	-229.8	305.4	303.9	1.48	206.243		
500.0	499.9	572.9	572.9	0.8	1.0	-149.67	198.5	-229.8	308.4	306.5	1.83	168.408		
600.0	599.8	672.8	672.8	1.0	1.2	-150.13	198.5	-229.8	312.9	310.7	2.18	143.311		
700.0	699.5	772.5	772.5	1.2	1.3	-150.72	198.5	-229.8	319.0	316.4	2.54	125.685		
800.0	799.2	872.2	872.2	1.5	1.5	-151.43	198.5	-229.8	326.6	323.7	2.89	112.825		
900.0	898.6	971.6	971.6	1.7	1.7	-152.24	198.5	-229.8	335.8	332.6	3.25	103.203		
1,000.0	997.9	1,070.9	1,070.9	2.0	1.9	-153.13	198.5	-229.8	346.7	343.1	3.62	95.888		
1,100.0	1,096.9	1,169.9	1,169.9	2.2	2.0	-154.08	198.5	-229.8	359.2	355.2	3.98	90.282		
1,200.0	1,195.7	1,268.7	1,268.7	2.6	2.2	-155.06	198.5	-229.8	373.3	369.0	4.34	85.980		
1,300.0	1,294.1	1,367.1	1,367.1	2.9	2.4	-156.07	198.5	-229.8	389.2	384.5	4.71	82.701		
1,400.0	1,392.3	1,465.3	1,465.3	3.3	2.6	-157.09	198.5	-229.8	406.7	401.7	5.07	80.239		
1,500.0	1,490.1	1,563.1	1,563.1	3.6	2.7	-158.10	198.5	-229.8	426.0	420.6	5.43	78.444		
1,600.0	1,587.5	1,660.5	1,660.5	4.1	2.9	-159.10	198.5	-229.8	447.0	441.2	5.79	77.199		
1,700.0	1,684.6	1,757.6	1,757.6	4.5	3.1	-160.07	198.5	-229.8	469.8	463.6	6.15	76.414		
1,800.0	1,781.2	1,854.2	1,854.2	5.0	3.2	-161.01	198.5	-229.8	494.3	487.8	6.50	76.020 SF		

Cathedral Energy Services

Anticollision Report

Company:	EnCana Oil & Gas (USA) Inc	Local Co-ordinate Reference:	Well Woolley-Becky 2G-7H-E168
Project:	DJ Wattenberg	TVD Reference:	WELL @ 5022.0ft (Original Well Elev)
Reference Site:	S7-T1N-R68W (Woolley-Sosa/Becky)	MD Reference:	WELL @ 5022.0ft (Original Well Elev)
Site Error:	0.0ft	North Reference:	True
Reference Well:	Woolley-Becky 2G-7H-E168	Survey Calculation Method:	Minimum Curvature
Well Error:	0.0ft	Output errors are at	2.00 sigma
Reference Wellbore	Hz	Database:	USA EDM 5000 Multi Users DB
Reference Design:	Plan #1	Offset TVD Reference:	Offset Datum

Offset Design												Offset Site Error:	0.0 ft
S7-T1N-R68W (Woolley-Sosa/Becky) - WOOLLEY 21-7 (EXISTING) - ENCANA WELL - NO SURVEYS												Offset Well Error:	0.0 ft
Survey Program: 8512-MWD													
Reference		Offset		Semi Major Axis			Distance						
Measured Depth	Vertical Depth	Measured Depth	Vertical Depth	Reference	Offset	Highside Toolface	Offset Wellbore Centre +N/-S	+E/-W	Between Centres	Between Ellipses	Total Uncertainty Axis	Separation Factor	Warning
(ft)	(ft)	(ft)	(ft)	(ft)	(ft)	(°)	(ft)	(ft)	(ft)	(ft)			
9,000.0	7,803.0	7,837.0	7,837.0	40.3	13.7	-90.00	1,643.6	1,090.1	489.6	446.4	43.21	11.330	
9,100.0	7,803.0	7,837.0	7,837.0	41.5	13.7	-90.00	1,643.6	1,090.1	452.7	407.9	44.79	10.107	
9,200.0	7,803.0	7,837.0	7,837.0	42.7	13.7	-90.00	1,643.6	1,090.1	436.2	389.8	46.40	9.402	
9,223.5	7,803.0	7,837.0	7,837.0	43.0	13.7	-90.00	1,643.6	1,090.1	435.6	388.8	46.78	9.312 CC, ES	
9,300.0	7,803.0	7,837.0	7,837.0	43.9	13.7	-90.00	1,643.6	1,090.1	442.2	394.2	48.01	9.211 SF	
9,400.0	7,803.0	7,837.0	7,837.0	45.2	13.7	-90.00	1,643.6	1,090.1	470.0	420.3	49.64	9.468	

Cathedral Energy Services

Anticollision Report

Company:	EnCana Oil & Gas (USA) Inc	Local Co-ordinate Reference:	Well Woolley-Becky 2G-7H-E168
Project:	DJ Wattenberg	TVD Reference:	WELL @ 5022.0ft (Original Well Elev)
Reference Site:	S7-T1N-R68W (Woolley-Sosa/Becky)	MD Reference:	WELL @ 5022.0ft (Original Well Elev)
Site Error:	0.0ft	North Reference:	True
Reference Well:	Woolley-Becky 2G-7H-E168	Survey Calculation Method:	Minimum Curvature
Well Error:	0.0ft	Output errors are at	2.00 sigma
Reference Wellbore	Hz	Database:	USA EDM 5000 Multi Users DB
Reference Design:	Plan #1	Offset TVD Reference:	Offset Datum

Offset Design S7-T1N-R68W (Woolley-Sosa/Becky) - WOOLLEY 22-7 (EXISTING) - ENCANA WELL - SURVEYS												Offset Site Error: 0.0 ft	
Survey Program: 71-Geolink MWD												Offset Well Error: 0.0 ft	
Reference		Offset		Semi Major Axis			Distance						Warning
Measured Depth	Vertical Depth	Measured Depth	Vertical Depth	Reference	Offset	Highside Toolface	Offset Wellbore Centre	Between Centres	Between Ellipses	Total Uncertainty	Separation Factor		
(ft)	(ft)	(ft)	(ft)	(ft)	(ft)	(°)	+N/-S (ft)	+E/-W (ft)	(ft)	(ft)	Axis		
4,600.0	4,494.7	4,823.7	4,616.1	17.9	24.4	-34.45	376.0	1,220.5	497.6	464.5	33.09	15.039	
4,700.0	4,592.6	4,918.0	4,706.9	18.2	24.9	-33.27	350.8	1,223.7	464.1	430.3	33.79	13.736	
4,800.0	4,690.6	5,005.0	4,791.0	18.6	25.3	-32.18	328.5	1,226.1	431.2	396.8	34.43	12.524	
4,900.0	4,788.6	5,092.0	4,875.6	19.0	25.6	-31.12	308.5	1,229.1	400.7	365.7	35.04	11.435	
5,000.0	4,886.6	5,179.0	4,960.8	19.4	26.0	-30.23	291.2	1,231.9	372.3	336.7	35.60	10.459	
5,100.0	4,984.6	5,271.3	5,051.8	19.8	26.3	-29.57	275.6	1,234.4	345.5	309.4	36.12	9.565	
5,200.0	5,082.5	5,365.1	5,144.4	20.2	26.5	-29.13	261.8	1,236.5	319.9	283.3	36.62	8.736	
5,300.0	5,180.5	5,459.5	5,238.0	20.6	26.8	-28.96	249.6	1,238.0	295.0	258.0	37.07	7.958	
5,400.0	5,278.5	5,553.2	5,331.3	21.0	27.0	-29.22	239.7	1,238.8	271.2	233.7	37.48	7.236	
5,500.0	5,376.5	5,646.9	5,424.7	21.4	27.1	-30.05	232.3	1,238.9	248.6	210.7	37.85	6.567	
5,600.0	5,474.5	5,738.6	5,516.2	21.8	27.3	-31.31	227.0	1,239.5	227.8	189.6	38.18	5.966	
5,700.0	5,572.4	5,833.3	5,610.9	22.1	27.3	-33.42	224.9	1,240.6	210.0	171.6	38.45	5.462	
5,800.0	5,670.4	5,931.4	5,708.9	22.5	27.4	-36.91	224.7	1,239.3	192.5	153.9	38.62	4.985	
5,900.0	5,768.4	6,028.0	5,805.5	22.9	27.5	-40.76	224.5	1,239.0	176.4	137.7	38.74	4.554	
6,000.0	5,866.4	6,125.2	5,902.8	23.3	27.5	-45.07	224.2	1,239.7	161.8	123.0	38.75	4.175	
6,100.0	5,964.3	6,222.6	6,000.1	23.7	27.6	-50.29	224.5	1,240.3	148.8	110.2	38.59	3.855	
6,200.0	6,062.3	6,320.7	6,098.2	24.1	27.7	-56.45	225.1	1,241.0	137.5	99.3	38.23	3.596	
6,300.0	6,160.3	6,419.0	6,196.5	24.5	27.7	-63.40	225.5	1,242.2	128.0	90.3	37.70	3.396	
6,400.0	6,258.3	6,517.3	6,294.8	24.9	27.8	-71.34	225.8	1,243.3	120.7	83.6	37.10	3.254	
6,500.0	6,356.3	6,615.5	6,393.0	25.3	27.9	-80.26	226.2	1,243.9	116.1	79.3	36.79	3.154	
6,600.0	6,454.2	6,713.7	6,491.2	25.7	27.9	-89.69	226.4	1,244.6	114.4	77.1	37.26	3.070	
6,603.1	6,457.3	6,716.8	6,494.3	25.7	27.9	-89.99	226.4	1,244.6	114.4	77.1	37.29	3.068 CC, ES	
6,700.0	6,552.2	6,812.0	6,589.5	26.1	28.0	-99.12	226.5	1,245.3	115.9	77.4	38.46	3.012 SF	
6,800.0	6,650.2	6,910.4	6,687.9	26.5	28.1	-108.10	226.4	1,246.0	120.2	80.4	39.87	3.016	
6,900.0	6,748.2	7,008.7	6,786.2	26.9	28.2	-116.28	226.3	1,246.9	127.3	86.2	41.06	3.100	
7,000.0	6,846.2	7,107.0	6,884.5	27.2	28.2	-123.50	226.0	1,247.9	136.6	94.7	41.90	3.259	
7,100.0	6,944.1	7,206.2	6,983.7	27.6	28.3	-129.88	225.3	1,249.1	147.3	104.9	42.43	3.472	
7,200.0	7,042.1	7,304.7	7,082.2	28.0	28.4	-135.45	224.0	1,250.6	159.0	116.3	42.72	3.722	
7,300.0	7,140.1	7,401.3	7,178.8	28.4	28.5	-140.16	222.9	1,251.6	172.5	129.6	42.87	4.024	
7,400.0	7,238.1	7,497.4	7,274.9	28.8	28.6	-144.12	222.2	1,251.8	188.0	145.0	42.96	4.376	
7,500.0	7,335.7	7,592.5	7,369.9	29.2	28.7	-120.05	221.8	1,250.9	203.9	160.7	43.21	4.718	
7,600.0	7,430.4	7,686.8	7,464.2	29.6	28.8	-107.28	221.6	1,249.3	217.8	174.6	43.14	5.048	
7,700.0	7,519.4	7,776.7	7,554.1	30.1	28.8	-107.13	221.4	1,248.2	233.6	190.8	42.74	5.464	
7,800.0	7,600.0	7,857.8	7,635.2	30.6	28.9	-110.96	221.3	1,247.5	257.8	215.6	42.20	6.110	
7,900.0	7,669.6	7,928.1	7,705.5	31.1	28.9	-114.58	221.5	1,247.0	295.8	254.2	41.61	7.109	
8,000.0	7,726.2	7,985.7	7,763.1	31.7	29.0	-115.72	221.7	1,246.7	349.1	307.6	41.50	8.411	
8,100.0	7,768.1	8,028.3	7,805.7	32.3	29.0	-112.91	222.0	1,246.6	416.2	373.3	42.84	9.715	
8,200.0	7,793.9	8,054.9	7,832.3	33.0	29.0	-104.91	222.1	1,246.5	493.9	448.1	45.80	10.783	

Cathedral Energy Services

Anticollision Report

Company:	EnCana Oil & Gas (USA) Inc	Local Co-ordinate Reference:	Well Woolley-Becky 2G-7H-E168
Project:	DJ Wattenberg	TVD Reference:	WELL @ 5022.0ft (Original Well Elev)
Reference Site:	S7-T1N-R68W (Woolley-Sosa/Becky)	MD Reference:	WELL @ 5022.0ft (Original Well Elev)
Site Error:	0.0ft	North Reference:	True
Reference Well:	Woolley-Becky 2G-7H-E168	Survey Calculation Method:	Minimum Curvature
Well Error:	0.0ft	Output errors are at	2.00 sigma
Reference Wellbore	Hz	Database:	USA EDM 5000 Multi Users DB
Reference Design:	Plan #1	Offset TVD Reference:	Offset Datum

Offset Design		S7-T1N-R68W (Woolley-Sosa/Becky) - WOOLLEY 2-4-7 (EXISTING) - ENCANA WELL - SURVEYS										Offset Site Error:		0.0 ft
Survey Program:		41-Geolink MWD										Offset Well Error:		0.0 ft
Reference		Offset		Semi Major Axis			Distance							Warning
Measured Depth	Vertical Depth	Measured Depth	Vertical Depth	Reference	Offset	Highside Toolface	Offset Wellbore Centre	Between Centres	Between Ellipses	Total Uncertainty Axis	Separation Factor			
(ft)	(ft)	(ft)	(ft)	(ft)	(ft)	(°)	+N/-S (ft)	+E/-W (ft)	(ft)	(ft)				
3,500.0	3,417.5	3,917.1	3,657.6	13.6	23.7	-63.93	388.4	849.1	499.1	478.5	20.54	24.302		
3,600.0	3,515.0	4,001.2	3,734.1	14.0	24.3	-62.59	354.6	841.7	448.6	427.7	20.93	21.437		
3,700.0	3,612.9	4,089.1	3,814.2	14.4	24.9	-60.90	318.7	835.2	398.3	377.0	21.32	18.687		
3,800.0	3,710.8	4,176.5	3,893.3	14.8	25.6	-62.65	282.2	829.3	347.4	325.7	21.68	16.023		
3,900.0	3,808.8	4,262.2	3,970.7	15.1	26.3	-64.49	245.7	825.8	296.7	274.6	22.10	13.426		
4,000.0	3,906.8	4,346.6	4,047.0	15.5	26.9	-66.99	209.7	822.5	246.5	223.9	22.59	10.909		
4,100.0	4,004.8	4,436.3	4,128.3	15.9	27.6	-70.95	171.8	819.1	197.1	173.7	23.38	8.430		
4,200.0	4,102.8	4,526.5	4,208.3	16.3	28.4	-77.92	130.4	814.9	145.3	120.1	25.21	5.765		
4,300.0	4,200.7	4,609.8	4,281.5	16.7	29.1	-91.56	91.1	810.0	95.4	65.6	29.79	3.201		
4,400.0	4,298.7	4,691.9	4,354.2	17.1	29.7	-121.85	53.0	805.2	58.5	21.0	37.48	1.561		
4,444.1	4,341.9	4,729.0	4,387.3	17.2	30.0	-142.04	36.5	803.4	53.6	14.8	38.73	1.383	Level 3, CC, ES, SF	
4,500.0	4,396.7	4,776.9	4,430.7	17.5	30.4	-166.69	16.2	801.4	60.9	23.5	37.38	1.630		
4,600.0	4,494.7	4,865.4	4,511.9	17.9	31.0	-167.12	-18.7	797.9	95.0	59.2	35.78	2.655		
4,700.0	4,592.6	4,955.9	4,596.3	18.2	31.5	-156.00	-51.2	794.4	136.0	101.2	34.80	3.908		
4,800.0	4,690.6	5,048.0	4,683.2	18.6	32.1	-150.99	-81.3	789.7	178.0	143.6	34.45	5.167		
4,900.0	4,788.6	5,144.9	4,775.4	19.0	32.6	-148.18	-110.8	785.3	218.8	184.4	34.44	6.354		
5,000.0	4,886.6	5,244.8	4,871.7	19.4	33.1	-146.84	-137.0	781.3	256.6	222.0	34.69	7.398		
5,100.0	4,984.6	5,351.3	4,975.5	19.8	33.5	-146.40	-160.5	777.6	291.3	256.1	35.11	8.295		
5,200.0	5,082.5	5,453.1	5,075.6	20.2	33.8	-146.53	-178.5	774.9	322.3	286.7	35.63	9.047		
5,300.0	5,180.5	5,554.1	5,175.3	20.6	34.1	-146.90	-194.3	772.1	352.0	315.9	36.17	9.734		
5,400.0	5,278.5	5,660.9	5,281.4	21.0	34.3	-147.73	-206.5	769.2	378.8	342.1	36.77	10.304		
5,500.0	5,376.5	5,767.0	5,387.0	21.4	34.5	-148.78	-215.5	766.0	403.9	366.5	37.38	10.806		
5,600.0	5,474.5	5,876.2	5,496.1	21.8	34.7	-150.01	-221.1	763.7	426.1	388.1	37.99	11.216		
5,700.0	5,572.4	5,978.8	5,598.7	22.1	34.8	-151.23	-223.9	762.1	446.6	408.1	38.55	11.584		
5,800.0	5,670.4	6,081.4	5,701.2	22.5	34.8	-152.58	-224.4	760.2	466.1	427.0	39.10	11.920		
5,900.0	5,768.4	6,179.3	5,799.1	22.9	34.9	-153.81	-224.3	758.4	485.3	445.7	39.60	12.253		

Cathedral Energy Services

Anticollision Report

Company:	EnCana Oil & Gas (USA) Inc	Local Co-ordinate Reference:	Well Woolley-Becky 2G-7H-E168
Project:	DJ Wattenberg	TVD Reference:	WELL @ 5022.0ft (Original Well Elev)
Reference Site:	S7-T1N-R68W (Woolley-Sosa/Becky)	MD Reference:	WELL @ 5022.0ft (Original Well Elev)
Site Error:	0.0ft	North Reference:	True
Reference Well:	Woolley-Becky 2G-7H-E168	Survey Calculation Method:	Minimum Curvature
Well Error:	0.0ft	Output errors are at	2.00 sigma
Reference Wellbore	Hz	Database:	USA EDM 5000 Multi Users DB
Reference Design:	Plan #1	Offset TVD Reference:	Offset Datum

Offset Design S7-T1N-R68W (Woolley-Sosa/Becky) - WOOLLEY 4-0-7 (EXISTING) - ENCANA WELL - SURVEYS													Offset Site Error:	0.0 ft
Survey Program: 71-Geolink MWD													Offset Well Error:	0.0 ft
Reference		Offset		Semi Major Axis			Distance							Warning
Measured Depth (ft)	Vertical Depth (ft)	Measured Depth (ft)	Vertical Depth (ft)	Reference (ft)	Offset (ft)	Highside Toolface (°)	Offset Wellbore Centre +N/-S (ft)	+E/-W (ft)	Between Centres (ft)	Between Ellipses (ft)	Total Uncertainty Axis	Separation Factor		
9,400.0	7,803.0	7,910.7	7,829.4	45.2	19.7	82.46	2,240.5	1,600.5	423.7	371.0	52.66	8.046		
9,500.0	7,803.0	7,913.0	7,831.7	46.5	19.7	84.09	2,240.6	1,600.6	326.0	271.6	54.40	5.993		
9,600.0	7,803.0	7,915.3	7,834.0	47.9	19.7	85.72	2,240.6	1,600.6	230.5	174.3	56.13	4.106		
9,700.0	7,803.0	7,917.5	7,836.3	49.2	19.7	87.35	2,240.7	1,600.6	141.1	83.3	57.84	2.439		
9,800.0	7,803.0	7,919.8	7,838.6	50.6	19.7	88.97	2,240.7	1,600.6	81.8	22.3	59.52	1.375 Level 3		
9,816.1	7,803.0	7,920.2	7,838.9	50.8	19.7	89.23	2,240.7	1,600.7	80.2	20.4	59.79	1.342 Level 3, CC, ES, SF		
9,900.0	7,803.0	7,922.1	7,840.8	52.0	19.7	90.59	2,240.8	1,600.7	116.1	54.9	61.17	1.897		
10,000.0	7,803.0	7,924.3	7,843.1	53.5	19.7	92.20	2,240.8	1,600.7	200.6	137.8	62.78	3.195		
10,100.0	7,803.0	7,926.6	7,845.3	54.9	19.7	93.80	2,240.9	1,600.7	294.9	230.6	64.36	4.583		
10,200.0	7,803.0	7,928.8	7,847.6	56.4	19.7	95.38	2,240.9	1,600.8	392.1	326.2	65.89	5.951		
10,300.0	7,803.0	7,931.1	7,849.8	57.9	19.7	96.95	2,241.0	1,600.8	490.4	423.0	67.37	7.278		

Cathedral Energy Services

Anticollision Report

Company:	EnCana Oil & Gas (USA) Inc	Local Co-ordinate Reference:	Well Woolley-Becky 2G-7H-E168
Project:	DJ Wattenberg	TVD Reference:	WELL @ 5022.0ft (Original Well Elev)
Reference Site:	S7-T1N-R68W (Woolley-Sosa/Becky)	MD Reference:	WELL @ 5022.0ft (Original Well Elev)
Site Error:	0.0ft	North Reference:	True
Reference Well:	Woolley-Becky 2G-7H-E168	Survey Calculation Method:	Minimum Curvature
Well Error:	0.0ft	Output errors are at	2.00 sigma
Reference Wellbore	Hz	Database:	USA EDM 5000 Multi Users DB
Reference Design:	Plan #1	Offset TVD Reference:	Offset Datum

Offset Design S7-T1N-R68W (Woolley-Sosa/Becky) - Woolley-Becky 2A-7H-E168 - Hz - Plan #1												Offset Site Error: 0.0 ft		
Survey Program: 0-Geolink MWD												Offset Well Error: 0.0 ft		
Reference		Offset		Semi Major Axis			Distance							Warning
Measured Depth	Vertical Depth	Measured Depth	Vertical Depth	Reference	Offset	Highside Toolface	Offset Wellbore Centre	Between Centres	Between Ellipses	Total Uncertainty	Separation			
(ft)	(ft)	(ft)	(ft)	(ft)	(ft)	(°)	+N/-S (ft)	+E/-W (ft)	(ft)	(ft)	Axis	Factor		
0.0	0.0	0.0	0.0	0.0	0.0	-90.00	0.0	-39.2	39.2					
100.0	100.0	98.0	98.0	0.1	0.1	-90.00	0.0	-39.2	39.2	38.9	0.26	151.181		
200.0	200.0	198.0	198.0	0.3	0.3	-90.00	0.0	-39.2	39.2	38.6	0.61	64.512	CC, ES	
300.0	300.0	297.4	297.4	0.5	0.5	169.46	-0.4	-39.9	40.1	39.2	0.96	41.985		
400.0	400.0	396.7	396.6	0.7	0.7	168.24	-1.7	-42.1	44.1	42.8	1.30	33.794		
500.0	499.9	495.7	495.6	0.8	0.8	166.75	-3.8	-45.8	51.3	49.6	1.65	31.013		
600.0	599.8	594.3	593.9	1.0	1.0	165.34	-6.8	-50.9	61.8	59.8	2.00	30.813	SF	
700.0	699.5	693.3	692.8	1.2	1.2	164.96	-9.5	-57.0	74.8	72.5	2.35	31.793		
800.0	799.2	792.2	791.4	1.5	1.4	166.07	-10.5	-63.2	89.6	86.9	2.70	33.195		
900.0	898.6	890.8	889.8	1.7	1.6	167.48	-10.7	-69.5	106.1	103.1	3.04	34.865		
1,000.0	997.9	989.1	987.9	2.0	1.8	168.66	-11.0	-75.8	124.3	121.0	3.39	36.721		
1,100.0	1,096.9	1,087.0	1,085.7	2.2	2.0	169.66	-11.3	-82.0	144.3	140.6	3.73	38.714		
1,200.0	1,195.7	1,184.6	1,183.1	2.6	2.2	170.50	-11.5	-88.3	166.0	161.9	4.07	40.814		
1,300.0	1,294.1	1,281.8	1,280.1	2.9	2.4	171.23	-11.8	-94.5	189.4	185.0	4.41	42.999		
1,400.0	1,392.3	1,378.6	1,376.6	3.3	2.6	171.86	-12.0	-100.7	214.5	209.8	4.74	45.252		
1,500.0	1,490.1	1,474.9	1,472.7	3.6	2.8	172.40	-12.3	-106.8	241.3	236.2	5.07	47.564		
1,600.0	1,587.5	1,570.7	1,568.4	4.1	3.0	172.88	-12.6	-112.9	269.8	264.4	5.40	49.926		
1,700.0	1,684.6	1,666.0	1,663.5	4.5	3.2	173.30	-12.8	-119.0	300.0	294.2	5.73	52.333		
1,800.0	1,781.2	1,760.8	1,758.1	5.0	3.4	173.67	-13.1	-125.1	331.8	325.7	6.06	54.781		
1,900.0	1,877.4	1,855.1	1,852.2	5.5	3.6	175.89	-13.3	-131.1	365.0	358.6	6.38	57.174		
2,000.0	1,973.5	1,949.3	1,946.2	6.0	3.8	179.79	-13.6	-137.1	398.5	391.8	6.72	59.333		
2,100.0	2,069.7	2,043.5	2,040.2	6.5	4.0	-176.56	-13.8	-143.1	432.0	424.9	7.05	61.300		
2,200.0	2,165.8	2,137.7	2,134.2	7.0	4.2	-173.88	-14.1	-149.1	465.4	458.1	7.38	63.093		
2,300.0	2,261.9	2,231.9	2,228.2	7.5	4.4	-174.30	-14.3	-155.2	498.9	491.2	7.71	64.717		

Cathedral Energy Services

Anticollision Report

Company:	EnCana Oil & Gas (USA) Inc	Local Co-ordinate Reference:	Well Woolley-Becky 2G-7H-E168
Project:	DJ Wattenberg	TVD Reference:	WELL @ 5022.0ft (Original Well Elev)
Reference Site:	S7-T1N-R68W (Woolley-Sosa/Becky)	MD Reference:	WELL @ 5022.0ft (Original Well Elev)
Site Error:	0.0ft	North Reference:	True
Reference Well:	Woolley-Becky 2G-7H-E168	Survey Calculation Method:	Minimum Curvature
Well Error:	0.0ft	Output errors are at	2.00 sigma
Reference Wellbore	Hz	Database:	USA EDM 5000 Multi Users DB
Reference Design:	Plan #1	Offset TVD Reference:	Offset Datum

Offset Design S7-T1N-R68W (Woolley-Sosa/Becky) - Woolley-Becky 2B-7H-E168 - Hz - Plan #1													Offset Site Error: 0.0 ft	
Survey Program: 0-Geolink MWD													Offset Well Error: 0.0 ft	
Reference		Offset		Semi Major Axis			Distance							Warning
Measured Depth	Vertical Depth	Measured Depth	Vertical Depth	Reference	Offset	Highside Toolface	Offset Wellbore Centre	Between Centres	Between Ellipses	Total Uncertainty Axis	Separation Factor			
(ft)	(ft)	(ft)	(ft)	(ft)	(ft)	(°)	+N/-S (ft)	+E/-W (ft)	(ft)	(ft)				
0.0	0.0	0.0	0.0	0.0	0.0	-77.76	7.3	-33.6	34.4					
100.0	100.0	98.0	98.0	0.1	0.1	-77.76	7.3	-33.6	34.4	34.1	0.26	132.597		
200.0	200.0	198.0	198.0	0.3	0.3	-77.76	7.3	-33.6	34.4	33.8	0.61	56.582	CC	
227.8	227.8	225.8	225.8	0.4	0.4	-177.76	7.3	-33.6	34.4	33.7	0.70	48.839		
300.0	300.0	298.0	298.0	0.5	0.5	-177.77	7.3	-33.6	34.6	33.6	0.96	36.161	ES	
400.0	400.0	397.7	397.7	0.7	0.7	-179.03	6.6	-34.1	36.7	35.4	1.31	28.138		
500.0	499.9	497.2	497.2	0.8	0.8	177.79	4.7	-35.8	41.5	39.9	1.66	25.080		
600.0	599.8	596.4	596.3	1.0	1.0	173.79	1.4	-38.5	49.2	47.2	2.01	24.468	SF	
700.0	699.5	696.3	696.1	1.2	1.2	171.10	-1.9	-41.5	58.9	56.5	2.36	24.934		
800.0	799.2	796.3	796.0	1.5	1.4	170.66	-3.7	-43.5	69.5	66.8	2.71	25.653		
900.0	898.6	896.0	895.7	1.7	1.5	171.53	-4.1	-44.8	81.1	78.0	3.06	26.539		
1,000.0	997.9	995.1	994.8	2.0	1.7	172.49	-4.3	-45.9	94.2	90.8	3.40	27.727		
1,100.0	1,096.9	1,094.0	1,093.7	2.2	1.9	173.32	-4.5	-46.9	109.1	105.4	3.74	29.173		
1,200.0	1,195.7	1,192.6	1,192.3	2.6	2.1	174.03	-4.6	-48.0	125.7	121.7	4.08	30.813		
1,300.0	1,294.1	1,290.9	1,290.6	2.9	2.2	174.63	-4.8	-49.1	144.1	139.7	4.42	32.605		
1,400.0	1,392.3	1,388.8	1,388.5	3.3	2.4	175.15	-4.9	-50.2	164.1	159.4	4.76	34.519		
1,500.0	1,490.1	1,486.4	1,486.1	3.6	2.6	175.60	-5.1	-51.2	185.9	180.8	5.09	36.532		
1,600.0	1,587.5	1,583.6	1,583.3	4.1	2.8	175.98	-5.2	-52.3	209.4	204.0	5.42	38.628		
1,700.0	1,684.6	1,680.4	1,680.1	4.5	2.9	176.31	-5.4	-53.4	234.6	228.8	5.75	40.795		
1,800.0	1,781.2	1,776.7	1,776.4	5.0	3.1	176.60	-5.6	-54.4	261.4	255.4	6.08	43.024		
1,900.0	1,877.4	1,872.6	1,872.3	5.5	3.3	178.70	-5.7	-55.5	289.8	283.4	6.41	45.219		
2,000.0	1,973.5	1,968.5	1,968.1	6.0	3.4	-177.61	-5.9	-56.5	318.2	311.5	6.75	47.174		
2,100.0	2,069.7	2,064.3	2,064.0	6.5	3.6	-174.20	-6.0	-57.6	346.6	339.5	7.08	48.930		
2,200.0	2,165.8	2,160.2	2,159.8	7.0	3.8	-171.77	-6.2	-58.6	375.0	367.5	7.42	50.518		
2,300.0	2,261.9	2,256.0	2,255.6	7.5	3.9	-172.37	-6.3	-59.6	403.3	395.6	7.76	51.969		
2,400.0	2,358.1	2,351.8	2,351.4	8.0	4.1	-172.89	-6.5	-60.7	431.7	423.6	8.10	53.302		
2,500.0	2,454.2	2,447.6	2,447.2	8.5	4.3	-173.34	-6.6	-61.7	460.1	451.7	8.44	54.531		
2,600.0	2,550.3	2,543.4	2,543.0	9.1	4.4	-173.75	-6.8	-62.8	488.6	479.8	8.78	55.668		

Cathedral Energy Services

Anticollision Report

Company:	EnCana Oil & Gas (USA) Inc	Local Co-ordinate Reference:	Well Woolley-Becky 2G-7H-E168
Project:	DJ Wattenberg	TVD Reference:	WELL @ 5022.0ft (Original Well Elev)
Reference Site:	S7-T1N-R68W (Woolley-Sosa/Becky)	MD Reference:	WELL @ 5022.0ft (Original Well Elev)
Site Error:	0.0ft	North Reference:	True
Reference Well:	Woolley-Becky 2G-7H-E168	Survey Calculation Method:	Minimum Curvature
Well Error:	0.0ft	Output errors are at	2.00 sigma
Reference Wellbore	Hz	Database:	USA EDM 5000 Multi Users DB
Reference Design:	Plan #1	Offset TVD Reference:	Offset Datum

Offset Design S7-T1N-R68W (Woolley-Sosa/Becky) - Woolley-Becky 2C-7H-E168 - Hz - Plan #1												Offset Site Error: 0.0 ft	
Survey Program: 0-Geolink MWD												Offset Well Error: 0.0 ft	
Reference		Offset		Semi Major Axis			Distance						Warning
Measured Depth	Vertical Depth	Measured Depth	Vertical Depth	Reference	Offset	Highside Toolface	Offset Wellbore Centre		Between Centres	Between Ellipses	Total Uncertainty	Separation	
(ft)	(ft)	(ft)	(ft)	(ft)	(ft)	(°)	+N/-S (ft)	+E/-W (ft)	(ft)	(ft)	Axis	Factor	
0.0	0.0	0.0	0.0	0.0	0.0	-90.00	0.0	-30.8	30.8				
100.0	100.0	99.0	99.0	0.1	0.1	-90.00	0.0	-30.8	30.8	30.5	0.26	118.188	
200.0	200.0	199.0	199.0	0.3	0.3	-90.00	0.0	-30.8	30.8	30.2	0.61	50.543 CC	
227.8	227.8	226.8	226.8	0.4	0.4	170.01	0.0	-30.8	30.8	30.1	0.71	43.647	
300.0	300.0	299.0	299.0	0.5	0.5	170.07	0.0	-30.8	31.0	30.0	0.96	32.355 ES	
400.0	400.0	399.0	399.0	0.7	0.7	170.59	0.0	-30.8	32.7	31.4	1.31	25.035	
500.0	499.9	498.9	498.9	0.8	0.8	171.49	0.0	-30.8	36.2	34.5	1.66	21.847	
600.0	599.8	598.8	598.8	1.0	1.0	172.56	0.0	-30.8	41.4	39.3	2.00	20.639	
700.0	699.5	699.4	699.4	1.2	1.2	173.65	0.0	-29.9	47.4	45.1	2.35	20.160	
800.0	799.2	800.1	800.0	1.5	1.4	174.75	-0.2	-27.3	53.5	50.8	2.70	19.805	
900.0	898.6	900.9	900.7	1.7	1.5	175.84	-0.3	-22.9	59.6	56.5	3.05	19.535 SF	
1,000.0	997.9	1,000.7	1,000.4	2.0	1.7	176.87	-0.6	-17.5	66.4	63.0	3.39	19.549	
1,100.0	1,096.9	1,100.3	1,099.9	2.2	1.9	177.77	-0.8	-12.1	74.9	71.2	3.74	20.035	
1,200.0	1,195.7	1,199.8	1,199.2	2.6	2.1	178.51	-1.0	-6.8	85.2	81.1	4.08	20.874	
1,300.0	1,294.1	1,299.1	1,298.4	2.9	2.3	179.11	-1.3	-1.4	97.3	92.8	4.42	21.984	
1,400.0	1,392.3	1,398.1	1,397.3	3.3	2.5	179.58	-1.5	3.9	111.0	106.3	4.76	23.307	
1,500.0	1,490.1	1,496.9	1,495.9	3.6	2.7	179.95	-1.7	9.3	126.6	121.4	5.10	24.801	
1,600.0	1,587.5	1,595.4	1,594.2	4.1	2.9	-179.76	-2.0	14.6	143.8	138.4	5.44	26.435	
1,700.0	1,684.6	1,693.6	1,692.3	4.5	3.1	-179.54	-2.2	19.9	162.8	157.0	5.77	28.186	
1,800.0	1,781.2	1,791.4	1,790.0	5.0	3.2	-179.37	-2.4	25.2	183.4	177.3	6.11	30.036	
1,900.0	1,877.4	1,888.9	1,887.4	5.5	3.4	-177.45	-2.7	30.5	205.6	199.1	6.45	31.890	
2,000.0	1,973.5	1,986.4	1,984.7	6.0	3.6	-174.06	-2.9	35.7	227.8	221.0	6.79	33.525	
2,100.0	2,069.7	2,083.9	2,082.1	6.5	3.8	-171.02	-3.1	41.0	249.8	242.6	7.14	34.978	
2,200.0	2,165.8	2,181.4	2,179.4	7.0	4.0	-168.98	-3.3	46.2	271.7	264.2	7.49	36.289	
2,300.0	2,261.9	2,278.9	2,276.7	7.5	4.2	-169.90	-3.6	51.5	293.6	285.7	7.83	37.501	
2,400.0	2,358.1	2,376.4	2,374.1	8.0	4.4	-170.68	-3.8	56.8	315.5	307.4	8.17	38.617	
2,500.0	2,454.2	2,473.8	2,471.4	8.5	4.6	-171.37	-4.0	62.0	337.6	329.1	8.51	39.649	
2,600.0	2,550.3	2,571.3	2,568.7	9.1	4.8	-171.97	-4.3	67.3	359.6	350.8	8.86	40.605	
2,700.0	2,646.4	2,668.8	2,666.1	9.6	5.0	-172.50	-4.5	72.6	381.7	372.5	9.20	41.492	
2,800.0	2,742.6	2,766.2	2,763.4	10.1	5.2	-172.97	-4.7	77.8	403.8	394.3	9.54	42.319	
2,900.0	2,838.7	2,863.7	2,860.7	10.6	5.4	-173.40	-4.9	83.1	426.0	416.1	9.89	43.090	
3,000.0	2,934.8	2,961.2	2,958.0	11.1	5.6	-173.78	-5.2	88.4	448.2	437.9	10.23	43.811	
3,100.0	3,031.0	3,058.7	3,055.4	11.7	5.7	-174.13	-5.4	93.6	470.3	459.8	10.57	44.486	
3,200.0	3,127.1	3,156.1	3,152.7	12.2	5.9	-174.12	-5.6	98.9	492.5	481.6	10.92	45.101	

Cathedral Energy Services

Anticollision Report

Company:	EnCana Oil & Gas (USA) Inc	Local Co-ordinate Reference:	Well Woolley-Becky 2G-7H-E168
Project:	DJ Wattenberg	TVD Reference:	WELL @ 5022.0ft (Original Well Elev)
Reference Site:	S7-T1N-R68W (Woolley-Sosa/Becky)	MD Reference:	WELL @ 5022.0ft (Original Well Elev)
Site Error:	0.0ft	North Reference:	True
Reference Well:	Woolley-Becky 2G-7H-E168	Survey Calculation Method:	Minimum Curvature
Well Error:	0.0ft	Output errors are at	2.00 sigma
Reference Wellbore	Hz	Database:	USA EDM 5000 Multi Users DB
Reference Design:	Plan #1	Offset TVD Reference:	Offset Datum

Offset Design S7-T1N-R68W (Woolley-Sosa/Becky) - Woolley-Becky 2D-7H-E168 - Hz - Plan #1													Offset Site Error: 0.0 ft	
Survey Program: 0-Geolink MWD													Offset Well Error: 0.0 ft	
Reference		Offset		Semi Major Axis			Distance							Warning
Measured Depth	Vertical Depth	Measured Depth	Vertical Depth	Reference	Offset	Highside Toolface	Offset Wellbore Centre		Between Centres	Between Ellipses	Total Uncertainty	Separation		
(ft)	(ft)	(ft)	(ft)	(ft)	(ft)	(°)	+N/-S (ft)	+E/-W (ft)	(ft)	(ft)	Axis	Factor		
0.0	0.0	0.0	0.0	0.0	0.0	-73.87	7.3	-25.2	26.2					
100.0	100.0	99.0	99.0	0.1	0.1	-73.87	7.3	-25.2	26.2	26.0	0.26	100.663		
200.0	200.0	199.0	199.0	0.3	0.3	-73.87	7.3	-25.2	26.2	25.6	0.61	43.048	CC	
227.8	227.8	226.8	226.8	0.4	0.4	-173.88	7.3	-25.2	26.3	25.5	0.71	37.183		
300.0	300.0	299.0	299.0	0.5	0.5	-173.92	7.3	-25.2	26.4	25.5	0.96	27.593	ES	
400.0	400.0	399.0	399.0	0.7	0.7	-174.29	7.3	-25.2	28.2	26.9	1.31	21.557		
500.0	499.9	498.9	498.9	0.8	0.8	-174.92	7.3	-25.2	31.6	30.0	1.66	19.118		
600.0	599.8	599.4	599.4	1.0	1.0	-175.31	7.3	-24.3	36.0	34.0	2.00	17.977		
700.0	699.5	699.9	699.9	1.2	1.2	-175.20	7.3	-21.7	40.5	38.1	2.35	17.191		
800.0	799.2	800.6	800.4	1.5	1.4	-174.75	7.2	-17.3	44.9	42.2	2.70	16.620		
900.0	898.6	901.3	900.9	1.7	1.6	-174.04	7.2	-11.1	49.4	46.4	3.05	16.189		
1,000.0	997.9	1,001.9	1,001.3	2.0	1.8	-173.14	7.1	-3.2	54.0	50.6	3.41	15.861	SF	
1,100.0	1,096.9	1,101.7	1,100.7	2.2	2.0	-172.44	7.0	5.2	59.7	56.0	3.76	15.899		
1,200.0	1,195.7	1,201.4	1,200.1	2.6	2.2	-172.06	7.0	13.7	67.2	63.1	4.11	16.352		
1,300.0	1,294.1	1,301.0	1,299.3	2.9	2.4	-171.95	6.9	22.1	76.4	71.9	4.46	17.122		
1,400.0	1,392.3	1,400.4	1,398.3	3.3	2.6	-172.01	6.8	30.5	87.3	82.5	4.81	18.142		
1,500.0	1,490.1	1,499.6	1,497.2	3.6	2.8	-172.20	6.8	38.9	99.9	94.7	5.16	19.362		
1,600.0	1,587.5	1,598.6	1,595.8	4.1	3.1	-172.45	6.7	47.3	114.2	108.7	5.51	20.748		
1,700.0	1,684.6	1,697.3	1,694.1	4.5	3.3	-172.75	6.6	55.7	130.3	124.4	5.85	22.272		
1,800.0	1,781.2	1,795.7	1,792.2	5.0	3.5	-173.05	6.6	64.0	148.0	141.8	6.19	23.912		
1,900.0	1,877.4	1,893.8	1,890.0	5.5	3.7	-171.60	6.5	72.3	167.2	160.7	6.54	25.574		
2,000.0	1,973.5	1,992.0	1,987.8	6.0	3.9	-168.69	6.4	80.6	186.3	179.5	6.90	27.025		
2,100.0	2,069.7	2,090.1	2,085.5	6.5	4.2	-166.13	6.4	89.0	205.2	197.9	7.25	28.311		
2,200.0	2,165.8	2,188.2	2,183.3	7.0	4.4	-164.56	6.3	97.3	223.8	216.2	7.59	29.475		
2,300.0	2,261.9	2,286.3	2,281.1	7.5	4.6	-165.86	6.3	105.6	242.4	234.5	7.93	30.571		
2,400.0	2,358.1	2,384.4	2,378.8	8.0	4.8	-166.97	6.2	113.9	261.1	252.8	8.27	31.585		
2,500.0	2,454.2	2,482.6	2,476.6	8.5	5.0	-167.93	6.1	122.2	279.9	271.3	8.61	32.526		
2,600.0	2,550.3	2,580.7	2,574.4	9.1	5.3	-168.78	6.1	130.5	298.8	289.8	8.95	33.400		
2,700.0	2,646.4	2,678.8	2,672.1	9.6	5.5	-169.52	6.0	138.8	317.7	308.4	9.29	34.214		
2,800.0	2,742.6	2,776.9	2,769.9	10.1	5.7	-170.18	5.9	147.1	336.7	327.1	9.63	34.973		
2,900.0	2,838.7	2,875.0	2,867.6	10.6	5.9	-170.77	5.9	155.5	355.7	345.7	9.97	35.682		
3,000.0	2,934.8	2,973.1	2,965.4	11.1	6.2	-171.29	5.8	163.8	374.8	364.4	10.31	36.346		
3,100.0	3,031.0	3,071.2	3,063.2	11.7	6.4	-171.77	5.7	172.1	393.8	383.2	10.65	36.969		
3,200.0	3,127.1	3,169.4	3,160.9	12.2	6.6	-171.89	5.7	180.4	412.9	401.9	11.00	37.538		
3,300.0	3,223.5	3,267.7	3,258.9	12.7	6.8	-170.61	5.6	188.7	430.9	419.5	11.36	37.929		
3,400.0	3,320.3	3,366.3	3,357.1	13.1	7.1	-169.17	5.5	197.1	447.3	435.5	11.72	38.166		
3,500.0	3,417.5	3,465.1	3,455.6	13.6	7.3	-167.53	5.5	205.4	462.0	450.0	12.08	38.263		
3,600.0	3,515.0	3,564.1	3,554.2	14.0	7.5	-165.63	5.4	213.8	475.2	462.8	12.43	38.233		
3,700.0	3,612.9	3,663.3	3,653.1	14.4	7.7	-163.43	5.3	222.2	486.9	474.1	12.78	38.087		
3,800.0	3,710.8	3,762.5	3,752.0	14.8	8.0	-163.99	5.3	230.7	497.7	484.6	13.13	37.915		

Cathedral Energy Services

Anticollision Report

Company:	EnCana Oil & Gas (USA) Inc	Local Co-ordinate Reference:	Well Woolley-Becky 2G-7H-E168
Project:	DJ Wattenberg	TVD Reference:	WELL @ 5022.0ft (Original Well Elev)
Reference Site:	S7-T1N-R68W (Woolley-Sosa/Becky)	MD Reference:	WELL @ 5022.0ft (Original Well Elev)
Site Error:	0.0ft	North Reference:	True
Reference Well:	Woolley-Becky 2G-7H-E168	Survey Calculation Method:	Minimum Curvature
Well Error:	0.0ft	Output errors are at	2.00 sigma
Reference Wellbore	Hz	Database:	USA EDM 5000 Multi Users DB
Reference Design:	Plan #1	Offset TVD Reference:	Offset Datum

Offset Design S7-T1N-R68W (Woolley-Sosa/Becky) - Woolley-Becky 2E-7H-E168 - Hz - Plan #1														Offset Site Error:	0.0 ft
Survey Program: O-Geolink MWD														Offset Well Error:	0.0 ft
Reference		Offset		Semi Major Axis		Distance									
Measured Depth (ft)	Vertical Depth (ft)	Measured Depth (ft)	Vertical Depth (ft)	Reference (ft)	Offset (ft)	Highside Toolface (°)	Offset Wellbore Centre +N/-S (ft)	+E/-W (ft)	Between Centres (ft)	Between Ellipses (ft)	Total Uncertainty Axis	Separation Factor	Warning		
0.0	0.0	0.0	0.0	0.0	0.0	-90.00	0.0	-8.4	8.5						
100.0	100.0	99.0	99.0	0.1	0.1	-90.00	0.0	-8.4	8.4	8.1	0.26	32.233			
200.0	200.0	199.0	199.0	0.3	0.3	-90.00	0.0	-8.4	8.4	7.8	0.61	13.784	CC		
227.8	227.8	226.8	226.8	0.4	0.4	170.04	0.0	-8.4	8.4	7.7	0.71	11.937			
300.0	300.0	299.0	299.0	0.5	0.5	170.25	0.0	-8.4	8.6	7.7	0.96	8.987	ES		
400.0	400.0	399.0	399.0	0.7	0.7	171.89	0.0	-8.4	10.3	9.0	1.31	7.908			
500.0	499.9	499.1	499.1	0.8	0.8	174.16	0.0	-7.5	12.9	11.3	1.66	7.818			
600.0	599.8	599.4	599.3	1.0	1.0	176.73	0.0	-4.9	15.6	13.6	2.00	7.767			
700.0	699.5	699.6	699.5	1.2	1.2	179.47	-0.1	-0.6	18.2	15.9	2.35	7.748	SF		
800.0	799.2	799.9	799.6	1.5	1.4	-177.71	-0.1	5.6	21.0	18.2	2.70	7.753			
900.0	898.6	900.2	899.6	1.7	1.6	-174.85	-0.2	13.4	23.8	20.7	3.05	7.777			
1,000.0	997.9	1,000.6	999.5	2.0	1.8	-171.99	-0.3	23.1	26.7	23.2	3.41	7.813			
1,100.0	1,096.9	1,101.0	1,099.3	2.2	2.1	-169.15	-0.4	34.4	29.7	25.9	3.78	7.852			
1,200.0	1,195.7	1,201.1	1,198.6	2.6	2.3	-166.62	-0.5	47.1	33.2	29.0	4.16	7.980			
1,300.0	1,294.1	1,301.0	1,297.6	2.9	2.6	-165.22	-0.6	59.9	38.4	33.8	4.55	8.442			
1,400.0	1,392.3	1,400.7	1,396.6	3.3	2.8	-164.74	-0.8	72.7	45.2	40.3	4.93	9.178			
1,500.0	1,490.1	1,500.4	1,495.4	3.6	3.1	-164.88	-0.9	85.4	53.8	48.5	5.31	10.135			
1,600.0	1,587.5	1,599.9	1,594.0	4.1	3.4	-165.38	-1.0	98.1	64.0	58.3	5.68	11.274			
1,700.0	1,684.6	1,699.1	1,692.5	4.5	3.7	-166.06	-1.1	110.8	75.9	69.9	6.04	12.566			
1,800.0	1,781.2	1,798.2	1,790.7	5.0	3.9	-166.80	-1.2	123.5	89.5	83.1	6.40	13.989			
1,900.0	1,877.4	1,897.1	1,888.8	5.5	4.2	-165.84	-1.3	136.1	104.6	97.8	6.76	15.462			
2,000.0	1,973.5	1,995.9	1,986.8	6.0	4.5	-163.58	-1.5	148.7	119.4	112.3	7.12	16.766			
2,100.0	2,069.7	2,094.8	2,084.9	6.5	4.8	-161.74	-1.6	161.4	133.8	126.3	7.46	17.933			
2,200.0	2,165.8	2,193.7	2,183.0	7.0	5.0	-160.93	-1.7	174.0	147.9	140.1	7.78	19.005			
2,300.0	2,261.9	2,292.5	2,281.0	7.5	5.3	-162.86	-1.8	186.7	162.0	153.9	8.09	20.020			
2,400.0	2,358.1	2,391.4	2,379.0	8.0	5.6	-164.47	-1.9	199.3	176.4	167.9	8.41	20.962			
2,500.0	2,454.2	2,490.2	2,477.1	8.5	5.9	-165.85	-2.1	211.9	190.8	182.0	8.74	21.837			
2,600.0	2,550.3	2,589.1	2,575.1	9.1	6.1	-167.03	-2.2	224.6	205.3	196.2	9.06	22.651			
2,700.0	2,646.4	2,687.9	2,673.2	9.6	6.4	-168.05	-2.3	237.2	219.9	210.5	9.39	23.408			
2,800.0	2,742.6	2,786.8	2,771.2	10.1	6.7	-168.95	-2.4	249.9	234.5	224.8	9.73	24.114			
2,900.0	2,838.7	2,885.7	2,869.3	10.6	7.0	-169.74	-2.5	262.5	249.3	239.2	10.06	24.774			
3,000.0	2,934.8	2,984.5	2,967.3	11.1	7.3	-170.44	-2.6	275.1	264.0	253.6	10.40	25.390			
3,100.0	3,031.0	3,083.4	3,065.4	11.7	7.5	-171.07	-2.8	287.8	278.8	268.0	10.74	25.968			
3,200.0	3,127.1	3,182.2	3,163.4	12.2	7.8	-171.32	-2.9	300.4	293.6	282.5	11.08	26.499			
3,300.0	3,223.5	3,281.3	3,261.6	12.7	8.1	-170.20	-3.0	313.1	307.2	295.8	11.43	26.874			
3,400.0	3,320.3	3,380.5	3,360.0	13.1	8.4	-168.92	-3.1	325.7	319.3	307.5	11.79	27.096			
3,500.0	3,417.5	3,479.8	3,458.6	13.6	8.7	-167.45	-3.2	338.5	329.8	317.7	12.13	27.179			
3,600.0	3,515.0	3,579.3	3,557.3	14.0	8.9	-165.75	-3.4	351.2	338.7	326.2	12.48	27.134			
3,700.0	3,612.9	3,679.0	3,656.1	14.4	9.2	-163.77	-3.5	363.9	346.0	333.2	12.83	26.973			
3,800.0	3,710.8	3,778.6	3,754.9	14.8	9.5	-164.55	-3.6	376.6	352.6	339.4	13.17	26.772			
3,900.0	3,808.8	3,878.3	3,853.7	15.1	9.8	-165.36	-3.7	389.4	359.2	345.7	13.51	26.582			
4,000.0	3,906.8	3,977.9	3,952.6	15.5	10.1	-166.13	-3.8	402.1	365.9	352.0	13.86	26.400			
4,100.0	4,004.8	4,077.6	4,051.4	15.9	10.3	-166.88	-3.9	414.9	372.7	358.5	14.21	26.227			
4,200.0	4,102.8	4,177.2	4,150.2	16.3	10.6	-167.60	-4.1	427.6	379.5	364.9	14.56	26.061			
4,300.0	4,200.7	4,276.9	4,249.1	16.7	10.9	-168.29	-4.2	440.4	386.4	371.4	14.92	25.902			
4,400.0	4,298.7	4,376.5	4,347.9	17.1	11.2	-168.96	-4.3	453.1	393.3	378.0	15.27	25.750			
4,500.0	4,396.7	4,476.2	4,446.8	17.5	11.5	-169.61	-4.4	465.8	400.3	384.6	15.63	25.603			
4,600.0	4,494.7	4,575.9	4,545.6	17.9	11.8	-170.23	-4.5	478.6	407.3	391.3	16.00	25.462			
4,700.0	4,592.6	4,675.5	4,644.4	18.2	12.0	-170.83	-4.7	491.3	414.4	398.0	16.36	25.326			
4,800.0	4,690.6	4,775.2	4,743.3	18.6	12.3	-171.42	-4.8	504.1	421.5	404.8	16.73	25.195			
4,900.0	4,788.6	4,874.8	4,842.1	19.0	12.6	-171.98	-4.9	516.8	428.7	411.6	17.10	25.069			
5,000.0	4,886.6	4,974.5	4,941.0	19.4	12.9	-172.52	-5.0	529.5	435.9	418.4	17.47	24.947			

CC - Min centre to center distance or convergent point, SF - min separation factor, ES - min ellipse separation

Cathedral Energy Services

Anticollision Report

Company:	EnCana Oil & Gas (USA) Inc	Local Co-ordinate Reference:	Well Woolley-Becky 2G-7H-E168
Project:	DJ Wattenberg	TVD Reference:	WELL @ 5022.0ft (Original Well Elev)
Reference Site:	S7-T1N-R68W (Woolley-Sosa/Becky)	MD Reference:	WELL @ 5022.0ft (Original Well Elev)
Site Error:	0.0ft	North Reference:	True
Reference Well:	Woolley-Becky 2G-7H-E168	Survey Calculation Method:	Minimum Curvature
Well Error:	0.0ft	Output errors are at	2.00 sigma
Reference Wellbore	Hz	Database:	USA EDM 5000 Multi Users DB
Reference Design:	Plan #1	Offset TVD Reference:	Offset Datum

Offset Design													S7-T1N-R68W (Woolley-Sosa/Becky) - Woolley-Becky 2E-7H-E168 - Hz - Plan #1		Offset Site Error:		0.0 ft	
Survey Program:													0-Geolink MWD		Offset Well Error:		0.0 ft	
Reference				Offset			Semi Major Axis			Distance						Warning		
Measured Depth	Vertical Depth	Measured Depth	Vertical Depth	Reference	Offset	Highside Toolface	Offset Wellbore Centre		Between Centres	Between Ellipses	Total Uncertainty Axis	Separation Factor						
(ft)	(ft)	(ft)	(ft)	(ft)	(ft)	(°)	+N/-S (ft)	+E/-W (ft)	(ft)	(ft)								
5,100.0	4,984.6	5,074.1	5,039.8	19.8	13.2	-173.05	-5.1	542.3	443.1	425.3	17.85	24.829						
5,200.0	5,082.5	5,173.8	5,138.6	20.2	13.5	-173.56	-5.3	555.0	450.4	432.2	18.22	24.715						
5,300.0	5,180.5	5,273.4	5,237.5	20.6	13.7	-174.05	-5.4	567.8	457.7	439.1	18.60	24.604						
5,400.0	5,278.5	5,373.1	5,336.3	21.0	14.0	-174.53	-5.5	580.5	465.1	446.1	18.98	24.497						
5,500.0	5,376.5	5,472.8	5,435.1	21.4	14.3	-175.00	-5.6	593.2	472.4	453.1	19.37	24.394						
5,600.0	5,474.5	5,572.4	5,534.0	21.8	14.6	-175.44	-5.7	606.0	479.8	460.1	19.75	24.293						
5,700.0	5,572.4	5,672.1	5,632.8	22.1	14.9	-175.88	-5.8	618.7	487.3	467.1	20.14	24.196						
5,800.0	5,670.4	5,771.7	5,731.7	22.5	15.2	-176.30	-6.0	631.5	494.7	474.2	20.53	24.102						

Cathedral Energy Services

Anticollision Report

Company:	EnCana Oil & Gas (USA) Inc	Local Co-ordinate Reference:	Well Woolley-Becky 2G-7H-E168
Project:	DJ Wattenberg	TVD Reference:	WELL @ 5022.0ft (Original Well Elev)
Reference Site:	S7-T1N-R68W (Woolley-Sosa/Becky)	MD Reference:	WELL @ 5022.0ft (Original Well Elev)
Site Error:	0.0ft	North Reference:	True
Reference Well:	Woolley-Becky 2G-7H-E168	Survey Calculation Method:	Minimum Curvature
Well Error:	0.0ft	Output errors are at	2.00 sigma
Reference Wellbore	Hz	Database:	USA EDM 5000 Multi Users DB
Reference Design:	Plan #1	Offset TVD Reference:	Offset Datum

Offset Design S7-T1N-R68W (Woolley-Sosa/Becky) - Woolley-Becky 2F-7H-E168 - Hz - Plan #1													Offset Site Error: 0.0 ft	
Survey Program: 0-Geolink MWD													Offset Well Error: 0.0 ft	
Reference		Offset		Semi Major Axis			Distance							Warning
Measured Depth (ft)	Vertical Depth (ft)	Measured Depth (ft)	Vertical Depth (ft)	Reference (ft)	Offset (ft)	Highside Toolface (°)	Offset Wellbore Centre +N/-S (ft)	+E/-W (ft)	Between Centres (ft)	Between Ellipses (ft)	Total Uncertainty Axis	Separation Factor		
0.0	0.0	0.0	0.0	0.0	0.0	-37.54	7.3	-5.6	9.2					
100.0	100.0	100.0	100.0	0.1	0.1	-37.54	7.3	-5.6	9.2	8.9	0.26	35.094		
200.0	200.0	200.0	200.0	0.3	0.3	-37.54	7.3	-5.6	9.2	8.6	0.61	15.040 CC		
228.2	228.2	228.2	228.2	0.4	0.4	-137.68	7.3	-5.6	9.2	8.5	0.71	12.986		
300.0	300.0	300.0	300.0	0.5	0.5	-138.44	7.3	-5.6	9.3	8.4	0.96	9.740 ES		
400.0	400.0	400.1	400.1	0.7	0.7	-140.57	7.5	-4.7	10.3	9.0	1.31	7.831		
500.0	499.9	500.2	500.1	0.8	0.8	-140.24	8.0	-2.2	11.7	10.0	1.67	7.006		
600.0	599.8	600.2	600.1	1.0	1.0	-138.26	8.8	2.1	13.6	11.5	2.03	6.683		
700.0	699.5	700.3	700.0	1.2	1.2	-135.40	10.0	8.1	16.0	13.6	2.42	6.629		
800.0	799.2	800.4	799.8	1.5	1.4	-132.25	11.5	15.8	19.0	16.2	2.83	6.729		
900.0	898.6	900.4	899.3	1.7	1.7	-129.15	13.4	25.2	22.6	19.4	3.27	6.914		
1,000.0	997.9	1,000.5	998.7	2.0	1.9	-126.30	15.5	36.4	26.9	23.1	3.76	7.142		
1,100.0	1,096.9	1,100.5	1,097.9	2.2	2.2	-123.75	18.1	49.2	31.7	27.4	4.29	7.385		
1,200.0	1,195.7	1,200.4	1,196.7	2.6	2.5	-121.50	20.9	63.7	37.2	32.3	4.88	7.627		
1,300.0	1,294.1	1,300.3	1,295.3	2.9	2.8	-119.55	24.1	79.9	43.3	37.8	5.52	7.857		
1,400.0	1,392.3	1,400.2	1,393.5	3.3	3.1	-117.96	27.6	97.6	50.1	43.9	6.20	8.084		
1,500.0	1,490.1	1,499.9	1,491.4	3.6	3.5	-117.91	31.2	115.7	57.7	50.8	6.89	8.365		
1,600.0	1,587.5	1,599.5	1,589.4	4.1	3.8	-119.19	34.7	133.8	66.1	58.5	7.59	8.705		
1,700.0	1,684.6	1,699.1	1,687.2	4.5	4.2	-121.31	38.3	151.9	75.4	67.1	8.27	9.109		
1,800.0	1,781.2	1,798.4	1,784.8	5.0	4.5	-123.91	41.8	169.9	85.7	76.8	8.94	9.587		
1,900.0	1,877.4	1,897.7	1,882.4	5.5	4.9	-125.01	45.4	187.9	96.9	87.4	9.59	10.112		
2,000.0	1,973.5	1,997.1	1,980.0	6.0	5.3	-124.29	48.9	206.0	107.2	97.0	10.22	10.494		
2,100.0	2,069.7	2,096.5	2,077.7	6.5	5.6	-123.58	52.5	224.0	116.3	105.5	10.82	10.751		
2,200.0	2,165.8	2,196.0	2,175.5	7.0	6.0	-123.67	56.1	242.1	124.4	113.0	11.38	10.924		
2,300.0	2,261.9	2,295.5	2,273.3	7.5	6.3	-126.40	59.6	260.1	132.3	120.3	11.91	11.104		
2,400.0	2,358.1	2,395.0	2,371.1	8.0	6.7	-128.81	63.2	278.2	140.4	128.0	12.42	11.303		
2,500.0	2,454.2	2,494.5	2,468.9	8.5	7.1	-130.96	66.7	296.3	148.8	135.9	12.92	11.515		
2,600.0	2,550.3	2,594.0	2,566.6	9.1	7.4	-132.88	70.3	314.3	157.4	143.9	13.41	11.733		
2,700.0	2,646.4	2,693.5	2,664.4	9.6	7.8	-134.59	73.8	332.4	166.1	152.2	13.89	11.953		
2,800.0	2,742.6	2,793.0	2,762.2	10.1	8.2	-136.14	77.4	350.4	174.9	160.6	14.37	12.174		
2,900.0	2,838.7	2,892.5	2,860.0	10.6	8.5	-137.54	81.0	368.5	183.9	169.1	14.84	12.392		
3,000.0	2,934.8	2,992.0	2,957.8	11.1	8.9	-138.80	84.5	386.6	193.0	177.7	15.31	12.606		
3,100.0	3,031.0	3,091.5	3,055.6	11.7	9.3	-139.95	88.1	404.6	202.1	186.4	15.77	12.815		
3,200.0	3,127.1	3,191.0	3,153.3	12.2	9.6	-140.70	91.6	422.7	211.3	195.1	16.24	13.016		
3,300.0	3,223.5	3,290.6	3,251.2	12.7	10.0	-139.95	95.2	440.8	219.4	202.7	16.71	13.135		
3,400.0	3,320.3	3,390.3	3,349.3	13.1	10.4	-138.84	98.8	458.9	225.9	208.7	17.18	13.145		
3,500.0	3,417.5	3,490.2	3,447.4	13.6	10.7	-137.35	102.3	477.0	230.7	213.0	17.67	13.055		
3,600.0	3,515.0	3,590.1	3,545.6	14.0	11.1	-135.47	105.9	495.1	233.7	215.6	18.16	12.873		
3,700.0	3,612.9	3,690.1	3,643.8	14.4	11.5	-133.15	109.5	513.3	235.1	216.5	18.65	12.607		
3,800.0	3,710.8	3,790.1	3,742.1	14.8	11.8	-133.50	113.0	531.4	235.6	216.5	19.15	12.302		
3,900.0	3,808.8	3,890.1	3,840.4	15.1	12.2	-133.90	116.6	549.6	236.1	216.5	19.65	12.016		
4,000.0	3,906.8	3,990.1	3,938.6	15.5	12.6	-134.30	120.2	567.7	236.7	216.5	20.15	11.748		
4,100.0	4,004.8	4,090.0	4,036.9	15.9	13.0	-134.70	123.8	585.9	237.2	216.6	20.63	11.495		
4,200.0	4,102.8	4,190.0	4,135.1	16.3	13.3	-135.09	127.3	604.0	237.7	216.6	21.12	11.258		
4,300.0	4,200.7	4,290.0	4,233.4	16.7	13.7	-135.49	130.9	622.2	238.3	216.7	21.60	11.034		
4,400.0	4,298.7	4,390.0	4,331.7	17.1	14.1	-135.88	134.5	640.3	238.9	216.8	22.07	10.823		
4,500.0	4,396.7	4,490.0	4,429.9	17.5	14.4	-136.27	138.1	658.5	239.5	216.9	22.54	10.623		
4,600.0	4,494.7	4,590.0	4,528.2	17.9	14.8	-136.65	141.6	676.6	240.1	217.0	23.01	10.435		
4,700.0	4,592.6	4,690.0	4,626.4	18.2	15.2	-137.04	145.2	694.8	240.7	217.2	23.47	10.256		
4,800.0	4,690.6	4,789.9	4,724.7	18.6	15.5	-137.42	148.8	712.9	241.3	217.4	23.92	10.087		
4,900.0	4,788.6	4,889.9	4,823.0	19.0	15.9	-137.81	152.4	731.1	241.9	217.5	24.37	9.926		
5,000.0	4,886.6	4,989.9	4,921.2	19.4	16.3	-138.19	155.9	749.2	242.5	217.7	24.82	9.773		

CC - Min centre to center distance or convergent point, SF - min separation factor, ES - min ellipse separation

Cathedral Energy Services

Anticollision Report

Company:	EnCana Oil & Gas (USA) Inc	Local Co-ordinate Reference:	Well Woolley-Becky 2G-7H-E168
Project:	DJ Wattenberg	TVD Reference:	WELL @ 5022.0ft (Original Well Elev)
Reference Site:	S7-T1N-R68W (Woolley-Sosa/Becky)	MD Reference:	WELL @ 5022.0ft (Original Well Elev)
Site Error:	0.0ft	North Reference:	True
Reference Well:	Woolley-Becky 2G-7H-E168	Survey Calculation Method:	Minimum Curvature
Well Error:	0.0ft	Output errors are at	2.00 sigma
Reference Wellbore	Hz	Database:	USA EDM 5000 Multi Users DB
Reference Design:	Plan #1	Offset TVD Reference:	Offset Datum

Offset Design S7-T1N-R68W (Woolley-Sosa/Becky) - Woolley-Becky 2F-7H-E168 - Hz - Plan #1												Offset Site Error:	0.0 ft
Survey Program: 0-Geolink MWD												Offset Well Error:	0.0 ft
Reference		Offset		Semi Major Axis		Distance							
Measured Depth (ft)	Vertical Depth (ft)	Measured Depth (ft)	Vertical Depth (ft)	Reference (ft)	Offset (ft)	Highside Toolface (°)	Offset Wellbore Centre +N/-S (ft)	+E/-W (ft)	Between Centres (ft)	Between Ellipses (ft)	Total Uncertainty Axis	Separation Factor	Warning
5,100.0	4,984.6	5,089.9	5,019.5	19.8	16.7	-138.56	159.5	767.4	243.2	217.9	25.26	9.629	
5,200.0	5,082.5	5,189.9	5,117.7	20.2	17.0	-138.94	163.1	785.5	243.8	218.1	25.69	9.491	
5,300.0	5,180.5	5,289.9	5,216.0	20.6	17.4	-139.31	166.6	803.7	244.5	218.4	26.12	9.359	
5,400.0	5,278.5	5,389.8	5,314.3	21.0	17.8	-139.69	170.2	821.8	245.2	218.6	26.55	9.234	
5,500.0	5,376.5	5,489.8	5,412.5	21.4	18.1	-140.06	173.8	840.0	245.9	218.9	26.97	9.115	
5,600.0	5,474.5	5,589.8	5,510.8	21.8	18.5	-140.42	177.4	858.1	246.6	219.2	27.39	9.002	
5,700.0	5,572.4	5,689.8	5,609.0	22.1	18.9	-140.79	180.9	876.2	247.3	219.5	27.81	8.893	
5,800.0	5,670.4	5,789.8	5,707.3	22.5	19.3	-141.15	184.5	894.4	248.0	219.8	28.22	8.790	
5,900.0	5,768.4	5,889.8	5,805.5	22.9	19.6	-141.51	188.1	912.5	248.7	220.1	28.62	8.691	
6,000.0	5,866.4	5,989.8	5,903.8	23.3	20.0	-141.87	191.7	930.7	249.5	220.4	29.02	8.596	
6,100.0	5,964.3	6,089.7	6,002.1	23.7	20.4	-142.23	195.2	948.8	250.2	220.8	29.42	8.506	
6,200.0	6,062.3	6,189.7	6,100.3	24.1	20.7	-142.58	198.8	967.0	251.0	221.2	29.81	8.419	
6,300.0	6,160.3	6,289.7	6,198.6	24.5	21.1	-142.94	202.4	985.1	251.7	221.5	30.20	8.336	
6,400.0	6,258.3	6,389.7	6,296.8	24.9	21.5	-143.29	206.0	1,003.3	252.5	221.9	30.58	8.257	
6,500.0	6,356.3	6,489.7	6,395.1	25.3	21.8	-143.64	209.5	1,021.4	253.3	222.3	30.97	8.180	
6,600.0	6,454.2	6,589.7	6,493.4	25.7	22.2	-143.98	213.1	1,039.6	254.1	222.8	31.34	8.107	
6,700.0	6,552.2	6,689.7	6,591.6	26.1	22.6	-144.33	216.7	1,057.7	254.9	223.2	31.72	8.037	
6,800.0	6,650.2	6,789.6	6,689.9	26.5	23.0	-144.67	220.3	1,075.9	255.7	223.6	32.08	7.970	
6,900.0	6,748.2	6,889.6	6,788.1	26.9	23.3	-145.01	223.8	1,094.0	256.5	224.1	32.45	7.906	
7,000.0	6,846.2	6,989.6	6,886.4	27.2	23.7	-145.35	227.4	1,112.2	257.4	224.6	32.81	7.844	
7,100.0	6,944.1	7,089.6	6,984.7	27.6	24.1	-145.68	231.0	1,130.3	258.2	225.0	33.17	7.784	
7,200.0	7,042.1	7,178.9	7,072.2	28.0	24.4	-145.99	234.6	1,146.5	259.0	225.5	33.52	7.725	
7,300.0	7,140.1	7,262.5	7,152.2	28.4	24.8	-146.33	238.2	1,161.4	259.7	226.0	33.87	7.666	
7,400.0	7,238.1	7,340.3	7,223.5	28.8	25.2	-137.84	241.8	1,174.8	260.4	226.5	34.22	7.607	
7,500.0	7,335.7	7,411.9	7,285.4	29.2	25.5	-104.22	245.4	1,186.5	261.1	227.0	34.57	7.548	
7,600.0	7,430.4	7,481.2	7,340.9	29.6	25.9	-79.64	249.0	1,197.1	261.8	227.5	34.92	7.489	
7,700.0	7,519.4	7,550.0	7,390.8	30.1	26.3	-66.79	252.6	1,206.7	262.5	228.0	35.27	7.430	
7,800.0	7,600.0	7,615.7	7,433.1	30.6	26.8	-59.15	256.2	1,215.0	263.2	228.5	35.62	7.371	
7,900.0	7,669.6	7,681.5	7,469.5	31.1	27.2	-54.26	259.8	1,222.2	263.9	229.0	35.97	7.312	
8,000.0	7,726.2	7,750.0	7,500.7	31.7	27.8	-51.14	263.4	1,228.4	264.6	229.5	36.32	7.253	
8,100.0	7,768.1	7,811.7	7,522.5	32.3	28.3	-49.41	267.0	1,232.9	265.3	230.0	36.67	7.194	
8,200.0	7,793.9	7,876.4	7,538.7	33.0	28.8	-48.75	270.6	1,236.5	266.0	230.5	37.02	7.135	
8,300.0	7,803.0	7,941.3	7,547.8	33.7	29.4	-49.10	274.2	1,238.7	266.7	231.0	37.37	7.076	
8,400.0	7,803.0	8,014.6	7,550.0	34.4	30.1	-49.19	277.8	1,239.8	267.4	231.5	37.72	7.017	
8,500.0	7,803.0	8,114.6	7,550.0	35.3	31.0	-49.02	281.4	1,240.6	268.1	232.0	38.07	6.958	
8,600.0	7,803.0	8,214.6	7,550.0	36.2	32.1	-48.85	285.0	1,241.5	268.8	232.5	38.42	6.899	
8,700.0	7,803.0	8,314.5	7,550.0	37.1	33.2	-48.68	288.6	1,242.4	269.5	233.0	38.77	6.840	
8,800.0	7,803.0	8,414.5	7,550.0	38.2	34.4	-48.51	292.2	1,243.3	270.2	233.5	39.12	6.781	
8,900.0	7,803.0	8,514.5	7,550.0	39.2	35.6	-48.33	295.8	1,244.1	270.9	234.0	39.47	6.722	
9,000.0	7,803.0	8,614.5	7,550.0	40.3	36.8	-48.16	300.0	1,245.0	271.6	234.5	39.82	6.663	
9,100.0	7,803.0	8,714.5	7,550.0	41.5	38.1	-47.98	304.2	1,245.9	272.3	235.0	40.17	6.604	
9,200.0	7,803.0	8,814.5	7,550.0	42.7	39.4	-47.80	308.4	1,246.7	273.0	235.5	40.52	6.545	
9,300.0	7,803.0	8,914.5	7,550.0	43.9	40.8	-47.62	312.6	1,247.6	273.7	236.0	40.87	6.486	
9,400.0	7,803.0	9,014.4	7,550.0	45.2	42.2	-47.44	316.8	1,248.5	274.4	236.5	41.22	6.427	
9,500.0	7,803.0	9,114.4	7,550.0	46.5	43.6	-47.26	321.0	1,249.4	275.1	237.0	41.57	6.368	
9,600.0	7,803.0	9,214.4	7,550.0	47.9	45.0	-47.08	325.2	1,250.2	275.8	237.5	41.92	6.309	
9,700.0	7,803.0	9,314.4	7,550.0	49.2	46.5	-46.90	329.4	1,251.1	276.5	238.0	42.27	6.250	
9,800.0	7,803.0	9,414.4	7,550.0	50.6	48.0	-46.71	333.6	1,252.0	277.2	238.5	42.62	6.191	
9,900.0	7,803.0	9,514.4	7,550.0	52.0	49.5	-46.52	337.8	1,252.9	277.9	239.0	42.97	6.132	
10,000.0	7,803.0	9,613.3	7,550.0	53.5	51.0	-46.34	342.0	1,253.7	278.6	239.5	43.32	6.073	
10,100.0	7,803.0	9,712.0	7,550.0	54.9	52.5	-46.24	346.2	1,253.7	279.3	240.0	43.67	6.014	
10,200.0	7,803.0	9,812.0	7,550.0	56.4	54.0	-46.15	350.4	1,253.7	280.0	240.5	44.02	5.955	

CC - Min centre to center distance or convergent point, SF - min separation factor, ES - min ellipse separation

Cathedral Energy Services

Anticollision Report

Company:	EnCana Oil & Gas (USA) Inc	Local Co-ordinate Reference:	Well Woolley-Becky 2G-7H-E168
Project:	DJ Wattenberg	TVD Reference:	WELL @ 5022.0ft (Original Well Elev)
Reference Site:	S7-T1N-R68W (Woolley-Sosa/Becky)	MD Reference:	WELL @ 5022.0ft (Original Well Elev)
Site Error:	0.0ft	North Reference:	True
Reference Well:	Woolley-Becky 2G-7H-E168	Survey Calculation Method:	Minimum Curvature
Well Error:	0.0ft	Output errors are at	2.00 sigma
Reference Wellbore	Hz	Database:	USA EDM 5000 Multi Users DB
Reference Design:	Plan #1	Offset TVD Reference:	Offset Datum

Offset Design S7-T1N-R68W (Woolley-Sosa/Becky) - Woolley-Becky 2F-7H-E168 - Hz - Plan #1													Offset Site Error:	0.0 ft
Survey Program: 0-Geolink MWD													Offset Well Error:	0.0 ft
Reference		Offset		Semi Major Axis			Distance				Total Uncertainty Axis	Separation Factor	Warning	
Measured Depth (ft)	Vertical Depth (ft)	Measured Depth (ft)	Vertical Depth (ft)	Reference (ft)	Offset (ft)	Highside Toolface (°)	Offset Wellbore Centre +N/-S (ft)	+E/-W (ft)	Between Centres (ft)	Between Ellipses (ft)				
10,281.8	7,803.0	9,891.5	7,550.0	57.6	55.2	-46.10	2,703.4	1,253.5	364.8	290.2	74.65	4.887		
10,300.0	7,803.0	9,908.9	7,550.0	57.9	55.5	-46.10	2,720.8	1,253.4	364.9	289.8	75.09	4.859		
10,400.0	7,803.0	10,004.5	7,550.0	59.4	57.0	-46.22	2,816.4	1,251.4	365.7	288.0	77.65	4.710		
10,500.0	7,803.0	10,100.0	7,550.0	60.9	58.4	-46.51	2,911.8	1,247.9	367.7	287.3	80.41	4.573		
10,600.0	7,803.0	10,195.5	7,550.0	62.4	59.9	-46.96	3,007.2	1,242.8	371.0	287.6	83.41	4.448		
10,700.0	7,803.0	10,293.1	7,550.0	63.9	61.4	-47.56	3,104.6	1,236.2	375.3	288.7	86.65	4.332		
10,800.0	7,803.0	10,392.9	7,550.0	65.5	63.0	-48.18	3,204.1	1,229.2	379.8	289.9	89.98	4.221		
10,900.0	7,803.0	10,492.7	7,550.0	67.0	64.6	-48.79	3,303.7	1,222.3	384.4	291.1	93.34	4.118		
11,000.0	7,803.0	10,592.6	7,550.0	68.6	66.1	-49.38	3,403.3	1,215.3	389.0	292.3	96.72	4.022		
11,100.0	7,803.0	10,692.4	7,550.0	70.2	67.7	-49.96	3,502.8	1,208.3	393.7	293.6	100.13	3.932		
11,200.0	7,803.0	10,792.2	7,550.0	71.8	69.3	-50.52	3,602.4	1,201.4	398.4	294.8	103.55	3.847		
11,300.0	7,803.0	10,892.0	7,550.0	73.4	70.9	-51.07	3,702.0	1,194.4	403.1	296.1	106.99	3.768		
11,400.0	7,803.0	10,991.8	7,550.0	75.0	72.5	-51.61	3,801.6	1,187.5	407.9	297.4	110.45	3.693		
11,500.0	7,803.0	11,091.6	7,550.0	76.6	74.2	-52.14	3,901.1	1,180.5	412.7	298.8	113.92	3.623		
11,600.0	7,803.0	11,191.4	7,550.0	78.2	75.8	-52.65	4,000.7	1,173.5	417.5	300.1	117.41	3.556		
11,700.0	7,803.0	11,291.3	7,550.0	79.8	77.4	-53.15	4,100.3	1,166.6	422.4	301.5	120.91	3.494		
11,800.0	7,803.0	11,391.1	7,550.0	81.4	79.0	-53.65	4,199.8	1,159.6	427.3	302.9	124.42	3.434		
11,900.0	7,803.0	11,490.9	7,550.0	83.0	80.7	-54.12	4,299.4	1,152.6	432.3	304.3	127.95	3.378		
12,000.0	7,803.0	11,590.7	7,550.0	84.7	82.3	-54.59	4,399.0	1,145.7	437.2	305.7	131.48	3.325		
12,100.0	7,803.0	11,690.5	7,550.0	86.3	84.0	-55.05	4,498.5	1,138.7	442.2	307.2	135.03	3.275		
12,200.0	7,803.0	11,790.3	7,550.0	88.0	85.6	-55.50	4,598.1	1,131.8	447.2	308.7	138.58	3.227		
12,300.0	7,803.0	11,890.1	7,550.0	89.6	87.3	-55.94	4,697.7	1,124.8	452.3	310.1	142.14	3.182		
12,400.0	7,803.0	11,989.9	7,550.0	91.3	88.9	-56.37	4,797.3	1,117.8	457.4	311.6	145.71	3.139		
12,500.0	7,803.0	12,089.8	7,550.0	92.9	90.6	-56.78	4,896.8	1,110.9	462.5	313.2	149.29	3.098		
12,600.0	7,803.0	12,189.6	7,550.0	94.6	92.3	-57.19	4,996.4	1,103.9	467.6	314.7	152.87	3.059		
12,700.0	7,803.0	12,289.4	7,550.0	96.3	93.9	-57.59	5,096.0	1,096.9	472.7	316.3	156.46	3.021		
12,800.0	7,803.0	12,389.2	7,550.0	97.9	95.6	-57.99	5,195.5	1,090.0	477.9	317.8	160.05	2.986		
12,900.0	7,803.0	12,492.7	7,550.0	99.6	97.4	-58.37	5,298.8	1,083.0	482.9	319.2	163.71	2.950		
13,000.0	7,803.0	12,600.4	7,550.0	101.3	99.2	-58.65	5,406.3	1,077.4	486.5	319.3	167.27	2.909		
13,100.0	7,803.0	12,708.2	7,550.0	102.9	101.0	-58.81	5,514.1	1,073.9	488.6	318.0	170.64	2.863		
13,200.0	7,803.0	12,816.1	7,550.0	104.6	102.8	-58.85	5,621.9	1,072.4	489.0	315.2	173.80	2.814		
13,300.0	7,803.0	12,923.9	7,550.0	106.3	104.7	-58.76	5,729.8	1,073.0	487.9	311.1	176.74	2.760		
13,400.0	7,803.0	13,031.7	7,550.0	108.0	106.5	-58.54	5,837.5	1,075.5	485.1	305.6	179.45	2.703		
13,500.0	7,803.0	13,133.1	7,550.0	109.7	108.3	-58.26	5,938.9	1,079.2	481.2	299.3	181.92	2.645		
13,600.0	7,803.0	13,233.0	7,550.0	111.3	110.0	-57.97	6,038.7	1,082.9	477.4	293.0	184.34	2.590		
13,700.0	7,803.0	13,332.9	7,550.0	113.0	111.7	-57.67	6,138.6	1,086.6	473.5	286.8	186.73	2.536		
13,800.0	7,803.0	13,432.8	7,550.0	114.7	113.5	-57.38	6,238.4	1,090.3	469.6	280.6	189.08	2.484		
13,900.0	7,803.0	13,532.7	7,550.0	116.4	115.2	-57.07	6,338.2	1,094.0	465.8	274.4	191.40	2.434		
14,000.0	7,803.0	13,632.6	7,550.0	118.1	116.9	-56.77	6,438.0	1,097.7	462.0	268.3	193.69	2.385		
14,100.0	7,803.0	13,732.5	7,550.0	119.8	118.7	-56.45	6,537.9	1,101.3	458.2	262.2	195.94	2.338		
14,200.0	7,803.0	13,832.4	7,550.0	121.5	120.4	-56.14	6,637.7	1,105.0	454.4	256.2	198.16	2.293		
14,300.0	7,803.0	13,932.3	7,550.0	123.2	122.1	-55.81	6,737.5	1,108.7	450.6	250.3	200.33	2.249		
14,400.0	7,803.0	14,032.2	7,550.0	124.9	123.8	-55.48	6,837.4	1,112.4	446.8	244.4	202.47	2.207		
14,500.0	7,803.0	14,132.1	7,550.0	126.6	125.6	-55.15	6,937.2	1,116.1	443.1	238.5	204.56	2.166		
14,600.0	7,803.0	14,232.0	7,550.0	128.3	127.3	-54.81	7,037.0	1,119.8	439.3	232.7	206.61	2.126		
14,700.0	7,803.0	14,331.9	7,550.0	130.0	129.0	-54.46	7,136.8	1,123.5	435.6	227.0	208.62	2.088		
14,752.0	7,803.0	14,367.7	7,550.0	130.9	129.7	-54.34	7,172.7	1,124.8	434.0	224.4	209.56	2.071		
14,756.2	7,803.0	14,367.7	7,550.0	131.0	129.7	-54.34	7,172.7	1,124.8	434.0	224.4	209.62	2.070 SF		

CC - Min centre to center distance or convergent point, SF - min separation factor, ES - min ellipse separation

Cathedral Energy Services

Anticollision Report

Company:	EnCana Oil & Gas (USA) Inc	Local Co-ordinate Reference:	Well Woolley-Becky 2G-7H-E168
Project:	DJ Wattenberg	TVD Reference:	WELL @ 5022.0ft (Original Well Elev)
Reference Site:	S7-T1N-R68W (Woolley-Sosa/Becky)	MD Reference:	WELL @ 5022.0ft (Original Well Elev)
Site Error:	0.0ft	North Reference:	True
Reference Well:	Woolley-Becky 2G-7H-E168	Survey Calculation Method:	Minimum Curvature
Well Error:	0.0ft	Output errors are at	2.00 sigma
Reference Wellbore	Hz	Database:	USA EDM 5000 Multi Users DB
Reference Design:	Plan #1	Offset TVD Reference:	Offset Datum

Offset Design S7-T1N-R68W (Woolley-Sosa/Becky) - Woolley-Becky 2H-7H-E168 - Hz - Plan #1													Offset Site Error: 0.0 ft	
Survey Program: 0-Geolink MWD													Offset Well Error: 0.0 ft	
Reference		Offset		Semi Major Axis			Distance							Warning
Measured Depth (ft)	Vertical Depth (ft)	Measured Depth (ft)	Vertical Depth (ft)	Reference (ft)	Offset (ft)	Highside Toolface (°)	Offset Wellbore Centre +N/-S (ft)	+E/-W (ft)	Between Centres (ft)	Between Ellipses (ft)	Total Uncertainty Axis	Separation Factor		
0.0	0.0	0.0	0.0	0.0	0.0	37.54	7.3	5.6	9.2					
100.0	100.0	100.0	100.0	0.1	0.1	37.54	7.3	5.6	9.2	8.9	0.26	35.094	CC, ES	
200.0	200.0	200.0	200.0	0.3	0.3	37.54	7.3	5.6	9.2	8.6	0.61	15.040		
300.0	300.0	299.9	299.9	0.5	0.5	-59.50	7.3	6.5	9.6	8.7	0.96	10.029		
400.0	400.0	399.8	399.7	0.7	0.7	-56.85	7.3	9.1	10.5	9.1	1.31	7.961		
500.0	499.9	499.6	499.5	0.8	0.8	-55.58	7.3	13.4	11.5	9.9	1.67	6.889		
600.0	599.8	599.5	599.2	1.0	1.0	-55.42	7.3	19.5	12.8	10.8	2.05	6.274		
700.0	699.5	699.3	698.7	1.2	1.3	-56.06	7.3	27.3	14.4	12.0	2.44	5.901		
800.0	799.2	799.1	798.0	1.5	1.5	-57.26	7.3	36.9	16.2	13.3	2.86	5.665		
900.0	898.6	898.9	897.1	1.7	1.7	-58.79	7.3	48.2	18.2	14.9	3.31	5.509		
1,000.0	997.9	998.6	996.0	2.0	2.0	-60.50	7.3	61.2	20.5	16.7	3.80	5.402		
1,100.0	1,096.9	1,098.4	1,094.7	2.2	2.3	-62.28	7.4	75.9	23.1	18.7	4.33	5.324		
1,200.0	1,195.7	1,198.1	1,193.0	2.6	2.6	-64.05	7.4	92.3	25.9	21.0	4.92	5.264		
1,300.0	1,294.1	1,297.7	1,291.0	2.9	3.0	-65.77	7.4	110.4	29.0	23.5	5.57	5.214		
1,400.0	1,392.3	1,397.4	1,388.7	3.3	3.4	-67.40	7.4	130.3	32.4	26.1	6.27	5.172		
1,500.0	1,490.1	1,497.0	1,486.0	3.6	3.8	-68.93	7.4	151.8	36.1	29.1	7.03	5.135		
1,600.0	1,587.5	1,596.6	1,582.8	4.1	4.2	-70.35	7.4	175.0	40.1	32.2	7.86	5.101		
1,700.0	1,684.6	1,696.1	1,679.2	4.5	4.7	-71.67	7.5	199.8	44.3	35.6	8.75	5.070		
1,800.0	1,781.2	1,795.7	1,775.1	5.0	5.2	-72.89	7.5	226.4	48.9	39.2	9.70	5.041		
1,900.0	1,877.4	1,895.4	1,870.8	5.5	5.7	-72.24	7.5	254.4	53.5	42.8	10.69	5.003		
2,000.0	1,973.5	1,995.3	1,966.7	6.0	6.2	-69.18	7.5	282.6	56.7	45.0	11.66	4.863		
2,100.0	2,069.7	2,095.3	2,062.6	6.5	6.7	-65.45	7.6	310.8	58.3	45.7	12.59	4.630		
2,200.0	2,165.8	2,195.3	2,158.5	7.0	7.3	-61.81	7.6	339.1	58.3	44.8	13.47	4.326		
2,300.0	2,261.9	2,295.3	2,254.4	7.5	7.8	-60.75	7.6	367.3	57.8	43.4	14.33	4.032		
2,400.0	2,358.1	2,395.3	2,350.4	8.0	8.3	-59.66	7.7	395.6	57.3	42.1	15.17	3.776		
2,500.0	2,454.2	2,495.3	2,446.3	8.5	8.9	-58.56	7.7	423.9	56.8	40.8	15.99	3.554		
2,600.0	2,550.3	2,595.3	2,542.2	9.1	9.4	-57.44	7.7	452.1	56.4	39.6	16.79	3.358		
2,700.0	2,646.4	2,695.3	2,638.1	9.6	9.9	-56.31	7.7	480.4	56.0	38.4	17.57	3.186		
2,800.0	2,742.6	2,795.3	2,734.0	10.1	10.5	-55.16	7.8	508.6	55.6	37.3	18.32	3.034		
2,900.0	2,838.7	2,895.2	2,829.9	10.6	11.0	-53.99	7.8	536.9	55.2	36.2	19.04	2.899		
3,000.0	2,934.8	2,995.2	2,925.9	11.1	11.5	-52.80	7.8	565.1	54.9	35.1	19.74	2.779		
3,100.0	3,031.0	3,095.2	3,021.8	11.7	12.1	-51.60	7.8	593.4	54.5	34.1	20.40	2.672		
3,200.0	3,127.1	3,195.2	3,117.7	12.2	12.6	-50.05	7.9	621.6	54.2	33.2	21.03	2.579		
3,243.0	3,168.5	3,238.2	3,159.0	12.4	12.8	-48.51	7.9	633.8	54.2	33.0	21.22	2.554		
3,300.0	3,223.5	3,295.2	3,213.6	12.7	13.1	-45.92	7.9	649.9	54.3	32.9	21.34	2.543		
3,400.0	3,320.3	3,395.1	3,309.4	13.1	13.7	-39.87	7.9	678.1	55.0	33.8	21.16	2.599		
3,500.0	3,417.5	3,494.9	3,405.2	13.6	14.2	-32.12	7.9	706.3	56.8	36.3	20.43	2.778		
3,600.0	3,515.0	3,594.7	3,500.9	14.0	14.8	-23.04	8.0	734.5	59.9	40.7	19.20	3.121		
3,700.0	3,612.9	3,694.2	3,596.4	14.4	15.3	-13.18	8.0	762.6	65.0	47.3	17.69	3.671		
3,800.0	3,710.8	3,793.7	3,691.8	14.8	15.8	-6.59	8.0	790.7	71.5	55.2	16.32	4.379		
3,900.0	3,808.8	3,893.2	3,787.2	15.1	16.4	-1.20	8.0	818.8	78.8	63.4	15.38	5.120		
4,000.0	3,906.8	3,992.7	3,882.7	15.5	16.9	3.26	8.1	846.9	86.6	71.8	14.85	5.834		
4,100.0	4,004.8	4,092.2	3,978.1	15.9	17.4	6.95	8.1	875.0	95.0	80.3	14.66	6.478		
4,200.0	4,102.8	4,191.6	4,073.5	16.3	18.0	10.04	8.1	903.2	103.6	88.9	14.73	7.034		
4,300.0	4,200.7	4,291.1	4,168.9	16.7	18.5	12.65	8.2	931.3	112.5	97.5	14.99	7.505		
4,400.0	4,298.7	4,390.6	4,264.4	17.1	19.0	14.88	8.2	959.4	121.6	106.2	15.38	7.903		
4,500.0	4,396.7	4,490.1	4,359.8	17.5	19.6	16.79	8.2	987.5	130.8	114.9	15.87	8.242		
4,600.0	4,494.7	4,589.6	4,455.2	17.9	20.1	18.45	8.2	1,015.6	140.2	123.8	16.42	8.536		
4,700.0	4,592.6	4,689.1	4,550.7	18.2	20.7	19.90	8.3	1,043.7	149.7	132.6	17.02	8.795		
4,800.0	4,690.6	4,788.5	4,646.1	18.6	21.2	21.18	8.3	1,071.8	159.2	141.6	17.64	9.027		
4,900.0	4,788.6	4,888.0	4,741.5	19.0	21.7	22.32	8.3	1,099.9	168.8	150.6	18.28	9.239		
5,000.0	4,886.6	4,987.5	4,837.0	19.4	22.3	23.33	8.3	1,128.0	178.5	159.6	18.92	9.434		

CC - Min centre to center distance or convergent point, SF - min separation factor, ES - min ellipse separation

Cathedral Energy Services

Anticollision Report

Company:	EnCana Oil & Gas (USA) Inc	Local Co-ordinate Reference:	Well Woolley-Becky 2G-7H-E168
Project:	DJ Wattenberg	TVD Reference:	WELL @ 5022.0ft (Original Well Elev)
Reference Site:	S7-T1N-R68W (Woolley-Sosa/Becky)	MD Reference:	WELL @ 5022.0ft (Original Well Elev)
Site Error:	0.0ft	North Reference:	True
Reference Well:	Woolley-Becky 2G-7H-E168	Survey Calculation Method:	Minimum Curvature
Well Error:	0.0ft	Output errors are at	2.00 sigma
Reference Wellbore	Hz	Database:	USA EDM 5000 Multi Users DB
Reference Design:	Plan #1	Offset TVD Reference:	Offset Datum

Offset Design S7-T1N-R68W (Woolley-Sosa/Becky) - Woolley-Becky 2H-7H-E168 - Hz - Plan #1												Offset Site Error: 0.0 ft	
Survey Program: 0-Geolink MWD												Offset Well Error: 0.0 ft	
Reference		Offset		Semi Major Axis			Distance						Warning
Measured Depth (ft)	Vertical Depth (ft)	Measured Depth (ft)	Vertical Depth (ft)	Reference (ft)	Offset (ft)	Highside Toolface (°)	Offset Wellbore Centre +N/-S (ft)	+E/-W (ft)	Between Centres (ft)	Between Ellipses (ft)	Total Uncertainty Axis	Separation Factor	
5,100.0	4,984.6	5,087.0	4,932.4	19.8	22.8	24.23	8.4	1,156.1	188.3	168.7	19.58	9.616	
5,200.0	5,082.5	5,186.5	5,027.8	20.2	23.3	25.05	8.4	1,184.2	198.0	177.8	20.24	9.787	
5,300.0	5,180.5	5,286.0	5,123.2	20.6	23.9	25.79	8.4	1,212.3	207.9	187.0	20.89	9.948	
5,400.0	5,278.5	5,385.4	5,218.7	21.0	24.4	26.46	8.4	1,240.5	217.7	196.1	21.55	10.102	
5,500.0	5,376.5	5,484.9	5,314.1	21.4	24.9	27.08	8.5	1,268.6	227.6	205.4	22.21	10.248	
5,600.0	5,474.5	5,584.4	5,409.5	21.8	25.5	27.64	8.5	1,296.7	237.5	214.6	22.86	10.388	
5,700.0	5,572.4	5,683.9	5,505.0	22.1	26.0	28.16	8.5	1,324.8	247.4	223.9	23.51	10.522	
5,800.0	5,670.4	5,783.4	5,600.4	22.5	26.6	28.64	8.5	1,352.9	257.3	233.2	24.16	10.650	
5,900.0	5,768.4	5,882.9	5,695.8	22.9	27.1	29.08	8.6	1,381.0	267.3	242.5	24.81	10.774	
6,000.0	5,866.4	5,982.3	5,791.3	23.3	27.6	29.49	8.6	1,409.1	277.2	251.8	25.45	10.894	
6,100.0	5,964.3	6,081.8	5,886.7	23.7	28.2	29.88	8.6	1,437.2	287.2	261.1	26.09	11.009	
6,200.0	6,062.3	6,181.3	5,982.1	24.1	28.7	30.23	8.7	1,465.3	297.2	270.5	26.73	11.120	
6,300.0	6,160.3	6,280.8	6,077.5	24.5	29.3	30.57	8.7	1,493.4	307.2	279.8	27.36	11.227	
6,400.0	6,258.3	6,380.3	6,173.0	24.9	29.8	30.88	8.7	1,521.5	317.2	289.2	27.99	11.331	
6,500.0	6,356.3	6,479.8	6,268.4	25.3	30.3	31.17	8.7	1,549.7	327.2	298.6	28.63	11.432	
6,600.0	6,454.2	6,579.2	6,363.8	25.7	30.9	31.45	8.8	1,577.8	337.3	308.0	29.25	11.529	
6,700.0	6,552.2	6,678.7	6,459.3	26.1	31.4	31.71	8.8	1,605.9	347.3	317.4	29.88	11.623	
6,800.0	6,650.2	6,778.2	6,554.7	26.5	31.9	31.96	8.8	1,634.0	357.3	326.8	30.50	11.715	
6,900.0	6,748.2	6,877.7	6,650.1	26.9	32.5	32.19	8.8	1,662.1	367.4	336.3	31.13	11.804	
7,000.0	6,846.2	6,977.2	6,745.5	27.2	33.0	32.41	8.9	1,690.2	377.4	345.7	31.75	11.890	
7,100.0	6,944.1	7,076.7	6,841.0	27.6	33.6	32.62	8.9	1,718.3	387.5	355.1	32.36	11.973	
7,200.0	7,042.1	7,176.1	6,936.4	28.0	34.1	32.81	8.9	1,746.4	397.6	364.6	32.98	12.054	
7,300.0	7,140.1	7,287.5	7,043.2	28.4	34.7	32.77	10.9	1,777.8	407.1	373.6	33.52	12.144	
7,400.0	7,238.1	7,417.1	7,165.0	28.8	35.4	29.72	36.1	1,813.3	410.6	378.0	32.59	12.599	
7,483.4	7,319.5	7,517.1	7,253.5	29.2	35.9	49.37	74.6	1,838.7	410.8	379.8	31.02	13.245	
7,500.0	7,335.7	7,535.1	7,268.7	29.2	36.0	51.85	83.2	1,843.0	410.5	379.9	30.59	13.419	
7,600.0	7,430.4	7,644.0	7,354.6	29.6	36.5	65.54	145.6	1,867.2	412.1	383.0	29.07	14.176	
7,700.0	7,519.4	7,745.5	7,423.1	30.1	37.0	68.80	217.8	1,886.1	416.0	387.7	28.28	14.709	
7,800.0	7,600.0	7,840.9	7,475.4	30.6	37.4	68.21	296.1	1,900.2	422.0	393.9	28.10	15.019	
7,900.0	7,669.6	7,931.2	7,512.9	31.1	37.8	66.06	377.6	1,909.8	429.6	401.3	28.27	15.196	
8,000.0	7,726.2	8,017.5	7,536.9	31.7	38.3	63.32	460.3	1,915.4	438.1	409.4	28.72	15.257	
8,100.0	7,768.1	8,100.0	7,548.5	32.3	38.7	60.45	541.8	1,917.4	446.9	417.2	29.65	15.073	
8,200.0	7,793.9	8,189.4	7,550.0	33.0	39.1	57.61	631.2	1,916.3	454.6	423.1	31.53	14.418	
8,300.0	7,803.0	8,288.9	7,550.0	33.7	39.7	56.41	730.6	1,914.5	457.3	422.2	35.13	13.016	
8,400.0	7,803.0	8,388.9	7,550.0	34.4	40.3	56.35	830.6	1,912.8	456.6	419.3	37.31	12.238	
8,500.0	7,803.0	8,488.8	7,550.0	35.3	41.0	56.29	930.6	1,911.1	455.8	416.3	39.51	11.538	
8,600.0	7,803.0	8,588.8	7,550.0	36.2	41.7	56.23	1,030.6	1,909.3	455.1	413.3	41.79	10.890	
8,700.0	7,803.0	8,688.8	7,550.0	37.1	42.5	56.16	1,130.6	1,907.6	454.4	410.2	44.15	10.293	
8,800.0	7,803.0	8,788.8	7,550.0	38.2	43.4	56.10	1,230.5	1,905.8	453.7	407.1	46.56	9.744	
8,900.0	7,803.0	8,888.8	7,550.0	39.2	44.3	56.04	1,330.5	1,904.1	452.9	403.9	49.02	9.240	
9,000.0	7,803.0	8,988.8	7,550.0	40.3	45.3	55.98	1,430.5	1,902.3	452.2	400.7	51.52	8.777	
9,100.0	7,803.0	9,088.8	7,550.0	41.5	46.3	55.92	1,530.5	1,900.6	451.5	397.4	54.06	8.351	
9,200.0	7,803.0	9,188.8	7,550.0	42.7	47.4	55.86	1,630.5	1,898.8	450.8	394.1	56.63	7.960	
9,300.0	7,803.0	9,288.8	7,550.0	43.9	48.5	55.79	1,730.4	1,897.1	450.0	390.8	59.22	7.599	
9,400.0	7,803.0	9,388.8	7,550.0	45.2	49.6	55.73	1,830.4	1,895.3	449.3	387.5	61.84	7.266	
9,500.0	7,803.0	9,488.8	7,550.0	46.5	50.8	55.67	1,930.4	1,893.6	448.6	384.1	64.47	6.959	
9,600.0	7,803.0	9,588.8	7,550.0	47.9	52.0	55.60	2,030.4	1,891.9	447.9	380.8	67.11	6.673	
9,700.0	7,803.0	9,688.8	7,550.0	49.2	53.2	55.54	2,130.4	1,890.1	447.2	377.4	69.77	6.409	
9,800.0	7,803.0	9,788.8	7,550.0	50.6	54.5	55.48	2,230.4	1,888.4	446.4	374.0	72.45	6.162	
9,900.0	7,803.0	9,888.8	7,550.0	52.0	55.8	55.41	2,330.3	1,886.6	445.7	370.6	75.13	5.933	
10,000.0	7,803.0	9,988.8	7,550.0	53.5	57.1	55.35	2,430.3	1,884.9	445.0	367.2	77.81	5.719	
10,100.0	7,803.0	10,088.8	7,550.0	54.9	58.4	55.29	2,530.3	1,883.1	444.3	363.8	80.51	5.519	

CC - Min centre to center distance or convergent point, SF - min separation factor, ES - min ellipse separation

Cathedral Energy Services

Anticollision Report

Company:	EnCana Oil & Gas (USA) Inc	Local Co-ordinate Reference:	Well Woolley-Becky 2G-7H-E168
Project:	DJ Wattenberg	TVD Reference:	WELL @ 5022.0ft (Original Well Elev)
Reference Site:	S7-T1N-R68W (Woolley-Sosa/Becky)	MD Reference:	WELL @ 5022.0ft (Original Well Elev)
Site Error:	0.0ft	North Reference:	True
Reference Well:	Woolley-Becky 2G-7H-E168	Survey Calculation Method:	Minimum Curvature
Well Error:	0.0ft	Output errors are at	2.00 sigma
Reference Wellbore	Hz	Database:	USA EDM 5000 Multi Users DB
Reference Design:	Plan #1	Offset TVD Reference:	Offset Datum

Offset Design S7-T1N-R68W (Woolley-Sosa/Becky) - Woolley-Becky 2H-7H-E168 - Hz - Plan #1													Offset Site Error:	0.0 ft
Survey Program: 0-Geolink MWD													Offset Well Error:	0.0 ft
Reference		Offset		Semi Major Axis			Distance							
Measured Depth (ft)	Vertical Depth (ft)	Measured Depth (ft)	Vertical Depth (ft)	Reference (ft)	Offset (ft)	Highside Toolface (°)	Offset Wellbore Centre +N/-S (ft)	+E/-W (ft)	Between Centres (ft)	Between Ellipses (ft)	Total Uncertainty Axis	Separation Factor	Warning	
10,200.0	7,803.0	10,188.8	7,550.0	56.4	59.8	55.22	2,630.3	1,881.4	443.6	360.4	83.21	5.331		
10,300.0	7,803.0	10,288.8	7,550.0	57.9	61.2	55.16	2,730.3	1,879.6	442.9	356.9	85.91	5.155		
10,400.0	7,803.0	10,388.8	7,550.0	59.4	62.6	55.09	2,830.2	1,877.9	442.1	353.5	88.62	4.989		
10,500.0	7,803.0	10,488.8	7,550.0	60.9	64.0	55.03	2,930.2	1,876.2	441.4	350.1	91.33	4.833		
10,600.0	7,803.0	10,588.8	7,550.0	62.4	65.4	54.96	3,030.2	1,874.4	440.7	346.7	94.04	4.686		
10,700.0	7,803.0	10,688.8	7,550.0	63.9	66.9	54.90	3,130.2	1,872.7	440.0	343.2	96.76	4.547		
10,800.0	7,803.0	10,788.8	7,550.0	65.5	68.4	54.83	3,230.2	1,870.9	439.3	339.8	99.47	4.416		
10,900.0	7,803.0	10,888.8	7,550.0	67.0	69.8	54.77	3,330.1	1,869.2	438.6	336.4	102.18	4.292		
11,000.0	7,803.0	10,988.8	7,550.0	68.6	71.3	54.70	3,430.1	1,867.4	437.9	333.0	104.90	4.174		
11,100.0	7,803.0	11,088.7	7,550.0	70.2	72.8	54.64	3,530.1	1,865.7	437.1	329.5	107.61	4.062		
11,200.0	7,803.0	11,188.7	7,550.0	71.8	74.4	54.57	3,630.1	1,863.9	436.4	326.1	110.33	3.956		
11,300.0	7,803.0	11,288.7	7,550.0	73.4	75.9	54.50	3,730.1	1,862.2	435.7	322.7	113.04	3.855		
11,400.0	7,803.0	11,388.7	7,550.0	75.0	77.4	54.44	3,830.0	1,860.4	435.0	319.3	115.75	3.758		
11,500.0	7,803.0	11,488.7	7,550.0	76.6	79.0	54.37	3,930.0	1,858.7	434.3	315.8	118.46	3.666		
11,600.0	7,803.0	11,588.7	7,550.0	78.2	80.5	54.30	4,030.0	1,857.0	433.6	312.4	121.16	3.579		
11,700.0	7,803.0	11,688.7	7,550.0	79.8	82.1	54.23	4,130.0	1,855.2	432.9	309.0	123.87	3.495		
11,800.0	7,803.0	11,788.7	7,550.0	81.4	83.7	54.17	4,230.0	1,853.5	432.2	305.6	126.57	3.415		
11,900.0	7,803.0	11,888.7	7,550.0	83.0	85.2	54.10	4,330.0	1,851.7	431.5	302.2	129.27	3.338		
12,000.0	7,803.0	11,988.7	7,550.0	84.7	86.8	54.03	4,429.9	1,850.0	430.8	298.8	131.96	3.264		
12,100.0	7,803.0	12,088.7	7,550.0	86.3	88.4	53.96	4,529.9	1,848.2	430.1	295.4	134.65	3.194		
12,200.0	7,803.0	12,188.7	7,550.0	88.0	90.0	53.89	4,629.9	1,846.5	429.3	292.0	137.34	3.126		
12,300.0	7,803.0	12,288.7	7,550.0	89.6	91.6	53.83	4,729.9	1,844.7	428.6	288.6	140.03	3.061		
12,400.0	7,803.0	12,388.7	7,550.0	91.3	93.2	53.76	4,829.9	1,843.0	427.9	285.2	142.71	2.999		
12,500.0	7,803.0	12,488.7	7,550.0	92.9	94.8	53.69	4,929.8	1,841.2	427.2	281.8	145.39	2.939		
12,600.0	7,803.0	12,588.7	7,550.0	94.6	96.5	53.62	5,029.8	1,839.5	426.5	278.5	148.06	2.881		
12,700.0	7,803.0	12,688.7	7,550.0	96.3	98.1	53.55	5,129.8	1,837.8	425.8	275.1	150.73	2.825		
12,800.0	7,803.0	12,788.7	7,550.0	97.9	99.7	53.48	5,229.8	1,836.0	425.1	271.7	153.40	2.771		
12,900.0	7,803.0	12,888.7	7,550.0	99.6	101.3	53.41	5,329.8	1,834.3	424.4	268.4	156.06	2.720		
13,000.0	7,803.0	12,988.7	7,550.0	101.3	103.0	53.34	5,429.7	1,832.5	423.7	265.0	158.72	2.670		
13,100.0	7,803.0	13,088.7	7,550.0	102.9	104.6	53.27	5,529.7	1,830.8	423.0	261.7	161.37	2.621		
13,200.0	7,803.0	13,188.7	7,550.0	104.6	106.3	53.20	5,629.7	1,829.0	422.3	258.3	164.02	2.575		
13,300.0	7,803.0	13,288.7	7,550.0	106.3	107.9	53.13	5,729.7	1,827.3	421.6	255.0	166.66	2.530		
13,400.0	7,803.0	13,388.7	7,550.0	108.0	109.6	53.05	5,829.7	1,825.5	420.9	251.6	169.30	2.486		
13,500.0	7,803.0	13,488.7	7,550.0	109.7	111.2	52.98	5,929.6	1,823.8	420.2	248.3	171.93	2.444		
13,600.0	7,803.0	13,588.7	7,550.0	111.3	112.9	52.91	6,029.6	1,822.1	419.5	245.0	174.56	2.403		
13,700.0	7,803.0	13,688.6	7,550.0	113.0	114.5	52.84	6,129.6	1,820.3	418.8	241.7	177.19	2.364		
13,800.0	7,803.0	13,788.6	7,550.0	114.7	116.2	52.77	6,229.6	1,818.6	418.1	238.3	179.81	2.326		
13,900.0	7,803.0	13,888.6	7,550.0	116.4	117.9	52.69	6,329.6	1,816.8	417.5	235.0	182.42	2.288		
14,000.0	7,803.0	13,988.6	7,550.0	118.1	119.5	52.62	6,429.6	1,815.1	416.8	231.7	185.03	2.252		
14,100.0	7,803.0	14,088.6	7,550.0	119.8	121.2	52.55	6,529.5	1,813.3	416.1	228.4	187.63	2.218		
14,200.0	7,803.0	14,188.6	7,550.0	121.5	122.9	52.48	6,629.5	1,811.6	415.4	225.2	190.23	2.184		
14,300.0	7,803.0	14,288.6	7,550.0	123.2	124.6	52.40	6,729.5	1,809.8	414.7	221.9	192.82	2.151		
14,400.0	7,803.0	14,388.6	7,550.0	124.9	126.2	52.33	6,829.5	1,808.1	414.0	218.6	195.40	2.119		
14,500.0	7,803.0	14,488.6	7,550.0	126.6	127.9	52.25	6,929.5	1,806.3	413.3	215.3	197.98	2.088		
14,600.0	7,803.0	14,588.6	7,550.0	128.3	129.6	52.18	7,029.4	1,804.6	412.6	212.1	200.56	2.057		
14,700.0	7,803.0	14,688.6	7,550.0	130.0	131.3	52.11	7,129.4	1,802.9	411.9	208.8	203.12	2.028		
14,756.2	7,803.0	14,742.8	7,550.0	131.0	132.2	52.07	7,183.6	1,801.9	411.5	207.0	204.54	2.012 SF		

Cathedral Energy Services

Anticollision Report

Company:	EnCana Oil & Gas (USA) Inc	Local Co-ordinate Reference:	Well Woolley-Becky 2G-7H-E168
Project:	DJ Wattenberg	TVD Reference:	WELL @ 5022.0ft (Original Well Elev)
Reference Site:	S7-T1N-R68W (Woolley-Sosa/Becky)	MD Reference:	WELL @ 5022.0ft (Original Well Elev)
Site Error:	0.0ft	North Reference:	True
Reference Well:	Woolley-Becky 2G-7H-E168	Survey Calculation Method:	Minimum Curvature
Well Error:	0.0ft	Output errors are at	2.00 sigma
Reference Wellbore	Hz	Database:	USA EDM 5000 Multi Users DB
Reference Design:	Plan #1	Offset TVD Reference:	Offset Datum

Offset Design S7-T1N-R68W (Woolley-Sosa/Becky) - Woolley-Sosa 2A-7H-E168 - Hz - Plan #1													Offset Site Error:	0.0 ft
Survey Program: 0-Geolink MWD													Offset Well Error:	0.0 ft
Reference		Offset		Semi Major Axis			Distance							Warning
Measured Depth	Vertical Depth	Measured Depth	Vertical Depth	Reference	Offset	Highside Toolface	Offset Wellbore Centre	Between Centres	Between Ellipses	Total Uncertainty Axis	Separation Factor			
(ft)	(ft)	(ft)	(ft)	(ft)	(ft)	(°)	+N/-S (ft)	+E/-W (ft)	(ft)	(ft)				
0.0	0.0	0.0	0.0	0.0	0.0	-90.31	-0.6	-106.0	106.0					
100.0	100.0	97.0	97.0	0.1	0.1	-90.31	-0.6	-106.0	106.0	105.7	0.26	410.892		
200.0	200.0	197.0	197.0	0.3	0.3	-90.31	-0.6	-106.0	106.0	105.4	0.61	174.955	CC, ES	
300.0	300.0	295.8	295.8	0.5	0.5	170.03	0.0	-106.5	106.7	105.8	0.95	111.949		
400.0	400.0	394.5	394.5	0.7	0.7	171.16	1.9	-108.1	110.1	108.8	1.30	84.541		
500.0	499.9	492.9	492.8	0.8	0.8	172.94	5.1	-110.9	116.5	114.8	1.65	70.395		
600.0	599.8	590.9	590.6	1.0	1.0	175.14	9.5	-114.7	125.9	123.9	2.01	62.652		
700.0	699.5	688.3	687.7	1.2	1.2	177.52	15.1	-119.6	138.5	136.1	2.37	58.517		
800.0	799.2	784.9	783.9	1.5	1.5	179.91	21.9	-125.6	154.3	151.6	2.73	56.627		
900.0	898.6	881.2	879.6	1.7	1.7	-177.84	29.9	-132.5	173.4	170.3	3.08	56.231	SF	
1,000.0	997.9	978.7	976.5	2.0	1.9	-175.95	38.3	-139.9	194.8	191.3	3.44	56.574		
1,100.0	1,096.9	1,075.9	1,073.0	2.2	2.2	-174.47	46.7	-147.2	218.0	214.2	3.80	57.372		
1,200.0	1,195.7	1,172.6	1,169.1	2.6	2.4	-173.30	55.0	-154.5	243.0	238.9	4.16	58.485		
1,300.0	1,294.1	1,268.9	1,264.7	2.9	2.7	-172.40	63.4	-161.8	269.8	265.3	4.51	59.823		
1,400.0	1,392.3	1,364.7	1,359.9	3.3	2.9	-171.69	71.6	-169.0	298.2	293.4	4.86	61.329		
1,500.0	1,490.1	1,460.0	1,454.6	3.6	3.2	-171.15	79.9	-176.2	328.4	323.2	5.22	62.961		
1,600.0	1,587.5	1,554.8	1,548.7	4.1	3.4	-170.72	88.1	-183.4	360.2	354.6	5.57	64.693		
1,700.0	1,684.6	1,649.0	1,642.3	4.5	3.7	-170.40	96.2	-190.5	393.6	387.7	5.92	66.505		
1,800.0	1,781.2	1,742.6	1,735.3	5.0	3.9	-170.16	104.3	-197.5	428.7	422.4	6.27	68.383		
1,900.0	1,877.4	1,835.8	1,827.9	5.5	4.2	-168.10	112.3	-204.6	465.1	458.5	6.63	70.126		

Cathedral Energy Services

Anticollision Report

Company:	EnCana Oil & Gas (USA) Inc	Local Co-ordinate Reference:	Well Woolley-Becky 2G-7H-E168
Project:	DJ Wattenberg	TVD Reference:	WELL @ 5022.0ft (Original Well Elev)
Reference Site:	S7-T1N-R68W (Woolley-Sosa/Becky)	MD Reference:	WELL @ 5022.0ft (Original Well Elev)
Site Error:	0.0ft	North Reference:	True
Reference Well:	Woolley-Becky 2G-7H-E168	Survey Calculation Method:	Minimum Curvature
Well Error:	0.0ft	Output errors are at	2.00 sigma
Reference Wellbore	Hz	Database:	USA EDM 5000 Multi Users DB
Reference Design:	Plan #1	Offset TVD Reference:	Offset Datum

Offset Design S7-T1N-R68W (Woolley-Sosa/Becky) - Woolley-Sosa 2B-7H-E168 - HZ - Plan #1											Offset Site Error:		0.0 ft	
Survey Program: 0-Geolink MWD											Offset Well Error:		0.0 ft	
Reference		Offset		Semi Major Axis			Distance							
Measured Depth	Vertical Depth	Measured Depth	Vertical Depth	Reference	Offset	Highside Toolface	Offset Wellbore Centre		Between Centres	Between Ellipses	Total Uncertainty	Separation	Warning	
(ft)	(ft)	(ft)	(ft)	(ft)	(ft)	(°)	+N/-S (ft)	+E/-W (ft)	(ft)	(ft)	Axis	Factor		
0.0	0.0	0.0	0.0	0.0	0.0	-86.94	5.4	-100.9	101.1					
100.0	100.0	97.0	97.0	0.1	0.1	-86.94	5.4	-100.9	101.1	100.8	0.26	391.938		
200.0	200.0	197.0	197.0	0.3	0.3	-86.94	5.4	-100.9	101.1	100.5	0.61	166.884	CC	
227.8	227.8	224.8	224.8	0.4	0.3	173.06	5.4	-100.9	101.1	100.4	0.70	143.896		
300.0	300.0	297.0	297.0	0.5	0.5	173.07	5.4	-100.9	101.3	100.3	0.95	106.096	ES	
400.0	400.0	396.4	396.4	0.7	0.6	173.61	6.2	-101.1	103.3	102.0	1.30	79.264		
500.0	499.9	495.6	495.6	0.8	0.8	175.08	8.6	-101.8	107.6	106.0	1.65	65.088		
600.0	599.8	594.6	594.5	1.0	1.0	177.29	12.7	-103.0	114.5	112.5	2.01	56.980		
700.0	699.5	693.1	692.8	1.2	1.2	179.96	18.4	-104.6	123.9	121.6	2.37	52.291		
800.0	799.2	791.1	790.5	1.5	1.4	-177.15	25.6	-106.7	136.2	133.5	2.74	49.734		
900.0	898.6	889.5	888.5	1.7	1.6	-174.38	34.1	-109.1	151.1	148.0	3.11	48.585		
1,000.0	997.9	987.8	986.4	2.0	1.8	-172.15	42.6	-111.6	168.0	164.5	3.48	48.242	SF	
1,100.0	1,096.9	1,085.9	1,084.1	2.2	2.1	-170.40	51.1	-114.0	186.8	183.0	3.86	48.448		
1,200.0	1,195.7	1,183.7	1,181.5	2.6	2.3	-169.06	59.6	-116.4	207.5	203.2	4.23	49.034		
1,300.0	1,294.1	1,281.1	1,278.5	2.9	2.5	-168.03	68.0	-118.8	229.8	225.2	4.61	49.892		
1,400.0	1,392.3	1,378.1	1,375.1	3.3	2.7	-167.27	76.4	-121.2	253.9	249.0	4.98	50.951		
1,500.0	1,490.1	1,474.7	1,471.3	3.6	3.0	-166.70	84.8	-123.6	279.7	274.3	5.36	52.161		
1,600.0	1,587.5	1,570.8	1,567.0	4.1	3.2	-166.29	93.1	-126.0	307.1	301.4	5.74	53.489		
1,700.0	1,684.6	1,666.5	1,662.3	4.5	3.4	-166.01	101.4	-128.4	336.2	330.0	6.12	54.912		
1,800.0	1,781.2	1,761.7	1,757.1	5.0	3.6	-165.82	109.7	-130.7	366.8	360.3	6.50	56.412		
1,900.0	1,877.4	1,856.4	1,851.5	5.5	3.8	-163.88	117.9	-133.1	398.8	391.9	6.90	57.808		
2,000.0	1,973.5	1,951.2	1,945.9	6.0	4.1	-160.27	126.1	-135.4	430.5	423.2	7.32	58.801		
2,100.0	2,069.7	2,046.2	2,040.5	6.5	4.3	-156.85	134.3	-137.8	461.7	453.9	7.75	59.535		
2,200.0	2,165.8	2,141.3	2,135.2	7.0	4.5	-154.35	142.5	-140.1	492.3	484.1	8.19	60.089		

Cathedral Energy Services

Anticollision Report

Company:	EnCana Oil & Gas (USA) Inc	Local Co-ordinate Reference:	Well Woolley-Becky 2G-7H-E168
Project:	DJ Wattenberg	TVD Reference:	WELL @ 5022.0ft (Original Well Elev)
Reference Site:	S7-T1N-R68W (Woolley-Sosa/Becky)	MD Reference:	WELL @ 5022.0ft (Original Well Elev)
Site Error:	0.0ft	North Reference:	True
Reference Well:	Woolley-Becky 2G-7H-E168	Survey Calculation Method:	Minimum Curvature
Well Error:	0.0ft	Output errors are at	2.00 sigma
Reference Wellbore	Hz	Database:	USA EDM 5000 Multi Users DB
Reference Design:	Plan #1	Offset TVD Reference:	Offset Datum

Offset Design S7-T1N-R68W (Woolley-Sosa/Becky) - Woolley-Sosa 2C-7H-E168 - HZ - Plan #1													Offset Site Error: 0.0 ft	
Survey Program: 0-Geolink MWD													Offset Well Error: 0.0 ft	
Reference		Offset		Semi Major Axis			Distance							Warning
Measured Depth	Vertical Depth	Measured Depth	Vertical Depth	Reference	Offset	Highside Toolface	Offset Wellbore Centre	Between Centres	Between Ellipses	Total Uncertainty	Separation			
(ft)	(ft)	(ft)	(ft)	(ft)	(ft)	(°)	+N/-S (ft)	+E/-W (ft)	(ft)	(ft)	Axis	Factor		
0.0	0.0	0.0	0.0	0.0	0.0	-90.38	-0.6	-96.0	96.0					
100.0	100.0	97.0	97.0	0.1	0.1	-90.38	-0.6	-96.0	96.0	95.7	0.26	372.116		
200.0	200.0	197.0	197.0	0.3	0.3	-90.38	-0.6	-96.0	96.0	95.4	0.61	158.444	CC	
227.8	227.8	224.8	224.8	0.4	0.3	169.63	-0.6	-96.0	96.0	95.3	0.70	136.619		
300.0	300.0	297.0	297.0	0.5	0.5	169.65	-0.6	-96.0	96.2	95.2	0.95	100.739	ES	
400.0	400.0	397.0	397.0	0.7	0.6	169.83	-0.6	-96.0	97.9	96.6	1.30	75.095		
500.0	499.9	497.4	497.4	0.8	0.8	170.62	0.2	-95.7	101.1	99.5	1.65	61.148		
600.0	599.8	597.7	597.6	1.0	1.0	172.43	2.6	-95.0	105.6	103.6	2.01	52.674		
700.0	699.5	697.8	697.6	1.2	1.2	175.06	6.8	-93.8	111.7	109.3	2.36	47.263		
800.0	799.2	797.6	797.3	1.5	1.4	178.28	12.6	-92.2	119.4	116.7	2.73	43.766		
900.0	898.6	897.0	896.4	1.7	1.6	-178.15	20.1	-90.0	129.1	126.0	3.11	41.558		
1,000.0	997.9	996.0	995.0	2.0	1.8	-174.61	28.8	-87.6	140.9	137.4	3.49	40.341		
1,100.0	1,096.9	1,094.8	1,093.3	2.2	2.0	-171.68	37.5	-85.1	154.8	150.9	3.88	39.862	SF	
1,200.0	1,195.7	1,193.3	1,191.4	2.6	2.2	-169.33	46.2	-82.6	170.8	166.5	4.28	39.896		
1,300.0	1,294.1	1,291.5	1,289.2	2.9	2.5	-167.49	54.9	-80.1	188.7	184.0	4.68	40.289		
1,400.0	1,392.3	1,389.4	1,386.7	3.3	2.7	-166.06	63.6	-77.6	208.4	203.3	5.09	40.941		
1,500.0	1,490.1	1,487.0	1,483.9	3.6	2.9	-164.98	72.2	-75.2	229.8	224.3	5.50	41.782		
1,600.0	1,587.5	1,584.3	1,580.7	4.1	3.1	-164.18	80.8	-72.7	253.0	247.1	5.92	42.767		
1,700.0	1,684.6	1,681.1	1,677.2	4.5	3.4	-163.60	89.4	-70.3	277.8	271.5	6.33	43.865		
1,800.0	1,781.2	1,777.5	1,773.2	5.0	3.6	-163.19	97.9	-67.8	304.2	297.5	6.75	45.052		
1,900.0	1,877.4	1,873.6	1,868.8	5.5	3.8	-161.12	106.4	-65.4	332.0	324.8	7.19	46.173		
2,000.0	1,973.5	1,969.8	1,964.6	6.0	4.0	-157.47	114.9	-63.0	359.4	351.7	7.65	46.957		
2,100.0	2,069.7	2,066.1	2,060.5	6.5	4.3	-154.05	123.4	-60.5	386.1	378.0	8.13	47.520		
2,200.0	2,165.8	2,162.6	2,156.6	7.0	4.5	-151.58	132.0	-58.1	412.3	403.7	8.60	47.936		
2,300.0	2,261.9	2,259.1	2,252.7	7.5	4.7	-152.11	140.5	-55.7	438.2	429.1	9.06	48.365		
2,400.0	2,358.1	2,355.6	2,348.8	8.0	4.9	-152.58	149.0	-53.2	464.2	454.7	9.52	48.753		
2,500.0	2,454.2	2,452.1	2,444.8	8.5	5.2	-153.00	157.6	-50.8	490.2	480.2	9.98	49.104		

Cathedral Energy Services

Anticollision Report

Company:	EnCana Oil & Gas (USA) Inc	Local Co-ordinate Reference:	Well Woolley-Becky 2G-7H-E168
Project:	DJ Wattenberg	TVD Reference:	WELL @ 5022.0ft (Original Well Elev)
Reference Site:	S7-T1N-R68W (Woolley-Sosa/Becky)	MD Reference:	WELL @ 5022.0ft (Original Well Elev)
Site Error:	0.0ft	North Reference:	True
Reference Well:	Woolley-Becky 2G-7H-E168	Survey Calculation Method:	Minimum Curvature
Well Error:	0.0ft	Output errors are at	2.00 sigma
Reference Wellbore	Hz	Database:	USA EDM 5000 Multi Users DB
Reference Design:	Plan #1	Offset TVD Reference:	Offset Datum

Offset Design S7-T1N-R68W (Woolley-Sosa/Becky) - Woolley-Sosa 2D-7H-E168 - HZ - Plan #1													Offset Site Error: 0.0 ft	
Survey Program: 0-Geolink MWD													Offset Well Error: 0.0 ft	
Reference		Offset		Semi Major Axis			Distance							Warning
Measured Depth	Vertical Depth	Measured Depth	Vertical Depth	Reference	Offset	Highside Toolface	Offset Wellbore Centre	Between Centres	Between Ellipses	Total Uncertainty	Separation			
(ft)	(ft)	(ft)	(ft)	(ft)	(ft)	(°)	+N/-S (ft)	+E/-W (ft)	(ft)	(ft)	Axis	Factor		
0.0	0.0	0.0	0.0	0.0	0.0	-86.64	5.3	-90.9	91.1					
100.0	100.0	97.0	97.0	0.1	0.1	-86.64	5.3	-90.9	91.1	90.8	0.26	353.210		
200.0	200.0	197.0	197.0	0.3	0.3	-86.64	5.3	-90.9	91.1	90.5	0.61	150.394	CC	
227.8	227.8	224.8	224.8	0.4	0.3	173.37	5.3	-90.9	91.1	90.4	0.70	129.682		
300.0	300.0	297.0	297.0	0.5	0.5	173.38	5.3	-90.9	91.3	90.3	0.95	95.635	ES	
400.0	400.0	397.0	397.0	0.7	0.6	173.50	5.3	-90.9	93.0	91.7	1.30	71.372		
500.0	499.9	496.9	496.9	0.8	0.8	173.73	5.3	-90.9	96.5	94.8	1.65	58.415		
600.0	599.8	597.8	597.8	1.0	1.0	174.44	6.0	-90.4	101.2	99.2	2.00	50.570		
700.0	699.5	698.6	698.5	1.2	1.2	175.96	8.0	-88.8	106.8	104.4	2.35	45.373		
800.0	799.2	799.3	799.2	1.5	1.4	178.14	11.5	-86.0	113.2	110.5	2.71	41.808		
900.0	898.6	899.9	899.5	1.7	1.6	-179.18	16.2	-82.2	120.7	117.6	3.07	39.324		
1,000.0	997.9	1,000.2	999.6	2.0	1.8	-176.16	22.4	-77.3	129.4	126.0	3.44	37.589		
1,100.0	1,096.9	1,100.4	1,099.3	2.2	2.0	-172.93	29.9	-71.3	139.5	135.7	3.83	36.385		
1,200.0	1,195.7	1,199.9	1,198.2	2.6	2.2	-169.69	38.6	-64.3	151.2	146.9	4.25	35.603		
1,300.0	1,294.1	1,298.7	1,296.3	2.9	2.5	-166.94	47.5	-57.2	164.8	160.1	4.67	35.284	SF	
1,400.0	1,392.3	1,397.3	1,394.2	3.3	2.7	-164.74	56.4	-50.1	180.4	175.3	5.11	35.318		
1,500.0	1,490.1	1,495.6	1,491.9	3.6	2.9	-163.03	65.3	-43.0	197.9	192.4	5.56	35.613		
1,600.0	1,587.5	1,593.6	1,589.2	4.1	3.2	-161.72	74.1	-36.0	217.2	211.1	6.02	36.103		
1,700.0	1,684.6	1,691.3	1,686.3	4.5	3.4	-160.75	82.9	-28.9	238.1	231.6	6.48	36.745		
1,800.0	1,781.2	1,788.7	1,783.0	5.0	3.7	-160.05	91.7	-21.9	260.7	253.8	6.95	37.507		
1,900.0	1,877.4	1,885.8	1,879.5	5.5	3.9	-157.78	100.4	-14.9	284.6	277.2	7.44	38.253		
2,000.0	1,973.5	1,983.0	1,976.0	6.0	4.2	-154.03	109.2	-7.9	308.1	300.1	7.96	38.723		
2,100.0	2,069.7	2,080.4	2,072.8	6.5	4.4	-150.56	118.0	-0.9	330.8	322.3	8.48	39.015		
2,200.0	2,165.8	2,177.9	2,169.6	7.0	4.7	-148.07	126.8	6.1	352.8	343.8	9.00	39.195		
2,300.0	2,261.9	2,275.4	2,266.5	7.5	5.0	-148.57	135.6	13.2	374.5	365.0	9.51	39.398		
2,400.0	2,358.1	2,373.0	2,363.4	8.0	5.2	-149.00	144.4	20.2	396.3	386.3	10.01	39.578		
2,500.0	2,454.2	2,470.5	2,460.3	8.5	5.5	-149.40	153.2	27.2	418.1	407.6	10.52	39.739		
2,600.0	2,550.3	2,568.1	2,557.2	9.1	5.7	-149.75	162.0	34.2	439.9	428.9	11.03	39.884		
2,700.0	2,646.4	2,665.7	2,654.1	9.6	6.0	-150.07	170.8	41.3	461.8	450.2	11.54	40.015		
2,800.0	2,742.6	2,763.2	2,751.0	10.1	6.2	-150.36	179.5	48.3	483.6	471.6	12.05	40.134		

Cathedral Energy Services

Anticollision Report

Company:	EnCana Oil & Gas (USA) Inc	Local Co-ordinate Reference:	Well Woolley-Becky 2G-7H-E168
Project:	DJ Wattenberg	TVD Reference:	WELL @ 5022.0ft (Original Well Elev)
Reference Site:	S7-T1N-R68W (Woolley-Sosa/Becky)	MD Reference:	WELL @ 5022.0ft (Original Well Elev)
Site Error:	0.0ft	North Reference:	True
Reference Well:	Woolley-Becky 2G-7H-E168	Survey Calculation Method:	Minimum Curvature
Well Error:	0.0ft	Output errors are at	2.00 sigma
Reference Wellbore	Hz	Database:	USA EDM 5000 Multi Users DB
Reference Design:	Plan #1	Offset TVD Reference:	Offset Datum

Offset Design S7-T1N-R68W (Woolley-Sosa/Becky) - Woolley-Sosa 2E-7H-E168 - HZ - Plan #1													Offset Site Error:	0.0 ft
Survey Program: 0-Geolink MWD													Offset Well Error:	0.0 ft
Reference		Offset		Semi Major Axis		Highside Tooface (")	Distance		Total Uncertainty Axis	Separation Factor	Warning			
Measured Depth (ft)	Vertical Depth (ft)	Measured Depth (ft)	Vertical Depth (ft)	Reference (ft)	Offset (ft)		Offset Wellbore Centre +N/-S (ft)	+E/-W (ft)						
0.0	0.0	0.0	0.0	0.0	0.0	-90.55	-0.7	-76.0	76.0					
100.0	100.0	97.0	97.0	0.1	0.1	-90.55	-0.7	-76.0	76.0	75.7	294.564			
200.0	200.0	197.0	197.0	0.3	0.3	-90.55	-0.7	-76.0	76.0	75.4	0.61	125.423 CC		
227.8	227.8	224.8	224.8	0.4	0.3	169.45	-0.7	-76.0	76.0	75.3	0.70	108.156		
300.0	300.0	297.0	297.0	0.5	0.5	169.48	-0.7	-76.0	76.2	75.2	0.95	79.791 ES		
400.0	400.0	397.0	397.0	0.7	0.6	169.71	-0.7	-76.0	77.9	76.6	1.30	59.753		
500.0	499.9	496.9	496.9	0.8	0.8	170.14	-0.7	-76.0	81.3	79.7	1.65	49.224		
600.0	599.8	596.8	596.8	1.0	1.0	170.73	-0.7	-76.0	86.5	84.5	2.00	43.235		
700.0	699.5	696.5	696.5	1.2	1.2	171.41	-0.7	-76.0	93.4	91.0	2.35	39.769		
800.0	799.2	796.2	796.2	1.5	1.3	172.13	-0.7	-76.0	102.0	99.3	2.69	37.852		
900.0	898.6	895.6	895.6	1.7	1.5	172.84	-0.7	-76.0	112.4	109.3	3.04	36.956		
1,000.0	997.9	994.9	994.9	2.0	1.7	173.53	-0.7	-76.0	124.5	121.1	3.39	36.771		
1,100.0	1,096.9	1,093.6	1,093.6	2.2	1.9	174.40	-0.2	-75.3	137.7	134.0	3.73	36.916		
1,200.0	1,195.7	1,196.5	1,196.5	2.6	2.0	175.62	1.3	-73.3	151.4	147.4	4.08	37.159		
1,300.0	1,294.1	1,297.4	1,297.3	2.9	2.2	177.11	3.9	-69.8	165.7	161.3	4.42	37.483		
1,400.0	1,392.3	1,398.3	1,398.0	3.3	2.4	178.79	7.6	-64.9	180.5	175.8	4.77	37.868		
1,500.0	1,490.1	1,499.2	1,498.6	3.6	2.6	-179.40	12.4	-58.6	196.1	190.9	5.12	38.289		
1,600.0	1,587.5	1,600.1	1,599.0	4.1	2.8	-177.51	18.2	-50.9	212.3	206.8	5.48	38.720		
1,700.0	1,684.6	1,700.8	1,699.1	4.5	3.0	-175.56	25.1	-41.8	229.4	223.5	5.86	39.128		
1,800.0	1,781.2	1,801.4	1,798.8	5.0	3.3	-173.60	33.1	-31.3	247.3	241.1	6.26	39.483		
1,900.0	1,877.4	1,902.0	1,898.3	5.5	3.6	-169.85	42.0	-19.5	266.0	259.3	6.71	39.646		
2,000.0	1,973.5	2,001.4	1,996.3	6.0	3.8	-164.60	51.8	-6.6	283.8	276.6	7.20	39.434		
2,100.0	2,069.7	2,099.7	2,093.3	6.5	4.1	-159.85	61.6	6.4	301.3	293.5	7.71	39.081		
2,200.0	2,165.8	2,198.2	2,190.4	7.0	4.4	-156.26	71.4	19.3	318.3	310.0	8.23	38.649		
2,300.0	2,261.9	2,296.7	2,287.6	7.5	4.7	-155.75	81.2	32.3	335.1	326.4	8.76	38.245		
2,400.0	2,358.1	2,395.2	2,384.8	8.0	5.0	-155.30	91.0	45.2	352.0	342.7	9.30	37.841		
2,500.0	2,454.2	2,493.8	2,482.0	8.5	5.3	-154.88	100.8	58.2	368.9	359.0	9.85	37.443		
2,600.0	2,550.3	2,592.3	2,579.1	9.1	5.6	-154.50	110.6	71.1	385.8	375.4	10.41	37.057		
2,700.0	2,646.4	2,690.8	2,676.3	9.6	5.9	-154.15	120.4	84.1	402.8	391.8	10.98	36.686		
2,800.0	2,742.6	2,789.3	2,773.5	10.1	6.2	-153.83	130.3	97.0	419.7	408.2	11.55	36.331		
2,900.0	2,838.7	2,887.9	2,870.7	10.6	6.6	-153.54	140.1	110.0	436.7	424.5	12.13	35.993		
3,000.0	2,934.8	2,986.4	2,967.9	11.1	6.9	-153.27	149.9	122.9	453.6	440.9	12.72	35.672		
3,100.0	3,031.0	3,084.9	3,065.0	11.7	7.2	-153.01	159.7	135.9	470.6	457.3	13.31	35.368		
3,200.0	3,127.1	3,183.5	3,162.2	12.2	7.5	-152.47	169.5	148.8	487.6	473.7	13.90	35.068 SF		

Cathedral Energy Services

Anticollision Report

Company:	EnCana Oil & Gas (USA) Inc	Local Co-ordinate Reference:	Well Woolley-Becky 2G-7H-E168
Project:	DJ Wattenberg	TVD Reference:	WELL @ 5022.0ft (Original Well Elev)
Reference Site:	S7-T1N-R68W (Woolley-Sosa/Becky)	MD Reference:	WELL @ 5022.0ft (Original Well Elev)
Site Error:	0.0ft	North Reference:	True
Reference Well:	Woolley-Becky 2G-7H-E168	Survey Calculation Method:	Minimum Curvature
Well Error:	0.0ft	Output errors are at	2.00 sigma
Reference Wellbore	Hz	Database:	USA EDM 5000 Multi Users DB
Reference Design:	Plan #1	Offset TVD Reference:	Offset Datum

Offset Design S7-T1N-R68W (Woolley-Sosa/Becky) - Woolley-Sosa 2F-7H-E168 - HZ - Plan #1													Offset Site Error:	0.0 ft
Survey Program: O-Geolink MWD													Offset Well Error:	0.0 ft
Reference		Offset		Semi Major Axis		Distance		Total		Separation		Warning		
Measured Depth (ft)	Vertical Depth (ft)	Measured Depth (ft)	Vertical Depth (ft)	Reference (ft)	Offset (ft)	Highside Toolface (°)	Offset Wellbore Centre +N/-S (ft)	+E/-W (ft)	Between Centres (ft)	Between Ellipses (ft)	Uncertainty Axis			
0.0	0.0	0.0	0.0	0.0	0.0	-85.77	5.2	-70.9	71.2					
100.0	100.0	97.0	97.0	0.1	0.1	-85.77	5.2	-70.9	71.1	70.9	0.26	275.795		
200.0	200.0	197.0	197.0	0.3	0.3	-85.77	5.2	-70.9	71.1	70.5	0.61	117.432 CC		
227.8	227.8	224.8	224.8	0.4	0.3	174.23	5.2	-70.9	71.2	70.5	0.70	101.270		
300.0	300.0	297.0	297.0	0.5	0.5	174.25	5.2	-70.9	71.3	70.4	0.95	74.724 ES		
400.0	400.0	398.0	398.0	0.7	0.7	174.74	5.6	-70.2	72.4	71.1	1.31	55.436		
500.0	499.9	499.1	499.0	0.8	0.8	176.09	6.9	-67.9	73.7	72.0	1.66	44.462		
600.0	599.8	600.1	600.0	1.0	1.0	178.24	8.9	-64.0	75.4	73.3	2.01	37.460		
700.0	699.5	701.1	700.7	1.2	1.2	-178.90	11.8	-58.5	77.5	75.1	2.37	32.681		
800.0	799.2	802.0	801.3	1.5	1.4	-175.44	15.6	-51.5	80.2	77.5	2.74	29.280		
900.0	898.6	902.8	901.7	1.7	1.7	-171.52	20.1	-43.0	83.8	80.6	3.13	26.791		
1,000.0	997.9	1,003.5	1,001.7	2.0	1.9	-167.28	25.5	-32.8	88.2	84.7	3.54	24.928		
1,100.0	1,096.9	1,104.1	1,101.4	2.2	2.2	-162.90	31.7	-21.2	93.7	89.8	3.99	23.505		
1,200.0	1,195.7	1,204.5	1,200.7	2.6	2.5	-158.52	38.7	-8.0	100.5	96.0	4.49	22.396		
1,300.0	1,294.1	1,304.8	1,299.6	2.9	2.8	-154.26	46.5	6.7	108.5	103.4	5.04	21.518		
1,400.0	1,392.3	1,404.8	1,397.9	3.3	3.2	-150.24	55.1	22.8	117.8	112.2	5.66	20.823		
1,500.0	1,490.1	1,503.9	1,495.3	3.6	3.5	-146.93	63.9	39.5	128.9	122.6	6.31	20.425		
1,600.0	1,587.5	1,603.0	1,592.5	4.1	3.9	-144.55	72.8	56.1	141.7	134.7	6.98	20.294		
1,700.0	1,684.6	1,701.8	1,689.6	4.5	4.2	-142.92	81.6	72.7	156.0	148.4	7.67	20.355		
1,800.0	1,781.2	1,800.5	1,786.5	5.0	4.6	-141.91	90.4	89.3	171.8	163.5	8.36	20.558		
1,900.0	1,877.4	1,899.1	1,883.2	5.5	4.9	-139.64	99.2	105.9	188.7	179.6	9.07	20.814		
2,000.0	1,973.5	1,997.8	1,980.1	6.0	5.3	-136.02	108.0	122.5	204.7	194.9	9.79	20.903		
2,100.0	2,069.7	2,096.7	2,077.2	6.5	5.7	-132.73	116.9	139.1	219.5	208.9	10.52	20.866		
2,200.0	2,165.8	2,195.8	2,174.5	7.0	6.0	-130.45	125.7	155.7	233.1	221.8	11.24	20.745		
2,300.0	2,261.9	2,294.8	2,271.7	7.5	6.4	-131.07	134.5	172.4	246.3	234.4	11.94	20.638		
2,400.0	2,358.1	2,393.9	2,369.0	8.0	6.8	-131.63	143.4	189.0	259.6	247.0	12.64	20.544		
2,500.0	2,454.2	2,493.0	2,466.3	8.5	7.1	-132.13	152.2	205.7	272.9	259.6	13.34	20.462		
2,600.0	2,550.3	2,592.1	2,563.6	9.1	7.5	-132.59	161.1	222.3	286.2	272.2	14.04	20.389		
2,700.0	2,646.4	2,691.2	2,660.8	9.6	7.9	-133.01	169.9	239.0	299.6	284.8	14.74	20.324		
2,800.0	2,742.6	2,790.3	2,758.1	10.1	8.3	-133.39	178.8	255.6	312.9	297.5	15.44	20.265		
2,900.0	2,838.7	2,889.3	2,855.4	10.6	8.6	-133.74	187.6	272.3	326.3	310.1	16.14	20.213		
3,000.0	2,934.8	2,988.4	2,952.7	11.1	9.0	-134.06	196.5	288.9	339.6	322.8	16.84	20.166		
3,100.0	3,031.0	3,087.5	3,049.9	11.7	9.4	-134.36	205.3	305.6	353.0	335.5	17.54	20.123		
3,200.0	3,127.1	3,186.6	3,147.2	12.2	9.7	-134.33	214.2	322.2	366.4	348.1	18.25	20.080		
3,300.0	3,223.5	3,285.8	3,244.6	12.7	10.1	-132.91	223.0	338.9	378.6	359.7	18.96	19.976		
3,400.0	3,320.3	3,385.3	3,342.3	13.1	10.5	-131.17	231.9	355.6	389.3	369.6	19.67	19.793		
3,500.0	3,417.5	3,484.9	3,440.0	13.6	10.9	-129.09	240.8	372.3	398.2	377.9	20.38	19.538		
3,600.0	3,515.0	3,584.6	3,537.9	14.0	11.2	-126.63	249.7	389.1	405.6	384.5	21.10	19.219		
3,700.0	3,612.9	3,684.4	3,635.9	14.4	11.6	-123.74	258.6	405.9	411.3	389.4	21.83	18.843		
3,800.0	3,710.8	3,784.3	3,734.0	14.8	12.0	-123.50	267.5	422.6	416.1	393.5	22.56	18.444		
3,900.0	3,808.8	3,884.2	3,832.0	15.1	12.4	-123.33	276.5	439.4	420.9	397.7	23.30	18.070		
4,000.0	3,906.8	3,984.0	3,930.1	15.5	12.8	-123.15	285.4	456.2	425.8	401.8	24.03	17.718		
4,100.0	4,004.8	4,083.9	4,028.1	15.9	13.1	-122.98	294.3	473.0	430.6	405.9	24.77	17.386		
4,200.0	4,102.8	4,183.8	4,126.2	16.3	13.5	-122.82	303.2	489.8	435.5	410.0	25.51	17.073		
4,300.0	4,200.7	4,283.7	4,224.2	16.7	13.9	-122.66	312.1	506.5	440.4	414.1	26.25	16.778		
4,400.0	4,298.7	4,383.5	4,322.3	17.1	14.3	-122.50	321.1	523.3	445.2	418.2	26.99	16.498		
4,500.0	4,396.7	4,483.4	4,420.3	17.5	14.6	-122.34	330.0	540.1	450.1	422.4	27.73	16.233		
4,600.0	4,494.7	4,583.3	4,518.4	17.9	15.0	-122.19	338.9	556.9	454.9	426.5	28.47	15.981		
4,700.0	4,592.6	4,683.2	4,616.4	18.2	15.4	-122.04	347.8	573.7	459.8	430.6	29.21	15.742		
4,800.0	4,690.6	4,783.0	4,714.5	18.6	15.8	-121.90	356.7	590.4	464.7	434.7	29.95	15.514		
4,900.0	4,788.6	4,882.9	4,812.5	19.0	16.1	-121.76	365.6	607.2	469.6	438.9	30.70	15.297		
5,000.0	4,886.6	4,982.8	4,910.6	19.4	16.5	-121.62	374.6	624.0	474.4	443.0	31.44	15.091		

CC - Min centre to center distance or convergent point, SF - min separation factor, ES - min ellipse separation

Cathedral Energy Services

Anticollision Report

Company:	EnCana Oil & Gas (USA) Inc	Local Co-ordinate Reference:	Well Woolley-Becky 2G-7H-E168
Project:	DJ Wattenberg	TVD Reference:	WELL @ 5022.0ft (Original Well Elev)
Reference Site:	S7-T1N-R68W (Woolley-Sosa/Becky)	MD Reference:	WELL @ 5022.0ft (Original Well Elev)
Site Error:	0.0ft	North Reference:	True
Reference Well:	Woolley-Becky 2G-7H-E168	Survey Calculation Method:	Minimum Curvature
Well Error:	0.0ft	Output errors are at	2.00 sigma
Reference Wellbore	Hz	Database:	USA EDM 5000 Multi Users DB
Reference Design:	Plan #1	Offset TVD Reference:	Offset Datum

Offset Design										S7-T1N-R68W (Woolley-Sosa/Becky) - Woolley-Sosa 2F-7H-E168 - HZ - Plan #1				Offset Site Error:		0.0 ft
Survey Program:										0-Geolink MWD				Offset Well Error:		0.0 ft
Reference		Offset		Semi Major Axis			Distance							Warning		
Measured Depth	Vertical Depth	Measured Depth	Vertical Depth	Reference	Offset	Highside Toolface	Offset Wellbore Centre	Between Centres	Between Ellipses	Total Uncertainty	Separation Factor					
(ft)	(ft)	(ft)	(ft)	(ft)	(ft)	(°)	+N/-S (ft)	+E/-W (ft)	(ft)	(ft)	Axis					
5,100.0	4,984.6	5,082.7	5,008.6	19.8	16.9	-121.48	383.5	640.8	479.3	447.1	32.18	14.893				
5,200.0	5,082.5	5,182.5	5,106.7	20.2	17.3	-121.35	392.4	657.6	484.2	451.3	32.93	14.705				
5,300.0	5,180.5	5,282.4	5,204.7	20.6	17.7	-121.22	401.3	674.3	489.1	455.4	33.67	14.524				
5,400.0	5,278.5	5,382.3	5,302.8	21.0	18.0	-121.09	410.2	691.1	494.0	459.6	34.42	14.352				
5,500.0	5,376.5	5,482.2	5,400.8	21.4	18.4	-120.96	419.2	707.9	498.9	463.7	35.17	14.186				
7,600.0	7,430.4	7,903.9	7,680.9	29.6	25.4	-113.90	297.7	1,098.1	458.9	428.9	30.00	15.294				
7,700.0	7,519.4	7,916.4	7,687.0	30.1	25.4	-110.85	286.9	1,099.2	422.7	394.0	28.76	14.697				
7,800.0	7,600.0	7,906.4	7,682.1	30.6	25.4	-106.39	295.6	1,098.3	407.9	378.6	29.26	13.938				
7,813.4	7,610.0	7,904.0	7,680.9	30.6	25.4	-105.63	297.7	1,098.1	407.7	378.2	29.43	13.851				
7,900.0	7,669.6	7,884.3	7,670.8	31.1	25.4	-99.87	314.4	1,096.4	416.1	385.2	30.87	13.476				
8,000.0	7,726.2	7,850.0	7,651.8	31.7	25.4	-90.95	342.8	1,093.2	443.9	410.8	33.12	13.405 SF				
8,100.0	7,768.1	7,821.3	7,634.7	32.3	25.5	-82.27	365.7	1,090.2	485.2	451.0	34.25	14.167				

Cathedral Energy Services

Anticollision Report

Company:	EnCana Oil & Gas (USA) Inc	Local Co-ordinate Reference:	Well Woolley-Becky 2G-7H-E168
Project:	DJ Wattenberg	TVD Reference:	WELL @ 5022.0ft (Original Well Elev)
Reference Site:	S7-T1N-R68W (Woolley-Sosa/Becky)	MD Reference:	WELL @ 5022.0ft (Original Well Elev)
Site Error:	0.0ft	North Reference:	True
Reference Well:	Woolley-Becky 2G-7H-E168	Survey Calculation Method:	Minimum Curvature
Well Error:	0.0ft	Output errors are at	2.00 sigma
Reference Wellbore	Hz	Database:	USA EDM 5000 Multi Users DB
Reference Design:	Plan #1	Offset TVD Reference:	Offset Datum

Offset Design S7-T1N-R68W (Woolley-Sosa/Becky) - Woolley-Sosa 2G-7H-E168 - HZ - Plan #1													Offset Site Error: 0.0 ft	
Survey Program: O-Geolink MWD													Offset Well Error: 0.0 ft	
Reference		Offset		Semi Major Axis			Distance							Warning
Measured Depth (ft)	Vertical Depth (ft)	Measured Depth (ft)	Vertical Depth (ft)	Reference (ft)	Offset (ft)	Highside Toolface (°)	Offset Wellbore Centre +N/-S (ft)	+E/-W (ft)	Between Centres (ft)	Between Ellipses (ft)	Total Uncertainty Axis	Separation Factor		
0.0	0.0	0.0	0.0	0.0	0.0	-90.68	-0.8	-66.0	66.0					
100.0	100.0	97.0	97.0	0.1	0.1	-90.68	-0.8	-66.0	66.0	65.7	0.26	255.790		
200.0	200.0	197.0	197.0	0.3	0.3	-90.68	-0.8	-66.0	66.0	65.4	0.61	108.914		
300.0	300.0	298.0	298.0	0.5	0.5	169.63	-0.5	-65.2	65.4	64.4	0.96	68.370		
400.0	400.0	399.1	399.1	0.7	0.7	170.78	0.5	-62.8	64.7	63.4	1.31	49.477		
500.0	499.9	500.1	500.0	0.8	0.8	172.82	2.2	-58.7	64.2	62.5	1.66	38.644		
600.0	599.8	601.1	600.7	1.0	1.1	175.77	4.6	-53.0	63.9	61.9	2.02	31.683		
620.2	619.9	621.4	621.0	1.1	1.1	176.47	5.1	-51.6	63.9	61.8	2.09	30.573 CC		
700.0	699.5	701.9	701.3	1.2	1.3	179.58	7.6	-45.6	64.1	61.7	2.38	26.904		
800.0	799.2	802.7	801.6	1.5	1.5	-175.83	11.3	-36.7	64.8	62.1	2.76	23.488		
900.0	898.6	903.5	901.7	1.7	1.8	-170.60	15.6	-26.1	66.4	63.2	3.16	20.984		
1,000.0	997.9	1,004.1	1,001.4	2.0	2.0	-164.94	20.6	-13.9	68.9	65.3	3.61	19.118		
1,100.0	1,096.9	1,104.5	1,100.8	2.2	2.3	-159.11	26.3	-0.1	72.7	68.6	4.10	17.715		
1,200.0	1,195.7	1,204.9	1,199.7	2.6	2.7	-153.36	32.6	15.3	77.7	73.0	4.67	16.657		
1,300.0	1,294.1	1,305.0	1,298.2	2.9	3.0	-147.91	39.6	32.3	84.1	78.8	5.30	15.870		
1,400.0	1,392.3	1,405.0	1,396.2	3.3	3.4	-142.88	47.2	50.8	92.0	86.0	6.01	15.295		
1,500.0	1,490.1	1,504.9	1,493.6	3.6	3.8	-138.36	55.4	70.9	101.2	94.4	6.79	14.890		
1,600.0	1,587.5	1,604.3	1,590.3	4.1	4.2	-134.50	64.2	92.2	111.8	104.2	7.63	14.658		
1,700.0	1,684.6	1,703.4	1,686.7	4.5	4.7	-131.82	73.0	113.6	123.9	115.4	8.47	14.628		
1,800.0	1,781.2	1,802.4	1,783.0	5.0	5.1	-130.15	81.7	135.0	137.4	128.0	9.32	14.735		
1,900.0	1,877.4	1,901.4	1,879.2	5.5	5.5	-127.53	90.5	156.3	151.7	141.5	10.18	14.893		
2,000.0	1,973.5	2,000.5	1,975.6	6.0	6.0	-123.66	99.3	177.7	164.9	153.8	11.06	14.903		
2,100.0	2,069.7	2,099.8	2,072.2	6.5	6.4	-120.15	108.1	199.2	176.6	164.7	11.94	14.787		
2,200.0	2,165.8	2,199.3	2,168.9	7.0	6.8	-117.64	116.9	220.6	186.9	174.1	12.82	14.582		
2,300.0	2,261.9	2,298.8	2,265.6	7.5	7.3	-118.04	125.8	242.1	196.8	183.1	13.68	14.381		
2,400.0	2,358.1	2,398.3	2,362.4	8.0	7.7	-118.39	134.6	263.6	206.7	192.1	14.55	14.202		
2,500.0	2,454.2	2,497.8	2,459.2	8.5	8.2	-118.72	143.4	285.1	216.5	201.1	15.42	14.043		
2,600.0	2,550.3	2,597.3	2,555.9	9.1	8.6	-119.01	152.2	306.5	226.4	210.1	16.29	13.900		
2,700.0	2,646.4	2,696.8	2,652.7	9.6	9.1	-119.28	161.0	328.0	236.3	219.1	17.16	13.770		
2,800.0	2,742.6	2,796.3	2,749.4	10.1	9.5	-119.53	169.9	349.5	246.2	228.2	18.03	13.653		
2,900.0	2,838.7	2,895.8	2,846.2	10.6	10.0	-119.76	178.7	371.0	256.1	237.2	18.91	13.547		
3,000.0	2,934.8	2,995.3	2,942.9	11.1	10.4	-119.97	187.5	392.4	266.0	246.2	19.78	13.450		
3,100.0	3,031.0	3,094.8	3,039.7	11.7	10.8	-120.17	196.3	413.9	275.9	255.3	20.65	13.361		
3,200.0	3,127.1	3,194.3	3,136.5	12.2	11.3	-120.05	205.1	435.4	285.8	264.3	21.53	13.277		
3,300.0	3,223.5	3,293.9	3,233.3	12.7	11.7	-118.48	214.0	456.9	294.7	272.3	22.40	13.154		
3,400.0	3,320.3	3,393.6	3,330.3	13.1	12.2	-116.50	222.8	478.4	302.2	278.9	23.29	12.974		
3,500.0	3,417.5	3,493.4	3,427.3	13.6	12.6	-114.09	231.7	500.0	308.2	284.0	24.18	12.744		
3,600.0	3,515.0	3,593.3	3,524.4	14.0	13.1	-111.22	240.5	521.5	312.7	287.7	25.08	12.470		
3,700.0	3,612.9	3,693.2	3,621.6	14.4	13.5	-107.82	249.4	543.1	315.9	289.9	25.98	12.157		
3,800.0	3,710.8	3,793.1	3,718.7	14.8	14.0	-107.03	258.2	564.6	318.4	291.5	26.91	11.833		
3,900.0	3,808.8	3,892.9	3,815.8	15.1	14.4	-106.31	267.1	586.2	320.9	293.1	27.83	11.532		
4,000.0	3,906.8	3,992.8	3,912.9	15.5	14.9	-105.60	275.9	607.7	323.5	294.7	28.75	11.253		
4,100.0	4,004.8	4,092.7	4,010.1	15.9	15.3	-104.90	284.8	629.3	326.1	296.4	29.67	10.992		
4,200.0	4,102.8	4,192.6	4,107.2	16.3	15.8	-104.21	293.7	650.9	328.8	298.2	30.58	10.750		
4,300.0	4,200.7	4,292.5	4,204.3	16.7	16.2	-103.53	302.5	672.4	331.5	300.0	31.50	10.524		
4,400.0	4,298.7	4,392.4	4,301.5	17.1	16.7	-102.86	311.4	694.0	334.3	301.8	32.41	10.312		
4,500.0	4,396.7	4,492.3	4,398.6	17.5	17.1	-102.21	320.2	715.5	337.1	303.7	33.32	10.115		
4,600.0	4,494.7	4,592.2	4,495.7	17.9	17.6	-101.56	329.1	737.1	339.9	305.7	34.23	9.929		
4,700.0	4,592.6	4,692.0	4,592.8	18.2	18.0	-100.93	337.9	758.7	342.8	307.7	35.14	9.755		
4,800.0	4,690.6	4,791.9	4,690.0	18.6	18.5	-100.31	346.8	780.2	345.8	309.7	36.05	9.592		
4,900.0	4,788.6	4,891.8	4,787.1	19.0	18.9	-99.70	355.6	801.8	348.7	311.8	36.95	9.439		
5,000.0	4,886.6	4,991.7	4,884.2	19.4	19.4	-99.09	364.5	823.3	351.7	313.9	37.85	9.294		

CC - Min centre to center distance or convergent point, SF - min separation factor, ES - min ellipse separation

Cathedral Energy Services

Anticollision Report

Company:	EnCana Oil & Gas (USA) Inc	Local Co-ordinate Reference:	Well Woolley-Becky 2G-7H-E168
Project:	DJ Wattenberg	TVD Reference:	WELL @ 5022.0ft (Original Well Elev)
Reference Site:	S7-T1N-R68W (Woolley-Sosa/Becky)	MD Reference:	WELL @ 5022.0ft (Original Well Elev)
Site Error:	0.0ft	North Reference:	True
Reference Well:	Woolley-Becky 2G-7H-E168	Survey Calculation Method:	Minimum Curvature
Well Error:	0.0ft	Output errors are at	2.00 sigma
Reference Wellbore	Hz	Database:	USA EDM 5000 Multi Users DB
Reference Design:	Plan #1	Offset TVD Reference:	Offset Datum

Offset Design S7-T1N-R68W (Woolley-Sosa/Becky) - Woolley-Sosa 2G-7H-E168 - HZ - Plan #1													Offset Site Error: 0.0 ft	
Survey Program: 0-Geolink MWD													Offset Well Error: 0.0 ft	
Reference		Offset		Semi Major Axis			Distance							Warning
Measured Depth (ft)	Vertical Depth (ft)	Measured Depth (ft)	Vertical Depth (ft)	Reference (ft)	Offset (ft)	Highside Toolface (°)	Offset Wellbore Centre +N/-S (ft)	+E/-W (ft)	Between Centres (ft)	Between Ellipses (ft)	Total Uncertainty Axis	Separation Factor		
5,100.0	4,984.6	5,091.6	4,981.4	19.8	19.8	-98.50	373.4	844.9	354.8	316.1	38.74	9.158		
5,200.0	5,082.5	5,191.5	5,078.5	20.2	20.3	-97.92	382.2	866.5	357.9	318.3	39.63	9.030		
5,300.0	5,180.5	5,291.4	5,175.6	20.6	20.7	-97.35	391.1	888.0	361.0	320.5	40.52	8.909		
5,400.0	5,278.5	5,391.2	5,272.8	21.0	21.2	-96.79	399.9	909.6	364.2	322.8	41.41	8.794		
5,500.0	5,376.5	5,491.1	5,369.9	21.4	21.6	-96.23	408.8	931.1	367.4	325.1	42.29	8.686		
5,600.0	5,474.5	5,591.0	5,467.0	21.8	22.1	-95.69	417.6	952.7	370.6	327.4	43.17	8.584		
5,700.0	5,572.4	5,690.9	5,564.1	22.1	22.5	-95.16	426.5	974.3	373.9	329.8	44.05	8.487		
5,800.0	5,670.4	5,790.8	5,661.3	22.5	23.0	-94.63	435.3	995.8	377.2	332.2	44.92	8.396		
5,900.0	5,768.4	5,890.7	5,758.4	22.9	23.4	-94.12	444.2	1,017.4	380.5	334.7	45.79	8.309		
6,000.0	5,866.4	5,990.6	5,855.5	23.3	23.9	-93.61	453.1	1,038.9	383.9	337.2	46.66	8.227		
6,100.0	5,964.3	6,090.5	5,952.7	23.7	24.3	-93.12	461.9	1,060.5	387.2	339.7	47.52	8.148		
6,200.0	6,062.3	6,190.3	6,049.8	24.1	24.8	-92.63	470.8	1,082.1	390.7	342.3	48.38	8.074		
6,300.0	6,160.3	6,290.2	6,146.9	24.5	25.2	-92.15	479.6	1,103.6	394.1	344.9	49.24	8.004		
6,400.0	6,258.3	6,390.1	6,244.0	24.9	25.7	-91.68	488.5	1,125.2	397.6	347.5	50.09	7.937		
6,500.0	6,356.3	6,490.0	6,341.2	25.3	26.1	-91.21	497.3	1,146.7	401.1	350.1	50.94	7.873		
6,600.0	6,454.2	6,589.9	6,438.3	25.7	26.6	-90.76	506.2	1,168.3	404.6	352.8	51.79	7.812		
6,700.0	6,552.2	6,689.8	6,535.4	26.1	27.0	-90.31	515.1	1,189.9	408.1	355.5	52.63	7.755		
6,800.0	6,650.2	6,789.7	6,632.6	26.5	27.5	-89.87	523.9	1,211.4	411.7	358.2	53.47	7.700		
6,900.0	6,748.2	6,889.5	6,729.7	26.9	27.9	-89.44	532.8	1,233.0	415.3	361.0	54.31	7.647		
7,000.0	6,846.2	6,989.4	6,826.8	27.2	28.4	-89.02	541.6	1,254.5	418.9	363.8	55.14	7.597		
7,100.0	6,944.1	7,089.3	6,924.0	27.6	28.8	-88.60	550.5	1,276.1	422.6	366.6	55.97	7.550		
7,200.0	7,042.1	7,189.2	7,021.1	28.0	29.3	-88.19	559.3	1,297.7	426.2	369.4	56.80	7.504		
7,300.0	7,140.1	7,289.1	7,118.2	28.4	29.7	-87.78	568.2	1,319.2	429.9	372.3	57.62	7.461		
7,400.0	7,238.1	7,389.1	7,386.5	28.8	30.6	-88.04	540.5	1,378.8	419.2	360.2	59.05	7.100		
7,500.0	7,335.7	7,488.6	7,585.3	29.2	30.8	-68.08	415.4	1,422.9	358.9	299.9	58.95	6.088		
7,600.0	7,430.4	7,585.2	7,647.8	29.6	30.8	-72.56	343.2	1,436.8	271.5	220.5	51.02	5.322		
7,700.0	7,519.4	7,634.1	7,664.1	30.1	30.8	-102.51	319.6	1,440.4	178.2	146.2	31.98	5.571		
7,800.0	7,600.0	7,732.3	7,663.1	30.6	30.8	-113.01	321.1	1,440.2	94.2	66.1	28.09	3.352		
7,865.3	7,646.8	7,922.1	7,657.5	30.9	30.8	-105.73	329.6	1,438.9	68.5	38.8	29.69	2.307 ES, SF		
7,900.0	7,669.6	7,914.7	7,653.3	31.1	30.8	-98.15	335.5	1,438.0	76.4	44.6	31.77	2.405		
8,000.0	7,726.2	7,888.2	7,637.7	31.7	30.8	-68.89	356.7	1,434.5	146.1	108.3	37.85	3.860		
8,100.0	7,768.1	7,850.0	7,613.5	32.3	30.8	-44.39	385.8	1,429.2	230.4	196.0	34.44	6.691		
8,200.0	7,793.9	7,820.6	7,593.7	33.0	30.8	-33.29	407.0	1,424.8	312.8	285.9	26.90	11.628		
8,300.0	7,803.0	7,782.5	7,566.5	33.7	30.8	-26.80	432.9	1,418.7	390.5	370.2	20.27	19.263		
8,400.0	7,803.0	7,750.0	7,541.9	34.4	30.8	-25.44	453.6	1,413.3	467.0	446.6	20.43	22.864		

Cathedral Energy Services

Anticollision Report

Company: EnCana Oil & Gas (USA) Inc
Project: DJ Wattenberg
Reference Site: S7-T1N-R68W (Woolley-Sosa/Becky)
Site Error: 0.0ft
Reference Well: Woolley-Becky 2G-7H-E168
Well Error: 0.0ft
Reference Wellbore: Hz
Reference Design: Plan #1

Local Co-ordinate Reference: Well Woolley-Becky 2G-7H-E168
TVD Reference: WELL @ 5022.0ft (Original Well Elev)
MD Reference: WELL @ 5022.0ft (Original Well Elev)
North Reference: True
Survey Calculation Method: Minimum Curvature
Output errors are at 2.00 sigma
Database: USA EDM 5000 Multi Users DB
Offset TVD Reference: Offset Datum

Reference Depths are relative to WELL @ 5022.0ft (Original Well Elev)
 Offset Depths are relative to Offset Datum
 Central Meridian is -105.500000 °

Coordinates are relative to: Woolley-Becky 2G-7H-E168
 Coordinate System is US State Plane 1983, Colorado Northern Zone
 Grid Convergence at Surface is: 0.29°

Ladder Plot

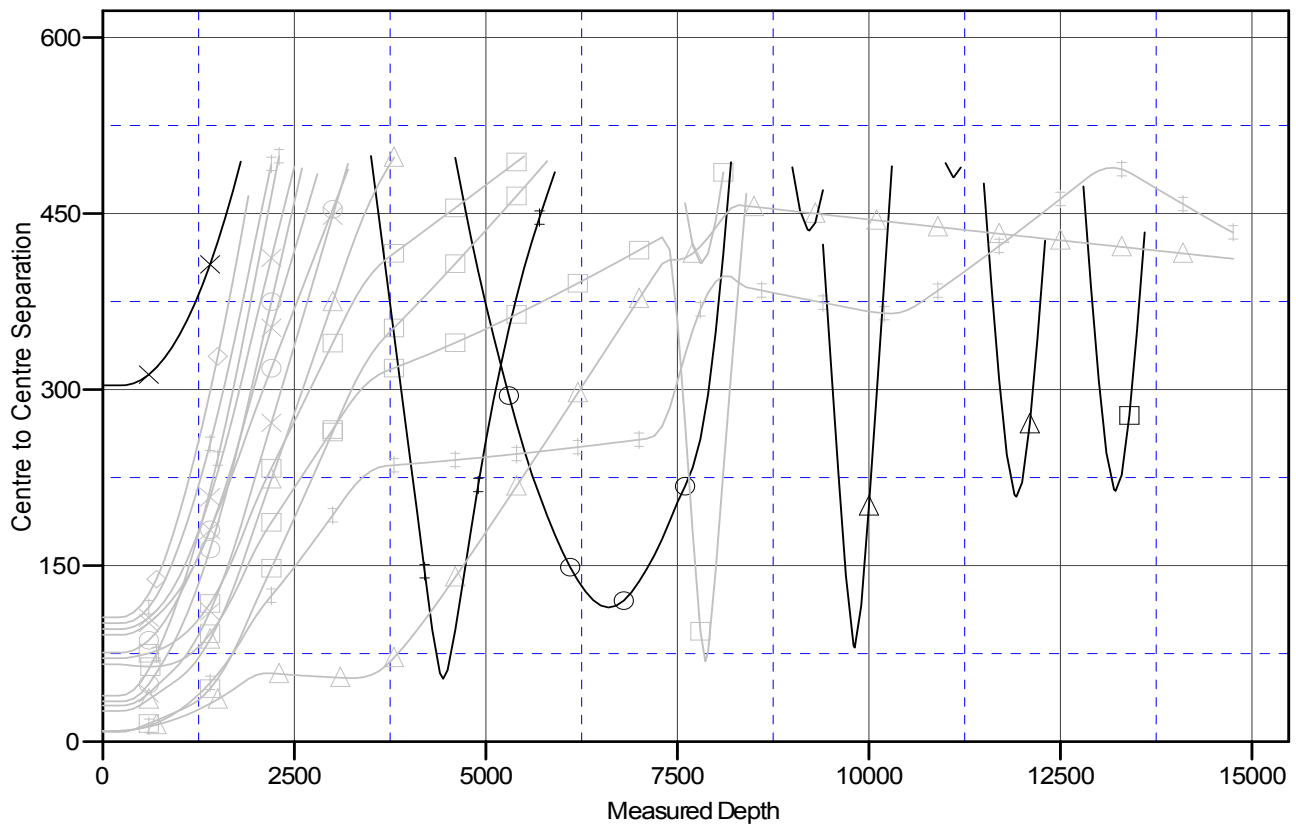

LEGEND

(TING), ENCANA WELL, SURVEYS V0	Woolley-Becky 2A-7H-E168, Hz, Plan #1 V0	Woolley-Sosa 2B-7H-E168, HZ, Plan #1
(ISTING), ENCANA WELL, NO SURVEYS V0	Woolley-Becky 2B-7H-E168, Hz, Plan #1 V0	Woolley-Sosa 2C-7H-E168, HZ, Plan #1
(NG), NOBLE WELL, NO SURVEYS V0	Woolley-Becky 2C-7H-E168, Hz, Plan #1 V0	Woolley-Sosa 2D-7H-E168, HZ, Plan #1
(ISTING), ENCANA WELL, NO SURVEYS V0	Woolley-Becky 2D-7H-E168, Hz, Plan #1 V0	Woolley-Sosa 2E-7H-E168, HZ, Plan #1
(ISTING), ENCANA WELL, NO SURVEYS V0	Woolley-Becky 2E-7H-E168, Hz, Plan #1 V0	Woolley-Sosa 2F-7H-E168, HZ, Plan #1
(ISTING), ENCANA WELL, SURVEYS V0	Woolley-Becky 2F-7H-E168, Hz, Plan #1 V0	Woolley-Sosa 2G-7H-E168, HZ, Plan #1
(ISTING), ENCANA WELL, SURVEYS V0	Woolley-Becky 2H-7H-E168, Hz, Plan #1 V0	
(ISTING), ENCANA WELL, SURVEYS V0	Woolley-Sosa 2A-7H-E168, Hz, Plan #1 V0	