

EE3 LLC
SURPRISE CENTRAL FACILITY
LOCATED IN S1/2SW1/4
SECTION 4, T6N, R80W, 6th PM

GPS LOCATION

40.513458934°N
106.386629099°W
PDOP=2.317
Undisturbed Ground
Elev.=8250.5'
Measured 12/2/2013
by T. Thrush

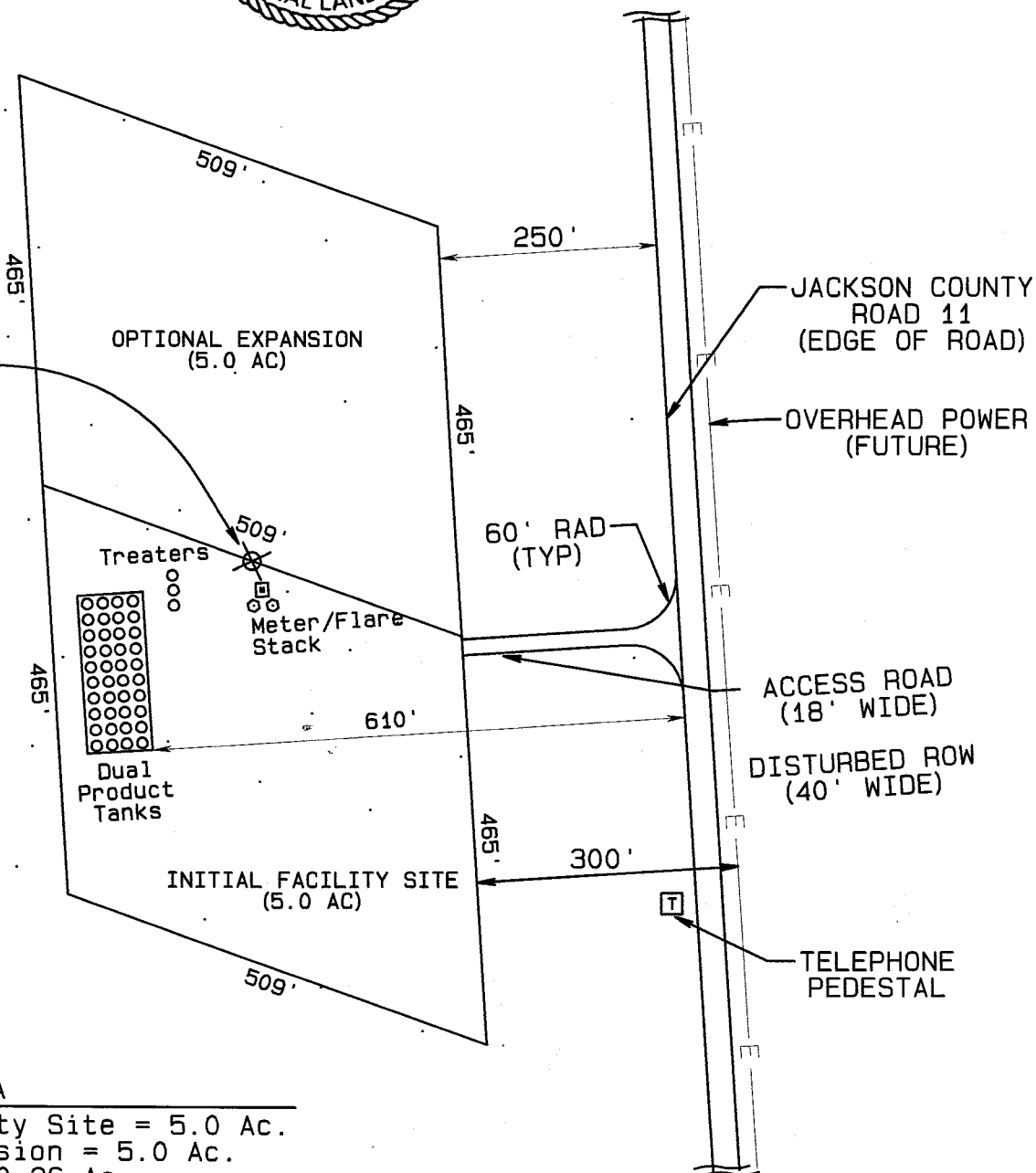

DISTURBED AREA

Initial Facility Site = 5.0 Ac.
Optional Expansion = 5.0 Ac.
Access Road = 0.26 Ac
TOTAL = 10.26 Ac

BASIS OF ELEVATION

SPOT ELEVATION AT THE SE CORNER OF SECTION 4,
T6N, R80W, 6TH PM. TAKEN FROM THE COALMONT
QUADRANGLE, USGS 7.5 MIN QUAD (TOPOGRAPHIC MAP)
WITH SAID ELEVATION MARKED AS BEING 8222 FEET.

GRAPHIC SCALE 1"=200'

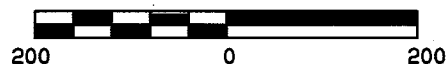

NORTH PARK ENGINEERING & CONSULTING, INC.
PO Box 395 Walden, CO 80480 970-723-3725

EE3 LLC

CONSTRUCTION LAYOUT
SURPRISE CENTRAL FACILITY
LOCATED IN S1/2SW1/4
SECTION 4, T6N, R80W, 6th PM

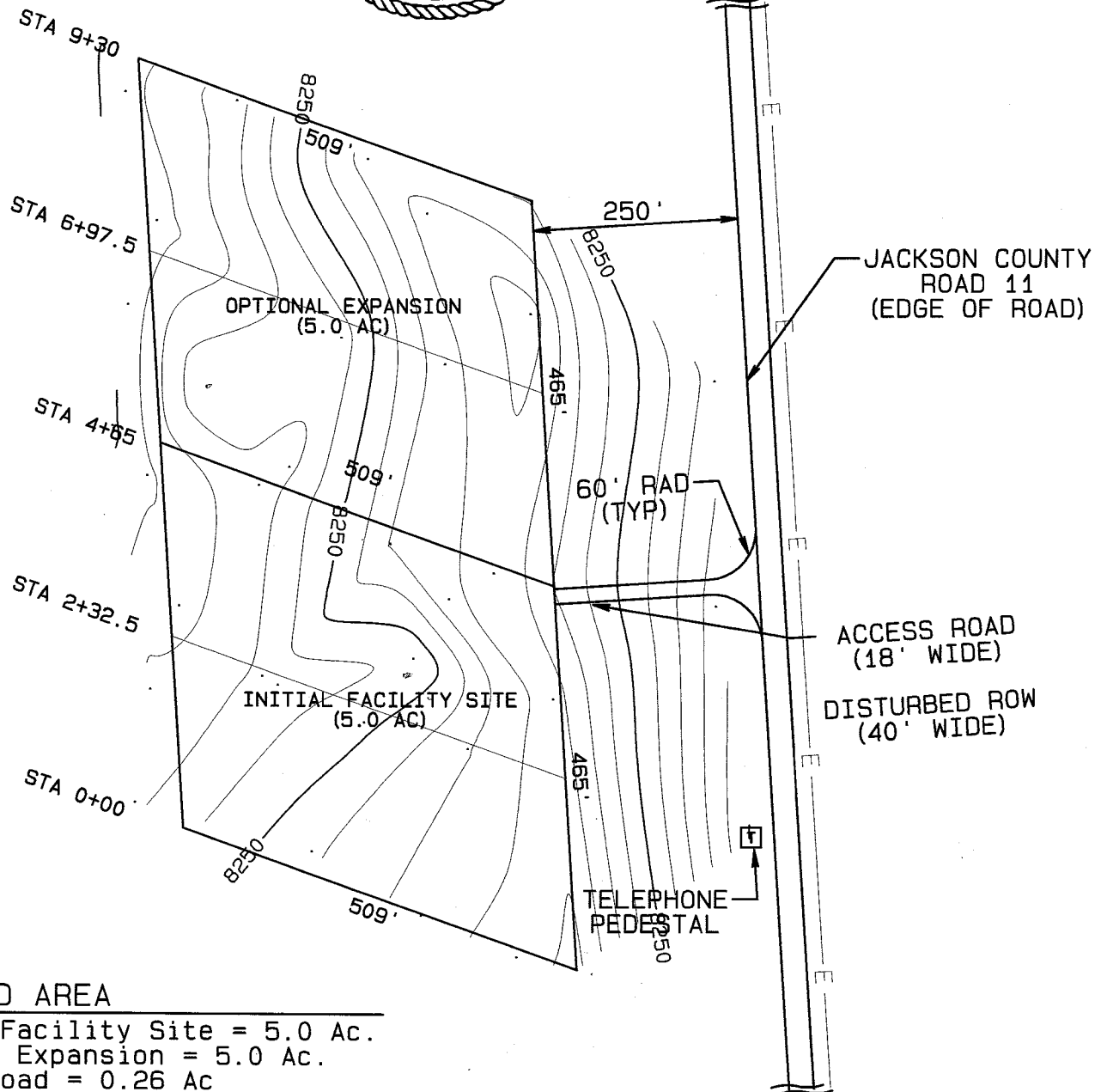
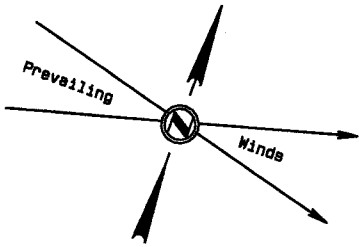

DISTURBED AREA

Initial Facility Site = 5.0 Ac.
Optional Expansion = 5.0 Ac.
Access Road = 0.26 Ac
TOTAL = 10.26 Ac

BASIS OF ELEVATION

SPOT ELEVATION AT THE SE CORNER OF SECTION 4,
T6N, R80W, 6TH PM. TAKEN FROM THE COALMONT
QUADRANGLE, USGS 7.5 MIN QUAD (TOPOGRAPHIC MAP)
WITH SAID ELEVATION MARKED AS BEING 8222 FEET.

GRAPHIC SCALE 1"=200'



NORTH PARK ENGINEERING & CONSULTING, INC.
PO Box 395 Walden, CO 80480 970-723-3725

EE3 LLC

CONSTRUCTION LAYOUT CROSS SECTION
SURPRISE CENTRAL FACILITY
LOCATED IN S1/2SW1/4
SECTION 4, T6N, R80W, 6th PM

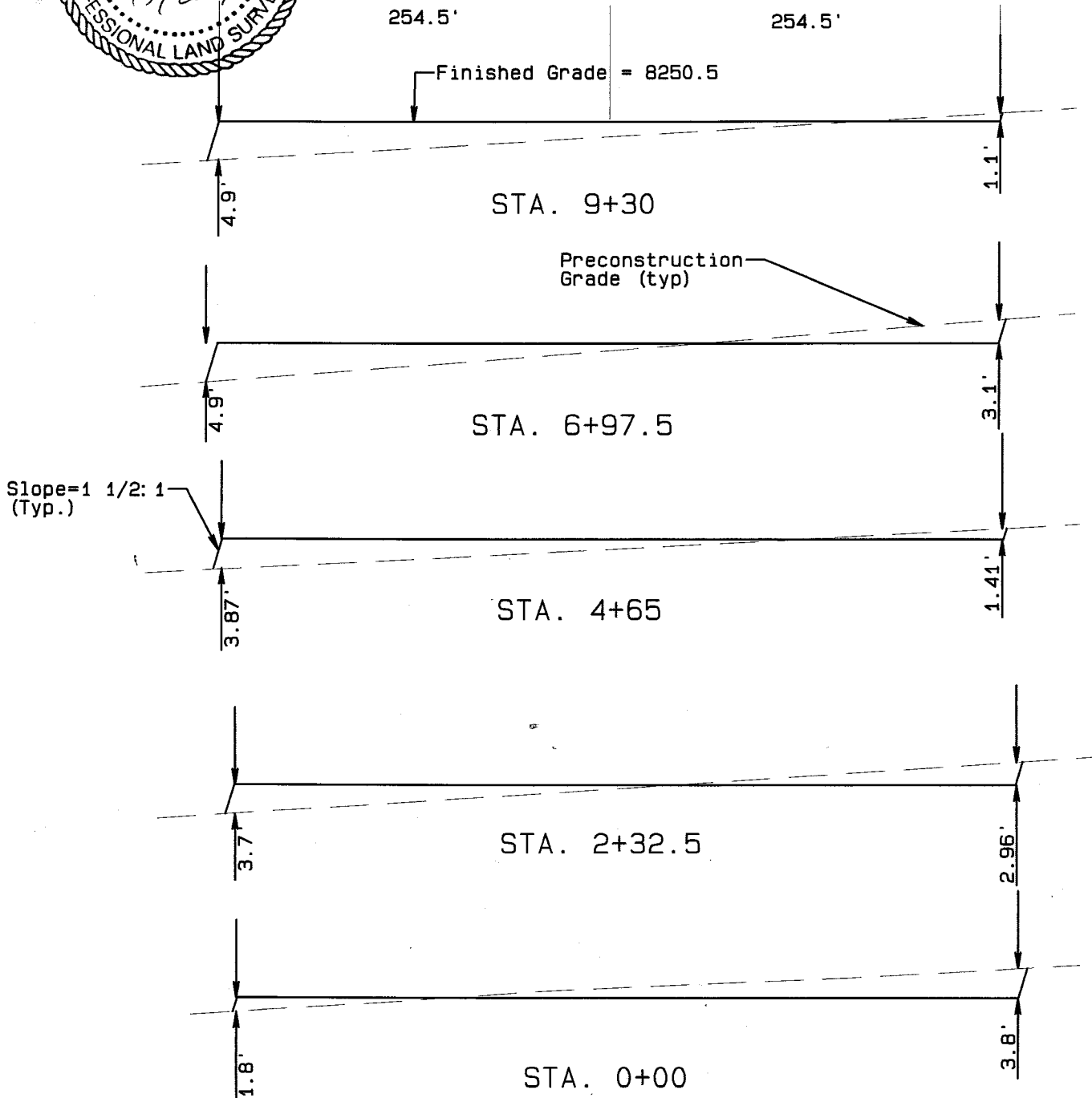

VERTICAL EXAG = 5 times

