



AZIMUTHS TO TRUE NORTH
MAGNETIC NORTH: 8.29°

MAGNETIC FIELD
STRENGTH: 53207.8SNT
DIP ANGLE: 67.48°
DATE: 1/23/2014
MODEL: IGRF200510

Project: DJ - Hereford Ranch
Site: Longhorn Sec 36
Well: Longhorn G 4-36H
Plan: APD Directional Plan Rev 1
Plat Certified: 01-22-14
Prepared By: Rael (03-03-14)

Surface Location



NAD 1927 (NADCON CONUS) Colorado North 501
Ground Elevation: 5343.0 RKB @ 5371.0usft (H&P #520 Rig KB 28usft)
Northing 594690.20 Easting 2309045.52 Latitude 40° 57' 37.663 N Longitude 104° 22' 52.004 W

Longhorn G 4-36H
Section 36-T12N-R63W
Weld County, CO

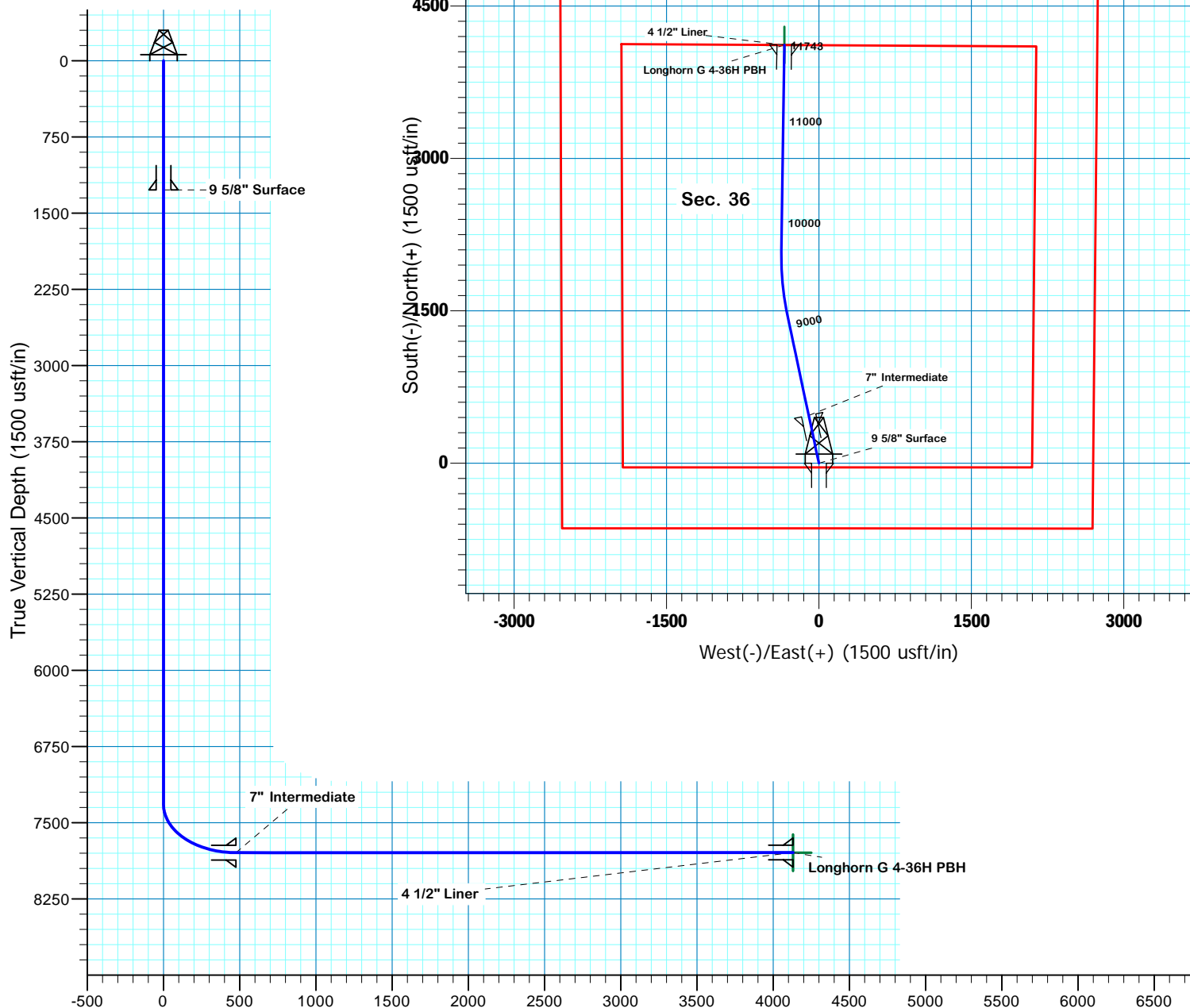

Vertical Section at 355.29° (1000 usft/in)

SECTION DETAILS

Sec	MD	Inc	Azi	TVD	+N/-S	+E/-W	Dleg	TFace	VSec	Target
1	0.0	0.00	0.00	0.0	0.0	0.0	0.00	0.00	0.0	
2	7318.0	0.00	0.00	7318.0	0.0	0.0	0.00	0.00	0.0	
3	8067.3	90.00	348.00	7795.0	466.6	-99.2	12.01	348.00	473.1	
4	9067.3	90.00	348.00	7795.0	1444.7	-307.1	0.00	0.00	1465.1	
5	9709.9	90.00	0.85	7795.0	2083.0	-369.4	2.00	90.00	2106.3	Longhorn G 4-36H PBH
6	11743.5	90.00	0.85	7795.0	4116.3	-339.1	0.00	0.00	4130.3	Longhorn G 4-36H PBH

TARGET DETAILS

Name	TVD	+N/-S	+E/-W	Northing	Easting	Latitude	Longitude	Shape
Longhorn G 4-36H PBH	7795.0	4116.3	-339.1	598801.94	2308654.50	40° 58' 18.335 N	104° 22' 56.424 W	Point