

1801 Broadway
Suite 500
Denver, Colorado 80202



Callie Fiddes
Regulatory Technician
Tel: 303.398.0550
E-mail: cfiddes@gwogco.com

January 14, 2014

Colorado Oil and Gas Conservation Commission
1120 Lincoln Street, Suite 801
Denver, Colorado 80203

RE: **Proposed Wellbore Spacing Unit**
Raindance FD 30-029HN

Niobrara New Drill
Township 6 North, Range 67 West, 6th P.M.
Section 30
Weld County, Colorado

Dear Director:

Great Western Operating Company, LLC is planning to drill the above captioned well in accordance with the provisions of COGCC Rule 318(l)e(2).

Great Western proposed wellbore spacing unit consists of:

- **W2E2, E2W2 Sec 30**

The 30 day notification time has passed and we have not received any objections to such well locations or proposed spacing unit, therefore Great Western hereby requests the Director to approve the above mentioned well. Great Western Operating Company, LLC respectfully requests that the COGCC review the enclosed map illustrating the proposed wellbore spacing unit.

Respectfully,

A handwritten signature in blue ink that reads "Callie Fiddes". The signature is written in a cursive, flowing style.

Callie Fiddes
Regulatory Technician
Great Western Operating Company, LLC

GREAT WESTERN OIL & GAS COMPANY

Well location, RAINDANCE FD 30-029HN, located as shown in the SW 1/4 SE 1/4 of Section 30, T6N, R67W, 6th P.M., Weld County, Colorado.

BASIS OF ELEVATION
USGS COOPERATIVE BASE NETWORK CONTROL STATION, DESIGNATION 'VERMILYEA'. NGS DATA SHEET LISTS THE NAVD 88 ELEVATION AS BEING 5026 FEET

BASIS OF BEARINGS
BASIS OF BEARINGS IS A G.P.S. OBSERVATION.

LEGEND:
 — = 90° SYMBOL
 ● = PROPOSED WELL HEAD.
 ○ = PROPOSED TARGET BOTTOM HOLE.
 ▲ = SECTION CORNERS LOCATED.
 △ = SECTION CORNERS RE-ESTABLISHED.
 ◇ = PROPOSED ENTRY POINT.
 (Not Set on Ground.)

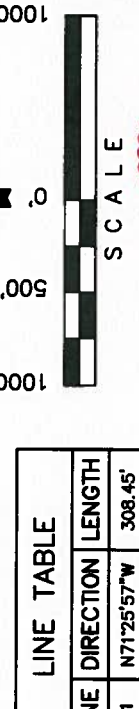

CERTIFICATE
THIS IS TO CERTIFY THAT THE ABOVE PLAT WAS PREPARED FROM FIELD NOTES OF ACTUAL SURVEYS MADE BY ME OR UNDER MY SUPERVISION AND THAT THE SAME ARE TRUE AND CORRECT TO THE BEST OF MY KNOWLEDGE AND BELIEF.

REGISTERED LAND SURVEYOR
STATE OF COLORADO
98-31413

UNTAH ENGINEERING & LAND SURVEYING
85 SOUTH 200 EAST - VERNAL, UTAH 84078
(435) 789-1017

SCALE 1" = 1000'	DATE SURVEYED: 03-22-13	DATE DRAWN: 03-27-13
PARTY D.N. K.H. H.K.W.	REFERENCES G.L.O. PLAT	
WEATHER COLD	FILE GREAT WESTERN OIL & GAS COMPANY	

