



Physical Address: 345 Comanche St.  
Mail to: Box 384, Kiowa, CO 80117  
Ph. 303-621-8672 - Fax 303-621-7749  
www.highprairiesurvey.com

Job # 13117-APC-CHARLOTTE #2-3 (Re-Entry)

Inv # 2972

High Prairie Surveying of Kiowa, Colorado has in accordance with a request from **MULL DRILLING COMPANY** has determined the location of **APC-CHARLOTTE #2-3 (Re-Entry)** to be **2390 feet FNL**, and **718 feet FEL**, (90° off Section lines) of **SECTION 3**, Township **17s**, Range **45w** of the 6th Principal Meridian, **Kiowa County**, Colorado.

Date: Staked on 01/29/14 Drawn on 01/30/14.

Re:

Staked by Elijah Frane

Drawn:

Drawn by Dustin Cotten

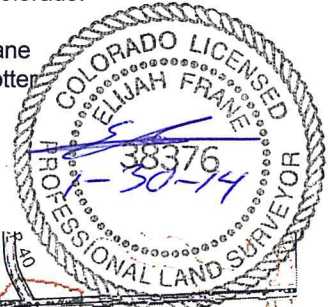

## Access Road Map

