

FORM  
19  
Rev 6/99

State of Colorado  
Oil and Gas Conservation Commission

1120 Lincoln Street, Suite 801, Denver, Colorado 80203 Phone: (303)894-2100 Fax: (303)894-2109



FOR OGCC USE ONLY

RECEIVED  
4/9/2012

SPILL/RELEASE REPORT

This form is to be submitted by the party responsible for the oil and gas spill or release. Any spill or release which may impact waters of the State must be reported as soon as practicable; any spill over 20 bbls must be reported within 24 hours and all spills over five bbls must be reported within ten days. Submit a Site Investigation and Remediation

Spill report taken by:

FACILITY ID:

OPERATOR INFORMATION

Name of Operator:	Chevron Production	OGCC Operator No:	16700	Phone Numbers	
Address:	100 Chevron Road	No:	970-675-3705		
City:	Rangely	State:	CO	Fax:	970-675-3809
Contact Person:	E. Faithe Schwartzengraber - HE Specialist Environmental	Email:	efsc@chevron.com		

DESCRIPTION OF SPILL OR RELEASE

Date of Incident:	7-Apr-12	Facility Name & No:	Rangely Weber Sand Unit	County:	Rio Blanco
Type of Facility (well, tank battery, flow line, pit):	Injection Line	QtrQtr:	NWNE	Section:	19
Well Name and Number:	Fee 29	Township:	2N	Range:	102W
API Number:	05-103-0614400	Meridian:	6PM		
Specify volume spilled and recovered (in bbls) for the following materials:					
Oil spilled:	0	Oil recov'd:	0	Water spilled:	20.7952
		Water recov'd:	20	Other spilled:	0
		Other recov'd:	0		
Ground Water impacted?	<input type="checkbox"/> Yes <input checked="" type="checkbox"/> No	Surface Water impacted?	<input type="checkbox"/> Yes <input checked="" type="checkbox"/> No		
Contained within berm?	<input type="checkbox"/> Yes <input checked="" type="checkbox"/> No	Area and vertical extent of spill:	4 X 268		
Current land use:	Non Crop Land	Weather conditions:	65 Degrees Sunny		
Soil/geology description:	Silty Clay				
IF LESS THAN A MILE, report distance IN FEET to nearest ... Surface water: N/A wetlands: N/A buildings: N/A					
Livestock: N/A Water wells: N/A Depth to shallowest ground water: N/A					
Cause of spill (e.g. equipment failure, human error, etc.): Internal Corrosion Detailed description of the spill/release incident:					
A leak occurred on a three inch steel pipe approximately 268 feet north of well Fee 29. Approximately 29.7952 bbls of brine water and 0 bbls of crude oil were released.					

CORRECTIVE ACTION

Describe immediate response (how stopped, contained and recovered): The line was shut in immediately upon detection. Vacuum trucks removed all of the free fluid, estimated recovery is approximately 20 bbls of brine water and 0 bbls of crude oil. The fluids that were picked up, were taken to the truck unloading facility at the Main Water Plant for recycling.

Describe any emergency pits constructed: NA

How was the extent of contamination determined?  
Visual Inspection. Chevron MCA Spill Calculation Worksheet.

Further remediation activities proposed (attach separate sheet if needed):

Describe measures taken to prevent problem from reoccurring: The damaged section of pipe will be repaired and returned to service.

OTHER NOTIFICATIONS

List the parties and agencies notified (County, BLM, EPA, DOT, Local Emergency Planning Coordinator or other).

Date	Agency	Contact	Phone	Response
7-Apr-12	COGCC	Chris Canfield	970-625-2497	LVM at 13:51

Spill/Release Tracking No: 2223865

# Chevron-Fee 29

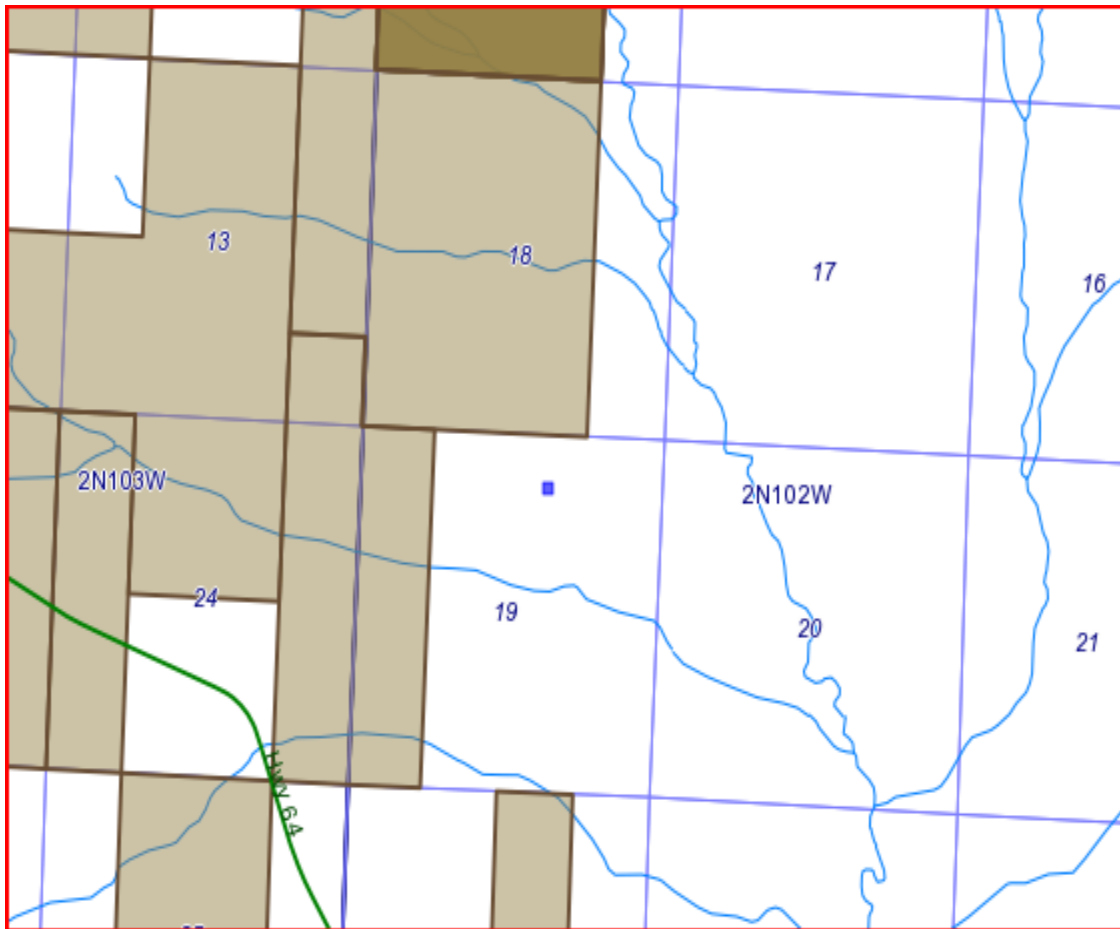

WELL HEAD



SPILL LOCATION



PERENNIAL STREAM



BLM Land

N



# Chevron –Fee 29

