



**WELL: Padilla #1 to be located 885.42' FEL and 1153.33' FNL in Section 9, Township 22 South, Range 58 West of the 6th P.M.**  
**Location falls in : Irrigated crop land    Ground Elevation = 4284.66'    Improvements: No visible improvements within 500 ft radius of the location.**

**LEGEND**

-  Aliquot corners (as noted)
-  Proposed Well Location

SCALE: 1"=1000'



**NOTES:**  
1. This survey was done by GPS methods and conforms to the minimum standards as set by the C.O.G.CC. Rule No. 215.  
2. The Bearings as shown hereon are based on GPS observation between the monuments shown hereon as found in the field date below.  
3. Distance shown hereon are at ground level, as measured in the field, with ties to wells measured at a perpendicular to section lines.  
Vertical = NAVD88 Horizontal = NAD83

**I, Daniel L. Boyd, a Licensed Professional Land Surveyor in the State of Colorado do hereby certify to:**  
**Crazy 8 Energy, that the Survey and Well location certificate shown hereon was done by me or under my direct supervision and that the drawing shown hereon accurately depicts the proposed location of the Well, Padilla #1.**  
**This certificatedoes not represent a land survey plat or improvement survey plat as defined by C.R.S. 38-51-102 and cannot be relied upon to determine ownership.**

**Daniel L. Boyd P.L.S. #11550**  
**Colorado Licensed Professional Land Surveyor**  
**for and behalf of Alta Surveys of Colorado, Inc.**

**Notice:**  
**According to Colorado Law, you must commence any legal action based upon any defect in this survey within three (3) years after you first discover such defect. In no event, may any action based upon any defect in this survey be commenced more than ten (10) years from the date of certification shown hereon.**

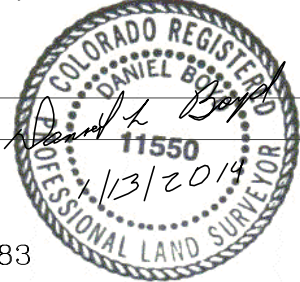

Alta Surveys of Colorado, Inc.  
813 B Desert Flower Blvd.  
Pueblo, CO 81001  
Phone: (719) 542-9169    Fax: (719) 542-9183

Project: RKS13-04  
Date of Field Work: 12/20/2013  
Date of Completion: 1/13/2014  
Client: Riemenschneider  
Dwn: KJD    Checked: DLB