

BILL BARRETT CORPORATION  
LOCATION DRAWING FOR

ANSCHUTZ STATE #4-62-2-3228CH2, #4-62-2-3228BH2,  
#4-62-2-1721CH2, #4-62-2-1721BH2

SECTION 2, T4N, R62W, 6th P.M.  
SW 1/4 NW 1/4

FIGURE #5

SCALE: 1" = 200'  
DATE SURVEYED: 12-02-13  
SURVEYED BY: DALLAS NIELSEN  
DATE DRAWN: 12-20-13  
DRAWN BY: J.W.  
REVISED: 01-06-14

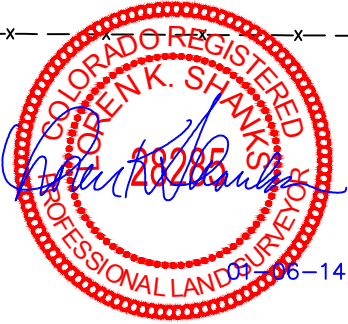

NOTE:  
THERE ARE NO EXISTING  
IMPROVEMENTS WITHIN 500' OF  
THE PROPOSED DISTURBANCE

500' Offset  
from Edge of  
Disturbance

Install  
Cattle Guard

Existing  
Fence

Topsoil  
Stockpile

Spoils Stockpile

Spoils Stockpile

PROPOSED  
ANSCHUTZ STATE  
#4-62-2-3228CH2  
(NAD 83)  
Lat: 40.344619°  
Long: 104.301708°

Proposed  
Access Road

Section Line