



Lat40°, Inc. 1635 Foxtrail Drive, Suite 325 Loveland, CO 970-776-3321

PRODUCTION FACILITY LOCATION DRAWING

SECTION: 5
TOWNSHIP: 3N
RANGE: 64W

BECKER RANCH 5RU-TB PAD

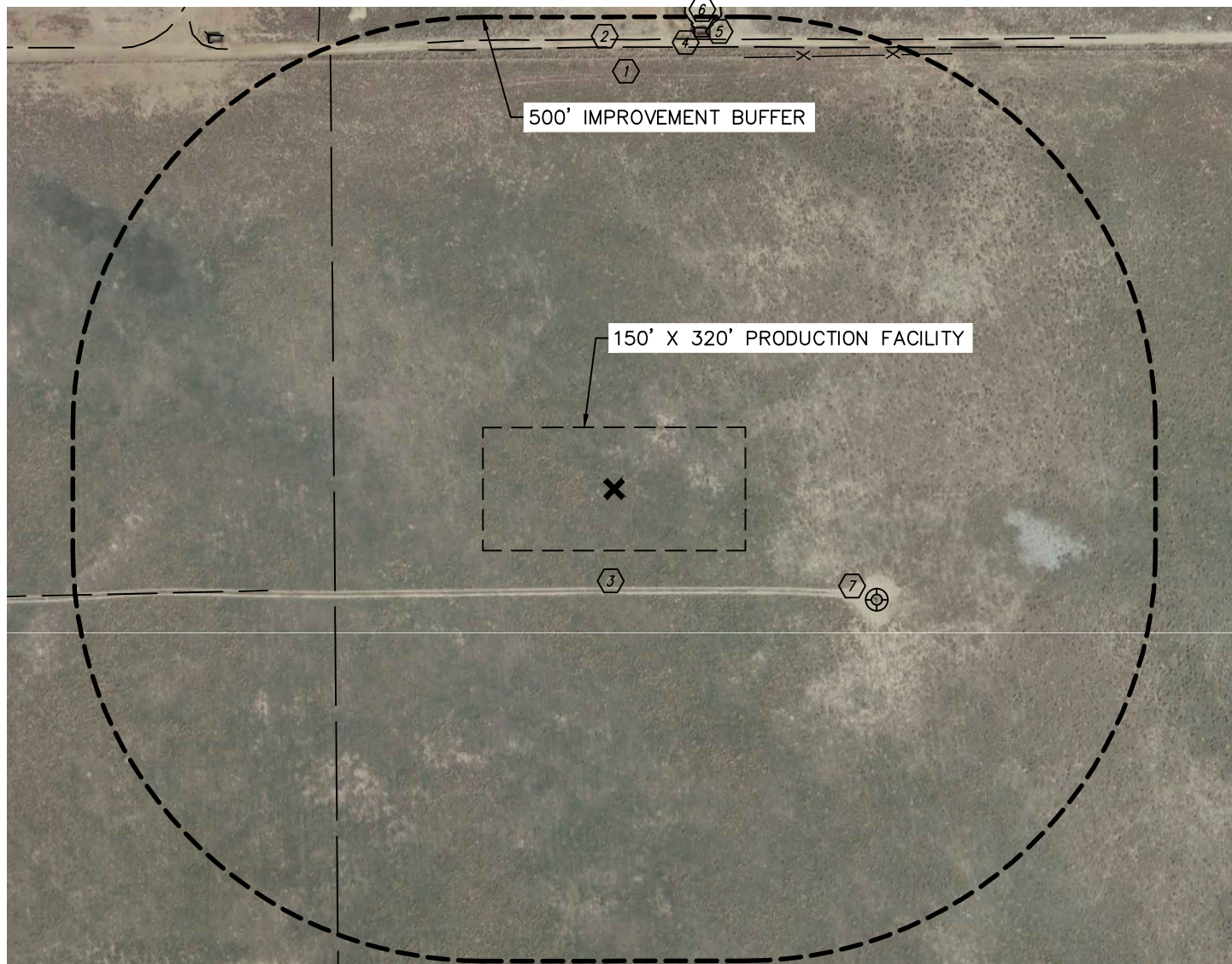

REFERENCE POINT LOCATION:

LAT: 40.26029°N
LONG: 104.56886°W
ELEV: 4778'
PDOP: 1.9
DATE: 7/18/2013
OPERATOR: ADAM KELLY
1/41/4: NE1/4NE1/4
FNL: 531'
FEL: 975'
DISTANCE TO WELL: 374'
ASSOCIATED NEW WELLS:
BECKER RANCH 5R-403
BECKER RANCH 5R-323
BECKER RANCH 5U-443
BECKER RANCH 5U-203
ASSOCIATED EXISTING WELLS:
N/A

IMPROVEMENTS:

- ① FENCE 522' N
- ② PUBLIC ROAD 538' N
- ③ FIELD ROAD 120' S
- ④ EDGE OF CONCRETE 559' NE
- ⑤ CONCRETE WALL 570' NE
- ⑥ RAMP 575' NE
- ⑦ EX. WELL HEAD 347' SE

NEAREST: BUILDING 1258' NW, BUILDING UNIT 2587' NW,
HIGH OCCUPANCY BUILDING UNIT 5280'+,
DESIGNATED OUTSIDE ACTIVITY AREA 5280'+,
PUBLIC ROAD 538' N, ABOVE GROUND UTILITY 1261' NW,
RAILROAD 5280'+, PROPERTY LINE 531' N

LEGEND

X - REFERENCE POINT
ALL DISTANCES ARE APPROXIMATE.

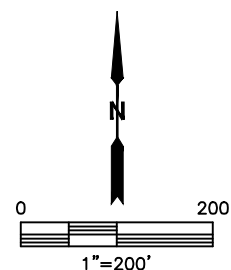

DATE: 8/26/2013
PROJECT#: 2013107