

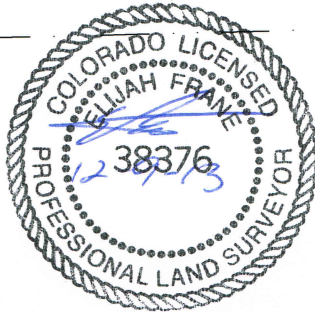

Physical Address: 345 Comanche St.
Mail to: Box 384 Kiowa, CO 80117
Ph. 303-621-8672 - Fax 303-621-2717
www.highprairiesurvey.com

Job # 12097 JOHN CRAIG #1-2

As-Built / Disturbed Area



NIGHTHAWK PRODUCTION LLC.
NE 1/4 SEC. 2-10S-56W
JOHN CRAIG #1-2
LINCOLN, Co. COLORADO

NE 1/4, SECTION 2
T10S-R56W

PAD AREA
DISTURBED AREA
(3.46 ACRES ±)

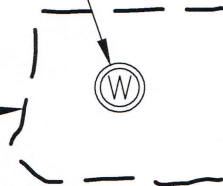

ACCESS ROAD
DISTURBED AREA
(1.50 ACRES ±)

