

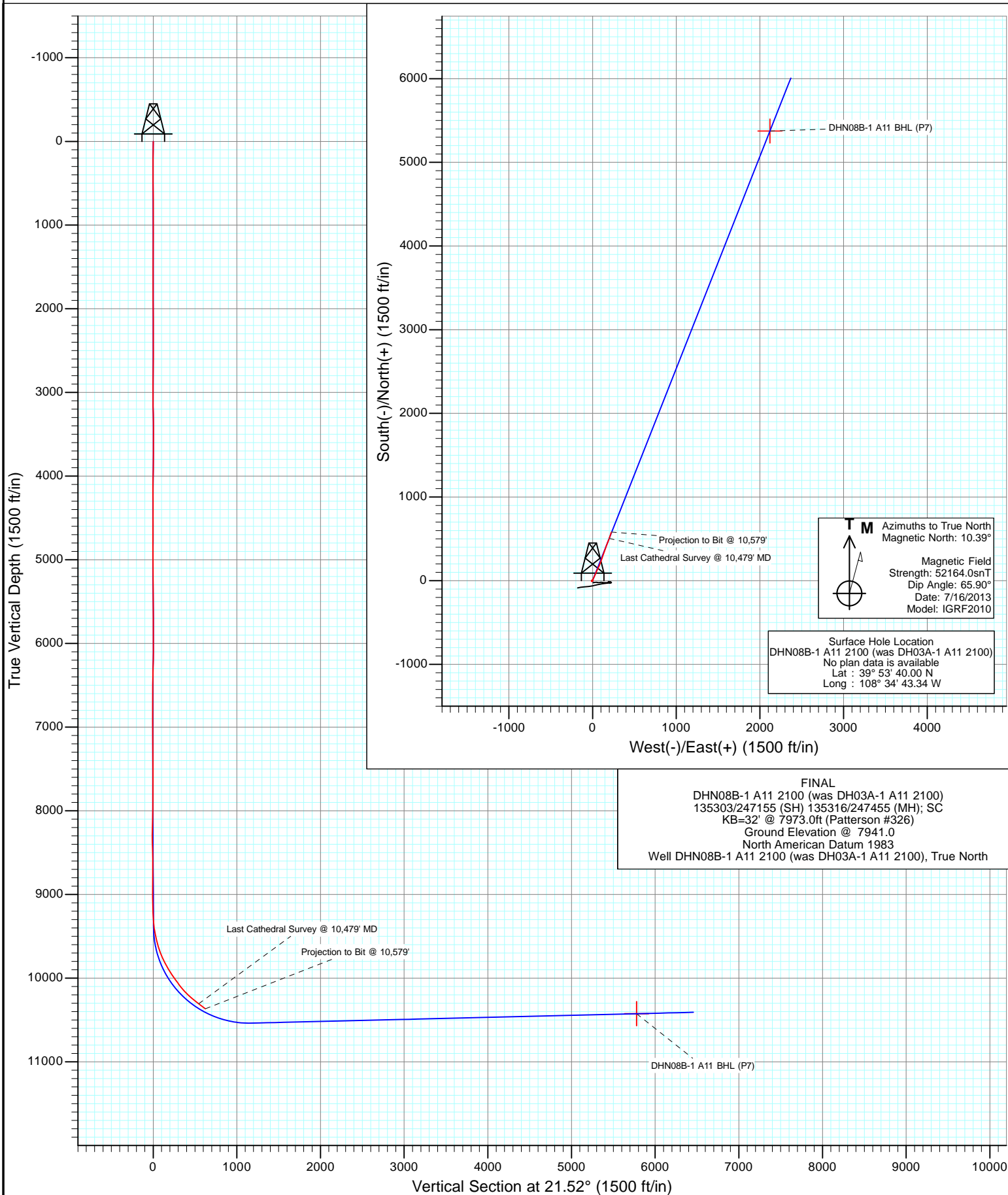

Project: Cathedral Bluffs
Site: Sec 11-2S-R100W
Well: DHN08B-1 A11 2100 (was DH03A-1 A11 2100)
Wellbore: Hz
Design: FINAL



Cathedral Energy Services

Survey Report

| | | | |
|------------------|--|-------------------------------------|---|
| Company: | EnCana Oil & Gas (USA) Inc | Local Co-ordinate Reference: | Well DHN08B-1 A11 2100 (was DH03A-1 A11 210 |
| Project: | Cathedral Bluffs | TVD Reference: | KB=32' @ 7973.0ft (Patterson #326) |
| Site: | Sec 11-2S-R100W | MD Reference: | KB=32' @ 7973.0ft (Patterson #326) |
| Well: | DHN08B-1 A11 2100 (was DH03A-1 A11 2100) | North Reference: | True |
| Wellbore: | Hz | Survey Calculation Method: | Minimum Curvature |
| Design: | FINAL | Database: | USA EDM 5000 Multi Users DB |

| | | | |
|--------------------|---------------------------|----------------------|----------------|
| Project | Cathedral Bluffs | | |
| Map System: | US State Plane 1983 | System Datum: | Mean Sea Level |
| Geo Datum: | North American Datum 1983 | | |
| Map Zone: | Colorado Central Zone | | |

| | | | | | |
|-----------------------|----------|-----------------|-----------------|-------------------|------------------|
| Site | | Sec 11-2S-R100W | | | |
| Site Position: | | Northing: | 1,765,302.83 ft | Latitude: | 39° 53' 39.77 N |
| From: | Lat/Long | Easting: | 2,136,283.89 ft | Longitude: | 108° 34' 43.23 W |
| Position Uncertainty: | 0.0 ft | Slot Radius: | 13.200 in | Grid Convergence: | -1.94 ° |

| | | | | | | |
|----------------------|--|--------|---------------------|-----------------|---------------|------------------|
| Well | DHN08B-1 A11 2100 (was DH03A-1 A11 2100) | | | | | |
| Well Position | +N/-S | 0.0 ft | Northing: | 1,765,326.19 ft | Latitude: | 39° 53' 40.00 N |
| | +E/-W | 0.0 ft | Easting: | 2,136,276.10 ft | Longitude: | 108° 34' 43.34 W |
| Position Uncertainty | | 0.0 ft | Wellhead Elevation: | ft | Ground Level: | 7,941.0 ft |

| | | | | | |
|------------------|-------------------|--------------------|------------------------|----------------------|----------------------------|
| Wellbore | Hz | | | | |
| Magnetics | Model Name | Sample Date | Declination (°) | Dip Angle (°) | Field Strength (nT) |
| | IGRF2010 | 7/16/2013 | 10.39 | 65.90 | 52,164 |

| | | | | | |
|--------------------------|-------------------------|-------------------|-------------------|----------------------|-----|
| Design | FINAL | | | | |
| Audit Notes: | | | | | |
| Version: | 1.0 | Phase: | ACTUAL | Tie On Depth: | 0.0 |
| Vertical Section: | Depth From (TVD) | +N/-S (ft) | +E/-W (ft) | Direction (°) | |
| | 0.0 | 0.0 | 0.0 | 21.52 | |

| | | | | | |
|-----------------------|----------------|--------------------------|------------------|--------------------|--|
| Survey Program | Date | 8/20/2013 | | | |
| From (ft) | To (ft) | Survey (Wellbore) | Tool Name | Description | |
| 209.0 | 10,579.0 | Survey #1 (Hz) | Geolink MWD | Geolink MWD | |

| | | | | | | | | | | |
|----------------------------|------------------------|--------------------|----------------------------|-------------------|-------------------|------------------------------|------------------------------|-----------------------------|------------------------------|--|
| Survey | | | | | | | | | | |
| Measured Depth (ft) | Inclination (°) | Azimuth (°) | Vertical Depth (ft) | +N/-S (ft) | +E/-W (ft) | Vertical Section (ft) | Dogleg Rate (°/100ft) | Build Rate (°/100ft) | Formations / Comments | |
| 0.0 | 0.00 | 0.00 | 0.0 | 0.0 | 0.0 | 0.0 | 0.00 | 0.00 | | |
| 209.0 | 0.70 | 286.60 | 209.0 | 0.4 | -1.2 | -0.1 | 0.33 | 0.33 | | |
| 301.0 | 0.70 | 280.40 | 301.0 | 0.6 | -2.3 | -0.3 | 0.08 | 0.00 | | |
| 393.0 | 0.00 | 280.40 | 393.0 | 0.7 | -2.9 | -0.4 | 0.76 | -0.76 | | |
| 485.0 | 0.30 | 62.20 | 485.0 | 0.8 | -2.7 | -0.2 | 0.33 | 0.33 | | |
| 577.0 | 0.30 | 22.50 | 577.0 | 1.2 | -2.3 | 0.2 | 0.22 | 0.00 | | |
| 608.0 | 0.20 | 1.30 | 608.0 | 1.3 | -2.3 | 0.4 | 0.43 | -0.32 | | |
| 703.0 | 0.30 | 331.40 | 703.0 | 1.7 | -2.4 | 0.7 | 0.17 | 0.11 | | |
| 798.0 | 0.40 | 285.80 | 798.0 | 2.0 | -2.9 | 0.8 | 0.30 | 0.11 | | |
| 892.0 | 0.30 | 287.90 | 892.0 | 2.2 | -3.4 | 0.8 | 0.11 | -0.11 | | |
| 987.0 | 0.20 | 332.30 | 987.0 | 2.4 | -3.7 | 0.8 | 0.22 | -0.11 | | |
| 1,081.0 | 0.40 | 145.70 | 1,081.0 | 2.3 | -3.6 | 0.8 | 0.64 | 0.21 | | |
| 1,176.0 | 0.90 | 148.80 | 1,176.0 | 1.3 | -3.1 | 0.1 | 0.53 | 0.53 | | |

Cathedral Energy Services

Survey Report

| | | | |
|------------------|--|-------------------------------------|---|
| Company: | EnCana Oil & Gas (USA) Inc | Local Co-ordinate Reference: | Well DHN08B-1 A11 2100 (was DH03A-1 A11 210 |
| Project: | Cathedral Bluffs | TVD Reference: | KB=32' @ 7973.0ft (Patterson #326) |
| Site: | Sec 11-2S-R100W | MD Reference: | KB=32' @ 7973.0ft (Patterson #326) |
| Well: | DHN08B-1 A11 2100 (was DH03A-1 A11 2100) | North Reference: | True |
| Wellbore: | Hz | Survey Calculation Method: | Minimum Curvature |
| Design: | FINAL | Database: | USA EDM 5000 Multi Users DB |

| Survey | | | | | | | | | |
|---------------------|-----------------|-------------|---------------------|------------|------------|-----------------------|-----------------------|----------------------|-----------------------|
| Measured Depth (ft) | Inclination (°) | Azimuth (°) | Vertical Depth (ft) | +N/-S (ft) | +E/-W (ft) | Vertical Section (ft) | Dogleg Rate (°/100ft) | Build Rate (°/100ft) | Formations / Comments |
| 1,271.0 | 0.80 | 147.80 | 1,271.0 | 0.1 | -2.3 | -0.7 | 0.11 | -0.11 | |
| 1,365.0 | 0.50 | 120.30 | 1,365.0 | -0.6 | -1.6 | -1.2 | 0.45 | -0.32 | |
| 1,460.0 | 0.40 | 89.90 | 1,460.0 | -0.8 | -0.9 | -1.1 | 0.27 | -0.11 | |
| 1,555.0 | 0.20 | 63.10 | 1,555.0 | -0.7 | -0.4 | -0.9 | 0.25 | -0.21 | |
| 1,645.0 | 0.40 | 330.80 | 1,645.0 | -0.4 | -0.5 | -0.5 | 0.50 | 0.22 | |
| 1,743.0 | 0.30 | 327.70 | 1,742.9 | 0.1 | -0.8 | -0.2 | 0.10 | -0.10 | |
| 1,838.0 | 0.70 | 306.30 | 1,837.9 | 0.7 | -1.4 | 0.1 | 0.46 | 0.42 | |
| 1,931.0 | 1.00 | 296.60 | 1,930.9 | 1.4 | -2.5 | 0.3 | 0.36 | 0.32 | |
| 2,026.0 | 1.00 | 303.60 | 2,025.9 | 2.2 | -4.0 | 0.6 | 0.13 | 0.00 | |
| 2,118.0 | 0.30 | 332.50 | 2,117.9 | 2.9 | -4.8 | 0.9 | 0.82 | -0.76 | |
| 2,215.0 | 0.40 | 101.00 | 2,214.9 | 3.0 | -4.5 | 1.1 | 0.65 | 0.10 | |
| 2,309.0 | 0.40 | 117.00 | 2,308.9 | 2.8 | -3.9 | 1.2 | 0.12 | 0.00 | |
| 2,404.0 | 0.10 | 119.20 | 2,403.9 | 2.6 | -3.6 | 1.1 | 0.32 | -0.32 | |
| 2,473.0 | 0.20 | 264.10 | 2,472.9 | 2.6 | -3.6 | 1.1 | 0.42 | 0.14 | |
| 2,600.0 | 0.50 | 256.60 | 2,599.9 | 2.4 | -4.4 | 0.6 | 0.24 | 0.24 | |
| 2,694.0 | 0.80 | 289.50 | 2,693.9 | 2.5 | -5.4 | 0.4 | 0.50 | 0.32 | |
| 2,789.0 | 1.10 | 139.10 | 2,788.9 | 2.1 | -5.4 | -0.1 | 1.94 | 0.32 | |
| 2,883.0 | 0.50 | 138.70 | 2,882.9 | 1.1 | -4.6 | -0.7 | 0.64 | -0.64 | |
| 2,977.0 | 0.60 | 166.30 | 2,976.9 | 0.3 | -4.2 | -1.3 | 0.30 | 0.11 | |
| 3,072.0 | 0.80 | 63.20 | 3,071.9 | 0.1 | -3.5 | -1.2 | 1.16 | 0.21 | |
| 3,167.0 | 1.00 | 59.30 | 3,166.9 | 0.8 | -2.2 | 0.0 | 0.22 | 0.21 | |
| 3,261.0 | 0.50 | 22.40 | 3,260.9 | 1.6 | -1.3 | 1.0 | 0.71 | -0.53 | |
| 3,355.0 | 0.40 | 340.30 | 3,354.9 | 2.3 | -1.3 | 1.7 | 0.36 | -0.11 | |
| 3,450.0 | 1.10 | 75.40 | 3,449.9 | 2.9 | -0.5 | 2.5 | 1.27 | 0.74 | |
| 3,544.0 | 0.70 | 100.40 | 3,543.8 | 3.0 | 1.0 | 3.1 | 0.59 | -0.43 | |
| 3,639.0 | 1.00 | 90.80 | 3,638.8 | 2.9 | 2.4 | 3.5 | 0.35 | 0.32 | |
| 3,733.0 | 1.90 | 171.20 | 3,732.8 | 1.3 | 3.4 | 2.5 | 2.12 | 0.96 | |
| 3,828.0 | 0.30 | 198.30 | 3,827.8 | -0.5 | 3.6 | 0.9 | 1.72 | -1.68 | |
| 3,922.0 | 0.70 | 233.30 | 3,921.8 | -1.0 | 3.0 | 0.1 | 0.52 | 0.43 | |
| 4,017.0 | 1.10 | 257.80 | 4,016.8 | -1.6 | 1.7 | -0.9 | 0.58 | 0.42 | |
| 4,111.0 | 1.50 | 270.20 | 4,110.8 | -1.8 | -0.4 | -1.8 | 0.52 | 0.43 | |
| 4,205.0 | 2.10 | 302.10 | 4,204.7 | -0.9 | -3.1 | -1.9 | 1.22 | 0.64 | |
| 4,299.0 | 1.00 | 317.00 | 4,298.7 | 0.7 | -5.1 | -1.3 | 1.24 | -1.17 | |
| 4,394.0 | 0.30 | 308.70 | 4,393.7 | 1.4 | -5.9 | -0.8 | 0.74 | -0.74 | |
| 4,488.0 | 1.00 | 298.00 | 4,487.7 | 2.0 | -6.8 | -0.7 | 0.75 | 0.74 | |
| 4,583.0 | 0.20 | 53.90 | 4,582.7 | 2.4 | -7.4 | -0.4 | 1.16 | -0.84 | |
| 4,677.0 | 0.40 | 274.00 | 4,676.7 | 2.6 | -7.6 | -0.4 | 0.60 | 0.21 | |
| 4,772.0 | 0.80 | 280.40 | 4,771.6 | 2.7 | -8.6 | -0.6 | 0.43 | 0.42 | |
| 4,866.0 | 1.10 | 141.70 | 4,865.6 | 2.1 | -8.7 | -1.2 | 1.89 | 0.32 | |
| 4,961.0 | 0.90 | 174.20 | 4,960.6 | 0.7 | -8.0 | -2.3 | 0.62 | -0.21 | |
| 5,056.0 | 0.80 | 210.80 | 5,055.6 | -0.6 | -8.3 | -3.6 | 0.57 | -0.11 | |
| 5,151.0 | 1.20 | 47.40 | 5,150.6 | -0.5 | -7.9 | -3.4 | 2.08 | 0.42 | |
| 5,246.0 | 1.00 | 358.30 | 5,245.6 | 1.0 | -7.2 | -1.8 | 0.98 | -0.21 | |
| 5,341.0 | 1.10 | 316.80 | 5,340.6 | 2.5 | -7.9 | -0.6 | 0.79 | 0.11 | |
| 5,435.0 | 0.70 | 78.80 | 5,434.6 | 3.2 | -7.9 | 0.1 | 1.69 | -0.43 | |
| 5,530.0 | 0.20 | 7.60 | 5,529.6 | 3.5 | -7.3 | 0.6 | 0.70 | -0.53 | |
| 5,625.0 | 1.00 | 91.50 | 5,624.6 | 3.6 | -6.5 | 1.0 | 1.05 | 0.84 | |
| 5,719.0 | 0.30 | 54.00 | 5,718.6 | 3.8 | -5.4 | 1.5 | 0.83 | -0.74 | |
| 5,814.0 | 0.80 | 104.40 | 5,813.6 | 3.7 | -4.6 | 1.8 | 0.69 | 0.53 | |
| 5,909.0 | 0.30 | 289.40 | 5,908.5 | 3.7 | -4.2 | 1.9 | 1.16 | -0.53 | |
| 6,004.0 | 0.80 | 115.20 | 6,003.5 | 3.5 | -3.8 | 1.8 | 1.16 | 0.53 | |
| 6,098.0 | 0.80 | 279.50 | 6,097.5 | 3.3 | -3.9 | 1.6 | 1.69 | 0.00 | |
| 6,193.0 | 1.10 | 244.60 | 6,192.5 | 3.0 | -5.4 | 0.8 | 0.67 | 0.32 | |

Cathedral Energy Services

Survey Report

| | | | |
|------------------|--|-------------------------------------|---|
| Company: | EnCana Oil & Gas (USA) Inc | Local Co-ordinate Reference: | Well DHN08B-1 A11 2100 (was DH03A-1 A11 210 |
| Project: | Cathedral Bluffs | TVD Reference: | KB=32' @ 7973.0ft (Patterson #326) |
| Site: | Sec 11-2S-R100W | MD Reference: | KB=32' @ 7973.0ft (Patterson #326) |
| Well: | DHN08B-1 A11 2100 (was DH03A-1 A11 2100) | North Reference: | True |
| Wellbore: | Hz | Survey Calculation Method: | Minimum Curvature |
| Design: | FINAL | Database: | USA EDM 5000 Multi Users DB |

| Survey | | | | | | | | | |
|---------------------|-----------------|-------------|---------------------|------------|------------|-----------------------|-----------------------|----------------------|-----------------------|
| Measured Depth (ft) | Inclination (°) | Azimuth (°) | Vertical Depth (ft) | +N/-S (ft) | +E/-W (ft) | Vertical Section (ft) | Dogleg Rate (°/100ft) | Build Rate (°/100ft) | Formations / Comments |
| 6,287.0 | 1.70 | 162.40 | 6,286.5 | 1.3 | -5.8 | -0.9 | 2.02 | 0.64 | |
| 6,382.0 | 1.40 | 266.50 | 6,381.5 | -0.1 | -6.5 | -2.5 | 2.58 | -0.32 | |
| 6,477.0 | 2.20 | 285.90 | 6,476.4 | 0.3 | -9.4 | -3.2 | 1.05 | 0.84 | |
| 6,572.0 | 1.30 | 250.70 | 6,571.4 | 0.5 | -12.2 | -4.0 | 1.43 | -0.95 | |
| 6,666.0 | 0.90 | 161.90 | 6,665.4 | -0.6 | -12.9 | -5.3 | 1.67 | -0.43 | |
| 6,760.0 | 1.20 | 179.20 | 6,759.4 | -2.3 | -12.7 | -6.8 | 0.46 | 0.32 | |
| 6,855.0 | 1.50 | 82.00 | 6,854.4 | -3.1 | -11.5 | -7.1 | 2.14 | 0.32 | |
| 6,950.0 | 0.80 | 96.40 | 6,949.3 | -3.0 | -9.6 | -6.3 | 0.79 | -0.74 | |
| 7,045.0 | 0.40 | 104.30 | 7,044.3 | -3.2 | -8.6 | -6.1 | 0.43 | -0.42 | |
| 7,139.0 | 1.40 | 68.90 | 7,138.3 | -2.8 | -7.2 | -5.3 | 1.17 | 1.06 | |
| 7,233.0 | 0.60 | 49.40 | 7,232.3 | -2.1 | -5.8 | -4.1 | 0.91 | -0.85 | |
| 7,328.0 | 0.60 | 157.00 | 7,327.3 | -2.2 | -5.2 | -4.0 | 1.02 | 0.00 | |
| 7,422.0 | 0.70 | 45.30 | 7,421.3 | -2.3 | -4.6 | -3.8 | 1.15 | 0.11 | |
| 7,517.0 | 1.40 | 93.70 | 7,516.3 | -2.0 | -3.0 | -2.9 | 1.13 | 0.74 | |
| 7,611.0 | 0.30 | 56.50 | 7,610.3 | -1.9 | -1.7 | -2.4 | 1.25 | -1.17 | |
| 7,705.0 | 0.20 | 128.00 | 7,704.3 | -1.9 | -1.3 | -2.2 | 0.32 | -0.11 | |
| 7,800.0 | 1.10 | 133.50 | 7,799.3 | -2.6 | -0.5 | -2.6 | 0.95 | 0.95 | |
| 7,895.0 | 0.60 | 176.80 | 7,894.3 | -3.7 | 0.2 | -3.4 | 0.82 | -0.53 | |
| 7,965.0 | 1.20 | 241.40 | 7,964.2 | -4.4 | -0.5 | -4.3 | 1.55 | 0.86 | |
| 8,101.0 | 2.50 | 269.40 | 8,100.2 | -5.1 | -4.7 | -6.5 | 1.14 | 0.96 | |
| 8,196.0 | 2.20 | 230.50 | 8,195.1 | -6.3 | -8.2 | -8.9 | 1.67 | -0.32 | |
| 8,290.0 | 0.50 | 234.30 | 8,289.1 | -7.7 | -9.9 | -10.8 | 1.81 | -1.81 | |
| 8,385.0 | 1.40 | 42.80 | 8,384.1 | -7.1 | -9.4 | -10.1 | 1.99 | 0.95 | |
| 8,480.0 | 2.20 | 355.10 | 8,479.0 | -4.4 | -8.8 | -7.3 | 1.71 | 0.84 | |
| 8,574.0 | 0.90 | 354.60 | 8,573.0 | -1.9 | -9.0 | -5.1 | 1.38 | -1.38 | |
| 8,669.0 | 1.80 | 194.00 | 8,668.0 | -2.6 | -9.5 | -5.9 | 2.81 | 0.95 | |
| 8,764.0 | 1.10 | 92.70 | 8,763.0 | -4.1 | -8.9 | -7.1 | 2.41 | -0.74 | |
| 8,859.0 | 1.60 | 55.20 | 8,857.9 | -3.4 | -6.9 | -5.7 | 1.04 | 0.53 | |
| 8,953.0 | 0.40 | 190.00 | 8,951.9 | -3.0 | -5.9 | -4.9 | 2.02 | -1.28 | |
| 9,048.0 | 2.00 | 303.60 | 9,046.9 | -2.4 | -7.3 | -4.9 | 2.31 | 1.68 | |
| 9,143.0 | 1.20 | 311.20 | 9,141.9 | -0.8 | -9.5 | -4.2 | 0.87 | -0.84 | |
| 9,238.0 | 3.20 | 52.00 | 9,236.8 | 1.5 | -8.1 | -1.6 | 3.81 | 2.11 | |
| 9,269.0 | 4.00 | 44.10 | 9,267.7 | 2.8 | -6.7 | 0.2 | 3.03 | 2.58 | |
| 9,300.0 | 4.30 | 40.30 | 9,298.7 | 4.5 | -5.2 | 2.3 | 1.31 | 0.97 | |
| 9,332.0 | 4.70 | 41.60 | 9,330.6 | 6.4 | -3.5 | 4.6 | 1.29 | 1.25 | |
| 9,364.0 | 6.10 | 43.10 | 9,362.4 | 8.6 | -1.5 | 7.4 | 4.40 | 4.37 | |
| 9,395.0 | 8.20 | 39.80 | 9,393.2 | 11.5 | 1.0 | 11.1 | 6.90 | 6.77 | |
| 9,426.0 | 9.30 | 34.50 | 9,423.8 | 15.3 | 3.9 | 15.6 | 4.40 | 3.55 | |
| 9,458.0 | 10.40 | 27.80 | 9,455.3 | 19.9 | 6.7 | 21.0 | 4.96 | 3.44 | |
| 9,489.0 | 11.90 | 26.20 | 9,485.8 | 25.3 | 9.4 | 27.0 | 4.94 | 4.84 | |
| 9,521.0 | 13.20 | 26.10 | 9,517.0 | 31.5 | 12.5 | 33.9 | 4.06 | 4.06 | |
| 9,552.0 | 14.50 | 25.40 | 9,547.1 | 38.2 | 15.7 | 41.3 | 4.23 | 4.19 | |
| 9,583.0 | 14.70 | 24.40 | 9,577.1 | 45.3 | 19.0 | 49.1 | 1.04 | 0.65 | |
| 9,615.0 | 15.10 | 22.90 | 9,608.0 | 52.8 | 22.3 | 57.3 | 1.74 | 1.25 | |
| 9,646.0 | 16.50 | 21.90 | 9,637.8 | 60.6 | 25.5 | 65.8 | 4.60 | 4.52 | |
| 9,678.0 | 19.40 | 21.60 | 9,668.3 | 69.8 | 29.1 | 75.6 | 9.07 | 9.06 | |
| 9,709.0 | 21.80 | 22.40 | 9,697.3 | 79.9 | 33.2 | 86.5 | 7.79 | 7.74 | |
| 9,740.0 | 22.50 | 23.80 | 9,726.0 | 90.7 | 37.8 | 98.2 | 2.83 | 2.26 | |
| 9,772.0 | 23.90 | 26.20 | 9,755.4 | 102.1 | 43.2 | 110.8 | 5.28 | 4.37 | |
| 9,803.0 | 25.30 | 26.90 | 9,783.6 | 113.6 | 48.9 | 123.6 | 4.61 | 4.52 | |
| 9,834.0 | 27.50 | 26.70 | 9,811.4 | 125.9 | 55.1 | 137.4 | 7.10 | 7.10 | |
| 9,866.0 | 29.00 | 25.90 | 9,839.6 | 139.5 | 61.9 | 152.5 | 4.83 | 4.69 | |
| 9,898.0 | 30.10 | 24.40 | 9,867.4 | 153.8 | 68.6 | 168.2 | 4.14 | 3.44 | |

Cathedral Energy Services

Survey Report

| | | | |
|------------------|--|-------------------------------------|---|
| Company: | EnCana Oil & Gas (USA) Inc | Local Co-ordinate Reference: | Well DHN08B-1 A11 2100 (was DH03A-1 A11 210 |
| Project: | Cathedral Bluffs | TVD Reference: | KB=32' @ 7973.0ft (Patterson #326) |
| Site: | Sec 11-2S-R100W | MD Reference: | KB=32' @ 7973.0ft (Patterson #326) |
| Well: | DHN08B-1 A11 2100 (was DH03A-1 A11 2100) | North Reference: | True |
| Wellbore: | Hz | Survey Calculation Method: | Minimum Curvature |
| Design: | FINAL | Database: | USA EDM 5000 Multi Users DB |

| Survey | | | | | | | | | |
|---------------------|-----------------|-------------|---------------------|------------|------------|-----------------------|-----------------------|----------------------|---|
| Measured Depth (ft) | Inclination (°) | Azimuth (°) | Vertical Depth (ft) | +N/-S (ft) | +E/-W (ft) | Vertical Section (ft) | Dogleg Rate (°/100ft) | Build Rate (°/100ft) | Formations / Comments |
| 9,929.0 | 30.50 | 23.70 | 9,894.2 | 168.1 | 74.9 | 183.8 | 1.72 | 1.29 | |
| 9,960.0 | 31.80 | 23.50 | 9,920.7 | 182.8 | 81.3 | 199.9 | 4.21 | 4.19 | |
| 9,992.0 | 33.00 | 22.90 | 9,947.7 | 198.5 | 88.1 | 217.0 | 3.88 | 3.75 | |
| 10,092.0 | 36.70 | 17.60 | 10,029.8 | 252.1 | 107.7 | 274.1 | 4.78 | 3.70 | |
| 10,124.0 | 36.10 | 16.00 | 10,055.5 | 270.3 | 113.2 | 293.0 | 3.51 | -1.87 | |
| 10,155.0 | 37.10 | 17.60 | 10,080.4 | 288.0 | 118.6 | 311.4 | 4.46 | 3.23 | |
| 10,187.0 | 38.60 | 18.80 | 10,105.7 | 306.6 | 124.7 | 331.0 | 5.22 | 4.69 | |
| 10,219.0 | 40.20 | 20.00 | 10,130.4 | 325.8 | 131.5 | 351.3 | 5.54 | 5.00 | |
| 10,250.0 | 42.40 | 20.10 | 10,153.7 | 345.0 | 138.5 | 371.8 | 7.10 | 7.10 | |
| 10,282.0 | 44.70 | 20.60 | 10,176.9 | 365.7 | 146.1 | 393.8 | 7.27 | 7.19 | |
| 10,291.0 | 45.40 | 20.70 | 10,183.3 | 371.6 | 148.4 | 400.2 | 7.82 | 7.78 | |
| 10,321.0 | 47.00 | 21.10 | 10,204.0 | 391.9 | 156.1 | 421.8 | 5.42 | 5.33 | |
| 10,352.0 | 47.70 | 21.80 | 10,225.0 | 413.1 | 164.5 | 444.6 | 2.80 | 2.26 | |
| 10,384.0 | 49.60 | 20.90 | 10,246.2 | 435.5 | 173.2 | 468.6 | 6.30 | 5.94 | |
| 10,415.0 | 51.30 | 20.60 | 10,265.9 | 457.8 | 181.7 | 492.5 | 5.53 | 5.48 | |
| 10,447.0 | 52.10 | 20.10 | 10,285.7 | 481.4 | 190.4 | 517.7 | 2.78 | 2.50 | |
| 10,479.0 | 53.10 | 18.70 | 10,305.2 | 505.3 | 198.8 | 543.1 | 4.67 | 3.12 | Last Cathedral Survey @ 10,479' MD Projection to Bit @ 10,579' |
| 10,579.0 | 53.10 | 18.70 | 10,365.2 | 581.1 | 224.5 | 622.9 | 0.00 | 0.00 | |

| Targets | | | | | | | | | |
|--|---------------|--------------|----------|------------|------------|---------------|--------------|-----------------|------------------|
| Target Name - hit/miss target - Shape | Dip Angle (°) | Dip Dir. (°) | TVD (ft) | +N/-S (ft) | +E/-W (ft) | Northing (ft) | Easting (ft) | Latitude | Longitude |
| DHN08B-1 A11 LP (3) - actual wellpath misses target center by 668.6ft at 10579.0ft MD (10365.2 TVD, 581.1 N, 224.5 E) - Point | 0.00 | 0.00 | 9,866.1 | 993.4 | 391.8 | 1,766,305.70 | 2,136,701.31 | 39° 53' 49.82 N | 108° 34' 38.31 W |
| DHN08B-1 A11 LP (P7) - actual wellpath misses target center by 478.0ft at 10579.0ft MD (10365.2 TVD, 581.1 N, 224.5 E) - Point | 0.00 | 0.00 | 10,539.9 | 993.4 | 391.8 | 1,766,305.70 | 2,136,701.31 | 39° 53' 49.82 N | 108° 34' 38.31 W |
| DHN08B-1 A11 BHL (P7) - actual wellpath misses target center by 5154.8ft at 10579.0ft MD (10365.2 TVD, 581.1 N, 224.5 E) - Point | 0.00 | 0.00 | 10,424.8 | 5,374.4 | 2,119.7 | 1,770,625.73 | 2,138,576.66 | 39° 54' 33.11 N | 108° 34' 16.14 W |
| DHN08B-1 A11 BHL (3) - actual wellpath misses target center by 5157.5ft at 10579.0ft MD (10365.2 TVD, 581.1 N, 224.5 E) - Point | 0.00 | 0.00 | 10,188.0 | 5,374.4 | 2,119.7 | 1,770,625.73 | 2,138,576.66 | 39° 54' 33.11 N | 108° 34' 16.14 W |

| Design Annotations | | | | | |
|---------------------|---------------------|-------------------|------------|------------------------------------|--|
| Measured Depth (ft) | Vertical Depth (ft) | Local Coordinates | | Comment | |
| | | +N/-S (ft) | +E/-W (ft) | | |
| 10,479.0 | 10,305.2 | 505.3 | 198.8 | Last Cathedral Survey @ 10,479' MD | |
| 10,579.0 | 10,365.2 | 581.1 | 224.5 | Projection to Bit @ 10,579' | |

Checked By: _____ Approved By: _____ Date: _____