

GREAT WESTERN OIL & GAS COMPANY

SCHMUNK EF 31-361HN, 31-362HN, 31-363HC, 31-365HN, 31-367HN, 31-368HC,
31-369HN, 31-A, 31-B, 31-C, 31-D & 31-E ON EXISTING SCHMUNK 31-31 WELL PAD

LOCATED IN WELD COUNTY, COLORADO

SECTION 31, T7N, R65W, 6th P.M.



PHOTO: VIEW FROM LOCATION STAKES TO CORNER #1

CAMERA ANGLE: SOUTHERLY



PHOTO: VIEW FROM BEGINNING OF PROPOSED ACCESS

CAMERA ANGLE: NORTHERLY



U
E
L
S

Uintah Engineering & Land Surveying
85 South 200 East Vernal, Utah 84078
(435) 789-1017 * FAX (435) 789-1813

LOCATION PHOTOS

09 12 13
MONTH DAY YEAR

TAKEN BY: Z.B.

DRAWN BY: J.L.G.

REV: 10-25-13 J.C.

PHOTO
P1

GREAT WESTERN OIL & GAS COMPANY

SCHMUNK EF 31-361HN, 31-362HN, 31-363HC, 31-365HN, 31-367HN, 31-368HC,
31-369HN, 31-A, 31-B, 31-C, 31-D & 31-E ON EXISTING SCHMUNK 31-31 WELL PAD

LOCATED IN WELD COUNTY, COLORADO

SECTION 31, T7N, R65W, 6th P.M.



PHOTO: VIEW OF LOCATION STAKES

CAMERA ANGLE: NORTHERLY



PHOTO: VIEW OF LOCATION STAKES

CAMERA ANGLE: EASTERLY



UELS

Uintah Engineering & Land Surveying
85 South 200 East Vernal, Utah 84078
(435) 789-1017 * FAX (435) 789-1813

LOCATION PHOTOS

09 12 13
MONTH DAY YEAR

TAKEN BY: Z.B.

DRAWN BY: J.L.G.

REV: 10-25-13 J.C.

PHOTO
P2

GREAT WESTERN OIL & GAS COMPANY

SCHMUNK EF 31-361HN, 31-362HN, 31-363HC, 31-365HN, 31-367HN, 31-368HC,
31-369HN, 31-A, 31-B, 31-C, 31-D & 31-E ON EXISTING SCHMUNK 31-31 WELL PAD
LOCATED IN WELD COUNTY, COLORADO
SECTION 31, T7N, R65W, 6th P.M.

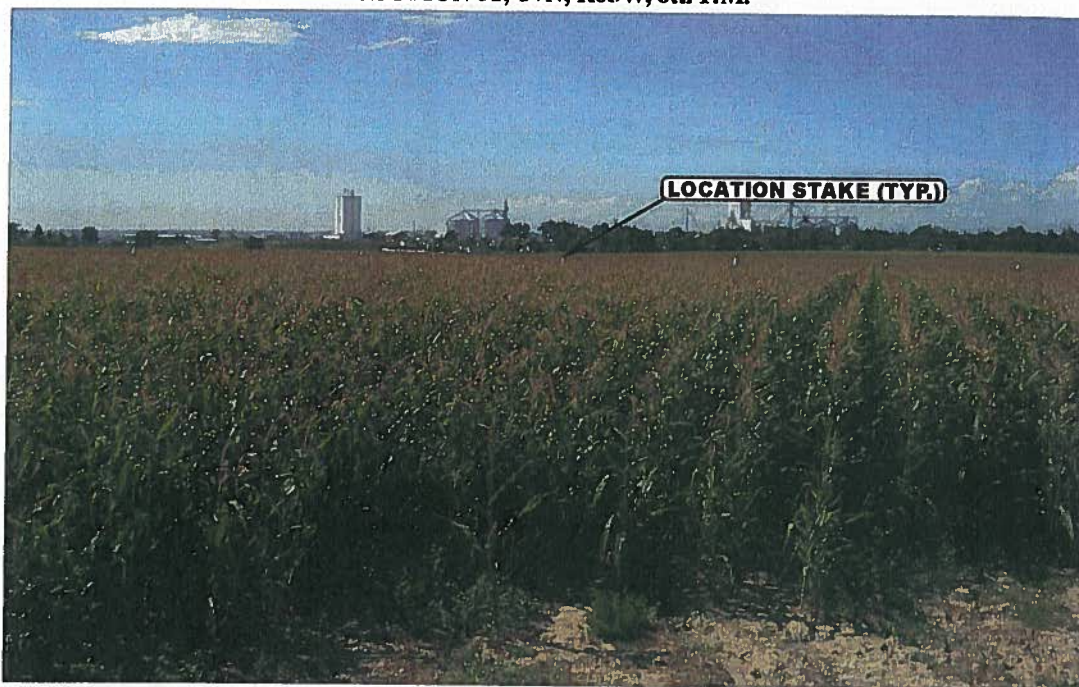

PHOTO: VIEW OF LOCATION STAKES

CAMERA ANGLE: SOUTHERLY

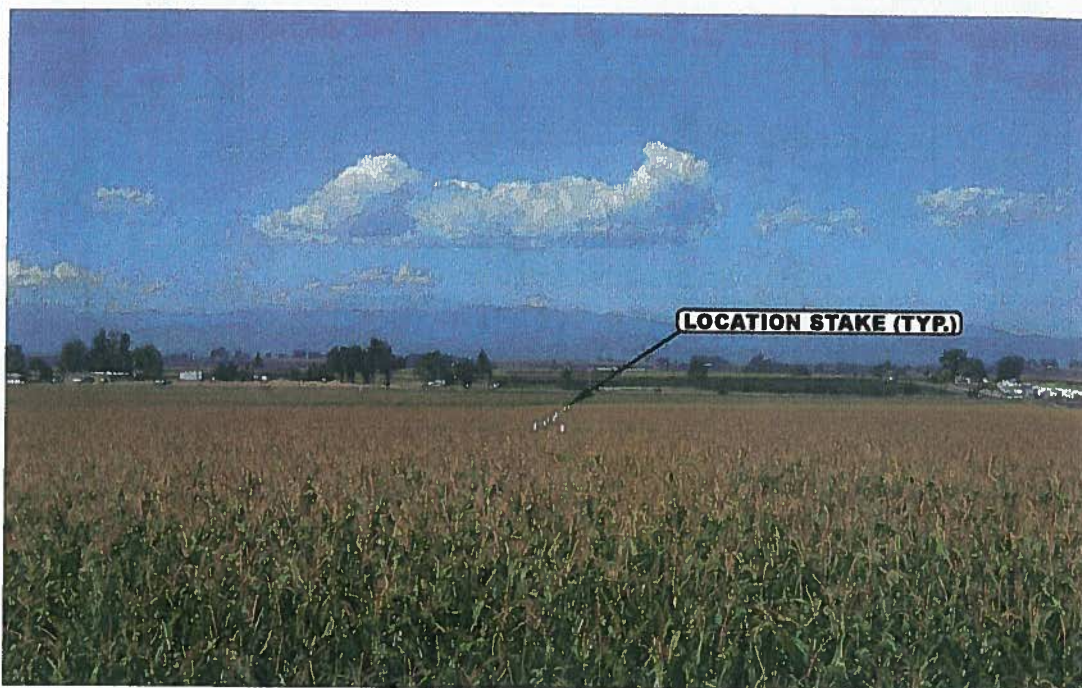

PHOTO: VIEW OF LOCATION STAKES

CAMERA ANGLE: WESTERLY



- Since 1964 -

UELS

Uintah Engineering & Land Surveying
85 South 200 East Vernal, Utah 84078
(435) 789-1017 * FAX (435) 789-1813

LOCATION PHOTOS

09 12 13
MONTH DAY YEAR

TAKEN BY: Z.B. DRAWN BY: J.L.G. REV: 10-25-13 J.C.

PHOTO
P3