

Lease Map – Romero PC G10-79HN

T4N-R65W Section 3: SW/4NW/4, W/2SW/4, 4: SE/4NE/4,
E/2SE/4, 9: E/2NE/4, NE/4SE/4, 10: W/2NW/4, NW/4SW/4

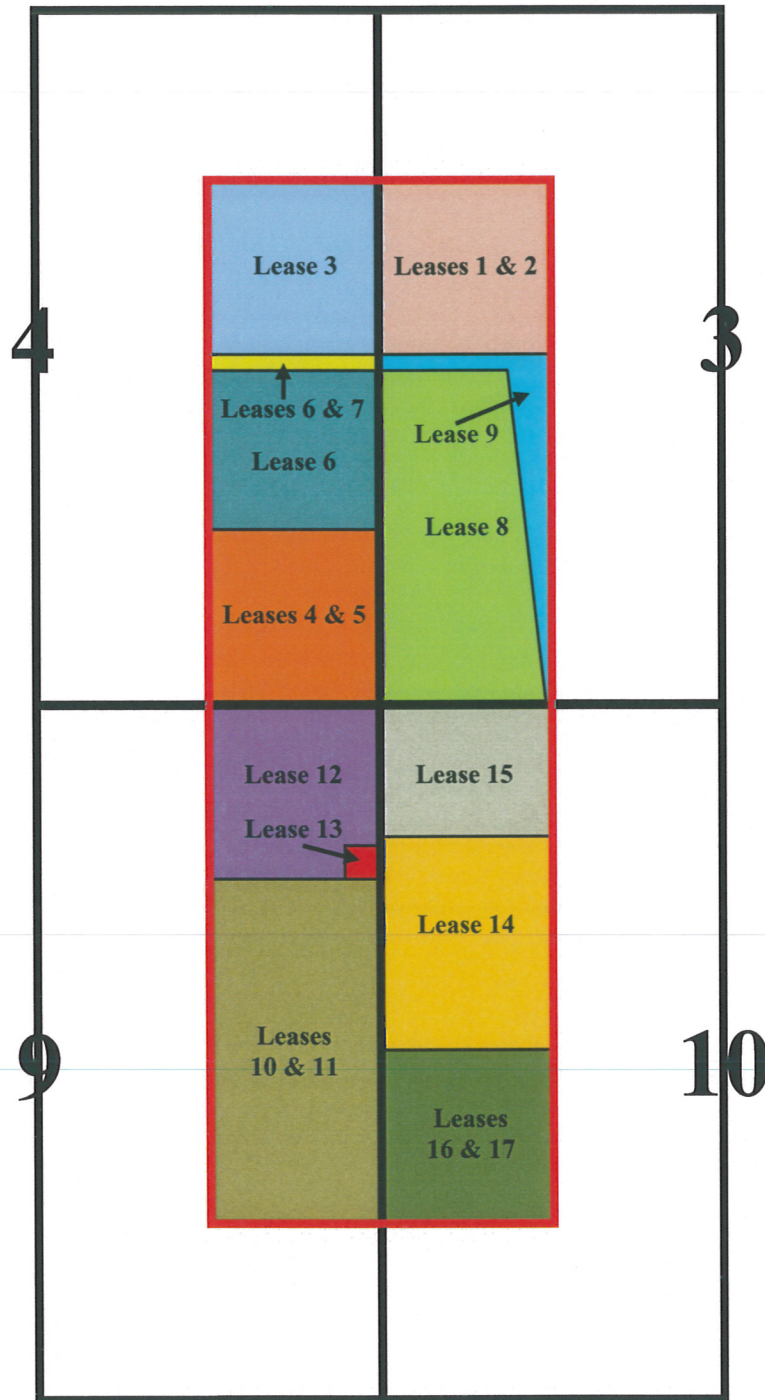

Leases:

1) T4N-R65W

3: Lot 4 (36.56), SW/4NW/4, also described as the entire W/2NW/4

2) W/2NW/4 of Section 3, T4N-R65W

3) E/2NE/4 of Section 4, T4N-R65W

4) S/2SE/4 of Section 4, T4N-R65W

5) S/2SE/4 of Section 4, T4N-R65W

6) T4N-R65W

4: The West Half of the Northwest Quarter (W/2NW/4) and the North Half of the Southeast Quarter (N/2SE/4) Excepting therefrom .918 acres conveyed by Warranty Deed recorded in Book 638, Reception #1560198

7) T4N-R65W

4: A strip of land sixty-six feet in width across the North end of the Southeast quarter

8) T4N-R65W

3: W/2SW/4

4: Lot 2 excluding a tract of land described as follows: Lot A as shown on recorded Exemption No. 1055-4-1-RE-153 recorded December 20, 1974 in Book 729 under Reception No. 1650643, Weld County Records, SW/4NE/4

9) TOWNSHIP 4 NORTH - RANGE 65 WEST, 6TH P.M.

Section 2: Lots 1,2,3,4, SW/4, S/4

Section 3: Lots 1,2,3, S/4NE, SE/4NW, E/4SW, SE/4, and that part of the W/4SW/4 lying East of the C.B. & Q. Railroad right of way, containing 10 acres more or less; A strip of land 60 feet wide off of the North side of NW/4SW/4 containing 2 acres more or less.

Section 5: Part of the E/4 described as follows: A strip of land 80 feet wide, the center line of which is described as follows: Commencing at a point whence the quarter corner on the North side of Section 5, bears North 13° 25' West 1510 feet distant; thence by true bearing (variation 14° 15' East) South 62° 45' East 2640 feet to a point 65 feet South of the quarter corner between Sections 4 & 5, containing 5 acres more or less.

Section 10: That part of the NE/4 described as follows: Commencing at the northeast corner of said quarter section, running thence South 89° 50' West on the North boundary line of said quarter section 1006.8 feet to a point; thence South 0° 10' East 800 feet to a point; thence North 89° 50' East 1006.8 feet to a point on the East boundary line of said quarter section; thence running North 0° 10' West on the East boundary line of said quarter section 800 feet to the point of beginning, containing 18.49 acres more or less.

TOWNSHIP 5 NORTH - RANGE 65 WEST, 6TH P.M.

Section 34: That part of the SE/4 described as follows: Beginning at a point from whence the quarter corner common to Sections 34 & 35 bears North 0° 10' West 1 259 feet; thence by true course and distance as follows: South 68° 14' West 2812 feet to a point; thence North 0° 10' East 203.8 feet to a point, said point being 73 feet North of the center line of the Lower Latham Reservoir dam as now constructed; thence North 69° 17' East 2813 feet to a point, said point being 53 feet North of the center line of the Lower Latham Reservoir dam as now constructed; thence North 0° 10' West 210 feet to the point of beginning, containing 12.4 acres more or less.

That part of the SE/4 containing 40 acres described as follows: Commencing at the quarter corner common to Section 35, thence North 138 feet; thence North 69° 17' East 2850 feet; thence South 1171 feet; thence West 2640 feet to the point of beginning.

Section 35: SW/4, W/4SW/4, and a strip of land in the NE/4 described as follows: Commencing at a point 875 feet East of the quarter corner between Sections 34 & 35; thence running North 81° 44' East 2038.8 feet; thence South 35° 28' East 85.1 feet; thence South 7° 11' East 150 feet to the half section line bisecting said Section 35; thence West on said half section line to the point of beginning, containing 7.3 acres more or less. Also a parcel of land described as follows: Beginning at a point on the West and West quarter section line through Section 35 from whence the quarter corner common to Sections 34 & 35 bears South 89° 55' West 930 feet; thence by true course and distance as follows: North 89° 55' East along said quarter section line 280.25 feet; thence North 80° 40' East 1463.3 feet to a point on the North & South quarter section line through said section 35; from whence the center of said Section 35 bears South 0° 15' East, 235.8 feet, continuing North 0° 15' West along said quarter section line, 132.89 feet; South 80° 46' West 1288.45 feet; thence South 78° 29' West 480 feet; thence South 12° 30' East 69.79 feet to the point of beginning, containing 5 acres more or less.

- 10) T4N-R65W
4: S/2SW/4
9: West 60.00 acres of SW/4, E/2SE/4, SE/4NE/4
- 11) E/2SE/4, SE/4NE/4 of Section 9, T4N-R65W
- 12) T4N-R65W
9: N/2NE/4 excluding Lot B of Recorded Exemption No. 1055-9-1-RE79 recorded August 16, 1973, in Book 698 as Reception No. 1619522, Weld County Records
- 13) T4N-R65W
9: Lot B of Recorded Exemption No. 1055-9-1-RE79 recorded August 16, 1973, in Book 698 as Reception No. 1619522, Weld County Records
- 14) T4N-R65W
10: SW/4NW/4 and the So. 20 ac. of the N.2NW/4
- 15) T4N-R65W
10: NW/4 lying East of C.B.&O. right of way as conveyed in Book 1218, P. 247, The N. 906 feet of the NW/4 lying W. of the East line of the C.B.&O. RR
- 16) T4N-R65W
10: W/2SW/4
15: N/2NW/4
- 17) T4N-R65W
10: W/2SW/4
15: N/2NW/4

Total Acreage: 3,115.44