

SECTION 35

SECTION 36

PICADILLY RD.

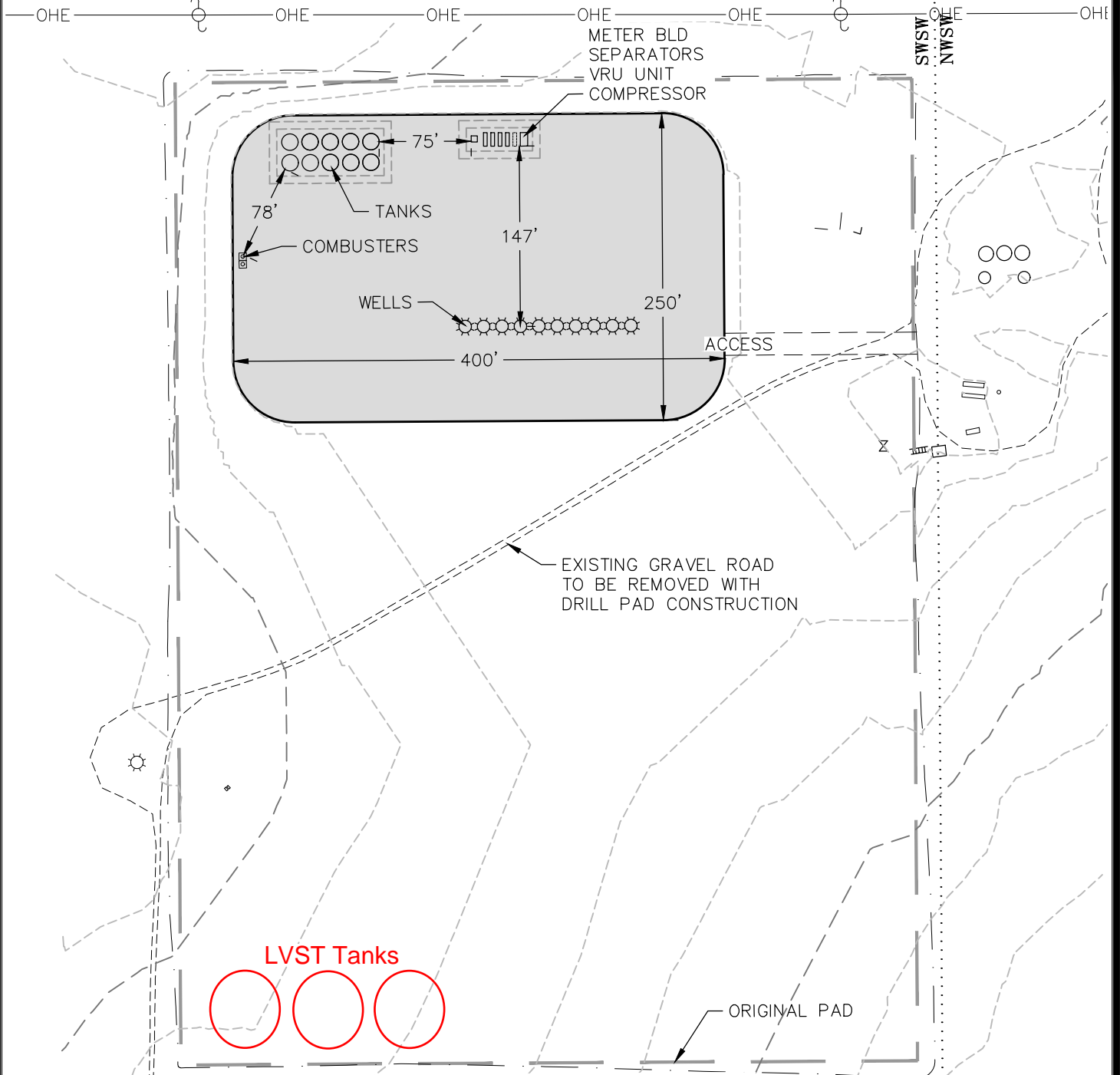

NOTES:

- 1) THIS IS A TYPICAL LAYOUT FOR THE PRODUCTION EQUIPMENT AND IS SUBJECT TO CHANGE DUE TO WELL PRODUCTION AND OPERATOR'S NEEDS.
- 2) PRODUCTION EQUIPMENT LAYOUT MUST MEET COGCC OFFSET REQUIREMENTS
- 3) TOTAL DISTURBED AREA INCLUDES TOPSOIL AND EXCESS MATERIAL STOCKPILE AREAS.
- 4) RECLAIMED SLOPES ARE VARIABLE.

TOTAL DISTURBED AREA = 12.26 ac.
 RECLAIMED AREA = 10.01 ac.
 UN-RECLAIMED AREA = 2.25 ac.
 (SHADED AREA)



ECLIPSE
 Surveying, Inc.

230 MAIN STREET, FORT MORGAN, CO 80701
 (970) 370-2263

REV. DATE: ----

SCALE: 1" = 120'

DATE: 9/18/13

SHEET: 6 OF 8

PROJECT: 36-1S-66W S

DFT: TAB



Bill Barrett Corporation

STATE OF COLORADO 36-1S-66W SOUTH
 RECLAIMED PAD & PRODUCTION
 EQUIPMENT