

Catamount Energy Partners

**San Juan Basin
La Plata County CO
Campbell 33-7-4 #2H**

Lateral #1

Plan: Plan #1

Standard Planning Report

30 October, 2013



Project: San Juan Basin
 Site: La Plata County CO
 Well: Campbell 33-7-4 #2H
 Wellbore: Lateral #1
 Design: Plan #1

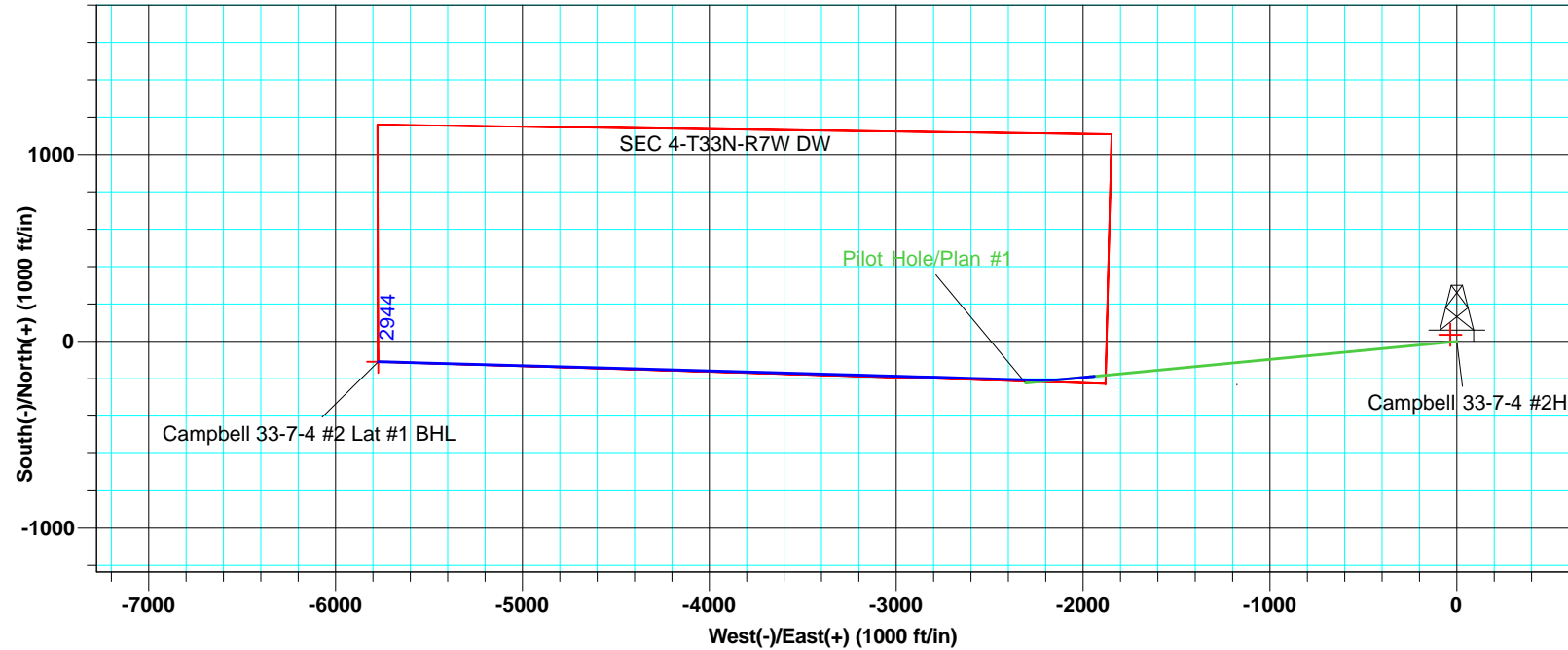

| WELL DETAILS | | | | | |
|----------------------|-------|------------|------------|-----------------|------------------|
| Campbell 33-7-4 #2H | | | | | |
| Ground Level: 6689.0 | | | | | |
| +N/-S | +E/-W | Northing | Easting | Latitude | Longitude |
| 0.0 | 0.0 | 1174967.71 | 2387533.00 | 37° 7' 41.770 N | 107° 36' 3.328 W |

| SITE DETAILS: La Plata County CO | |
|----------------------------------|------------|
| Site Centre Northing: | 760788.19 |
| Easting: | 2556100.64 |
| Positional Uncertainty: | 0.0 |
| Convergence: | -0.92 |
| Local North: | Grid |

| PROJECT DETAILS: San Juan Basin | |
|---------------------------------|---------------------------|
| Geodetic System: | US State Plane 1983 |
| Datum: | North American Datum 1983 |
| Ellipsoid: | GRS 1980 |
| Zone: | Colorado Southern Zone |
| System Datum: | Mean Sea Level |

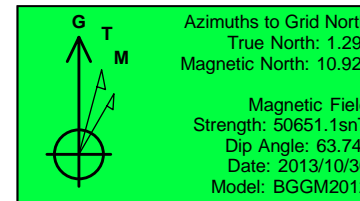

ALL AZIMUTHS MUST BE CORRECTED TO GRID NORTH
 To convert a Magnetic Direction to a Grid Direction, Add 10.92°
 To convert a True Direction to a Grid Direction, Add 1.29°

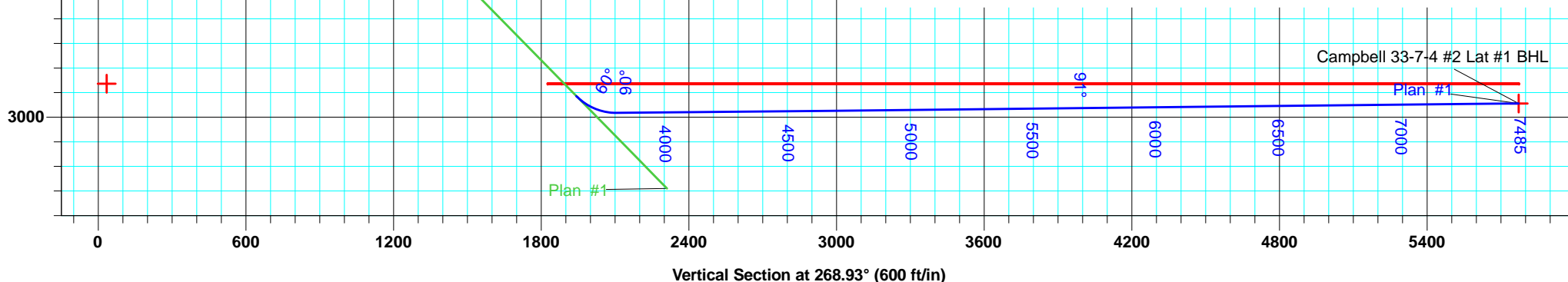

| | | | |
|------------------|---------------------------|-------------------------------------|------------------------------------|
| Database: | EDM 5000.1 Old | Local Co-ordinate Reference: | Well Campbell 33-7-4 #2H |
| Company: | Catamount Energy Partners | TVD Reference: | KB @ 6701.0ft (Original Well Elev) |
| Project: | San Juan Basin | MD Reference: | KB @ 6701.0ft (Original Well Elev) |
| Site: | La Plata County CO | North Reference: | Grid |
| Well: | Campbell 33-7-4 #2H | Survey Calculation Method: | Minimum Curvature |
| Wellbore: | Lateral #1 | | |
| Design: | Plan #1 | | |

| | | | |
|--------------------|--|----------------------|-----------------------------|
| Project | San Juan Basin, Southern Colorado, Fruitland Coal HZ | | |
| Map System: | US State Plane 1983 | System Datum: | Mean Sea Level |
| Geo Datum: | North American Datum 1983 | | Using Well Reference Point |
| Map Zone: | Colorado Southern Zone | | Using geodetic scale factor |

| | | | |
|------------------------------|--------------------|--------------------------|-------------------|
| Site | La Plata County CO | | |
| Site Position: | | Northing: | 760,788.19 usft |
| From: | Lat/Long | Easting: | 2,556,100.64 usft |
| Position Uncertainty: | 0.0 ft | Slot Radius: | 6-1/8 " |
| | | Latitude: | 36° 0' 0.000 N |
| | | Longitude: | 107° 0' 0.000 W |
| | | Grid Convergence: | -0.92 ° |

| | | | |
|-----------------------------|--|---------------|------------------------------------|
| Well | Campbell 33-7-4 #2H, Fruitland Coal Horizontal | | |
| Well Position | +N/-S | 413,993.4 ft | Northing: 1,174,967.71 usft |
| | +E/-W | -168,491.9 ft | Easting: 2,387,533.00 usft |
| Position Uncertainty | | 1.0 ft | Wellhead Elevation: |
| | | | Ground Level: 6,689.0 ft |

| | | | | | |
|------------------|-------------------|--------------------|------------------------|----------------------|----------------------------|
| Wellbore | Lateral #1 | | | | |
| Magnetics | Model Name | Sample Date | Declination (°) | Dip Angle (°) | Field Strength (nT) |
| | BGGM2012 | 2013/10/30 | 9.63 | 63.74 | 50,651 |

| | | | | |
|--------------------------|------------------------------|-------------------|----------------------|----------------------|
| Design | Plan #1 | | | |
| Audit Notes: | | | | |
| Version: | Phase: | PLAN | Tie On Depth: | 3,632.0 |
| Vertical Section: | Depth From (TVD) (ft) | +N/-S (ft) | +E/-W (ft) | Direction (°) |
| | 0.0 | 0.0 | 0.0 | 268.93 |

| Plan Sections | | | | | | | | | | |
|----------------------|-----------------|-------------|---------------------|------------|------------|-------------------------|------------------------|-----------------------|---------|--------------------|
| Measured Depth (ft) | Inclination (°) | Azimuth (°) | Vertical Depth (ft) | +N/-S (ft) | +E/-W (ft) | Dogleg Rate (°/100usft) | Build Rate (°/100usft) | Turn Rate (°/100usft) | TFO (°) | Target |
| 3,632.0 | 44.50 | 264.50 | 2,914.2 | -186.8 | -1,939.6 | 0.00 | 0.00 | 0.00 | 0.00 | |
| 3,814.0 | 90.00 | 264.50 | 2,982.7 | -202.4 | -2,102.3 | 25.00 | 25.00 | 0.00 | 0.00 | |
| 3,956.8 | 90.62 | 271.61 | 2,982.0 | -207.3 | -2,244.9 | 5.00 | 0.43 | 4.98 | 85.03 | |
| 7,484.5 | 90.62 | 271.61 | 2,944.0 | -108.0 | -5,771.0 | 0.00 | 0.00 | 0.00 | 0.00 | Campbell 33-7-4 #2 |

| | | | |
|------------------|---------------------------|-------------------------------------|------------------------------------|
| Database: | EDM 5000.1 Old | Local Co-ordinate Reference: | Well Campbell 33-7-4 #2H |
| Company: | Catamount Energy Partners | TVD Reference: | KB @ 6701.0ft (Original Well Elev) |
| Project: | San Juan Basin | MD Reference: | KB @ 6701.0ft (Original Well Elev) |
| Site: | La Plata County CO | North Reference: | Grid |
| Well: | Campbell 33-7-4 #2H | Survey Calculation Method: | Minimum Curvature |
| Wellbore: | Lateral #1 | | |
| Design: | Plan #1 | | |

| Planned Survey | | | | | | | | | |
|--------------------------|-----------------|-------------|---------------------|------------|------------|-----------------------|-------------------------|------------------------|-----------------------|
| Measured Depth (ft) | Inclination (°) | Azimuth (°) | Vertical Depth (ft) | +N/-S (ft) | +E/-W (ft) | Vertical Section (ft) | Dogleg Rate (°/100usft) | Build Rate (°/100usft) | Turn Rate (°/100usft) |
| 0.0 | 0.00 | 0.00 | 0.0 | 0.0 | 0.0 | 0.0 | 0.00 | 0.00 | 0.00 |
| 100.0 | 0.00 | 0.00 | 100.0 | 0.0 | 0.0 | 0.0 | 0.00 | 0.00 | 0.00 |
| 150.0 | 0.00 | 0.00 | 150.0 | 0.0 | 0.0 | 0.0 | 0.00 | 0.00 | 0.00 |
| 200.0 | 1.50 | 264.50 | 200.0 | -0.1 | -0.7 | 0.7 | 3.00 | 3.00 | 0.00 |
| 300.0 | 4.50 | 264.50 | 299.8 | -0.6 | -5.9 | 5.9 | 3.00 | 3.00 | 0.00 |
| 400.0 | 7.50 | 264.50 | 399.3 | -1.6 | -16.3 | 16.3 | 3.00 | 3.00 | 0.00 |
| 500.0 | 10.50 | 264.50 | 498.0 | -3.1 | -31.8 | 31.9 | 3.00 | 3.00 | 0.00 |
| 600.0 | 13.50 | 264.50 | 595.8 | -5.1 | -52.5 | 52.6 | 3.00 | 3.00 | 0.00 |
| 700.0 | 16.50 | 264.50 | 692.4 | -7.5 | -78.3 | 78.4 | 3.00 | 3.00 | 0.00 |
| 800.0 | 19.50 | 264.50 | 787.5 | -10.5 | -109.0 | 109.2 | 3.00 | 3.00 | 0.00 |
| 900.0 | 22.50 | 264.50 | 880.9 | -13.9 | -144.7 | 144.9 | 3.00 | 3.00 | 0.00 |
| 1,000.0 | 25.50 | 264.50 | 972.2 | -17.8 | -185.2 | 185.5 | 3.00 | 3.00 | 0.00 |
| 1,100.0 | 28.50 | 264.50 | 1,061.3 | -22.2 | -230.4 | 230.8 | 3.00 | 3.00 | 0.00 |
| 1,200.0 | 31.50 | 264.50 | 1,147.9 | -27.0 | -280.1 | 280.6 | 3.00 | 3.00 | 0.00 |
| 1,300.0 | 34.50 | 264.50 | 1,231.8 | -32.2 | -334.3 | 334.9 | 3.00 | 3.00 | 0.00 |
| 1,400.0 | 37.50 | 264.50 | 1,312.6 | -37.8 | -392.8 | 393.5 | 3.00 | 3.00 | 0.00 |
| 1,500.0 | 40.50 | 264.50 | 1,390.4 | -43.9 | -455.5 | 456.2 | 3.00 | 3.00 | 0.00 |
| 1,600.0 | 43.50 | 264.50 | 1,464.7 | -50.3 | -522.1 | 522.9 | 3.00 | 3.00 | 0.00 |
| 1,633.3 | 44.50 | 264.50 | 1,488.6 | -52.5 | -545.1 | 546.0 | 3.00 | 3.00 | 0.00 |
| 1,700.0 | 44.50 | 264.50 | 1,536.2 | -57.0 | -591.6 | 592.6 | 0.00 | 0.00 | 0.00 |
| 1,800.0 | 44.50 | 264.50 | 1,607.5 | -63.7 | -661.4 | 662.5 | 0.00 | 0.00 | 0.00 |
| 1,900.0 | 44.50 | 264.50 | 1,678.8 | -70.4 | -731.2 | 732.4 | 0.00 | 0.00 | 0.00 |
| 2,000.0 | 44.50 | 264.50 | 1,750.2 | -77.1 | -800.9 | 802.2 | 0.00 | 0.00 | 0.00 |
| 2,100.0 | 44.50 | 264.50 | 1,821.5 | -83.8 | -870.7 | 872.1 | 0.00 | 0.00 | 0.00 |
| 2,200.0 | 44.50 | 264.50 | 1,892.8 | -90.6 | -940.5 | 942.0 | 0.00 | 0.00 | 0.00 |
| 2,252.1 | 44.50 | 264.50 | 1,930.0 | -94.1 | -976.8 | 978.4 | 0.00 | 0.00 | 0.00 |
| SEC 4-T33N-R7W DW | | | | | | | | | |
| 2,300.0 | 44.50 | 264.50 | 1,964.1 | -97.3 | -1,010.3 | 1,011.9 | 0.00 | 0.00 | 0.00 |
| 2,400.0 | 44.50 | 264.50 | 2,035.5 | -104.0 | -1,080.0 | 1,081.8 | 0.00 | 0.00 | 0.00 |
| 2,500.0 | 44.50 | 264.50 | 2,106.8 | -110.7 | -1,149.8 | 1,151.7 | 0.00 | 0.00 | 0.00 |
| 2,600.0 | 44.50 | 264.50 | 2,178.1 | -117.4 | -1,219.6 | 1,221.5 | 0.00 | 0.00 | 0.00 |
| 2,700.0 | 44.50 | 264.50 | 2,249.4 | -124.1 | -1,289.3 | 1,291.4 | 0.00 | 0.00 | 0.00 |
| 2,800.0 | 44.50 | 264.50 | 2,320.8 | -130.9 | -1,359.1 | 1,361.3 | 0.00 | 0.00 | 0.00 |
| 2,900.0 | 44.50 | 264.50 | 2,392.1 | -137.6 | -1,428.9 | 1,431.2 | 0.00 | 0.00 | 0.00 |
| 3,000.0 | 44.50 | 264.50 | 2,463.4 | -144.3 | -1,498.6 | 1,501.1 | 0.00 | 0.00 | 0.00 |
| 3,100.0 | 44.50 | 264.50 | 2,534.7 | -151.0 | -1,568.4 | 1,570.9 | 0.00 | 0.00 | 0.00 |
| 3,200.0 | 44.50 | 264.50 | 2,606.1 | -157.7 | -1,638.2 | 1,640.8 | 0.00 | 0.00 | 0.00 |
| 3,300.0 | 44.50 | 264.50 | 2,677.4 | -164.5 | -1,707.9 | 1,710.7 | 0.00 | 0.00 | 0.00 |
| 3,400.0 | 44.50 | 264.50 | 2,748.7 | -171.2 | -1,777.7 | 1,780.6 | 0.00 | 0.00 | 0.00 |
| 3,500.0 | 44.50 | 264.50 | 2,820.0 | -177.9 | -1,847.5 | 1,850.5 | 0.00 | 0.00 | 0.00 |
| 3,567.2 | 44.50 | 264.50 | 2,868.0 | -182.4 | -1,894.4 | 1,897.5 | 0.00 | 0.00 | 0.00 |
| 3,600.0 | 44.50 | 264.50 | 2,891.4 | -184.6 | -1,917.2 | 1,920.4 | 0.00 | 0.00 | 0.00 |
| 3,632.0 | 44.50 | 264.50 | 2,914.2 | -186.8 | -1,939.6 | 1,942.7 | 0.00 | 0.00 | 0.00 |
| 3,640.0 | 46.50 | 264.50 | 2,919.8 | -187.3 | -1,945.2 | 1,948.4 | 25.00 | 25.00 | 0.00 |
| 3,660.0 | 51.50 | 264.50 | 2,932.9 | -188.8 | -1,960.3 | 1,963.5 | 25.00 | 25.00 | 0.00 |
| 3,680.0 | 56.50 | 264.50 | 2,944.7 | -190.3 | -1,976.4 | 1,979.6 | 25.00 | 25.00 | 0.00 |
| 3,700.0 | 61.50 | 264.50 | 2,955.0 | -191.9 | -1,993.4 | 1,996.7 | 25.00 | 25.00 | 0.00 |
| 3,720.0 | 66.50 | 264.50 | 2,963.7 | -193.7 | -2,011.3 | 2,014.6 | 25.00 | 25.00 | 0.00 |
| 3,740.0 | 71.50 | 264.50 | 2,970.9 | -195.5 | -2,029.9 | 2,033.2 | 25.00 | 25.00 | 0.00 |
| 3,760.0 | 76.50 | 264.50 | 2,976.4 | -197.3 | -2,049.0 | 2,052.4 | 25.00 | 25.00 | 0.00 |
| 3,780.0 | 81.50 | 264.50 | 2,980.2 | -199.2 | -2,068.6 | 2,071.9 | 25.00 | 25.00 | 0.00 |
| 3,800.0 | 86.50 | 264.50 | 2,982.3 | -201.1 | -2,088.3 | 2,091.7 | 25.00 | 25.00 | 0.00 |
| 3,814.0 | 90.00 | 264.50 | 2,982.7 | -202.4 | -2,102.3 | 2,105.7 | 25.00 | 25.00 | 0.00 |
| 3,900.0 | 90.37 | 268.78 | 2,982.5 | -207.5 | -2,188.1 | 2,191.6 | 5.00 | 0.43 | 4.98 |

| | | | |
|------------------|---------------------------|-------------------------------------|------------------------------------|
| Database: | EDM 5000.1 Old | Local Co-ordinate Reference: | Well Campbell 33-7-4 #2H |
| Company: | Catamount Energy Partners | TVD Reference: | KB @ 6701.0ft (Original Well Elev) |
| Project: | San Juan Basin | MD Reference: | KB @ 6701.0ft (Original Well Elev) |
| Site: | La Plata County CO | North Reference: | Grid |
| Well: | Campbell 33-7-4 #2H | Survey Calculation Method: | Minimum Curvature |
| Wellbore: | Lateral #1 | | |
| Design: | Plan #1 | | |

| Planned Survey | | | | | | | | | |
|-------------------------------|-----------------|-------------|---------------------|------------|------------|-----------------------|-------------------------|------------------------|-----------------------|
| Measured Depth (ft) | Inclination (°) | Azimuth (°) | Vertical Depth (ft) | +N/-S (ft) | +E/-W (ft) | Vertical Section (ft) | Dogleg Rate (°/100usft) | Build Rate (°/100usft) | Turn Rate (°/100usft) |
| 3,956.8 | 90.62 | 271.61 | 2,982.0 | -207.3 | -2,244.9 | 2,248.4 | 5.00 | 0.43 | 4.98 |
| 4,000.0 | 90.62 | 271.61 | 2,981.5 | -206.1 | -2,288.1 | 2,291.5 | 0.00 | 0.00 | 0.00 |
| 4,100.0 | 90.62 | 271.61 | 2,980.4 | -203.2 | -2,388.0 | 2,391.4 | 0.00 | 0.00 | 0.00 |
| 4,200.0 | 90.62 | 271.61 | 2,979.3 | -200.4 | -2,488.0 | 2,491.3 | 0.00 | 0.00 | 0.00 |
| 4,300.0 | 90.62 | 271.61 | 2,978.3 | -197.6 | -2,587.9 | 2,591.2 | 0.00 | 0.00 | 0.00 |
| 4,400.0 | 90.62 | 271.61 | 2,977.2 | -194.8 | -2,687.9 | 2,691.1 | 0.00 | 0.00 | 0.00 |
| 4,500.0 | 90.62 | 271.61 | 2,976.1 | -192.0 | -2,787.9 | 2,791.0 | 0.00 | 0.00 | 0.00 |
| 4,600.0 | 90.62 | 271.61 | 2,975.0 | -189.2 | -2,887.8 | 2,890.8 | 0.00 | 0.00 | 0.00 |
| 4,700.0 | 90.62 | 271.61 | 2,974.0 | -186.4 | -2,987.8 | 2,990.7 | 0.00 | 0.00 | 0.00 |
| 4,800.0 | 90.62 | 271.61 | 2,972.9 | -183.5 | -3,087.7 | 3,090.6 | 0.00 | 0.00 | 0.00 |
| 4,900.0 | 90.62 | 271.61 | 2,971.8 | -180.7 | -3,187.7 | 3,190.5 | 0.00 | 0.00 | 0.00 |
| 5,000.0 | 90.62 | 271.61 | 2,970.7 | -177.9 | -3,287.6 | 3,290.4 | 0.00 | 0.00 | 0.00 |
| 5,100.0 | 90.62 | 271.61 | 2,969.7 | -175.1 | -3,387.6 | 3,390.3 | 0.00 | 0.00 | 0.00 |
| 5,200.0 | 90.62 | 271.61 | 2,968.6 | -172.3 | -3,487.5 | 3,490.1 | 0.00 | 0.00 | 0.00 |
| 5,300.0 | 90.62 | 271.61 | 2,967.5 | -169.5 | -3,587.5 | 3,590.0 | 0.00 | 0.00 | 0.00 |
| 5,400.0 | 90.62 | 271.61 | 2,966.4 | -166.7 | -3,687.4 | 3,689.9 | 0.00 | 0.00 | 0.00 |
| 5,500.0 | 90.62 | 271.61 | 2,965.4 | -163.8 | -3,787.4 | 3,789.8 | 0.00 | 0.00 | 0.00 |
| 5,600.0 | 90.62 | 271.61 | 2,964.3 | -161.0 | -3,887.4 | 3,889.7 | 0.00 | 0.00 | 0.00 |
| 5,700.0 | 90.62 | 271.61 | 2,963.2 | -158.2 | -3,987.3 | 3,989.6 | 0.00 | 0.00 | 0.00 |
| 5,800.0 | 90.62 | 271.61 | 2,962.1 | -155.4 | -4,087.3 | 4,089.5 | 0.00 | 0.00 | 0.00 |
| 5,900.0 | 90.62 | 271.61 | 2,961.1 | -152.6 | -4,187.2 | 4,189.3 | 0.00 | 0.00 | 0.00 |
| 6,000.0 | 90.62 | 271.61 | 2,960.0 | -149.8 | -4,287.2 | 4,289.2 | 0.00 | 0.00 | 0.00 |
| 6,100.0 | 90.62 | 271.61 | 2,958.9 | -147.0 | -4,387.1 | 4,389.1 | 0.00 | 0.00 | 0.00 |
| 6,200.0 | 90.62 | 271.61 | 2,957.8 | -144.1 | -4,487.1 | 4,489.0 | 0.00 | 0.00 | 0.00 |
| 6,300.0 | 90.62 | 271.61 | 2,956.7 | -141.3 | -4,587.0 | 4,588.9 | 0.00 | 0.00 | 0.00 |
| 6,400.0 | 90.62 | 271.61 | 2,955.7 | -138.5 | -4,687.0 | 4,688.8 | 0.00 | 0.00 | 0.00 |
| 6,500.0 | 90.62 | 271.61 | 2,954.6 | -135.7 | -4,786.9 | 4,788.6 | 0.00 | 0.00 | 0.00 |
| 6,600.0 | 90.62 | 271.61 | 2,953.5 | -132.9 | -4,886.9 | 4,888.5 | 0.00 | 0.00 | 0.00 |
| 6,700.0 | 90.62 | 271.61 | 2,952.4 | -130.1 | -4,986.9 | 4,988.4 | 0.00 | 0.00 | 0.00 |
| 6,800.0 | 90.62 | 271.61 | 2,951.4 | -127.3 | -5,086.8 | 5,088.3 | 0.00 | 0.00 | 0.00 |
| 6,900.0 | 90.62 | 271.61 | 2,950.3 | -124.4 | -5,186.8 | 5,188.2 | 0.00 | 0.00 | 0.00 |
| 7,000.0 | 90.62 | 271.61 | 2,949.2 | -121.6 | -5,286.7 | 5,288.1 | 0.00 | 0.00 | 0.00 |
| 7,100.0 | 90.62 | 271.61 | 2,948.1 | -118.8 | -5,386.7 | 5,388.0 | 0.00 | 0.00 | 0.00 |
| 7,200.0 | 90.62 | 271.61 | 2,947.1 | -116.0 | -5,486.6 | 5,487.8 | 0.00 | 0.00 | 0.00 |
| 7,300.0 | 90.62 | 271.61 | 2,946.0 | -113.2 | -5,586.6 | 5,587.7 | 0.00 | 0.00 | 0.00 |
| 7,400.0 | 90.62 | 271.61 | 2,944.9 | -110.4 | -5,686.5 | 5,687.6 | 0.00 | 0.00 | 0.00 |
| 7,484.5 | 90.62 | 271.61 | 2,944.0 | -108.0 | -5,771.0 | 5,772.0 | 0.00 | 0.00 | 0.00 |
| Campbell 33-7-4 #2 Lat #1 BHL | | | | | | | | | |

| | | | |
|------------------|---------------------------|-------------------------------------|------------------------------------|
| Database: | EDM 5000.1 Old | Local Co-ordinate Reference: | Well Campbell 33-7-4 #2H |
| Company: | Catamount Energy Partners | TVD Reference: | KB @ 6701.0ft (Original Well Elev) |
| Project: | San Juan Basin | MD Reference: | KB @ 6701.0ft (Original Well Elev) |
| Site: | La Plata County CO | North Reference: | Grid |
| Well: | Campbell 33-7-4 #2H | Survey Calculation Method: | Minimum Curvature |
| Wellbore: | Lateral #1 | | |
| Design: | Plan #1 | | |

Design Targets

| Target Name - hit/miss target - Shape | Dip Angle (°) | Dip Dir. (°) | TVD (ft) | +N/-S (ft) | +E/-W (ft) | Northing (usft) | Easting (usft) | Latitude | Longitude |
|--|------------------|-----------------|-------------|---------------|---------------|--------------------|-------------------|-----------------|-------------------|
| SEC 4-T33N-R7W DV | 0.00 | 360.00 | 2,864.0 | 35.5 | -34.4 | 1,175,003.26 | 2,387,498.59 | 37° 7' 42.114 N | 107° 36' 3.762 W |
| - plan misses target center by 1333.2ft at 2252.1ft MD (1930.0 TVD, -94.1 N, -976.8 E) | | | | | | | | | |
| - Polygon | | | | | | | | | |
| Point 1 | | | 2,864.0 | 1,123.7 | -5,740.9 | 1,176,126.98 | 2,381,757.59 | | |
| Point 2 | | | 2,864.0 | 1,073.2 | -1,812.7 | 1,176,076.48 | 2,385,685.86 | | |
| Point 3 | | | 2,864.0 | -262.2 | -1,845.0 | 1,174,741.05 | 2,385,653.56 | | |
| Point 4 | | | 2,864.0 | -144.1 | -5,738.1 | 1,174,859.15 | 2,381,760.39 | | |
| Campbell 33-7-4 #2 L | 0.00 | 360.00 | 2,944.0 | -108.0 | -5,771.0 | 1,174,859.70 | 2,381,761.90 | 37° 7' 39.413 N | 107° 37' 14.540 W |
| - plan hits target center | | | | | | | | | |
| - Point | | | | | | | | | |