

# TEKTON WINDSOR, LLC

Location	Windsor, CO, USA(Imported)	Slot	Slot #10
Field	Windsor Project		
Installation	Frye Farms	Wellbore	FRYE FARMS #9

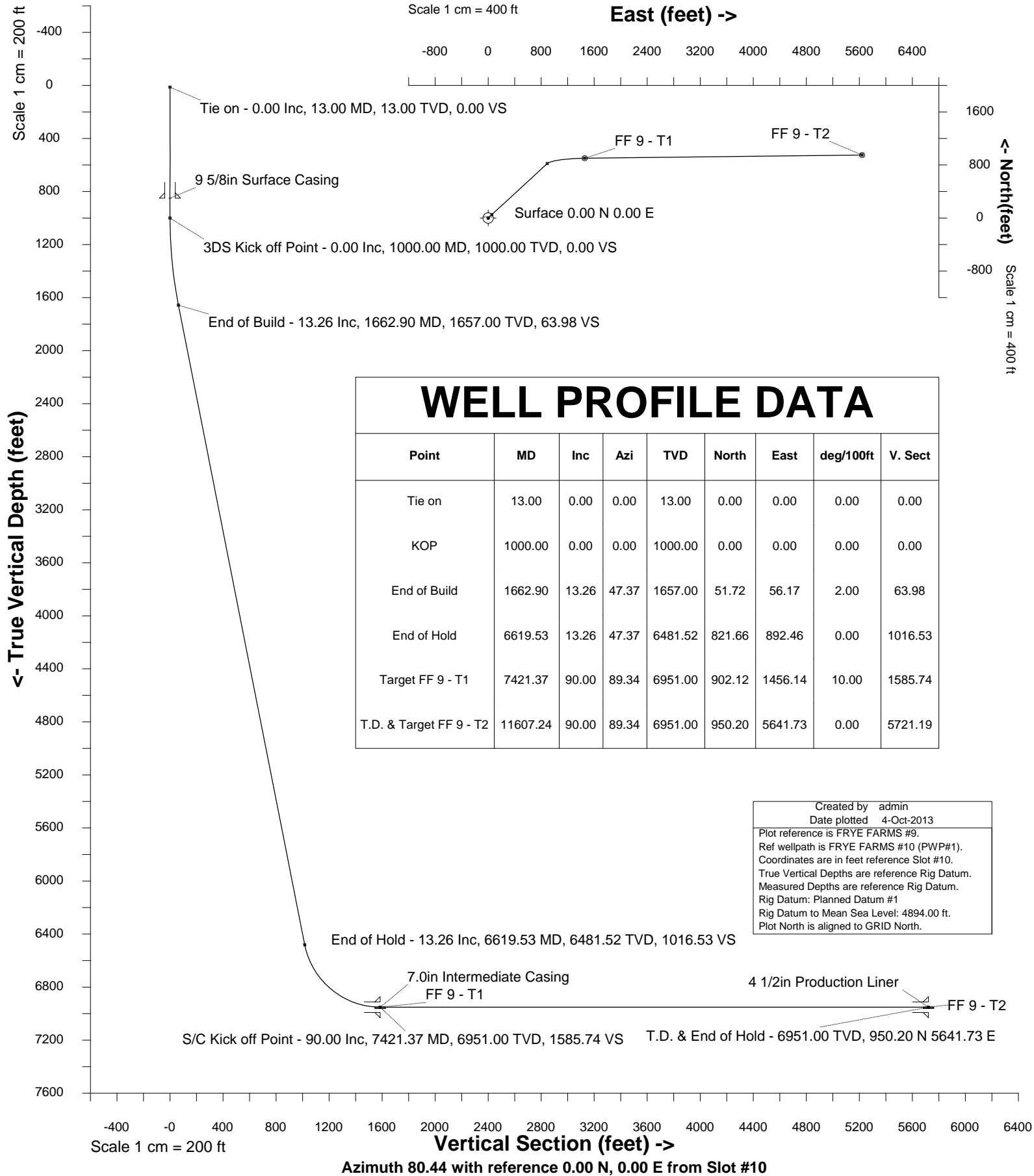



INTEGRATED PETROLEUM TECHNOLOGIES, INC  
SYSDRILL  
Well Design Combined Report  
Wellbore: FRYE FARMS #9

Wellhead Details							
Name	Northing	Easting	Latitude	Longitude	North	East	Elevation Above Inst.
Slot #10	1403481.6024	3164019.6930	40.43946279	-104.91073490	107.56N	95.60W	-0.00

Declination			
Date	Source	Time	
17-Oct-2012	IGRF Model [1900.0-2015.0]	17:08	
25-Oct-2012	IGRF Model [1900.0-2015.0]	11:33	
25-Oct-2012	IGRF Model [1900.0-2015.0]	11:47	

Site Details				
Name	Northing	Easting	Coord System Name	North Alignment
Frye Farms	1403374.0431	3164115.2936	CO83-NF on NORTH AMERICAN DATUM 1983 datum	Grid

Summary Wellpath									
MD[ft]	Inc[deg]	Azi[deg]	TVD[ft]	North[ft]	East[ft]	Dogleg [deg/100ft]	Vertical Section[ft]	Northing	Easting
13.00	0.00	0.000	13.00	0.00N	0.00E		0.00	1403481.60	3164019.69
1000.00	0.00	0.000	1000.00	0.00N	0.00E	==>	0.00	1403481.60	3164019.69
1662.90	13.26	47.370	1657.00	51.72N	56.17E	2.00	63.98	1403533.32	3164075.86
6619.53	13.26	47.370	6481.52	821.66N	892.46E	==>	1016.53	1404303.23	3164912.11
7421.37	90.00	89.340	6951.00	902.12N	1456.14E	10.00	1585.74	1404383.69	3165475.77
11607.24	90.00	89.340	6951.00	950.20N	5641.73E	==>	5721.19	1404431.77	3169661.20

Interpolated Wellpath									
MD[ft]	Inc[deg]	Azi[deg]	TVD[ft]	North[ft]	East[ft]	Dogleg [deg/100ft]	Vertical Section[ft]	Northing	Easting
0.00	0.00	0.000	0.00	0.00N	0.00E		0.00	1403481.60	3164019.69
13.00	0.00	0.000	13.00	0.00N	0.00E	==>	0.00	1403481.60	3164019.69
100.00	0.00	0.000	100.00	0.00N	0.00E	==>	0.00	1403481.60	3164019.69
200.00	0.00	0.000	200.00	0.00N	0.00E	==>	0.00	1403481.60	3164019.69
300.00	0.00	0.000	300.00	0.00N	0.00E	==>	0.00	1403481.60	3164019.69
400.00	0.00	0.000	400.00	0.00N	0.00E	==>	0.00	1403481.60	3164019.69
500.00	0.00	0.000	500.00	0.00N	0.00E	==>	0.00	1403481.60	3164019.69
600.00	0.00	0.000	600.00	0.00N	0.00E	==>	0.00	1403481.60	3164019.69
700.00	0.00	0.000	700.00	0.00N	0.00E	==>	0.00	1403481.60	3164019.69
800.00	0.00	0.000	800.00	0.00N	0.00E	==>	0.00	1403481.60	3164019.69
900.00	0.00	0.000	900.00	0.00N	0.00E	==>	0.00	1403481.60	3164019.69
987.00	0.00	0.000	987.00	0.00N	0.00E	==>	0.00	1403481.60	3164019.69
1000.00	0.00	0.000	1000.00	0.00N	0.00E	==>	0.00	1403481.60	3164019.69
1087.00	1.74	47.370	1086.99	0.89N	0.97E	2.00	1.11	1403482.50	3164020.66
1187.00	3.74	47.370	1186.87	4.13N	4.49E	2.00	5.11	1403485.73	3164024.18
1287.00	5.74	47.370	1286.52	9.73N	10.57E	2.00	12.04	1403491.33	3164030.26
1387.00	7.74	47.370	1385.82	17.68N	19.20E	2.00	21.87	1403499.28	3164038.89
1487.00	9.74	47.370	1484.66	27.97N	30.38E	2.00	34.60	1403509.57	3164050.07
1587.00	11.74	47.370	1582.90	40.59N	44.09E	2.00	50.22	1403522.19	3164063.78
1662.90	13.26	47.370	1657.00	51.72N	56.17E	2.00	63.98	1403533.32	3164075.86
1700.00	13.26	47.370	1693.11	57.48N	62.43E	==>	71.11	1403539.08	3164082.12
1800.00	13.26	47.370	1790.45	73.01N	79.30E	==>	90.33	1403554.61	3164098.99
1900.00	13.26	47.370	1887.78	88.55N	96.18E	==>	109.55	1403570.15	3164115.87
2000.00	13.26	47.370	1985.12	104.08N	113.05E	==>	128.76	1403585.68	3164132.74
2100.00	13.26	47.370	2082.45	119.61N	129.92E	==>	147.98	1403601.21	3164149.61
2200.00	13.26	47.370	2179.78	135.15N	146.79E	==>	167.20	1403616.74	3164166.48
2300.00	13.26	47.370	2277.12	150.68N	163.66E	==>	186.42	1403632.28	3164183.35
2400.00	13.26	47.370	2374.45	166.21N	180.54E	==>	205.63	1403647.81	3164200.22
2500.00	13.26	47.370	2471.79	181.75N	197.41E	==>	224.85	1403663.34	3164217.09
2600.00	13.26	47.370	2569.12	197.28N	214.28E	==>	244.07	1403678.88	3164233.96
2700.00	13.26	47.370	2666.46	212.82N	231.15E	==>	263.29	1403694.41	3164250.84
2800.00	13.26	47.370	2763.79	228.35N	248.02E	==>	282.50	1403709.94	3164267.71
2900.00	13.26	47.370	2861.13	243.88N	264.90E	==>	301.72	1403725.48	3164284.58
3000.00	13.26	47.370	2958.46	259.42N	281.77E	==>	320.94	1403741.01	3164301.45
3100.00	13.26	47.370	3055.80	274.95N	298.64E	==>	340.16	1403756.54	3164318.32
3200.00	13.26	47.370	3153.13	290.48N	315.51E	==>	359.38	1403772.07	3164335.19

All data is in Feet unless otherwise stated  
Coordinates are from Slot MD's are from Rig and TVD's are from Rig ( Planned Datum #1 4894.0ft above Mean Sea Level )  
Vertical Section is from 0.00N 0.00E on azimuth 80.440 degrees  
Bottom hole distance is 5721.19 Feet on azimuth 80.44 degrees from Wellhead  
Calculation method uses Minimum Curvature method  
Prepared by Integrated Petroleum Technologies, Inc.  
Date Printed: 4-Oct-2013



INTEGRATED PETROLEUM TECHNOLOGIES, INC  
SYSDRILL  
Well Design Combined Report  
Wellbore: FRYE FARMS #9

Interpolated Wellpath									
MD[ft]	Inc[deg]	Azi[deg]	TVD[ft]	North[ft]	East[ft]	Dogleg [deg/100ft]	Vertical Section[ft]	Northing	Easting
3300.00	13.26	47.370	3250.47	306.02N	332.38E	==>	378.59	1403787.61	3164352.06
3400.00	13.26	47.370	3347.80	321.55N	349.26E	==>	397.81	1403803.14	3164368.94
3500.00	13.26	47.370	3445.14	337.08N	366.13E	==>	417.03	1403818.67	3164385.81
3600.00	13.26	47.370	3542.47	352.62N	383.00E	==>	436.25	1403834.21	3164402.68
3700.00	13.26	47.370	3639.81	368.15N	399.87E	==>	455.46	1403849.74	3164419.55
3800.00	13.26	47.370	3737.14	383.69N	416.74E	==>	474.68	1403865.27	3164436.42
3900.00	13.26	47.370	3834.47	399.22N	433.62E	==>	493.90	1403880.81	3164453.29
4000.00	13.26	47.370	3931.81	414.75N	450.49E	==>	513.12	1403896.34	3164470.16
4100.00	13.26	47.370	4029.14	430.29N	467.36E	==>	532.33	1403911.87	3164487.03
4200.00	13.26	47.370	4126.48	445.82N	484.23E	==>	551.55	1403927.40	3164503.91
4300.00	13.26	47.370	4223.81	461.35N	501.10E	==>	570.77	1403942.94	3164520.78
4400.00	13.26	47.370	4321.15	476.89N	517.98E	==>	589.99	1403958.47	3164537.65
4500.00	13.26	47.370	4418.48	492.42N	534.85E	==>	609.20	1403974.00	3164554.52
4600.00	13.26	47.370	4515.82	507.95N	551.72E	==>	628.42	1403989.54	3164571.39
4700.00	13.26	47.370	4613.15	523.49N	568.59E	==>	647.64	1404005.07	3164588.26
4800.00	13.26	47.370	4710.49	539.02N	585.46E	==>	666.86	1404020.60	3164605.13
4900.00	13.26	47.370	4807.82	554.55N	602.34E	==>	686.07	1404036.13	3164622.01
5000.00	13.26	47.370	4905.16	570.09N	619.21E	==>	705.29	1404051.67	3164638.88
5100.00	13.26	47.370	5002.49	585.62N	636.08E	==>	724.51	1404067.20	3164655.75
5200.00	13.26	47.370	5099.83	601.16N	652.95E	==>	743.73	1404082.73	3164672.62
5300.00	13.26	47.370	5197.16	616.69N	669.82E	==>	762.94	1404098.27	3164689.49
5400.00	13.26	47.370	5294.50	632.22N	686.70E	==>	782.16	1404113.80	3164706.36
5500.00	13.26	47.370	5391.83	647.76N	703.57E	==>	801.38	1404129.33	3164723.23
5600.00	13.26	47.370	5489.16	663.29N	720.44E	==>	820.60	1404144.87	3164740.10
5700.00	13.26	47.370	5586.50	678.82N	737.31E	==>	839.81	1404160.40	3164756.98
5800.00	13.26	47.370	5683.83	694.36N	754.18E	==>	859.03	1404175.93	3164773.85
5900.00	13.26	47.370	5781.17	709.89N	771.06E	==>	878.25	1404191.46	3164790.72
6000.00	13.26	47.370	5878.50	725.42N	787.93E	==>	897.47	1404207.00	3164807.59
6100.00	13.26	47.370	5975.84	740.96N	804.80E	==>	916.68	1404222.53	3164824.46
6200.00	13.26	47.370	6073.17	756.49N	821.67E	==>	935.90	1404238.06	3164841.33
6300.00	13.26	47.370	6170.51	772.02N	838.54E	==>	955.12	1404253.60	3164858.20
6400.00	13.26	47.370	6267.84	787.56N	855.42E	==>	974.34	1404269.13	3164875.08
6500.00	13.26	47.370	6365.18	803.09N	872.29E	==>	993.55	1404284.66	3164891.95
6600.00	13.26	47.370	6462.51	818.63N	889.16E	==>	1012.77	1404300.20	3164908.82
6619.53	13.26	47.370	6481.52	821.66N	892.46E	==>	1016.53	1404303.23	3164912.11
6700.00	19.92	63.560	6558.64	834.03N	911.55E	10.00	1037.41	1404315.60	3164931.20
6800.00	29.16	72.930	6649.54	848.80N	950.19E	10.00	1077.96	1404330.37	3164969.84
6900.00	38.75	78.020	6732.41	862.48N	1004.23E	10.00	1133.52	1404344.05	3165023.88
7000.00	48.49	81.330	6804.72	874.66N	1072.03E	10.00	1202.41	1404356.23	3165091.68
7100.00	58.30	83.760	6864.28	884.96N	1151.54E	10.00	1282.52	1404366.53	3165171.18
7200.00	68.15	85.720	6909.28	893.07N	1240.33E	10.00	1371.43	1404374.64	3165259.97
7300.00	78.01	87.420	6938.35	898.75N	1335.71E	10.00	1466.43	1404380.31	3165355.35
7400.00	87.89	89.010	6950.61	901.82N	1434.78E	10.00	1564.63	1404383.38	3165454.41
7421.37	90.00	89.340	6951.00	902.12N	1456.14E	10.00	1585.74	1404383.69	3165475.77
7500.00	90.00	89.340	6951.00	903.03N	1534.77E	==>	1663.43	1404384.59	3165554.40
7600.00	90.00	89.340	6951.00	904.18N	1634.76E	==>	1762.23	1404385.74	3165654.39
7700.00	90.00	89.340	6951.00	905.32N	1734.75E	==>	1861.02	1404386.89	3165754.38
7800.00	90.00	89.340	6951.00	906.47N	1834.75E	==>	1959.82	1404388.04	3165854.37
7900.00	90.00	89.340	6951.00	907.62N	1934.74E	==>	2058.61	1404389.19	3165954.36
8000.00	90.00	89.340	6951.00	908.77N	2034.73E	==>	2157.41	1404390.34	3166054.35
8100.00	90.00	89.340	6951.00	909.92N	2134.73E	==>	2256.20	1404391.48	3166154.34
8200.00	90.00	89.340	6951.00	911.07N	2234.72E	==>	2355.00	1404392.63	3166254.32
8300.00	90.00	89.340	6951.00	912.22N	2334.71E	==>	2453.79	1404393.78	3166354.31
8400.00	90.00	89.340	6951.00	913.36N	2434.71E	==>	2552.59	1404394.93	3166454.30
8500.00	90.00	89.340	6951.00	914.51N	2534.70E	==>	2651.38	1404396.08	3166554.29
8600.00	90.00	89.340	6951.00	915.66N	2634.69E	==>	2750.18	1404397.23	3166654.28
8700.00	90.00	89.340	6951.00	916.81N	2734.69E	==>	2848.98	1404398.38	3166754.27
8800.00	90.00	89.340	6951.00	917.96N	2834.68E	==>	2947.77	1404399.52	3166854.26
8900.00	90.00	89.340	6951.00	919.11N	2934.67E	==>	3046.57	1404400.67	3166954.25
9000.00	90.00	89.340	6951.00	920.26N	3034.67E	==>	3145.36	1404401.82	3167054.24
9100.00	90.00	89.340	6951.00	921.40N	3134.66E	==>	3244.16	1404402.97	3167154.23
9200.00	90.00	89.340	6951.00	922.55N	3234.65E	==>	3342.95	1404404.12	3167254.22

All data is in Feet unless otherwise stated  
Coordinates are from Slot MD's are from Rig and TVD's are from Rig ( Planned Datum #1 4894.0ft above Mean Sea Level )  
Vertical Section is from 0.00N 0.00E on azimuth 80.440 degrees  
Bottom hole distance is 5721.19 Feet on azimuth 80.44 degrees from Wellhead  
Calculation method uses Minimum Curvature method  
Prepared by Integrated Petroleum Technologies, Inc.  
Date Printed: 4-Oct-2013



INTEGRATED PETROLEUM TECHNOLOGIES, INC  
SYSDRILL  
Well Design Combined Report  
Wellbore: FRYE FARMS #9

Interpolated Wellpath									
MD[ft]	Inc[deg]	Azi[deg]	TVD[ft]	North[ft]	East[ft]	Dogleg [deg/100ft]	Vertical Section[ft]	Northing	Easting
9300.00	90.00	89.340	6951.00	923.70N	3334.65E	==>	3441.75	1404405.27	3167354.21
9400.00	90.00	89.340	6951.00	924.85N	3434.64E	==>	3540.54	1404406.42	3167454.20
9500.00	90.00	89.340	6951.00	926.00N	3534.63E	==>	3639.34	1404407.56	3167554.19
9600.00	90.00	89.340	6951.00	927.15N	3634.63E	==>	3738.13	1404408.71	3167654.18
9700.00	90.00	89.340	6951.00	928.30N	3734.62E	==>	3836.93	1404409.86	3167754.17
9800.00	90.00	89.340	6951.00	929.44N	3834.62E	==>	3935.72	1404411.01	3167854.16
9900.00	90.00	89.340	6951.00	930.59N	3934.61E	==>	4034.52	1404412.16	3167954.14
10000.00	90.00	89.340	6951.00	931.74N	4034.60E	==>	4133.32	1404413.31	3168054.13
10100.00	90.00	89.340	6951.00	932.89N	4134.60E	==>	4232.11	1404414.46	3168154.12
10200.00	90.00	89.340	6951.00	934.04N	4234.59E	==>	4330.91	1404415.60	3168254.11
10300.00	90.00	89.340	6951.00	935.19N	4334.58E	==>	4429.70	1404416.75	3168354.10
10400.00	90.00	89.340	6951.00	936.34N	4434.58E	==>	4528.50	1404417.90	3168454.09
10500.00	90.00	89.340	6951.00	937.49N	4534.57E	==>	4627.29	1404419.05	3168554.08
10600.00	90.00	89.340	6951.00	938.63N	4634.56E	==>	4726.09	1404420.20	3168654.07
10700.00	90.00	89.340	6951.00	939.78N	4734.56E	==>	4824.88	1404421.35	3168754.06
10800.00	90.00	89.340	6951.00	940.93N	4834.55E	==>	4923.68	1404422.50	3168854.05
10900.00	90.00	89.340	6951.00	942.08N	4934.54E	==>	5022.47	1404423.64	3168954.04
11000.00	90.00	89.340	6951.00	943.23N	5034.54E	==>	5121.27	1404424.79	3169054.03
11100.00	90.00	89.340	6951.00	944.38N	5134.53E	==>	5220.06	1404425.94	3169154.02
11200.00	90.00	89.340	6951.00	945.53N	5234.52E	==>	5318.86	1404427.09	3169254.01
11300.00	90.00	89.340	6951.00	946.67N	5334.52E	==>	5417.66	1404428.24	3169354.00
11400.00	90.00	89.340	6951.00	947.82N	5434.51E	==>	5516.45	1404429.39	3169453.99
11500.00	90.00	89.340	6951.00	948.97N	5534.50E	==>	5615.25	1404430.54	3169553.98
11600.00	90.00	89.340	6951.00	950.12N	5634.50E	==>	5714.04	1404431.68	3169653.97
11607.24	90.00	89.340	6951.00	950.20N	5641.73E	==>	5721.19	1404431.77	3169661.20

All data is in Feet unless otherwise stated  
Coordinates are from Slot MD's are from Rig and TVD's are from Rig ( Planned Datum #1 4894.0ft above Mean Sea Level )  
Vertical Section is from 0.00N 0.00E on azimuth 80.440 degrees  
Bottom hole distance is 5721.19 Feet on azimuth 80.44 degrees from Wellhead  
Calculation method uses Minimum Curvature method  
Prepared by Integrated Petroleum Technologies, Inc.  
Date Printed: 4-Oct-2013



INTEGRATED PETROLEUM TECHNOLOGIES, INC  
SYSDRILL  
Well Design Combined Report  
Wellbore: FRYE FARMS #9

Hole Sections								
Diameter [in]	Start MD[ft]	Start TVD[ft]	Start North[ft]	Start East[ft]	End MD[ft]	End TVD[ft]	End North[ft]	End East[ft]
12 1/4	13.00	13.00	0.00N	0.00E	850.00	850.00	0.00N	0.00E
8 3/4	850.00	850.00	0.00N	0.00E	7421.00	6951.00	902.12N	1455.77E
6 1/8	7421.00	6951.00	902.12N	1455.77E	11607.24	6951.00	950.20N	5641.73E

Casings								
Name	Top MD[ft]	Top TVD[ft]	Top North[ft]	Top East[ft]	Shoe MD[ft]	Shoe TVD[ft]	Shoe North[ft]	Shoe East[ft]
9 5/8in Surface Casing	13.00	13.00	0.00N	0.00E	850.00	850.00	0.00N	0.00E
7.0in Intermediate Casing	13.00	13.00	0.00N	0.00E	7421.00	6951.00	902.12N	1455.77E
4 1/2in Production Liner	6619.00	6481.01	821.58N	892.37E	11607.24	6951.00	950.20N	5641.73E

Targets								
Name	North[ft]	East[ft]	TVD[ft]	Latitude	Longitude	Northing	Easting	Last Revised
FF 9 - T1	902.12N	1456.14E	6951.00	40.44191228	-104.90548214	1404383.69	3165475.77	8-Mar-2013
FF 9 - T2	950.20N	5641.73E	6951.00	40.44196625	-104.89044411	1404431.77	3169661.20	8-Mar-2013

Survey Tool Program						
Reference	Survey Name	MD[ft]	TVD[ft]	Survey Tool	Error Model	
65090	Planned	11607.24	6951.00	WdW Rate Gyro	Standard	

Notes

All data is in Feet unless otherwise stated  
Coordinates are from Slot MD's are from Rig and TVD's are from Rig ( Planned Datum #1 4894.0ft above Mean Sea Level )  
Vertical Section is from 0.00N 0.00E on azimuth 80.440 degrees  
Bottom hole distance is 5721.19 Feet on azimuth 80.44 degrees from Wellhead  
Calculation method uses Minimum Curvature method  
Prepared by Integrated Petroleum Technologies, Inc.  
Date Printed: 4-Oct-2013



SYSDRILL  
Closest Approach + Clearance Factor Summary Report  
Wellbore: FRYE FARMS #9

Ellipse separations are reported ONLY if BOTH wells have uncertainty data  
Only Depth and Magnetic Reference Field error terms are correlated across tie points  
Proximities beyond 2500.00ft with expansion rate of 0.00ft/1000ft are not reported  
Scan limit is calculated on CENTRE to CENTRE distance

Summary data uses Closest Approach clearance calculation for all minima  
Hole size/Casings ARE included  
Hole size/Casings are NOT subtracted from Centre-Centre distance  
Confidence limit of 95.00% / 2.80 SD.

Wellbore		
Name	Created	Last Revised
FRYE FARMS #9	2-Oct-2013	4-Oct-2013

Well		
Name	Government ID	Last Revised
FRYE FARMS #10		16-May-2013

Slot						
Name	Grid Northing	Grid Easting	Latitude	Longitude	North	East
Slot #10	1403481.6024	3164019.6930	40.43946279	-104.91073490	107.56N	95.60W

Installation				
Name	Easting	Northing	Coord System Name	North Alignment
Frye Farms	3164115.2936	1403374.0431	CO83-NF on NORTH AMERICAN DATUM 1983 datum	Grid

Field				
Name	Easting	Northing	Coord System Name	North Alignment
Windsor Project	3162710.0707	1407271.6545	CO83-NF on NORTH AMERICAN DATUM 1983 datum	Grid

Clearance Summary										
Offset WellName	Offset Wellbore	Offset Slot	Offset Structure	Separation [ft]	MD[ft]	Diverging From[ft]	Ellipse Separation [ft]	Ellipse MD[ft]	Clearance Factor	Clearance MD[ft]
FRYE FARMS #9	FRYE FARMS #13	Slot #9	Frye Farms	15.93	1030.06	11607.24	13.61	1079.27	2.73	11607.24
FRYE FARMS #11	FRYE FARMS #10	Slot #11	Frye Farms	16.09	1000.00	11535.18	13.83	1030.06	3.25	11561.56
FRYE FARMS #8	FRYE FARMS #8	Slot #8	Frye Farms	31.86	1013.66	11607.24	29.58	1046.46	3.26	11607.24
FRYE FARMS #12	FRYE FARMS #11	Slot #12	Frye Farms	32.01	1000.00	11498.75	29.75	849.61	6.99	11594.36
FRYE FARMS #13	FRYE FARMS #12	Slot #13	Frye Farms	47.94	1000.00	11501.16	45.68	849.61	10.17	11607.24
FRYE FARMS #7	FRYE FARMS #7	Slot #7	Frye Farms	47.94	1013.66	11607.24	45.68	1013.66	6.52	11607.24
FRYE FARM 7-5-32	FRYE FARM 7-5-32 (AWB)	FRYE FARMS #7-5-32	Frye Farms	53.65	913.00	913.00	50.16	915.23	14.47	980.85
FRYE FARMS #6	FRYE FARMS #6	Slot #6	Frye Farms	63.92	1013.66	11607.24	61.66	1013.66	9.79	11607.24
CENTER POINT #7	CENTER POINT #7	Slot #7	Center Point	72.94	7123.72	7123.72	45.10	7148.83	2.37	7165.23
FRYE FARMS #9-5-32	FRYE FARMS #9-5-32 (AWB)	FRYE FARMS #9-5-32	Frye Farms	106.70	516.28	516.28	104.65	516.28	36.99	1079.27
FRYE	FRYE	FRYE	Frye Farms	125.91	244.30	244.30	124.37	244.30	63.85	849.61

All data is in Feet unless otherwise stated  
Coordinates are from Slot MD's are from Rig and TVD's are from Rig ( Planned Datum #1 4894.0ft above Mean Sea Level )  
Vertical Section is from 0.00N 0.00E on azimuth 80.440 degrees  
Prepared by Integrated Petroleum Technologies, Inc.  
Date Printed: 4-Oct-2013



SYSDRILL  
Closest Approach + Clearance Factor Summary Report  
Wellbore: FRYE FARMS #9

Clearance Summary										
Offset WellName	Offset Wellbore	Offset Slot	Offset Structure	Separation [ft]	MD[ft]	Diverging From[ft]	Ellipse Separation [ft]	Ellipse MD[ft]	Clearance Factor	Clearance MD[ft]
FARMS #9-7-32	FARMS #9-7-32 (AWB)	FARMS #9-7-32								
CENTER POINT #5	CENTER POINT #5	Slot #5	Center Point	288.72	6919.20	6919.20	256.00	6935.57	8.22	7001.19
RANCHO WATER VALLEY #9	RANCHO WATER VALLEY #9	Slot #09	Rancho Water Valley	303.62	11607.24	11607.24	231.37	11607.24	4.20	11607.24
RANCHO WATER VALLEY #8	RANCHO WATER VALLEY #8	Slot #08	Rancho Water Valley	405.96	11607.24	11607.24	372.17	11607.24	12.01	11607.24
Pavistma South 1 #1-5-32-09 0-4-NH	Pavistma South 1 #1-5-32-090-4 -NH (PWB)	Slot #1	Pavistma South	524.59	6820.74	6820.74	496.55	6820.74	18.68	6837.15
PAVISTMA #7	PAVISTMA #7	Slot #7	Pavistma	572.54	11497.54	11497.54	443.96	11513.00	4.44	11528.75
PAVISTMA #5	PAVISTMA #5	Slot #5	Pavistma	614.14	6820.74	6820.74	573.93	6820.74	15.19	6853.55
PAVISTMA #6	PAVISTMA #6	Slot #6	Pavistma	711.61	6837.15	6837.15	675.48	6837.15	19.70	6837.15
Pavistma South 2 #1-5-32-09 0-4-CH	Pavistma South 2 #1-5-32-090-4 -CH (PWB)	Slot #2	Pavistma South	714.33	6914.06	6914.06	679.25	6919.17	20.32	6935.57
RANCHO WATER VALLEY #13	RANCHO WATER VALLEY #13	Slot #13	Rancho Water Valley	817.15	11607.24	11607.24	757.86	11607.24	13.78	11604.93
RANCHO WATER VALLEY #13	RANCHO WATER VALLEY #13 (AWB)	Slot #13	Rancho Water Valley	840.47	7630.34	11607.24	659.13	7657.36	4.62	7673.76
PAVISTMA #4	PAVISTMA #4	Slot #4	Pavistma	998.38	6804.34	6804.34	947.36	6813.00	19.39	6886.36
PAVISTMA #8	PAVISTMA #8	Slot #8	Pavistma	1016.34	6858.05	6858.05	969.72	6858.05	21.76	6886.36
Pavistma South 3 #1-6-32-09 0-4-NH	Pavistma South 3 #1-6-32-090-4 -NH (PWB)	Slot #3	Pavistma South	1053.63	6813.00	6813.00	1002.74	6820.74	20.57	6886.36
PAVISTMA #10	PAVISTMA #10	Slot #10	Pavistma	1221.59	11502.37	11502.37	1088.73	11528.75	9.12	11607.24
PAVISTMA #9	PAVISTMA #9	Slot #9	Pavistma	1292.03	6886.36	6886.36	1241.43	6886.36	25.43	6951.98
RANCHO WATER VALLEY #12	RANCHO WATER VALLEY #12	Slot #12	Rancho Water Valley	1321.20	11607.24	11607.24	1130.65	7738.55	6.87	7738.55
HILLSIDE #17	HILLSIDE #17	Slot #17	Hillside	1374.83	11503.37	11503.37	1264.61	11513.00	12.46	11545.15
RANCHO WATER VALLEY #11	RANCHO WATER VALLEY 11 #7-7-33-270-6 -CH (AWB)	Slot #11	Rancho Water Valley	1466.43	9240.86	11486.74	1294.64	7788.59	7.95	7788.59

All data is in Feet unless otherwise stated  
Coordinates are from Slot MD's are from Rig and TVD's are from Rig ( Planned Datum #1 4894.0ft above Mean Sea Level )  
Vertical Section is from 0.00N 0.00E on azimuth 80.440 degrees  
Prepared by Integrated Petroleum Technologies, Inc.  
Date Printed: 4-Oct-2013



SYSDRILL  
Closest Approach + Clearance Factor Summary Report  
Wellbore: FRYE FARMS #9

Clearance Summary										
Offset WellName	Offset Wellbore	Offset Slot	Offset Structure	Separation [ft]	MD[ft]	Diverging From[ft]	Ellipse Separation [ft]	Ellipse MD[ft]	Clearance Factor	Clearance MD[ft]
RANCHO WATER VALLEY #11	RANCHO WATER VALLEY #11	Slot #11	Rancho Water Valley	1470.60	11607.24	11607.24	1411.54	11607.24	24.90	11607.24
PAVISTMA #11	PAVISTMA #11	Slot #11	Pavistma	1588.17	6902.76	6902.76	1535.59	6902.76	29.89	7034.00
RANCHO WATER VALLEY #10	RANCHO WATER VALLEY #10	Slot #10	Rancho Water Valley	1649.02	11607.24	11607.24	1590.13	11607.24	28.00	11607.24
Pavistma South 4 #1-7-32-09 0-4-CH	Pavistma South 4 #1-7-32-090-4 -CH (PWB)	Slot #4	Pavistma South	1665.72	6942.71	6942.71	1611.42	6951.98	30.05	7165.23
HILLSIDE #18	HILLSIDE #18	Slot #18	Hillside	1702.11	11504.89	11504.89	1591.92	11513.00	15.40	11607.24
Pavistma South 5 #1-8-32-09 0-4-NH	Pavistma South 5 #1-8-32-090-4 -NH (PWB)	Slot #5	Pavistma South	1865.95	6783.23	6783.23	1811.48	6813.00	32.93	7247.25
HILLSIDE #15	HILLSIDE #15	Slot #15	Hillside	1885.57	11508.44	11508.44	1776.06	11528.75	17.14	11607.24
PAVISTMA #12	PAVISTMA #12	Slot #12	Pavistma	1895.00	6919.17	6919.17	1841.17	6935.57	34.55	7132.42
HILLSIDE #14	HILLSIDE #14	Slot #14	Hillside	2033.21	11513.00	11513.00	1922.77	11528.75	18.32	11607.24
RANCHO WATER VALLEY #7	RANCHO WATER VALLEY #7	Slot #07	Rancho Water Valley	2038.82	6848.07	6848.07	1980.77	6853.55	34.68	11607.24
RANCHO WATER VALLEY #7	RANCHO WATER VALLEY #7 REV 1	Slot #07	Rancho Water Valley	2055.33	7919.82	7919.82	1996.86	11607.24	34.68	11607.24
RAINDANCE #6	RAINDANCE #6	Slot #6	Raindance	2060.75	6984.78	6984.78	1881.59	6968.38	11.47	6919.17
RANCHO WATER VALLEY #6	RANCHO WATER VALLEY #6	Slot #06	Rancho Water Valley	2179.93	6674.61	6674.61	2121.77	6689.51	37.33	6837.15
RAINDANCE #5	RAINDANCE #5	Slot #5	Raindance	2181.88	6935.57	6935.57	1996.57	6935.57	11.75	6869.96
RANCHO WATER VALLEY #6	RANCHO WATER VALLEY #6 REV 1	Slot #06	Rancho Water Valley	2220.83	11607.24	11607.24	2161.61	11607.24	37.50	11607.24
CENTER POINT #2	CENTER POINT #2	Slot #2	Center Point	2365.65	11513.00	11513.00	2283.47	11528.75	28.62	11607.24
RAINDANCE #4	RAINDANCE #4	Slot #4	Raindance	2495.60	6951.98	6951.98	2305.93	6951.98	13.14	6886.36
RANCHO WATER VALLEY #4	RANCHO WATER VALLEY #4	Slot #04	Rancho Water Valley	2550.80	7887.02	7887.02	2355.17	7885.80	13.04	7885.80