

**5D Plan Report****ANADARKO**

Field Name: *WATTENBURG_NAD83*
Site Name: *GEE 15C-25HZ PAD*
Well Name: *GEE 27N-12HZ*
Plan: *PLAN 1*





Weatherford®

Plan Data for GEE 27N-12HZ

Field: WATTENBURG_NAD83

Map Unit: USFt

Vertical Reference Datum (VRD): Mean Sea Level

Projected Coordinate System: NAD83 / Colorado North (ftUS)

Site: GEE 15C-25HZ PAD

Unit: USFeet

TVD Reference:

Company Name: ANADARKO

Position:

Northing: 1290361.43USft

Latitude: 40.128524°

Easting: 3185826.54USft

Longitude: -104.835439°

North Reference: True

Grid Convergence: 0.43°

Elevation Above VRD: 4859.00USft

Slot: GEE 27N-12HZ

Position:

Offset is from Site centre

+N/-S: 115.84USft Northing: 1290477.50USft

Latitude: 40.128842°

+E/-W: 31.03USft Easting: 3185856.71USft

Longitude: -104.835328°

Elevation Above VRD: 4859.00USft

Well: GEE 27N-12HZ

Type: Main-Well

File Number:

Vertical Section: Position offset of origin from Slot centre:

+N/-S: -115.84USft

Azimuth: 360.33°

+E/-W: -31.03USft

Magnetic Parameters:

Model: Field Strength: Declination: Dip: Date:

BGGM 52735(nT)

8.63°

66.74°

2013-07-08

Plan Point Information:

DogLeg Severity Unit: °/100.00ft				Position offsets from Slot centre									
MD	Inc	Az	TVD	+N/-S	+E/-W	VSec	DLS	Toolface	Build	Turn			
(USft)	(°)	(°)	(USft)	(USft)	(USft)	(USft)	(DLSU)	(°)	(DLSU)	(DLSU)			
0.00	0.00	0.00	0.00	0.00	0.00	0.00	0.00	0.0	0.00	0.00			
2500.00	0.00	0.00	2500.00	0.00	0.00	0.00	0.00	0.0	0.00	0.00			
2796.53	5.93	57.99	2796.00	8.13	13.00	8.20	2.00	58.0	2.00	0.00			
6334.52	5.93	57.99	6315.05	201.87	323.00	203.73	0.00	0.0	0.00	0.00			
6631.04	0.00	0.00	6611.05	210.00	336.00	211.93	2.00	180.0	-2.00	0.00			
7530.87	89.98	0.33	7184.01	782.78	339.34	784.72	10.00	0.3	10.00	0.00			
17432.97	89.98	0.33	7187.00	10684.70	397.17	10686.81	0.00	0.0	0.00	0.00			

Target Set Information:

Name: GEE 27N-12HZ

Name	TVD	Lat	Long
(USft)	(°)	(°)	(°)
PBHL 7187.00	40.158173	-104.833907	

Formation Point Information:

Name	TVD	Elevation	MD
	(USft)	(USft)	(USft)
SHARON SPRINGS	7050.00	-2174.00	7131.11
NIOBRARA A	7118.00	-2242.00	7253.31
NIOBRARA B	7152.00	-2276.00	7338.63

Casing Point Information:

Name	MD	TVD
	(USft)	(USft)
9 5/8 in	967.00	967.00
7 in	7530.88	7184.01

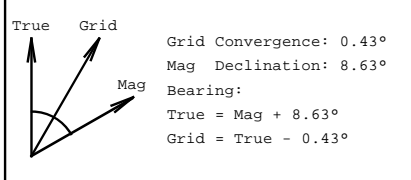

LINER - 6531.04' MD
KOP - 6631.04' MD

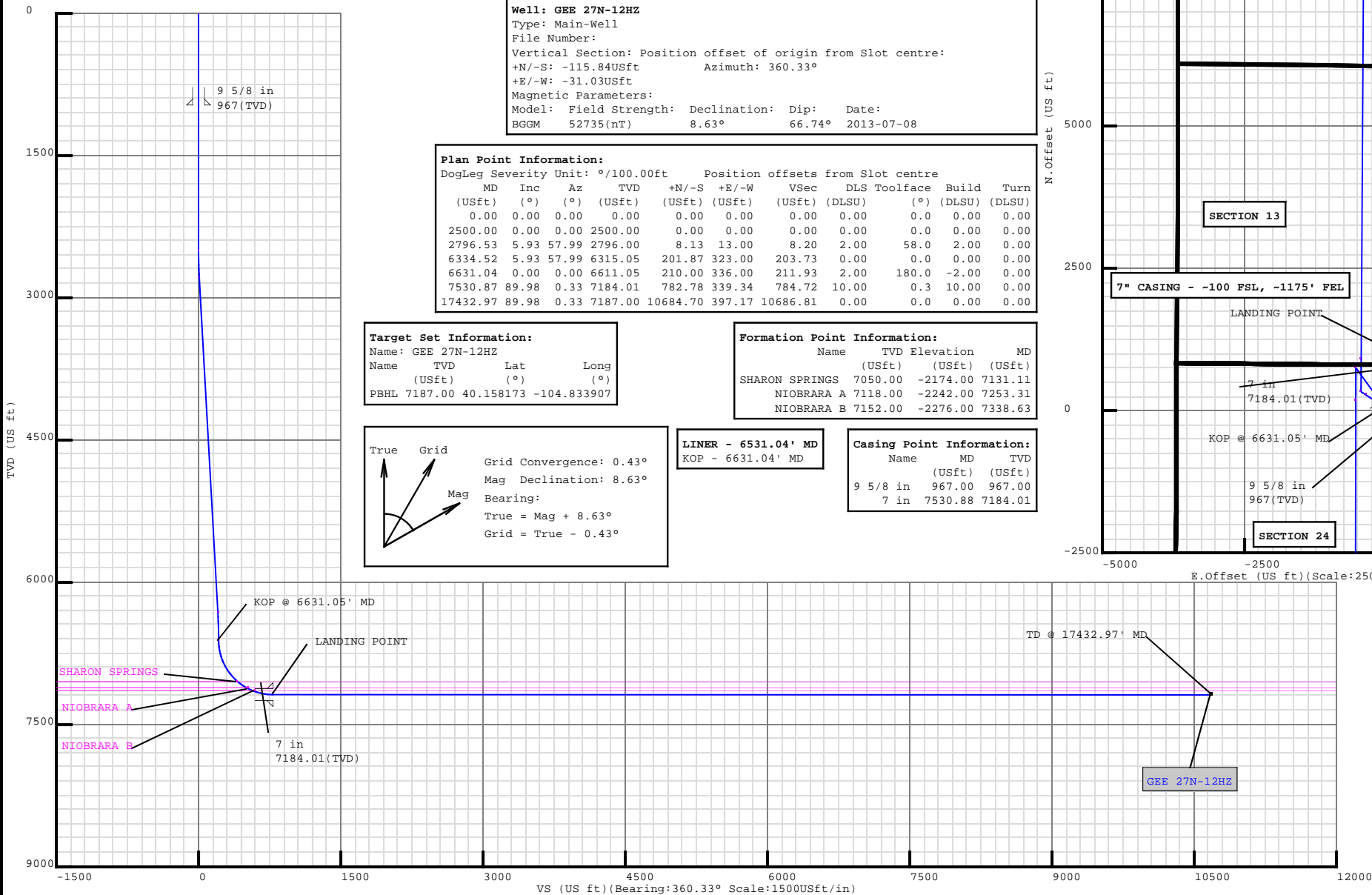
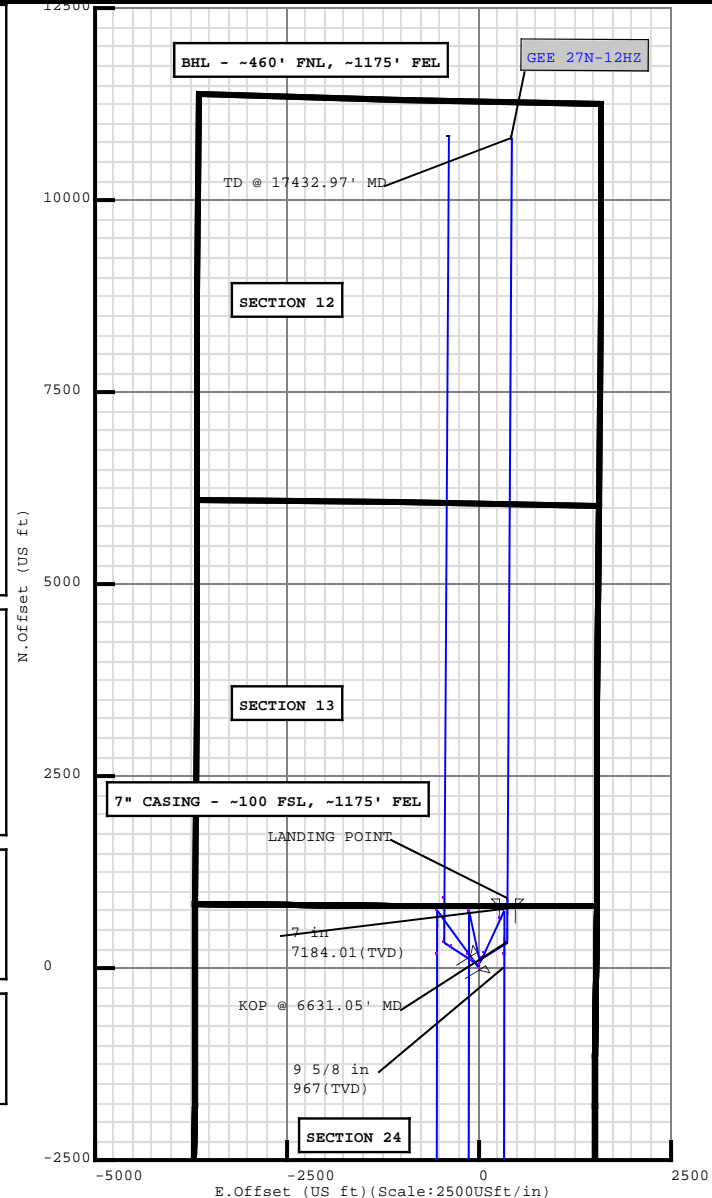

Plan Surveys for the GEE 27N-12HZ

Site Name GEE 15C-25HZ PAD	Units : US ft	North Reference : True	Convergence Angle : 0.43
	Position	Northing : 1290361.43 US ft	Latitude : 40.128524
		Easting : 3185826.54 US ft	Longitude : -104.835439
	Elevation above: 4859.00 US ft Comment :		
Slot Name GEE 27N-12HZ	Position (Offsets relative to Site Centre)		
	+N / -S : 115.84 US ft	Northing : 1290477.50 US ft	Latitude : 40.128842
	+E / -W : 31.03 US ft	Easting : 3185856.71 US ft	Longitude : -104.835328
	Slot TVD Reference : Ground Elevation Elevation above : 4859.00 US ft Comment :		
Well Name GEE 27N-12HZ	Type : Main well	UWI :	Plan : PLAN 1
	Rig Height <i>Drill Floor</i> : 17.00 US ft	Comment :	
	Relative to : 4876.00 US ft		
	Closure Distance : 10692.1 US ft	Closure Azimuth : 2.12878°	
	Vertical Section (Position of Origin Relative to Slot)		
	+N / -S : -115.84 US ft	+E / -W : -31.03 US ft	Az : 0.33°
	Magnetic Parameters		
	Model : BGGM	Field Strength : 52735.5nT	Dec : 8.63°
			Dip : 66.74°
			Date : 08/Jul/2013

Target Set**Name :** GEE 27N-12HZ**Number of Targets :** 1**Comment :**

TargetName:	Position (Relative to centre)			
PBHL	+N / -S : 10684.70US ft		Northing : 1301164.88 US ft	Latitude : 40°9'29.422800"
Shape:	+E / -W : 397.16 US ft		Easting : 3186173.79US ft	Longitude : -104°50'2.065200"
Cuboid	TVD (Drill Floor) : 7187.00 US ft			
	Orientation	Azimuth : 0.00°	Inclination : 0.00°	
	Dimensions	Length : 20.00 US ft	Breadth : 20.00 US ft	Height : 20.00 US ft

Casing Points (Relative to centre, TVD relative to Drill Floor)									
Name	MD (US ft)	Inc (°)	Az (°)	TVD (US ft)	N.Offset (US ft)	E.Offset (US ft)	Latitude (°)	Longitude (°)	
9 5/8 in	967.00	0.00	0.00	967.00	0.00	0.00	40.128842	-104.835328	
7 in	7530.88	89.98	0.33	7184.01	782.78	339.34	40.130991	-104.834114	

Well path created using minimum curvature

Salient Points (Relative to centre, TVD relative to Drill Floor)									
MD (US ft)	Inc (°)	Az (°)	TVD (US ft)	N.Offset (US ft)	E.Offset (US ft)	DLS (°/100 US ft)	T.Face (°)	VS (US ft)	Comment
0.00	0.00	0.00	0.00	0.00	0.00	0.00	0.00	116.02	
967.00	0.00	0.00	967.00	0.00	0.00	0.00	0.00	116.02	9 5/8 in
2500.00	0.00	0.00	2500.00	0.00	0.00	0.00	0.00	116.02	
2796.53	5.93	57.99	2796.00	8.13	13.00	2.00	57.99	124.22	
6334.52	5.93	57.99	6315.05	201.87	323.00	0.00	0.00	319.75	
6631.04	0.00	0.00	6611.05	210.00	336.00	2.00	180.00	327.95	KOP @ 6631.05' MD
7131.11	50.01	0.33	7050.00	414.71	337.20	10.00	0.33	532.67	SHARON SPRINGS :
7253.31	62.23	0.33	7118.00	515.97	337.79	10.00	0.00	633.92	NIOBRARA A :
7338.63	70.76	0.33	7152.00	594.13	338.24	10.00	0.00	712.09	NIOBRARA B :
7530.87	89.98	0.33	7184.01	782.78	339.34	10.00	0.00	900.74	LANDING POINT
7530.88	89.98	0.33	7184.01	782.78	339.34	0.00	0.00	900.75	7 in
17432.97	89.98	0.33	7187.00	10684.70	397.16	0.00	0.00	10802.83	TD @ 17432.97' MD

5D Plan Report

Interpolated Points (Relative to centre, TVD relative to Drill Floor)									
MD (US ft)	Inc (°)	Az (°)	TVD (US ft)	N.Offset (US ft)	E.Offset (US ft)	DLS (°/100 US ft)	T.Face (°)	VS (US ft)	Comment
0.00	0.00	0.00	0.00	0.00	0.00	0.00	0.00	116.02	9 5/8 in
100.00	0.00	0.00	100.00	0.00	0.00	0.00	0.00	116.02	
200.00	0.00	0.00	200.00	0.00	0.00	0.00	0.00	116.02	
300.00	0.00	0.00	300.00	0.00	0.00	0.00	0.00	116.02	
400.00	0.00	0.00	400.00	0.00	0.00	0.00	0.00	116.02	
500.00	0.00	0.00	500.00	0.00	0.00	0.00	0.00	116.02	
600.00	0.00	0.00	600.00	0.00	0.00	0.00	0.00	116.02	
700.00	0.00	0.00	700.00	0.00	0.00	0.00	0.00	116.02	
800.00	0.00	0.00	800.00	0.00	0.00	0.00	0.00	116.02	
900.00	0.00	0.00	900.00	0.00	0.00	0.00	0.00	116.02	
967.00	0.00	0.00	967.00	0.00	0.00	0.00	0.00	116.02	
1000.00	0.00	0.00	1000.00	0.00	0.00	0.00	0.00	116.02	
1100.00	0.00	0.00	1100.00	0.00	0.00	0.00	0.00	116.02	
1200.00	0.00	0.00	1200.00	0.00	0.00	0.00	0.00	116.02	
1300.00	0.00	0.00	1300.00	0.00	0.00	0.00	0.00	116.02	
1400.00	0.00	0.00	1400.00	0.00	0.00	0.00	0.00	116.02	
1500.00	0.00	0.00	1500.00	0.00	0.00	0.00	0.00	116.02	
1600.00	0.00	0.00	1600.00	0.00	0.00	0.00	0.00	116.02	
1700.00	0.00	0.00	1700.00	0.00	0.00	0.00	0.00	116.02	
1800.00	0.00	0.00	1800.00	0.00	0.00	0.00	0.00	116.02	
1900.00	0.00	0.00	1900.00	0.00	0.00	0.00	0.00	116.02	
2000.00	0.00	0.00	2000.00	0.00	0.00	0.00	0.00	116.02	
2100.00	0.00	0.00	2100.00	0.00	0.00	0.00	0.00	116.02	
2200.00	0.00	0.00	2200.00	0.00	0.00	0.00	0.00	116.02	
2300.00	0.00	0.00	2300.00	0.00	0.00	0.00	0.00	116.02	
2400.00	0.00	0.00	2400.00	0.00	0.00	0.00	0.00	116.02	
2500.00	0.00	0.00	2500.00	0.00	0.00	0.00	0.00	116.02	
2600.00	2.00	57.99	2599.98	0.92	1.48	2.00	57.99	116.95	
2700.00	4.00	57.99	2699.84	3.70	5.92	2.00	0.00	119.75	
2796.53	5.93	57.99	2796.00	8.13	13.00	2.00	0.00	124.22	
2800.00	5.93	57.99	2799.45	8.32	13.31	0.00	0.00	124.41	
2900.00	5.93	57.99	2898.92	13.79	22.07	0.00	0.00	129.94	
3000.00	5.93	57.99	2998.38	19.27	30.83	0.00	0.00	135.47	
3100.00	5.93	57.99	3097.85	24.75	39.59	0.00	0.00	140.99	
3200.00	5.93	57.99	3197.31	30.22	48.35	0.00	0.00	146.52	
3300.00	5.93	57.99	3296.78	35.70	57.12	0.00	0.00	152.05	
3400.00	5.93	57.99	3396.24	41.17	65.88	0.00	0.00	157.57	
3500.00	5.93	57.99	3495.71	46.65	74.64	0.00	0.00	163.10	
3600.00	5.93	57.99	3595.17	52.13	83.40	0.00	0.00	168.63	
3700.00	5.93	57.99	3694.64	57.60	92.16	0.00	0.00	174.15	
3800.00	5.93	57.99	3794.10	63.08	100.93	0.00	0.00	179.68	

5D Plan Report

Interpolated Points (Relative to centre, TVD relative to Drill Floor)									
MD (US ft)	Inc (°)	Az (°)	TVD (US ft)	N.Offset (US ft)	E.Offset (US ft)	DLS (°/100 US ft)	T.Face (°)	VS (US ft)	Comment
3900.00	5.93	57.99	3893.56	68.55	109.69	0.00	0.00	185.21	
4000.00	5.93	57.99	3993.03	74.03	118.45	0.00	0.00	190.73	
4100.00	5.93	57.99	4092.49	79.51	127.21	0.00	0.00	196.26	
4200.00	5.93	57.99	4191.96	84.98	135.97	0.00	0.00	201.79	
4300.00	5.93	57.99	4291.42	90.46	144.74	0.00	0.00	207.31	
4400.00	5.93	57.99	4390.89	95.94	153.50	0.00	0.00	212.84	
4500.00	5.93	57.99	4490.35	101.41	162.26	0.00	0.00	218.37	
4600.00	5.93	57.99	4589.82	106.89	171.02	0.00	0.00	223.89	
4700.00	5.93	57.99	4689.28	112.36	179.78	0.00	0.00	229.42	
4800.00	5.93	57.99	4788.75	117.84	188.54	0.00	0.00	234.94	
4900.00	5.93	57.99	4888.21	123.32	197.31	0.00	0.00	240.47	
5000.00	5.93	57.99	4987.68	128.79	206.07	0.00	0.00	246.00	
5100.00	5.93	57.99	5087.14	134.27	214.83	0.00	0.00	251.52	
5200.00	5.93	57.99	5186.61	139.75	223.59	0.00	0.00	257.05	
5300.00	5.93	57.99	5286.07	145.22	232.35	0.00	0.00	262.58	
5400.00	5.93	57.99	5385.54	150.70	241.12	0.00	0.00	268.10	
5500.00	5.93	57.99	5485.00	156.17	249.88	0.00	0.00	273.63	
5600.00	5.93	57.99	5584.47	161.65	258.64	0.00	0.00	279.16	
5700.00	5.93	57.99	5683.93	167.13	267.40	0.00	0.00	284.68	
5800.00	5.93	57.99	5783.40	172.60	276.16	0.00	0.00	290.21	
5900.00	5.93	57.99	5882.86	178.08	284.93	0.00	0.00	295.74	
6000.00	5.93	57.99	5982.32	183.56	293.69	0.00	0.00	301.26	
6100.00	5.93	57.99	6081.79	189.03	302.45	0.00	0.00	306.79	
6200.00	5.93	57.99	6181.25	194.51	311.21	0.00	0.00	312.32	
6300.00	5.93	57.99	6280.72	199.98	319.97	0.00	0.00	317.84	
6334.52	5.93	57.99	6315.05	201.87	323.00	0.00	0.00	319.75	
6400.00	4.62	57.99	6380.26	205.07	328.10	2.00	180.00	322.97	
6500.00	2.62	57.99	6480.05	208.41	333.46	2.00	180.00	326.35	
6600.00	0.62	57.99	6580.01	209.91	335.86	2.00	180.00	327.86	
6631.04	0.00	0.00	6611.05	210.00	336.00	2.00	180.00	327.95	KOP @ 6631.05' MD
6700.00	6.90	0.33	6679.84	214.14	336.02	10.00	0.33	332.10	
6800.00	16.90	0.33	6777.57	234.73	336.14	10.00	0.00	352.68	
6900.00	26.90	0.33	6870.24	271.97	336.36	10.00	0.00	389.93	
7000.00	36.90	0.33	6955.03	324.74	336.67	10.00	0.00	442.70	
7100.00	46.90	0.33	7029.37	391.44	337.06	10.00	0.00	509.39	
7131.11	50.01	0.33	7050.00	414.71	337.20	10.00	0.00	532.67	SHARON SPRINGS :
7200.00	56.90	0.33	7091.00	470.02	337.52	10.00	0.00	587.98	
7253.31	62.23	0.33	7118.00	515.97	337.79	10.00	0.00	633.92	NIOBRARA A :
7300.00	66.90	0.33	7138.05	558.12	338.03	10.00	0.00	676.08	
7338.63	70.76	0.33	7152.00	594.13	338.24	10.00	0.00	712.09	NIOBRARA B :
7400.00	76.90	0.33	7169.09	653.05	338.59	10.00	0.00	771.01	

5D Plan Report

Interpolated Points (Relative to centre, TVD relative to Drill Floor)									
MD (US ft)	Inc (°)	Az (°)	TVD (US ft)	N.Offset (US ft)	E.Offset (US ft)	DLS (°/100 US ft)	T.Face (°)	VS (US ft)	Comment
7500.00	86.90	0.33	7183.17	751.92	339.16	10.00	0.00	869.88	LANDING POINT 7 in
7530.87	89.98	0.33	7184.01	782.78	339.34	10.00	0.00	900.74	
7530.88	89.98	0.33	7184.01	782.78	339.34	0.00	0.00	900.75	
7600.00	89.98	0.33	7184.03	851.90	339.75	0.00	0.00	969.87	
7700.00	89.98	0.33	7184.06	951.90	340.33	0.00	0.00	1069.87	
7800.00	89.98	0.33	7184.09	1051.90	340.92	0.00	0.00	1169.87	
7900.00	89.98	0.33	7184.12	1151.90	341.50	0.00	0.00	1269.87	
8000.00	89.98	0.33	7184.15	1251.90	342.08	0.00	0.00	1369.87	
8100.00	89.98	0.33	7184.18	1351.89	342.67	0.00	0.00	1469.87	
8200.00	89.98	0.33	7184.21	1451.89	343.25	0.00	0.00	1569.87	
8300.00	89.98	0.33	7184.24	1551.89	343.84	0.00	0.00	1669.87	
8400.00	89.98	0.33	7184.27	1651.89	344.42	0.00	0.00	1769.87	
8500.00	89.98	0.33	7184.30	1751.89	345.00	0.00	0.00	1869.87	
8600.00	89.98	0.33	7184.33	1851.89	345.59	0.00	0.00	1969.87	
8700.00	89.98	0.33	7184.36	1951.88	346.17	0.00	0.00	2069.87	
8800.00	89.98	0.33	7184.39	2051.88	346.76	0.00	0.00	2169.87	
8900.00	89.98	0.33	7184.42	2151.88	347.34	0.00	0.00	2269.87	
9000.00	89.98	0.33	7184.45	2251.88	347.92	0.00	0.00	2369.87	
9100.00	89.98	0.33	7184.48	2351.88	348.51	0.00	0.00	2469.87	
9200.00	89.98	0.33	7184.51	2451.88	349.09	0.00	0.00	2569.87	
9300.00	89.98	0.33	7184.54	2551.87	349.67	0.00	0.00	2669.87	
9400.00	89.98	0.33	7184.57	2651.87	350.26	0.00	0.00	2769.87	
9500.00	89.98	0.33	7184.60	2751.87	350.84	0.00	0.00	2869.87	
9600.00	89.98	0.33	7184.63	2851.87	351.43	0.00	0.00	2969.87	
9700.00	89.98	0.33	7184.66	2951.87	352.01	0.00	0.00	3069.87	
9800.00	89.98	0.33	7184.69	3051.87	352.59	0.00	0.00	3169.87	
9900.00	89.98	0.33	7184.72	3151.86	353.18	0.00	0.00	3269.87	
10000.00	89.98	0.33	7184.75	3251.86	353.76	0.00	0.00	3369.87	
10100.00	89.98	0.33	7184.78	3351.86	354.35	0.00	0.00	3469.87	
10200.00	89.98	0.33	7184.81	3451.86	354.93	0.00	0.00	3569.87	
10300.00	89.98	0.33	7184.84	3551.86	355.51	0.00	0.00	3669.87	
10400.00	89.98	0.33	7184.87	3651.85	356.10	0.00	0.00	3769.87	
10500.00	89.98	0.33	7184.90	3751.85	356.68	0.00	0.00	3869.87	
10600.00	89.98	0.33	7184.93	3851.85	357.27	0.00	0.00	3969.87	
10700.00	89.98	0.33	7184.97	3951.85	357.85	0.00	0.00	4069.87	
10800.00	89.98	0.33	7185.00	4051.85	358.43	0.00	0.00	4169.87	
10900.00	89.98	0.33	7185.03	4151.85	359.02	0.00	0.00	4269.87	
11000.00	89.98	0.33	7185.06	4251.84	359.60	0.00	0.00	4369.87	
11100.00	89.98	0.33	7185.09	4351.84	360.19	0.00	0.00	4469.87	
11200.00	89.98	0.33	7185.12	4451.84	360.77	0.00	0.00	4569.87	
11300.00	89.98	0.33	7185.15	4551.84	361.35	0.00	0.00	4669.87	

5D Plan Report

Interpolated Points (Relative to centre, TVD relative to Drill Floor)									
MD (US ft)	Inc (°)	Az (°)	TVD (US ft)	N.Offset (US ft)	E.Offset (US ft)	DLS (°/100 US ft)	T.Face (°)	VS (US ft)	Comment
11400.00	89.98	0.33	7185.18	4651.84	361.94	0.00	0.00	4769.87	
11500.00	89.98	0.33	7185.21	4751.84	362.52	0.00	0.00	4869.87	
11600.00	89.98	0.33	7185.24	4851.83	363.11	0.00	0.00	4969.87	
11700.00	89.98	0.33	7185.27	4951.83	363.69	0.00	0.00	5069.87	
11800.00	89.98	0.33	7185.30	5051.83	364.27	0.00	0.00	5169.87	
11900.00	89.98	0.33	7185.33	5151.83	364.86	0.00	0.00	5269.87	
12000.00	89.98	0.33	7185.36	5251.83	365.44	0.00	0.00	5369.87	
12100.00	89.98	0.33	7185.39	5351.83	366.02	0.00	0.00	5469.87	
12200.00	89.98	0.33	7185.42	5451.82	366.61	0.00	0.00	5569.87	
12300.00	89.98	0.33	7185.45	5551.82	367.19	0.00	0.00	5669.87	
12400.00	89.98	0.33	7185.48	5651.82	367.78	0.00	0.00	5769.87	
12500.00	89.98	0.33	7185.51	5751.82	368.36	0.00	0.00	5869.87	
12600.00	89.98	0.33	7185.54	5851.82	368.94	0.00	0.00	5969.87	
12700.00	89.98	0.33	7185.57	5951.82	369.53	0.00	0.00	6069.87	
12800.00	89.98	0.33	7185.60	6051.81	370.11	0.00	0.00	6169.87	
12900.00	89.98	0.33	7185.63	6151.81	370.70	0.00	0.00	6269.87	
13000.00	89.98	0.33	7185.66	6251.81	371.28	0.00	0.00	6369.87	
13100.00	89.98	0.33	7185.69	6351.81	371.86	0.00	0.00	6469.87	
13200.00	89.98	0.33	7185.72	6451.81	372.45	0.00	0.00	6569.87	
13300.00	89.98	0.33	7185.75	6551.81	373.03	0.00	0.00	6669.87	
13400.00	89.98	0.33	7185.78	6651.80	373.62	0.00	0.00	6769.87	
13500.00	89.98	0.33	7185.81	6751.80	374.20	0.00	0.00	6869.87	
13600.00	89.98	0.33	7185.84	6851.80	374.78	0.00	0.00	6969.87	
13700.00	89.98	0.33	7185.87	6951.80	375.37	0.00	0.00	7069.87	
13800.00	89.98	0.33	7185.90	7051.80	375.95	0.00	0.00	7169.87	
13900.00	89.98	0.33	7185.93	7151.79	376.54	0.00	0.00	7269.87	
14000.00	89.98	0.33	7185.96	7251.79	377.12	0.00	0.00	7369.87	
14100.00	89.98	0.33	7185.99	7351.79	377.70	0.00	0.00	7469.87	
14200.00	89.98	0.33	7186.02	7451.79	378.29	0.00	0.00	7569.87	
14300.00	89.98	0.33	7186.05	7551.79	378.87	0.00	0.00	7669.87	
14400.00	89.98	0.33	7186.08	7651.79	379.45	0.00	0.00	7769.87	
14500.00	89.98	0.33	7186.11	7751.78	380.04	0.00	0.00	7869.87	
14600.00	89.98	0.33	7186.14	7851.78	380.62	0.00	0.00	7969.87	
14700.00	89.98	0.33	7186.17	7951.78	381.21	0.00	0.00	8069.87	
14800.00	89.98	0.33	7186.20	8051.78	381.79	0.00	0.00	8169.87	
14900.00	89.98	0.33	7186.23	8151.78	382.37	0.00	0.00	8269.87	
15000.00	89.98	0.33	7186.26	8251.78	382.96	0.00	0.00	8369.87	
15100.00	89.98	0.33	7186.29	8351.77	383.54	0.00	0.00	8469.87	
15200.00	89.98	0.33	7186.33	8451.77	384.13	0.00	0.00	8569.87	
15300.00	89.98	0.33	7186.36	8551.77	384.71	0.00	0.00	8669.87	
15400.00	89.98	0.33	7186.39	8651.77	385.29	0.00	0.00	8769.87	

5D Plan Report

Interpolated Points (Relative to centre, TVD relative to Drill Floor)									
MD (US ft)	Inc (°)	Az (°)	TVD (US ft)	N.Offset (US ft)	E.Offset (US ft)	DLS (°/100 US ft)	T.Face (°)	VS (US ft)	Comment
15500.00	89.98	0.33	7186.42	8751.77	385.88	0.00	0.00	8869.87	
15600.00	89.98	0.33	7186.45	8851.77	386.46	0.00	0.00	8969.87	
15700.00	89.98	0.33	7186.48	8951.76	387.05	0.00	0.00	9069.87	
15800.00	89.98	0.33	7186.51	9051.76	387.63	0.00	0.00	9169.87	
15900.00	89.98	0.33	7186.54	9151.76	388.21	0.00	0.00	9269.87	
16000.00	89.98	0.33	7186.57	9251.76	388.80	0.00	0.00	9369.87	
16100.00	89.98	0.33	7186.60	9351.76	389.38	0.00	0.00	9469.87	
16200.00	89.98	0.33	7186.63	9451.76	389.97	0.00	0.00	9569.87	
16300.00	89.98	0.33	7186.66	9551.75	390.55	0.00	0.00	9669.87	
16400.00	89.98	0.33	7186.69	9651.75	391.13	0.00	0.00	9769.87	
16500.00	89.98	0.33	7186.72	9751.75	391.72	0.00	0.00	9869.87	
16600.00	89.98	0.33	7186.75	9851.75	392.30	0.00	0.00	9969.87	
16700.00	89.98	0.33	7186.78	9951.75	392.89	0.00	0.00	10069.87	
16800.00	89.98	0.33	7186.81	10051.75	393.47	0.00	0.00	10169.87	
16900.00	89.98	0.33	7186.84	10151.74	394.05	0.00	0.00	10269.87	
17000.00	89.98	0.33	7186.87	10251.74	394.64	0.00	0.00	10369.87	
17100.00	89.98	0.33	7186.90	10351.74	395.22	0.00	0.00	10469.87	
17200.00	89.98	0.33	7186.93	10451.74	395.80	0.00	0.00	10569.87	
17300.00	89.98	0.33	7186.96	10551.74	396.39	0.00	0.00	10669.87	
17400.00	89.98	0.33	7186.99	10651.74	396.97	0.00	0.00	10769.87	
17432.97	89.98	0.33	7187.00	10684.70	397.16	0.00	0.00	10802.83	TD @ 17432.97' MD

Formation Points (Relative to centre, TVD relative to Drill Floor)			
Name	MD (US ft)	TVD (US ft)	
SHARON SPRINGS	7131.11	7050.00	
NIOBRARA A	7253.31	7118.00	
NIOBRARA B	7338.63	7152.00	