

**SPEAKER 27-8-61
CARRIZO NIOBRARA LLC
PAD LAYOUT**

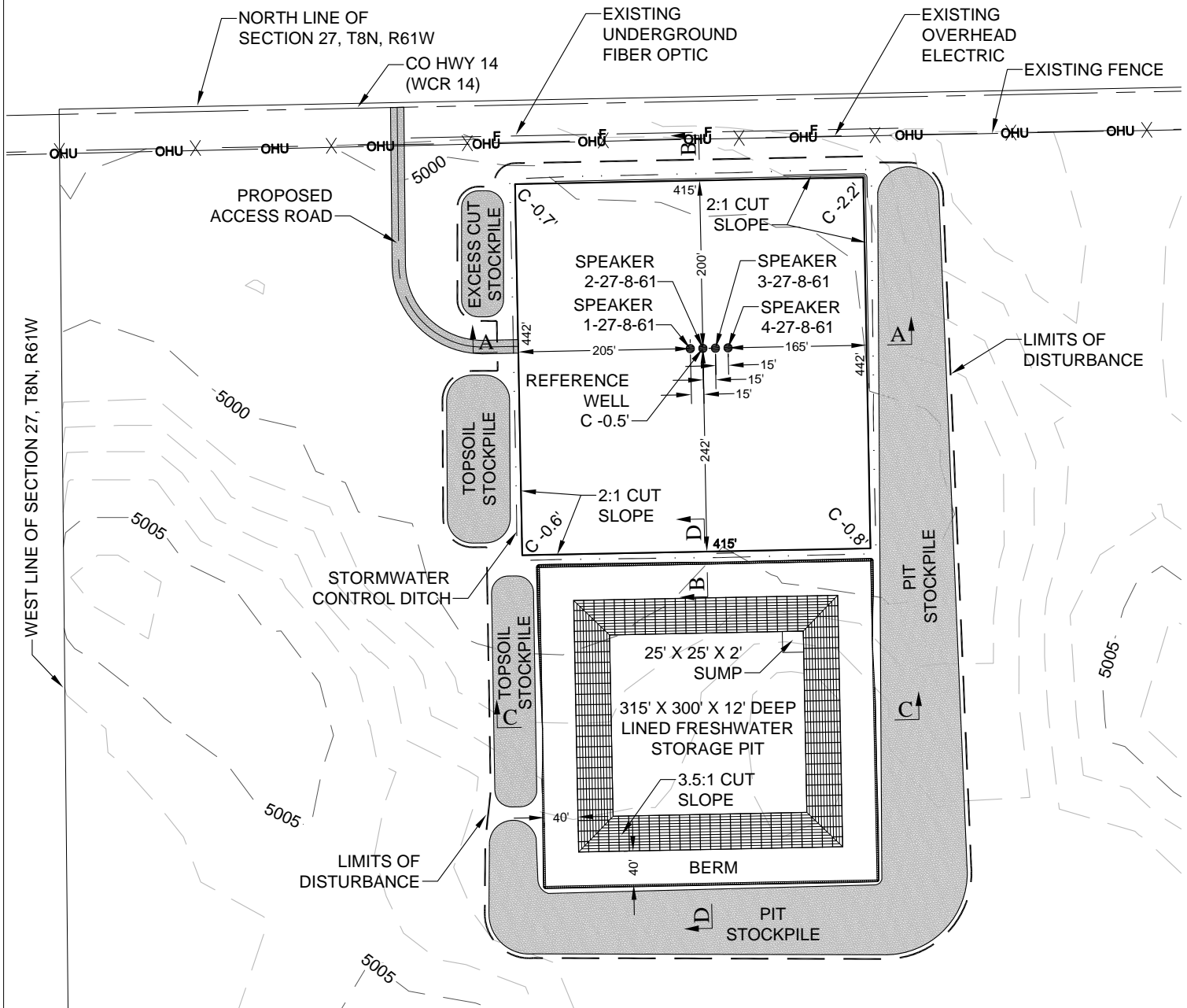

NOTES:

1. A COMPLETE UTILITIES LOCATION IS RECOMMENDED BEFORE CONSTRUCTION.
2. EARTHWORK QUANTITIES ARE APPROXIMATE & FOR INFORMATION ONLY. 6" OF TOPSOIL HAS BEEN SUBTRACTED FROM EXISTING SURFACE PRIOR TO PERFORMING EARTHWORK CALCULATION.
3. STOCKPILES ARE ASSUMED TO BE 10' IN HEIGHT WITH 2:1 SIDE SLOPES.

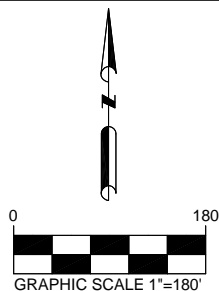

SITE QUANTITIES

FINISHED GRADE ELEVATION = 4998.80'
 CUT SLOPES = 2:1
 FILL SLOPES = 2:1
 TOTAL CUT FOR PAD = 1,530 CY
 TOTAL FILL FOR PAD (+10% SHRINKAGE) = 193 CY
 NET EXCESS MATERIAL = 1,337 CY
 PIT STOCKPILE = 31,901 CY
 TOPSOIL FROM GRADED AREA = 6,312 CY
 TOTAL DISTURBANCE AREA = 12.52 ACRES

PREPARED BY:



FIELD DATE:

06-11-13

DRAWING DATE:

07-24-13

BY:

CPO

CHECKED BY:

JLF

PAD NAME:

SPEAKER 27-8-61

SURFACE LOCATION:

NW 1/4, NW 1/4, SEC. 27, T8N, R61W, 6TH P.M.
 WELD COUNTY, COLORADO

PREPARED FOR:

CARRIZO
 NIOBRARA LLC

SPEAKER 27-8-61
CARRIZO NIOBRARA LLC
CROSS SECTIONS

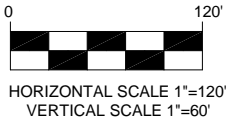
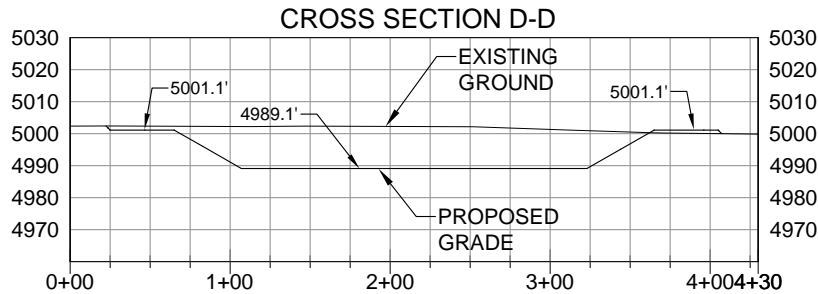
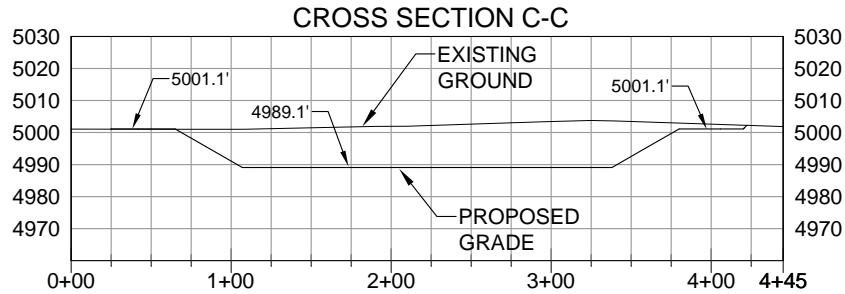
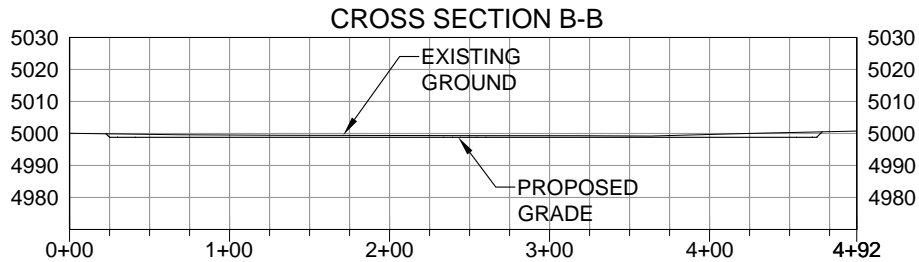
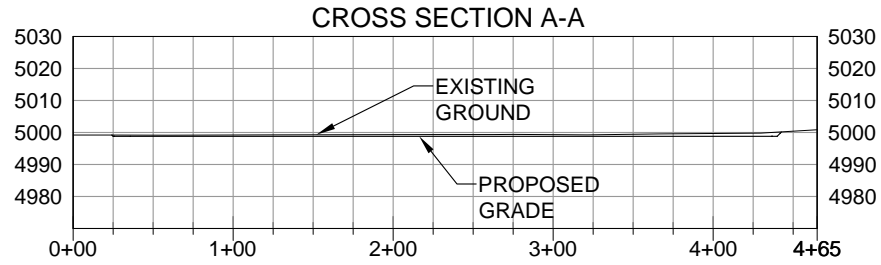

NOTE:

1. A COMPLETE UTILITIES LOCATION IS RECOMMENDED BEFORE CONSTRUCTION.

PREPARED BY:



FIELD DATE:

06-11-13

DRAWING DATE:

07-24-13

BY:

CPO

CHECKED BY:

JLF

PAD NAME:

SPEAKER 27-8-61

SURFACE LOCATION:

NW 1/4, NW 1/4, SEC. 27, T8N, R61W, 6TH P.M.
WELD COUNTY, COLORADO

PREPARED FOR:

CARRIZO
NIOBRARA LLC