

1625 Broadway
Suite 2000
Denver, CO 80202

Tel: 303.228.4000
Fax: 303.228.4280
www.nobleenergyinc.com



July 23, 2013

Colorado Oil and Gas Conservation Commission
The Chancery Building
1120 Lincoln Street, Suite 801
Denver, CO 80203
Attn: Mr. Matt Lepore, Director

RE: HEITMAN FEDERAL 32-68-1HNM
Niobrara New Drill
Township 4 North, Range 66 West, 6th P.M.
Section 32: NW/4NE/4: 250' FNL & 2410' FEL (Surface Location)
Section 32: NW/4NE/4: 991' FNL & 1366' FEL (Beginning of Lateral)
Section 34: NW/4NW/4: 990' FNL & 535' FWL (Bottom Hole Location)
Weld County, Colorado

Mr. Lepore:

Noble Energy, Inc. ("NEI") is planning to drill the captioned boundary well in accordance with the provisions of COGCC Rule 318A.e.

NEI's proposed wellbore spacing unit consists of the NE/4 SEC. 32, N/2 SEC. 33, W/2NW/4 SEC. 34, T4N , R66W, creating a 560-acre wellbore spacing unit for the Niobrara formation. NEI is not the only owner within the proposed wellbore spacing unit and as such provided notice to the remaining owner(s) within said proposed spacing unit as required under COGCC Rule 318A(l).e(6). Copies of the required notice letter(s) is/are on file at the NEI offices. The required thirty (30) day notice period has elapsed absent the receipt by NEI of an objection to said proposal by the owner(s) within the proposed spacing unit for this well.

Enclosed are copies of the following documents to assist you in your review and approval of NEI's proposed APD for the captioned well:

- Map & plat illustrating proposed wellbore spacing unit.

Thank you for your attention to the enclosed. NEI respectfully requests that the COGCC review the enclosed information and approve the Application for Permit to Drill the captioned well.

Sincerely,

A handwritten signature in blue ink that reads 'Jan Kajiwar'.

Jan Kajiwar
Regulatory Analyst III
Noble Energy Inc.

NE/4 of Section 32, N/2 of Section 33 and W/2NW/4 of
Section 34, Township 4 North, Range 66 West

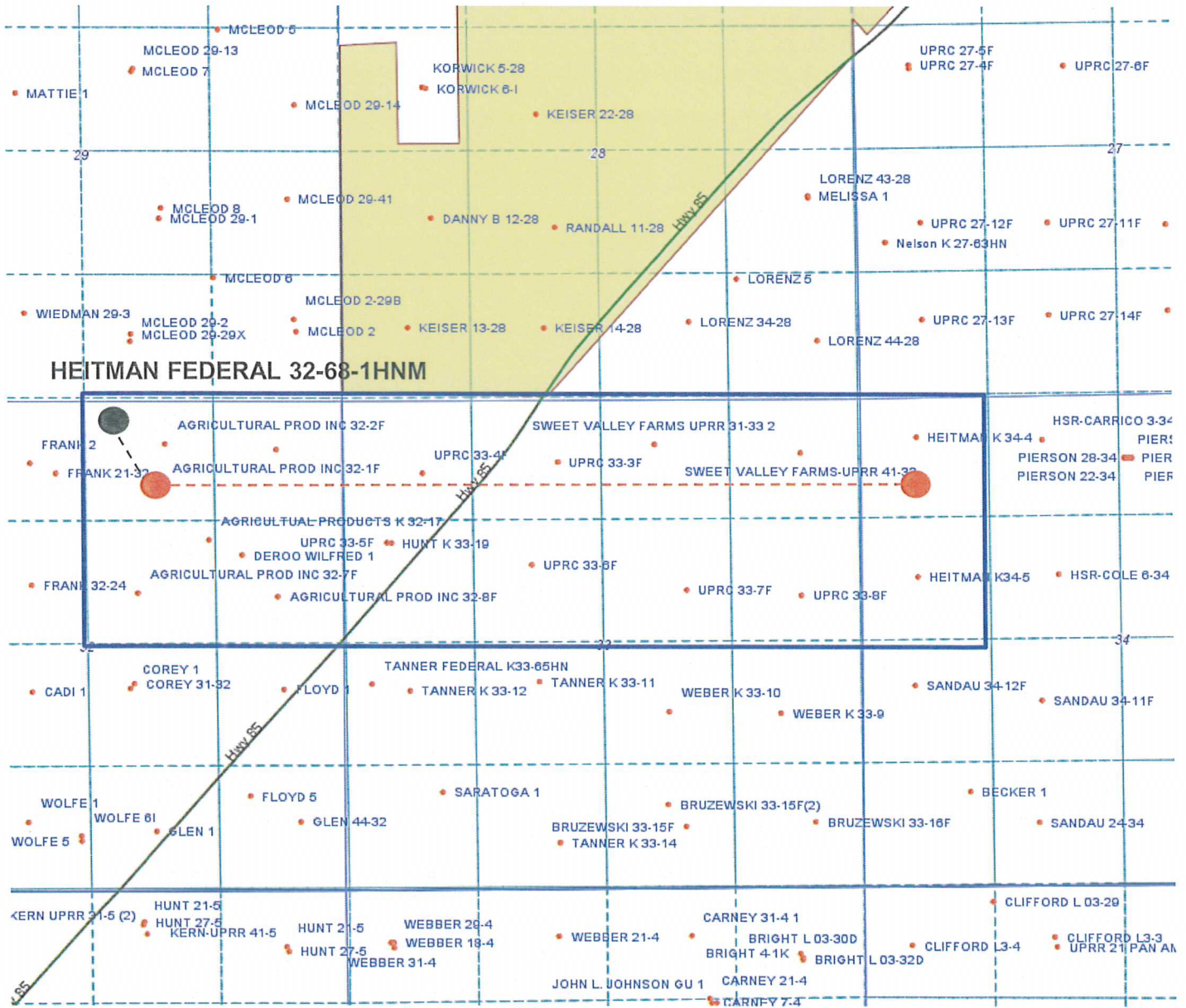

Legend



Proposed 560± acre spacing unit



Bottom Hole Location