



July 25, 2013



Kerr-McGee Oil & Gas Onshore LP
1099 18th Street, Suite 1800
Denver, Colorado 80202
720-929-6000 Fax 720-929-7000

Mr. Robert Chesson
Environmental Protection Specialist
Colorado Oil and Gas Conservation Commission
1120 Lincoln Street, Suite 801
Denver, Colorado 80203

**Re: No Further Action Status Request
Edstrom 24-8 #1
COGCC Remediation No. 4312
SESW 8-T1S-R67W**

Dear Mr. Chesson:

Kerr-McGee Oil and Gas Onshore, LP (Kerr-McGee) is submitting this letter report as an update to the Form 27, submitted on August 25, 2008, for the Edstrom 24-8 #1 tank battery. We are requesting a No Further Action (NFA) status for this site.

On May 19, 2008, field crews discovered soil with petroleum hydrocarbon impacts resulting from a leak in the oil and water dumphines. The well was shut in, and the remaining fluids were transferred from the production tank. Kerr-McGee contracted LT Environmental, Inc. to oversee excavation activities, collect confirmation soil samples, perform quarterly groundwater monitoring, and interpret the analytical results. Approximately 500 cubic yards of petroleum hydrocarbon impacted soil were removed from the excavation and transported to the Waste Connections landfill in Erie, Colorado for disposal.

Confirmation soil samples were collected from the excavation sidewalls and submitted for total extractable petroleum hydrocarbon (TEPH) analysis by Environmental Protection Agency (EPA) Method 8015 (full carbon chain). The analytical results confirmed that TEPH concentrations were below the Colorado Oil and Gas Conservation Commission's sensitive area allowable levels at the extent of the excavation.

Groundwater was encountered in the excavation at approximately 14 feet below ground surface. One excavation groundwater sample (GW01) was collected from the excavation on June 2, 2008 and submitted for benzene, toluene, ethylbenzene, and total xylenes (BTEX) analysis by EPA Method 8260B. The benzene concentration in the GW01 groundwater sample exceeded the Colorado Groundwater Quality Standards (CGWQS) at 53 micrograms per liter ($\mu\text{g/L}$). Five gallons of MicroBlaze[®] microbial solution was applied to the groundwater and exposed smear zone prior to backfilling the excavation. The excavation area was restored to its pre-release grade and Kerr-McGee's production facility remains at the site.

In order to assess the extent and magnitude of the residual dissolved phase groundwater impacts, four monitoring wells (MW01 through MW04) were installed at the site and sampled for BTEX

analysis by EPA Method 8260B in July 2008. Benzene concentrations exceeded the CGWQS in monitoring wells MW01, MW02, and MW03. BTEX concentrations were below the CGWQS and below the laboratory reporting limit of 1.0 µg/L in monitoring well MW04. Based on the groundwater analytical results, three additional monitoring wells (MW05 through MW07) were installed downgradient of monitoring wells MW01 through MW03 in August 2008.

All seven monitoring wells were sampled during the October 2008 quarterly sampling event. BTEX concentrations in monitoring wells MW04 through MW07 were below CGWQS and the laboratory reporting limit of 1.0 µg/L. Based on the October 2008 analytical results, monitoring wells MW04 through MW07 were designated as point of compliance wells. Groundwater monitoring continued on a quarterly basis.

As of the January 23, 2013 sampling event, BTEX concentrations in all seven monitoring wells (MW01 through MW07) have remained below the CGWQS for four consecutive quarterly groundwater monitoring events. A Site Map showing the general site layout, excavation outline, and monitoring well locations is provided as Figure 1. The groundwater analytical results are summarized in Table 1 and the laboratory analytical reports are attached.

Remedial actions employed at the site included excavation of the source area and application of the MicroBlaze[®] groundwater amendment to the open excavation. Based on these remedial actions and groundwater analytical results showing BTEX concentrations below the CGWQS for four consecutive quarterly monitoring events, Kerr-McGee is requesting NFA status for this site.

Feel free to contact me at 720-929-6726 if you have any questions regarding this information.

Sincerely,

Kerr-McGee Oil & Gas Onshore, LP

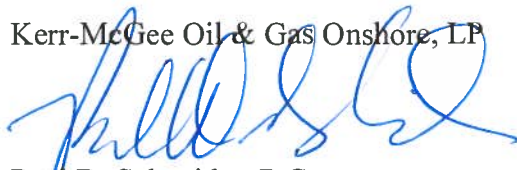

Paul D. Schneider, P.G.
Senior Staff EHS Representative

Attachments

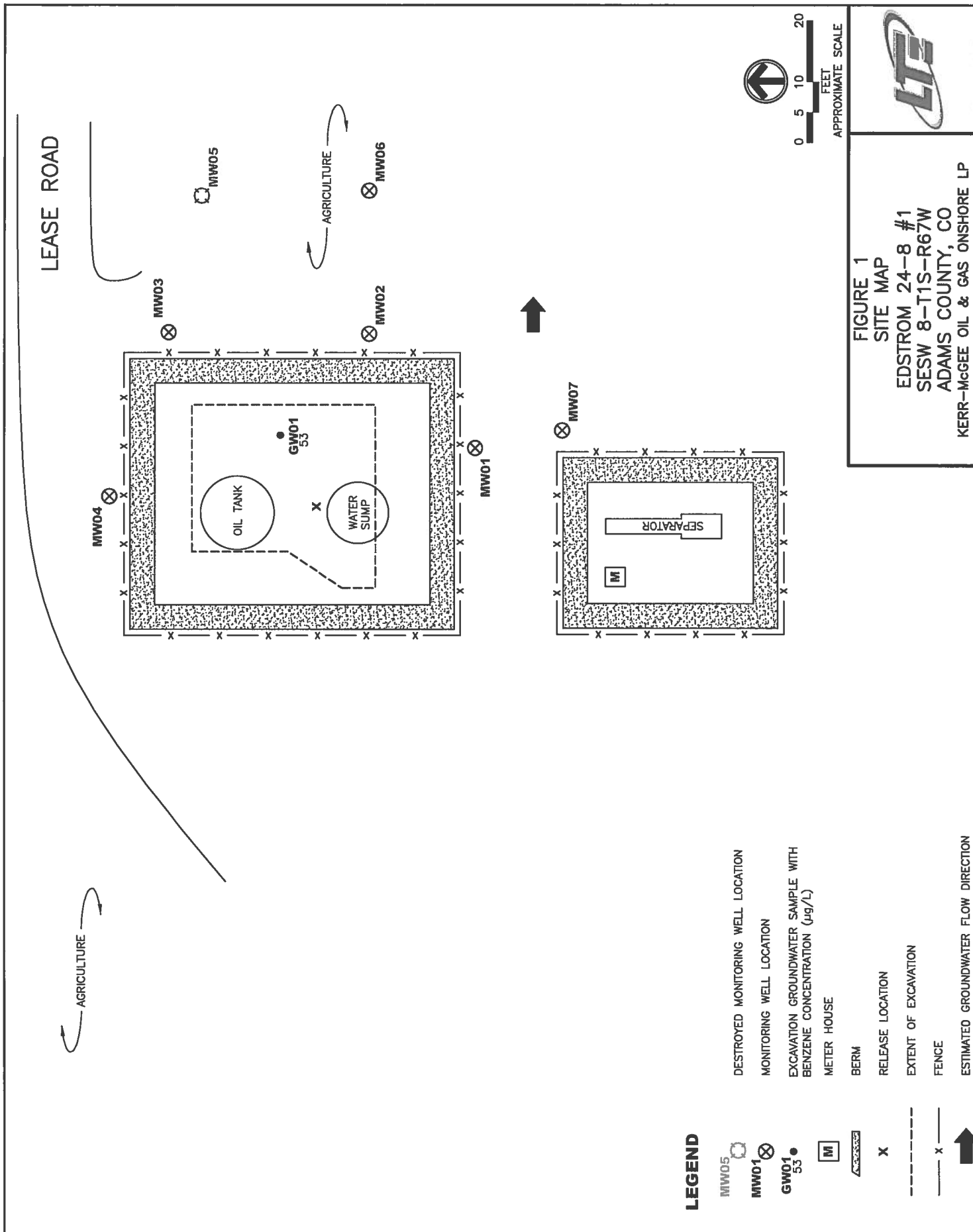

TABLE 1
GROUNDWATER ANALYTICAL AND FIELD RESULTS
EDSTROM 24-8 #1

ADAMS COUNTY, COLORADO
KERR-McGEE OIL & GAS ONSHORE LP

Well Name	Date	Benzene (ug/L)	Toluene (ug/L)	Ethylbenzene (ug/L)	Xylenes (ug/L)	Depth Water/ (Depth Product) (ft bgs)
GW01	06/02/2000	53	<1.0	120	800	NM
MW01	07/14/2008	200	3.9	5.4	19	13.60
	10/10/2008	7.9	<1.0	2.0	<1.0	13.70
	01/07/2009	5.2	<1.0	<1.0	2.3	13.33
	04/09/2009	1.5	<1.0	<1.0	<1.0	13.23
	07/09/2009	1.9	<1.0	4.9	<1.0	12.26
	10/30/2009	<1.0	<1.0	<1.0	<1.0	12.79
	01/04/2010	<1.0	<1.0	<1.0	<1.0	12.40
	04/20/2010	1.2	<1.0	<1.0	<1.0	11.91
	07/08/2010	1.9	<1.0	<1.0	<1.0	11.67
	10/04/2010	3.5	<1.0	<1.0	<1.0	12.92
	01/10/2011	2.3	<1.0	<1.0	<1.0	12.96
	04/21/2011	1.0	<1.0	1.2	<1.0	12.54
	07/18/2011	1.6	<1.0	<1.0	<1.0	13.00
	10/21/2011	1.0	<1.0	<1.0	<1.0	13.98
	01/04/2012	<1.0	<1.0	<1.0	<1.0	13.48
	04/12/2012	<1.0	<1.0	<1.0	<1.0	13.15
	07/10/2012	<1.0	<1.0	<1.0	<1.0	12.90
	10/12/2012	<1.0	<1.0	<1.0	<1.0	15.05
	01/23/2013	2.0	<1.0	<1.0	<1.0	15.47
MW02	07/14/2008	410	<1.0	490	370	13.14
	10/10/2008	590	<1.0	100	58	13.22
	01/07/2009	710	<1.0	150	59	12.71
	04/09/2009	330	<1.0	94	12	12.41
	07/09/2009	210	<1.0	28	<1.0	11.74
	10/30/2009	29	<1.0	1.7	<1.0	11.46
	01/04/2010	74	<1.0	<1.0	<1.0	11.87
	04/20/2010	60	<1.0	<1.0	<1.0	11.42
	07/08/2010	80	<1.0	<1.0	<1.0	11.14
	10/04/2010	42	<1.0	<1.0	<1.0	12.47
	01/10/2011	62	<1.0	1.1	<1.0	12.47
	04/21/2011	46	<1.0	<1.0	<1.0	12.03
	07/18/2011	100	<1.0	<1.0	<1.0	12.60
	10/21/2011	49	<1.0	<1.0	<1.0	13.52
	01/04/2012	9.0	<1.0	16	<1.0	13.10
	04/12/2012	1.9	<1.0	<1.0	<1.0	12.42
	07/10/2012	<1.0	<1.0	<1.0	<1.0	11.87
	10/12/2012	1.9	<1.0	<1.0	<1.0	12.05
	01/23/2013	1.5	<1.0	<1.0	<1.0	15.94



TABLE 1 (Continued)
GROUNDWATER ANALYTICAL AND FIELD RESULTS
EDSTROM 24-8 #1

ADAMS COUNTY, COLORADO
KERR-McGEE OIL & GAS ONSHORE LP

Well Name	Date	Benzene (ug/L)	Toluene (ug/L)	Ethylbenzene (ug/L)	Xylenes (ug/L)	Depth Water/ (Depth Product) (ft bgs)
MW03	07/14/2008	280	<1.0	310	1700	12.81
	10/10/2008	250	<1.0	140	420	12.98
	01/07/2009	83	<1.0	78	50	12.30
	04/09/2009	560	<1.0	340	700	12.07
	07/09/2009	610	<1.0	460	1400	11.27
	10/30/2009	400	<1.0	10	8.9	11.80
	01/04/2010	8.0	<1.0	2.4	7.8	11.39
	04/20/2010	33	<1.0	22	75	10.99
	07/08/2010	8.7	<1.0	11	32	10.76
	10/04/2010	16	<1.0	34	46	12.06
	01/10/2011	3.5	<1.0	7.2	20	12.02
	04/21/2011	3.8	<1.0	4.8	16	11.66
	07/18/2011	1.4	<1.0	3.8	15	12.33
	10/21/2011	4.4	<1.0	6.9	<1.0	13.22
	01/04/2012	<1.0	<1.0	<1.0	<1.0	12.71
	04/12/2012	4.4	<1.0	4.5	8.1	15.45
	07/10/2012	1.5	<1.0	1.5	<1.0	11.94
	10/12/2012	<1.0	<1.0	<1.0	<1.0	12.19
	01/23/2013	<1.0	<1.0	<1.0	<1.0	14.70
MW04	07/14/2008	<1.0	<1.0	<1.0	<1.0	11.49
	10/10/2008	<1.0	<1.0	<1.0	<1.0	12.37
	01/07/2009	<1.0	<1.0	<1.0	<1.0	11.76
	04/09/2009	<1.0	<1.0	<1.0	<1.0	11.54
	07/09/2009	<1.0	<1.0	<1.0	<1.0	10.77
	10/30/2009	<1.0	<1.0	<1.0	<1.0	11.16
	01/04/2010	<1.0	<1.0	<1.0	<1.0	10.82
	04/20/2010	<1.0	<1.0	<1.0	<1.0	10.38
	07/08/2010	<1.0	<1.0	<1.0	<1.0	10.17
	10/04/2010	<1.0	<1.0	<1.0	<1.0	11.48
	01/10/2011	<1.0	<1.0	<1.0	<1.0	11.56
	04/21/2011	<1.0	<1.0	<1.0	<1.0	11.08
	07/18/2011	<1.0	<1.0	<1.0	<1.0	11.85
	10/21/2011	<1.0	<1.0	<1.0	<1.0	12.73
	01/04/2012	<1.0	<1.0	<1.0	<1.0	12.25
	04/12/2012	<1.0	<1.0	<1.0	<1.0	11.99
	07/10/2012	<1.0	<1.0	<1.0	<1.0	11.43
	10/12/2012	<1.0	<1.0	<1.0	<1.0	11.63
	01/23/2013	<1.0	<1.0	<1.0	<1.0	14.38



TABLE 1 (Continued)
GROUNDWATER ANALYTICAL AND FIELD RESULTS
EDSTROM 24-8 #1

ADAMS COUNTY, COLORADO
KERR-McGEE OIL & GAS ONSHORE LP

Well Name	Date	Benzene (ug/L)	Toluene (ug/L)	Ethylbenzene (ug/L)	Xylenes (ug/L)	Depth Water/ (Depth Product) (ft bgs)
MW05	10/10/2008	<1.0	<1.0	<1.0	<1.0	13.03
	01/07/2009	<1.0	<1.0	<1.0	<1.0	12.58
	04/09/2009	<1.0	<1.0	<1.0	<1.0	12.31
	07/09/2009	<1.0	<1.0	<1.0	<1.0	11.61
	10/30/2009	<1.0	<1.0	<1.0	<1.0	12.05
	01/04/2010	Dry - Not Sampled				Dry
	04/20/2010	<1.0	<1.0	<1.0	<1.0	11.45
	07/08/2010	<1.0	<1.0	<1.0	<1.0	11.18
	10/04/2010	<1.0	<1.0	<1.0	<1.0	12.32
	01/10/2011	<1.0	<1.0	<1.0	<1.0	12.35
	04/21/2011	<1.0	<1.0	<1.0	<1.0	11.94
	07/18/2011	<1.0	<1.0	<1.0	<1.0	12.58
	10/21/2011	<1.0	<1.0	<1.0	<1.0	13.31
	01/04/2012	<1.0	<1.0	<1.0	<1.0	12.89
	04/12/2012	<1.0	<1.0	<1.0	<1.0	12.41
	07/10/2012	Damaged - Not Sampled				PVC Broken NM
	10/12/2012	Damaged - Not Sampled				
	MW05 destroyed as of 1/23/2013					
MW06	10/10/2008	<1.0	<1.0	<1.0	<1.0	13.45
	01/07/2009	<1.0	<1.0	<1.0	<1.0	13.10
	04/09/2009	<1.0	<1.0	<1.0	<1.0	12.91
	07/09/2009	<1.0	<1.0	<1.0	<1.0	12.52
	10/30/2009	<1.0	<1.0	<1.0	<1.0	12.44
	01/04/2010	<1.0	<1.0	<1.0	<1.0	12.18
	04/20/2010	<1.0	<1.0	<1.0	<1.0	11.63
	07/08/2010	<1.0	<1.0	<1.0	<1.0	11.05
	10/04/2010	<1.0	<1.0	<1.0	<1.0	12.51
	01/10/2011	<1.0	<1.0	<1.0	<1.0	12.48
	04/21/2011	<1.0	<1.0	<1.0	<1.0	12.32
	07/18/2011	<1.0	<1.0	<1.0	<1.0	12.67
	10/21/2011	<1.0	<1.0	<1.0	<1.0	13.57
	01/04/2012	<1.0	<1.0	<1.0	<1.0	13.15
	04/12/2012	<1.0	<1.0	<1.0	<1.0	12.65
	07/10/2012	<1.0	<1.0	<1.0	<1.0	12.26
	10/12/2012	<1.0	<1.0	<1.0	<1.0	14.43
	01/23/2013	<1.0	<1.0	<1.0	<1.0	15.01



TABLE 1 (Continued)
GROUNDWATER ANALYTICAL AND FIELD RESULTS
EDSTROM 24-8 #1

ADAMS COUNTY, COLORADO
KERR-McGEE OIL & GAS ONSHORE LP

Well Name	Date	Benzene (ug/L)	Toluene (ug/L)	Ethylbenzene (ug/L)	Xylenes (ug/L)	Depth Water/ (Depth Product) (ft bgs)
MW07	10/10/2008	<1.0	<1.0	<1.0	<1.0	14.19
	01/07/2009	<1.0	<1.0	<1.0	<1.0	14.10
	04/09/2009	<1.0	<1.0	<1.0	<1.0	13.78
	07/09/2009	<1.0	<1.0	<1.0	<1.0	12.72
	10/30/2009	<1.0	<1.0	<1.0	<1.0	13.32
	01/04/2010	<1.0	<1.0	<1.0	<1.0	13.12
	04/20/2010	<1.0	<1.0	<1.0	<1.0	12.65
	07/08/2010	<1.0	<1.0	<1.0	<1.0	11.94
	10/04/2010	<1.0	<1.0	<1.0	<1.0	13.18
	01/10/2011	<1.0	<1.0	<1.0	<1.0	13.30
	04/21/2011	<1.0	<1.0	<1.0	<1.0	13.06
	07/18/2011	<1.0	<1.0	<1.0	<1.0	13.20
	10/21/2011	<1.0	<1.0	<1.0	<1.0	14.17
	01/04/2012	<1.0	<1.0	<1.0	<1.0	13.79
	04/12/2012	<1.0	<1.0	<1.0	<1.0	13.36
	07/10/2012	<1.0	<1.0	<1.0	<1.0	13.04
	10/12/2012	<1.0	<1.0	<1.0	<1.0	14.76
	01/23/2013	<1.0	<1.0	<1.0	<1.0	15.67
Colo GW Quality Standards		5	1000	700	1400	

Notes: NM - Not Measured
ug/L - micrograms per Liter
NA - Not Analyzed/Not Available

GW - Groundwater ft bgs - feet below ground surface
< - less than laboratory reporting limit
Bold numbers indicate result equaled or exceeded standard.



Summit Scientific

741 Corporate Circle – Suite I ♦ Golden, Colorado 80401

303.277.9310 - laboratory ♦ 303.277.9531 - fax

January 28, 2013

John Cocroft
LT Environmental, Inc.
4600 West 60th Avenue
Arvada, CO 80003
RE: KMG - Edstrom 24-8 #1

Enclosed are the results of analyses for samples received by Summit Scientific on 01/23/13 16:20. If you have any questions concerning this report, please feel free to contact me.

Sincerely,



Joseph J Egry IV
Laboratory Director

This report shall not be reproduced, except in its entirety, without the written approval of Summit Scientific. Test results relate only to samples analyzed.

Summit Scientific is the sole authority for authorizing edits or modifications to this document. Unauthorized modification of this report is strictly prohibited.

S₂

LT Environmental, Inc.
4600 West 60th Avenue
Arvada CO, 80003

Project: KMG - Edstrom 24-8 #1

Project Number: KMG 08390
Project Manager: John Cocroft

Reported:
01/28/13 14:22

ANALYTICAL REPORT FOR SAMPLES

Sample ID	Laboratory ID	Matrix	Date Sampled	Date Received
MW01	R301148-01	Water	01/23/13 11:40	01/23/13 16:20
MW02	R301148-02	Water	01/23/13 11:50	01/23/13 16:20
MW03	R301148-03	Water	01/23/13 12:00	01/23/13 16:20
MW04	R301148-04	Water	01/23/13 12:10	01/23/13 16:20
MW06	R301148-06	Water	01/23/13 12:20	01/23/13 16:20
MW07	R301148-07	Water	01/23/13 12:30	01/23/13 16:20

Summit Scientific

The results in this report apply to the samples analyzed in accordance with the chain of custody document. This analytical report must be reproduced in its entirety.

S₂

LT Environmental, Inc.
4600 West 60th Avenue
Arvada CO, 80003

Project: KMG - Edstrom 24-8 #1

Project Number: KMG 08390
Project Manager: John Cocroft

Reported:
01/28/13 14:22

Summit Scientific
R301148
Page 1 of 1

711 Corporate Circle - Suite 1
Golden, Colorado 80601
303-277-9310 - 303-374-5933 Fax

Client: LT Environmental, Inc.
Project: KMG - Edstrom 24-8 #1
Project Manager: John Cocroft
Project Number: KMG 08390

Number	Sample Identification	Matrix	Type	Sample Date	Sample Time	Sampled By	Container	Qty	Analysis
01-401	NW01	Water	Field Sample	1/23/13	1140	SD	Na Val - HCl	3	0280 PTEX, TDTL
02-401	NW02	Water	Field Sample		1150		Na Val - HCl	3	0280 PTEX, TDTL
03-401	NW03	Water	Field Sample		1200		Na Val - HCl	3	0280 PTEX, TDTL
04-401	NW04	Water	Field Sample		1210		Na Val - HCl	3	0280 PTEX, TDTL
05-401	NW05	Water	Field Sample				Na Val - HCl	3	0280 PTEX, TDTL
06-401	NW06	Water	Field Sample	1/23/13	1220	SD	Na Val - HCl	3	0280 PTEX, TDTL
07-401	NW07	Water	Field Sample		1230		Na Val - HCl	3	0280 PTEX, TDTL

Turn Around Time (Check)

Same Day ☐ 7/15am
24 Hours ☒ 7/15am
48 Hours ☐

Sample Integrity:
Temperature (C/F) 5.0
Time (C/F) 5.0

Indispatched By _____ Date _____

Received By _____ Date _____

Reviewed By [Signature] Date 1/23/13

Reviewed By [Signature] Date 1/23/13 1140

Summit Scientific

[Signature]

The results in this report apply to the samples analyzed in accordance with the chain of custody document. This analytical report must be reproduced in its entirety.

S₂

LT Environmental, Inc.
4600 West 60th Avenue
Arvada CO, 80003

Project: KMG - Edstrom 24-8 #1

Project Number: KMG 08390
Project Manager: John Cocroft

Reported:
01/28/13 14:22

MW01
R301148-01 (Water)

Summit Scientific

Volatile Organic Compounds by EPA Method 8260B

Date Sampled: 01/23/13 11:40

Analyte	Result	Reporting		Dilution	Batch	Prepared	Analyzed	Method	Notes
		Limit	Units						
Benzene	2.0	1.0	ug/l	1	3012405	01/24/13	01/26/13	EPA 8260B	
Toluene	ND	1.0	"	"	"	"	"	"	
Ethylbenzene	ND	1.0	"	"	"	"	"	"	
Xylenes (total)	ND	1.0	"	"	"	"	"	"	

Date Sampled: 01/23/13 11:40

Analyte	Result	Reporting		Dilution	Batch	Prepared	Analyzed	Method	Notes
		Limit	Units						
Surrogate: 1,2-Dichloroethane-d4		101 %	37-154		"	"	"	"	
Surrogate: Toluene-d8		99.9 %	45-149		"	"	"	"	
Surrogate: 4-Bromofluorobenzene		99.9 %	45-146		"	"	"	"	

Summit Scientific

The results in this report apply to the samples analyzed in accordance with the chain of custody document. This analytical report must be reproduced in its entirety.

S₂

LT Environmental, Inc.
4600 West 60th Avenue
Arvada CO, 80003

Project: KMG - Edstrom 24-8 #1

Project Number: KMG 08390
Project Manager: John Cocroft

Reported:
01/28/13 14:22

MW02
R301148-02 (Water)

Summit Scientific

Volatile Organic Compounds by EPA Method 8260B

Date Sampled: 01/23/13 11:50

Analyte	Result	Reporting Limit	Units	Dilution	Batch	Prepared	Analyzed	Method	Notes
Benzene	1.5	1.0	ug/l	1	3012405	01/24/13	01/26/13	EPA 8260B	
Toluene	ND	1.0	"	"	"	"	"	"	
Ethylbenzene	ND	1.0	"	"	"	"	"	"	
Xylenes (total)	ND	1.0	"	"	"	"	"	"	

Date Sampled: 01/23/13 11:50

Analyte	Result	Reporting Limit	Units	Dilution	Batch	Prepared	Analyzed	Method	Notes
Surrogate: 1,2-Dichloroethane-d4		99.5 %	37-154		"	"	"	"	
Surrogate: Toluene-d8		101 %	45-149		"	"	"	"	
Surrogate: 4-Bromofluorobenzene		91.4 %	45-146		"	"	"	"	

Summit Scientific

The results in this report apply to the samples analyzed in accordance with the chain of custody document. This analytical report must be reproduced in its entirety.

S₂

LT Environmental, Inc.
4600 West 60th Avenue
Arvada CO, 80003

Project: KMG - Edstrom 24-8 #1

Project Number: KMG 08390
Project Manager: John Cocroft

Reported:
01/28/13 14:22

MW03
R301148-03 (Water)

Summit Scientific

Volatile Organic Compounds by EPA Method 8260B

Date Sampled: 01/23/13 12:00

Analyte	Result	Reporting		Units	Dilution	Batch	Prepared	Analyzed	Method	Notes
		Limit								
Benzene	ND	1.0		ug/l	1	3012405	01/24/13	01/26/13	EPA 8260B	
Toluene	ND	1.0		"	"	"	"	"	"	
Ethylbenzene	ND	1.0		"	"	"	"	"	"	
Xylenes (total)	ND	1.0		"	"	"	"	"	"	

Date Sampled: 01/23/13 12:00

Analyte	Result	Reporting		Units	Dilution	Batch	Prepared	Analyzed	Method	Notes
		Limit								
Surrogate: 1,2-Dichloroethane-d4		97.7 %		37-154		"	"	"	"	
Surrogate: Toluene-d8		97.9 %		45-149		"	"	"	"	
Surrogate: 4-Bromofluorobenzene		95.1 %		45-146		"	"	"	"	

Summit Scientific

The results in this report apply to the samples analyzed in accordance with the chain of custody document. This analytical report must be reproduced in its entirety.

S₂

LT Environmental, Inc.
4600 West 60th Avenue
Arvada CO, 80003

Project: KMG - Edstrom 24-8 #1

Project Number: KMG 08390
Project Manager: John Cocroft

Reported:
01/28/13 14:22

MW04
R301148-04 (Water)

Summit Scientific

Volatile Organic Compounds by EPA Method 8260B

Date Sampled: 01/23/13 12:10

Analyte	Result	Reporting Limit	Units	Dilution	Batch	Prepared	Analyzed	Method	Notes
Benzene	ND	1.0	ug/l	1	3012405	01/24/13	01/26/13	EPA 8260B	
Toluene	ND	1.0	"	"	"	"	"	"	
Ethylbenzene	ND	1.0	"	"	"	"	"	"	
Xylenes (total)	ND	1.0	"	"	"	"	"	"	

Date Sampled: 01/23/13 12:10

Analyte	Result	Reporting Limit	Units	Dilution	Batch	Prepared	Analyzed	Method	Notes
Surrogate: 1,2-Dichloroethane-d4		98.8 %	37-154		"	"	"	"	
Surrogate: Toluene-d8		100 %	45-149		"	"	"	"	
Surrogate: 4-Bromofluorobenzene		104 %	45-146		"	"	"	"	

Summit Scientific

The results in this report apply to the samples analyzed in accordance with the chain of custody document. This analytical report must be reproduced in its entirety.

S₂

LT Environmental, Inc.
4600 West 60th Avenue
Arvada CO, 80003

Project: KMG - Edstrom 24-8 #1

Project Number: KMG 08390
Project Manager: John Cocroft

Reported:
01/28/13 14:22

MW06
R301148-06 (Water)

Summit Scientific

Volatile Organic Compounds by EPA Method 8260B

Date Sampled: 01/23/13 12:20

Analyte	Result	Reporting Limit	Units	Dilution	Batch	Prepared	Analyzed	Method	Notes
Benzene	ND	1.0	ug/l	1	3012405	01/24/13	01/26/13	EPA 8260B	
Toluene	ND	1.0	"	"	"	"	"	"	
Ethylbenzene	ND	1.0	"	"	"	"	"	"	
Xylenes (total)	ND	1.0	"	"	"	"	"	"	

Date Sampled: 01/23/13 12:20

Analyte	Result	Reporting Limit	Units	Dilution	Batch	Prepared	Analyzed	Method	Notes
Surrogate: 1,2-Dichloroethane-d4		96.6 %	37-154		"	"	"	"	
Surrogate: Toluene-d8		100 %	45-149		"	"	"	"	
Surrogate: 4-Bromofluorobenzene		86.7 %	45-146		"	"	"	"	

Summit Scientific

The results in this report apply to the samples analyzed in accordance with the chain of custody document. This analytical report must be reproduced in its entirety.

S₂

LT Environmental, Inc.
4600 West 60th Avenue
Arvada CO, 80003

Project: KMG - Edstrom 24-8 #1

Project Number: KMG 08390
Project Manager: John Cocroft

Reported:
01/28/13 14:22

MW07
R301148-07 (Water)

Summit Scientific

Volatile Organic Compounds by EPA Method 8260B

Date Sampled: 01/23/13 12:30

Analyte	Result	Reporting Limit	Units	Dilution	Batch	Prepared	Analyzed	Method	Notes
Benzene	ND	1.0	ug/l	1	3012405	01/24/13	01/26/13	EPA 8260B	
Toluene	ND	1.0	"	"	"	"	"	"	
Ethylbenzene	ND	1.0	"	"	"	"	"	"	
Xylenes (total)	ND	1.0	"	"	"	"	"	"	

Date Sampled: 01/23/13 12:30

Analyte	Result	Reporting Limit	Units	Dilution	Batch	Prepared	Analyzed	Method	Notes
Surrogate: 1,2-Dichloroethane-d4		101 %	37-154		"	"	"	"	
Surrogate: Toluene-d8		98.6 %	45-149		"	"	"	"	
Surrogate: 4-Bromofluorobenzene		103 %	45-146		"	"	"	"	

Summit Scientific

The results in this report apply to the samples analyzed in accordance with the chain of custody document. This analytical report must be reproduced in its entirety.

S₂

LT Environmental, Inc.
4600 West 60th Avenue
Arvada CO, 80003

Project: KMG - Edstrom 24-8 #1

Project Number: KMG 08390
Project Manager: John Cocroft

Reported:
01/28/13 14:22

Volatile Organic Compounds by EPA Method 8260B - Quality Control
Summit Scientific

Analyte	Reporting			Spike	Source		%REC		RPD	
	Result	Limit	Units	Level	Result	%REC	Limits	RPD	Limit	Notes

Batch 3012405 - EPA 5030 Water MS

Blank (3012405-BLK1)

Prepared & Analyzed: 01/24/13

Benzene	ND	1.0	ug/l							
Toluene	ND	1.0	"							
Ethylbenzene	ND	1.0	"							
Xylenes (total)	ND	1.0	"							
Surrogate: 1,2-Dichloroethane-d4	12.3		"	13.2		92.8	37-154			
Surrogate: Toluene-d8	12.9		"	13.3		97.1	45-149			
Surrogate: 4-Bromofluorobenzene	13.8		"	13.3		104	45-146			

Blank (3012405-BLK2)

Prepared & Analyzed: 01/24/13

Benzene	ND	1.0	ug/l							
Toluene	ND	1.0	"							
Ethylbenzene	ND	1.0	"							
Xylenes (total)	ND	1.0	"							
Surrogate: 1,2-Dichloroethane-d4	12.5		"	13.2		94.2	37-154			
Surrogate: Toluene-d8	13.2		"	13.3		98.6	45-149			
Surrogate: 4-Bromofluorobenzene	13.0		"	13.3		97.8	45-146			

LCS (3012405-BS1)

Prepared & Analyzed: 01/24/13

Benzene	27.6	1.0	ug/l	33.3		83.0	51-132			
Toluene	27.1	1.0	"	33.3		81.4	51-138			
Ethylbenzene	28.8	1.0	"	33.3		86.5	58-146			
m,p-Xylene	58.0	2.0	"	66.7		86.9	57-144			
o-Xylene	28.8	1.0	"	33.3		86.6	53-146			
Surrogate: 1,2-Dichloroethane-d4	12.4		"	13.2		93.5	37-154			
Surrogate: Toluene-d8	13.0		"	13.3		97.7	45-149			
Surrogate: 4-Bromofluorobenzene	13.0		"	13.3		97.4	45-146			

LCS (3012405-BS2)

Prepared & Analyzed: 01/24/13

Benzene	27.8	1.0	ug/l	33.3		83.6	51-132			
Toluene	27.4	1.0	"	33.3		82.4	51-138			
Ethylbenzene	28.9	1.0	"	33.3		86.6	58-146			
m,p-Xylene	58.7	2.0	"	66.7		88.0	57-144			
o-Xylene	29.0	1.0	"	33.3		86.9	53-146			
Surrogate: 1,2-Dichloroethane-d4	12.8		"	13.2		96.8	37-154			
Surrogate: Toluene-d8	13.0		"	13.3		97.4	45-149			
Surrogate: 4-Bromofluorobenzene	13.2		"	13.3		99.1	45-146			

Summit Scientific

The results in this report apply to the samples analyzed in accordance with the chain of custody document. This analytical report must be reproduced in its entirety.



S₂

LT Environmental, Inc.
4600 West 60th Avenue
Arvada CO, 80003

Project: KMG - Edstrom 24-8 #1

Project Number: KMG 08390
Project Manager: John Cocroft

Reported:
01/28/13 14:22

Volatile Organic Compounds by EPA Method 8260B - Quality Control
Summit Scientific

Analyte	Reporting			Spike		Source		%REC		RPD	
	Result	Limit	Units	Level		Result	%REC	Limits	RPD	Limit	Notes

Batch 3012405 - EPA 5030 Water MS

LCS Dup (3012405-BSD1)

Prepared & Analyzed: 01/24/13

Benzene	27.2	1.0	ug/l	33.3		81.8	51-132	1.46	17	
Toluene	26.6	1.0	"	33.3		79.8	51-138	1.97	17	
Ethylbenzene	28.0	1.0	"	33.3		83.9	58-146	3.03	16	
m,p-Xylene	57.0	2.0	"	66.7		85.5	57-144	1.69	16	
o-Xylene	28.3	1.0	"	33.3		84.8	53-146	2.03	15	
Surrogate: 1,2-Dichloroethane-d4	13.0		"	13.2		98.5	37-154			
Surrogate: Toluene-d8	13.2		"	13.3		99.0	45-149			
Surrogate: 4-Bromofluorobenzene	13.0		"	13.3		97.1	45-146			

LCS Dup (3012405-BSD2)

Prepared & Analyzed: 01/24/13

Benzene	32.2	1.0	ug/l	33.3		96.6	51-132	14.5	17	
Toluene	31.5	1.0	"	33.3		94.5	51-138	13.7	17	
Ethylbenzene	33.8	1.0	"	33.3		102	58-146	15.9	16	
m,p-Xylene	68.2	2.0	"	66.7		102	57-144	15.0	16	
o-Xylene	33.6	1.0	"	33.3		101	53-146	14.7	15	
Surrogate: 1,2-Dichloroethane-d4	12.6		"	13.2		95.4	37-154			
Surrogate: Toluene-d8	12.9		"	13.3		96.9	45-149			
Surrogate: 4-Bromofluorobenzene	13.6		"	13.3		102	45-146			

Matrix Spike (3012405-MS1)

Source: R301129-01

Prepared & Analyzed: 01/24/13

Benzene	31.0	1.0	ug/l	33.3	13.5	52.6	34-141			
Toluene	30.2	1.0	"	33.3	ND	90.7	27-151			
Ethylbenzene	32.3	1.0	"	33.3	1.78	91.7	29-160			
m,p-Xylene	65.2	2.0	"	66.7	3.10	93.1	20-166			
o-Xylene	32.0	1.0	"	33.3	ND	96.0	33-159			
Surrogate: 1,2-Dichloroethane-d4	12.7		"	13.2		96.2	37-154			
Surrogate: Toluene-d8	12.9		"	13.3		96.5	45-149			
Surrogate: 4-Bromofluorobenzene	13.4		"	13.3		100	45-146			

Summit Scientific

The results in this report apply to the samples analyzed in accordance with the chain of custody document. This analytical report must be reproduced in its entirety.



S₂

LT Environmental, Inc.
4600 West 60th Avenue
Arvada CO, 80003

Project: KMG - Edstrom 24-8 #1

Project Number: KMG 08390
Project Manager: John Cocroft

Reported:
01/28/13 14:22

Volatile Organic Compounds by EPA Method 8260B - Quality Control
Summit Scientific

Analyte	Reporting			Spike	Source	%REC		RPD		
	Result	Limit	Units	Level	Result	%REC	Limits	RPD	Limit	Notes

Batch 3012405 - EPA 5030 Water MS

Matrix Spike (3012405-MS2)		Source: R301129-02			Prepared: 01/24/13		Analyzed: 01/25/13			
Benzene	28.0	1.0	ug/l	33.3	9.55	55.5	34-141			
Toluene	27.3	1.0	"	33.3	ND	81.9	27-151			
Ethylbenzene	29.1	1.0	"	33.3	ND	87.3	29-160			
m,p-Xylene	58.8	2.0	"	66.7	2.56	84.3	20-166			
o-Xylene	28.8	1.0	"	33.3	1.69	81.4	33-159			
Surrogate: 1,2-Dichloroethane-d4	12.7		"	13.2		95.7	37-154			
Surrogate: Toluene-d8	13.1		"	13.3		98.3	45-149			
Surrogate: 4-Bromofluorobenzene	13.2		"	13.3		99.1	45-146			
Matrix Spike Dup (3012405-MSD1)		Source: R301129-01			Prepared & Analyzed: 01/24/13					
Benzene	29.6	1.0	ug/l	33.3	13.5	48.4	34-141	4.58	32	
Toluene	29.0	1.0	"	33.3	ND	87.1	27-151	4.02	25	
Ethylbenzene	30.5	1.0	"	33.3	1.78	86.1	29-160	5.86	50	
m,p-Xylene	61.9	2.0	"	66.7	3.10	88.2	20-166	5.16	36	
o-Xylene	30.6	1.0	"	33.3	ND	91.8	33-159	4.47	26	
Surrogate: 1,2-Dichloroethane-d4	12.8		"	13.2		96.6	37-154			
Surrogate: Toluene-d8	13.5		"	13.3		101	45-149			
Surrogate: 4-Bromofluorobenzene	12.9		"	13.3		96.8	45-146			
Matrix Spike Dup (3012405-MSD2)		Source: R301129-02			Prepared: 01/24/13		Analyzed: 01/25/13			
Benzene	32.4	1.0	ug/l	33.3	9.55	68.6	34-141	14.5	32	
Toluene	31.8	1.0	"	33.3	ND	95.5	27-151	15.3	25	
Ethylbenzene	33.3	1.0	"	33.3	ND	100	29-160	13.5	50	
m,p-Xylene	67.9	2.0	"	66.7	2.56	98.0	20-166	14.5	36	
o-Xylene	33.0	1.0	"	33.3	1.69	93.8	33-159	13.4	26	
Surrogate: 1,2-Dichloroethane-d4	13.2		"	13.2		99.6	37-154			
Surrogate: Toluene-d8	13.5		"	13.3		102	45-149			
Surrogate: 4-Bromofluorobenzene	13.2		"	13.3		99.1	45-146			

Summit Scientific

The results in this report apply to the samples analyzed in accordance with the chain of custody document. This analytical report must be reproduced in its entirety.



S₂

LT Environmental, Inc.
4600 West 60th Avenue
Arvada CO, 80003

Project: KMG - Edstrom 24-8 #1

Project Number: KMG 08390
Project Manager: John Cocroft

Reported:
01/28/13 14:22

Notes and Definitions

DET Analyte DETECTED
ND Analyte NOT DETECTED at or above the reporting limit
NR Not Reported
dry Sample results reported on a dry weight basis
RPD Relative Percent Difference

Summit Scientific

The results in this report apply to the samples analyzed in accordance with the chain of custody document. This analytical report must be reproduced in its entirety.



Summit Scientific

741 Corporate Circle – Suite I ♦ Golden, Colorado 80401

303.277.9310 - laboratory ♦ 303.277.9531 - fax

October 18, 2012

John Cocroft
LT Environmental, Inc.
4600 West 60th Avenue
Arvada, CO 80003
RE: KMG - Edstrom 24-8 #1

Enclosed are the results of analyses for samples received by Summit Scientific on 10/12/12 16:15. If you have any questions concerning this report, please feel free to contact me.

Sincerely,

A handwritten signature in black ink, appearing to read "Joseph J. Egry IV". The signature is fluid and cursive, with a horizontal line extending from the end.

Joseph J Egry IV
Laboratory Director

S₂

LT Environmental, Inc.
4600 West 60th Avenue
Arvada CO, 80003

Project: KMG - Edstrom 24-8 #1

Project Number: KMG 08390
Project Manager: John Cocroft

Reported:
10/18/12 14:51

ANALYTICAL REPORT FOR SAMPLES

Sample ID	Laboratory ID	Matrix	Date Sampled	Date Received
MW01	R210130-01	Water	10/12/12 15:00	10/12/12 16:15
MW02	R210130-02	Water	10/12/12 14:55	10/12/12 16:15
MW03	R210130-03	Water	10/12/12 14:50	10/12/12 16:15
MW04	R210130-04	Water	10/12/12 14:45	10/12/12 16:15
MW06	R210130-06	Water	10/12/12 14:40	10/12/12 16:15
MW07	R210130-07	Water	10/12/12 14:35	10/12/12 16:15

Summit Scientific

The results in this report apply to the samples analyzed in accordance with the chain of custody document. This analytical report must be reproduced in its entirety.

S₂

LT Environmental, Inc.
4600 West 60th Avenue
Arvada CO, 80003

Project: KMG - Edstrom 24-8 #1

Project Number: KMG 08390
Project Manager: John Cocroft

Reported:
10/18/12 14:51

Page 1 of 1

R210130
Summit Scientific

741 Corporate Circle - Suite 1
Golden, Colorado 80401
303-277-9110 - 303-574-9933 Fax

Client: LT Environmental, Inc.		Project Manager: John Cocroft		Project Number: KMG 0839					
Project: KMG - Edstrom 24-8 #1									
Number	Sample Identification	Matrix	Type	Sample Date	Sample Time	Sampled By	Container	Qty	Analytes
01-001	NTH01	Water	Field Sample	10/12/12	1500	JD	16-164 - RC	3	02000 HPLC_11111
02-001	NTH02	Water	Field Sample		1455		16-164 - RC	3	02000 HPLC_11111
03-001	NTH03	Water	Field Sample		1450		16-164 - RC	3	02000 HPLC_11111
04-001	NTH04	Water	Field Sample		1445	✓	16-164 - RC	3	02000 HPLC_11111
05-001	NTH05	Water	Field Sample		-	-	16-164 - RC	3	02000 HPLC_11111
06-001	NTH06	Water	Field Sample	10/12/12	1440	JD	16-164 - RC	3	02000 HPLC_11111
07-001	NTH07	Water	Field Sample		1435	✓	16-164 - RC	3	02000 HPLC_11111

Turn Around Time (Chart)

See Day
71 hours
24 hours
48 hours

Sample Integrity:

Temperature
Seal Int. 16

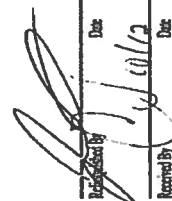
Received By:  Date: 10/12/12 16:15

Relinquished By: _____ Date: _____

Received By: _____ Date: _____

Summit Scientific



The results in this report apply to the samples analyzed in accordance with the chain of custody document. This analytical report must be reproduced in its entirety.

S₂

LT Environmental, Inc.
4600 West 60th Avenue
Arvada CO, 80003

Project: KMG - Edstrom 24-8 #1

Project Number: KMG 08390
Project Manager: John Cocroft

Reported:
10/18/12 14:51

MW01
R210130-01 (Water)

Summit Scientific

Volatile Organic Compounds by EPA Method 8260B

Date Sampled: 10/12/12 15:00

Analyte	Result	Reporting		Units	Dilution	Batch	Prepared	Analyzed	Method	Notes
		Limit								
Benzene	ND	1.0		ug/l	1	2101708	10/17/12	10/18/12	EPA 8260B	
Toluene	ND	1.0		"	"	"	"	"	"	
Ethylbenzene	ND	1.0		"	"	"	"	"	"	
Xylenes (total)	ND	1.0		"	"	"	"	"	"	

Date Sampled: 10/12/12 15:00

Analyte	Result	Reporting		Units	Dilution	Batch	Prepared	Analyzed	Method	Notes
		Limit								
Surrogate: 1,2-Dichloroethane-d4		96.7 %		49.7-150		"	"	"	"	
Surrogate: Toluene-d8		97.1 %		51-150		"	"	"	"	
Surrogate: 4-Bromofluorobenzene		97.0 %		50.1-150		"	"	"	"	

Summit Scientific

The results in this report apply to the samples analyzed in accordance with the chain of custody document. This analytical report must be reproduced in its entirety.

S₂

LT Environmental, Inc.
4600 West 60th Avenue
Arvada CO, 80003

Project: KMG - Edstrom 24-8 #1

Project Number: KMG 08390
Project Manager: John Cocroft

Reported:
10/18/12 14:51

MW02
R210130-02 (Water)

Summit Scientific

Volatile Organic Compounds by EPA Method 8260B

Date Sampled: 10/12/12 14:55

Analyte	Result	Reporting		Dilution	Batch	Prepared	Analyzed	Method	Notes
		Limit	Units						
Benzene	1.9	1.0	ug/l	1	2101708	10/17/12	10/18/12	EPA 8260B	
Toluene	ND	1.0	"	"	"	"	"	"	
Ethylbenzene	ND	1.0	"	"	"	"	"	"	
Xylenes (total)	ND	1.0	"	"	"	"	"	"	

Date Sampled: 10/12/12 14:55

Analyte	Result	Reporting		Dilution	Batch	Prepared	Analyzed	Method	Notes
		Limit	Units						
Surrogate: 1,2-Dichloroethane-d4		94.1 %	49.7-150		"	"	"	"	
Surrogate: Toluene-d8		98.0 %	51-150		"	"	"	"	
Surrogate: 4-Bromofluorobenzene		98.7 %	50.1-150		"	"	"	"	

Summit Scientific

The results in this report apply to the samples analyzed in accordance with the chain of custody document. This analytical report must be reproduced in its entirety.

S₂

LT Environmental, Inc.
4600 West 60th Avenue
Arvada CO, 80003

Project: KMG - Edstrom 24-8 #1

Project Number: KMG 08390
Project Manager: John Cocroft

Reported:
10/18/12 14:51

MW03
R210130-03 (Water)

Summit Scientific

Volatile Organic Compounds by EPA Method 8260B

Date Sampled: 10/12/12 14:50

Analyte	Result	Reporting		Units	Dilution	Batch	Prepared	Analyzed	Method	Notes
		Limit								
Benzene	ND	1.0		ug/l	1	2101708	10/17/12	10/18/12	EPA 8260B	
Toluene	ND	1.0		"	"	"	"	"	"	
Ethylbenzene	ND	1.0		"	"	"	"	"	"	
Xylenes (total)	ND	1.0		"	"	"	"	"	"	

Date Sampled: 10/12/12 14:50

Analyte	Result	Reporting		Units	Dilution	Batch	Prepared	Analyzed	Method	Notes
		Limit								
Surrogate: 1,2-Dichloroethane-d4		96.3 %		49.7-150		"	"	"	"	
Surrogate: Toluene-d8		96.5 %		51-150		"	"	"	"	
Surrogate: 4-Bromofluorobenzene		86.2 %		50.1-150		"	"	"	"	

Summit Scientific

The results in this report apply to the samples analyzed in accordance with the chain of custody document. This analytical report must be reproduced in its entirety.

S₂

LT Environmental, Inc.
4600 West 60th Avenue
Arvada CO, 80003

Project: KMG - Edstrom 24-8 #1

Project Number: KMG 08390
Project Manager: John Cocroft

Reported:
10/18/12 14:51

MW04
R210130-04 (Water)

Summit Scientific

Volatile Organic Compounds by EPA Method 8260B

Date Sampled: 10/12/12 14:45

Analyte	Result	Reporting		Units	Dilution	Batch	Prepared	Analyzed	Method	Notes
		Limit								
Benzene	ND	1.0		ug/l	1	2101708	10/17/12	10/18/12	EPA 8260B	
Toluene	ND	1.0		"	"	"	"	"	"	
Ethylbenzene	ND	1.0		"	"	"	"	"	"	
Xylenes (total)	ND	1.0		"	"	"	"	"	"	

Date Sampled: 10/12/12 14:45

Analyte	Result	Reporting		Units	Dilution	Batch	Prepared	Analyzed	Method	Notes
		Limit								
Surrogate: 1,2-Dichloroethane-d4		95.5 %		49.7-150		"	"	"	"	
Surrogate: Toluene-d8		95.3 %		51-150		"	"	"	"	
Surrogate: 4-Bromofluorobenzene		103 %		50.1-150		"	"	"	"	

Summit Scientific

The results in this report apply to the samples analyzed in accordance with the chain of custody document. This analytical report must be reproduced in its entirety.

S₂

LT Environmental, Inc.
4600 West 60th Avenue
Arvada CO, 80003

Project: KMG - Edstrom 24-8 #1

Project Number: KMG 08390
Project Manager: John Cocroft

Reported:
10/18/12 14:51

MW06
R210130-06 (Water)

Summit Scientific

Volatile Organic Compounds by EPA Method 8260B

Date Sampled: 10/12/12 14:40

Analyte	Result	Reporting		Units	Dilution	Batch	Prepared	Analyzed	Method	Notes
		Limit								
Benzene	ND	1.0		ug/l	1	2101708	10/17/12	10/18/12	EPA 8260B	
Toluene	ND	1.0		"	"	"	"	"	"	
Ethylbenzene	ND	1.0		"	"	"	"	"	"	
Xylenes (total)	ND	1.0		"	"	"	"	"	"	

Date Sampled: 10/12/12 14:40

Analyte	Result	Reporting		Units	Dilution	Batch	Prepared	Analyzed	Method	Notes
		Limit								
Surrogate: 1,2-Dichloroethane-d4		94.2 %		49.7-150		"	"	"	"	
Surrogate: Toluene-d8		95.0 %		51-150		"	"	"	"	
Surrogate: 4-Bromofluorobenzene		104 %		50.1-150		"	"	"	"	

Summit Scientific

The results in this report apply to the samples analyzed in accordance with the chain of custody document. This analytical report must be reproduced in its entirety.

S₂

LT Environmental, Inc.
4600 West 60th Avenue
Arvada CO, 80003

Project: KMG - Edstrom 24-8 #1

Project Number: KMG 08390
Project Manager: John Cocroft

Reported:
10/18/12 14:51

MW07
R210130-07 (Water)

Summit Scientific

Volatile Organic Compounds by EPA Method 8260B

Date Sampled: 10/12/12 14:35

Analyte	Result	Reporting		Units	Dilution	Batch	Prepared	Analyzed	Method	Notes
		Limit								
Benzene	ND	1.0		ug/l	1	2101708	10/17/12	10/18/12	EPA 8260B	
Toluene	ND	1.0		"	"	"	"	"	"	
Ethylbenzene	ND	1.0		"	"	"	"	"	"	
Xylenes (total)	ND	1.0		"	"	"	"	"	"	

Date Sampled: 10/12/12 14:35

Analyte	Result	Reporting		Units	Dilution	Batch	Prepared	Analyzed	Method	Notes
		Limit								
Surrogate: 1,2-Dichloroethane-d4		97.3 %		49.7-150		"	"	"	"	
Surrogate: Toluene-d8		95.3 %		51-150		"	"	"	"	
Surrogate: 4-Bromofluorobenzene		103 %		50.1-150		"	"	"	"	

Summit Scientific

The results in this report apply to the samples analyzed in accordance with the chain of custody document. This analytical report must be reproduced in its entirety.

S₂

LT Environmental, Inc.
4600 West 60th Avenue
Arvada CO, 80003

Project: KMG - Edstrom 24-8 #1

Project Number: KMG 08390
Project Manager: John Cocroft

Reported:
10/18/12 14:51

Volatile Organic Compounds by EPA Method 8260B - Quality Control
Summit Scientific

Analyte	Reporting			Spike	Source		%REC		RPD	
	Result	Limit	Units	Level	Result	%REC	Limits	RPD	Limit	Notes

Batch 2101708 - EPA 5030 Water MS

Blank (2101708-BLK1)

Prepared & Analyzed: 10/17/12

Benzene	ND	1.0	ug/l							
Toluene	ND	1.0	"							
Ethylbenzene	ND	1.0	"							
Xylenes (total)	ND	1.0	"							
Surrogate: 1,2-Dichloroethane-d4	12.8		"	13.2		96.9	49.7-150			
Surrogate: Toluene-d8	13.0		"	13.3		97.2	51-150			
Surrogate: 4-Bromofluorobenzene	13.8		"	13.3		103	50.1-150			

LCS (2101708-BS1)

Prepared & Analyzed: 10/17/12

Benzene	24.9	1.0	ug/l	33.3		74.7	51-132			
Toluene	25.0	1.0	"	33.3		75.1	51-138			
Ethylbenzene	26.7	1.0	"	33.3		80.1	58-146			
m,p-Xylene	53.8	2.0	"	66.7		80.8	57-144			
o-Xylene	26.5	1.0	"	33.3		79.4	53-146			
Surrogate: 1,2-Dichloroethane-d4	12.8		"	13.2		97.1	49.7-150			
Surrogate: Toluene-d8	13.1		"	13.3		98.5	51-150			
Surrogate: 4-Bromofluorobenzene	13.4		"	13.3		101	50.1-150			

LCS Dup (2101708-BSD1)

Prepared & Analyzed: 10/17/12

Benzene	26.9	1.0	ug/l	33.3		80.8	51-132	7.87	17	
Toluene	27.1	1.0	"	33.3		81.3	51-138	7.94	17	
Ethylbenzene	28.6	1.0	"	33.3		85.9	58-146	6.90	16	
m,p-Xylene	57.9	2.0	"	66.7		86.9	57-144	7.28	16	
o-Xylene	28.2	1.0	"	33.3		84.7	53-146	6.44	15	
Surrogate: 1,2-Dichloroethane-d4	13.2		"	13.2		99.6	49.7-150			
Surrogate: Toluene-d8	13.2		"	13.3		99.4	51-150			
Surrogate: 4-Bromofluorobenzene	13.2		"	13.3		99.4	50.1-150			

Summit Scientific

The results in this report apply to the samples analyzed in accordance with the chain of custody document. This analytical report must be reproduced in its entirety.

Page 9 of 11

S₂

LT Environmental, Inc.
4600 West 60th Avenue
Arvada CO, 80003

Project: KMG - Edstrom 24-8 #1

Project Number: KMG 08390
Project Manager: John Cocroft

Reported:
10/18/12 14:51

Volatile Organic Compounds by EPA Method 8260B - Quality Control
Summit Scientific

Analyte	Reporting			Spike	Source	%REC		RPD	
	Result	Limit	Units	Level	Result	%REC	Limits	RPD	Limit

Batch 2101708 - EPA 5030 Water MS

Matrix Spike (2101708-MS1)		Source: R210128-04			Prepared & Analyzed: 10/17/12				
Benzene	26.9	1.0	ug/l	33.3	ND	80.6	34-141		
Toluene	27.0	1.0	"	33.3	ND	81.1	27-151		
Ethylbenzene	28.8	1.0	"	33.3	ND	86.4	29-160		
m,p-Xylene	58.8	2.0	"	66.7	ND	88.2	20-166		
o-Xylene	28.5	1.0	"	33.3	ND	85.4	33-159		
Surrogate: 1,2-Dichloroethane-d4	13.1		"	13.2		98.7	49.7-150		
Surrogate: Toluene-d8	13.2		"	13.3		99.3	51-150		
Surrogate: 4-Bromofluorobenzene	13.0		"	13.3		97.4	50.1-150		
Matrix Spike Dup (2101708-MSD1)		Source: R210128-04			Prepared & Analyzed: 10/17/12				
Benzene	26.4	1.0	ug/l	33.3	ND	79.1	34-141	1.88	32
Toluene	26.5	1.0	"	33.3	ND	79.5	27-151	2.02	25
Ethylbenzene	28.5	1.0	"	33.3	ND	85.4	29-160	1.12	50
m,p-Xylene	58.0	2.0	"	66.7	ND	87.0	20-166	1.42	36
o-Xylene	27.9	1.0	"	33.3	ND	83.6	33-159	2.09	26
Surrogate: 1,2-Dichloroethane-d4	12.4		"	13.2		93.9	49.7-150		
Surrogate: Toluene-d8	13.2		"	13.3		99.0	51-150		
Surrogate: 4-Bromofluorobenzene	13.2		"	13.3		99.2	50.1-150		

Summit Scientific

The results in this report apply to the samples analyzed in accordance with the chain of custody document. This analytical report must be reproduced in its entirety.



S₂

LT Environmental, Inc.
4600 West 60th Avenue
Arvada CO, 80003

Project: KMG - Edstrom 24-8 #1

Project Number: KMG 08390
Project Manager: John Cocroft

Reported:
10/18/12 14:51

Notes and Definitions

DET Analyte DETECTED
ND Analyte NOT DETECTED at or above the reporting limit
NR Not Reported
dry Sample results reported on a dry weight basis
RPD Relative Percent Difference



Summit Scientific

741 Corporate Circle – Suite I ♦ Golden, Colorado 80401

303.277.9310 - laboratory ♦ 303.277.9531 - fax

July 19, 2012

John Cocroft
LT Environmental, Inc.
4600 West 60th Avenue
Arvada, CO 80003
RE: KMG - Edstrom 24-8 #1

Enclosed are the results of analyses for samples received by Summit Scientific on 07/10/12 15:45. If you have any questions concerning this report, please feel free to contact me.

Sincerely,



Paul Shrewsbury For Ben Shrewsbury
President / Laboratory Director

S₂

LT Environmental, Inc.
4600 West 60th Avenue
Arvada CO, 80003

Project: KMG - Edstrom 24-8 #1

Project Number: KMG 08390
Project Manager: John Cocroft

Reported:
07/19/12 13:56

ANALYTICAL REPORT FOR SAMPLES

Sample ID	Laboratory ID	Matrix	Date Sampled	Date Received
MW01	R207112-01	Water	07/10/12 14:30	07/10/12 15:45
MW02	R207112-02	Water	07/10/12 14:25	07/10/12 15:45
MW03	R207112-03	Water	07/10/12 14:20	07/10/12 15:45
MW04	R207112-04	Water	07/10/12 14:15	07/10/12 15:45
MW06	R207112-06	Water	07/10/12 14:10	07/10/12 15:45
MW07	R207112-07	Water	07/10/12 14:05	07/10/12 15:45

Summit Scientific

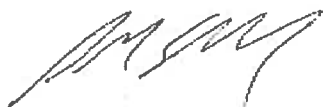

The results in this report apply to the samples analyzed in accordance with the chain of custody document. This analytical report must be reproduced in its entirety.

S₂

LT Environmental, Inc.
4600 West 60th Avenue
Arvada CO, 80003

Project: KMG - Edstrom 24-8 #1

Project Number: KMG 08390
Project Manager: John Cocroft

Reported:
07/19/12 13:56

Page 1 of 1

R207112

Summit Scientific

341 Corporate Circle - Suite 1
Golden, Colorado 80601
303-277-8310 - 303-374-5033 Fax

Project Manager: John Cocroft
Project Number: KMG 08390

Client: LT Environmental, Inc.
Project: KMG - Edstrom 24-8 #1

Number	Sample Identification	Matrix	Type	Sample Date	Sample Time	Supplied By	Container	Qty	Analysis
01-001	MTW01	Water	Field Sample	7/19/12	1430	JD	Van Vels - HCT	3	EDM08TES, TTVL
02-001	MTW02	Water	Field Sample		1425		Van Vels - HCT	3	EDM08TES, TTVL
03-001	MTW03	Water	Field Sample		1420		Van Vels - HCT	3	EDM08TES, TTVL
04-001	MTW04	Water	Field Sample		1415		Van Vels - HCT	3	EDM08TES, TTVL
05-001	MTW05	Water	Field Sample		-		Van Vels - HCT	3	EDM08TES, TTVL
06-001	MTW06	Water	Field Sample		1410	JD	Van Vels - HCT	3	EDM08TES, TTVL
07-001	MTW07	Water	Field Sample		1405		Van Vels - HCT	3	EDM08TES, TTVL

Terra Aerial Time (Clock)
Sunrise ☐ 7:00am
Sunset ☐ 8:00am
Sample Integrity: 5.7
Inspector Signature: [Signature]
Date: 7/19/12

Relinquished By: [Signature] Date/Time: 7/19/12 13:56
Received By: [Signature] Date/Time: 7/19/12 13:56

Prepared By: [Signature] Date/Time: 7/19/12
Received By: [Signature] Date/Time: 7/19/12

Summit Scientific



The results in this report apply to the samples analyzed in accordance with the chain of custody document. This analytical report must be reproduced in its entirety.

S₂

LT Environmental, Inc.
4600 West 60th Avenue
Arvada CO, 80003

Project: KMG - Edstrom 24-8 #1

Project Number: KMG 08390
Project Manager: John Cocroft

Reported:
07/19/12 13:56

MW01
R207112-01 (Water)

Summit Scientific

Volatile Organic Compounds by EPA Method 8260B

Date Sampled: 07/10/12 14:30

Analyte	Result	Reporting Limit	Units	Dilution	Batch	Prepared	Analyzed	Method	Notes
Benzene	ND	1.0	ug/l	1	2071611	07/16/12	07/17/12	EPA 8260B	
Toluene	ND	1.0	"	"	"	"	"	"	
Ethylbenzene	ND	1.0	"	"	"	"	"	"	
Xylenes (total)	ND	1.0	"	"	"	"	"	"	

Date Sampled: 07/10/12 14:30

Analyte	Result	Reporting Limit	Units	Dilution	Batch	Prepared	Analyzed	Method	Notes
Surrogate: 1,2-Dichloroethane-d4		89.4 %	49.7-150		"	"	"	"	
Surrogate: Toluene-d8		101 %	51-150		"	"	"	"	
Surrogate: 4-Bromofluorobenzene		100 %	50.1-150		"	"	"	"	

Summit Scientific

The results in this report apply to the samples analyzed in accordance with the chain of custody document. This analytical report must be reproduced in its entirety.



S₂

LT Environmental, Inc.
4600 West 60th Avenue
Arvada CO, 80003

Project: KMG - Edstrom 24-8 #1

Project Number: KMG 08390
Project Manager: John Cocroft

Reported:
07/19/12 13:56

MW02
R207112-02 (Water)

Summit Scientific

Volatile Organic Compounds by EPA Method 8260B

Date Sampled: 07/10/12 14:25

Analyte	Result	Reporting Limit	Units	Dilution	Batch	Prepared	Analyzed	Method	Notes
Benzene	ND	1.0	ug/l	1	2071611	07/16/12	07/17/12	EPA 8260B	
Toluene	ND	1.0	"	"	"	"	"	"	
Ethylbenzene	ND	1.0	"	"	"	"	"	"	
Xylenes (total)	ND	1.0	"	"	"	"	"	"	

Date Sampled: 07/10/12 14:25

Analyte	Result	Reporting Limit	Units	Dilution	Batch	Prepared	Analyzed	Method	Notes
Surrogate: 1,2-Dichloroethane-d4		87.0 %	49.7-150		"	"	"	"	
Surrogate: Toluene-d8		99.0 %	51-150		"	"	"	"	
Surrogate: 4-Bromofluorobenzene		95.8 %	50.1-150		"	"	"	"	

Summit Scientific

The results in this report apply to the samples analyzed in accordance with the chain of custody document. This analytical report must be reproduced in its entirety.

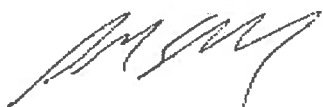

S₂

LT Environmental, Inc.
4600 West 60th Avenue
Arvada CO, 80003

Project: KMG - Edstrom 24-8 #1

Project Number: KMG 08390
Project Manager: John Cocroft

Reported:
07/19/12 13:56

MW03
R207112-03 (Water)

Summit Scientific

Volatile Organic Compounds by EPA Method 8260B

Date Sampled: 07/10/12 14:20

Analyte	Result	Reporting Limit	Units	Dilution	Batch	Prepared	Analyzed	Method	Notes
Benzene	1.5	1.0	ug/l	1	2071611	07/16/12	07/17/12	EPA 8260B	
Toluene	ND	1.0	"	"	"	"	"	"	
Ethylbenzene	1.5	1.0	"	"	"	"	"	"	
Xylenes (total)	ND	1.0	"	"	"	"	"	"	

Date Sampled: 07/10/12 14:20

Analyte	Result	Reporting Limit	Units	Dilution	Batch	Prepared	Analyzed	Method	Notes
Surrogate: 1,2-Dichloroethane-d4		95.8 %	49.7-150		"	"	"	"	
Surrogate: Toluene-d8		100 %	51-150		"	"	"	"	
Surrogate: 4-Bromofluorobenzene		92.2 %	50.1-150		"	"	"	"	

Summit Scientific

The results in this report apply to the samples analyzed in accordance with the chain of custody document. This analytical report must be reproduced in its entirety.



S₂

LT Environmental, Inc.
4600 West 60th Avenue
Arvada CO, 80003

Project: KMG - Edstrom 24-8 #1

Project Number: KMG 08390
Project Manager: John Cocroft

Reported:
07/19/12 13:56

MW04
R207112-04 (Water)

Summit Scientific

Volatile Organic Compounds by EPA Method 8260B

Date Sampled: 07/10/12 14:15

Analyte	Result	Reporting Limit	Units	Dilution	Batch	Prepared	Analyzed	Method	Notes
Benzene	ND	1.0	ug/l	1	2071611	07/16/12	07/18/12	EPA 8260B	
Toluene	ND	1.0	"	"	"	"	"	"	
Ethylbenzene	ND	1.0	"	"	"	"	"	"	
Xylenes (total)	ND	1.0	"	"	"	"	"	"	

Date Sampled: 07/10/12 14:15

Analyte	Result	Reporting Limit	Units	Dilution	Batch	Prepared	Analyzed	Method	Notes
Surrogate: 1,2-Dichloroethane-d4		82.7 %	49.7-150		"	"	"	"	
Surrogate: Toluene-d8		101 %	51-150		"	"	"	"	
Surrogate: 4-Bromofluorobenzene		104 %	50.1-150		"	"	"	"	

Summit Scientific

The results in this report apply to the samples analyzed in accordance with the chain of custody document. This analytical report must be reproduced in its entirety.



S₂

LT Environmental, Inc.
4600 West 60th Avenue
Arvada CO, 80003

Project: KMG - Edstrom 24-8 #1

Project Number: KMG 08390
Project Manager: John Cocroft

Reported:
07/19/12 13:56

MW06
R207112-06 (Water)

Summit Scientific

Volatile Organic Compounds by EPA Method 8260B

Date Sampled: 07/10/12 14:10

Analyte	Result	Reporting Limit	Units	Dilution	Batch	Prepared	Analyzed	Method	Notes
Benzene	ND	1.0	ug/l	1	2071611	07/16/12	07/18/12	EPA 8260B	
Toluene	ND	1.0	"	"	"	"	"	"	
Ethylbenzene	ND	1.0	"	"	"	"	"	"	
Xylenes (total)	ND	1.0	"	"	"	"	"	"	

Date Sampled: 07/10/12 14:10

Analyte	Result	Reporting Limit	Units	Dilution	Batch	Prepared	Analyzed	Method	Notes
Surrogate: 1,2-Dichloroethane-d4		82.8 %	49.7-150		"	"	"	"	
Surrogate: Toluene-d8		99.8 %	51-150		"	"	"	"	
Surrogate: 4-Bromofluorobenzene		98.9 %	50.1-150		"	"	"	"	

Summit Scientific

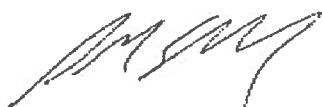

The results in this report apply to the samples analyzed in accordance with the chain of custody document. This analytical report must be reproduced in its entirety.

S₂

LT Environmental, Inc.
4600 West 60th Avenue
Arvada CO, 80003

Project: KMG - Edstrom 24-8 #1

Project Number: KMG 08390
Project Manager: John Cocroft

Reported:
07/19/12 13:56

MW07
R207112-07 (Water)

Summit Scientific

Volatile Organic Compounds by EPA Method 8260B

Date Sampled: 07/10/12 14:05

Analyte	Result	Reporting Limit	Units	Dilution	Batch	Prepared	Analyzed	Method	Notes
Benzene	ND	1.0	ug/l	1	2071611	07/16/12	07/18/12	EPA 8260B	
Toluene	ND	1.0	"	"	"	"	"	"	
Ethylbenzene	ND	1.0	"	"	"	"	"	"	
Xylenes (total)	ND	1.0	"	"	"	"	"	"	

Date Sampled: 07/10/12 14:05

Analyte	Result	Reporting Limit	Units	Dilution	Batch	Prepared	Analyzed	Method	Notes
Surrogate: 1,2-Dichloroethane-d4		85.0 %	49.7-150		"	"	"	"	
Surrogate: Toluene-d8		101 %	51-150		"	"	"	"	
Surrogate: 4-Bromofluorobenzene		99.7 %	50.1-150		"	"	"	"	

Summit Scientific

The results in this report apply to the samples analyzed in accordance with the chain of custody document. This analytical report must be reproduced in its entirety.

S₂

LT Environmental, Inc.
4600 West 60th Avenue
Arvada CO, 80003

Project: KMG - Edstrom 24-8 #1

Project Number: KMG 08390
Project Manager: John Cocroft

Reported:
07/19/12 13:56

Volatile Organic Compounds by EPA Method 8260B - Quality Control
Summit Scientific

Analyte	Reporting			Spike	Source		%REC		RPD	
	Result	Limit	Units	Level	Result	%REC	Limits	RPD	Limit	Notes

Batch 2071611 - EPA 5030 Water MS

Blank (2071611-BLK1)

Prepared: 07/16/12 Analyzed: 07/17/12

Benzene	ND	1.0	ug/l							
Toluene	ND	1.0	"							
Ethylbenzene	ND	1.0	"							
Xylenes (total)	ND	1.0	"							
Surrogate: 1,2-Dichloroethane-d4	10.5		"	13.2		79.3	49.7-150			
Surrogate: Toluene-d8	13.2		"	13.3		99.2	51-150			
Surrogate: 4-Bromofluorobenzene	13.2		"	13.3		98.9	50.1-150			

LCS (2071611-BS1)

Prepared: 07/16/12 Analyzed: 07/17/12

Benzene	21.3	1.0	ug/l	33.3		63.9	56.7-114			
Toluene	21.6	1.0	"	33.3		64.9	50.7-130			
Ethylbenzene	24.3	1.0	"	33.3		72.8	54.2-143			
m,p-Xylene	53.0	2.0	"	66.7		79.5	58.3-134			
o-Xylene	23.1	1.0	"	33.3		69.3	57.4-134			
Surrogate: 1,2-Dichloroethane-d4	10.7		"	13.2		80.9	49.7-150			
Surrogate: Toluene-d8	13.2		"	13.3		98.8	51-150			
Surrogate: 4-Bromofluorobenzene	13.2		"	13.3		98.9	50.1-150			

LCS Dup (2071611-BSD1)

Prepared: 07/16/12 Analyzed: 07/17/12

Benzene	23.4	1.0	ug/l	33.3		70.3	56.7-114	9.43	14.6	
Toluene	23.8	1.0	"	33.3		71.3	50.7-130	9.47	18.9	
Ethylbenzene	26.4	1.0	"	33.3		79.3	54.2-143	8.52	11.9	
m,p-Xylene	51.8	2.0	"	66.7		77.6	58.3-134	2.39	13.7	
o-Xylene	25.2	1.0	"	33.3		75.7	57.4-134	8.90	15	
Surrogate: 1,2-Dichloroethane-d4	10.5		"	13.2		79.2	49.7-150			
Surrogate: Toluene-d8	13.5		"	13.3		101	51-150			
Surrogate: 4-Bromofluorobenzene	13.0		"	13.3		97.8	50.1-150			

Summit Scientific

The results in this report apply to the samples analyzed in accordance with the chain of custody document. This analytical report must be reproduced in its entirety.



S₂

LT Environmental, Inc.
4600 West 60th Avenue
Arvada CO, 80003

Project: KMG - Edstrom 24-8 #1

Project Number: KMG 08390
Project Manager: John Cocroft

Reported:
07/19/12 13:56

Volatile Organic Compounds by EPA Method 8260B - Quality Control
Summit Scientific

Analyte	Reporting			Spike	Source	%REC		RPD	
	Result	Limit	Units	Level	Result	%REC	Limits	RPD	Limit

Batch 2071611 - EPA 5030 Water MS

Matrix Spike (2071611-MS1) **Source: R207101-04** Prepared: 07/16/12 Analyzed: 07/17/12

Benzene	23.1	1.0	ug/l	33.3	ND	69.2	33.5-135		
Toluene	23.6	1.0	"	33.3	ND	70.8	30-150		
Ethylbenzene	26.3	1.0	"	33.3	ND	78.9	30-150		
m,p-Xylene	51.3	2.0	"	66.7	ND	77.0	30-150		
o-Xylene	25.0	1.0	"	33.3	ND	75.0	44.8-147		
Surrogate: 1,2-Dichloroethane-d4	10.8		"	13.2		81.5	49.7-150		
Surrogate: Toluene-d8	13.2		"	13.3		99.2	51-150		
Surrogate: 4-Bromofluorobenzene	12.9		"	13.3		96.6	50.1-150		

Matrix Spike Dup (2071611-MSD1) **Source: R207101-04** Prepared: 07/16/12 Analyzed: 07/17/12

Benzene	21.7	1.0	ug/l	33.3	ND	65.2	33.5-135	6.07	21.3
Toluene	22.4	1.0	"	33.3	ND	67.3	30-150	5.09	15.5
Ethylbenzene	24.6	1.0	"	33.3	ND	73.9	30-150	6.56	17.4
m,p-Xylene	48.0	2.0	"	66.7	ND	72.1	30-150	6.60	18.1
o-Xylene	23.6	1.0	"	33.3	ND	70.9	44.8-147	5.63	15
Surrogate: 1,2-Dichloroethane-d4	10.8		"	13.2		82.0	49.7-150		
Surrogate: Toluene-d8	13.3		"	13.3		100	51-150		
Surrogate: 4-Bromofluorobenzene	12.9		"	13.3		96.8	50.1-150		

Summit Scientific

The results in this report apply to the samples analyzed in accordance with the chain of custody document. This analytical report must be reproduced in its entirety.

S₂

LT Environmental, Inc.
4600 West 60th Avenue
Arvada CO, 80003

Project: KMG - Edstrom 24-8 #1

Project Number: KMG 08390
Project Manager: John Cocroft

Reported:
07/19/12 13:56

Notes and Definitions

DET Analyte DETECTED
ND Analyte NOT DETECTED at or above the reporting limit
NR Not Reported
dry Sample results reported on a dry weight basis
RPD Relative Percent Difference

Summit Scientific



The results in this report apply to the samples analyzed in accordance with the chain of custody document. This analytical report must be reproduced in its entirety.

Summit Scientific

741 Corporate Circle – Suite I ♦ Golden, Colorado 80401

303.277.9310 - laboratory ♦ 303.277.9531 - fax

April 20, 2012

John Cocroft
LT Environmental, Inc.
4600 West 60th Avenue
Arvada, CO 80003
RE: KMG - Edstrom 24-8 #1

Enclosed are the results of analyses for samples received by Summit Scientific on 04/12/12 17:00. If you have any questions concerning this report, please feel free to contact me.

Sincerely,



Paul Shrewsbury For Ben Shrewsbury
President / Laboratory Director

S₂

LT Environmental, Inc.
4600 West 60th Avenue
Arvada CO, 80003

Project: KMG - Edstrom 24-8 #1
Project Number: KMG 08390
Project Manager: John Cocroft

Reported:
04/20/12 19:49

ANALYTICAL REPORT FOR SAMPLES

Sample ID	Laboratory ID	Matrix	Date Sampled	Date Received
MW01	R204081-01	Water	04/12/12 14:45	04/12/12 17:00
MW02	R204081-02	Water	04/12/12 14:35	04/12/12 17:00
MW03	R204081-03	Water	04/12/12 14:25	04/12/12 17:00
MW04	R204081-04	Water	04/12/12 14:15	04/12/12 17:00
MW05	R204081-05	Water	04/12/12 14:05	04/12/12 17:00
MW06	R204081-06	Water	04/12/12 13:55	04/12/12 17:00
MW07	R204081-07	Water	04/12/12 13:45	04/12/12 17:00

Summit Scientific

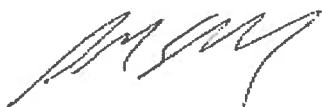

The results in this report apply to the samples analyzed in accordance with the chain of custody document. This analytical report must be reproduced in its entirety.

S₂

LT Environmental, Inc.
4600 West 60th Avenue
Arvada CO, 80003

Project: KMG - Edstrom 24-8 #1

Project Number: KMG 08390
Project Manager: John Cocroft

Reported:
04/20/12 19:49

Page 1 of 1

Revised

Summit Scientific

7411 Corporate Circle - Suite 1
Golden, Colorado 80601
303-277-9310 - 303-574-5933 Fax

Client: LT Environmental, Inc.
Project: KMG - Edstrom 24-8 #1
Project Manager: John Cocroft
Project Number: KMG 08390

Number	Sample Identification	Matrix	Type	Sample Date	Sample Time	Sampled By	Container	Qty	Analysis
01-001	SW001	Water	Field Sample	4/12/12	1445	JJ	Van Veld - HCT	3	EDM08390_TVAL
02-001	SW002	Water	Field Sample		1435		Van Veld - HCT	3	EDM08390_TVAL
03-001	SW003	Water	Field Sample		1425		Van Veld - HCT	3	EDM08390_TVAL
04-001	SW004	Water	Field Sample		1415		Van Veld - HCT	3	EDM08390_TVAL
05-001	SW005	Water	Field Sample		1405		Van Veld - HCT	3	EDM08390_TVAL
06-001	SW006	Water	Field Sample		1355		Van Veld - HCT	3	EDM08390_TVAL
07-001	SW007	Water	Field Sample		1345		Van Veld - HCT	3	EDM08390_TVAL

Time Aboard Time (Check)

Sum Int ☐ 21 Hrs ☒ 24 Hrs
21 Hrs ☐ 24 Hrs

Sample Integrity:
Impassive Open Sample 53
Test (5) No

Refrigerated By _____ Date/Time _____

Received By _____ Date/Time _____

Prepared By John Cocroft Date/Time 4/12/12

Received By John Cocroft Date/Time 4/12/12 17:00

Summit Scientific



The results in this report apply to the samples analyzed in accordance with the chain of custody document. This analytical report must be reproduced in its entirety.

S₂

LT Environmental, Inc.
4600 West 60th Avenue
Arvada CO, 80003

Project: KMG - Edstrom 24-8 #1

Project Number: KMG 08390
Project Manager: John Cocroft

Reported:
04/20/12 19:49

MW01
R204081-01 (Water)

Summit Scientific

Volatile Organic Compounds by EPA Method 8260B

Date Sampled: 04/12/12 14:45

Analyte	Result	Reporting Limit	Units	Dilution	Batch	Prepared	Analyzed	Method	Notes
Benzene	ND	1.0	ug/l	1	2041805	04/18/12	04/20/12	EPA 8260B	
Toluene	ND	1.0	"	"	"	"	"	"	
Ethylbenzene	ND	1.0	"	"	"	"	"	"	
Xylenes (total)	ND	1.0	"	"	"	"	"	"	

Date Sampled: 04/12/12 14:45

Analyte	Result	Reporting Limit	Units	Dilution	Batch	Prepared	Analyzed	Method	Notes
Surrogate: 1,2-Dichloroethane-d4		87.0 %	57.9-139		"	"	"	"	
Surrogate: Toluene-d8		98.0 %	83.1-115		"	"	"	"	
Surrogate: 4-Bromofluorobenzene		112 %	80.8-120		"	"	"	"	

Summit Scientific

The results in this report apply to the samples analyzed in accordance with the chain of custody document. This analytical report must be reproduced in its entirety.

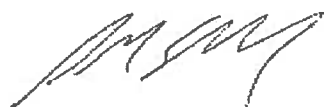

S₂

LT Environmental, Inc.
4600 West 60th Avenue
Arvada CO, 80003

Project: KMG - Edstrom 24-8 #1

Project Number: KMG 08390
Project Manager: John Cocroft

Reported:
04/20/12 19:49

MW02
R204081-02 (Water)

Summit Scientific

Volatile Organic Compounds by EPA Method 8260B

Date Sampled: 04/12/12 14:35

Analyte	Result	Reporting Limit	Units	Dilution	Batch	Prepared	Analyzed	Method	Notes
Benzene	1.9	1.0	ug/l	1	2041805	04/18/12	04/20/12	EPA 8260B	
Toluene	ND	1.0	"	"	"	"	"	"	
Ethylbenzene	ND	1.0	"	"	"	"	"	"	
Xylenes (total)	ND	1.0	"	"	"	"	"	"	

Date Sampled: 04/12/12 14:35

Analyte	Result	Reporting Limit	Units	Dilution	Batch	Prepared	Analyzed	Method	Notes
Surrogate: 1,2-Dichloroethane-d4		103 %	57.9-139		"	"	"	"	
Surrogate: Toluene-d8		98.3 %	83.1-115		"	"	"	"	
Surrogate: 4-Bromofluorobenzene		97.3 %	80.8-120		"	"	"	"	

Summit Scientific

The results in this report apply to the samples analyzed in accordance with the chain of custody document. This analytical report must be reproduced in its entirety.



S₂

LT Environmental, Inc.
4600 West 60th Avenue
Arvada CO, 80003

Project: KMG - Edstrom 24-8 #1
Project Number: KMG 08390
Project Manager: John Cocroft

Reported:
04/20/12 19:49

MW03
R204081-03 (Water)

Summit Scientific

Volatile Organic Compounds by EPA Method 8260B

Date Sampled: 04/12/12 14:25

Analyte	Result	Reporting Limit	Units	Dilution	Batch	Prepared	Analyzed	Method	Notes
Benzene	4.4	1.0	ug/l	1	2041805	04/18/12	04/20/12	EPA 8260B	
Toluene	ND	1.0	"	"	"	"	"	"	
Ethylbenzene	4.5	1.0	"	"	"	"	"	"	
Xylenes (total)	8.1	1.0	"	"	"	"	"	"	

Date Sampled: 04/12/12 14:25

Analyte	Result	Reporting Limit	Units	Dilution	Batch	Prepared	Analyzed	Method	Notes
<i>Surrogate: 1,2-Dichloroethane-d4</i>		<i>83.8 %</i>	<i>57.9-139</i>		<i>"</i>	<i>"</i>	<i>"</i>	<i>"</i>	
<i>Surrogate: Toluene-d8</i>		<i>98.4 %</i>	<i>83.1-115</i>		<i>"</i>	<i>"</i>	<i>"</i>	<i>"</i>	
<i>Surrogate: 4-Bromofluorobenzene</i>		<i>106 %</i>	<i>80.8-120</i>		<i>"</i>	<i>"</i>	<i>"</i>	<i>"</i>	

Summit Scientific

The results in this report apply to the samples analyzed in accordance with the chain of custody document. This analytical report must be reproduced in its entirety.

S₂

LT Environmental, Inc.
4600 West 60th Avenue
Arvada CO, 80003

Project: KMG - Edstrom 24-8 #1
Project Number: KMG 08390
Project Manager: John Cocroft

Reported:
04/20/12 19:49

MW04
R204081-04 (Water)

Summit Scientific

Volatile Organic Compounds by EPA Method 8260B

Date Sampled: 04/12/12 14:15

Analyte	Result	Reporting	Units	Dilution	Batch	Prepared	Analyzed	Method	Notes
		Limit							
Benzene	ND	1.0	ug/l	1	2041805	04/18/12	04/20/12	EPA 8260B	
Toluene	ND	1.0	"	"	"	"	"	"	
Ethylbenzene	ND	1.0	"	"	"	"	"	"	
Xylenes (total)	ND	1.0	"	"	"	"	"	"	

Date Sampled: 04/12/12 14:15

Analyte	Result	Reporting	Units	Dilution	Batch	Prepared	Analyzed	Method	Notes
		Limit							
Surrogate: 1,2-Dichloroethane-d4		104 %	57.9-139		"	"	"	"	
Surrogate: Toluene-d8		98.4 %	83.1-115		"	"	"	"	
Surrogate: 4-Bromofluorobenzene		94.3 %	80.8-120		"	"	"	"	

Summit Scientific

The results in this report apply to the samples analyzed in accordance with the chain of custody document. This analytical report must be reproduced in its entirety.

S₂

LT Environmental, Inc.
4600 West 60th Avenue
Arvada CO, 80003

Project: KMG - Edstrom 24-8 #1
Project Number: KMG 08390
Project Manager: John Cocroft

Reported:
04/20/12 19:49

MW05
R204081-05 (Water)

Summit Scientific

Volatile Organic Compounds by EPA Method 8260B

Date Sampled: 04/12/12 14:05

Analyte	Result	Reporting		Units	Dilution	Batch	Prepared	Analyzed	Method	Notes
		Limit								
Benzene	ND	1.0		ug/l	1	2041805	04/18/12	04/20/12	EPA 8260B	
Toluene	ND	1.0		"	"	"	"	"	"	
Ethylbenzene	ND	1.0		"	"	"	"	"	"	
Xylenes (total)	ND	1.0		"	"	"	"	"	"	

Date Sampled: 04/12/12 14:05

Analyte	Result	Reporting		Units	Dilution	Batch	Prepared	Analyzed	Method	Notes
		Limit								
Surrogate: 1,2-Dichloroethane-d4		105 %		57.9-139		"	"	"	"	
Surrogate: Toluene-d8		99.6 %		83.1-115		"	"	"	"	
Surrogate: 4-Bromofluorobenzene		95.5 %		80.8-120		"	"	"	"	

Summit Scientific

The results in this report apply to the samples analyzed in accordance with the chain of custody document. This analytical report must be reproduced in its entirety.

S₂

LT Environmental, Inc.
4600 West 60th Avenue
Arvada CO, 80003

Project: KMG - Edstrom 24-8 #1

Project Number: KMG 08390
Project Manager: John Cocroft

Reported:
04/20/12 19:49

MW06
R204081-06 (Water)

Summit Scientific

Volatile Organic Compounds by EPA Method 8260B

Date Sampled: 04/12/12 13:55

Analyte	Result	Reporting	Units	Dilution	Batch	Prepared	Analyzed	Method	Notes
		Limit							
Benzene	ND	1.0	ug/l	1	2041805	04/18/12	04/20/12	EPA 8260B	
Toluene	ND	1.0	"	"	"	"	"	"	
Ethylbenzene	ND	1.0	"	"	"	"	"	"	
Xylenes (total)	ND	1.0	"	"	"	"	"	"	

Date Sampled: 04/12/12 13:55

Analyte	Result	Reporting	Units	Dilution	Batch	Prepared	Analyzed	Method	Notes
		Limit							
Surrogate: 1,2-Dichloroethane-d4		104 %	57.9-139		"	"	"	"	
Surrogate: Toluene-d8		98.0 %	83.1-115		"	"	"	"	
Surrogate: 4-Bromofluorobenzene		95.8 %	80.8-120		"	"	"	"	

Summit Scientific

The results in this report apply to the samples analyzed in accordance with the chain of custody document. This analytical report must be reproduced in its entirety.

S₂

LT Environmental, Inc.
4600 West 60th Avenue
Arvada CO, 80003

Project: KMG - Edstrom 24-8 #1

Project Number: KMG 08390
Project Manager: John Cocroft

Reported:
04/20/12 19:49

MW07
R204081-07 (Water)

Summit Scientific

Volatile Organic Compounds by EPA Method 8260B

Date Sampled: 04/12/12 13:45

Analyte	Result	Reporting		Units	Dilution	Batch	Prepared	Analyzed	Method	Notes
		Limit								
Benzene	ND	1.0		ug/l	1	2041805	04/18/12	04/20/12	EPA 8260B	
Toluene	ND	1.0		"	"	"	"	"	"	
Ethylbenzene	ND	1.0		"	"	"	"	"	"	
Xylenes (total)	ND	1.0		"	"	"	"	"	"	

Date Sampled: 04/12/12 13:45

Analyte	Result	Reporting		Units	Dilution	Batch	Prepared	Analyzed	Method	Notes
		Limit								
Surrogate: 1,2-Dichloroethane-d4		106 %		57.9-139		"	"	"	"	
Surrogate: Toluene-d8		98.0 %		83.1-115		"	"	"	"	
Surrogate: 4-Bromofluorobenzene		95.6 %		80.8-120		"	"	"	"	

Summit Scientific

The results in this report apply to the samples analyzed in accordance with the chain of custody document. This analytical report must be reproduced in its entirety.

S₂

LT Environmental, Inc.
4600 West 60th Avenue
Arvada CO, 80003

Project: KMG - Edstrom 24-8 #1
Project Number: KMG 08390
Project Manager: John Cocroft

Reported:
04/20/12 19:49

Volatile Organic Compounds by EPA Method 8260B - Quality Control
Summit Scientific

Analyte	Reporting			Spike	Source		%REC		RPD	
	Result	Limit	Units	Level	Result	%REC	Limits	RPD	Limit	Notes

Batch 2041805 - EPA 5030 Water MS

Blank (2041805-BLK1)

Prepared: 04/18/12 Analyzed: 04/19/12

Benzene	ND	1.0	ug/l							
Toluene	ND	1.0	"							
Ethylbenzene	ND	1.0	"							
Xylenes (total)	ND	1.0	"							
Surrogate: 1,2-Dichloroethane-d4	10.2		"	13.3		76.9	57.9-139			
Surrogate: Toluene-d8	12.2		"	13.4		91.7	83.1-115			
Surrogate: 4-Bromofluorobenzene	12.6		"	13.4		94.5	80.8-120			

Blank (2041805-BLK2)

Prepared: 04/18/12 Analyzed: 04/19/12

Benzene	ND	1.0	ug/l							
Toluene	ND	1.0	"							
Ethylbenzene	ND	1.0	"							
Xylenes (total)	ND	1.0	"							
Surrogate: 1,2-Dichloroethane-d4	10.2		"	13.3		77.1	57.9-139			
Surrogate: Toluene-d8	12.2		"	13.4		91.7	83.1-115			
Surrogate: 4-Bromofluorobenzene	12.6		"	13.4		94.7	80.8-120			

LCS (2041805-BS1)

Prepared: 04/18/12 Analyzed: 04/19/12

Benzene	77.0	1.0	ug/l	100		77.0	60.1-131			
Toluene	73.6	1.0	"	100		73.6	65.9-127			
Ethylbenzene	77.8	1.0	"	100		77.8	65.1-129			
m,p-Xylene	143	2.0	"	200		71.4	66.8-127			
o-Xylene	76.4	1.0	"	100		76.4	61.2-120			
Surrogate: 1,2-Dichloroethane-d4	10.0		"	13.3		75.4	57.9-139			
Surrogate: Toluene-d8	12.0		"	13.4		90.0	83.1-115			
Surrogate: 4-Bromofluorobenzene	12.9		"	13.4		96.6	80.8-120			

LCS (2041805-BS2)

Prepared: 04/18/12 Analyzed: 04/19/12

Benzene	77.7	1.0	ug/l	100		77.7	60.1-131			
Toluene	74.7	1.0	"	100		74.7	65.9-127			
Ethylbenzene	78.0	1.0	"	100		78.0	65.1-129			
m,p-Xylene	143	2.0	"	200		71.4	66.8-127			
o-Xylene	76.2	1.0	"	100		76.2	61.2-120			
Surrogate: 1,2-Dichloroethane-d4	10.2		"	13.3		76.5	57.9-139			
Surrogate: Toluene-d8	12.3		"	13.4		92.1	83.1-115			
Surrogate: 4-Bromofluorobenzene	12.8		"	13.4		95.7	80.8-120			

Summit Scientific

The results in this report apply to the samples analyzed in accordance with the chain of custody document. This analytical report must be reproduced in its entirety.

S₂

LT Environmental, Inc.
4600 West 60th Avenue
Arvada CO, 80003

Project: KMG - Edstrom 24-8 #1

Project Number: KMG 08390
Project Manager: John Cocroft

Reported:
04/20/12 19:49

Volatile Organic Compounds by EPA Method 8260B - Quality Control
Summit Scientific

Analyte	Reporting			Spike	Source		%REC		RPD	
	Result	Limit	Units	Level	Result	%REC	Limits	RPD	Limit	Notes

Batch 2041805 - EPA 5030 Water MS

LCS Dup (2041805-BSD1)

Prepared: 04/18/12 Analyzed: 04/19/12

Benzene	78.5	1.0	ug/l	100		78.5	60.1-131	1.93	10.9	
Toluene	74.8	1.0	"	100		74.8	65.9-127	1.72	11.3	
Ethylbenzene	79.0	1.0	"	100		79.0	65.1-129	1.52	20	
m,p-Xylene	145	2.0	"	200		72.4	66.8-127	1.33	20	
o-Xylene	77.3	1.0	"	100		77.3	61.2-120	1.22	20	
Surrogate: 1,2-Dichloroethane-d4	10.1		"	13.3		76.2	57.9-139			
Surrogate: Toluene-d8	12.1		"	13.4		90.5	83.1-115			
Surrogate: 4-Bromofluorobenzene	12.8		"	13.4		96.1	80.8-120			

LCS Dup (2041805-BSD2)

Prepared: 04/18/12 Analyzed: 04/19/12

Benzene	77.8	1.0	ug/l	100		77.8	60.1-131	0.167	10.9	
Toluene	74.4	1.0	"	100		74.4	65.9-127	0.375	11.3	
Ethylbenzene	78.8	1.0	"	100		78.8	65.1-129	1.03	20	
m,p-Xylene	145	2.0	"	200		72.4	66.8-127	1.27	20	
o-Xylene	77.5	1.0	"	100		77.5	61.2-120	1.80	20	
Surrogate: 1,2-Dichloroethane-d4	10.0		"	13.3		75.7	57.9-139			
Surrogate: Toluene-d8	12.1		"	13.4		90.6	83.1-115			
Surrogate: 4-Bromofluorobenzene	12.7		"	13.4		95.1	80.8-120			

Matrix Spike (2041805-MS1)

Source: R204074-03

Prepared: 04/18/12 Analyzed: 04/19/12

Benzene	78.4	1.0	ug/l	100	ND	78.4	52.7-130			
Toluene	75.7	1.0	"	100	ND	75.7	57-127			
Ethylbenzene	78.4	1.0	"	100	ND	78.4	59.2-127			
m,p-Xylene	143	2.0	"	200	ND	71.5	53.2-132			
o-Xylene	77.3	1.0	"	100	ND	77.3	56.3-117			
Surrogate: 1,2-Dichloroethane-d4	10.2		"	13.3		76.5	57.9-139			
Surrogate: Toluene-d8	12.0		"	13.4		90.2	83.1-115			
Surrogate: 4-Bromofluorobenzene	12.6		"	13.4		94.7	80.8-120			

Summit Scientific

The results in this report apply to the samples analyzed in accordance with the chain of custody document. This analytical report must be reproduced in its entirety.

S₂

LT Environmental, Inc.
4600 West 60th Avenue
Arvada CO, 80003

Project: KMG - Edstrom 24-8 #1

Project Number: KMG 08390
Project Manager: John Cocroft

Reported:
04/20/12 19:49

Volatile Organic Compounds by EPA Method 8260B - Quality Control
Summit Scientific

Analyte	Reporting			Spike	Source		%REC		RPD	
	Result	Limit	Units	Level	Result	%REC	Limits	RPD	Limit	Notes

Batch 2041805 - EPA 5030 Water MS

Matrix Spike (2041805-MS2) **Source: R204074-02** Prepared: 04/18/12 Analyzed: 04/19/12

Benzene	78.0	1.0	ug/l	100	ND	78.0	52.7-130		
Toluene	74.5	1.0	"	100	ND	74.5	57-127		
Ethylbenzene	79.0	1.0	"	100	ND	79.0	59.2-127		
m,p-Xylene	146	2.0	"	200	ND	73.0	53.2-132		
o-Xylene	78.3	1.0	"	100	ND	78.3	56.3-117		
Surrogate: 1,2-Dichloroethane-d4	9.78		"	13.3		73.8	57.9-139		
Surrogate: Toluene-d8	12.2		"	13.4		90.9	83.1-115		
Surrogate: 4-Bromofluorobenzene	13.0		"	13.4		97.1	80.8-120		

Matrix Spike Dup (2041805-MSD1) **Source: R204074-03** Prepared: 04/18/12 Analyzed: 04/19/12

Benzene	78.5	1.0	ug/l	100	ND	78.5	52.7-130	0.127	19.3
Toluene	75.2	1.0	"	100	ND	75.2	57-127	0.716	18.7
Ethylbenzene	79.6	1.0	"	100	ND	79.6	59.2-127	1.51	20
m,p-Xylene	146	2.0	"	200	ND	72.8	53.2-132	1.81	20
o-Xylene	78.2	1.0	"	100	ND	78.2	56.3-117	1.27	20
Surrogate: 1,2-Dichloroethane-d4	10.1		"	13.3		75.9	57.9-139		
Surrogate: Toluene-d8	12.1		"	13.4		90.3	83.1-115		
Surrogate: 4-Bromofluorobenzene	12.6		"	13.4		94.1	80.8-120		

Matrix Spike Dup (2041805-MSD2) **Source: R204074-02** Prepared: 04/18/12 Analyzed: 04/19/12

Benzene	78.0	1.0	ug/l	100	ND	78.0	52.7-130	0.0256	19.3
Toluene	75.2	1.0	"	100	ND	75.2	57-127	1.03	18.7
Ethylbenzene	79.2	1.0	"	100	ND	79.2	59.2-127	0.227	20
m,p-Xylene	145	2.0	"	200	ND	72.5	53.2-132	0.557	20
o-Xylene	78.1	1.0	"	100	ND	78.1	56.3-117	0.192	20
Surrogate: 1,2-Dichloroethane-d4	10.3		"	13.3		77.5	57.9-139		
Surrogate: Toluene-d8	12.3		"	13.4		92.3	83.1-115		
Surrogate: 4-Bromofluorobenzene	12.9		"	13.4		96.7	80.8-120		

Summit Scientific



The results in this report apply to the samples analyzed in accordance with the chain of custody document. This analytical report must be reproduced in its entirety.

S₂

LT Environmental, Inc.
4600 West 60th Avenue
Arvada CO, 80003

Project: KMG - Edstrom 24-8 #1

Project Number: KMG 08390
Project Manager: John Cocroft

Reported:
04/20/12 19:49

Notes and Definitions

DET Analyte DETECTED
ND Analyte NOT DETECTED at or above the reporting limit
NR Not Reported
dry Sample results reported on a dry weight basis
RPD Relative Percent Difference

Summit Scientific

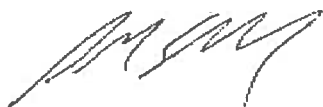

The results in this report apply to the samples analyzed in accordance with the chain of custody document. This analytical report must be reproduced in its entirety.