

DALEY LAND SURVEYING, INC.

PARKER, CO. 80134

303 953 9841

EXISTING CONTOURS PRESCOTT RANCHES 32-34

SECTION 32, TOWNSHIP 12 SOUTH, RANGE 59 WEST OF THE 6TH PRINCIPAL MERIDIAN

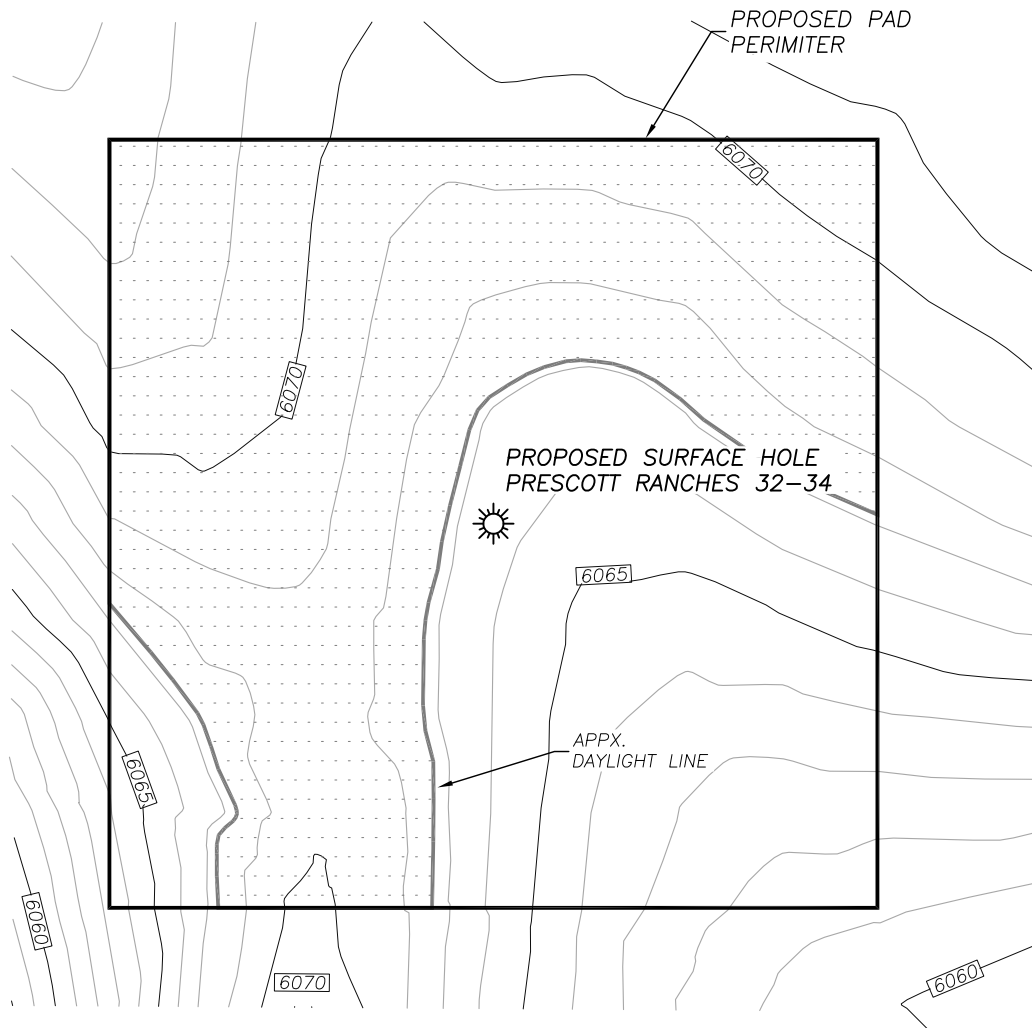

CONTOUR INTERVAL = 1'

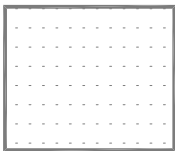

AREA OF
PROPOSED CUT

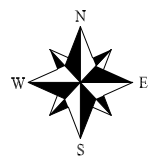

0 100
SCALE: 1" = 100'

PROPOSED PAD CONTOURS PRESCOTT RANCHES 32-34

SECTION 32, TOWNSHIP 12 SOUTH, RANGE 59 WEST OF THE 6TH PRINCIPAL MERIDIAN

PROPOSED
GRADING LIMITS

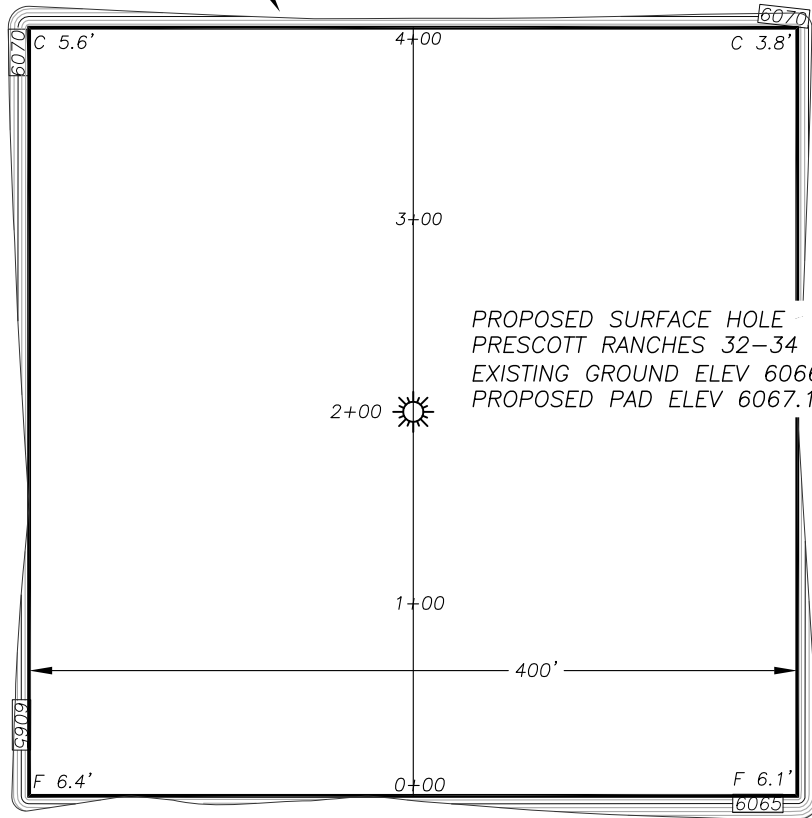

0 100
SCALE: 1" = 100'

CONTOUR INTERVAL = 1'

PRESCOTT RANCHES 32-34

Top of pad elevation: 6067.1'

Cut slope ratio: 2.0

Fill slope ratio: 2.0

Cut Swell Factor: 1.00

Fill Shrink Factor: 1.00

Pad Earthwork Volumes

Total cut: 7199 C.Y.

Total fill: 5233 C.Y.

Balance Export: 1966 C.Y. (4" Topsoil)

Area: 3.9 Acres

PROPOSED PAD CROSS SECTIONS PRESCOTT RANCHES 32-34

SECTION 32, TOWNSHIP 12 SOUTH, RANGE 59 WEST OF THE 6TH PRINCIPAL MERIDIAN

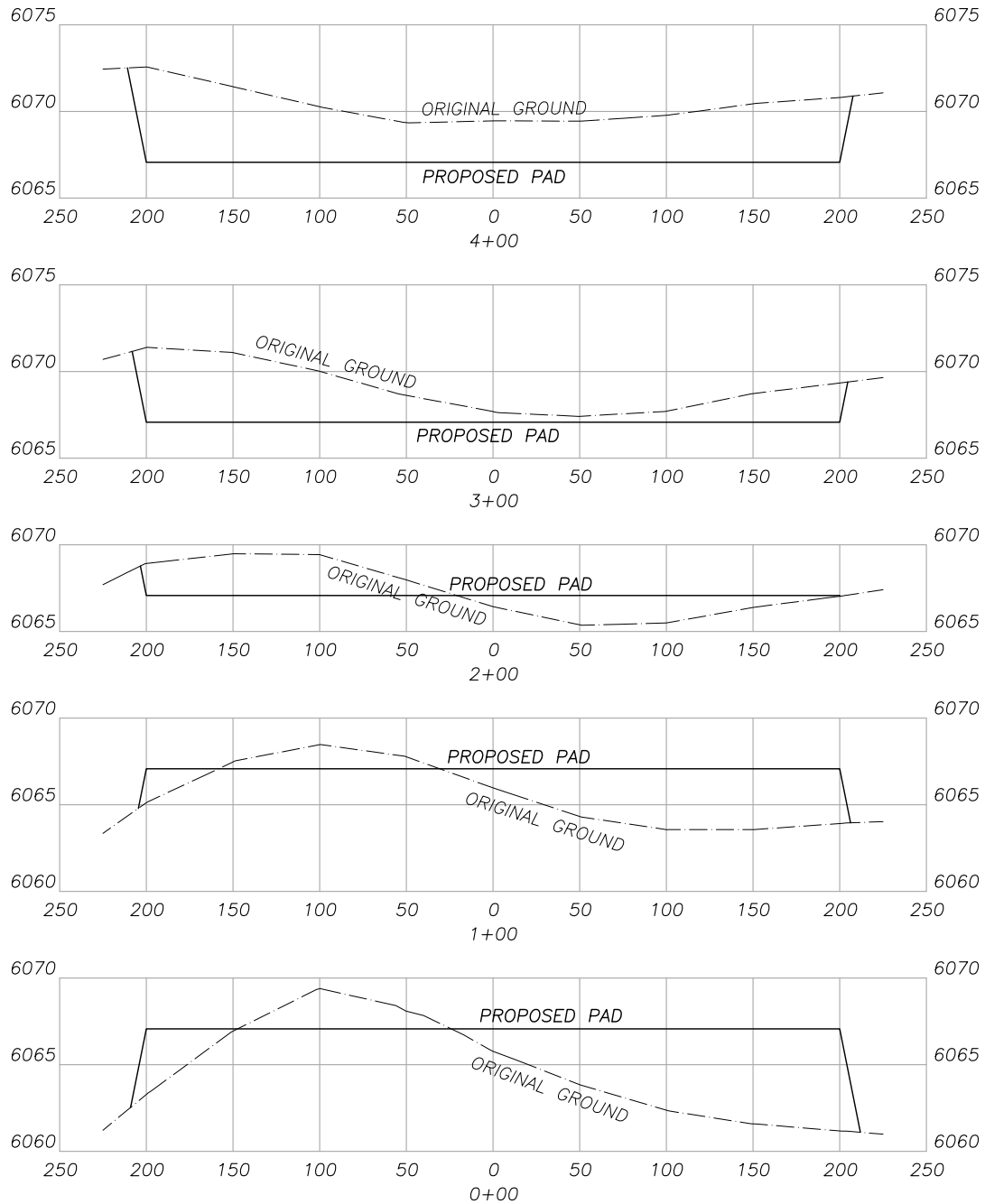

Horizontal Scale 50
Vertical Scale 5

PROPOSED RIG LAYOUT PRESCOTT RANCHES 32-34

SECTION 32, TOWNSHIP 12 SOUTH, RANGE 59 WEST OF THE 6TH PRINCIPAL MERIDIAN

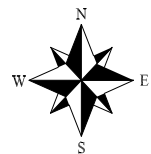
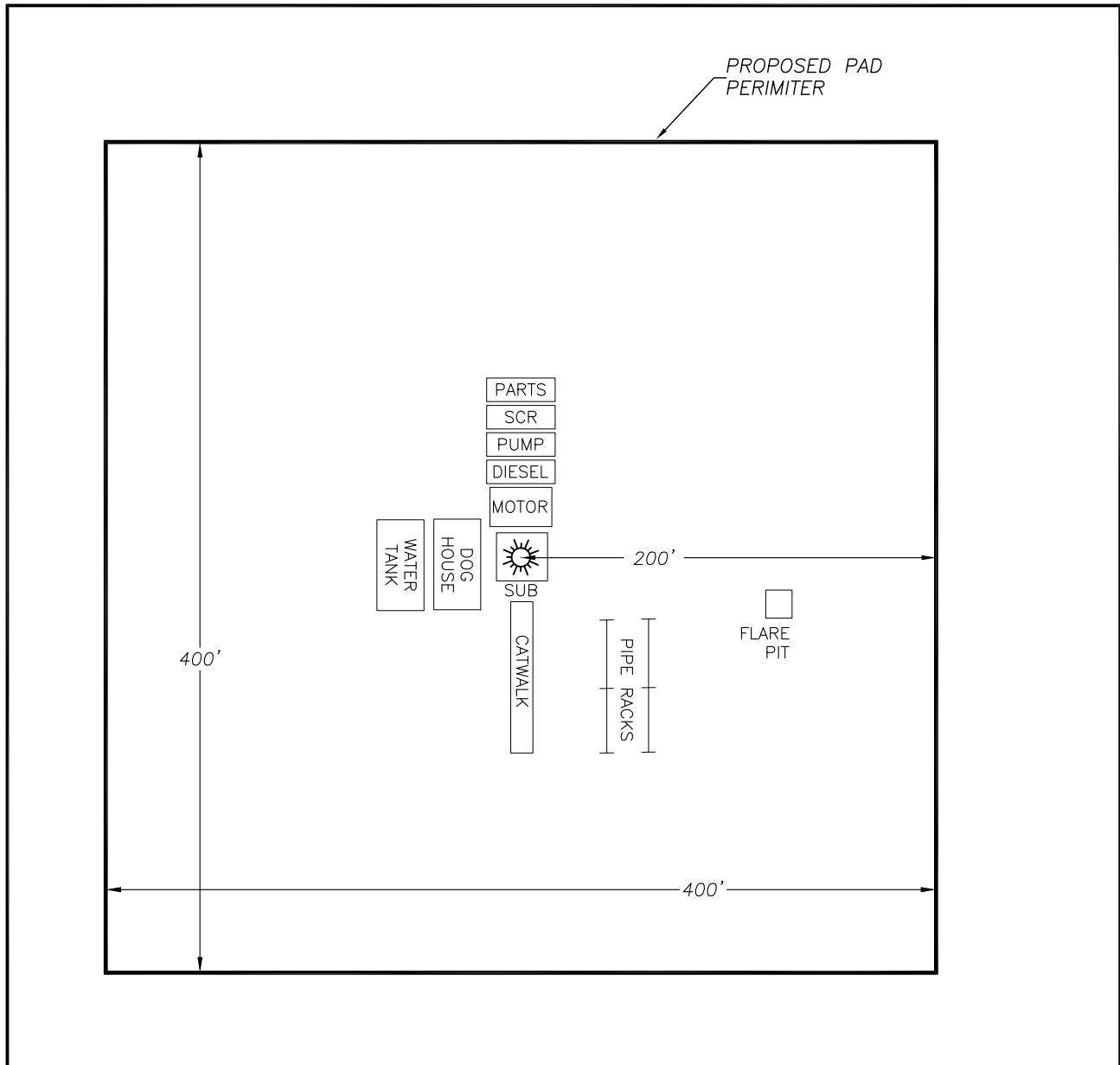

0 80
SCALE: 1" = 80'

PROPOSED PRODUCTION FACILITY PRESCOTT RANCHES 32-34

SECTION 32, TOWNSHIP 12 SOUTH, RANGE 59 WEST OF THE 6TH PRINCIPAL MERIDIAN

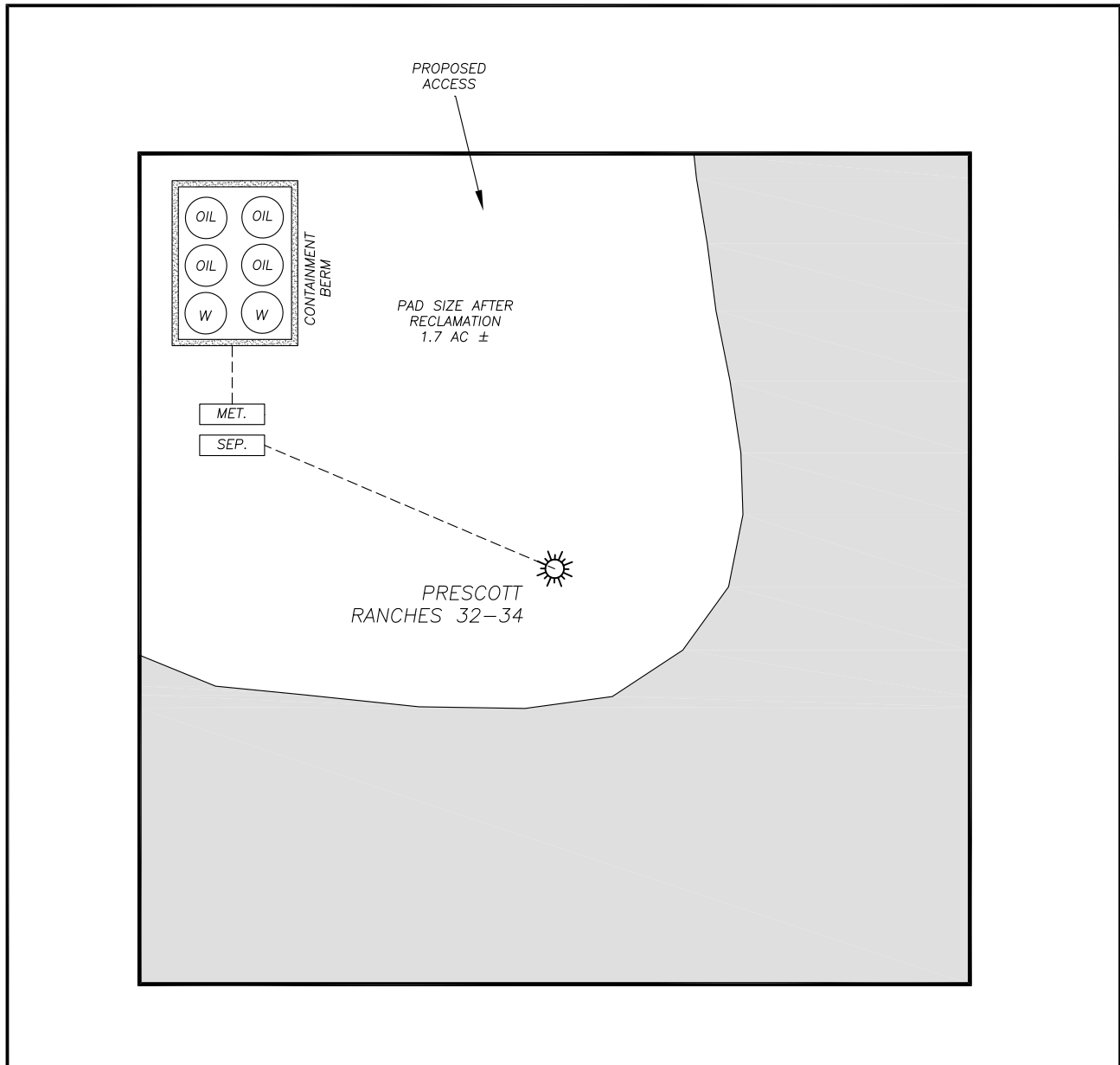

0 80
SCALE: 1" = 80'