

Belanger, Paul (Contractor)

Subject: FW: HF4 unit boundary
Attachments: 1991 Ex A McElmo TR 1-17 = white on COGCC map.pdf

From: Robert Johnston [<mailto:johnstonland@frontier.net>]
Sent: Tuesday, July 02, 2013 3:00 PM
To: Belanger, Paul (Contractor)
Cc: Keith, Douglas B
Subject: RE: HF4 unit boundary

The white box is i.d. on McElmo Dome Unit as Tract 1-17 (and maybe part of Tract 1-18) both of which are LEASED to Chevron & based on the fact they are listed on Ex. A, it would appear that they are pooled & unitized within the McElmo Dome Unit, there for the white box IS NOT a unit boundary. Therefore if your measurement to the unit boundary was more than 5280, you are good to go.

Rob

Rob Johnston, Owner/Principal
Johnston Land Company, Inc.
1315 Main Ave., Suite 221
Durango, CO 81301
Office 970-259-2959
Cell 970-759-0444

From: Belanger, Paul (Contractor)
Sent: Thursday, June 06, 2013 12:02 PM
To: Robert Johnston
Subject: HF4 unit boundary

Rob,
Doing my own unit boundary checking we are >5280' unless the white square below (1335') is not part of the unit – so it might help to explain what portion of the unit that white square is?

Thanks
Paul

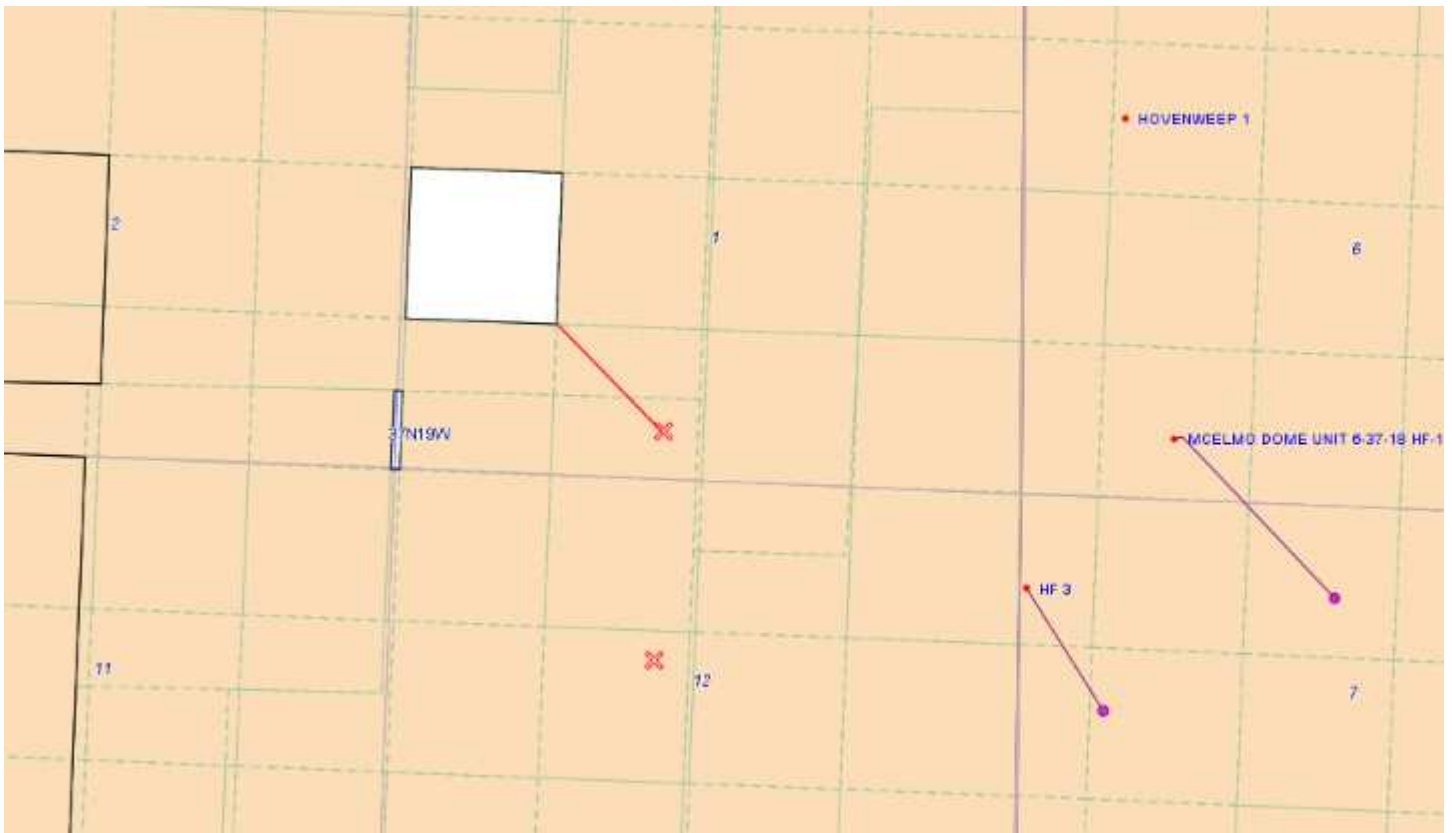

Paul E. Belanger, Geologist
Regulatory Contractor @ Kinder Morgan
cell 303-249-7966
If you need to contact someone in Cortez office
please call 970-882-2464

TRACT NO.	DESCRIPTION	ACRES	BASIC ROYALTY PERCENTAGE AND SERIAL NO.	OVERRIDING ROYALTY AND PERCENTAGE	WORKING INTEREST AND PERCENTAGE	TRACT PARTICIPATION			
	SEC. 36: SE/4NE/4			CELSIUS ENERGY COMPANY	2.2500				
				CELESTE C. GRYNBERG & DEAN SMERNOFF, CO-TRUSTEES FOR MIRIAM ZELA TRUST	0.4166				
				CELESTE C. GRYNBERG & DEAN SMERNOFF, CO-TRUSTEES FOR RACHEL SUSAN TRUST	0.4167				
				CELESTE C. GRYNBERG & DEAN SMERNOFF, CO-TRUSTEES FOR STEPHEN MARK TRUST	0.4167				
				VICTOR ROBERTS	1.5000				
1-13	T38N-R18W, NMPM SEC. 32: E/2NE/4	80.00	USA	12.5000 C-19348	CELSIUS ENERGY COMPANY	3.5000	MOBIL PROD. TEX & NM, INC.	100.0000	0.0394186%
					W. B. COLLINS	1.0000			
					WILLIAM A. GILLESPIE TRUST DONNA A. GILLESPIE, TRUSTEE	2.0000			
					MARY LOU ROSE	1.0000			
1-14	T38N-R19W, NMPM SEC. 23: NW/4	160.00	USA	12.5000 C-19351	SUSAN C. PERIERA, TRUSTEE FOR VIRIGINIA M. HUMMEL	NC 1.6700	TIDELANDS ENERGY COMPANY	100.0000	0.0788372%
					SUSAN PEREIRA, TRUSTEE FOR PETER R. K. HUMMEL	NC 1.6700			
					SUSAN PEREIRA, TRUSTEE FOR EDGAR S. C. HUMMEL	NC 1.6700			
1-15	T38N-R19W, NMPM SEC. 23: SE/4 SEC. 24: SE/4	320.00	USA	12.5000 C-21139	WILLIAM R. THURSTON, TRUSTEE	6.2500	MOBIL PROD. TEX & NM, INC.	100.0000	0.1576744%
1-16	T37N-R19W, NMPM SEC. 2: LOTS 8 THRU 16, N/2S/2	419.90	USA	12.5000 C-25553	DORIS R. MERRICK ADMINISTRATOR OF ESTATE OF CHARLES MERRICK	NC 5.0000	MOBIL PROD. TEX & NM, INC.	100.0000	0.2068984%
1-17	T37N-R19W, NMPM SEC. 1: LOTS 5 THRU 14, NW/4SW/4 SEC. 2: LOTS 5, 6, & 7 SW/4NE/4, S/2NW/4	517.49	USA	12.5000 C-22368	RAYMOND CHORNEY	0.5000	CHEVRON U.S.A. INC.	100.0000	0.2549842%
1-18	T37N-R19W, NMPM SEC. 1: W/2NW/4 SEC. 2: NE/4NE/4	120.00	USA	12.5000 C-22375	CELESTE C. GRYNBERG & DEAN SMERNOFF, CO-TRUSTEES FOR MIRIAM ZELA TRUST	2.0832	CHEVRON U.S.A. INC.	100.0000	0.0591279%

015

016

017

018

019

020

HB-6 BHL
HB-6
Drill three
HE-6 bottom hole
HE-6 surface