

Re-Entry Plan for Bailey 26 Pad Wells

7/19/2013

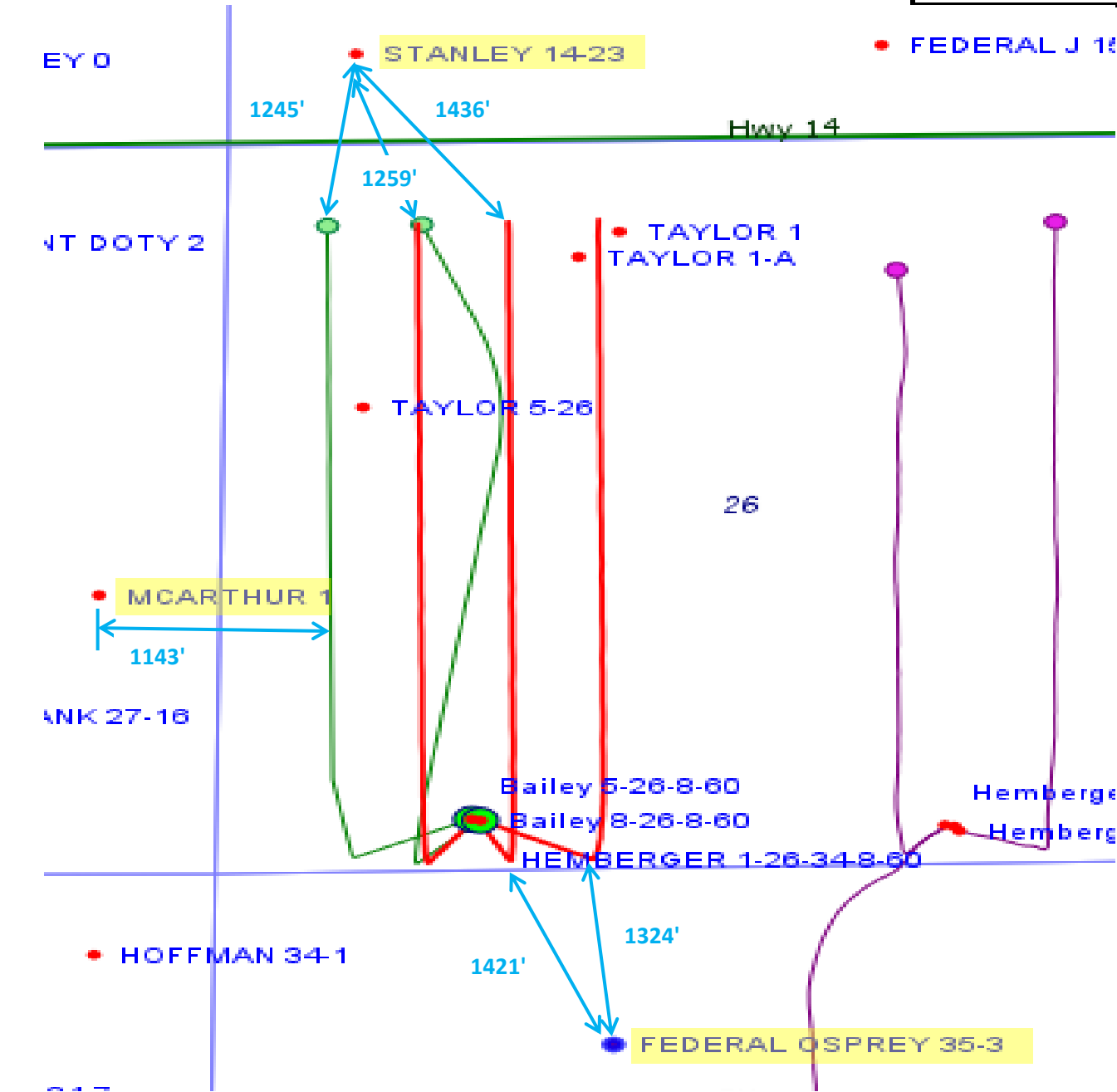

Out of Section Wells

Well Name	Status	Distance from Wellbore, ft	Plan to Address Proximity
Federal Osprey 35-3	Producing	1324'	Cement or isolation packer will provide adequate protection required for the 1500' offset policy for the Bailey 7-26-8-60 and the Bailey 8-26-8-60 completions.
McArthur 1	DA'd	1143' (Impacts 1 lateral & 6 stages)	Re-enter the well and plug to provide adequate protection.
Stanley 14-23	DA'd	1245'	Re-enter the well and plug to provide adequate protection.

In Section Wells

Well Name	Status	Laterals Impacted	Potential Stages Impacted	Plan to Address Proximity
Taylor 1	PA'd	4	15.8	Re-enter the well and plug to provide adequate protection.
Taylor 1-A	DA'd	4	19.9	Re-enter the well and plug to provide adequate protection.
Taylor 5-26	DA'd	3	25.7	Re-enter the well and plug to provide adequate protection.