



## **Bayswater**

**Windsor**

**Windsor LV 14H**

**Windsor LV F-14H**

**Windsor LV F-14H**

**Plan: Windsor LV F-14H**

## **Standard Planning Report**

**26 July, 2013**

WELL DETAILS: Windsor LV F-14H											
+N/S			+E/W			Northing			Easting		
0.00			0.00			196500.380			318020.704		
Ground Level			4847.00			Latitude			Longitude		
						40.490510			-104.822600		
SECTION DETAILS											
Seq	MD	Inc	API	TVD	+N/S	+E/W	Day	TFace	VStart	Target	Annotation
1	0.00	0.00	0.00	0.00	0.00	0.00	0.00	0.00	0.00		
2	750.00	0.00	7.10	750.75	0.00	0.00	0.00	0.00	0.00		
3	1103.11	8.06	1.11	1103.19	-25.13	17.34	2.00	152.37	-6.32		Start Build 2.00
4	4850.00	0.00	1.50	4850.75	0.00	0.00	0.00	0.00	0.00		Start 5590.84 hold at 1103.11 MD
5	7636.24	90.43	289.47	7242.00	-601.49	-203.05	10.00	116.79	343.50		Start DLS 10.00 TFO 116.79
6	11937.70	90.43	289.47	7196.00	-626.51	-453.90	1.00	121.98	4058.00		Start DLS 0.00 TFO 121.98
TD at 11937.70											
DESIGN TARGET DETAILS											
Name	TVD	+N/S	+E/W	Northing	Easting	Latitude	Longitude	Shape			
Windsor LV F-14H	1196.50	-626.58	-453.91	1967841.231	3173678.705	40.488240	-104.838560	Circle (Radius: 25.00)			
LV F-14H Entry Point	212.00	-601.49	-203.05	1967897.279	3180210.324	40.488310	-104.851930	Circle (Radius: 15.00)			
-plan 10% target center											

Company Name: Bayswater	
FORMATION TOP DETAILS	
No formation data is available	

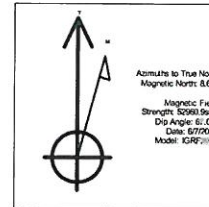

PROJECT DETAILS: Windsor	
Geodetic System:	US State Plane 1983
Datum:	North American Datum 1983
Ellipsoid:	GRS 1980
Zone:	Colorado Central Zone
System Datum:	Mean Sea Level

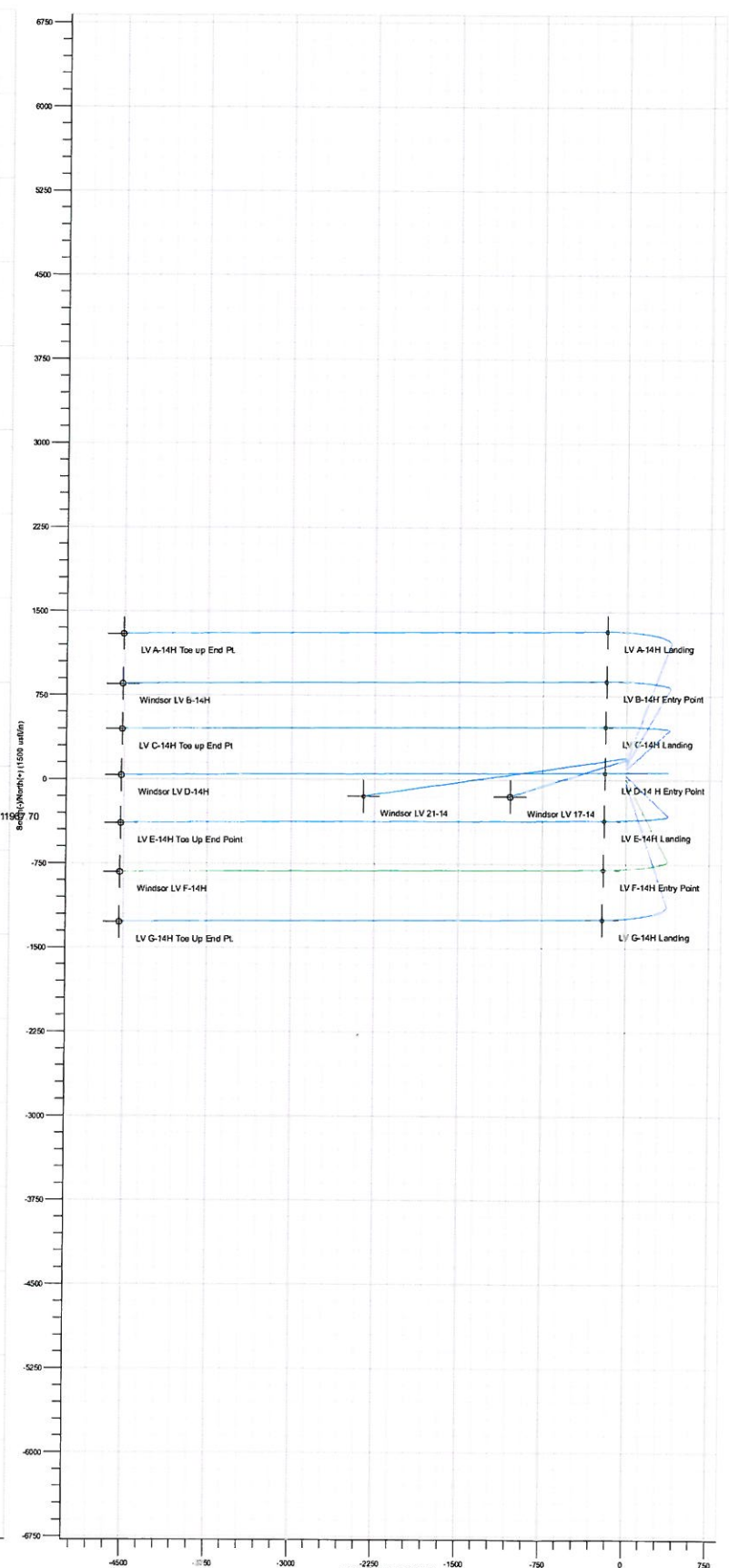
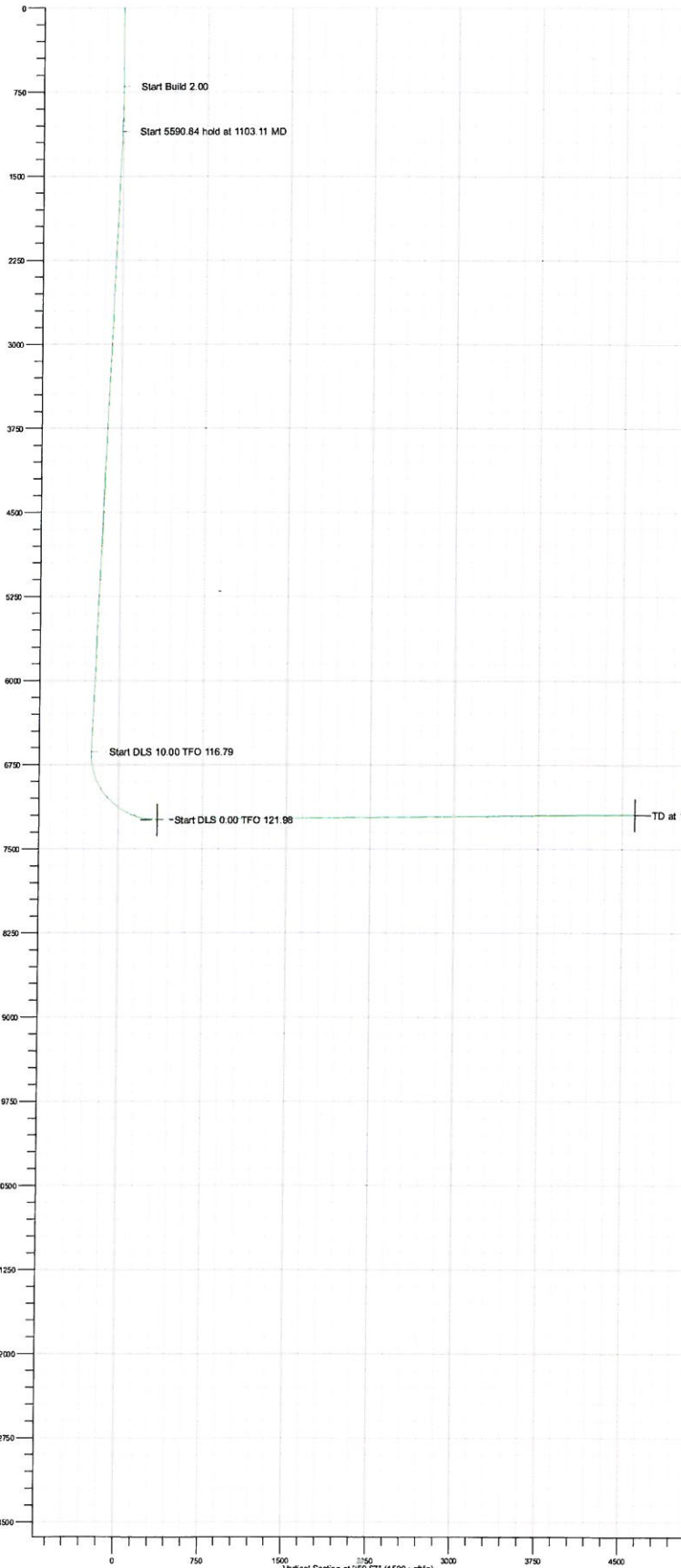

<b>Database:</b>	Compass DB	<b>Local Co-ordinate Reference:</b>	Well Windsor LV F-14H
<b>Company:</b>	Bayswater	<b>TVD Reference:</b>	WELL @ 4847.00usft (Original Well Elev)
<b>Project:</b>	Windsor	<b>MD Reference:</b>	WELL @ 4847.00usft (Original Well Elev)
<b>Site:</b>	Windsor LV 14H	<b>North Reference:</b>	True
<b>Well:</b>	Windsor LV F-14H	<b>Survey Calculation Method:</b>	Minimum Curvature
<b>Wellbore:</b>	Windsor LV F-14H		
<b>Design:</b>	Windsor LV F-14H		

<b>Project</b>	Windsor, Colorado		
<b>Map System:</b>	US State Plane 1983	<b>System Datum:</b>	Mean Sea Level
<b>Geo Datum:</b>	North American Datum 1983		
<b>Map Zone:</b>	Colorado Central Zone		Using geodetic scale factor

Site		Windsor LV 14H			
Site Position:		Northing:	1,968,660.741 usft	Latitude:	40.490950
From:	Lat/Long	Easting:	3,180,209.343 usft	Longitude:	-104.852250
Position Uncertainty:	0.00 usft	Slot Radius:	13-3/16 "	Grid Convergence:	0.41 °

Well	Windsor LV F-14H					
Well Position	+N/-S	-160.31 usft	Northing:	1,968,500.379 usft	Latitude:	40.490510
	+E/-W	-2.78 usft	Easting:	3,180,207.704 usft	Longitude:	-104.852260
Position Uncertainty		0.00 usft	Wellhead Elevation:	4,847.00 usft	Ground Level:	4,847.00 usft

<b>Wellbore</b>	Windsor LV F-14H				
<b>Magnetics</b>	<b>Model Name</b>	<b>Sample Date</b>	<b>Declination (°)</b>	<b>Dip Angle (°)</b>	<b>Field Strength (nT)</b>
	IGRF2010	6/7/2013	8.65	67.04	52,961

Design	Windsor LV F-14H				
Audit Notes:					
Version:	1	Phase:	PROTOTYPE	Tie On Depth:	0.00
Vertical Section:	Depth From (TVD)	+N/-S	+E/-W	Direction	
	(usft)	(usft)	(usft)	(°)	
	0.00	0.00	0.00	259.67	

<b>Plan Sections</b>										
Measured Depth (usft)	Inclination (°)	Azimuth (°)	Vertical Depth (usft)	+N/-S (usft)	+E/-W (usft)	Dogleg Rate (°/100usft)	Build Rate (°/100usft)	Turn Rate (°/100usft)	TFO (°)	Target
0.00	0.00	0.00	0.00	0.00	0.00	0.00	0.00	0.00	0.00	
700.00	0.00	0.00	700.00	0.00	0.00	0.00	0.00	0.00	0.00	
1,103.11	8.06	152.57	1,101.78	-25.13	13.04	2.00	2.00	0.00	152.57	
6,693.95	8.06	152.57	6,637.36	-721.08	374.24	0.00	0.00	0.00	0.00	
7,636.54	90.60	269.67	7,242.00	-801.49	-203.05	10.00	8.76	12.42	116.79	LV F-14H Entry Point
11,967.70	90.60	269.67	7,196.60	-826.51	-4,533.90	0.00	0.00	0.00	121.98	

Database:	Compass DB	Local Co-ordinate Reference:	Well Windsor LV F-14H
Company:	Bayswater	TVD Reference:	WELL @ 4847.00usft (Original Well Elev)
Project:	Windsor	MD Reference:	WELL @ 4847.00usft (Original Well Elev)
Site:	Windsor LV 14H	North Reference:	True
Well:	Windsor LV F-14H	Survey Calculation Method:	Minimum Curvature
Wellbore:	Windsor LV F-14H		
Design:	Windsor LV F-14H		

Planned Survey									
Measured Depth (usft)	Inclination (°)	Azimuth (°)	Vertical Depth (usft)	+N/-S (usft)	+E/-W (usft)	Vertical Section (usft)	Dogleg Rate (°/100usft)	Build Rate (°/100usft)	Turn Rate (°/100usft)
0.00	0.00	0.00	0.00	0.00	0.00	0.00	0.00	0.00	0.00
100.00	0.00	0.00	100.00	0.00	0.00	0.00	0.00	0.00	0.00
200.00	0.00	0.00	200.00	0.00	0.00	0.00	0.00	0.00	0.00
300.00	0.00	0.00	300.00	0.00	0.00	0.00	0.00	0.00	0.00
400.00	0.00	0.00	400.00	0.00	0.00	0.00	0.00	0.00	0.00
500.00	0.00	0.00	500.00	0.00	0.00	0.00	0.00	0.00	0.00
600.00	0.00	0.00	600.00	0.00	0.00	0.00	0.00	0.00	0.00
700.00	0.00	0.00	700.00	0.00	0.00	0.00	0.00	0.00	0.00
<b>Start Build 2.00</b>									
800.00	2.00	152.57	799.98	-1.55	0.80	-0.51	2.00	2.00	0.00
900.00	4.00	152.57	899.84	-6.19	3.21	-2.05	2.00	2.00	0.00
1,000.00	6.00	152.57	999.45	-13.93	7.23	-4.61	2.00	2.00	0.00
1,100.00	8.00	152.57	1,098.70	-24.75	12.84	-8.20	2.00	2.00	0.00
1,103.11	8.06	152.57	1,101.78	-25.13	13.04	-8.32	2.00	2.00	0.00
<b>Start 5590.84 hold at 1103.11 MD</b>									
1,200.00	8.06	152.57	1,197.71	-37.19	19.30	-12.32	0.00	0.00	0.00
1,300.00	8.06	152.57	1,296.73	-49.64	25.76	-16.44	0.00	0.00	0.00
1,400.00	8.06	152.57	1,395.74	-62.09	32.22	-20.57	0.00	0.00	0.00
1,500.00	8.06	152.57	1,494.75	-74.54	38.68	-24.69	0.00	0.00	0.00
1,600.00	8.06	152.57	1,593.76	-86.98	45.14	-28.81	0.00	0.00	0.00
1,700.00	8.06	152.57	1,692.77	-99.43	51.61	-32.94	0.00	0.00	0.00
1,800.00	8.06	152.57	1,791.78	-111.88	58.07	-37.06	0.00	0.00	0.00
1,900.00	8.06	152.57	1,890.80	-124.33	64.53	-41.18	0.00	0.00	0.00
2,000.00	8.06	152.57	1,989.81	-136.78	70.99	-45.31	0.00	0.00	0.00
2,100.00	8.06	152.57	2,088.82	-149.22	77.45	-49.43	0.00	0.00	0.00
2,200.00	8.06	152.57	2,187.83	-161.67	83.91	-53.55	0.00	0.00	0.00
2,300.00	8.06	152.57	2,286.84	-174.12	90.37	-57.68	0.00	0.00	0.00
2,400.00	8.06	152.57	2,385.85	-186.57	96.83	-61.80	0.00	0.00	0.00
2,500.00	8.06	152.57	2,484.87	-199.02	103.29	-65.92	0.00	0.00	0.00
2,600.00	8.06	152.57	2,583.88	-211.46	109.75	-70.05	0.00	0.00	0.00
2,700.00	8.06	152.57	2,682.89	-223.91	116.21	-74.17	0.00	0.00	0.00
2,800.00	8.06	152.57	2,781.90	-236.36	122.67	-78.29	0.00	0.00	0.00
2,900.00	8.06	152.57	2,880.91	-248.81	129.13	-82.42	0.00	0.00	0.00
3,000.00	8.06	152.57	2,979.92	-261.26	135.59	-86.54	0.00	0.00	0.00
3,100.00	8.06	152.57	3,078.93	-273.70	142.05	-90.66	0.00	0.00	0.00
3,200.00	8.06	152.57	3,177.95	-286.15	148.51	-94.79	0.00	0.00	0.00
3,300.00	8.06	152.57	3,276.96	-298.60	154.97	-98.91	0.00	0.00	0.00
3,400.00	8.06	152.57	3,375.97	-311.05	161.43	-103.03	0.00	0.00	0.00
3,500.00	8.06	152.57	3,474.98	-323.50	167.90	-107.16	0.00	0.00	0.00
3,600.00	8.06	152.57	3,573.99	-335.95	174.36	-111.28	0.00	0.00	0.00
3,700.00	8.06	152.57	3,673.00	-348.39	180.82	-115.40	0.00	0.00	0.00
3,800.00	8.06	152.57	3,772.02	-360.84	187.28	-119.53	0.00	0.00	0.00
3,900.00	8.06	152.57	3,871.03	-373.29	193.74	-123.65	0.00	0.00	0.00
4,000.00	8.06	152.57	3,970.04	-385.74	200.20	-127.77	0.00	0.00	0.00
4,100.00	8.06	152.57	4,069.05	-398.19	206.66	-131.90	0.00	0.00	0.00
4,200.00	8.06	152.57	4,168.06	-410.63	213.12	-136.02	0.00	0.00	0.00
4,300.00	8.06	152.57	4,267.07	-423.08	219.58	-140.14	0.00	0.00	0.00
4,400.00	8.06	152.57	4,366.09	-435.53	226.04	-144.27	0.00	0.00	0.00
4,500.00	8.06	152.57	4,465.10	-447.98	232.50	-148.39	0.00	0.00	0.00
4,600.00	8.06	152.57	4,564.11	-460.43	238.96	-152.51	0.00	0.00	0.00
4,700.00	8.06	152.57	4,663.12	-472.87	245.42	-156.64	0.00	0.00	0.00
4,800.00	8.06	152.57	4,762.13	-485.32	251.88	-160.76	0.00	0.00	0.00
4,900.00	8.06	152.57	4,861.14	-497.77	258.34	-164.88	0.00	0.00	0.00
5,000.00	8.06	152.57	4,960.16	-510.22	264.80	-169.01	0.00	0.00	0.00

<b>Database:</b>	Compass DB	<b>Local Co-ordinate Reference:</b>	Well Windsor LV F-14H
<b>Company:</b>	Bayswater	<b>TVD Reference:</b>	WELL @ 4847.00usft (Original Well Elev)
<b>Project:</b>	Windsor	<b>MD Reference:</b>	WELL @ 4847.00usft (Original Well Elev)
<b>Site:</b>	Windsor LV 14H	<b>North Reference:</b>	True
<b>Well:</b>	Windsor LV F-14H	<b>Survey Calculation Method:</b>	Minimum Curvature
<b>Wellbore:</b>	Windsor LV F-14H		
<b>Design:</b>	Windsor LV F-14H		

Planned Survey

Measured Depth (usft)	Inclination (°)	Azimuth (°)	Vertical Depth (usft)	+N/-S (usft)	+E/-W (usft)	Vertical Section (usft)	Dogleg Rate (°/100usft)	Build Rate (°/100usft)	Turn Rate (°/100usft)
5,100.00	8.06	152.57	5,059.17	-522.67	271.26	-173.13	0.00	0.00	0.00
5,200.00	8.06	152.57	5,158.18	-535.11	277.72	-177.25	0.00	0.00	0.00
5,300.00	8.06	152.57	5,257.19	-547.56	284.18	-181.38	0.00	0.00	0.00
5,400.00	8.06	152.57	5,356.20	-560.01	290.65	-185.50	0.00	0.00	0.00
5,500.00	8.06	152.57	5,455.21	-572.46	297.11	-189.62	0.00	0.00	0.00
5,600.00	8.06	152.57	5,554.23	-584.91	303.57	-193.75	0.00	0.00	0.00
5,700.00	8.06	152.57	5,653.24	-597.35	310.03	-197.87	0.00	0.00	0.00
5,800.00	8.06	152.57	5,752.25	-609.80	316.49	-201.99	0.00	0.00	0.00
5,900.00	8.06	152.57	5,851.26	-622.25	322.95	-206.12	0.00	0.00	0.00
6,000.00	8.06	152.57	5,950.27	-634.70	329.41	-210.24	0.00	0.00	0.00
6,100.00	8.06	152.57	6,049.28	-647.15	335.87	-214.36	0.00	0.00	0.00
6,200.00	8.06	152.57	6,148.30	-659.59	342.33	-218.49	0.00	0.00	0.00
6,300.00	8.06	152.57	6,247.31	-672.04	348.79	-222.61	0.00	0.00	0.00
6,400.00	8.06	152.57	6,346.32	-684.49	355.25	-226.74	0.00	0.00	0.00
6,500.00	8.06	152.57	6,445.33	-696.94	361.71	-230.86	0.00	0.00	0.00
6,600.00	8.06	152.57	6,544.34	-709.39	368.17	-234.98	0.00	0.00	0.00
6,693.95	8.06	152.57	6,637.36	-721.08	374.24	-238.86	0.00	0.00	0.00
<b>Start DLS 10.00 TFO 116.79</b>									
6,700.00	7.81	156.55	6,643.36	-721.83	374.60	-239.07	10.00	-4.20	65.76
6,800.00	9.99	223.84	6,742.39	-734.35	371.29	-233.57	10.00	2.18	67.29
6,900.00	18.37	247.26	6,839.33	-746.73	350.69	-211.09	10.00	8.38	23.43
7,000.00	27.83	255.76	6,931.23	-758.60	313.44	-172.31	10.00	9.45	8.50
7,100.00	37.55	260.14	7,015.30	-769.58	260.66	-118.42	10.00	9.72	4.38
7,200.00	47.37	262.92	7,089.00	-779.35	193.96	-51.05	10.00	9.82	2.78
7,300.00	57.24	264.94	7,150.07	-787.62	115.37	27.75	10.00	9.87	2.01
7,400.00	67.14	266.54	7,196.66	-794.13	27.27	115.59	10.00	9.90	1.61
7,500.00	77.06	267.93	7,227.36	-798.68	-67.66	209.79	10.00	9.91	1.39
7,600.00	86.98	269.21	7,241.23	-801.13	-166.53	307.51	10.00	9.92	1.28
7,636.54	90.60	269.67	7,242.00	-801.49	-203.05	343.50	10.00	9.92	1.25
<b>Start DLS 0.00 TFO 121.98 - LV F-14H Entry Point</b>									
7,700.00	90.60	269.67	7,241.33	-801.86	-266.51	405.99	0.00	0.00	0.00
7,800.00	90.60	269.67	7,240.28	-802.44	-366.50	504.47	0.00	0.00	0.00
7,900.00	90.60	269.67	7,239.24	-803.01	-466.50	602.94	0.00	0.00	0.00
8,000.00	90.60	269.67	7,238.19	-803.59	-566.49	701.42	0.00	0.00	0.00
8,100.00	90.60	269.67	7,237.14	-804.17	-666.48	799.90	0.00	0.00	0.00
8,200.00	90.60	269.67	7,236.09	-804.75	-766.47	898.37	0.00	0.00	0.00
8,300.00	90.60	269.67	7,235.04	-805.33	-866.47	996.85	0.00	0.00	0.00
8,400.00	90.60	269.67	7,233.99	-805.91	-966.46	1,095.32	0.00	0.00	0.00
8,500.00	90.60	269.67	7,232.94	-806.49	-1,066.45	1,193.80	0.00	0.00	0.00
8,600.00	90.60	269.67	7,231.89	-807.07	-1,166.45	1,292.27	0.00	0.00	0.00
8,700.00	90.60	269.67	7,230.84	-807.65	-1,266.44	1,390.75	0.00	0.00	0.00
8,800.00	90.60	269.67	7,229.79	-808.22	-1,366.43	1,489.22	0.00	0.00	0.00
8,900.00	90.60	269.67	7,228.75	-808.80	-1,466.42	1,587.70	0.00	0.00	0.00
9,000.00	90.60	269.67	7,227.70	-809.38	-1,566.42	1,686.18	0.00	0.00	0.00
9,100.00	90.60	269.67	7,226.65	-809.96	-1,666.41	1,784.65	0.00	0.00	0.00
9,200.00	90.60	269.67	7,225.60	-810.54	-1,766.40	1,883.13	0.00	0.00	0.00
9,300.00	90.60	269.67	7,224.55	-811.12	-1,866.40	1,981.60	0.00	0.00	0.00
9,400.00	90.60	269.67	7,223.50	-811.69	-1,966.39	2,080.08	0.00	0.00	0.00
9,500.00	90.60	269.67	7,222.45	-812.27	-2,066.38	2,178.55	0.00	0.00	0.00
9,600.00	90.60	269.67	7,221.41	-812.85	-2,166.37	2,277.03	0.00	0.00	0.00
9,700.00	90.60	269.67	7,220.36	-813.43	-2,266.37	2,375.50	0.00	0.00	0.00
9,800.00	90.60	269.67	7,219.31	-814.00	-2,366.36	2,473.98	0.00	0.00	0.00
9,900.00	90.60	269.67	7,218.26	-814.58	-2,466.35	2,572.45	0.00	0.00	0.00
10,000.00	90.60	269.67	7,217.21	-815.16	-2,566.35	2,670.93	0.00	0.00	0.00

<b>Database:</b>	Compass DB	<b>Local Co-ordinate Reference:</b>	Well Windsor LV F-14H
<b>Company:</b>	Bayswater	<b>TVD Reference:</b>	WELL @ 4847.00usft (Original Well Elev)
<b>Project:</b>	Windsor	<b>MD Reference:</b>	WELL @ 4847.00usft (Original Well Elev)
<b>Site:</b>	Windsor LV 14H	<b>North Reference:</b>	True
<b>Well:</b>	Windsor LV F-14H	<b>Survey Calculation Method:</b>	Minimum Curvature
<b>Wellbore:</b>	Windsor LV F-14H		
<b>Design:</b>	Windsor LV F-14H		

**Planned Survey**

Measured Depth (usft)	Inclination (°)	Azimuth (°)	Vertical Depth (usft)	+N/-S (usft)	+E/-W (usft)	Vertical Section (usft)	Dogleg Rate (°/100usft)	Build Rate (°/100usft)	Turn Rate (°/100usft)
10,100.00	90.60	269.67	7,216.16	-815.74	-2,666.34	2,769.40	0.00	0.00	0.00
10,200.00	90.60	269.67	7,215.12	-816.31	-2,766.33	2,867.88	0.00	0.00	0.00
10,300.00	90.60	269.67	7,214.07	-816.89	-2,866.32	2,966.35	0.00	0.00	0.00
10,400.00	90.60	269.67	7,213.02	-817.47	-2,966.32	3,064.83	0.00	0.00	0.00
10,500.00	90.60	269.67	7,211.97	-818.05	-3,066.31	3,163.30	0.00	0.00	0.00
10,600.00	90.60	269.67	7,210.92	-818.62	-3,166.30	3,261.78	0.00	0.00	0.00
10,700.00	90.60	269.67	7,209.88	-819.20	-3,266.30	3,360.25	0.00	0.00	0.00
10,800.00	90.60	269.67	7,208.83	-819.78	-3,366.29	3,458.73	0.00	0.00	0.00
10,900.00	90.60	269.67	7,207.78	-820.35	-3,466.28	3,557.21	0.00	0.00	0.00
11,000.00	90.60	269.67	7,206.73	-820.93	-3,566.27	3,655.68	0.00	0.00	0.00
11,100.00	90.60	269.67	7,205.69	-821.51	-3,666.27	3,754.16	0.00	0.00	0.00
11,200.00	90.60	269.67	7,204.64	-822.08	-3,766.26	3,852.63	0.00	0.00	0.00
11,300.00	90.60	269.67	7,203.59	-822.66	-3,866.25	3,951.11	0.00	0.00	0.00
11,400.00	90.60	269.67	7,202.54	-823.24	-3,966.25	4,049.58	0.00	0.00	0.00
11,500.00	90.60	269.67	7,201.50	-823.81	-4,066.24	4,148.06	0.00	0.00	0.00
11,600.00	90.60	269.67	7,200.45	-824.39	-4,166.23	4,246.53	0.00	0.00	0.00
11,700.00	90.60	269.67	7,199.40	-824.97	-4,266.22	4,345.01	0.00	0.00	0.00
11,800.00	90.60	269.67	7,198.35	-825.54	-4,366.22	4,443.48	0.00	0.00	0.00
11,900.00	90.60	269.67	7,197.31	-826.12	-4,466.21	4,541.96	0.00	0.00	0.00
11,967.70	90.60	269.67	7,196.60	-826.51	-4,533.90	4,608.62	0.00	0.00	0.00
TD at 11967.70 - Windsor LV F-14H									

**Design Targets**

Target Name	Dip Angle (°)	Dip Dir. (°)	TVD (usft)	+N/-S (usft)	+E/-W (usft)	Northing (usft)	Easting (usft)	Latitude	Longitude
- hit/miss target									
- Shape									
Windsor LV F-14H	0.00	0.00	7,196.55	-826.58	-4,533.96	1,967,641.291	3,175,678.706	40.488240	-104.868560
- plan misses target center by 0.11usft at 11967.70usft MD (7196.60 TVD, -826.51 N, -4533.90 E)									
- Circle (radius 25.00)									
LV F-14H Entry Point	0.00	0.00	7,242.00	-801.49	-203.05	1,967,697.279	3,180,010.324	40.488310	-104.852990
- plan hits target center									
- Circle (radius 15.00)									

**Plan Annotations**

Measured Depth (usft)	Vertical Depth (usft)	+N/-S (usft)	+E/-W (usft)	Comment
700.00	700.00	0.00	0.00	Start Build 2.00
1,103.11	1,101.78	-25.13	13.04	Start 5590.84 hold at 1103.11 MD
6,693.95	6,637.36	-721.08	374.24	Start DLS 10.00 TFO 116.79
7,636.54	7,242.00	-801.49	-203.05	Start DLS 0.00 TFO 121.98
11,967.70	7,196.60	-826.51	-4,533.90	TD at 11967.70



## **Bayswater**

**Windsor**

**Windsor LV 14H**

**Windsor LV 17-14**

**Windsor LV 17-14**

**Windsor LV 17-14**

## **Anticollision Report**

**20 June, 2013**

<b>Company:</b>	Bayswater	<b>Local Co-ordinate Reference:</b>	Well Windsor LV 17-14
<b>Project:</b>	Windsor	<b>TVD Reference:</b>	WELL @ 4845.00usft (Original Well Elev)
<b>Reference Site:</b>	Windsor LV 14H	<b>MD Reference:</b>	WELL @ 4845.00usft (Original Well Elev)
<b>Site Error:</b>	0.00 usft	<b>North Reference:</b>	True
<b>Reference Well:</b>	Windsor LV 17-14	<b>Survey Calculation Method:</b>	Minimum Curvature
<b>Well Error:</b>	0.00 usft	<b>Output errors are at</b>	2.00 sigma
<b>Reference Wellbore</b>	Windsor LV 17-14	<b>Database:</b>	Compass DB Connection
<b>Reference Design:</b>	Windsor LV 17-14	<b>Offset TVD Reference:</b>	Reference Datum

<b>Reference</b>	Windsor LV 17-14		
<b>Filter type:</b>	NO GLOBAL FILTER: Using user defined selection & filtering criteria		
<b>Interpolation Method:</b>	MD Interval 100.00usft	<b>Error Model:</b>	ISCWSA
<b>Depth Range:</b>	Unlimited	<b>Scan Method:</b>	Closest Approach 3D
<b>Results Limited by:</b>	Maximum center-center distance of 9,999.98 usft	<b>Error Surface:</b>	Elliptical Conic
<b>Warning Levels Evaluated at:</b>	2.00 Sigma	<b>Casing Method:</b>	Not applied

<b>Survey Tool Program</b>	Date 6/20/2013			
<b>From (usft)</b>	<b>To (usft)</b>	<b>Survey (Wellbore)</b>	<b>Tool Name</b>	<b>Description</b>
0.00	7,922.62	Windsor LV 17-14 (Windsor LV 17-14)	MWD	MWD - Standard

Summary						
Site Name	Reference Measured Depth (usft)	Offset Measured Depth (usft)	Distance Between Centres (usft)	Distance Between Ellipses (usft)	Separation Factor	Warning
Offset Well - Wellbore - Design						
Windsor LV 14H						
Windsor LV A-14H - Windsor LV A-14H - Windsor LV A-1	909.85	910.31	14.42	10.60	3.773	CC, ES, SF
Windsor LV B-14H - Windsor LV B-14H - Windsor LV B-1	1,018.99	1,020.67	41.03	36.70	9.490	CC, ES, SF
Windsor LV C-14H - Windsor LV C-14H - Windsor LV C-1	1,048.23	1,049.71	74.65	70.18	16.727	CC, ES
Windsor LV C-14H - Windsor LV C-14H - Windsor LV C-1	7,413.15	8,463.14	617.37	553.08	9.603	SF
Windsor LV D-14H - Windsor LV D-14H - Windsor LV D-1	943.06	942.74	113.33	109.39	28.764	CC, ES
Windsor LV D-14H - Windsor LV D-14H - Windsor LV D-1	7,409.70	8,443.98	205.72	141.76	3.216	SF
Windsor LV E-14H - Windsor LV E-14H - Windsor LV E-1	666.33	667.33	147.52	144.74	53.201	CC
Windsor LV E-14H - Windsor LV E-14H - Windsor LV E-1	700.00	700.00	147.52	144.60	50.487	ES
Windsor LV E-14H - Windsor LV E-14H - Windsor LV E-1	7,407.28	8,445.08	220.50	156.74	3.458	SF
Windsor LV F-14H - Windsor LV F-14H - Windsor LV F-1	665.99	667.99	180.33	177.55	65.016	CC
Windsor LV F-14H - Windsor LV F-14H - Windsor LV F-1	700.00	700.00	180.34	177.41	61.718	ES
Windsor LV F-14H - Windsor LV F-14H - Windsor LV F-1	7,403.85	8,471.81	657.64	593.83	10.307	SF
Windsor LV G-14H - Windsor LV G-14H - Windsor LV G-1	665.64	668.64	213.11	210.34	76.818	CC
Windsor LV G-14H - Windsor LV G-14H - Windsor LV G-1	700.00	700.00	213.13	210.21	72.941	ES
Windsor LV G-14H - Windsor LV G-14H - Windsor LV G-1	7,400.46	8,525.45	1,102.07	1,037.96	17.192	SF

Offset Design Windsor LV 14H - Windsor LV A-14H - Windsor LV A-14H - Windsor LV A-14H												Offset Site Error:	0.00 usft
Survey Program: 0-MWD												Offset Well Error:	0.00 usft
Reference		Offset		Semi Major Axis			Distance					Warning	
Measured Depth (usft)	Vertical Depth (usft)	Measured Depth (usft)	Vertical Depth (usft)	Reference (usft)	Offset (usft)	Highside Toolface (°)	Offset Wellbore Centre +N/-S (usft)	+E/-W (usft)	Between Centres (usft)	Between Ellipses (usft)	Minimum Separation (usft)		Separation Factor
0.00	0.00	0.00	0.00	0.00	0.00	-179.59	-19.99	-0.14	20.00	19.99	0.00	N/A	
100.00	100.00	100.00	100.00	0.11	0.11	-179.59	-19.99	-0.14	20.00	19.77	0.22	88.959	
200.00	200.00	200.00	200.00	0.34	0.34	-179.59	-19.99	-0.14	20.00	19.32	0.67	29.653	
300.00	300.00	300.00	300.00	0.56	0.56	-179.59	-19.99	-0.14	20.00	18.87	1.12	17.792	
400.00	400.00	400.00	400.00	0.79	0.79	-179.59	-19.99	-0.14	20.00	18.42	1.57	12.708	
500.00	500.00	500.00	500.00	1.01	1.01	-179.59	-19.99	-0.14	20.00	17.97	2.02	9.884	
600.00	600.00	600.00	600.00	1.24	1.24	-179.59	-19.99	-0.14	20.00	17.52	2.47	8.087	
700.00	700.00	700.00	700.00	1.46	1.46	-179.59	-19.99	-0.14	20.00	17.07	2.92	6.843	
800.00	799.98	800.56	800.54	1.67	1.69	-79.46	-18.34	0.48	17.96	14.60	3.36	5.350	
900.00	899.84	900.52	900.36	1.87	1.92	-111.03	-13.43	2.33	14.48	10.70	3.78	3.831	
909.85	909.66	910.31	910.12	1.89	1.94	-116.01	-12.78	2.58	14.42	10.60	3.82	3.773	CC, ES, SF
1,000.00	999.45	999.31	998.76	2.09	2.14	-160.48	-5.38	5.37	20.36	16.16	4.21	4.838	
1,100.00	1,098.70	1,096.37	1,095.10	2.34	2.39	176.21	5.62	9.52	38.90	34.24	4.66	8.350	

CC - Min centre to center distance or convergent point, SF - min separation factor, ES - min ellipse separation

<b>Company:</b>	Bayswater	<b>Local Co-ordinate Reference:</b>	Well Windsor LV 17-14
<b>Project:</b>	Windsor	<b>TVD Reference:</b>	WELL @ 4845.00usft (Original Well Elev)
<b>Reference Site:</b>	Windsor LV 14H	<b>MD Reference:</b>	WELL @ 4845.00usft (Original Well Elev)
<b>Site Error:</b>	0.00 usft	<b>North Reference:</b>	True
<b>Reference Well:</b>	Windsor LV 17-14	<b>Survey Calculation Method:</b>	Minimum Curvature
<b>Well Error:</b>	0.00 usft	<b>Output errors are at</b>	2.00 sigma
<b>Reference Wellbore</b>	Windsor LV 17-14	<b>Database:</b>	Compass DB Connection
<b>Reference Design:</b>	Windsor LV 17-14	<b>Offset TVD Reference:</b>	Reference Datum

Offset Design Windsor LV 14H - Windsor LV A-14H - Windsor LV A-14H - Windsor LV A-14H													Offset Site Error:	0.00 usft
Survey Program: 0-MWD													Offset Well Error:	0.00 usft
Reference		Offset		Semi Major Axis		Highside Toolface (°)	Offset Wellbore Centre		Distance				Warning	
Measured Depth (usft)	Vertical Depth (usft)	Measured Depth (usft)	Vertical Depth (usft)	Reference (usft)	Offset (usft)		+N/-S (usft)	+E/-W (usft)	Between Centres (usft)	Between Ellipses (usft)	Minimum Separation (usft)	Separation Factor		
1,200.00	1,197.47	1,191.19	1,188.78	2.63	2.65	167.04	19.31	14.69	65.44	60.32	5.12	12.792		
1,300.00	1,295.62	1,283.94	1,279.92	2.96	2.94	162.58	35.41	20.77	98.30	92.71	5.59	17.599		
1,400.00	1,393.06	1,376.80	1,371.01	3.36	3.26	160.45	52.32	27.15	135.22	129.16	6.05	22.334		
1,500.00	1,489.64	1,468.43	1,460.89	3.81	3.59	159.52	69.00	33.45	175.22	168.70	6.53	26.836		
1,600.00	1,585.27	1,558.71	1,549.44	4.34	3.93	159.14	85.44	39.65	218.22	211.20	7.01	31.116		
1,700.00	1,679.82	1,647.54	1,636.57	4.94	4.26	159.05	101.62	45.76	264.13	256.62	7.51	35.148		
1,800.00	1,773.78	1,735.60	1,722.94	5.59	4.60	159.37	117.65	51.81	311.50	303.43	8.06	38.633		
1,900.00	1,867.75	1,823.66	1,809.32	6.26	4.95	159.60	133.69	57.86	358.87	350.24	8.63	41.597		
2,000.00	1,961.72	1,911.72	1,895.69	6.94	5.30	159.78	149.73	63.91	406.24	397.04	9.20	44.148		
2,100.00	2,055.69	1,999.78	1,982.07	7.63	5.65	159.93	165.76	69.96	453.62	443.83	9.78	46.359		
2,200.00	2,149.66	2,087.84	2,068.44	8.33	6.00	160.04	181.80	76.02	501.00	490.62	10.38	48.287		
2,300.00	2,243.63	2,175.90	2,154.82	9.03	6.36	160.14	197.83	82.07	548.38	537.40	10.97	49.982		
2,400.00	2,337.60	2,263.96	2,241.20	9.74	6.72	160.22	213.87	88.12	595.76	584.18	11.57	51.481		
2,500.00	2,431.57	2,352.02	2,327.57	10.45	7.08	160.29	229.90	94.17	643.14	630.96	12.18	52.814		
2,600.00	2,525.54	2,440.08	2,413.95	11.16	7.44	160.35	245.94	100.22	690.52	677.74	12.79	54.007		
2,700.00	2,619.51	2,528.14	2,500.32	11.88	7.80	160.40	261.97	106.28	737.90	724.51	13.40	55.078		
2,800.00	2,713.48	2,616.19	2,586.70	12.60	8.16	160.45	278.01	112.33	785.29	771.28	14.01	56.045		
2,900.00	2,807.45	2,704.25	2,673.08	13.32	8.53	160.49	294.04	118.38	832.67	818.04	14.63	56.922		
3,000.00	2,901.42	2,792.31	2,759.45	14.04	8.89	160.52	310.08	124.43	880.06	864.81	15.25	57.720		
3,100.00	2,995.39	2,880.37	2,845.83	14.76	9.26	160.56	326.11	130.48	927.44	911.57	15.87	58.449		
3,200.00	3,089.35	2,968.43	2,932.20	15.49	9.62	160.58	342.15	136.54	974.82	958.33	16.49	59.117		
3,300.00	3,183.32	3,056.49	3,018.58	16.21	9.99	160.61	358.18	142.59	1,022.21	1,005.10	17.11	59.732		
3,400.00	3,277.29	3,144.55	3,104.95	16.94	10.36	160.64	374.22	148.64	1,069.59	1,051.86	17.74	60.298		
3,500.00	3,371.26	3,232.61	3,191.33	17.67	10.72	160.66	390.26	154.69	1,116.98	1,098.61	18.36	60.823		
3,600.00	3,465.23	3,320.67	3,277.71	18.39	11.09	160.68	406.29	160.74	1,164.36	1,145.37	18.99	61.309		
3,700.00	3,559.20	3,408.73	3,364.08	19.12	11.46	160.70	422.33	166.80	1,211.75	1,192.13	19.62	61.761		
3,800.00	3,653.17	3,496.79	3,450.46	19.85	11.83	160.71	438.36	172.85	1,259.13	1,238.88	20.25	62.182		
3,900.00	3,747.14	3,584.86	3,536.84	20.57	12.20	160.75	454.40	178.90	1,306.51	1,285.63	20.89	62.554		
4,000.00	3,841.77	3,673.79	3,624.07	21.10	12.57	161.07	470.59	185.01	1,352.23	1,330.65	21.58	62.666		
4,100.00	3,937.47	3,764.17	3,712.72	21.59	12.95	161.31	487.05	191.22	1,394.99	1,372.74	22.25	62.693		
4,200.00	4,034.12	3,855.89	3,802.68	22.02	13.33	161.48	503.75	197.53	1,434.74	1,411.84	22.90	62.648		
4,300.00	4,131.60	3,948.83	3,893.85	22.41	13.72	161.57	520.68	203.92	1,471.44	1,447.91	23.53	62.543		
4,400.00	4,229.81	4,042.90	3,986.12	22.75	14.12	161.61	537.80	210.38	1,505.05	1,480.92	24.12	62.387		
4,500.00	4,328.61	4,137.96	4,079.36	23.03	14.52	161.58	555.11	216.91	1,535.54	1,510.85	24.69	62.188		
4,600.00	4,427.89	4,233.90	4,173.47	23.27	14.92	161.51	572.59	223.51	1,562.88	1,537.66	25.23	61.952		
4,700.00	4,527.53	4,330.61	4,268.33	23.46	15.33	161.37	590.20	230.15	1,587.07	1,561.34	25.73	61.683		
4,800.00	4,627.40	4,427.97	4,363.83	23.61	15.74	161.19	607.93	236.85	1,608.07	1,581.87	26.20	61.385		
4,900.00	4,727.38	4,525.86	4,459.85	23.71	16.15	53.46	625.75	243.57	1,625.90	1,599.26	26.63	61.047		
5,000.00	4,827.38	4,623.95	4,556.06	23.80	16.56	53.10	643.61	250.31	1,642.39	1,615.27	27.11	60.580		
5,100.00	4,927.38	4,722.04	4,652.27	23.89	16.97	52.74	661.47	257.06	1,658.94	1,631.35	27.59	60.132		
5,200.00	5,027.38	4,820.13	4,748.48	23.99	17.39	52.39	679.34	263.80	1,675.55	1,647.49	28.07	59.702		
5,300.00	5,127.38	4,918.22	4,844.70	24.08	17.80	52.04	697.20	270.54	1,692.23	1,663.69	28.54	59.290		
5,400.00	5,227.38	5,016.30	4,940.91	24.18	18.21	51.71	715.06	277.28	1,708.96	1,679.94	29.02	58.895		
5,500.00	5,327.38	5,114.39	5,037.12	24.28	18.63	51.37	732.92	284.02	1,725.75	1,696.26	29.49	58.515		
5,600.00	5,427.38	5,212.48	5,133.33	24.38	19.04	51.05	750.78	290.76	1,742.60	1,712.63	29.97	58.151		
5,700.00	5,527.38	5,310.57	5,229.54	24.48	19.45	50.73	768.64	297.50	1,759.50	1,729.06	30.44	57.800		
5,800.00	5,627.38	5,408.65	5,325.75	24.59	19.87	50.42	786.50	304.24	1,776.45	1,745.54	30.91	57.463		
5,900.00	5,727.38	5,506.74	5,421.97	24.69	20.28	50.11	804.36	310.99	1,793.46	1,762.07	31.39	57.139		
6,000.00	5,827.38	5,604.83	5,518.18	24.80	20.70	49.81	822.23	317.73	1,810.51	1,778.65	31.86	56.827		
6,100.00	5,927.38	5,702.92	5,614.39	24.91	21.11	49.51	840.09	324.47	1,827.61	1,795.28	32.33	56.526		
6,200.00	6,027.38	5,801.00	5,710.80	25.02	21.52	49.22	857.95	331.21	1,844.76	1,811.96	32.80	56.236		
6,300.00	6,127.38	5,891.05	5,745.24	25.13	41.56	-0.79	1,137.06	-1,065.19	1,843.73	1,779.48	64.25	28.697		

CC - Min centre to center distance or convergent point, SF - min separation factor, ES - min ellipse separation

<b>Company:</b>	Bayswater	<b>Local Co-ordinate Reference:</b>	Well Windsor LV 17-14
<b>Project:</b>	Windsor	<b>TVD Reference:</b>	WELL @ 4845.00usft (Original Well Elev)
<b>Reference Site:</b>	Windsor LV 14H	<b>MD Reference:</b>	WELL @ 4845.00usft (Original Well Elev)
<b>Site Error:</b>	0.00 usft	<b>North Reference:</b>	True
<b>Reference Well:</b>	Windsor LV 17-14	<b>Survey Calculation Method:</b>	Minimum Curvature
<b>Well Error:</b>	0.00 usft	<b>Output errors are at</b>	2.00 sigma
<b>Reference Wellbore</b>	Windsor LV 17-14	<b>Database:</b>	Compass DB Connection
<b>Reference Design:</b>	Windsor LV 17-14	<b>Offset TVD Reference:</b>	Reference Datum

Offset Design Windsor LV 14H - Windsor LV A-14H - Windsor LV A-14H - Windsor LV A-14H													Offset Site Error:	0.00 usft
Survey Program: 0-MVD													Offset Well Error:	0.00 usft
Reference		Offset		Semi Major Axis		Highside Toolface (°)	Offset Wellbore Centre		Distance				Warning	
Measured Depth (usft)	Vertical Depth (usft)	Measured Depth (usft)	Vertical Depth (usft)	Reference (usft)	Offset (usft)		+N/-S (usft)	+E/-W (usft)	Between Centres (usft)	Between Ellipses (usft)	Minimum Separation (usft)	Separation Factor		
6,400.00	6,227.38	8,590.01	7,245.25	25.25	41.54	-0.75	1,137.07	-1,064.14	1,784.87	1,720.53	64.34	27.740		
6,500.00	6,327.38	8,588.96	7,245.26	25.36	41.51	-0.71	1,137.07	-1,063.09	1,729.80	1,665.36	64.44	26.843		
6,600.00	6,427.38	8,587.91	7,245.27	25.48	41.49	-0.67	1,137.08	-1,062.05	1,678.88	1,614.34	64.54	26.013		
6,700.00	6,527.38	8,586.86	7,245.28	25.60	41.46	-0.63	1,137.08	-1,061.00	1,632.50	1,567.86	64.64	25.256		
6,800.00	6,627.38	8,585.82	7,245.29	25.72	41.44	-0.58	1,137.09	-1,059.95	1,591.06	1,526.32	64.74	24.576		
6,900.00	6,727.38	8,584.77	7,245.31	25.84	41.41	-0.54	1,137.10	-1,058.91	1,554.95	1,490.11	64.84	23.980		
7,000.00	6,827.38	8,583.72	7,245.32	25.96	41.39	-0.50	1,137.10	-1,057.86	1,524.56	1,459.62	64.95	23.474		
7,100.00	6,927.38	8,582.68	7,245.33	26.08	41.36	-0.46	1,137.11	-1,056.81	1,500.23	1,435.18	65.05	23.062		
7,200.00	7,027.38	8,581.63	7,245.34	26.21	41.34	-0.42	1,137.11	-1,055.77	1,482.27	1,417.11	65.16	22.748		
7,300.00	7,127.38	8,580.58	7,245.35	26.33	41.31	-0.38	1,137.12	-1,054.72	1,470.89	1,405.62	65.27	22.536		
7,400.00	7,227.38	8,579.53	7,245.36	26.46	41.29	-0.34	1,137.13	-1,053.67	1,466.26	1,400.89	65.38	22.428		
7,417.98	7,245.36	8,579.35	7,245.36	26.49	41.28	-0.33	1,137.13	-1,053.48	1,466.15	1,400.76	65.40	22.419		
7,500.00	7,327.38	8,578.49	7,245.37	26.59	41.26	-0.30	1,137.13	-1,052.62	1,468.44	1,402.96	65.49	22.423		
7,600.00	7,427.38	8,577.44	7,245.38	26.72	41.24	-0.26	1,137.14	-1,051.58	1,477.41	1,411.81	65.60	22.522		
7,700.00	7,527.38	8,576.39	7,245.39	26.85	41.21	-0.22	1,137.14	-1,050.53	1,493.03	1,427.31	65.71	22.721		
7,800.00	7,627.38	8,575.35	7,245.40	26.99	41.19	-0.18	1,137.15	-1,049.48	1,515.10	1,449.27	65.83	23.016		
7,900.00	7,727.38	8,574.30	7,245.42	27.12	41.17	-0.13	1,137.16	-1,048.44	1,543.35	1,477.40	65.94	23.404		
7,922.62	7,750.00	8,574.06	7,245.42	27.15	41.16	-0.13	1,137.16	-1,048.20	1,550.56	1,484.59	65.97	23.504		

<b>Company:</b>	Bayswater	<b>Local Co-ordinate Reference:</b>	Well Windsor LV 17-14
<b>Project:</b>	Windsor	<b>TVD Reference:</b>	WELL @ 4845.00usft (Original Well Elev)
<b>Reference Site:</b>	Windsor LV 14H	<b>MD Reference:</b>	WELL @ 4845.00usft (Original Well Elev)
<b>Site Error:</b>	0.00 usft	<b>North Reference:</b>	True
<b>Reference Well:</b>	Windsor LV 17-14	<b>Survey Calculation Method:</b>	Minimum Curvature
<b>Well Error:</b>	0.00 usft	<b>Output errors are at</b>	2.00 sigma
<b>Reference Wellbore</b>	Windsor LV 17-14	<b>Database:</b>	Compass DB Connection
<b>Reference Design:</b>	Windsor LV 17-14	<b>Offset TVD Reference:</b>	Reference Datum

Offset Design Windsor LV 14H - Windsor LV B-14H - Windsor LV B-14H - Windsor LV B-14H													Offset Site Error:	0.00 usft
Survey Program: 0-MWD													Offset Well Error:	0.00 usft
Measured Depth (usft)	Vertical Depth (usft)	Measured Depth (usft)	Vertical Depth (usft)	Reference (usft)	Offset (usft)	Highside Toolface (°)	Offset Wellbore Centre +N/-S (usft)	+E/-W (usft)	Between Centres (usft)	Between Ellipses (usft)	Minimum Separation (usft)	Separation Factor	Warning	
0.00	0.00	0.00	0.00	0.00	0.00	-179.84	-52.80	-0.14	52.80					
100.00	100.00	100.00	100.00	0.11	0.11	-179.84	-52.80	-0.14	52.80	52.57	0.22	234.891		
200.00	200.00	200.00	200.00	0.34	0.34	-179.84	-52.80	-0.14	52.80	52.12	0.67	78.297		
300.00	300.00	300.00	300.00	0.56	0.56	-179.84	-52.80	-0.14	52.80	51.67	1.12	46.978		
400.00	400.00	400.00	400.00	0.79	0.79	-179.84	-52.80	-0.14	52.80	51.22	1.57	33.556		
500.00	500.00	500.00	500.00	1.01	1.01	-179.84	-52.80	-0.14	52.80	50.77	2.02	26.099		
600.00	600.00	600.00	600.00	1.24	1.24	-179.84	-52.80	-0.14	52.80	50.32	2.47	21.354		
700.00	700.00	700.00	700.00	1.46	1.46	-179.84	-52.80	-0.14	52.80	49.87	2.92	18.069		
800.00	799.98	801.52	801.50	1.67	1.69	-75.32	-51.24	0.75	50.79	47.43	3.36	15.128		
900.00	899.84	902.38	902.21	1.87	1.92	-85.50	-46.60	3.42	45.69	41.91	3.79	12.065		
1,000.00	999.45	1,001.96	1,001.40	2.09	2.15	-106.27	-39.01	7.78	41.20	36.97	4.23	9.733		
1,018.99	1,018.33	1,020.67	1,020.00	2.14	2.19	-111.50	-37.25	8.79	41.03	36.70	4.32	9.490 CC, ES, SF		
1,100.00	1,098.70	1,099.65	1,098.36	2.34	2.39	-135.46	-28.68	13.72	45.14	40.45	4.69	9.618		
1,200.00	1,197.47	1,195.95	1,193.77	2.63	2.66	-158.01	-17.38	20.22	61.99	56.85	5.14	12.063		
1,300.00	1,295.62	1,291.30	1,288.24	2.96	2.93	-170.47	-6.18	26.65	87.59	82.02	5.57	15.728		
1,400.00	1,393.06	1,385.60	1,381.67	3.36	3.21	-177.31	4.89	33.02	118.72	112.72	6.00	19.798		
1,500.00	1,489.64	1,478.72	1,473.93	3.81	3.49	178.68	15.82	39.30	154.05	147.63	6.43	23.974		
1,600.00	1,585.27	1,570.55	1,564.92	4.34	3.77	176.19	26.61	45.50	193.03	186.18	6.86	28.150		
1,700.00	1,679.82	1,660.98	1,654.52	4.94	4.05	174.57	37.22	51.60	235.39	228.09	7.30	32.267		
1,800.00	1,773.78	1,750.68	1,743.39	5.59	4.33	173.54	47.75	57.66	279.40	271.61	7.79	35.872		
1,900.00	1,867.75	1,840.37	1,832.26	6.26	4.61	172.79	58.29	63.71	323.47	315.18	8.30	38.994		
2,000.00	1,961.72	1,930.07	1,921.12	6.94	4.90	172.21	68.82	69.76	367.58	358.76	8.81	41.718		
2,100.00	2,055.69	2,019.76	2,009.99	7.63	5.19	171.76	79.35	75.82	411.70	402.37	9.33	44.107		
2,200.00	2,149.66	2,109.46	2,098.86	8.33	5.48	171.40	89.88	81.87	455.84	445.98	9.86	46.216		
2,300.00	2,243.63	2,199.16	2,187.73	9.03	5.77	171.10	100.41	87.92	500.00	489.60	10.40	48.088		
2,400.00	2,337.60	2,288.85	2,276.60	9.74	6.06	170.85	110.94	93.98	544.16	533.23	10.94	49.756		
2,500.00	2,431.57	2,378.55	2,365.47	10.45	6.35	170.64	121.47	100.03	588.34	576.86	11.48	51.253		
2,600.00	2,525.54	2,468.24	2,454.34	11.16	6.64	170.46	132.00	106.08	632.51	620.49	12.02	52.601		
2,700.00	2,619.51	2,557.94	2,543.21	11.88	6.93	170.30	142.53	112.14	676.69	664.12	12.57	53.820		
2,800.00	2,713.48	2,647.63	2,632.08	12.60	7.23	170.16	153.07	118.19	720.88	707.75	13.12	54.928		
2,900.00	2,807.45	2,737.33	2,720.95	13.32	7.52	170.04	163.60	124.25	765.07	751.39	13.68	55.938		
3,000.00	2,901.42	2,827.03	2,809.82	14.04	7.82	169.93	174.13	130.30	809.26	795.03	14.23	56.863		
3,100.00	2,995.39	2,916.72	2,898.69	14.76	8.11	169.83	184.66	136.35	853.45	838.66	14.79	57.712		
3,200.00	3,089.35	3,006.42	2,987.56	15.49	8.41	169.74	195.19	142.41	897.64	882.30	15.35	58.493		
3,300.00	3,183.32	3,096.11	3,076.43	16.21	8.70	169.66	205.72	148.46	941.84	925.94	15.91	59.215		
3,400.00	3,277.29	3,185.81	3,165.30	16.94	9.00	169.59	216.25	154.51	986.04	969.57	16.47	59.883		
3,500.00	3,371.26	3,275.51	3,254.17	17.67	9.30	169.52	226.78	160.57	1,030.24	1,013.21	17.03	60.504		
3,600.00	3,465.23	3,365.20	3,343.04	18.39	9.59	169.46	237.31	166.62	1,074.44	1,056.85	17.59	61.081		
3,700.00	3,559.20	3,454.90	3,431.91	19.12	9.89	169.40	247.85	172.67	1,118.64	1,100.48	18.15	61.620		
3,800.00	3,653.17	3,544.59	3,520.78	19.85	10.19	169.35	258.38	178.73	1,162.84	1,144.12	18.72	62.123		
3,900.00	3,747.14	3,634.29	3,609.65	20.57	10.49	169.31	268.91	184.78	1,207.03	1,187.74	19.29	62.570		
4,000.00	3,841.77	3,724.83	3,699.35	21.10	10.79	169.42	279.54	190.89	1,249.47	1,229.54	19.93	62.685		
4,100.00	3,937.47	3,816.75	3,790.43	21.59	11.09	169.49	290.33	197.10	1,288.78	1,268.23	20.55	62.711		
4,200.00	4,034.12	3,909.96	3,882.78	22.02	11.40	169.51	301.27	203.39	1,324.91	1,303.77	21.14	62.661		
4,300.00	4,131.60	4,004.33	3,976.28	22.41	11.71	169.50	312.35	209.76	1,357.83	1,336.12	21.71	62.545		
4,400.00	4,229.81	4,099.76	4,070.82	22.75	12.03	169.46	323.56	216.20	1,387.50	1,365.25	22.25	62.370		
4,500.00	4,328.61	4,196.11	4,166.29	23.03	12.35	169.38	334.87	222.70	1,413.88	1,391.13	22.75	62.144		
4,600.00	4,427.89	4,293.29	4,262.57	23.27	12.67	169.26	346.28	229.26	1,436.96	1,413.73	23.22	61.872		
4,700.00	4,527.53	4,391.16	4,359.55	23.46	13.00	169.12	357.77	235.86	1,456.70	1,433.04	23.66	61.556		
4,800.00	4,627.40	4,489.62	4,457.09	23.61	13.33	168.94	369.33	242.51	1,473.10	1,449.03	24.07	61.201		
4,900.00	4,727.38	4,588.53	4,555.09	23.71	13.66	61.25	380.95	249.18	1,486.14	1,461.69	24.45	60.787		
5,000.00	4,827.38	4,687.61	4,653.26	23.80	13.99	60.98	392.58	255.87	1,497.75	1,472.87	24.88	60.188		

CC - Min centre to center distance or convergent point, SF - min separation factor, ES - min ellipse separation

<b>Company:</b>	Bayswater	<b>Local Co-ordinate Reference:</b>	Well Windsor LV 17-14
<b>Project:</b>	Windsor	<b>TVD Reference:</b>	WELL @ 4845.00usft (Original Well Elev)
<b>Reference Site:</b>	Windsor LV 14H	<b>MD Reference:</b>	WELL @ 4845.00usft (Original Well Elev)
<b>Site Error:</b>	0.00 usft	<b>North Reference:</b>	True
<b>Reference Well:</b>	Windsor LV 17-14	<b>Survey Calculation Method:</b>	Minimum Curvature
<b>Well Error:</b>	0.00 usft	<b>Output errors are at</b>	2.00 sigma
<b>Reference Wellbore</b>	Windsor LV 17-14	<b>Database:</b>	Compass DB Connection
<b>Reference Design:</b>	Windsor LV 17-14	<b>Offset TVD Reference:</b>	Reference Datum

Offset Design Windsor LV 14H - Windsor LV B-14H - Windsor LV B-14H - Windsor LV B-14H													Offset Site Error:	0.00 usft
Survey Program: 0-MWD													Offset Well Error:	0.00 usft
Reference		Offset		Semi Major Axis			Distance							Warning
Measured Depth (usft)	Vertical Depth (usft)	Measured Depth (usft)	Vertical Depth (usft)	Reference (usft)	Offset (usft)	Highside Toolface (°)	Offset Wellbore Centre +N/-S (usft)	+E/-W (usft)	Between Centres (usft)	Between Ellipses (usft)	Minimum Separation (usft)	Separation Factor		
5,100.00	4,927.38	4,786.68	4,751.43	23.89	14.32	60.72	404.21	262.56	1,509.39	1,484.07	25.32	59.609		
5,200.00	5,027.38	4,885.76	4,849.59	23.99	14.65	60.46	415.84	269.24	1,521.06	1,495.30	25.76	59.047		
5,300.00	5,127.38	4,984.84	4,947.76	24.08	14.98	60.20	427.48	275.93	1,532.77	1,506.57	26.20	58.504		
5,400.00	5,227.38	5,083.92	5,045.92	24.18	15.31	59.95	439.11	282.62	1,544.50	1,517.86	26.64	57.977		
5,500.00	5,327.38	5,183.00	5,144.09	24.28	15.64	59.70	450.74	289.30	1,556.27	1,529.18	27.08	57.467		
5,600.00	5,427.38	5,282.08	5,242.26	24.38	15.97	59.45	462.37	295.99	1,568.06	1,540.53	27.52	56.973		
5,700.00	5,527.38	5,381.16	5,340.42	24.48	16.30	59.21	474.01	302.68	1,579.88	1,551.91	27.97	56.494		
5,800.00	5,627.38	5,480.24	5,438.59	24.59	16.63	58.97	485.64	309.37	1,591.72	1,563.32	28.41	56.030		
5,900.00	5,727.38	5,579.32	5,536.75	24.69	16.96	58.74	497.27	316.05	1,603.60	1,574.75	28.85	55.579		
6,000.00	5,827.38	5,678.39	5,634.92	24.80	17.29	58.51	508.91	322.74	1,615.50	1,586.20	29.30	55.142		
6,100.00	5,927.38	5,777.47	5,733.09	24.91	17.62	58.28	520.54	329.43	1,627.43	1,597.68	29.74	54.718		
6,200.00	6,027.38	5,876.54	5,831.16	25.02	17.95	-1.05	532.17	336.12	1,639.32	1,608.55	30.18	54.292		
6,300.00	6,127.38	5,975.62	5,929.77	25.13	18.28	-0.99	543.80	342.81	1,651.20	1,619.08	30.62	53.867		
6,400.00	6,227.38	6,074.70	6,027.84	25.25	18.61	-0.93	555.43	349.50	1,663.08	1,629.60	31.06	53.442		
6,500.00	6,327.38	6,173.78	6,125.92	25.36	18.94	-0.87	567.06	356.19	1,674.96	1,640.12	31.50	53.017		
6,600.00	6,427.38	6,272.86	6,223.00	25.48	19.27	-0.81	578.69	362.88	1,686.84	1,650.64	31.94	52.592		
6,700.00	6,527.38	6,371.94	6,321.16	25.60	19.60	-0.75	590.32	369.57	1,698.72	1,661.16	32.38	52.167		
6,800.00	6,627.38	6,471.02	6,419.28	25.72	19.93	-0.69	601.95	376.26	1,710.60	1,671.68	32.82	51.742		
6,900.00	6,727.38	6,570.10	6,517.44	25.84	20.26	-0.63	613.58	382.95	1,722.48	1,682.20	33.26	51.317		
7,000.00	6,827.38	6,669.18	6,615.52	25.96	20.59	-0.58	625.21	389.64	1,734.36	1,692.72	33.70	50.892		
7,100.00	6,927.38	6,768.26	6,713.60	26.08	20.92	-0.52	636.84	396.33	1,746.24	1,703.24	34.14	50.467		
7,200.00	7,027.38	6,867.34	6,811.76	26.21	21.25	-0.46	648.47	403.02	1,758.12	1,713.76	34.58	50.042		
7,300.00	7,127.38	6,966.42	6,909.84	26.33	21.58	-0.40	660.10	409.71	1,770.00	1,724.28	35.02	49.617		
7,400.00	7,227.38	7,065.50	7,007.92	26.46	21.91	-0.34	671.73	416.40	1,781.88	1,734.80	35.46	49.192		
7,415.57	7,242.95	7,080.07	7,021.49	26.48	21.99	-0.33	674.11	418.78	1,784.26	1,737.18	35.58	49.142		
7,500.00	7,327.38	7,159.14	7,100.56	26.59	22.32	-0.28	685.74	425.47	1,796.14	1,747.70	36.02	48.717		
7,600.00	7,427.38	7,258.22	7,198.64	26.72	22.65	-0.22	697.37	432.16	1,808.02	1,758.22	36.46	48.292		
7,700.00	7,527.38	7,357.30	7,296.72	26.85	22.98	-0.16	709.00	438.85	1,819.90	1,768.74	36.90	47.867		
7,800.00	7,627.38	7,456.38	7,395.80	26.99	23.31	-0.11	720.63	445.54	1,831.78	1,779.26	37.34	47.442		
7,900.00	7,727.38	7,555.46	7,494.88	27.12	23.64	-0.05	732.26	452.23	1,843.66	1,789.78	37.78	47.017		
7,922.62	7,750.00	7,570.03	7,513.00	27.15	23.72	-0.03	734.64	454.61	1,846.04	1,792.16	37.86	46.967		

<b>Company:</b>	Bayswater	<b>Local Co-ordinate Reference:</b>	Well Windsor LV 17-14
<b>Project:</b>	Windsor	<b>TVD Reference:</b>	WELL @ 4845.00usft (Original Well Elev)
<b>Reference Site:</b>	Windsor LV 14H	<b>MD Reference:</b>	WELL @ 4845.00usft (Original Well Elev)
<b>Site Error:</b>	0.00 usft	<b>North Reference:</b>	True
<b>Reference Well:</b>	Windsor LV 17-14	<b>Survey Calculation Method:</b>	Minimum Curvature
<b>Well Error:</b>	0.00 usft	<b>Output errors are at</b>	2.00 sigma
<b>Reference Wellbore</b>	Windsor LV 17-14	<b>Database:</b>	Compass DB Connection
<b>Reference Design:</b>	Windsor LV 17-14	<b>Offset TVD Reference:</b>	Reference Datum

Offset Design Windsor LV 14H - Windsor LV C-14H - Windsor LV C-14H - Windsor LV C-14H													Offset Site Error:	0.00 usft
Survey Program: 0-MWD													Offset Well Error:	0.00 usft
Reference		Offset		Semi Major Axis			Distance							Warning
Measured Depth (usft)	Vertical Depth (usft)	Measured Depth (usft)	Vertical Depth (usft)	Reference (usft)	Offset (usft)	Highside Toolface (°)	Offset Wellbore Centre +N/-S (usft)	+E/-W (usft)	Between Centres (usft)	Between Ellipses (usft)	Minimum Separation (usft)	Separation Factor		
0.00	0.00	0.00	0.00	0.00	0.00	-179.90	-85.58	-0.14	85.58					
100.00	100.00	100.00	100.00	0.11	0.11	-179.90	-85.58	-0.14	85.58	85.36	0.22	380.769		
200.00	200.00	200.00	200.00	0.34	0.34	-179.90	-85.58	-0.14	85.58	84.91	0.67	126.923		
300.00	300.00	300.00	300.00	0.56	0.56	-179.90	-85.58	-0.14	85.58	84.46	1.12	76.154		
400.00	400.00	400.00	400.00	0.79	0.79	-179.90	-85.58	-0.14	85.58	84.01	1.57	54.396		
500.00	500.00	500.00	500.00	1.01	1.01	-179.90	-85.58	-0.14	85.58	83.56	2.02	42.308		
600.00	600.00	600.00	600.00	1.24	1.24	-179.90	-85.58	-0.14	85.58	83.11	2.47	34.615		
700.00	700.00	700.00	700.00	1.46	1.46	-179.90	-85.58	-0.14	85.58	82.66	2.92	29.290		
800.00	799.98	801.92	801.90	1.67	1.69	-74.54	-84.37	1.21	83.92	80.57	3.36	25.008		
900.00	899.84	903.11	902.94	1.87	1.91	-81.28	-80.78	5.22	79.64	75.85	3.78	21.053		
1,000.00	999.45	1,002.42	1,001.89	2.09	2.14	-93.24	-75.21	11.44	75.32	71.08	4.23	17.795		
1,048.23	1,047.37	1,049.71	1,049.00	2.21	2.26	-100.33	-72.40	14.57	74.65	70.18	4.46	16.727 CC, ES		
1,100.00	1,098.70	1,100.29	1,099.38	2.34	2.38	-108.52	-69.41	17.91	75.54	70.83	4.71	16.042		
1,200.00	1,197.47	1,197.40	1,196.10	2.63	2.62	-124.45	-63.65	24.34	83.05	77.85	5.19	15.993		
1,300.00	1,295.62	1,293.62	1,291.95	2.96	2.86	-138.19	-57.95	30.70	98.59	92.94	5.65	17.443		
1,400.00	1,393.06	1,388.85	1,386.80	3.36	3.11	-148.63	-52.30	37.00	121.32	115.24	6.08	19.940		
1,500.00	1,489.64	1,482.96	1,480.54	3.81	3.35	-156.17	-46.73	43.23	149.96	143.46	6.50	23.075		
1,600.00	1,585.27	1,575.85	1,573.06	4.34	3.60	-161.58	-41.22	49.37	183.52	176.61	6.91	26.577		
1,700.00	1,679.82	1,667.39	1,664.23	4.94	3.84	-165.51	-35.80	55.42	221.35	214.04	7.31	30.282		
1,800.00	1,773.78	1,758.22	1,754.71	5.59	4.08	-168.56	-30.41	61.43	261.48	253.72	7.76	33.694		
1,900.00	1,867.75	1,849.05	1,845.18	6.26	4.33	-170.79	-25.03	67.44	302.08	293.85	8.22	36.739		
2,000.00	1,961.72	1,939.88	1,935.65	6.94	4.57	-172.51	-19.65	73.45	342.97	334.27	8.69	39.453		
2,100.00	2,055.69	2,030.71	2,028.12	7.63	4.81	-173.85	-14.26	79.46	384.06	374.89	9.17	41.877		
2,200.00	2,149.66	2,121.54	2,116.60	8.33	5.06	-174.94	-8.88	85.46	425.29	415.64	9.66	44.047		
2,300.00	2,243.63	2,212.37	2,207.07	9.03	5.31	-175.84	-3.50	91.47	466.64	456.49	10.15	45.995		
2,400.00	2,337.60	2,303.21	2,297.54	9.74	5.55	-176.59	1.88	97.48	508.06	497.42	10.64	47.751		
2,500.00	2,431.57	2,394.04	2,388.01	10.45	5.80	-177.23	7.27	103.49	549.54	538.40	11.14	49.339		
2,600.00	2,525.54	2,484.87	2,478.49	11.16	6.05	-177.78	12.65	109.50	591.07	579.43	11.64	50.780		
2,700.00	2,619.51	2,575.70	2,568.96	11.88	6.29	-178.26	18.03	115.50	632.64	620.50	12.14	52.093		
2,800.00	2,713.48	2,666.53	2,659.43	12.60	6.54	-178.68	23.42	121.51	674.24	661.59	12.65	53.293		
2,900.00	2,807.45	2,757.36	2,749.90	13.32	6.79	-179.05	28.80	127.52	715.87	702.71	13.16	54.393		
3,000.00	2,901.42	2,848.19	2,840.38	14.04	7.04	-179.38	34.18	133.53	757.52	743.85	13.67	55.405		
3,100.00	2,995.39	2,939.03	2,930.85	14.76	7.29	-179.67	39.57	139.54	799.19	785.01	14.19	56.338		
3,200.00	3,089.35	3,029.86	3,021.32	15.49	7.54	-179.94	44.95	145.54	840.88	826.18	14.70	57.201		
3,300.00	3,183.32	3,120.69	3,111.79	16.21	7.79	-179.82	50.33	151.55	882.58	867.36	15.22	58.000		
3,400.00	3,277.29	3,211.52	3,202.27	16.94	8.04	-179.60	55.71	157.56	924.29	908.55	15.73	58.743		
3,500.00	3,371.26	3,302.35	3,292.74	17.67	8.28	-179.40	61.10	163.57	966.01	949.76	16.25	59.435		
3,600.00	3,465.23	3,393.18	3,383.21	18.39	8.53	-179.22	66.48	169.58	1,007.74	990.97	16.77	60.081		
3,700.00	3,559.20	3,484.01	3,473.68	19.12	8.78	-179.05	71.86	175.58	1,049.48	1,032.18	17.29	60.685		
3,800.00	3,653.17	3,574.85	3,564.16	19.85	9.03	-178.89	77.25	181.59	1,091.22	1,073.41	17.82	61.251		
3,900.00	3,747.14	3,665.68	3,654.63	20.57	9.28	-178.75	82.63	187.60	1,132.97	1,114.62	18.35	61.757		
4,000.00	3,841.77	3,757.32	3,745.91	21.10	9.54	-178.63	88.06	193.66	1,172.90	1,153.96	18.94	61.920		
4,100.00	3,937.47	3,850.29	3,838.52	21.59	9.79	-178.52	93.57	199.81	1,209.62	1,190.11	19.51	61.986		
4,200.00	4,034.12	3,944.49	3,932.34	22.02	10.05	-178.41	99.15	206.04	1,243.08	1,223.02	20.06	61.968		
4,300.00	4,131.60	4,039.79	4,027.26	22.41	10.31	-178.30	104.80	212.34	1,273.24	1,252.66	20.58	61.875		
4,400.00	4,229.81	4,136.08	4,123.18	22.75	10.58	-178.19	110.51	218.71	1,300.06	1,278.99	21.06	61.717		
4,500.00	4,328.61	4,233.25	4,219.96	23.03	10.85	-178.08	116.27	225.14	1,323.50	1,301.98	21.52	61.500		
4,600.00	4,427.89	4,331.17	4,317.49	23.27	11.12	-177.97	122.07	231.62	1,343.55	1,321.61	21.94	61.228		
4,700.00	4,527.53	4,429.73	4,415.66	23.46	11.39	-177.85	127.91	238.14	1,360.18	1,337.84	22.33	60.905		
4,800.00	4,627.40	4,528.80	4,514.34	23.61	11.66	-177.73	133.78	244.69	1,373.36	1,350.67	22.69	60.535		
4,900.00	4,727.38	4,628.27	4,613.41	23.71	11.94	-177.62	139.68	251.27	1,383.10	1,360.08	23.02	60.092		
5,000.00	4,827.38	4,727.87	4,712.63	23.80	12.21	-177.51	145.58	257.86	1,391.34	1,367.93	23.42	59.421		

CC - Min centre to center distance or convergent point, SF - min separation factor, ES - min ellipse separation

<b>Company:</b>	Bayswater	<b>Local Co-ordinate Reference:</b>	Well Windsor LV 17-14
<b>Project:</b>	Windsor	<b>TVD Reference:</b>	WELL @ 4845.00usft (Original Well Elev)
<b>Reference Site:</b>	Windsor LV 14H	<b>MD Reference:</b>	WELL @ 4845.00usft (Original Well Elev)
<b>Site Error:</b>	0.00 usft	<b>North Reference:</b>	True
<b>Reference Well:</b>	Windsor LV 17-14	<b>Survey Calculation Method:</b>	Minimum Curvature
<b>Well Error:</b>	0.00 usft	<b>Output errors are at</b>	2.00 sigma
<b>Reference Wellbore</b>	Windsor LV 17-14	<b>Database:</b>	Compass DB Connection
<b>Reference Design:</b>	Windsor LV 17-14	<b>Offset TVD Reference:</b>	Reference Datum

Offset Design Windsor LV 14H - Windsor LV C-14H - Windsor LV C-14H - Windsor LV C-14H													Offset Site Error:	0.00 usft
Survey Program: 0-MWD													Offset Well Error:	0.00 usft
Reference		Offset		Semi Major Axis			Distance							Warning
Measured Depth (usft)	Vertical Depth (usft)	Measured Depth (usft)	Vertical Depth (usft)	Reference (usft)	Offset (usft)	Highside Toolface (°)	Offset Wellbore Centre +N/-S (usft)	+E/-W (usft)	Between Centres (usft)	Between Ellipses (usft)	Minimum Separation (usft)	Separation Factor		
5,100.00	4,927.38	4,827.48	4,811.84	23.89	12.49	69.85	151.48	264.45	1,399.59	1,375.78	23.82	58.768		
5,200.00	5,027.38	4,927.08	4,911.05	23.99	12.76	69.72	157.38	271.03	1,407.85	1,383.63	24.22	58.132		
5,300.00	5,127.38	5,026.68	5,010.26	24.08	13.04	69.58	163.29	277.62	1,416.12	1,391.50	24.62	57.513		
5,400.00	5,227.38	5,126.29	5,109.47	24.18	13.31	69.45	169.19	284.21	1,424.39	1,399.37	25.03	56.911		
5,500.00	5,327.38	5,225.89	5,208.68	24.28	13.59	69.32	175.09	290.80	1,432.68	1,407.24	25.44	56.324		
5,600.00	5,427.38	5,325.50	5,307.89	24.38	13.86	69.20	181.00	297.39	1,440.96	1,415.12	25.85	55.753		
5,700.00	5,527.38	5,425.10	5,407.10	24.48	14.14	69.07	186.90	303.98	1,449.26	1,423.00	26.26	55.196		
5,800.00	5,627.38	5,524.71	5,506.32	24.59	14.41	68.95	192.80	310.56	1,457.56	1,430.89	26.67	54.654		
5,900.00	5,727.38	5,624.31	5,605.53	24.69	14.69	68.82	198.71	317.15	1,465.87	1,438.79	27.08	54.126		
6,000.00	5,827.38	5,723.92	5,704.74	24.80	14.96	68.70	204.61	323.74	1,474.19	1,446.69	27.50	53.612		
6,100.00	5,927.38	5,823.53	5,804.35	24.91	15.23	68.58	210.51	330.32	1,482.51	1,454.61	27.92	53.098		
6,200.00	6,027.38	5,923.14	5,903.96	25.02	15.50	68.46	216.41	336.90	1,490.83	1,462.53	28.34	52.584		
6,300.00	6,127.38	6,022.75	6,003.57	25.13	15.77	68.34	222.31	343.48	1,499.15	1,470.45	28.76	52.070		
6,400.00	6,227.38	6,122.36	6,103.18	25.25	16.04	68.22	228.21	350.06	1,507.47	1,478.37	29.18	51.556		
6,500.00	6,327.38	6,221.97	6,202.79	25.36	16.31	68.10	234.11	356.64	1,515.79	1,486.29	29.60	51.042		
6,600.00	6,427.38	6,321.58	6,302.40	25.48	16.58	67.98	240.01	363.22	1,524.11	1,494.21	30.02	50.528		
6,700.00	6,527.38	6,421.19	6,401.99	25.60	16.85	67.86	245.91	369.80	1,532.43	1,502.13	30.44	50.014		
6,800.00	6,627.38	6,520.80	6,501.60	25.72	17.12	67.74	251.81	376.38	1,540.75	1,510.05	30.86	49.500		
6,900.00	6,727.38	6,620.41	6,601.21	25.84	17.39	67.62	257.71	382.96	1,549.07	1,517.97	31.28	48.986		
7,000.00	6,827.38	6,720.02	6,700.82	25.96	17.66	67.50	263.61	389.54	1,557.39	1,525.89	31.70	48.472		
7,100.00	6,927.38	6,819.63	6,800.43	26.08	17.93	67.38	269.51	396.12	1,565.71	1,533.81	32.12	47.958		
7,200.00	7,027.38	6,919.24	6,900.04	26.21	18.20	67.26	275.41	402.70	1,574.03	1,541.73	32.54	47.444		
7,300.00	7,127.38	7,018.85	7,000.05	26.33	18.47	67.14	281.31	409.28	1,582.35	1,549.65	32.96	46.930		
7,400.00	7,227.38	7,118.46	7,100.06	26.46	18.74	67.02	287.21	415.86	1,590.67	1,557.57	33.38	46.416		
7,413.15	7,240.53	7,131.61	7,113.21	26.48	18.67	67.00	288.36	-1,048.57	617.37	553.08	64.29	9.603 SF		
7,500.00	7,327.38	7,208.23	7,200.04	26.59	18.64	-0.25	288.36	-1,047.66	623.45	559.07	64.38	9.684		
7,600.00	7,427.38	7,307.84	7,300.05	26.72	18.62	-0.15	288.37	-1,046.62	645.02	580.54	64.48	10.003		
7,700.00	7,527.38	7,407.45	7,400.06	26.85	18.59	-0.05	288.38	-1,045.57	680.75	616.16	64.59	10.540		
7,800.00	7,627.38	7,507.06	7,500.07	26.99	18.56	0.04	288.38	-1,044.52	728.55	663.85	64.70	11.261		
7,900.00	7,727.38	7,606.67	7,600.08	27.12	18.54	0.14	288.39	-1,043.48	786.22	721.41	64.81	12.132		
7,922.62	7,750.00	7,629.29	7,620.09	27.15	18.53	0.16	288.39	-1,043.24	800.42	735.59	64.83	12.346		

<b>Company:</b>	Bayswater	<b>Local Co-ordinate Reference:</b>	Well Windsor LV 17-14
<b>Project:</b>	Windsor	<b>TVD Reference:</b>	WELL @ 4845.00usft (Original Well Elev)
<b>Reference Site:</b>	Windsor LV 14H	<b>MD Reference:</b>	WELL @ 4845.00usft (Original Well Elev)
<b>Site Error:</b>	0.00 usft	<b>North Reference:</b>	True
<b>Reference Well:</b>	Windsor LV 17-14	<b>Survey Calculation Method:</b>	Minimum Curvature
<b>Well Error:</b>	0.00 usft	<b>Output errors are at</b>	2.00 sigma
<b>Reference Wellbore</b>	Windsor LV 17-14	<b>Database:</b>	Compass DB Connection
<b>Reference Design:</b>	Windsor LV 17-14	<b>Offset TVD Reference:</b>	Reference Datum

Offset Design Windsor LV 14H - Windsor LV D-14H - Windsor LV D-14H - Windsor LV D-14H													Offset Site Error:	0.00 usft
Survey Program:		0-MWD										Offset Well Error:	0.00 usft	
Reference		Offset		Semi Major Axis			Distance						Warning	
Measured Depth (usft)	Vertical Depth (usft)	Measured Depth (usft)	Vertical Depth (usft)	Reference (usft)	Offset (usft)	Highside Toolface (°)	Offset Wellbore Centre +N/-S (usft)	+E/-W (usft)	Between Centres (usft)	Between Ellipses (usft)	Minimum Separation (usft)	Separation Factor		
0.00	0.00	1.00	0.00	0.00	0.00	-179.93	-114.73	-0.14	114.73	114.73	0.00	N/A		
100.00	100.00	101.00	100.00	0.11	0.11	-179.93	-114.73	-0.14	114.73	114.51	0.23	505.402		
200.00	200.00	201.00	200.00	0.34	0.34	-179.93	-114.73	-0.14	114.73	114.06	0.68	169.587		
300.00	300.00	301.00	300.00	0.56	0.56	-179.93	-114.73	-0.14	114.73	113.61	1.13	101.888		
400.00	400.00	401.00	400.00	0.79	0.79	-179.93	-114.73	-0.14	114.73	113.16	1.58	72.818		
500.00	500.00	501.00	500.00	1.01	1.01	-179.93	-114.73	-0.14	114.73	112.71	2.03	56.654		
600.00	600.00	601.00	600.00	1.24	1.24	-179.93	-114.73	-0.14	114.73	112.26	2.47	46.363		
700.00	700.00	701.00	700.00	1.46	1.46	-179.93	-114.73	-0.14	114.73	111.81	2.92	39.237		
800.00	799.98	800.88	799.86	1.67	1.67	-74.19	-114.73	1.63	114.26	110.91	3.34	34.167		
900.00	899.84	900.11	898.95	1.87	1.88	-79.34	-114.73	6.82	113.44	109.69	3.75	30.237		
943.06	942.77	942.74	941.49	1.97	1.98	-82.37	-114.73	9.60	113.33	109.39	3.94	28.764 CC, ES		
1,000.00	999.45	998.97	997.60	2.09	2.10	-86.85	-114.73	13.28	113.61	109.42	4.19	27.123		
1,100.00	1,098.70	1,097.25	1,095.67	2.34	2.32	-95.78	-114.74	19.71	116.04	111.39	4.66	24.925		
1,200.00	1,197.47	1,194.82	1,193.03	2.63	2.55	-105.57	-114.74	26.09	122.17	117.02	5.15	23.721		
1,300.00	1,295.62	1,291.58	1,289.58	2.96	2.78	-115.38	-114.74	32.42	133.15	127.49	5.66	23.526		
1,400.00	1,393.06	1,387.40	1,385.20	3.36	3.01	-124.45	-114.74	38.69	149.61	143.44	6.17	24.258		
1,500.00	1,489.64	1,482.17	1,479.76	3.81	3.24	-132.34	-114.74	44.89	171.61	164.95	6.66	25.758		
1,600.00	1,585.27	1,575.76	1,573.16	4.34	3.47	-138.92	-114.74	51.01	198.89	191.74	7.14	27.844		
1,700.00	1,679.82	1,668.08	1,665.27	4.94	3.69	-144.30	-114.74	57.05	231.04	223.42	7.61	30.356		
1,800.00	1,773.78	1,759.71	1,756.71	5.59	3.92	-148.90	-114.74	63.04	266.27	258.18	8.09	32.915		
1,900.00	1,867.75	1,851.35	1,848.15	6.26	4.15	-152.44	-114.74	69.04	302.69	294.13	8.57	35.334		
2,000.00	1,961.72	1,942.98	1,939.59	6.94	4.37	-155.23	-114.74	75.03	339.94	330.89	9.05	37.580		
2,100.00	2,055.69	2,034.61	2,031.02	7.63	4.60	-157.48	-114.74	81.03	377.75	368.22	9.53	39.650		
2,200.00	2,149.66	2,126.25	2,122.46	8.33	4.83	-159.33	-114.74	87.02	415.98	405.97	10.01	41.547		
2,300.00	2,243.63	2,217.88	2,213.90	9.03	5.06	-160.87	-114.74	93.02	454.52	444.02	10.50	43.286		
2,400.00	2,337.60	2,309.52	2,305.34	9.74	5.29	-162.17	-114.74	99.01	493.31	482.31	10.99	44.877		
2,500.00	2,431.57	2,401.15	2,396.78	10.45	5.52	-163.28	-114.74	105.00	532.27	520.79	11.49	46.336		
2,600.00	2,525.54	2,492.78	2,488.21	11.16	5.75	-164.24	-114.75	111.00	571.39	559.41	11.98	47.676		
2,700.00	2,619.51	2,584.42	2,579.65	11.88	5.98	-165.08	-114.75	116.99	610.63	598.14	12.49	48.908		
2,800.00	2,713.48	2,676.05	2,671.09	12.60	6.21	-165.82	-114.75	122.99	649.96	636.97	12.99	50.043		
2,900.00	2,807.45	2,767.69	2,762.53	13.32	6.45	-166.47	-114.75	128.98	689.37	675.88	13.49	51.092		
3,000.00	2,901.42	2,859.32	2,853.96	14.04	6.68	-167.06	-114.75	134.97	728.86	714.86	14.00	52.062		
3,100.00	2,995.39	2,950.96	2,945.40	14.76	6.91	-167.58	-114.75	140.97	768.40	753.89	14.51	52.963		
3,200.00	3,089.35	3,042.59	3,036.84	15.49	7.14	-168.05	-114.75	146.96	807.99	792.97	15.02	53.799		
3,300.00	3,183.32	3,134.22	3,128.28	16.21	7.37	-168.48	-114.75	152.96	847.62	832.09	15.53	54.578		
3,400.00	3,277.29	3,225.86	3,219.72	16.94	7.61	-168.87	-114.75	158.95	887.29	871.25	16.04	55.305		
3,500.00	3,371.26	3,317.49	3,311.15	17.67	7.84	-169.23	-114.75	164.94	926.99	910.43	16.56	55.985		
3,600.00	3,465.23	3,409.13	3,402.59	18.39	8.07	-169.56	-114.75	170.94	966.72	949.65	17.07	56.621		
3,700.00	3,559.20	3,500.76	3,494.03	19.12	8.30	-169.86	-114.75	176.93	1,006.47	988.88	17.59	57.218		
3,800.00	3,653.17	3,592.39	3,585.47	19.85	8.54	-170.14	-114.75	182.93	1,046.25	1,028.14	18.11	57.779		
3,900.00	3,747.14	3,684.03	3,676.91	20.57	8.77	-170.41	-114.75	188.92	1,086.04	1,067.40	18.63	58.290		
4,000.00	3,841.77	3,776.44	3,769.12	21.10	9.01	-170.77	-114.75	194.97	1,124.04	1,104.84	19.19	58.572		
4,100.00	3,937.47	3,870.12	3,862.60	21.59	9.24	-171.06	-114.76	201.09	1,158.84	1,139.11	19.73	58.734		
4,200.00	4,034.12	3,964.97	3,957.24	22.02	9.48	-171.31	-114.76	207.30	1,190.40	1,170.15	20.25	58.794		
4,300.00	4,131.60	4,060.86	4,052.93	22.41	9.73	-171.50	-114.76	213.57	1,218.67	1,197.93	20.74	58.763		
4,400.00	4,229.81	4,157.67	4,149.54	22.75	9.98	-171.66	-114.76	219.90	1,243.62	1,222.41	21.20	58.653		
4,500.00	4,328.61	4,255.30	4,246.96	23.03	10.22	-171.77	-114.76	226.29	1,265.21	1,243.57	21.64	58.471		
4,600.00	4,427.89	4,353.63	4,345.07	23.27	10.47	-171.85	-114.76	232.72	1,283.41	1,261.37	22.04	58.223		
4,700.00	4,527.53	4,452.52	4,443.75	23.46	10.73	-171.90	-114.76	239.19	1,298.21	1,275.80	22.42	57.914		
4,800.00	4,627.40	4,551.87	4,542.88	23.61	10.98	-171.92	-114.76	245.69	1,309.59	1,286.83	22.76	57.547		
4,900.00	4,727.38	4,651.54	4,642.35	23.71	11.23	80.62	-114.76	252.21	1,317.53	1,294.45	23.08	57.097		
5,000.00	4,827.38	4,751.33	4,741.92	23.80	11.49	80.67	-114.76	258.74	1,323.98	1,300.52	23.46	56.425		

CC - Min centre to center distance or convergent point, SF - min separation factor, ES - min ellipse separation

<b>Company:</b>	Bayswater	<b>Local Co-ordinate Reference:</b>	Well Windsor LV 17-14
<b>Project:</b>	Windsor	<b>TVD Reference:</b>	WELL @ 4845.00usft (Original Well Elev)
<b>Reference Site:</b>	Windsor LV 14H	<b>MD Reference:</b>	WELL @ 4845.00usft (Original Well Elev)
<b>Site Error:</b>	0.00 usft	<b>North Reference:</b>	True
<b>Reference Well:</b>	Windsor LV 17-14	<b>Survey Calculation Method:</b>	Minimum Curvature
<b>Well Error:</b>	0.00 usft	<b>Output errors are at</b>	2.00 sigma
<b>Reference Wellbore</b>	Windsor LV 17-14	<b>Database:</b>	Compass DB Connection
<b>Reference Design:</b>	Windsor LV 17-14	<b>Offset TVD Reference:</b>	Reference Datum

Offset Design Windsor LV 14H - Windsor LV D-14H - Windsor LV D-14H - Windsor LV D-14H													Offset Site Error: 0.00 usft
Survey Program: O-MWD													Offset Well Error: 0.00 usft
Reference		Offset		Semi Major Axis		Highside Toolface (°)	Offset Wellbore Centre		Distance				Warning
Measured Depth (usft)	Vertical Depth (usft)	Measured Depth (usft)	Vertical Depth (usft)	Reference (usft)	Offset (usft)		+N/-S (usft)	+E/-W (usft)	Between Centres (usft)	Between Ellipses (usft)	Minimum Separation (usft)	Separation Factor	
5,100.00	4,927.38	4,851.11	4,841.49	23.89	11.74	80.71	-114.76	265.26	1,330.44	1,306.58	23.86	55.771	
5,200.00	5,027.38	4,950.90	4,941.06	23.99	12.00	80.76	-114.76	271.79	1,336.89	1,312.65	24.25	55.134	
5,300.00	5,127.38	5,050.88	5,040.63	24.08	12.25	80.80	-114.76	278.32	1,343.35	1,318.71	24.64	54.513	
5,400.00	5,227.38	5,150.47	5,140.21	24.18	12.51	80.85	-114.76	284.85	1,349.81	1,324.77	25.04	53.908	
5,500.00	5,327.38	5,250.26	5,239.78	24.28	12.76	80.89	-114.77	291.37	1,356.27	1,330.83	25.44	53.319	
5,600.00	5,427.38	5,350.04	5,339.35	24.38	13.02	80.94	-114.77	297.90	1,362.73	1,336.89	25.84	52.744	
5,700.00	5,527.38	5,449.83	5,438.92	24.48	13.27	80.98	-114.77	304.43	1,369.19	1,342.95	26.24	52.184	
5,800.00	5,627.38	5,549.81	5,538.49	24.59	13.53	81.02	-114.77	310.95	1,375.65	1,349.01	26.64	51.638	
5,900.00	5,727.38	5,649.40	5,638.07	24.69	13.78	81.06	-114.77	317.48	1,382.11	1,355.07	27.04	51.106	
6,000.00	5,827.38	5,749.18	5,737.64	24.80	14.04	81.11	-114.77	324.01	1,388.57	1,361.12	27.45	50.587	
6,100.00	5,927.38	5,847.69	5,836.94	24.91	13.83	-4.15	-123.37	-1,059.90	1,325.69	1,262.80	62.90	21.078	
6,200.00	6,027.38	5,946.65	5,936.95	25.02	13.51	-3.85	-123.36	-1,058.86	1,227.01	1,164.03	62.97	19.484	
6,300.00	6,127.38	6,045.60	6,036.96	25.13	13.48	-3.56	-123.35	-1,057.81	1,128.55	1,065.50	63.05	17.898	
6,400.00	6,227.38	6,144.55	6,136.97	25.25	13.45	-3.27	-123.35	-1,056.76	1,030.39	987.26	63.13	16.321	
6,500.00	6,327.38	6,243.50	6,236.99	25.36	13.43	-2.98	-123.34	-1,055.72	932.63	869.41	63.21	14.754	
6,600.00	6,427.38	6,342.46	6,337.00	25.48	13.40	-2.69	-123.34	-1,054.67	835.39	772.09	63.29	13.199	
6,700.00	6,527.38	6,441.41	6,437.01	25.60	13.37	-2.40	-123.33	-1,053.62	738.88	675.51	63.37	11.659	
6,800.00	6,627.38	6,540.36	6,537.02	25.72	13.35	-2.11	-123.32	-1,052.57	643.44	579.99	63.45	10.140	
6,900.00	6,727.38	6,639.32	6,637.03	25.84	13.32	-1.82	-123.32	-1,051.53	549.63	486.09	63.54	8.651	
7,000.00	6,827.38	6,738.27	6,737.04	25.96	13.29	-1.53	-123.31	-1,050.48	458.43	394.81	63.62	7.206	
7,100.00	6,927.38	6,837.22	6,837.05	26.08	13.27	-1.23	-123.31	-1,049.43	371.79	308.09	63.70	5.836	
7,200.00	7,027.38	6,936.17	6,937.06	26.21	13.24	-0.94	-123.30	-1,048.39	293.75	229.97	63.78	4.605	
7,300.00	7,127.38	7,035.13	7,037.07	26.33	13.22	-0.65	-123.29	-1,047.34	233.14	169.27	63.87	3.650	
7,400.00	7,227.38	7,134.08	7,137.08	26.46	13.19	-0.36	-123.29	-1,046.29	205.95	142.00	63.95	3.220	
7,409.70	7,237.08	7,143.98	7,237.08	26.47	13.19	-0.33	-123.29	-1,046.19	205.72	141.76	63.96	3.216 SF	
7,500.00	7,327.38	7,243.03	7,237.09	26.59	13.16	-0.07	-123.28	-1,045.24	224.66	160.63	64.03	3.508	
7,600.00	7,427.38	7,341.99	7,337.11	26.72	13.14	0.22	-123.28	-1,044.20	280.23	216.11	64.12	4.371	
7,700.00	7,527.38	7,440.94	7,437.12	26.85	13.11	0.52	-123.27	-1,043.15	355.78	291.58	64.20	5.542	
7,800.00	7,627.38	7,539.89	7,537.13	26.99	13.08	0.81	-123.26	-1,042.10	441.17	376.89	64.29	6.863	
7,900.00	7,727.38	7,638.84	7,637.14	27.12	13.06	1.10	-123.26	-1,041.06	531.68	467.31	64.37	8.260	
7,922.62	7,750.00	7,658.61	7,637.14	27.15	13.05	1.16	-123.26	-1,040.82	552.61	488.21	64.39	8.582	

<b>Company:</b>	Bayswater	<b>Local Co-ordinate Reference:</b>	Well Windsor LV 17-14
<b>Project:</b>	Windsor	<b>TVD Reference:</b>	WELL @ 4845.00usft (Original Well Elev)
<b>Reference Site:</b>	Windsor LV 14H	<b>MD Reference:</b>	WELL @ 4845.00usft (Original Well Elev)
<b>Site Error:</b>	0.00 usft	<b>North Reference:</b>	True
<b>Reference Well:</b>	Windsor LV 17-14	<b>Survey Calculation Method:</b>	Minimum Curvature
<b>Well Error:</b>	0.00 usft	<b>Output errors are at</b>	2.00 sigma
<b>Reference Wellbore</b>	Windsor LV 17-14	<b>Database:</b>	Compass DB Connection
<b>Reference Design:</b>	Windsor LV 17-14	<b>Offset TVD Reference:</b>	Reference Datum

Offset Design Windsor LV 14H - Windsor LV E-14H - Windsor LV E-14H - Windsor LV E-14H											Offset Site Error:	0.00 usft
Survey Program: 0-MWD											Offset Well Error:	0.00 usft
Reference		Offset		Semi Major Axis		Highside Toolface (°)	Distance		Minimum Separation (usft)	Separation Factor	Warning	
Measured Depth (usft)	Vertical Depth (usft)	Measured Depth (usft)	Vertical Depth (usft)	Reference (usft)	Offset (usft)		Offset Wellbore Centre +N/-S (usft)	+E/-W (usft)				
0.00	0.00	1.00	0.00	0.00	0.00	-179.94	-147.52	-0.14	147.52			
100.00	100.00	101.00	100.00	0.11	0.11	-179.94	-147.52	-0.14	147.52	0.23	649.819	
200.00	200.00	201.00	200.00	0.34	0.34	-179.94	-147.52	-0.14	147.52	0.68	218.045	
300.00	300.00	301.00	300.00	0.56	0.56	-179.94	-147.52	-0.14	147.52	1.13	131.001	
400.00	400.00	401.00	400.00	0.79	0.79	-179.94	-147.52	-0.14	147.52	1.58	93.626	
500.00	500.00	501.00	500.00	1.01	1.01	-179.94	-147.52	-0.14	147.52	2.03	72.843	
600.00	600.00	601.00	600.00	1.24	1.24	-179.94	-147.52	-0.14	147.52	2.47	59.611	
666.33	666.33	667.33	666.33	1.39	1.39	-179.94	-147.52	-0.14	147.52	2.77	53.201 CC	
700.00	700.00	700.00	699.00	1.46	1.46	-179.94	-147.52	-0.14	147.52	2.92	50.487 ES	
800.00	799.98	797.47	796.45	1.67	1.66	-73.54	-148.66	1.06	148.20	3.33	44.543	
900.00	899.84	893.47	892.33	1.87	1.84	-76.86	-152.00	4.61	150.51	3.71	40.552	
1,000.00	999.45	989.93	988.45	2.09	2.04	-81.57	-157.43	10.37	155.20	4.13	37.585	
1,100.00	1,098.70	1,088.25	1,086.39	2.34	2.27	-87.54	-163.43	16.73	161.47	4.58	35.223	
1,200.00	1,197.47	1,185.95	1,183.70	2.63	2.50	-94.08	-169.39	23.05	169.69	5.08	33.426	
1,300.00	1,295.62	1,282.89	1,280.25	2.96	2.74	-100.90	-175.31	29.32	180.72	5.61	32.227	
1,400.00	1,393.06	1,378.96	1,375.94	3.36	2.98	-107.69	-181.17	35.54	195.27	6.17	31.637	
1,500.00	1,489.64	1,474.04	1,470.65	3.81	3.22	-114.18	-186.97	41.69	213.86	6.76	31.631	
1,600.00	1,585.27	1,568.02	1,564.25	4.34	3.47	-120.16	-192.71	47.77	236.79	7.36	32.152	
1,700.00	1,679.82	1,660.78	1,656.65	4.94	3.72	-125.53	-198.37	53.77	264.13	7.98	33.118	
1,800.00	1,773.78	1,752.89	1,748.39	5.59	3.96	-130.54	-203.99	59.73	294.76	8.58	34.350	
1,900.00	1,867.75	1,845.00	1,840.14	6.26	4.21	-134.64	-209.61	65.69	327.16	9.17	35.664	
2,000.00	1,961.72	1,937.12	1,931.89	6.94	4.46	-138.02	-215.23	71.65	360.86	9.76	36.988	
2,100.00	2,055.69	2,029.23	2,023.64	7.63	4.71	-140.83	-220.85	77.61	395.51	10.33	38.280	
2,200.00	2,149.66	2,121.34	2,115.39	8.33	4.96	-143.20	-226.47	83.56	430.90	10.90	39.517	
2,300.00	2,243.63	2,213.46	2,207.13	9.03	5.22	-145.22	-232.09	89.52	466.85	11.47	40.690	
2,400.00	2,337.60	2,305.57	2,298.88	9.74	5.47	-146.95	-237.71	95.48	503.24	12.04	41.792	
2,500.00	2,431.57	2,397.68	2,390.63	10.45	5.73	-148.46	-243.33	101.44	539.98	12.61	42.825	
2,600.00	2,525.54	2,489.80	2,482.38	11.16	5.98	-149.77	-248.95	107.40	577.02	13.18	43.790	
2,700.00	2,619.51	2,581.91	2,574.13	11.88	6.24	-150.93	-254.57	113.36	614.28	13.74	44.692	
2,800.00	2,713.48	2,674.02	2,665.87	12.60	6.49	-151.95	-260.20	119.32	651.74	14.31	45.534	
2,900.00	2,807.45	2,766.14	2,757.62	13.32	6.75	-152.87	-265.82	125.28	689.36	14.88	46.320	
3,000.00	2,901.42	2,858.25	2,849.37	14.04	7.01	-153.69	-271.44	131.24	727.12	15.45	47.055	
3,100.00	2,995.39	2,950.36	2,941.12	14.76	7.26	-154.43	-277.06	137.20	765.00	16.02	47.743	
3,200.00	3,089.35	3,042.47	3,032.87	15.49	7.52	-155.11	-282.68	143.16	802.97	16.59	48.387	
3,300.00	3,183.32	3,134.59	3,124.62	16.21	7.78	-155.72	-288.30	149.12	841.04	17.17	48.991	
3,400.00	3,277.29	3,226.70	3,216.36	16.94	8.04	-156.28	-293.92	155.08	879.18	17.74	49.558	
3,500.00	3,371.26	3,318.81	3,308.11	17.67	8.30	-156.79	-299.54	161.03	917.38	18.31	50.091	
3,600.00	3,465.23	3,410.93	3,399.86	18.39	8.56	-157.26	-305.16	166.99	955.64	18.89	50.592	
3,700.00	3,559.20	3,503.04	3,491.61	19.12	8.82	-157.70	-310.78	172.95	993.96	19.46	51.065	
3,800.00	3,653.17	3,595.15	3,583.36	19.85	9.07	-158.10	-316.40	178.91	1,032.32	20.04	51.511	
3,900.00	3,747.14	3,687.27	3,675.11	20.57	9.33	-158.50	-322.02	184.87	1,070.71	20.62	51.928	
4,000.00	3,841.77	3,780.12	3,767.59	21.10	9.60	-159.09	-327.69	190.88	1,107.43	21.18	52.283	
4,100.00	3,937.47	3,874.18	3,861.28	21.59	9.86	-159.57	-333.43	196.96	1,141.11	21.73	52.508	
4,200.00	4,034.12	3,969.34	3,956.05	22.02	10.13	-159.94	-339.24	203.12	1,171.71	22.27	52.622	
4,300.00	4,131.60	4,065.47	4,051.81	22.41	10.40	-160.22	-345.10	209.34	1,199.17	22.78	52.636	
4,400.00	4,229.81	4,162.47	4,148.42	22.75	10.67	-160.41	-351.02	215.61	1,223.47	23.28	52.564	
4,500.00	4,328.61	4,260.21	4,245.78	23.03	10.95	-160.52	-356.99	221.94	1,244.56	23.75	52.412	
4,600.00	4,427.89	4,358.58	4,343.76	23.27	11.23	-160.55	-362.99	228.30	1,262.42	24.19	52.189	
4,700.00	4,527.53	4,457.45	4,442.24	23.46	11.51	-160.51	-369.02	234.70	1,277.05	24.61	51.901	
4,800.00	4,627.40	4,556.71	4,541.10	23.61	11.79	-160.40	-375.08	241.12	1,288.42	24.99	51.550	
4,900.00	4,727.38	4,656.23	4,640.23	23.71	12.07	92.31	-381.15	247.56	1,296.54	25.36	51.118	
5,000.00	4,827.38	4,755.84	4,739.44	23.80	12.35	92.57	-387.23	254.00	1,303.28	25.79	50.528	

CC - Min centre to center distance or convergent point, SF - min separation factor, ES - min ellipse separation

<b>Company:</b>	Bayswater	<b>Local Co-ordinate Reference:</b>	Well Windsor LV 17-14
<b>Project:</b>	Windsor	<b>TVD Reference:</b>	WELL @ 4845.00usft (Original Well Elev)
<b>Reference Site:</b>	Windsor LV 14H	<b>MD Reference:</b>	WELL @ 4845.00usft (Original Well Elev)
<b>Site Error:</b>	0.00 usft	<b>North Reference:</b>	True
<b>Reference Well:</b>	Windsor LV 17-14	<b>Survey Calculation Method:</b>	Minimum Curvature
<b>Well Error:</b>	0.00 usft	<b>Output errors are at</b>	2.00 sigma
<b>Reference Wellbore</b>	Windsor LV 17-14	<b>Database:</b>	Compass DB Connection
<b>Reference Design:</b>	Windsor LV 17-14	<b>Offset TVD Reference:</b>	Reference Datum

Offset Design Windsor LV 14H - Windsor LV E-14H - Windsor LV E-14H - Windsor LV E-14H													Offset Site Error:	0.00 usft
Survey Program: 0-MWD													Offset Well Error:	0.00 usft
Reference		Offset		Semi Major Axis			Distance							Warning
Measured Depth (usft)	Vertical Depth (usft)	Measured Depth (usft)	Vertical Depth (usft)	Reference (usft)	Offset (usft)	Highside Toolface (°)	Offset Wellbore Centre +N/-S (usft)	+E/-W (usft)	Between Centres (usft)	Between Ellipses (usft)	Minimum Separation (usft)	Separation Factor		
5,100.00	4,927.38	4,855.44	4,838.65	23.89	12.63	92.82	-393.31	260.45	1,310.04	1,283.81	26.22	49.956		
5,200.00	5,027.38	4,955.04	4,937.86	23.99	12.91	93.07	-399.38	266.89	1,316.82	1,290.17	26.65	49.403		
5,300.00	5,127.38	5,054.65	5,037.07	24.08	13.20	93.32	-405.46	273.33	1,323.63	1,296.55	27.09	48.866		
5,400.00	5,227.38	5,154.25	5,136.28	24.18	13.48	93.57	-411.54	279.78	1,330.47	1,302.95	27.52	48.346		
5,500.00	5,327.38	5,253.86	5,235.49	24.28	13.76	93.81	-417.62	286.22	1,337.33	1,309.38	27.95	47.841		
5,600.00	5,427.38	5,353.46	5,334.69	24.38	14.04	94.05	-423.70	292.67	1,344.21	1,315.83	28.39	47.352		
5,700.00	5,527.38	5,453.06	5,433.90	24.48	14.32	94.29	-429.77	299.11	1,351.12	1,322.30	28.82	46.877		
5,800.00	5,627.38	5,552.67	5,533.11	24.59	14.61	94.52	-435.85	305.55	1,358.05	1,328.79	29.26	46.416		
5,900.00	5,727.38	5,652.27	5,632.32	24.69	14.89	94.76	-441.93	312.00	1,365.00	1,335.31	29.69	45.969		
6,000.00	5,827.38	5,751.87	5,731.53	24.80	15.17	94.99	-448.01	318.44	1,371.98	1,341.85	30.13	45.534		
6,100.00	5,927.38	5,851.76	5,831.53	24.91	15.47	-176.78	-549.57	-1,057.41	1,378.68	1,263.76	61.92	21.410		
6,200.00	6,027.38	5,951.72	5,931.54	25.02	15.76	-177.05	-549.57	-1,056.36	1,227.19	1,165.14	62.06	19.775		
6,300.00	6,127.38	6,051.67	6,031.55	25.13	16.04	-177.32	-549.56	-1,055.32	1,128.97	1,066.77	62.20	18.151		
6,400.00	6,227.38	6,151.62	6,131.56	25.25	16.33	-177.59	-549.56	-1,054.27	1,031.09	968.75	62.34	16.540		
6,500.00	6,327.38	6,251.58	6,231.57	25.36	16.62	-177.86	-549.55	-1,053.22	933.65	871.17	62.48	14.943		
6,600.00	6,427.38	6,351.53	6,331.58	25.48	16.91	-178.14	-549.54	-1,052.18	836.82	774.20	62.62	13.364		
6,700.00	6,527.38	6,451.48	6,431.59	25.60	17.20	-178.41	-549.54	-1,051.13	740.83	678.06	62.76	11.804		
6,800.00	6,627.38	6,551.43	6,531.60	25.72	17.49	-178.68	-549.53	-1,050.08	646.05	583.15	62.90	10.271		
6,900.00	6,727.38	6,651.39	6,631.61	25.84	17.78	-178.95	-549.52	-1,049.04	553.11	490.07	63.04	8.774		
7,000.00	6,827.38	6,751.34	6,731.62	25.96	18.07	-179.22	-549.52	-1,047.99	463.13	399.94	63.18	7.330		
7,100.00	6,927.38	6,851.29	6,831.64	26.08	18.36	-179.50	-549.51	-1,046.94	378.20	314.88	63.32	5.972		
7,200.00	7,027.38	6,951.25	6,931.65	26.21	18.65	-179.77	-549.51	-1,045.89	302.63	239.16	63.47	4.768		
7,300.00	7,127.38	7,051.20	7,031.66	26.33	18.94	-179.96	-549.50	-1,044.85	245.21	181.60	63.61	3.855		
7,400.00	7,227.38	7,151.15	7,131.67	26.46	19.23	-179.69	-549.49	-1,043.80	220.62	156.87	63.75	3.461		
7,407.28	7,234.66	7,158.08	7,134.67	26.47	19.23	-179.67	-549.49	-1,043.72	220.50	156.74	63.76	3.458 SF		
7,500.00	7,327.38	7,251.10	7,231.68	26.59	19.52	-179.42	-549.49	-1,042.75	239.19	175.30	63.89	3.744		
7,600.00	7,427.38	7,351.06	7,331.69	26.72	19.81	-179.14	-549.48	-1,041.71	292.84	228.80	64.03	4.573		
7,700.00	7,527.38	7,451.01	7,431.70	26.85	20.10	-178.87	-549.48	-1,040.66	366.46	302.28	64.17	5.710		
7,800.00	7,627.38	7,551.96	7,531.71	26.99	20.39	-178.60	-549.47	-1,039.61	450.36	386.04	64.32	7.002		
7,900.00	7,727.38	7,651.92	7,631.72	27.12	20.68	-178.33	-549.46	-1,038.57	539.77	475.32	64.46	8.374		
7,922.62	7,750.00	7,678.68	7,654.73	27.15	20.68	-178.27	-549.46	-1,038.33	560.50	496.01	64.49	8.691		

<b>Company:</b>	Bayswater	<b>Local Co-ordinate Reference:</b>	Well Windsor LV 17-14
<b>Project:</b>	Windsor	<b>TVD Reference:</b>	WELL @ 4845.00usft (Original Well Elev)
<b>Reference Site:</b>	Windsor LV 14H	<b>MD Reference:</b>	WELL @ 4845.00usft (Original Well Elev)
<b>Site Error:</b>	0.00 usft	<b>North Reference:</b>	True
<b>Reference Well:</b>	Windsor LV 17-14	<b>Survey Calculation Method:</b>	Minimum Curvature
<b>Well Error:</b>	0.00 usft	<b>Output errors are at</b>	2.00 sigma
<b>Reference Wellbore</b>	Windsor LV 17-14	<b>Database:</b>	Compass DB Connection
<b>Reference Design:</b>	Windsor LV 17-14	<b>Offset TVD Reference:</b>	Reference Datum

Offset Design				Windsor LV 14H - Windsor LV F-14H - Windsor LV F-14H - Windsor LV F-14H										Offset Site Error: 0.00 usft	
Survey Program: 0-MWD														Offset Well Error: 0.00 usft	
Reference		Offset		Semi Major Axis			Distance							Warning	
Measured Depth (usft)	Vertical Depth (usft)	Measured Depth (usft)	Vertical Depth (usft)	Reference (usft)	Offset (usft)	Highside Toolface (°)	Offset Wellbore Centre +N/-S (usft)	+E/-W (usft)	Between Centres (usft)	Between Ellipses (usft)	Minimum Separation (usft)	Separation Factor			
0.00	0.00	2.00	0.00	0.00	0.00	-179.07	-180.30	-2.92	180.33	180.32	0.00	N/A			
100.00	100.00	102.00	100.00	0.11	0.12	-179.07	-180.30	-2.92	180.33	180.10	0.23	786.551			
200.00	200.00	202.00	200.00	0.34	0.34	-179.07	-180.30	-2.92	180.33	179.65	0.68	265.656			
300.00	300.00	302.00	300.00	0.56	0.57	-179.07	-180.30	-2.92	180.33	179.20	1.13	159.817			
400.00	400.00	402.00	400.00	0.79	0.79	-179.07	-180.30	-2.92	180.33	178.75	1.58	114.285			
500.00	500.00	502.00	500.00	1.01	1.02	-179.07	-180.30	-2.92	180.33	178.30	2.03	88.945			
600.00	600.00	602.00	600.00	1.24	1.24	-179.07	-180.30	-2.92	180.33	177.85	2.48	72.802			
665.99	665.99	667.99	665.99	1.38	1.39	-179.07	-180.30	-2.92	180.33	177.55	2.77	65.016 CC			
700.00	700.00	700.00	698.00	1.46	1.46	-179.07	-180.30	-2.92	180.34	177.41	2.92	61.718 ES			
800.00	799.98	796.58	794.56	1.67	1.65	-72.32	-181.75	-2.17	181.30	177.98	3.32	54.572			
900.00	899.84	890.88	888.74	1.87	1.83	-74.40	-185.94	0.00	184.30	180.61	3.70	49.838			
1,000.00	999.45	984.44	981.97	2.09	2.02	-77.68	-192.82	3.57	189.83	185.73	4.10	46.272			
1,100.00	1,098.70	1,076.88	1,073.79	2.34	2.23	-81.85	-202.27	8.48	198.62	194.07	4.54	43.706			
1,200.00	1,197.47	1,172.55	1,168.53	2.63	2.48	-86.77	-214.08	14.60	210.69	205.65	5.04	41.826			
1,300.00	1,295.62	1,269.27	1,264.30	2.96	2.75	-92.00	-226.12	20.85	224.62	219.04	5.58	40.257			
1,400.00	1,393.06	1,365.20	1,359.28	3.36	3.04	-97.29	-238.06	27.05	240.85	234.68	6.17	39.021			
1,500.00	1,489.64	1,460.20	1,453.34	3.81	3.33	-102.48	-249.88	33.19	259.90	253.08	6.82	38.134			
1,600.00	1,585.27	1,554.17	1,546.39	4.34	3.82	-107.47	-261.58	39.26	282.15	274.65	7.50	37.604			
1,700.00	1,679.82	1,647.00	1,638.29	4.94	3.92	-112.16	-273.14	45.26	307.89	299.66	8.23	37.410			
1,800.00	1,773.78	1,739.21	1,729.59	5.59	4.22	-116.81	-284.62	51.21	336.54	327.57	8.97	37.522			
1,900.00	1,867.75	1,831.42	1,820.89	6.26	4.53	-120.76	-296.09	57.17	367.04	357.33	9.70	37.835			
2,000.00	1,961.72	1,923.63	1,912.19	6.94	4.84	-124.12	-307.57	63.13	398.95	388.53	10.43	38.268			
2,100.00	2,055.69	2,015.84	2,003.49	7.63	5.15	-127.00	-319.05	69.09	431.98	420.84	11.14	38.768			
2,200.00	2,149.66	2,108.05	2,094.79	8.33	5.46	-129.48	-330.53	75.04	465.88	454.03	11.85	39.300			
2,300.00	2,243.63	2,200.27	2,186.09	9.03	5.77	-131.63	-342.01	81.00	500.48	487.91	12.56	39.843			
2,400.00	2,337.60	2,292.48	2,277.39	9.74	6.09	-133.51	-353.49	86.96	535.63	522.37	13.26	40.380			
2,500.00	2,431.57	2,384.69	2,368.69	10.45	6.40	-135.17	-364.96	92.92	571.25	557.28	13.97	40.904			
2,600.00	2,525.54	2,476.90	2,459.99	11.16	6.72	-136.63	-376.44	98.87	607.24	592.57	14.66	41.410			
2,700.00	2,619.51	2,569.11	2,551.29	11.88	7.04	-137.94	-387.92	104.83	643.54	628.18	15.36	41.895			
2,800.00	2,713.48	2,661.32	2,642.59	12.60	7.36	-139.10	-399.40	110.79	680.11	664.05	16.06	42.358			
2,900.00	2,807.45	2,753.53	2,733.89	13.32	7.68	-140.15	-410.88	116.75	716.90	700.15	16.75	42.798			
3,000.00	2,901.42	2,845.75	2,825.19	14.04	8.00	-141.10	-422.36	122.70	753.88	736.43	17.44	43.216			
3,100.00	2,995.39	2,937.96	2,916.49	14.76	8.32	-141.96	-433.84	128.66	791.02	772.88	18.14	43.612			
3,200.00	3,089.35	3,030.17	3,007.79	15.49	8.64	-142.74	-445.31	134.62	828.31	809.48	18.83	43.987			
3,300.00	3,183.32	3,122.38	3,099.09	16.21	8.96	-143.46	-456.79	140.57	865.72	846.19	19.52	44.343			
3,400.00	3,277.29	3,214.59	3,190.39	16.94	9.28	-144.11	-468.27	146.53	903.24	883.02	20.22	44.680			
3,500.00	3,371.26	3,306.80	3,281.69	17.67	9.61	-144.72	-479.75	152.49	940.85	919.94	20.91	44.999			
3,600.00	3,465.23	3,399.01	3,372.99	18.39	9.93	-145.28	-491.23	158.45	978.54	956.94	21.60	45.302			
3,700.00	3,559.20	3,491.23	3,464.29	19.12	10.25	-145.80	-502.71	164.40	1,016.32	994.02	22.29	45.589			
3,800.00	3,653.17	3,583.44	3,555.59	19.85	10.57	-146.28	-514.19	170.36	1,054.15	1,031.17	22.99	45.862			
3,900.00	3,747.14	3,675.65	3,646.90	20.57	10.90	-146.76	-525.66	176.32	1,092.05	1,068.37	23.68	46.122			
4,000.00	3,841.77	3,768.56	3,738.89	21.10	11.22	-147.54	-537.23	182.32	1,128.44	1,104.13	24.31	46.421			
4,100.00	3,937.47	3,862.61	3,832.01	21.59	11.55	-148.16	-548.94	188.40	1,162.11	1,137.18	24.93	46.614			
4,200.00	4,034.12	3,957.68	3,926.14	22.02	11.89	-148.64	-560.77	194.54	1,192.98	1,167.44	25.54	46.712			
4,300.00	4,131.60	4,053.67	4,021.18	22.41	12.23	-148.98	-572.72	200.74	1,221.00	1,194.87	26.13	46.727			
4,400.00	4,229.81	4,150.44	4,117.00	22.75	12.57	-149.20	-584.77	206.99	1,246.14	1,219.44	26.70	46.670			
4,500.00	4,328.61	4,247.90	4,213.49	23.03	12.91	-149.30	-596.90	213.29	1,268.38	1,241.13	27.25	46.547			
4,600.00	4,427.89	4,345.90	4,310.53	23.27	13.25	-149.30	-609.10	219.62	1,287.69	1,259.91	27.77	46.365			
4,700.00	4,527.53	4,444.35	4,408.00	23.46	13.60	-149.19	-621.35	225.98	1,304.06	1,275.80	28.27	46.130			
4,800.00	4,627.40	4,543.11	4,505.78	23.61	13.95	-148.97	-633.65	232.36	1,317.52	1,288.78	28.74	45.847			
4,900.00	4,727.38	4,642.07	4,603.77	23.71	14.30	103.87	-645.96	238.75	1,328.07	1,298.89	29.19	45.504			
5,000.00	4,827.38	4,741.08	4,701.80	23.80	14.65	104.32	-658.29	245.15	1,337.42	1,307.74	29.68	45.068			

CC - Min centre to center distance or convergent point, SF - min separation factor, ES - min ellipse separation

<b>Company:</b>	Bayswater	<b>Local Co-ordinate Reference:</b>	Well Windsor LV 17-14
<b>Project:</b>	Windsor	<b>TVD Reference:</b>	WELL @ 4845.00usft (Original Well Elev)
<b>Reference Site:</b>	Windsor LV 14H	<b>MD Reference:</b>	WELL @ 4845.00usft (Original Well Elev)
<b>Site Error:</b>	0.00 usft	<b>North Reference:</b>	True
<b>Reference Well:</b>	Windsor LV 17-14	<b>Survey Calculation Method:</b>	Minimum Curvature
<b>Well Error:</b>	0.00 usft	<b>Output errors are at</b>	2.00 sigma
<b>Reference Wellbore</b>	Windsor LV 17-14	<b>Database:</b>	Compass DB Connection
<b>Reference Design:</b>	Windsor LV 17-14	<b>Offset TVD Reference:</b>	Reference Datum

Offset Design Windsor LV 14H - Windsor LV F-14H - Windsor LV F-14H - Windsor LV F-14H													Offset Site Error: 0.00 usft	
Survey Program: 0-MWD													Offset Well Error: 0.00 usft	
Reference		Offset		Semi Major Axis			Distance						Warning	
Measured Depth (usft)	Vertical Depth (usft)	Measured Depth (usft)	Vertical Depth (usft)	Reference (usft)	Offset (usft)	Highside Toolface (°)	Offset Wellbore Centre +N/-S (usft)	+E/-W (usft)	Between Centres (usft)	Between Ellipses (usft)	Minimum Separation (usft)	Separation Factor		
5,100.00	4,927.38	4,840.09	4,799.83	23.89	15.00	104.76	-670.61	251.55	1,346.85	1,316.69	30.16	44.650		
5,200.00	5,027.38	4,939.11	4,897.86	23.99	15.34	105.20	-682.94	257.94	1,356.36	1,325.71	30.65	44.251		
5,300.00	5,127.38	5,038.12	4,995.90	24.08	15.69	105.63	-695.26	264.34	1,365.95	1,334.81	31.14	43.869		
5,400.00	5,227.38	5,137.13	5,093.93	24.18	16.04	106.05	-707.59	270.74	1,375.61	1,343.99	31.62	43.502		
5,500.00	5,327.38	5,236.14	5,191.96	24.28	16.39	106.47	-719.91	277.13	1,385.35	1,353.24	32.10	43.151		
5,600.00	5,427.38	5,335.15	5,290.00	24.38	16.74	106.88	-732.24	283.53	1,395.16	1,362.57	32.59	42.814		
5,700.00	5,527.38	5,434.16	5,388.03	24.48	17.09	107.29	-744.56	289.93	1,405.04	1,371.98	33.07	42.490		
5,800.00	5,627.38	5,533.18	5,486.06	24.59	17.44	107.69	-756.89	296.32	1,415.00	1,381.45	33.55	42.180		
5,900.00	5,727.38	5,632.19	5,584.10	24.69	17.79	108.09	-769.21	302.72	1,425.02	1,390.99	34.02	41.882		
6,000.00	5,827.38	5,731.20	5,682.13	24.80	18.14	108.48	-781.54	309.12	1,435.10	1,400.60	34.50	41.595		
6,100.00	5,927.38	5,830.21	5,780.16	24.91	18.49	108.86	-793.86	315.51	1,445.26	1,410.28	34.98	41.320		
6,200.00	6,027.38	5,844.44	7,231.10	25.02	39.01	-179.23	-986.70	-1,053.82	1,371.71	1,309.31	62.41	21.980		
6,300.00	6,127.38	5,883.39	7,231.12	25.13	38.98	-179.32	-986.69	-1,052.77	1,284.86	1,222.34	62.52	20.552		
6,400.00	6,227.38	5,882.34	7,231.13	25.25	38.96	-179.41	-986.69	-1,051.72	1,200.04	1,137.42	62.63	19.162		
6,500.00	6,327.38	5,881.30	7,231.14	25.36	38.93	-179.51	-986.68	-1,050.67	1,117.75	1,055.01	62.74	17.816		
6,600.00	6,427.38	5,880.25	7,231.15	25.48	38.91	-179.60	-986.68	-1,049.63	1,038.56	975.71	62.85	16.524		
6,700.00	6,527.38	5,879.20	7,231.16	25.60	38.88	-179.69	-986.67	-1,048.58	963.25	900.28	62.97	15.298		
6,800.00	6,627.38	5,878.15	7,231.17	25.72	38.85	-179.78	-986.66	-1,047.53	892.80	829.72	63.08	14.153		
6,900.00	6,727.38	5,877.10	7,231.18	25.84	38.83	-179.87	-986.66	-1,046.48	828.45	765.25	63.20	13.109		
7,000.00	6,827.38	5,876.05	7,231.19	25.96	38.80	-179.96	-986.65	-1,045.43	771.73	708.42	63.32	12.189		
7,100.00	6,927.38	5,875.00	7,231.20	26.08	38.78	179.95	-986.65	-1,044.38	724.44	661.00	63.44	11.420		
7,200.00	7,027.38	5,873.95	7,231.21	26.21	38.75	179.85	-986.64	-1,043.33	688.51	624.95	63.56	10.833		
7,300.00	7,127.38	5,872.90	7,231.23	26.33	38.72	179.76	-986.63	-1,042.28	665.79	602.11	63.68	10.456		
7,400.00	7,227.38	5,871.85	7,231.24	26.46	38.70	179.67	-986.63	-1,041.23	657.65	593.85	63.80	10.308		
7,403.85	7,231.23	5,871.81	7,231.24	26.47	38.70	179.67	-986.63	-1,041.19	657.64	593.83	63.80	10.307 SF		
7,500.00	7,327.38	5,870.81	7,231.25	26.59	38.67	179.58	-986.62	-1,040.19	664.63	600.70	63.92	10.397		
7,600.00	7,427.38	5,869.76	7,231.26	26.72	38.65	179.49	-986.62	-1,039.14	686.26	622.21	64.05	10.715		
7,700.00	7,527.38	5,868.71	7,231.27	26.85	38.62	179.40	-986.61	-1,038.09	721.23	657.06	64.17	11.239		
7,800.00	7,627.38	5,867.66	7,231.28	26.99	38.60	179.31	-986.60	-1,037.04	767.72	703.42	64.30	11.940		
7,900.00	7,727.38	5,866.61	7,231.29	27.12	38.57	179.22	-986.60	-1,035.99	823.78	759.36	64.43	12.786		
7,922.62	7,750.00	5,866.37	7,231.29	27.15	38.56	179.19	-986.60	-1,035.75	837.60	773.14	64.46	12.995		

<b>Company:</b>	Bayswater	<b>Local Co-ordinate Reference:</b>	Well Windsor LV 17-14
<b>Project:</b>	Windsor	<b>TVD Reference:</b>	WELL @ 4845.00usft (Original Well Elev)
<b>Reference Site:</b>	Windsor LV 14H	<b>MD Reference:</b>	WELL @ 4845.00usft (Original Well Elev)
<b>Site Error:</b>	0.00 usft	<b>North Reference:</b>	True
<b>Reference Well:</b>	Windsor LV 17-14	<b>Survey Calculation Method:</b>	Minimum Curvature
<b>Well Error:</b>	0.00 usft	<b>Output errors are at</b>	2.00 sigma
<b>Reference Wellbore</b>	Windsor LV 17-14	<b>Database:</b>	Compass DB Connection
<b>Reference Design:</b>	Windsor LV 17-14	<b>Offset TVD Reference:</b>	Reference Datum

Offset Design Windsor LV 14H - Windsor LV G-14H - Windsor LV G-14H - Windsor LV G-14H													Offset Site Error:	0.00 usft
Survey Program: 0-MWD													Offset Well Error:	0.00 usft
Reference		Offset		Semi Major Axis		Highside Toolface (°)	Distance		Minimum Separation (usft)	Separation Factor	Warning			
Measured Depth (usft)	Vertical Depth (usft)	Measured Depth (usft)	Vertical Depth (usft)	Reference (usft)	Offset (usft)		Offset Wellbore Centre +N/-S (usft)	+E/-W (usft)						
0.00	0.00	3.00	0.00	0.00	0.00	-179.21	-213.09	-2.92	213.11	213.11	0.00	N/A		
100.00	100.00	103.00	100.00	0.11	0.12	-179.21	-213.09	-2.92	213.11	212.88	0.23	920.529		
200.00	200.00	203.00	200.00	0.34	0.34	-179.21	-213.09	-2.92	213.11	212.43	0.68	312.919		
300.00	300.00	303.00	300.00	0.56	0.57	-179.21	-213.09	-2.92	213.11	211.98	1.13	188.498		
400.00	400.00	403.00	400.00	0.79	0.79	-179.21	-213.09	-2.92	213.11	211.53	1.58	134.871		
500.00	500.00	503.00	500.00	1.01	1.02	-179.21	-213.09	-2.92	213.11	211.08	2.03	104.999		
600.00	600.00	603.00	600.00	1.24	1.24	-179.21	-213.09	-2.92	213.11	210.63	2.48	85.961		
665.64	665.64	668.64	665.64	1.38	1.39	-179.21	-213.09	-2.92	213.11	210.34	2.77	76.818 CC		
700.00	700.00	700.00	697.00	1.46	1.46	-179.21	-213.09	-2.92	213.13	210.21	2.92	72.941 ES		
800.00	799.98	796.19	793.17	1.67	1.65	-72.27	-214.62	-2.41	214.21	210.89	3.32	64.508		
900.00	899.84	889.26	886.12	1.87	1.82	-73.83	-219.01	-0.93	217.43	213.73	3.69	58.884		
1,000.00	999.45	981.68	978.23	2.09	2.01	-76.29	-226.20	1.50	223.11	219.02	4.09	54.527		
1,100.00	1,098.70	1,073.17	1,069.12	2.34	2.22	-79.46	-236.09	4.83	231.77	227.24	4.53	51.192		
1,200.00	1,197.47	1,163.44	1,158.42	2.63	2.45	-83.12	-248.53	9.02	243.97	238.96	5.01	48.705		
1,300.00	1,295.62	1,252.21	1,245.79	2.96	2.72	-87.00	-263.37	14.02	260.26	254.71	5.55	46.931		
1,400.00	1,393.06	1,345.37	1,337.10	3.36	3.04	-91.18	-280.92	19.94	280.29	274.14	6.15	45.554		
1,500.00	1,489.64	1,439.90	1,429.72	3.81	3.39	-95.41	-298.83	25.98	302.42	295.60	6.82	44.343		
1,600.00	1,585.27	1,533.48	1,521.41	4.34	3.75	-99.51	-316.55	31.95	326.88	319.33	7.55	43.292		
1,700.00	1,679.82	1,625.99	1,612.05	4.94	4.11	-103.43	-334.07	37.86	353.97	345.63	8.34	42.435		
1,800.00	1,773.78	1,717.92	1,702.13	5.59	4.49	-107.52	-351.49	43.73	383.41	374.24	9.17	41.823		
1,900.00	1,867.75	1,809.86	1,792.21	6.26	4.86	-111.05	-368.90	49.60	414.50	404.50	10.00	41.452		
2,000.00	1,961.72	1,901.79	1,882.29	6.94	5.25	-114.10	-386.32	55.47	446.89	436.05	10.83	41.246		
2,100.00	2,055.69	1,993.73	1,972.37	7.63	5.84	-116.76	-403.73	61.34	480.32	468.65	11.67	41.153		
2,200.00	2,149.66	2,085.66	2,062.45	8.33	6.03	-119.08	-421.15	67.22	514.59	502.08	12.51	41.139		
2,300.00	2,243.63	2,177.60	2,152.53	9.03	6.42	-121.12	-438.56	73.09	549.53	536.19	13.34	41.180		
2,400.00	2,337.60	2,269.53	2,242.61	9.74	6.82	-122.92	-455.98	78.96	585.04	570.86	14.18	41.257		
2,500.00	2,431.57	2,361.47	2,332.69	10.45	7.22	-124.52	-473.39	84.83	621.01	605.99	15.02	41.358		
2,600.00	2,525.54	2,453.40	2,422.77	11.16	7.62	-125.95	-490.81	90.70	657.37	641.52	15.85	41.476		
2,700.00	2,619.51	2,545.34	2,512.85	11.88	8.02	-127.23	-508.22	96.57	694.05	677.36	16.68	41.602		
2,800.00	2,713.48	2,637.27	2,602.93	12.60	8.42	-128.39	-525.64	102.44	731.01	713.49	17.52	41.735		
2,900.00	2,807.45	2,729.21	2,693.00	13.32	8.82	-129.43	-543.05	108.31	768.20	749.85	18.35	41.869		
3,000.00	2,901.42	2,821.14	2,783.08	14.04	9.23	-130.38	-560.47	114.18	805.60	786.42	19.18	42.004		
3,100.00	2,995.39	2,913.08	2,873.16	14.76	9.63	-131.25	-577.88	120.05	843.18	823.17	20.01	42.137		
3,200.00	3,089.35	3,005.01	2,963.24	15.49	10.04	-132.05	-595.30	125.92	880.91	860.07	20.84	42.268		
3,300.00	3,183.32	3,096.95	3,053.32	16.21	10.44	-132.78	-612.71	131.79	918.78	897.11	21.67	42.396		
3,400.00	3,277.29	3,188.88	3,143.40	16.94	10.85	-133.45	-630.13	137.67	956.76	934.26	22.50	42.520		
3,500.00	3,371.26	3,280.82	3,233.48	17.67	11.26	-134.07	-647.54	143.54	994.86	971.52	23.33	42.641		
3,600.00	3,465.23	3,372.75	3,323.56	18.39	11.67	-134.65	-664.96	149.41	1,033.04	1,008.88	24.16	42.758		
3,700.00	3,559.20	3,464.69	3,413.64	19.12	12.07	-135.18	-682.37	155.28	1,071.31	1,046.32	24.99	42.870		
3,800.00	3,653.17	3,556.62	3,503.72	19.85	12.48	-135.68	-699.79	161.15	1,109.65	1,083.84	25.82	42.979		
3,900.00	3,747.14	3,648.56	3,593.80	20.57	12.89	-136.19	-717.20	167.02	1,148.06	1,121.41	26.65	43.085		
4,000.00	3,841.77	3,741.15	3,684.52	21.10	13.30	-137.10	-734.74	172.93	1,185.19	1,157.80	27.39	43.273		
4,100.00	3,937.47	3,834.80	3,776.28	21.59	13.72	-137.83	-752.48	178.91	1,219.96	1,191.85	28.12	43.389		
4,200.00	4,034.12	3,929.39	3,868.97	22.02	14.14	-138.39	-770.40	184.95	1,252.31	1,223.48	28.83	43.442		
4,300.00	4,131.60	4,024.82	3,962.47	22.41	14.56	-138.79	-788.47	191.05	1,282.17	1,252.66	29.52	43.441		
4,400.00	4,229.81	4,120.97	4,056.68	22.75	14.99	-139.04	-806.69	197.19	1,309.53	1,279.35	30.18	43.392		
4,500.00	4,328.51	4,217.72	4,151.47	23.03	15.42	-139.16	-825.01	203.36	1,334.35	1,303.53	30.81	43.303		
4,600.00	4,427.89	4,314.94	4,246.73	23.27	15.86	-139.16	-843.43	209.57	1,356.63	1,325.21	31.42	43.179		
4,700.00	4,527.53	4,412.53	4,342.35	23.46	16.29	-139.03	-861.92	215.81	1,376.38	1,344.39	31.99	43.025		
4,800.00	4,627.40	4,510.37	4,438.21	23.61	16.73	-138.78	-880.45	222.05	1,393.62	1,361.09	32.53	42.845		
4,900.00	4,727.38	4,608.33	4,534.20	23.71	17.16	-138.12	-899.01	228.31	1,408.38	1,375.35	33.04	42.633		
5,000.00	4,827.38	4,706.31	4,630.20	23.80	17.60	-137.70	-917.57	234.57	1,422.17	1,388.61	33.56	42.374		

CC - Min centre to center distance or convergent point, SF - min separation factor, ES - min ellipse separation

<b>Company:</b>	Bayswater	<b>Local Co-ordinate Reference:</b>	Well Windsor LV 17-14
<b>Project:</b>	Windsor	<b>TVD Reference:</b>	WELL @ 4845.00usft (Original Well Elev)
<b>Reference Site:</b>	Windsor LV 14H	<b>MD Reference:</b>	WELL @ 4845.00usft (Original Well Elev)
<b>Site Error:</b>	0.00 usft	<b>North Reference:</b>	True
<b>Reference Well:</b>	Windsor LV 17-14	<b>Survey Calculation Method:</b>	Minimum Curvature
<b>Well Error:</b>	0.00 usft	<b>Output errors are at</b>	2.00 sigma
<b>Reference Wellbore</b>	Windsor LV 17-14	<b>Database:</b>	Compass DB Connection
<b>Reference Design:</b>	Windsor LV 17-14	<b>Offset TVD Reference:</b>	Reference Datum

Offset Design Windsor LV 14H - Windsor LV G-14H - Windsor LV G-14H - Windsor LV G-14H													Offset Site Error:	0.00 usft
Survey Program: 0-MWD													Offset Well Error:	0.00 usft
Reference		Offset		Semi Major Axis			Distance							Warning
Measured Depth (usft)	Vertical Depth (usft)	Measured Depth (usft)	Vertical Depth (usft)	Reference (usft)	Offset (usft)	Highside Toolface (°)	Offset Wellbore Centre +N-S (usft)	+E-W (usft)	Between Centres (usft)	Between Ellipses (usft)	Minimum Separation (usft)	Separation Factor		
5,100.00	4,927.38	4,804.29	4,726.20	23.89	18.04	115.28	-936.13	240.82	1,436.11	1,402.02	34.09	42.133		
5,200.00	5,027.38	4,902.27	4,822.21	23.99	18.48	115.84	-954.69	247.08	1,450.19	1,415.58	34.60	41.908		
5,300.00	5,127.38	5,000.25	4,918.21	24.08	18.91	116.39	-973.25	253.34	1,464.40	1,429.29	35.12	41.699		
5,400.00	5,227.38	5,098.24	5,014.22	24.18	19.35	116.93	-991.81	259.59	1,478.75	1,443.12	35.63	41.504		
5,500.00	5,327.38	5,196.22	5,110.22	24.28	19.79	117.46	-1,010.37	265.85	1,493.23	1,457.10	36.14	41.322		
5,600.00	5,427.38	5,294.20	5,206.22	24.38	20.23	117.99	-1,028.93	272.11	1,507.84	1,471.20	36.64	41.153		
5,700.00	5,527.38	5,392.18	5,302.23	24.48	20.67	118.50	-1,047.49	278.36	1,522.57	1,485.43	37.14	40.996		
5,800.00	5,627.38	5,490.16	5,398.23	24.59	21.10	119.00	-1,066.05	284.62	1,537.41	1,499.78	37.64	40.849		
5,900.00	5,727.38	5,588.14	5,494.24	24.69	21.54	119.49	-1,084.61	290.88	1,552.37	1,514.25	38.13	40.713		
6,000.00	5,827.38	5,686.13	5,590.24	24.80	21.98	119.98	-1,103.17	297.13	1,567.45	1,528.83	38.62	40.587		
6,100.00	5,927.38	5,784.11	5,686.24	24.91	22.42	120.45	-1,121.73	303.39	1,582.63	1,543.53	39.11	40.469		
6,200.00	6,027.38	5,882.09	5,782.25	25.02	22.86	120.92	-1,140.29	309.65	1,597.92	1,558.33	39.59	40.361		
6,300.00	6,127.38	5,980.07	5,882.25	25.13	23.29	121.39	-1,158.85	315.90	1,613.20	1,573.61	40.07	40.253		
6,400.00	6,227.38	6,078.05	5,982.25	25.25	23.72	121.86	-1,177.41	322.15	1,628.48	1,588.89	40.55	40.145		
6,500.00	6,327.38	6,176.03	6,082.25	25.36	24.15	122.33	-1,195.97	328.40	1,643.76	1,604.17	41.03	40.037		
6,600.00	6,427.38	6,274.01	6,182.25	25.48	24.58	122.80	-1,214.53	334.65	1,659.04	1,619.45	41.51	39.929		
6,700.00	6,527.38	6,372.00	6,282.25	25.60	25.01	123.27	-1,233.09	340.90	1,674.32	1,634.73	42.00	39.821		
6,800.00	6,627.38	6,470.00	6,382.25	25.72	25.44	123.74	-1,251.65	347.15	1,689.60	1,650.01	42.48	39.713		
6,900.00	6,727.38	6,568.00	6,482.25	25.84	25.87	124.21	-1,270.21	353.40	1,704.88	1,665.29	42.96	39.605		
7,000.00	6,827.38	6,666.00	6,582.25	25.96	26.30	124.68	-1,288.77	359.65	1,720.16	1,680.57	43.44	39.497		
7,100.00	6,927.38	6,764.00	6,682.25	26.08	26.73	125.15	-1,307.33	365.90	1,735.44	1,695.85	43.92	39.389		
7,200.00	7,027.38	6,862.00	6,782.25	26.21	27.16	125.62	-1,325.89	372.15	1,750.72	1,711.13	44.40	39.281		
7,300.00	7,127.38	6,960.00	6,882.25	26.33	27.59	126.09	-1,344.45	378.40	1,766.00	1,726.41	44.88	39.173		
7,400.00	7,227.38	7,058.00	6,982.25	26.46	28.02	126.56	-1,363.01	384.65	1,781.28	1,741.69	45.36	39.065		
7,400.46	7,227.84	7,058.46	6,982.71	26.46	28.02	126.56	-1,363.01	384.65	1,781.28	1,741.69	45.36	39.065		
7,500.00	7,327.38	7,156.00	7,082.25	26.59	28.45	127.03	-1,381.57	390.90	1,796.56	1,756.97	45.84	38.957		
7,600.00	7,427.38	7,254.00	7,182.25	26.72	28.88	127.50	-1,400.13	397.15	1,811.84	1,772.25	46.32	38.849		
7,700.00	7,527.38	7,352.00	7,282.25	26.85	29.31	127.97	-1,418.69	403.40	1,827.12	1,787.53	46.80	38.741		
7,800.00	7,627.38	7,450.00	7,382.25	26.98	29.74	128.44	-1,437.25	409.65	1,842.40	1,802.81	47.28	38.633		
7,900.00	7,727.38	7,548.00	7,482.25	27.12	30.17	128.91	-1,455.81	415.90	1,857.68	1,818.09	47.76	38.525		
7,922.62	7,750.00	7,570.62	7,504.87	27.15	30.21	128.95	-1,458.00	417.00	1,860.00	1,820.00	47.80	38.500		

<b>Company:</b>	Bayswater	<b>Local Co-ordinate Reference:</b>	Well Windsor LV 17-14
<b>Project:</b>	Windsor	<b>TVD Reference:</b>	WELL @ 4845.00usft (Original Well Elev)
<b>Reference Site:</b>	Windsor LV 14H	<b>MD Reference:</b>	WELL @ 4845.00usft (Original Well Elev)
<b>Site Error:</b>	0.00 usft	<b>North Reference:</b>	True
<b>Reference Well:</b>	Windsor LV 17-14	<b>Survey Calculation Method:</b>	Minimum Curvature
<b>Well Error:</b>	0.00 usft	<b>Output errors are at</b>	2.00 sigma
<b>Reference Wellbore</b>	Windsor LV 17-14	<b>Database:</b>	Compass DB Connection
<b>Reference Design:</b>	Windsor LV 17-14	<b>Offset TVD Reference:</b>	Reference Datum

Reference Depths are relative to WELL @ 4845.00usft (Original Well E  
Offset Depths are relative to Offset Datum  
Central Meridian is -105.500000

Coordinates are relative to: Windsor LV 17-14  
Coordinate System is US State Plane 1983, Colorado Central Zone  
Grid Convergence at Surface is: 0.41°

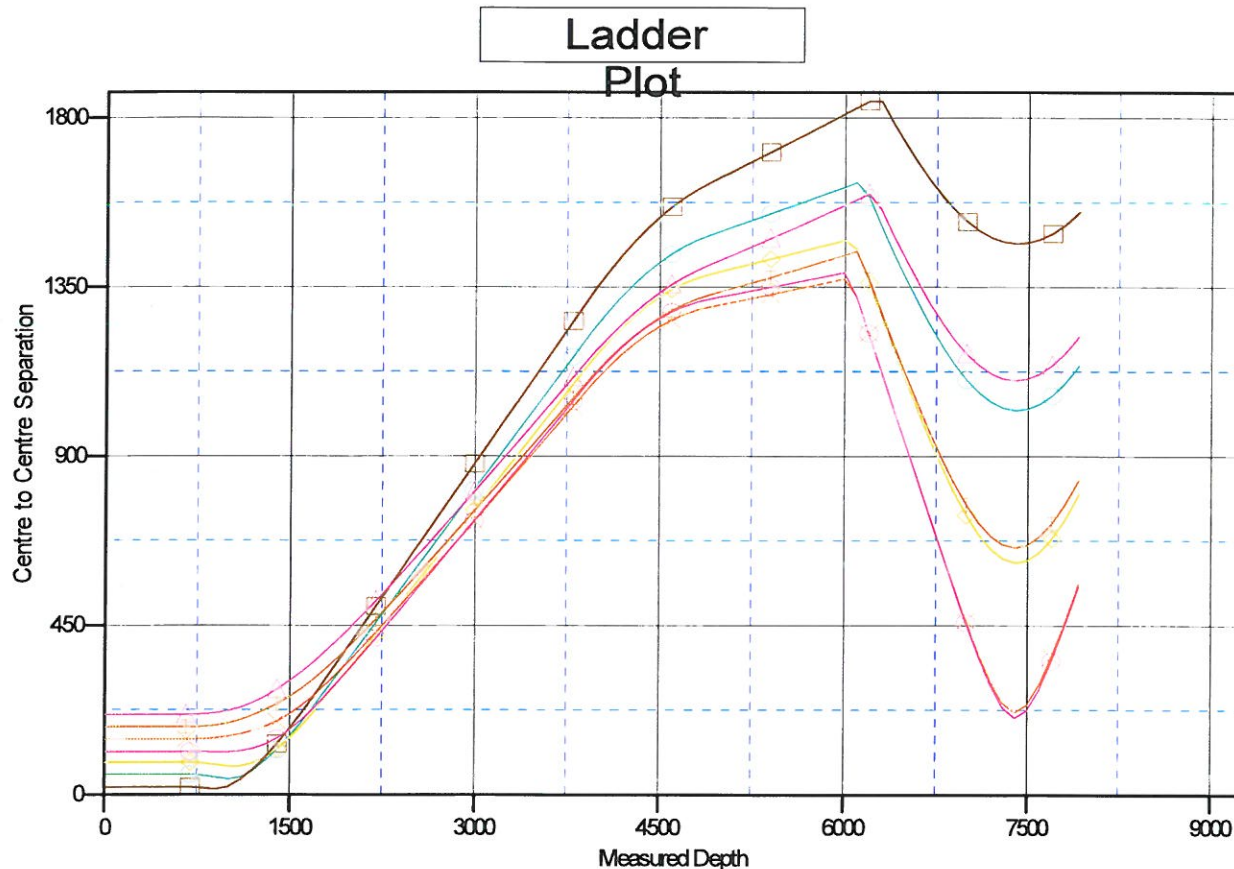

**LEGEND**

14H, Windsor LV B-14H, Windsor LV B-14HV0    ✕    Windsor LV E-14H, Windsor LV E-14H, Windsor LV E-14HV0    ◇    Windsor LV D-14H, Windsor LV D-14H, Windsor LV D-14HV0  
 14H, Windsor LV C-14H, Windsor LV C-14HV0    ▲    Windsor LV G-14H, Windsor LV G-14H, Windsor LV G-14HV0  
 14H, Windsor LV A-14H, Windsor LV A-14HV0    ◆    Windsor LV F-14H, Windsor LV F-14H, Windsor LV F-14HV0

<b>Company:</b>	Bayswater	<b>Local Co-ordinate Reference:</b>	Well Windsor LV 17-14
<b>Project:</b>	Windsor	<b>TVD Reference:</b>	WELL @ 4845.00usft (Original Well Elev)
<b>Reference Site:</b>	Windsor LV 14H	<b>MD Reference:</b>	WELL @ 4845.00usft (Original Well Elev)
<b>Site Error:</b>	0.00 usft	<b>North Reference:</b>	True
<b>Reference Well:</b>	Windsor LV 17-14	<b>Survey Calculation Method:</b>	Minimum Curvature
<b>Well Error:</b>	0.00 usft	<b>Output errors are at</b>	2.00 sigma
<b>Reference Wellbore</b>	Windsor LV 17-14	<b>Database:</b>	Compass DB Connection
<b>Reference Design:</b>	Windsor LV 17-14	<b>Offset TVD Reference:</b>	Reference Datum

Reference Depths are relative to WELL @ 4845.00usft (Original Well E  
Offset Depths are relative to Offset Datum  
Central Meridian is -105.500000

Coordinates are relative to: Windsor LV 17-14  
Coordinate System is US State Plane 1983, Colorado Central Zone  
Grid Convergence at Surface is: 0.41°

