



Bayswater

Windsor

Windsor LV 14H

Windsor LV C-14H

Windsor LV C-14H

Plan: Windsor LV C-14H

Standard Planning Report

09 July, 2013

WELL DETAILS: Windsor LV C-14H										
			Ground Level		4345.00				Spot	
			N/E/W	North	East	Latitude	Longitude			
			0.00	0.00	1968955.136	3180203.810	40.490770			
SECTION DETAILS										
Sec	MD	Inc	Adj	TVD	N/E/W	Dep	True	V-Set	Target	Annotation
1	0.00	0.00	0.00	0.00	0.00	0.00	0.00	0.00	0.00	
2	700.00	0.00	0.00	700.00	0.00	0.00	0.00	0.00	0.00	
3	961.98	5.11	48.22	961.61	7.94	8.30	2.00	41.11	8.27	Start Build 2.00
4	6474.00	5.21	48.22	6474.00	34.11	58.89	8.11	0.00	337.18	Start 5335.52 hold at 961.98 MD
5	7141.74	90.80	219.67	7085.00	378.94	-191.92	10.50	-138.40	22.12	Start DLS 10.00 TFO -138.40
6	11742.00	89.90	219.67	7085.00	378.94	-191.92	10.50	-138.40	22.12	TD at 11742.00
DESIGN TARGET DETAILS										
Name	TVD	N/E/W	Dep	True	Latitude	Longitude	Shape			
LV C-14H Toe up End Pt	7049.00	353.00	-192.61	1968918.761	3175683.751	40.491740	-104.500510	Circle (Radius: 25.00)		
LV C-14H Landing	7085.00	378.94	-191.92	1968918.761	3175683.751	40.491740	-104.500510	Circle (Radius: 15.00)		
plan file target center										

Company Name: Bayswater				
FORMATION TOP DETAILS				
TVD(Push)	MD(Push)	Formation	DipAngle	DpDir
7045.00	7045.00	No Entry	0.00	

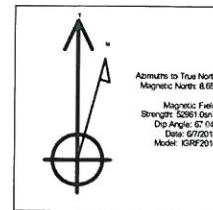

PROJECT DETAILS: Windsor	
Geodetic System:	US State Plane 1983
Datum:	North American Datum 1983
Ellipsoid:	GRS 1980
Zone:	Colorado Central Zone
System Datum:	Mean Sea Level

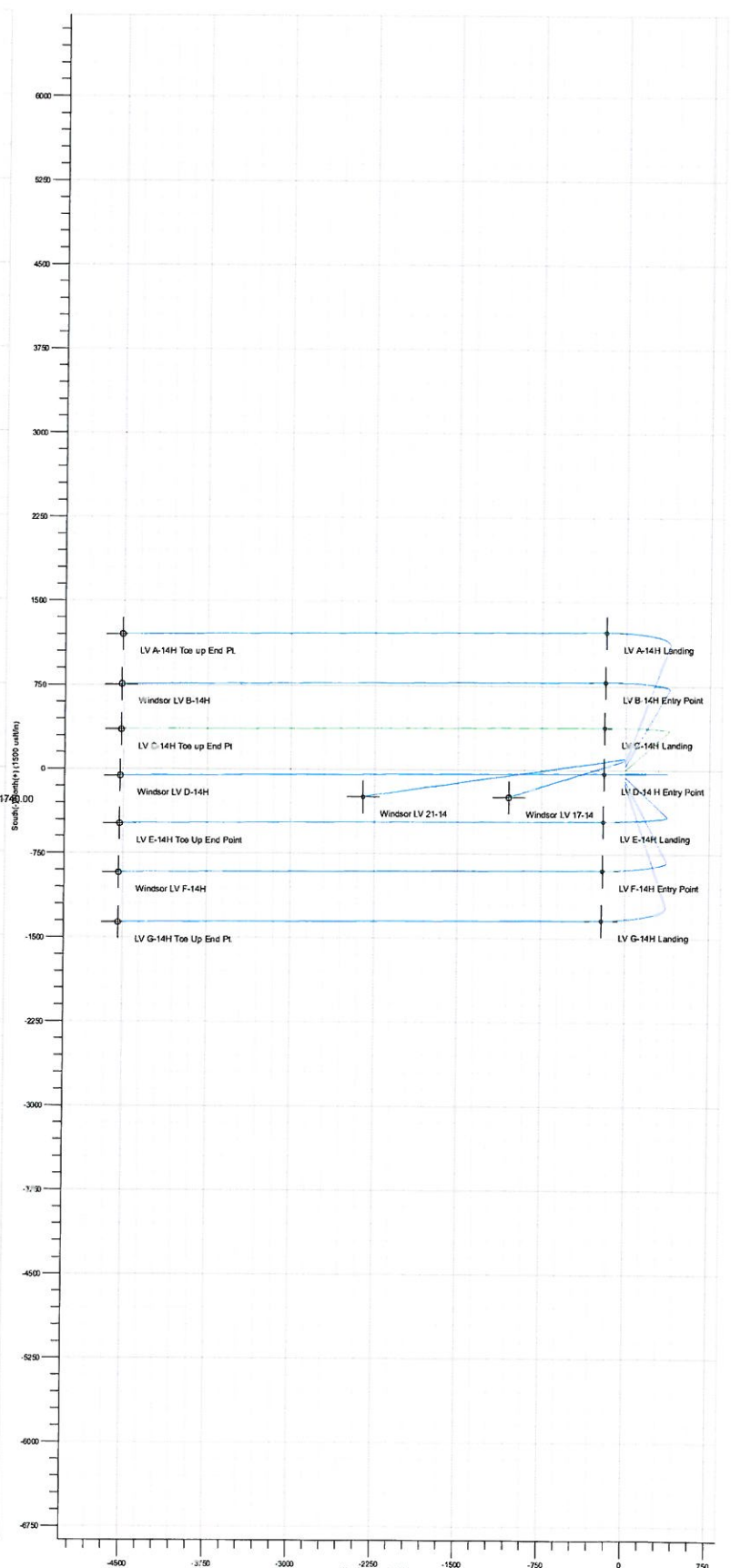
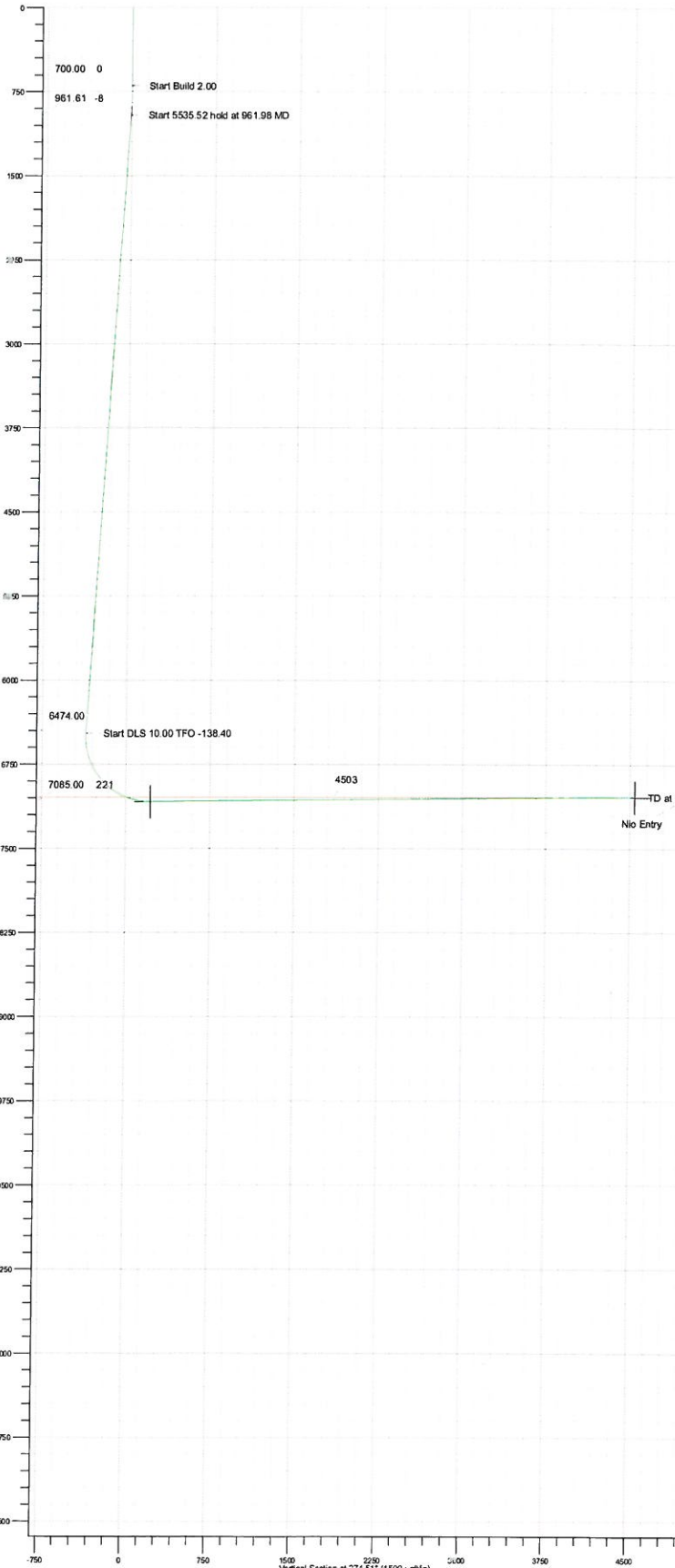

Database:	Compass DB	Local Co-ordinate Reference:	Well Windsor LV C-14H
Company:	Bayswater	TVD Reference:	WELL @ 4845.00usft (Original Well Elev)
Project:	Windsor	MD Reference:	WELL @ 4845.00usft (Original Well Elev)
Site:	Windsor LV 14H	North Reference:	True
Well:	Windsor LV C-14H	Survey Calculation Method:	Minimum Curvature
Wellbore:	Windsor LV C-14H		
Design:	Windsor LV C-14H		

Project	Windsor, Colorado		
Map System:	US State Plane 1983	System Datum:	Mean Sea Level
Geo Datum:	North American Datum 1983		
Map Zone:	Colorado Central Zone		Using geodetic scale factor

Site		Windsor LV 14H			
Site Position:		Northing:	1,968,660.741 usft	Latitude:	40.490950
From:	Lat/Long	Easting:	3,180,209.343 usft	Longitude:	-104.852250
Position Uncertainty:	0.00 usft	Slot Radius:	13-3/16 "	Grid Convergence:	0.41 °

Well	Windsor LV C-14H					
Well Position	+N/-S	-65.59 usft	Northing:	1,968,595.138 usft	Latitude:	40.490770
	+E/-W	0.00 usft	Easting:	3,180,209.810 usft	Longitude:	-104.852250
Position Uncertainty		0.00 usft	Wellhead Elevation:	4,845.00 usft	Ground Level:	4,845.00 usft

Wellbore	Windsor LV C-14H				
Magnetics	Model Name	Sample Date	Declination (°)	Dip Angle (°)	Field Strength (nT)
	IGRF2010	6/7/2013	8.65	67.04	52,961

Design	Windsor LV C-14H				
Audit Notes:					
Version:	1	Phase:	PROTOTYPE	Tie On Depth:	0.00
Vertical Section:	Depth From (TVD)	+N/-S	+E/-W	Direction	
	(usft)	(usft)	(usft)	(°)	
	0.00	0.00	0.00	274.51	

Plan Sections										
Measured Depth (usft)	Inclination (°)	Azimuth (°)	Vertical Depth (usft)	+N/-S (usft)	+E/-W (usft)	Dogleg Rate (°/100usft)	Build Rate (°/100usft)	Turn Rate (°/100usft)	TFO (°)	Target
0.00	0.00	0.00	0.00	0.00	0.00	0.00	0.00	0.00	0.00	
700.00	0.00	0.00	700.00	0.00	0.00	0.00	0.00	0.00	0.00	
961.98	5.24	48.22	961.61	7.98	8.93	2.00	2.00	0.00	48.22	
6,497.50	5.24	48.22	6,474.00	344.77	385.89	0.00	0.00	0.00	0.00	
7,442.74	90.60	269.67	7,085.00	378.90	-191.92	10.00	9.03	-14.66	-138.40	LV C-14H Landing
11,740.00	90.60	269.67	7,040.00	354.08	-4,488.88	0.00	0.00	0.00	88.79	

Database:	Compass DB	Local Co-ordinate Reference:	Well Windsor LV C-14H
Company:	Bayswater	TVD Reference:	WELL @ 4845.00usft (Original Well Elev)
Project:	Windsor	MD Reference:	WELL @ 4845.00usft (Original Well Elev)
Site:	Windsor LV 14H	North Reference:	True
Well:	Windsor LV C-14H	Survey Calculation Method:	Minimum Curvature
Wellbore:	Windsor LV C-14H		
Design:	Windsor LV C-14H		

Planned Survey

Measured Depth (usft)	Inclination (°)	Azimuth (°)	Vertical Depth (usft)	+N/-S (usft)	+E/-W (usft)	Vertical Section (usft)	Dogleg Rate (°/100usft)	Build Rate (°/100usft)	Turn Rate (°/100usft)
0.00	0.00	0.00	0.00	0.00	0.00	0.00	0.00	0.00	0.00
100.00	0.00	0.00	100.00	0.00	0.00	0.00	0.00	0.00	0.00
200.00	0.00	0.00	200.00	0.00	0.00	0.00	0.00	0.00	0.00
300.00	0.00	0.00	300.00	0.00	0.00	0.00	0.00	0.00	0.00
400.00	0.00	0.00	400.00	0.00	0.00	0.00	0.00	0.00	0.00
500.00	0.00	0.00	500.00	0.00	0.00	0.00	0.00	0.00	0.00
600.00	0.00	0.00	600.00	0.00	0.00	0.00	0.00	0.00	0.00
700.00	0.00	0.00	700.00	0.00	0.00	0.00	0.00	0.00	0.00
Start Build 2.00									
800.00	2.00	48.22	799.98	1.16	1.30	-1.21	2.00	2.00	0.00
900.00	4.00	48.22	899.84	4.65	5.20	-4.82	2.00	2.00	0.00
961.98	5.24	48.22	961.61	7.98	8.93	-8.27	2.00	2.00	0.00
Start 5535.52 hold at 961.98 MD									
1,000.00	5.24	48.22	999.48	10.29	11.52	-10.67	0.00	0.00	0.00
1,100.00	5.24	48.22	1,099.06	16.37	18.33	-16.98	0.00	0.00	0.00
1,200.00	5.24	48.22	1,198.64	22.46	25.14	-23.29	0.00	0.00	0.00
1,300.00	5.24	48.22	1,298.22	28.54	31.95	-29.60	0.00	0.00	0.00
1,400.00	5.24	48.22	1,397.80	34.63	38.76	-35.91	0.00	0.00	0.00
1,500.00	5.24	48.22	1,497.39	40.71	45.57	-42.22	0.00	0.00	0.00
1,600.00	5.24	48.22	1,596.97	46.79	52.38	-48.53	0.00	0.00	0.00
1,700.00	5.24	48.22	1,696.55	52.88	59.19	-54.84	0.00	0.00	0.00
1,800.00	5.24	48.22	1,796.13	58.96	66.00	-61.15	0.00	0.00	0.00
1,900.00	5.24	48.22	1,895.72	65.05	72.81	-67.46	0.00	0.00	0.00
2,000.00	5.24	48.22	1,995.30	71.13	79.62	-73.78	0.00	0.00	0.00
2,100.00	5.24	48.22	2,094.88	77.22	86.42	-80.09	0.00	0.00	0.00
2,200.00	5.24	48.22	2,194.46	83.30	93.23	-86.40	0.00	0.00	0.00
2,300.00	5.24	48.22	2,294.04	89.38	100.04	-92.71	0.00	0.00	0.00
2,400.00	5.24	48.22	2,393.63	95.47	106.85	-99.02	0.00	0.00	0.00
2,500.00	5.24	48.22	2,493.21	101.55	113.66	-105.33	0.00	0.00	0.00
2,600.00	5.24	48.22	2,592.79	107.64	120.47	-111.64	0.00	0.00	0.00
2,700.00	5.24	48.22	2,692.37	113.72	127.28	-117.95	0.00	0.00	0.00
2,800.00	5.24	48.22	2,791.96	119.80	134.09	-124.26	0.00	0.00	0.00
2,900.00	5.24	48.22	2,891.54	125.89	140.90	-130.57	0.00	0.00	0.00
3,000.00	5.24	48.22	2,991.12	131.97	147.71	-136.88	0.00	0.00	0.00
3,100.00	5.24	48.22	3,090.70	138.06	154.52	-143.19	0.00	0.00	0.00
3,200.00	5.24	48.22	3,190.28	144.14	161.33	-149.50	0.00	0.00	0.00
3,300.00	5.24	48.22	3,289.87	150.23	168.14	-155.81	0.00	0.00	0.00
3,400.00	5.24	48.22	3,389.45	156.31	174.95	-162.12	0.00	0.00	0.00
3,500.00	5.24	48.22	3,489.03	162.39	181.76	-168.43	0.00	0.00	0.00
3,600.00	5.24	48.22	3,588.61	168.48	188.57	-174.74	0.00	0.00	0.00
3,700.00	5.24	48.22	3,688.19	174.56	195.38	-181.05	0.00	0.00	0.00
3,800.00	5.24	48.22	3,787.78	180.65	202.19	-187.36	0.00	0.00	0.00
3,900.00	5.24	48.22	3,887.36	186.73	209.00	-193.67	0.00	0.00	0.00
4,000.00	5.24	48.22	3,986.94	192.82	215.81	-199.98	0.00	0.00	0.00
4,100.00	5.24	48.22	4,086.52	198.90	222.62	-206.29	0.00	0.00	0.00
4,200.00	5.24	48.22	4,186.11	204.98	229.43	-212.60	0.00	0.00	0.00
4,300.00	5.24	48.22	4,285.69	211.07	236.24	-218.91	0.00	0.00	0.00
4,400.00	5.24	48.22	4,385.27	217.15	243.05	-225.22	0.00	0.00	0.00
4,500.00	5.24	48.22	4,484.85	223.24	249.86	-231.54	0.00	0.00	0.00
4,600.00	5.24	48.22	4,584.43	229.32	256.67	-237.85	0.00	0.00	0.00
4,700.00	5.24	48.22	4,684.02	235.41	263.48	-244.16	0.00	0.00	0.00
4,800.00	5.24	48.22	4,783.60	241.49	270.29	-250.47	0.00	0.00	0.00
4,900.00	5.24	48.22	4,883.18	247.57	277.10	-256.78	0.00	0.00	0.00
5,000.00	5.24	48.22	4,982.76	253.66	283.91	-263.09	0.00	0.00	0.00

Database: Compass DB
Company: Bayswater
Project: Windsor
Site: Windsor LV 14H
Well: Windsor LV C-14H
Wellbore: Windsor LV C-14H
Design: Windsor LV C-14H

Local Co-ordinate Reference: Well Windsor LV C-14H
TVD Reference: WELL @ 4845.00usft (Original Well Elev)
MD Reference: WELL @ 4845.00usft (Original Well Elev)
North Reference: True
Survey Calculation Method: Minimum Curvature

Planned Survey

Measured Depth (usft)	Inclination (°)	Azimuth (°)	Vertical Depth (usft)	+N/-S (usft)	+E/-W (usft)	Vertical Section (usft)	Dogleg Rate (°/100usft)	Build Rate (°/100usft)	Turn Rate (°/100usft)
5,100.00	5.24	48.22	5,082.34	259.74	290.72	-269.40	0.00	0.00	0.00
5,200.00	5.24	48.22	5,181.93	265.83	297.53	-275.71	0.00	0.00	0.00
5,300.00	5.24	48.22	5,281.51	271.91	304.34	-282.02	0.00	0.00	0.00
5,400.00	5.24	48.22	5,381.09	277.99	311.15	-288.33	0.00	0.00	0.00
5,500.00	5.24	48.22	5,480.67	284.08	317.96	-294.64	0.00	0.00	0.00
5,600.00	5.24	48.22	5,580.26	290.16	324.77	-300.95	0.00	0.00	0.00
5,700.00	5.24	48.22	5,679.84	296.25	331.58	-307.26	0.00	0.00	0.00
5,800.00	5.24	48.22	5,779.42	302.33	338.39	-313.57	0.00	0.00	0.00
5,900.00	5.24	48.22	5,879.00	308.42	345.20	-319.88	0.00	0.00	0.00
6,000.00	5.24	48.22	5,978.58	314.50	352.01	-326.19	0.00	0.00	0.00
6,100.00	5.24	48.22	6,078.17	320.58	358.82	-332.50	0.00	0.00	0.00
6,200.00	5.24	48.22	6,177.75	326.67	365.63	-338.81	0.00	0.00	0.00
6,300.00	5.24	48.22	6,277.33	332.75	372.44	-345.12	0.00	0.00	0.00
6,400.00	5.24	48.22	6,376.91	338.84	379.25	-351.43	0.00	0.00	0.00
6,497.50	5.24	48.22	6,474.00	344.77	385.89	-357.59	0.00	0.00	0.00
Start DLS 10.00 TFO -138.40									
6,500.00	5.06	46.33	6,476.50	344.92	386.06	-357.74	10.00	-7.37	-75.37
6,600.00	7.22	298.37	6,576.16	350.96	383.71	-354.93	10.00	2.16	-107.96
6,700.00	16.68	281.40	6,673.91	356.80	364.06	-334.88	10.00	9.47	-16.98
6,800.00	26.54	276.69	6,766.77	362.25	327.71	-298.21	10.00	9.86	-4.71
6,900.00	36.47	274.42	6,851.92	367.16	275.76	-246.03	10.00	9.93	-2.27
7,000.00	46.43	273.02	6,926.79	371.36	209.78	-179.93	10.00	9.96	-1.40
7,100.00	56.40	272.02	6,989.08	374.75	131.79	-101.92	10.00	9.97	-1.00
7,200.00	66.37	271.23	7,036.91	377.20	44.15	-14.35	10.00	9.98	-0.79
7,221.08	68.48	271.08	7,045.00	377.59	24.69	5.07	10.00	9.98	-0.71
Nio Entry									
7,300.00	76.35	270.55	7,068.83	378.65	-50.47	80.09	10.00	9.98	-0.67
7,400.00	86.33	269.93	7,083.86	379.05	-149.21	178.55	10.00	9.98	-0.62
7,442.74	90.60	269.67	7,085.00	378.90	-191.92	221.12	10.00	9.98	-0.61
Start DLS 0.00 TFO 88.79 - LV C-14H Landing									
7,500.00	90.60	269.67	7,084.40	378.57	-249.18	278.18	0.00	0.00	0.00
7,600.00	90.60	269.67	7,083.35	377.99	-349.17	377.81	0.00	0.00	0.00
7,700.00	90.60	269.67	7,082.31	377.41	-449.16	477.45	0.00	0.00	0.00
7,800.00	90.60	269.67	7,081.26	376.83	-549.16	577.09	0.00	0.00	0.00
7,900.00	90.60	269.67	7,080.21	376.25	-649.15	676.73	0.00	0.00	0.00
8,000.00	90.60	269.67	7,079.17	375.67	-749.14	776.36	0.00	0.00	0.00
8,100.00	90.60	269.67	7,078.12	375.10	-849.14	876.00	0.00	0.00	0.00
8,200.00	90.60	269.67	7,077.07	374.52	-949.13	975.64	0.00	0.00	0.00
8,300.00	90.60	269.67	7,076.02	373.94	-1,049.12	1,075.28	0.00	0.00	0.00
8,400.00	90.60	269.67	7,074.98	373.36	-1,149.11	1,174.92	0.00	0.00	0.00
8,500.00	90.60	269.67	7,073.93	372.78	-1,249.11	1,274.55	0.00	0.00	0.00
8,600.00	90.60	269.67	7,072.88	372.20	-1,349.10	1,374.19	0.00	0.00	0.00
8,700.00	90.60	269.67	7,071.84	371.62	-1,449.09	1,473.83	0.00	0.00	0.00
8,800.00	90.60	269.67	7,070.79	371.05	-1,549.09	1,573.47	0.00	0.00	0.00
8,900.00	90.60	269.67	7,069.74	370.47	-1,649.08	1,673.10	0.00	0.00	0.00
9,000.00	90.60	269.67	7,068.69	369.89	-1,749.07	1,772.74	0.00	0.00	0.00
9,100.00	90.60	269.67	7,067.65	369.31	-1,849.06	1,872.38	0.00	0.00	0.00
9,200.00	90.60	269.67	7,066.60	368.73	-1,949.06	1,972.02	0.00	0.00	0.00
9,300.00	90.60	269.67	7,065.55	368.15	-2,049.05	2,071.65	0.00	0.00	0.00
9,400.00	90.60	269.67	7,064.51	367.58	-2,149.04	2,171.29	0.00	0.00	0.00
9,500.00	90.60	269.67	7,063.46	367.00	-2,249.04	2,270.93	0.00	0.00	0.00
9,600.00	90.60	269.67	7,062.41	366.42	-2,349.03	2,370.57	0.00	0.00	0.00
9,700.00	90.60	269.67	7,061.36	365.84	-2,449.02	2,470.21	0.00	0.00	0.00

Database:	Compass DB	Local Co-ordinate Reference:	Well Windsor LV C-14H
Company:	Bayswater	TVD Reference:	WELL @ 4845.00usft (Original Well Elev)
Project:	Windsor	MD Reference:	WELL @ 4845.00usft (Original Well Elev)
Site:	Windsor LV 14H	North Reference:	True
Well:	Windsor LV C-14H	Survey Calculation Method:	Minimum Curvature
Wellbore:	Windsor LV C-14H		
Design:	Windsor LV C-14H		

Planned Survey									
Measured Depth (usft)	Inclination (°)	Azimuth (°)	Vertical Depth (usft)	+N/-S (usft)	+E/-W (usft)	Vertical Section (usft)	Dogleg Rate (°/100usft)	Build Rate (°/100usft)	Turn Rate (°/100usft)
9,800.00	90.60	269.67	7,060.32	365.27	-2,549.01	2,569.84	0.00	0.00	0.00
9,900.00	90.60	269.67	7,059.27	364.69	-2,649.01	2,669.48	0.00	0.00	0.00
10,000.00	90.60	269.67	7,058.22	364.11	-2,749.00	2,769.12	0.00	0.00	0.00
10,100.00	90.60	269.67	7,057.18	363.53	-2,848.99	2,868.76	0.00	0.00	0.00
10,200.00	90.60	269.67	7,056.13	362.96	-2,948.99	2,968.40	0.00	0.00	0.00
10,300.00	90.60	269.67	7,055.08	362.38	-3,048.98	3,068.03	0.00	0.00	0.00
10,400.00	90.60	269.67	7,054.03	361.80	-3,148.97	3,167.67	0.00	0.00	0.00
10,500.00	90.60	269.67	7,052.99	361.22	-3,248.96	3,267.31	0.00	0.00	0.00
10,600.00	90.60	269.67	7,051.94	360.65	-3,348.96	3,366.95	0.00	0.00	0.00
10,700.00	90.60	269.67	7,050.89	360.07	-3,448.95	3,466.58	0.00	0.00	0.00
10,800.00	90.60	269.67	7,049.85	359.49	-3,548.94	3,566.22	0.00	0.00	0.00
10,900.00	90.60	269.67	7,048.80	358.92	-3,648.94	3,665.86	0.00	0.00	0.00
11,000.00	90.60	269.67	7,047.75	358.34	-3,748.93	3,765.50	0.00	0.00	0.00
11,100.00	90.60	269.67	7,046.70	357.76	-3,848.92	3,865.14	0.00	0.00	0.00
11,200.00	90.60	269.67	7,045.66	357.19	-3,948.91	3,964.77	0.00	0.00	0.00
11,300.00	90.60	269.67	7,044.61	356.61	-4,048.91	4,064.41	0.00	0.00	0.00
11,400.00	90.60	269.67	7,043.56	356.04	-4,148.90	4,164.05	0.00	0.00	0.00
11,500.00	90.60	269.67	7,042.51	355.46	-4,248.89	4,263.69	0.00	0.00	0.00
11,600.00	90.60	269.67	7,041.47	354.88	-4,348.89	4,363.33	0.00	0.00	0.00
11,700.00	90.60	269.67	7,040.42	354.31	-4,448.88	4,462.96	0.00	0.00	0.00
11,740.00	90.60	269.67	7,040.00	354.08	-4,488.88	4,502.82	0.00	0.00	0.00
TD at 11740.00 - Toe up End Pt									

Design Targets									
Target Name	Dip Angle (°)	Dip Dir. (°)	TVD (usft)	+N/-S (usft)	+E/-W (usft)	Northing (usft)	Easting (usft)	Latitude	Longitude
Toe up End Pt	0.00	0.00	7,040.00	353.80	-4,522.61	1,968,916.761	3,175,683.751	40.491740	-104.868510
- hit/miss target									
- Shape									
- plan misses target center by 33.73usft at 11740.00usft MD (7040.00 TVD, 354.08 N, -4488.88 E)									
- Circle (radius 25.00)									
LV C-14H Landing	0.00	0.00	7,085.00	378.90	-191.92	1,968,972.750	3,180,015.150	40.491810	-104.852940
- plan hits target center									
- Circle (radius 15.00)									

Formations						
Measured Depth (usft)	Vertical Depth (usft)	Name	Lithology	Dip (°)	Dip Direction (°)	
7,221.08	7,045.00	Nio Entry		0.00		

Database:	Compass DB	Local Co-ordinate Reference:	Well Windsor LV C-14H
Company:	Bayswater	TVD Reference:	WELL @ 4845.00usft (Original Well Elev)
Project:	Windsor	MD Reference:	WELL @ 4845.00usft (Original Well Elev)
Site:	Windsor LV 14H	North Reference:	True
Well:	Windsor LV C-14H	Survey Calculation Method:	Minimum Curvature
Wellbore:	Windsor LV C-14H		
Design:	Windsor LV C-14H		

Plan Annotations				
Measured Depth (usft)	Vertical Depth (usft)	Local Coordinates		Comment
		+N/-S (usft)	+E/-W (usft)	
700.00	700.00	0.00	0.00	Start Build 2.00
961.98	961.61	7.98	8.93	Start 5535.52 hold at 961.98 MD
6,497.50	6,474.00	344.77	385.89	Start DLS 10.00 TFO -138.40
7,442.74	7,085.00	378.90	-191.92	Start DLS 0.00 TFO 88.79
11,740.00	7,040.00	354.08	-4,488.88	TD at 11740.00