

T7N

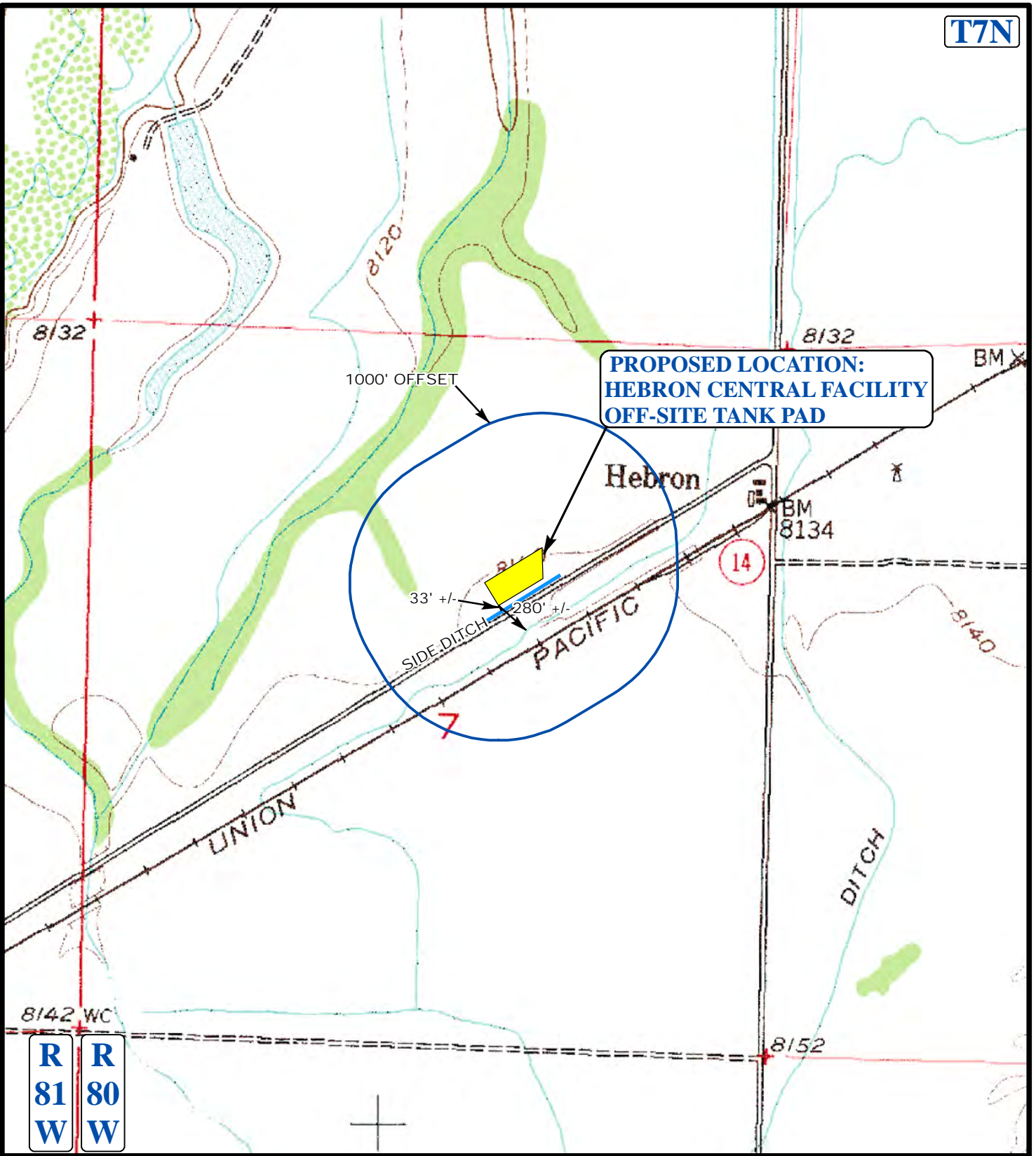

**LEGEND:**

- EXISTING WATER
- 1000' OFFSET BOUNDRY



**EE3 LLC.**

**HEBRON CENTRAL FACILITY  
OFF-SITE TANK PAD  
SECTION 7, T7N, R80W, 6th P.M.  
SW 1/4 NE 1/4**



**Uintah Engineering & Land Surveying**  
85 South 200 East Vernal, Utah 84078  
(435) 789-1017 \* FAX (435) 789-1813

<b>HYDROLOGY MAP</b>	<b>05</b>	<b>14</b>	<b>13</b>
	MONTH	DAY	YEAR
SCALE: 1"= 1000'   DRAWN BY: J.L.H.   REVISED: 06-14-13			

