

DISTURBED AREA = 1.76 ACRES
 CUT SLOPES: 1.5:1
 FILL SLOPES: 1.75:1
 PAD QUANTITIES:
 TOTAL CUT = 11000 CUBIC YARDS
 TOTAL FILL = 9800 CUBIC YARDS
 SPOIL = 1200 (CUT) CUBIC YARDS

COMPACTION SHRINKAGE NOT ACCOUNTED
 FOR IN VOL. CALCS.

TOP SOIL QUANTITY FOR PAD BASED ON
 6 INCH DEPTH: 1425 CUBIC YARDS

Notes:

1. Contact utility line locators before digging. CALL 811
2. Earth work quantities are estimated and should be used at contractors own discretion.
3. Topsoil is included in earth work quantities.
4. Excess material is to be added to the fill slopes on the north side of the pad.

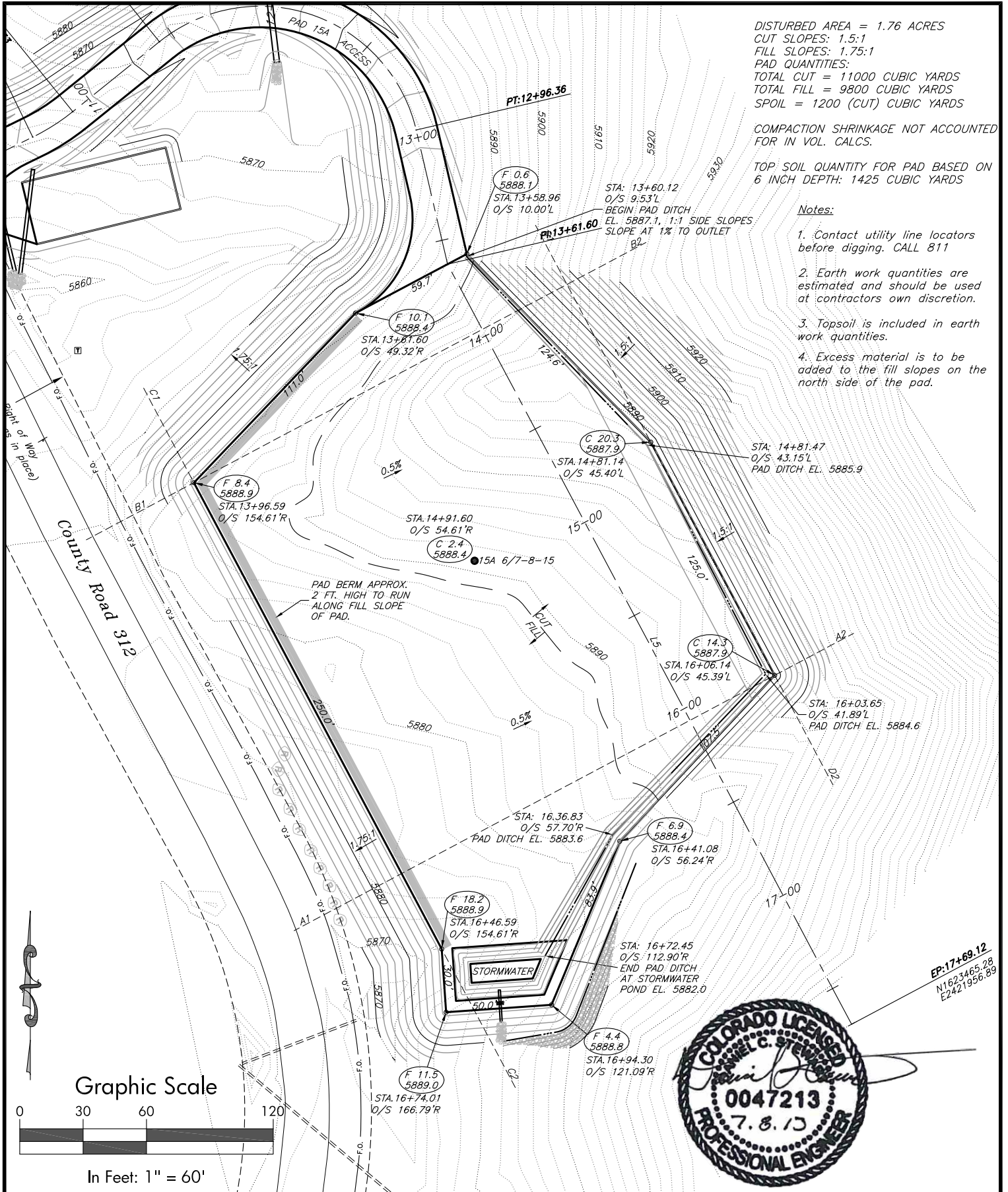

Graphic Scale

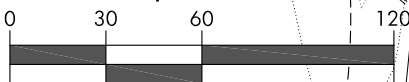

In Feet: 1" = 60'



SGM INC.

118 W. 6th Street, Suite 200
 Glenwood Springs, Colorado 81601
 (970) 945-1004 (FAX 945-5948)
 Aspen, Colorado (970) 925-6727

Scale: 1" = 60'

Sheet 2A of 7

Pad 15A

Dejour Pad 15A Construction Layout

Sections 15&16, T.6 S, R. 91 W., 6th P.M., Garfield County, CO

Job# 2010-112.001 Date: 7.16.13 By: DCS File: Pad 15 2013



EP:17+69.12
 N1623465.28
 E2421956.89