

T7S, R93W, 6th P.M.

ENCANA OIL & GAS (USA) INC

***GENERAL MULTI WELL PLAN
SECTION DRILLING MAP***

***WELL PAD (K22W)
T7S, R93W, 6th P.M.***

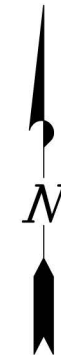
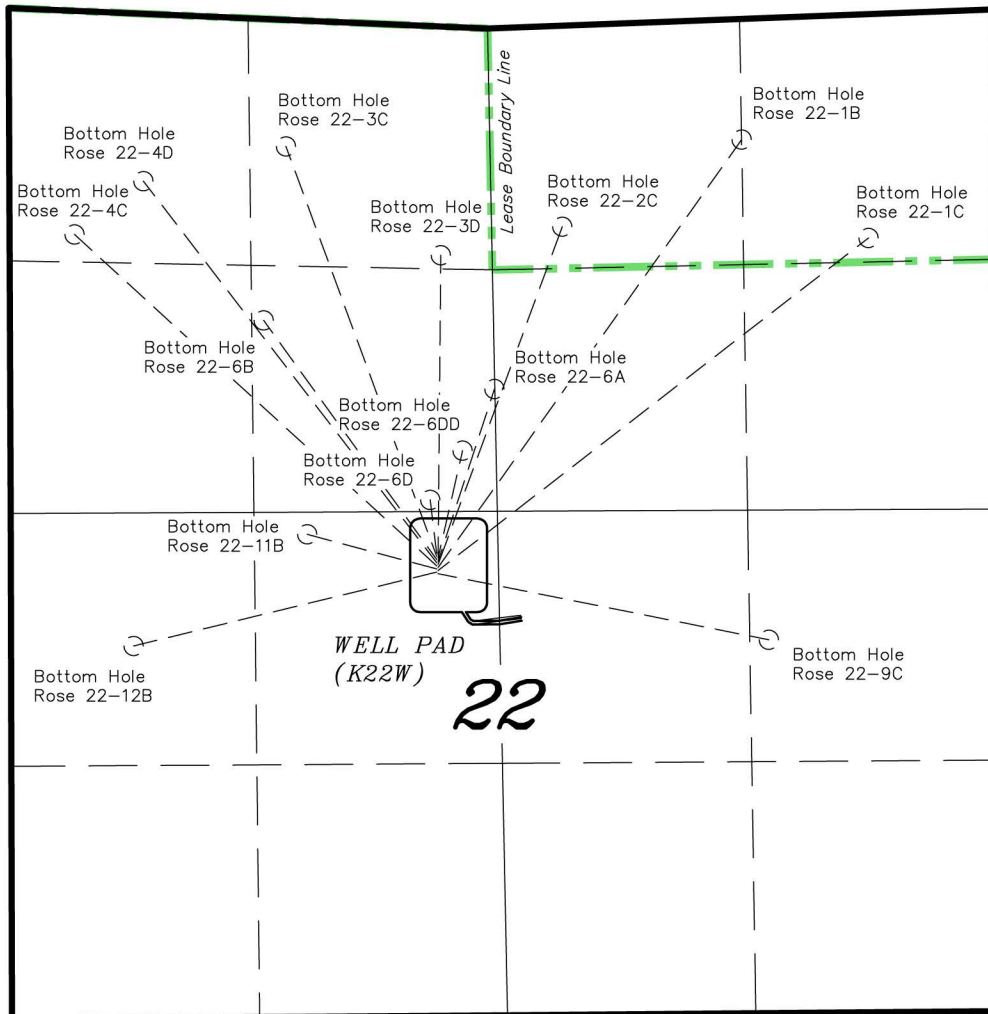

TRI STATE LAND SURVEYING & CONSULTING

180 NORTH VERNAL AVE. — VERNAL, UTAH 84078
(435) 781-2501

DATE SURVEYED: 03-08-13	SURVEYED BY: C.D.S.	SHEET 1 OF 8
DATE DRAWN: 05-06-13	DRAWN BY: M.W.	
REVISED:	SCALE: 1" = 1000'	