



EOG Resources, Inc.
1540 Belco Drive
P.O. Box 250
Big Piney, WY 83113
(307) 276-3331
Fax (307) 276-3335

June 17, 2013

Rick Allison
State of Colorado OGCC
1120 Lincoln St
Suite 801
Denver, CO 80203



RE: Elmer 8-31H & Disposal Facility

Dear Mr. Allison,

Attached you will find the completed Form 19 for the incident which occurred on 6/10/2013 at the above referenced facility.

If you have any further questions or need more information please contact me at 307-276-4854.

Sincerely,

A handwritten signature in blue ink, appearing to read "Shayla A. Schell".

Shayla A. Schell
Sr. Environmental Asst.

cc: File – Well

FORM

19

Rev 6/99

State of Colorado Oil and Gas Conservation Commission

1120 Lincoln Street, Suite 801, Denver, Colorado 80203 (303)894-2100 Fax: (303)894-2109



RECEIVED

JUN 20 2013

COGCC

SPILL/RELEASE REPORT

This form is to be submitted by the party responsible for the oil and gas spill or release. Any spill or release which may impact waters of the State must be reported as soon as practicable; any spill over 20 bbls must be reported within 24 hours and all spills over five bbls must be reported within ten days. Submit a Site Investigation and Remediation Workplan (Form 27) when requested by the Director.

Spill report taken by:

FACILITY ID:

OPERATOR INFORMATION

Name of Operator: EOG Resources, Inc. OGCC Operator No: 27742Address: 600 17th Street STE 1100 NCity: Denver State: CO Zip: 80202Contact Person: Shayla Schell

Phone Numbers

No: 307-276-4854Fax: 307-276-3555E-Mail: shayla_schell@eogresources.com

DESCRIPTION OF SPILL OR RELEASE

Date of Incident: 06/10/2013 Facility Name & No.: Elmer 8-31H & Disposal FacilityType of Facility (well, tank battery, flow line, pit): Salt water disposal facilityWell Name and Number: Elmer 8-31H SIMBA #1-06 SWDAPI Number: 05 123 30584 00 123-3035County: WeldQtrQtr: SW/SE Section: 31Township: 12N Range: 62WMeridian: 6

Specify volume spilled and recovered (in bbls) for the following materials:

Oil spilled: _____ Oil recov'd: _____ Water spilled: 10BBL Water recov'd: 0 Other spilled: 0 Other recov'd: 0Ground Water impacted? ☐ Yes ☒ NoSurface Water impacted? ☐ Yes ☒ NoContained within berm? ☐ Yes ☒ NoArea and vertical extent of spill: 200' x 2'Current land use: Wellsite & Salt Water Disposal FacilityWeather conditions: Windy, no precipitationSoil/geology description: Pipeline right of way & access road barrow ditch, minimal vegetation. Rangeland in process of reclamation and temporarily stabilized.IF LESS THAN A MILE, report distance IN FEET to nearest.... Surface water: 3050' wetlands: n/a buildings: n/aLivestock: n/a water wells: n/a Depth to shallowest ground water: unkwnCause of spill (e.g., equipment failure, human error, etc.): Normal wear and tear

Detailed description of the spill/release incident:

Due to normal wear and tear, a underground flowline from the Elmer disposal facility to the Simba injection well, developed a break in the line which caused a leak of salt water to surface and run downslope. The release area is downslope - 200' X2' and the initial release point areal extent - 20'x15'.

CORRECTIVE ACTION

Describe immediate response (how stopped, contained and recovered):

Well was shut-in to stop any further discharge.

Describe any emergency pits constructed:

none

How was the extent of contamination determined:

Visual inspection and wet soil was observed.

Further remediation activities proposed (attach separate sheet if needed):

The flowline was repaired and any affected soils in this area was turned with the line excavation. The remaining area has been bladed with access road maintenance.

Describe measures taken to prevent problem from reoccurring:

The line chemical treating is under evaluation in order to develop a more preventative corrosion control for the underground line.

OTHER NOTIFICATIONS

List the parties and agencies notified (County, BLM, EPA, DOT, Local Emergency Planning Coordinator or other).

Date	Agency	Contact	Phone	Response
6/10/2012	CDPHE	Greg Stastinos	1-877-518-5608	Written report only

Spill/Release Tracking No: **2145346**

RECEIVED

JUN 20 2013

COGCC

T120N R620W S31

Elmer 08-31H

2/01

T110N R620W S6

Simba 01-06

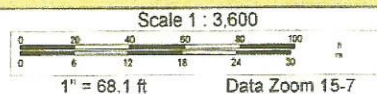

Lease from Elmer to Simba
on 6-10-13

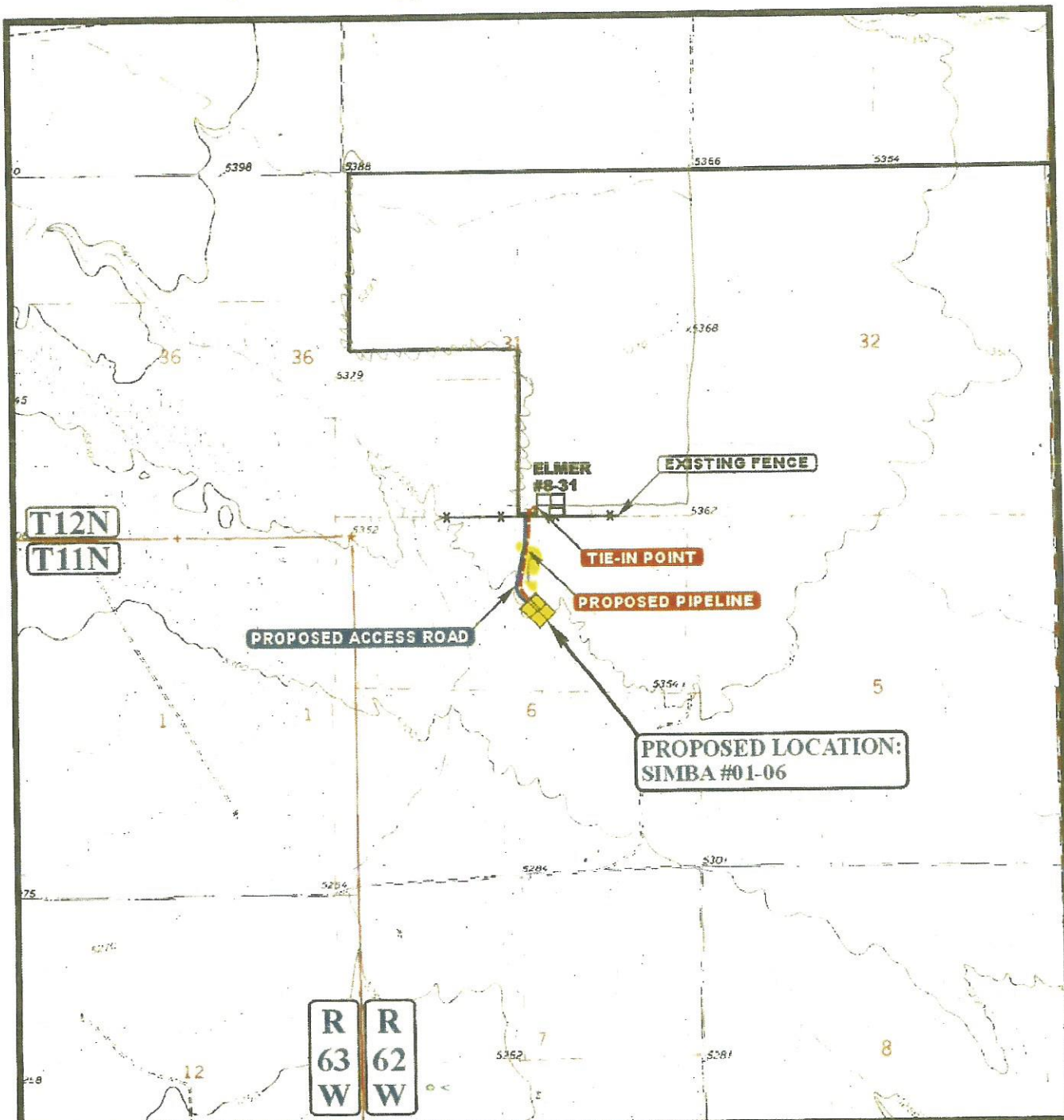

APPROXIMATE TOTAL PIPELINE DISTANCE = 1,708' +/-

LEGEND:

- PROPOSED ACCESS ROAD
- PROPOSED PIPELINE
- EXISTING FENCE



EOG RESOURCES, INC.

SIMBA #01-06
SECTION 6, T11N, R62W, 6th P.M.
1127' FNL 2412' FEL



Uintah Engineering & Land Surveying
85 South 200 East Vernal, Utah 84078
(435) 789-1017 * FAX (435) 789-1813

TOPOGRAPHIC
MAP

11 10 11
MONTH DAY YEAR

SCALE: 1" = 2000' DRAWN BY: B.D.H. REVISED: 00-00-00

D
TOPO