

ConocoPhillips Company

CONSTRUCTION LAYOUT FOR

MURPHY FAMILY #4-64-36-1H & #4-63-31-2H
SECTION 36, T4S, R64W, 6th P.M.
NE 1/4 SE 1/4

FIGURE #1

SCALE: 1" = 100'
DATE: 10-18-12
DRAWN BY: S.R.L.

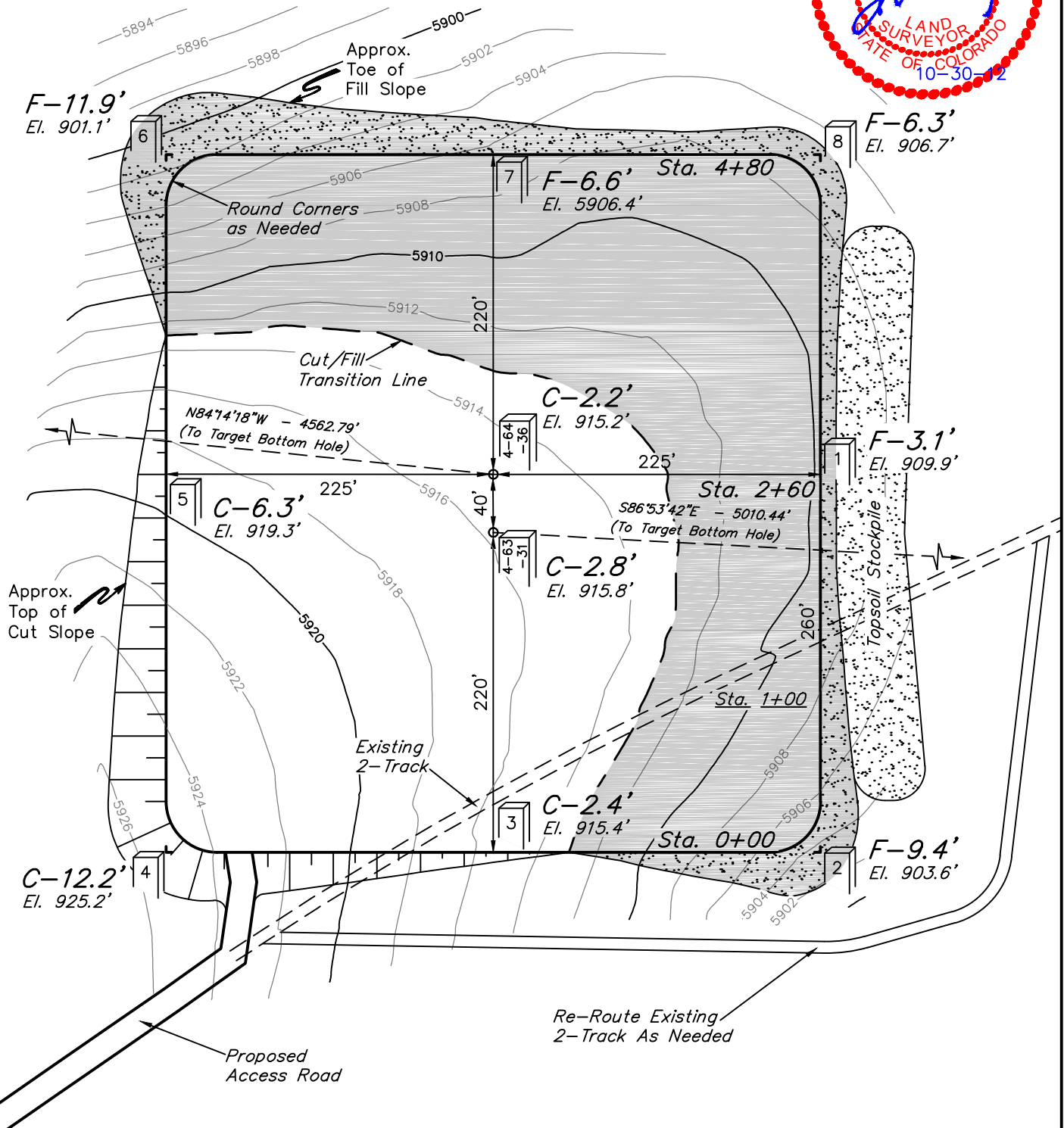

Elev. Ungraded Ground At #4-64-36 Loc. Stake = 5915.2'
FINISHED GRADE ELEV. AT #4-64-36 LOC. STAKE = 5913.0'

UINTAH ENGINEERING & LAND SURVEYING
85 So. 200 East * Vernal, Utah 84078 * (435) 789-1017

ConocoPhillips Company

FIGURE #2

CONSTRUCTION LAYOUT CROSS SECTIONS FOR MURPHY FAMILY #4-64-36-1H & #4-63-31-2H SECTION 36, T4S, R64W, 6th P.M. NE 1/4 SE 1/4

1" = 40'
X-Section
Scale
1" = 100'

DATE: 10-18-12
DRAWN BY: S.R.L.

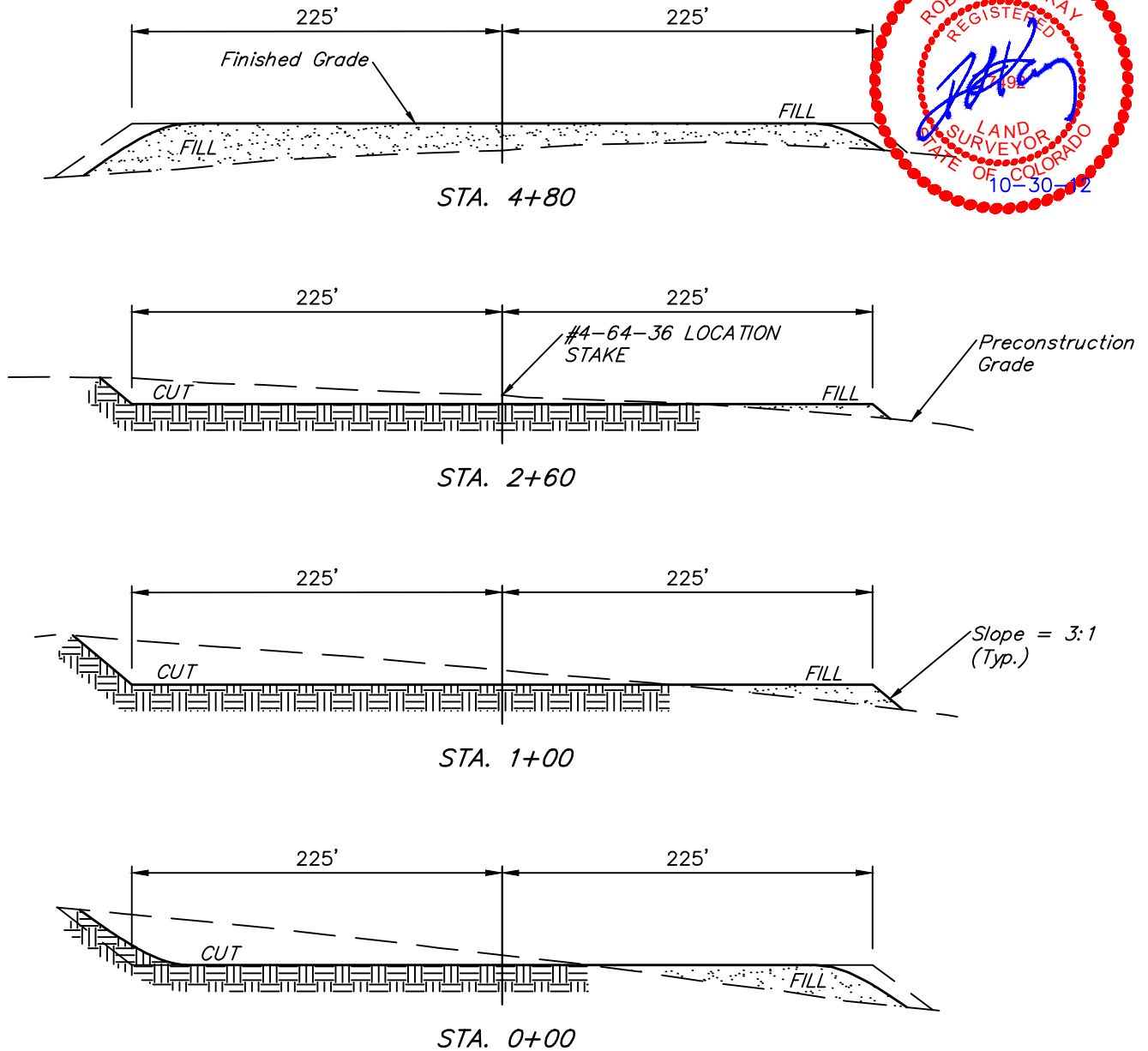

NOTE:

Topsoil should not be Stripped Below Finished Grade on Substructure Area.

APPROXIMATE ACREAGES

WELL SITE DISTURBANCE = ± 5.876 ACRES
ACCESS ROAD DISTURBANCE = ± 0.472 ACRES
TOTAL = ± 6.348 ACRES

* NOTE:

FILL QUANTITY INCLUDES 5% FOR COMPACTION

APPROXIMATE YARDAGES

(6") Topsoil Stripping = 4,740 Cu. Yds.
Remaining Location = 17,750 Cu. Yds.
TOTAL CUT = 22,490 CU. YDS.
FILL = 17,750 CU. YDS.

EXCESS MATERIAL = 4,740 Cu. Yds.
Topsoil = 4,740 Cu. Yds.
EXCESS UNBALANCE = 0 Cu. Yds.
(After Interim Rehabilitation)

UINTAH ENGINEERING & LAND SURVEYING
85 So. 200 East * Vernal, Utah 84078 * (435) 789-1017