

ConocoPhillips Company
MURPHY FAMILY #4-64-36-1H & #4-63-31-2H
LOCATED IN ARAPOAHOE COUNTY, COLORADO
SECTION 36, T4S, R64W, 6th P.M.

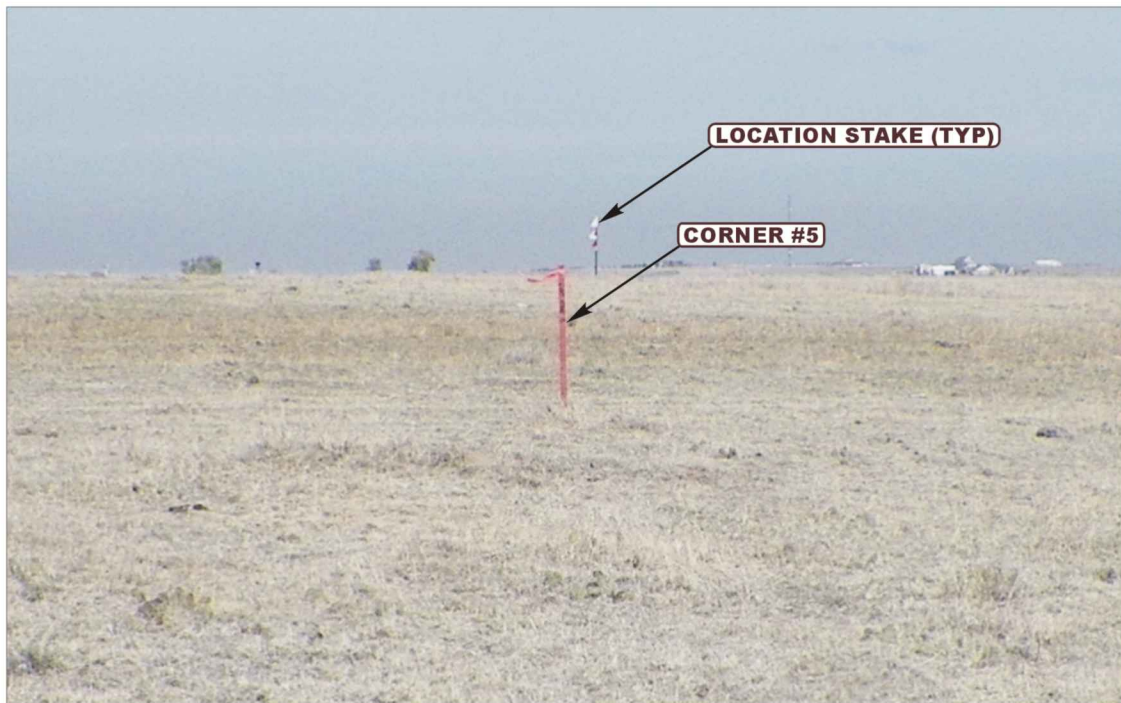

PHOTO: VIEW FROM CORNER #5 TO LOCATION STAKE

CAMERA ANGLE: NORTHERLY

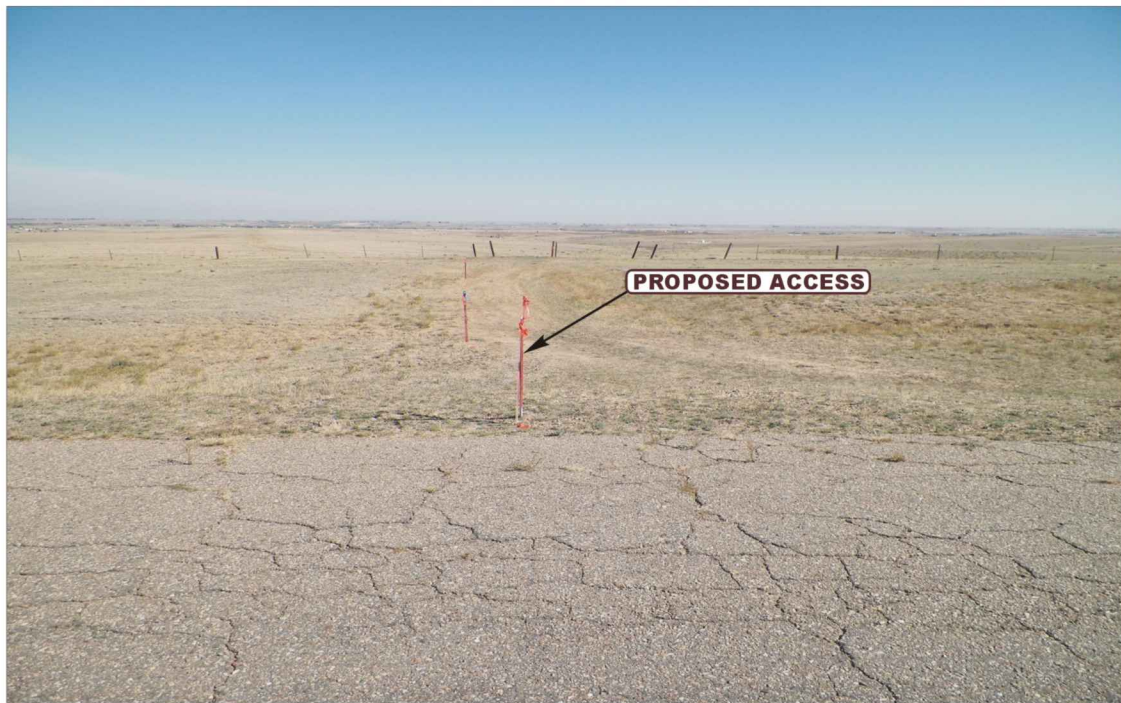

PHOTO: VIEW FROM BEGINNING OF PROPOSED ACCESS

CAMERA ANGLE: EASTERLY



- Since 1964 -

U&LS Uintah Engineering & Land Surveying
85 South 200 East Vernal, Utah 84078
(435) 789-1017 * FAX (435) 789-1813

LOCATION PHOTOS

10 **22** **12**
MONTH DAY YEAR

TAKEN BY: D.L.S. DRAWN BY: B.D.H. REVISED: 00-00-00

PHOTO
P1

ConocoPhillips Company
MURPHY FAMILY #4-64-36-1H & #4-63-31-2H
LOCATED IN ARAPOAHOE COUNTY, COLORADO
SECTION 36, T4S, R64W, 6th P.M.



PHOTO: VIEW OF LOCATION STAKE

CAMERA ANGLE: NORTHERLY



PHOTO: VIEW OF LOCATION STAKE

CAMERA ANGLE: EASTERLY



- Since 1964 -

**U
E
L
S**

Uintah Engineering & Land Surveying
85 South 200 East Vernal, Utah 84078
(435) 789-1017 * FAX (435) 789-1813

LOCATION PHOTOS

10 **22** **12**
MONTH DAY YEAR

TAKEN BY: D.L.S. DRAWN BY: B.D.H. REVISED: 00-00-00

PHOTO
P2

ConocoPhillips Company
MURPHY FAMILY #4-64-36-1H & #4-63-31-2H
LOCATED IN ARAPOAHOE COUNTY, COLORADO
SECTION 36, T4S, R64W, 6th P.M.



PHOTO: VIEW OF LOCATION STAKE

CAMERAANGLE: SOUTHERLY



PHOTO: VIEW OF LOCATION STAKE

CAMERAANGLE: WESTERLY



Since 1964

**U
E
L
S**

Uintah Engineering & Land Surveying
85 South 200 East Vernal, Utah 84078
(435) 789-1017 * FAX (435) 789-1813

LOCATION PHOTOS

10
MONTH

22
DAY

12
YEAR

TAKEN BY: D.L.S. DRAWN BY: B.D.H. REVISED: 00-00-00

PHOTO
P3