

Location Drawing

Nearest:
Building: 2,643' southwest
Property Line: 258' south
Above Ground Utility: 2,193' northwest
Public Road: 227' south
Railroad: 8,884' northwest

Reference Point Well Data:

Northwest corner of the
proposed facility pad
Latitude: N 40.24804°
Longitude: W 105.04741°
FSL: 258'
FWL: 2142'
ELEV: 5158'
PDOP: 1.7

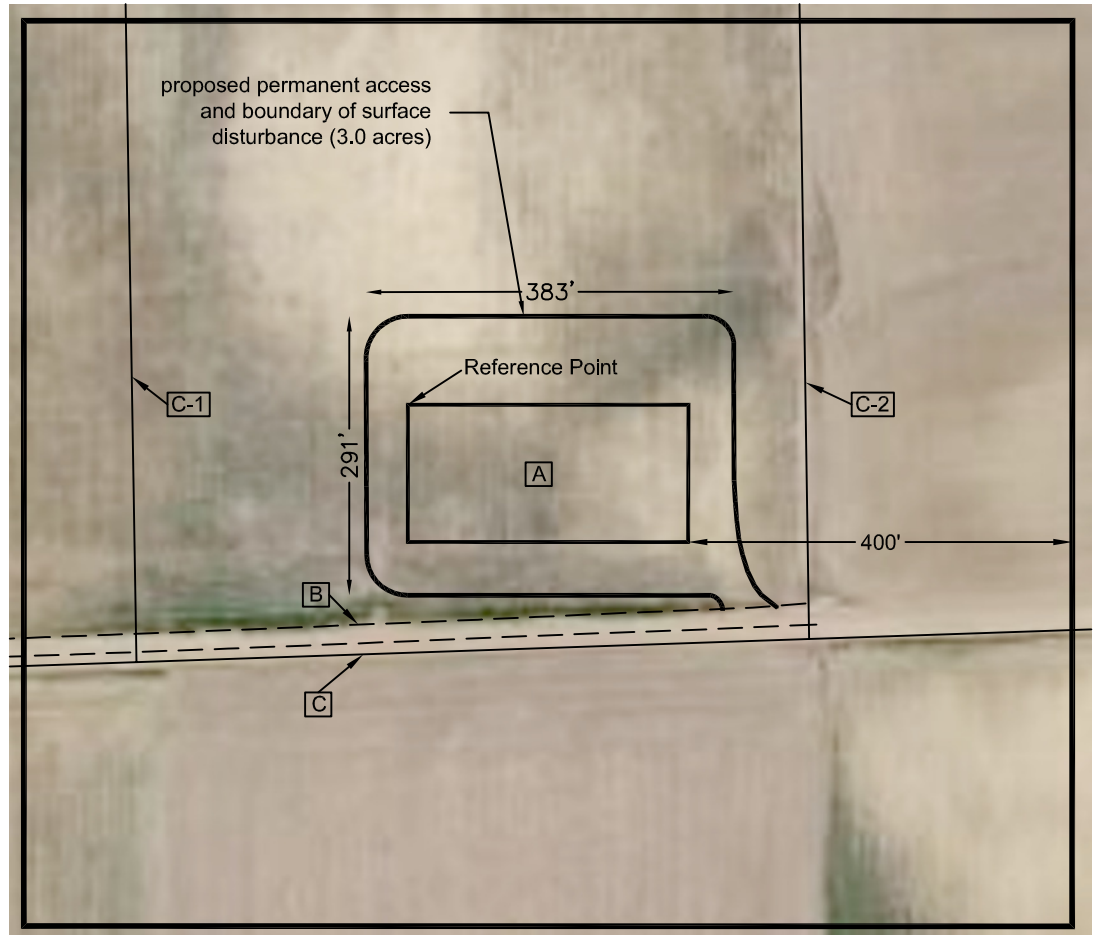

Field observations taken
on 12/18/12 by operator
John Rice.

**Distances listed below
are measured from the
Northwest corner of the
proposed facility pad**

- A** proposed facility pad
- B** Weld County Road 36, 227' south
- C** property line 258' south
- C-1** property line 287' west
- C-2** property line 414' east

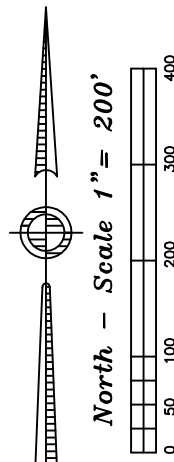

**Zisch SESW
Proposed Facility Drawing**

Improvements extending
400' from disturbance

Township 3 North, Range 68 West,
Section 6: SE¼ SW¼
Weld County, Colorado

May 15, 2013

JR Land Surveying, LLC
8114 Northstar Drive
Windsor, Colorado 80528
P. 970-576-4641