

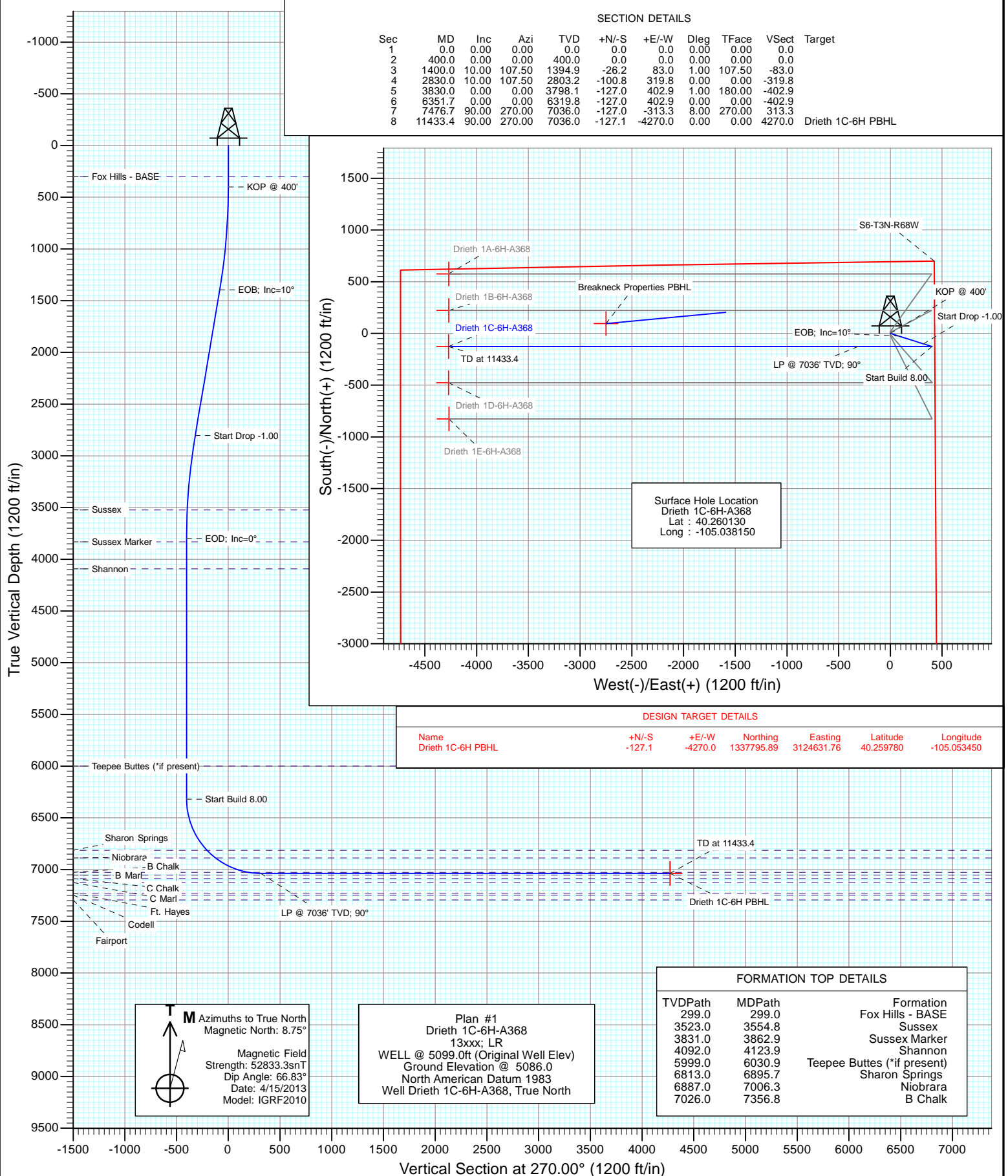

Project: DJ Wattenberg
Site: S6-T3N-R68W (Zisch/Drieth 1)
Well: Drieth 1C-6H-A368
Wellbore: Hz
Design: Plan #1



Planning Report

Database:	USA EDM 5000 Multi Users DB	Local Co-ordinate Reference:	Well Drieth 1C-6H-A368
Company:	EnCana Oil & Gas (USA) Inc	TVD Reference:	WELL @ 5099.0ft (Original Well Elev)
Project:	DJ Wattenberg	MD Reference:	WELL @ 5099.0ft (Original Well Elev)
Site:	S6-T3N-R68W (Zisch/Drieth 1)	North Reference:	True
Well:	Drieth 1C-6H-A368	Survey Calculation Method:	Minimum Curvature
Wellbore:	Hz		
Design:	Plan #1		

Project	DJ Wattenberg		
Map System:	US State Plane 1983	System Datum:	Mean Sea Level
Geo Datum:	North American Datum 1983		
Map Zone:	Colorado Northern Zone		

Site		S6-T3N-R68W (Zisch/Drieth 1)			
Site Position:		Northing:	1,333,692.15 ft	Latitude:	40.248510
From:	Lat/Long	Easting:	3,124,995.76 ft	Longitude:	-105.052220
Position Uncertainty:	0.0 ft	Slot Radius:	13.200 in	Grid Convergence:	0.29 °

Well	Drieth 1C-6H-A368					
Well Position	+N/-S	0.0 ft	Northing:	1,337,945.25 ft	Latitude:	40.260130
	+E/-W	0.0 ft	Easting:	3,128,901.07 ft	Longitude:	-105.038150
Position Uncertainty		0.0 ft	Wellhead Elevation:	ft	Ground Level:	5,086.0 ft

Wellbore	Hz				
Magnetics	Model Name	Sample Date	Declination (°)	Dip Angle (°)	Field Strength (nT)
	IGRF2010	4/15/2013	8.75	66.83	52,833

Design	Plan #1			
Audit Notes:				
Version:	Phase:	PLAN	Tie On Depth:	0.0
Vertical Section:	Depth From (TVD) (ft)	+N/-S (ft)	+E/-W (ft)	Direction (°)
	0.0	0.0	0.0	270.00

Plan Sections										
Measured Depth (ft)	Inclination (°)	Azimuth (°)	Vertical Depth (ft)	+N/-S (ft)	+E/-W (ft)	Dogleg Rate (°/100ft)	Build Rate (°/100ft)	Turn Rate (°/100ft)	TFO (°)	Target
0.0	0.00	0.00	0.0	0.0	0.0	0.00	0.00	0.00	0.00	
400.0	0.00	0.00	400.0	0.0	0.0	0.00	0.00	0.00	0.00	
1,400.0	10.00	107.50	1,394.9	-26.2	83.0	1.00	1.00	0.00	107.50	
2,830.0	10.00	107.50	2,803.2	-100.8	319.8	0.00	0.00	0.00	0.00	
3,830.0	0.00	0.00	3,798.1	-127.0	402.9	1.00	-1.00	0.00	180.00	
6,351.7	0.00	0.00	6,319.8	-127.0	402.9	0.00	0.00	0.00	0.00	
7,476.7	90.00	270.00	7,036.0	-127.0	-313.3	8.00	8.00	0.00	270.00	
11,433.4	90.00	270.00	7,036.0	-127.1	-4,270.0	0.00	0.00	0.00	0.00	Drieth 1C-6H PBHL

Planning Report

Database:	USA EDM 5000 Multi Users DB	Local Co-ordinate Reference:	Well Drieth 1C-6H-A368
Company:	EnCana Oil & Gas (USA) Inc	TVD Reference:	WELL @ 5099.0ft (Original Well Elev)
Project:	DJ Wattenberg	MD Reference:	WELL @ 5099.0ft (Original Well Elev)
Site:	S6-T3N-R68W (Zisch/Drieth 1)	North Reference:	True
Well:	Drieth 1C-6H-A368	Survey Calculation Method:	Minimum Curvature
Wellbore:	Hz		
Design:	Plan #1		

Planned Survey

Measured Depth (ft)	Inclination (°)	Azimuth (°)	Vertical Depth (ft)	+N/-S (ft)	+E/-W (ft)	Vertical Section (ft)	Dogleg Rate (°/100ft)	Build Rate (°/100ft)	Comments / Formations
0.0	0.00	0.00	0.0	0.0	0.0	0.0	0.00	0.00	
100.0	0.00	0.00	100.0	0.0	0.0	0.0	0.00	0.00	
200.0	0.00	0.00	200.0	0.0	0.0	0.0	0.00	0.00	
299.0	0.00	0.00	299.0	0.0	0.0	0.0	0.00	0.00	Fox Hills - BASE
300.0	0.00	0.00	300.0	0.0	0.0	0.0	0.00	0.00	
400.0	0.00	0.00	400.0	0.0	0.0	0.0	0.00	0.00	KOP @ 400'
500.0	1.00	107.50	500.0	-0.3	0.8	-0.8	1.00	1.00	
600.0	2.00	107.50	600.0	-1.0	3.3	-3.3	1.00	1.00	
700.0	3.00	107.50	699.9	-2.4	7.5	-7.5	1.00	1.00	
800.0	4.00	107.50	799.7	-4.2	13.3	-13.3	1.00	1.00	
900.0	5.00	107.50	899.4	-6.6	20.8	-20.8	1.00	1.00	
1,000.0	6.00	107.50	998.9	-9.4	29.9	-29.9	1.00	1.00	
1,100.0	7.00	107.50	1,098.3	-12.8	40.7	-40.7	1.00	1.00	
1,200.0	8.00	107.50	1,197.4	-16.8	53.2	-53.2	1.00	1.00	
1,300.0	9.00	107.50	1,296.3	-21.2	67.3	-67.3	1.00	1.00	
1,400.0	10.00	107.50	1,394.9	-26.2	83.0	-83.0	1.00	1.00	EOB; Inc=10°
1,500.0	10.00	107.50	1,493.4	-31.4	99.6	-99.6	0.00	0.00	
1,600.0	10.00	107.50	1,591.9	-36.6	116.1	-116.1	0.00	0.00	
1,700.0	10.00	107.50	1,690.4	-41.8	132.7	-132.7	0.00	0.00	
1,800.0	10.00	107.50	1,788.9	-47.1	149.3	-149.3	0.00	0.00	
1,900.0	10.00	107.50	1,887.3	-52.3	165.8	-165.8	0.00	0.00	
2,000.0	10.00	107.50	1,985.8	-57.5	182.4	-182.4	0.00	0.00	
2,100.0	10.00	107.50	2,084.3	-62.7	198.9	-198.9	0.00	0.00	
2,200.0	10.00	107.50	2,182.8	-67.9	215.5	-215.5	0.00	0.00	
2,300.0	10.00	107.50	2,281.3	-73.2	232.1	-232.1	0.00	0.00	
2,400.0	10.00	107.50	2,379.7	-78.4	248.6	-248.6	0.00	0.00	
2,500.0	10.00	107.50	2,478.2	-83.6	265.2	-265.2	0.00	0.00	
2,600.0	10.00	107.50	2,576.7	-88.8	281.7	-281.7	0.00	0.00	
2,700.0	10.00	107.50	2,675.2	-94.1	298.3	-298.3	0.00	0.00	
2,800.0	10.00	107.50	2,773.7	-99.3	314.9	-314.9	0.00	0.00	
2,830.0	10.00	107.50	2,803.2	-100.8	319.8	-319.8	0.00	0.00	Start Drop -1.00
2,900.0	9.30	107.50	2,872.2	-104.4	331.0	-331.0	1.00	-1.00	
3,000.0	8.30	107.50	2,971.0	-109.0	345.6	-345.6	1.00	-1.00	
3,100.0	7.30	107.50	3,070.1	-113.1	358.6	-358.6	1.00	-1.00	
3,200.0	6.30	107.50	3,169.4	-116.6	369.9	-369.9	1.00	-1.00	
3,300.0	5.30	107.50	3,268.9	-119.7	379.5	-379.5	1.00	-1.00	
3,400.0	4.30	107.50	3,368.5	-122.2	387.5	-387.5	1.00	-1.00	
3,500.0	3.30	107.50	3,468.3	-124.2	393.8	-393.8	1.00	-1.00	
3,554.8	2.75	107.50	3,523.0	-125.0	396.6	-396.6	1.00	-1.00	Sussex
3,600.0	2.30	107.50	3,568.2	-125.6	398.5	-398.5	1.00	-1.00	
3,700.0	1.30	107.50	3,668.1	-126.6	401.5	-401.5	1.00	-1.00	
3,800.0	0.30	107.50	3,768.1	-127.0	402.8	-402.8	1.00	-1.00	
3,830.0	0.00	0.00	3,798.1	-127.0	402.9	-402.9	1.00	-1.00	EOD; Inc=0°
3,862.9	0.00	0.00	3,831.0	-127.0	402.9	-402.9	0.00	0.00	Sussex Marker
3,900.0	0.00	0.00	3,868.1	-127.0	402.9	-402.9	0.00	0.00	
4,000.0	0.00	0.00	3,968.1	-127.0	402.9	-402.9	0.00	0.00	
4,100.0	0.00	0.00	4,068.1	-127.0	402.9	-402.9	0.00	0.00	
4,123.9	0.00	0.00	4,092.0	-127.0	402.9	-402.9	0.00	0.00	Shannon
4,200.0	0.00	0.00	4,168.1	-127.0	402.9	-402.9	0.00	0.00	
4,300.0	0.00	0.00	4,268.1	-127.0	402.9	-402.9	0.00	0.00	
4,400.0	0.00	0.00	4,368.1	-127.0	402.9	-402.9	0.00	0.00	
4,500.0	0.00	0.00	4,468.1	-127.0	402.9	-402.9	0.00	0.00	

Planning Report

Database:	USA EDM 5000 Multi Users DB	Local Co-ordinate Reference:	Well Drieth 1C-6H-A368
Company:	EnCana Oil & Gas (USA) Inc	TVD Reference:	WELL @ 5099.0ft (Original Well Elev)
Project:	DJ Wattenberg	MD Reference:	WELL @ 5099.0ft (Original Well Elev)
Site:	S6-T3N-R68W (Zisch/Drieth 1)	North Reference:	True
Well:	Drieth 1C-6H-A368	Survey Calculation Method:	Minimum Curvature
Wellbore:	Hz		
Design:	Plan #1		

Planned Survey

Measured Depth (ft)	Inclination (°)	Azimuth (°)	Vertical Depth (ft)	+N/-S (ft)	+E/-W (ft)	Vertical Section (ft)	Dogleg Rate (°/100ft)	Build Rate (°/100ft)	Comments / Formations
4,600.0	0.00	0.00	4,568.1	-127.0	402.9	-402.9	0.00	0.00	
4,700.0	0.00	0.00	4,668.1	-127.0	402.9	-402.9	0.00	0.00	
4,800.0	0.00	0.00	4,768.1	-127.0	402.9	-402.9	0.00	0.00	
4,900.0	0.00	0.00	4,868.1	-127.0	402.9	-402.9	0.00	0.00	
5,000.0	0.00	0.00	4,968.1	-127.0	402.9	-402.9	0.00	0.00	
5,100.0	0.00	0.00	5,068.1	-127.0	402.9	-402.9	0.00	0.00	
5,200.0	0.00	0.00	5,168.1	-127.0	402.9	-402.9	0.00	0.00	
5,300.0	0.00	0.00	5,268.1	-127.0	402.9	-402.9	0.00	0.00	
5,400.0	0.00	0.00	5,368.1	-127.0	402.9	-402.9	0.00	0.00	
5,500.0	0.00	0.00	5,468.1	-127.0	402.9	-402.9	0.00	0.00	
5,600.0	0.00	0.00	5,568.1	-127.0	402.9	-402.9	0.00	0.00	
5,700.0	0.00	0.00	5,668.1	-127.0	402.9	-402.9	0.00	0.00	
5,800.0	0.00	0.00	5,768.1	-127.0	402.9	-402.9	0.00	0.00	
5,900.0	0.00	0.00	5,868.1	-127.0	402.9	-402.9	0.00	0.00	
6,000.0	0.00	0.00	5,968.1	-127.0	402.9	-402.9	0.00	0.00	
6,030.9	0.00	0.00	5,999.0	-127.0	402.9	-402.9	0.00	0.00	Teepee Buttes (*if present)
6,100.0	0.00	0.00	6,068.1	-127.0	402.9	-402.9	0.00	0.00	
6,200.0	0.00	0.00	6,168.1	-127.0	402.9	-402.9	0.00	0.00	
6,300.0	0.00	0.00	6,268.1	-127.0	402.9	-402.9	0.00	0.00	
6,351.7	0.00	0.00	6,319.8	-127.0	402.9	-402.9	0.00	0.00	Start Build 8.00
6,400.0	3.87	270.00	6,368.1	-127.0	401.2	-401.2	8.00	8.00	
6,500.0	11.87	270.00	6,467.1	-127.0	387.6	-387.6	8.00	8.00	
6,600.0	19.87	270.00	6,563.2	-127.0	360.2	-360.2	8.00	8.00	
6,700.0	27.87	270.00	6,654.6	-127.0	319.8	-319.8	8.00	8.00	
6,800.0	35.87	270.00	6,739.4	-127.0	267.1	-267.1	8.00	8.00	
6,895.7	43.52	270.00	6,813.0	-127.0	206.0	-206.0	8.00	8.00	Sharon Springs
6,900.0	43.87	270.00	6,816.1	-127.0	203.0	-203.0	8.00	8.00	
7,000.0	51.87	270.00	6,883.1	-127.0	128.9	-128.9	8.00	8.00	
7,006.3	52.37	270.00	6,887.0	-127.0	124.0	-124.0	8.00	8.00	Niobrara
7,100.0	59.87	270.00	6,939.2	-127.0	46.2	-46.2	8.00	8.00	
7,200.0	67.87	270.00	6,983.2	-127.0	-43.5	43.5	8.00	8.00	
7,300.0	75.87	270.00	7,014.3	-127.0	-138.5	138.5	8.00	8.00	
7,356.8	80.41	270.00	7,026.0	-127.0	-194.1	194.1	8.00	8.00	B Chalk
7,400.0	83.87	270.00	7,031.9	-127.0	-236.8	236.8	8.00	8.00	
7,476.7	90.00	270.00	7,036.0	-127.0	-313.3	313.3	8.00	8.00	LP @ 7036' TVD; 90°
7,500.0	90.00	270.00	7,036.0	-127.0	-336.7	336.7	0.00	0.00	
7,600.0	90.00	270.00	7,036.0	-127.0	-436.7	436.7	0.00	0.00	
7,700.0	90.00	270.00	7,036.0	-127.0	-536.7	536.7	0.00	0.00	
7,800.0	90.00	270.00	7,036.0	-127.0	-636.7	636.7	0.00	0.00	
7,900.0	90.00	270.00	7,036.0	-127.0	-736.7	736.7	0.00	0.00	
8,000.0	90.00	270.00	7,036.0	-127.0	-836.7	836.7	0.00	0.00	
8,100.0	90.00	270.00	7,036.0	-127.1	-936.7	936.7	0.00	0.00	
8,200.0	90.00	270.00	7,036.0	-127.1	-1,036.7	1,036.7	0.00	0.00	
8,300.0	90.00	270.00	7,036.0	-127.1	-1,136.7	1,136.7	0.00	0.00	
8,400.0	90.00	270.00	7,036.0	-127.1	-1,236.7	1,236.7	0.00	0.00	
8,500.0	90.00	270.00	7,036.0	-127.1	-1,336.7	1,336.7	0.00	0.00	
8,600.0	90.00	270.00	7,036.0	-127.1	-1,436.7	1,436.7	0.00	0.00	
8,700.0	90.00	270.00	7,036.0	-127.1	-1,536.7	1,536.7	0.00	0.00	
8,800.0	90.00	270.00	7,036.0	-127.1	-1,636.7	1,636.7	0.00	0.00	
8,900.0	90.00	270.00	7,036.0	-127.1	-1,736.7	1,736.7	0.00	0.00	
9,000.0	90.00	270.00	7,036.0	-127.1	-1,836.7	1,836.7	0.00	0.00	
9,100.0	90.00	270.00	7,036.0	-127.1	-1,936.7	1,936.7	0.00	0.00	

Planning Report

Database:	USA EDM 5000 Multi Users DB	Local Co-ordinate Reference:	Well Drieth 1C-6H-A368
Company:	EnCana Oil & Gas (USA) Inc	TVD Reference:	WELL @ 5099.0ft (Original Well Elev)
Project:	DJ Wattenberg	MD Reference:	WELL @ 5099.0ft (Original Well Elev)
Site:	S6-T3N-R68W (Zisch/Drieth 1)	North Reference:	True
Well:	Drieth 1C-6H-A368	Survey Calculation Method:	Minimum Curvature
Wellbore:	Hz		
Design:	Plan #1		

Planned Survey

Measured Depth (ft)	Inclination (°)	Azimuth (°)	Vertical Depth (ft)	+N/-S (ft)	+E/-W (ft)	Vertical Section (ft)	Dogleg Rate (°/100ft)	Build Rate (°/100ft)	Comments / Formations
9,200.0	90.00	270.00	7,036.0	-127.1	-2,036.7	2,036.7	0.00	0.00	
9,300.0	90.00	270.00	7,036.0	-127.1	-2,136.7	2,136.7	0.00	0.00	
9,400.0	90.00	270.00	7,036.0	-127.1	-2,236.7	2,236.7	0.00	0.00	
9,500.0	90.00	270.00	7,036.0	-127.1	-2,336.7	2,336.7	0.00	0.00	
9,600.0	90.00	270.00	7,036.0	-127.1	-2,436.7	2,436.7	0.00	0.00	
9,700.0	90.00	270.00	7,036.0	-127.1	-2,536.7	2,536.7	0.00	0.00	
9,800.0	90.00	270.00	7,036.0	-127.1	-2,636.7	2,636.7	0.00	0.00	
9,900.0	90.00	270.00	7,036.0	-127.1	-2,736.7	2,736.7	0.00	0.00	
10,000.0	90.00	270.00	7,036.0	-127.1	-2,836.7	2,836.7	0.00	0.00	
10,100.0	90.00	270.00	7,036.0	-127.1	-2,936.7	2,936.7	0.00	0.00	
10,200.0	90.00	270.00	7,036.0	-127.1	-3,036.7	3,036.7	0.00	0.00	
10,300.0	90.00	270.00	7,036.0	-127.1	-3,136.7	3,136.7	0.00	0.00	
10,400.0	90.00	270.00	7,036.0	-127.1	-3,236.7	3,236.7	0.00	0.00	
10,500.0	90.00	270.00	7,036.0	-127.1	-3,336.7	3,336.7	0.00	0.00	
10,600.0	90.00	270.00	7,036.0	-127.1	-3,436.7	3,436.7	0.00	0.00	
10,700.0	90.00	270.00	7,036.0	-127.1	-3,536.7	3,536.7	0.00	0.00	
10,800.0	90.00	270.00	7,036.0	-127.1	-3,636.7	3,636.7	0.00	0.00	
10,900.0	90.00	270.00	7,036.0	-127.1	-3,736.7	3,736.7	0.00	0.00	
11,000.0	90.00	270.00	7,036.0	-127.1	-3,836.7	3,836.7	0.00	0.00	
11,100.0	90.00	270.00	7,036.0	-127.1	-3,936.7	3,936.7	0.00	0.00	
11,200.0	90.00	270.00	7,036.0	-127.1	-4,036.7	4,036.7	0.00	0.00	
11,300.0	90.00	270.00	7,036.0	-127.1	-4,136.7	4,136.7	0.00	0.00	
11,400.0	90.00	270.00	7,036.0	-127.1	-4,236.7	4,236.7	0.00	0.00	
11,433.4	90.00	270.00	7,036.0	-127.1	-4,270.0	4,270.0	0.00	0.00	TD at 11433.4 - Drieth 1C-6H PBHL

Targets

Target Name - hit/miss target - Shape	Dip Angle (°)	Dip Dir. (°)	TVD (ft)	+N/-S (ft)	+E/-W (ft)	Northing (ft)	Easting (ft)	Latitude	Longitude
Drieth 1C-6H PBHL - plan hits target center - Point	0.00	0.00	7,036.0	-127.1	-4,270.0	1,337,795.89	3,124,631.76	40.259780	-105.053450

Formations

Measured Depth (ft)	Vertical Depth (ft)	Name	Lithology	Dip (°)	Dip Direction (°)
299.0	299.0	Fox Hills - BASE			
3,554.8	3,523.0	Sussex			
3,862.9	3,831.0	Sussex Marker			
4,123.9	4,092.0	Shannon			
6,030.9	5,999.0	Teepee Buttes (*if present)			
6,895.7	6,813.0	Sharon Springs			
7,006.3	6,887.0	Niobrara			
7,356.8	7,026.0	B Chalk			

Planning Report

Database:	USA EDM 5000 Multi Users DB	Local Co-ordinate Reference:	Well Drieth 1C-6H-A368
Company:	EnCana Oil & Gas (USA) Inc	TVD Reference:	WELL @ 5099.0ft (Original Well Elev)
Project:	DJ Wattenberg	MD Reference:	WELL @ 5099.0ft (Original Well Elev)
Site:	S6-T3N-R68W (Zisch/Drieth 1)	North Reference:	True
Well:	Drieth 1C-6H-A368	Survey Calculation Method:	Minimum Curvature
Wellbore:	Hz		
Design:	Plan #1		

Plan Annotations

Measured Depth (ft)	Vertical Depth (ft)	Local Coordinates		Comment
		+N/-S (ft)	+E/-W (ft)	
400.0	400.0	0.0	0.0	KOP @ 400'
1,400.0	1,394.9	-26.2	83.0	EOB; Inc=10°
2,830.0	2,803.2	-100.8	319.8	Start Drop -1.00
3,830.0	3,798.1	-127.0	402.9	EOD; Inc=0°
6,351.7	6,319.8	-127.0	402.9	Start Build 8.00
7,476.7	7,036.0	-127.0	-313.3	LP @ 7036' TVD; 90°
11,433.4	7,036.0	-127.1	-4,270.0	TD at 11433.4

EnCana Oil & Gas (USA) Inc

DJ Wattenberg

S6-T3N-R68W (Zisch/Drieth 1)

Drieth 1C-6H-A368

Hz

Plan #1

Anticollision Report

15 April, 2013

Anticollision Report

Company:	EnCana Oil & Gas (USA) Inc	Local Co-ordinate Reference:	Well Drieth 1C-6H-A368
Project:	DJ Wattenberg	TVD Reference:	WELL @ 5099.0ft (Original Well Elev)
Reference Site:	S6-T3N-R68W (Zisch/Drieth 1)	MD Reference:	WELL @ 5099.0ft (Original Well Elev)
Site Error:	0.0ft	North Reference:	True
Reference Well:	Drieth 1C-6H-A368	Survey Calculation Method:	Minimum Curvature
Well Error:	0.0ft	Output errors are at	2.00 sigma
Reference Wellbore	Hz	Database:	USA EDM 5000 Multi Users DB
Reference Design:	Plan #1	Offset TVD Reference:	Offset Datum

Reference	Plan #1		
Filter type:	NO GLOBAL FILTER: Using user defined selection & filtering criteria		
Interpolation Method:	MD Interval 100.0ft	Error Model:	Systematic Ellipse
Depth Range:	Unlimited	Scan Method:	Closest Approach 3D
Results Limited by:	Maximum center-center distance of 500.0ft	Error Surface:	Elliptical Conic
Warning Levels Evaluated at:	2.00 Sigma		

Survey Tool Program	Date	4/15/2013		
From (ft)	To (ft)	Survey (Wellbore)	Tool Name	Description
0.0	11,433.4	Plan #1 (Hz)	MWD	Geolink MWD

Summary						
Site Name	Reference Measured Depth (ft)	Offset Measured Depth (ft)	Distance Between Centres (ft)	Distance Between Ellipses (ft)	Separation Factor	Warning
Offset Well - Wellbore - Design						
S6-T3N-R68W (Zisch/Drieth 1)						
Breakneck Properties 21-6 - DD - Plan #1	9,912.5	7,178.0	222.0	124.8	2.285	CC, ES, SF
Drieth 1A-6H-A368 - Hz - Plan #1	166.3	167.3	18.2	17.7	33.921	CC
Drieth 1A-6H-A368 - Hz - Plan #1	200.0	201.0	18.2	17.6	27.830	ES
Drieth 1A-6H-A368 - Hz - Plan #1	500.0	500.0	25.2	23.5	14.765	SF
Drieth 1B-6H-A368 - Hz - Plan #1	266.3	267.3	10.9	10.0	12.334	CC
Drieth 1B-6H-A368 - Hz - Plan #1	300.0	301.0	10.9	9.9	10.890	ES
Drieth 1B-6H-A368 - Hz - Plan #1	11,433.4	11,655.4	413.2	225.7	2.203	SF
Drieth 1D-6H-A368 - Hz - Plan #1	300.0	300.0	10.9	9.9	10.909	CC, ES
Drieth 1D-6H-A368 - Hz - Plan #1	11,433.4	11,679.7	413.2	225.5	2.201	SF
Drieth 1E-6H-A368 - Hz - Plan #1	200.0	200.0	21.9	21.2	33.485	CC, ES
Drieth 1E-6H-A368 - Hz - Plan #1	700.0	697.4	39.0	36.6	16.111	SF
SUMMER 6-1 (EXISTING) - EXISTING - NO SURVEYS						Out of range

Anticollision Report

Company:	EnCana Oil & Gas (USA) Inc	Local Co-ordinate Reference:	Well Drieth 1C-6H-A368
Project:	DJ Wattenberg	TVD Reference:	WELL @ 5099.0ft (Original Well Elev)
Reference Site:	S6-T3N-R68W (Zisch/Drieth 1)	MD Reference:	WELL @ 5099.0ft (Original Well Elev)
Site Error:	0.0ft	North Reference:	True
Reference Well:	Drieth 1C-6H-A368	Survey Calculation Method:	Minimum Curvature
Well Error:	0.0ft	Output errors are at	2.00 sigma
Reference Wellbore	Hz	Database:	USA EDM 5000 Multi Users DB
Reference Design:	Plan #1	Offset TVD Reference:	Offset Datum

Offset Design													S6-T3N-R68W (Zisch/Drieth 1) - Breakneck Properties 21-6 - DD - Plan #1		Offset Site Error:		0.0 ft	
Survey Program:													0-MWD		Offset Well Error:		0.0 ft	
Reference		Offset		Semi Major Axis			Distance							Warning				
Measured Depth	Vertical Depth	Measured Depth	Vertical Depth	Reference	Offset	Highside Toolface	Offset Wellbore Centre		Between Centres	Between Ellipses	Total Uncertainty Axis	Separation Factor						
(ft)	(ft)	(ft)	(ft)	(ft)	(ft)	(°)	+N/-S (ft)	+E/-W (ft)	(ft)	(ft)								
9,500.0	7,036.0	7,178.0	7,036.0	62.9	24.3	90.00	94.9	-2,749.2	468.4	381.3	87.13	5.376						
9,600.0	7,036.0	7,178.0	7,036.0	65.4	24.3	90.00	94.9	-2,749.2	383.3	293.8	89.56	4.280						
9,700.0	7,036.0	7,178.0	7,036.0	67.8	24.3	90.00	94.9	-2,749.2	307.3	215.3	91.99	3.341						
9,800.0	7,036.0	7,178.0	7,036.0	70.2	24.3	90.00	94.9	-2,749.2	248.9	154.4	94.42	2.636						
9,900.0	7,036.0	7,178.0	7,036.0	72.7	24.3	90.00	94.9	-2,749.2	222.3	125.5	96.86	2.295						
9,912.5	7,036.0	7,178.0	7,036.0	73.0	24.3	90.00	94.9	-2,749.2	222.0	124.8	97.16	2.285	CC, ES, SF					
10,000.0	7,036.0	7,178.0	7,036.0	75.1	24.3	90.00	94.9	-2,749.2	238.6	139.3	99.30	2.403						
10,100.0	7,036.0	7,178.0	7,036.0	77.5	24.3	90.00	94.9	-2,749.2	290.6	188.8	101.74	2.856						
10,200.0	7,036.0	7,178.0	7,036.0	80.0	24.3	90.00	94.9	-2,749.2	363.2	259.0	104.18	3.487						
10,300.0	7,036.0	7,178.0	7,036.0	82.4	24.3	90.00	94.9	-2,749.2	446.6	340.0	106.62	4.188						

Anticollision Report

Company:	EnCana Oil & Gas (USA) Inc	Local Co-ordinate Reference:	Well Drieth 1C-6H-A368
Project:	DJ Wattenberg	TVD Reference:	WELL @ 5099.0ft (Original Well Elev)
Reference Site:	S6-T3N-R68W (Zisch/Drieth 1)	MD Reference:	WELL @ 5099.0ft (Original Well Elev)
Site Error:	0.0ft	North Reference:	True
Reference Well:	Drieth 1C-6H-A368	Survey Calculation Method:	Minimum Curvature
Well Error:	0.0ft	Output errors are at	2.00 sigma
Reference Wellbore	Hz	Database:	USA EDM 5000 Multi Users DB
Reference Design:	Plan #1	Offset TVD Reference:	Offset Datum

Offset Design S6-T3N-R68W (Zisch/Drieth 1) - Drieth 1A-6H-A368 - Hz - Plan #1													Offset Site Error:	0.0 ft
Survey Program: 0-MWD													Offset Well Error:	0.0 ft
Reference		Offset		Semi Major Axis			Distance						Warning	
Measured Depth (ft)	Vertical Depth (ft)	Measured Depth (ft)	Vertical Depth (ft)	Reference (ft)	Offset (ft)	Highside Toolface (°)	Offset Wellbore Centre +N/-S (ft)	+E/-W (ft)	Between Centres (ft)	Between Ellipses (ft)	Total Uncertainty Axis	Separation Factor		
0.0	0.0	1.0	1.0	0.0	0.0	0.00	18.2	0.0	18.2					
100.0	100.0	101.0	101.0	0.2	0.2	0.00	18.2	0.0	18.2	17.9	0.31	59.635		
166.3	166.3	167.3	167.3	0.3	0.3	0.00	18.2	0.0	18.2	17.7	0.54	33.921 CC		
200.0	200.0	201.0	201.0	0.3	0.3	0.00	18.2	0.0	18.2	17.6	0.65	27.830 ES		
300.0	300.0	300.7	300.7	0.5	0.5	1.56	18.9	0.5	18.9	17.9	1.00	18.878		
400.0	400.0	400.4	400.4	0.7	0.7	5.53	21.1	2.0	21.2	19.8	1.35	15.632		
500.0	500.0	500.0	499.9	0.9	0.9	-98.90	24.6	4.6	25.2	23.5	1.70	14.765 SF		
600.0	600.0	599.4	599.0	1.0	1.1	-98.51	29.5	8.1	31.0	28.9	2.06	15.046		
700.0	699.9	698.5	697.9	1.2	1.3	-99.61	35.8	12.6	38.7	36.2	2.43	15.926		
800.0	799.7	797.4	796.3	1.4	1.5	-101.37	43.5	18.1	48.2	45.3	2.81	17.140		
900.0	899.4	895.9	894.2	1.6	1.8	-103.29	52.5	24.6	59.5	56.3	3.21	18.535		
1,000.0	998.9	994.1	991.5	1.8	2.0	-105.13	62.9	32.0	72.8	69.2	3.64	20.012		
1,100.0	1,098.3	1,091.7	1,088.2	2.1	2.3	-106.80	74.5	40.3	88.1	84.0	4.10	21.503		
1,200.0	1,197.4	1,188.9	1,184.0	2.3	2.6	-108.27	87.4	49.6	105.3	100.7	4.58	22.962		
1,300.0	1,296.3	1,285.5	1,279.0	2.6	3.0	-109.55	101.6	59.7	124.4	119.3	5.11	24.362		
1,400.0	1,394.9	1,381.5	1,373.1	2.9	3.3	-110.65	116.9	70.7	145.4	139.8	5.66	25.684		
1,500.0	1,493.4	1,476.8	1,466.3	3.3	3.7	-111.53	133.4	82.5	168.1	161.8	6.24	26.930		
1,600.0	1,591.9	1,571.7	1,558.6	3.6	4.1	-111.88	151.1	95.1	192.0	185.1	6.83	28.089		
1,700.0	1,690.4	1,666.0	1,650.0	3.9	4.5	-111.88	169.9	108.6	217.1	209.6	7.44	29.179		
1,800.0	1,788.9	1,761.5	1,742.3	4.3	5.0	-111.67	189.9	122.9	243.1	235.1	8.05	30.185		
1,900.0	1,887.3	1,858.0	1,835.6	4.6	5.4	-111.49	210.2	137.5	269.2	260.6	8.68	31.031		
2,000.0	1,985.8	1,954.6	1,928.8	4.9	5.9	-111.34	230.5	152.0	295.4	286.1	9.30	31.749		
2,100.0	2,084.3	2,051.1	2,022.0	5.3	6.3	-111.22	250.8	166.5	321.5	311.6	9.93	32.365		
2,200.0	2,182.8	2,147.6	2,115.3	5.6	6.8	-111.11	271.2	181.1	347.7	337.1	10.57	32.900		
2,300.0	2,281.3	2,244.1	2,208.5	6.0	7.3	-111.02	291.5	195.6	373.8	362.6	11.20	33.367		
2,400.0	2,379.7	2,340.6	2,301.7	6.3	7.7	-110.94	311.8	210.2	399.9	388.1	11.84	33.779		
2,500.0	2,478.2	2,437.2	2,395.0	6.7	8.2	-110.87	332.1	224.7	426.1	413.6	12.48	34.144		
2,600.0	2,576.7	2,533.7	2,488.2	7.0	8.7	-110.80	352.4	239.3	452.2	439.1	13.12	34.470		
2,700.0	2,675.2	2,630.2	2,581.4	7.4	9.1	-110.75	372.7	253.8	478.4	464.6	13.76	34.762		

Anticollision Report

Company:	EnCana Oil & Gas (USA) Inc	Local Co-ordinate Reference:	Well Drieth 1C-6H-A368
Project:	DJ Wattenberg	TVD Reference:	WELL @ 5099.0ft (Original Well Elev)
Reference Site:	S6-T3N-R68W (Zisch/Drieth 1)	MD Reference:	WELL @ 5099.0ft (Original Well Elev)
Site Error:	0.0ft	North Reference:	True
Reference Well:	Drieth 1C-6H-A368	Survey Calculation Method:	Minimum Curvature
Well Error:	0.0ft	Output errors are at	2.00 sigma
Reference Wellbore	Hz	Database:	USA EDM 5000 Multi Users DB
Reference Design:	Plan #1	Offset TVD Reference:	Offset Datum

Offset Design S6-T3N-R68W (Zisch/Drieth 1) - Drieth 1B-6H-A368 - Hz - Plan #1													Offset Site Error:	0.0 ft
Survey Program: 0-MWD													Offset Well Error:	0.0 ft
Reference		Offset		Semi Major Axis			Distance				Total Uncertainty Axis	Separation Factor	Warning	
Measured Depth (ft)	Vertical Depth (ft)	Measured Depth (ft)	Vertical Depth (ft)	Reference (ft)	Offset (ft)	Highside Toolface (°)	Offset Wellbore Centre +N/-S (ft)	+E/-W (ft)	Between Centres (ft)	Between Ellipses (ft)				
0.0	0.0	1.0	1.0	0.0	0.0	0.00	10.9	0.0	10.9					
100.0	100.0	101.0	101.0	0.2	0.2	0.00	10.9	0.0	10.9	10.6	0.31	35.781		
200.0	200.0	201.0	201.0	0.3	0.3	0.00	10.9	0.0	10.9	10.3	0.65	16.698		
266.3	266.3	267.3	267.3	0.4	0.4	0.00	10.9	0.0	10.9	10.0	0.89	12.334 CC		
300.0	300.0	301.0	301.0	0.5	0.5	0.00	10.9	0.0	10.9	9.9	1.00	10.890 ES		
400.0	400.0	400.9	400.9	0.7	0.7	3.96	11.3	0.8	11.4	10.0	1.35	8.409		
500.0	500.0	500.8	500.7	0.9	0.9	-97.44	12.6	3.1	13.0	11.3	1.70	7.651		
600.0	600.0	600.5	600.4	1.0	1.0	-94.39	14.6	7.0	16.1	14.0	2.06	7.804		
700.0	699.9	700.2	699.9	1.2	1.2	-93.63	17.5	12.3	20.5	18.0	2.43	8.406		
800.0	799.7	799.8	799.2	1.4	1.4	-94.11	21.2	19.2	26.1	23.3	2.82	9.241		
900.0	899.4	899.2	898.1	1.6	1.7	-95.13	25.6	27.6	33.0	29.7	3.24	10.194		
1,000.0	998.9	998.5	996.8	1.8	1.9	-96.32	30.9	37.5	41.2	37.5	3.68	11.191		
1,100.0	1,098.3	1,097.5	1,095.0	2.1	2.2	-97.50	36.9	48.9	50.6	46.5	4.16	12.185		
1,200.0	1,197.4	1,196.4	1,192.7	2.3	2.5	-98.59	43.8	61.8	61.4	56.7	4.67	13.143		
1,300.0	1,296.3	1,295.0	1,290.0	2.6	2.8	-99.57	51.4	76.1	73.5	68.3	5.23	14.046		
1,400.0	1,394.9	1,393.3	1,386.6	2.9	3.1	-100.43	59.7	91.8	86.9	81.0	5.84	14.883		
1,500.0	1,493.4	1,491.3	1,482.7	3.3	3.5	-100.84	68.9	109.0	101.4	94.9	6.47	15.674		
1,600.0	1,591.9	1,590.1	1,579.4	3.6	3.9	-100.74	78.5	127.1	116.4	109.3	7.11	16.378		
1,700.0	1,690.4	1,688.9	1,676.0	3.9	4.2	-100.67	88.2	145.2	131.5	123.7	7.76	16.947		
1,800.0	1,788.9	1,787.8	1,772.7	4.3	4.6	-100.61	97.8	163.4	146.5	138.1	8.42	17.414		
1,900.0	1,887.3	1,886.7	1,869.4	4.6	5.0	-100.56	107.4	181.5	161.6	152.5	9.08	17.803		
2,000.0	1,985.8	1,985.5	1,966.1	4.9	5.4	-100.52	117.1	199.7	176.7	166.9	9.74	18.132		
2,100.0	2,084.3	2,084.4	2,062.8	5.3	5.8	-100.48	126.7	217.8	191.7	181.3	10.41	18.412		
2,200.0	2,182.8	2,183.2	2,159.5	5.6	6.2	-100.45	136.4	236.0	206.8	195.7	11.09	18.655		
2,300.0	2,281.3	2,282.1	2,256.2	6.0	6.6	-100.43	146.0	254.1	221.9	210.1	11.76	18.865		
2,400.0	2,379.7	2,380.9	2,352.9	6.3	7.0	-100.40	155.7	272.3	236.9	224.5	12.44	19.050		
2,500.0	2,478.2	2,480.3	2,450.1	6.7	7.4	-100.39	165.4	290.5	252.0	238.8	13.11	19.212		
2,600.0	2,576.7	2,581.9	2,549.7	7.0	7.8	-100.60	174.7	308.0	266.3	252.5	13.79	19.317		
2,700.0	2,675.2	2,683.6	2,649.9	7.4	8.1	-101.09	183.2	324.1	279.7	265.3	14.45	19.355		
2,800.0	2,773.7	2,785.6	2,750.5	7.7	8.4	-101.84	190.9	338.5	292.2	277.1	15.11	19.340		
2,900.0	2,872.2	2,887.7	2,851.5	8.0	8.7	-102.82	197.8	351.4	303.6	287.9	15.74	19.289		
3,000.0	2,971.0	2,990.0	2,953.0	8.4	9.0	-103.73	203.8	362.8	313.8	297.5	16.32	19.225		
3,100.0	3,070.1	3,092.4	3,054.9	8.6	9.3	-104.55	209.0	372.5	322.8	305.9	16.86	19.143		
3,200.0	3,169.4	3,195.0	3,157.0	8.9	9.5	-105.29	213.3	380.7	330.4	313.1	17.35	19.044		
3,300.0	3,268.9	3,297.7	3,259.5	9.1	9.7	-105.96	216.8	387.2	336.7	318.9	17.79	18.925		
3,400.0	3,368.5	3,400.5	3,362.1	9.3	9.9	-106.58	219.4	392.1	341.7	323.5	18.19	18.788		
3,500.0	3,468.3	3,503.3	3,464.8	9.5	10.0	-107.16	221.2	395.4	345.4	326.8	18.54	18.629		
3,600.0	3,568.2	3,606.2	3,567.7	9.7	10.1	-107.70	222.1	397.1	347.7	328.9	18.85	18.449		
3,700.0	3,668.1	3,707.6	3,669.1	9.8	10.2	-108.17	222.2	397.3	348.8	329.7	19.12	18.242		
3,800.0	3,768.1	3,807.6	3,769.1	10.0	10.3	-108.39	222.2	397.3	349.2	329.9	19.37	18.031		
3,900.0	3,868.1	3,907.6	3,869.1	10.1	10.5	-0.91	222.2	397.3	349.3	334.4	14.85	23.513		
4,000.0	3,968.1	4,007.6	3,969.1	10.2	10.6	-0.91	222.2	397.3	349.3	334.1	15.17	23.016		
4,100.0	4,068.1	4,107.6	4,069.1	10.3	10.7	-0.91	222.2	397.3	349.3	333.8	15.50	22.539		
4,200.0	4,168.1	4,207.6	4,169.1	10.4	10.8	-0.91	222.2	397.3	349.3	333.4	15.82	22.079		
4,300.0	4,268.1	4,307.6	4,269.1	10.6	10.9	-0.91	222.2	397.3	349.3	333.1	16.14	21.637		
4,400.0	4,368.1	4,407.6	4,369.1	10.7	11.0	-0.91	222.2	397.3	349.3	332.8	16.47	21.210		
4,500.0	4,468.1	4,507.6	4,469.1	10.8	11.2	-0.91	222.2	397.3	349.3	332.5	16.79	20.799		
4,600.0	4,568.1	4,607.6	4,569.1	10.9	11.3	-0.91	222.2	397.3	349.3	332.1	17.12	20.402		
4,700.0	4,668.1	4,707.6	4,669.1	11.1	11.4	-0.91	222.2	397.3	349.3	331.8	17.45	20.019		
4,800.0	4,768.1	4,807.6	4,769.1	11.2	11.5	-0.91	222.2	397.3	349.3	331.5	17.77	19.650		
4,900.0	4,868.1	4,907.6	4,869.1	11.3	11.7	-0.91	222.2	397.3	349.3	331.2	18.10	19.292		
5,000.0	4,968.1	5,007.6	4,969.1	11.5	11.8	-0.91	222.2	397.3	349.3	330.8	18.43	18.947		

CC - Min centre to center distance or convergent point, SF - min separation factor, ES - min ellipse separation

Anticollision Report

Company:	EnCana Oil & Gas (USA) Inc	Local Co-ordinate Reference:	Well Drieth 1C-6H-A368
Project:	DJ Wattenberg	TVD Reference:	WELL @ 5099.0ft (Original Well Elev)
Reference Site:	S6-T3N-R68W (Zisch/Drieth 1)	MD Reference:	WELL @ 5099.0ft (Original Well Elev)
Site Error:	0.0ft	North Reference:	True
Reference Well:	Drieth 1C-6H-A368	Survey Calculation Method:	Minimum Curvature
Well Error:	0.0ft	Output errors are at	2.00 sigma
Reference Wellbore	Hz	Database:	USA EDM 5000 Multi Users DB
Reference Design:	Plan #1	Offset TVD Reference:	Offset Datum

Offset Design S6-T3N-R68W (Zisch/Drieth 1) - Drieth 1B-6H-A368 - Hz - Plan #1													Offset Site Error:	0.0 ft
Survey Program: O-MWD													Offset Well Error:	0.0 ft
Reference		Offset		Semi Major Axis		Distance		Total		Separation		Warning		
Measured Depth (ft)	Vertical Depth (ft)	Measured Depth (ft)	Vertical Depth (ft)	Reference (ft)	Offset (ft)	Highside Toolface (°)	Offset Wellbore Centre +N/-S (ft)	+E/-W (ft)	Between Centres (ft)	Between Ellipses (ft)	Uncertainty Axis			
5,100.0	5,068.1	5,107.6	5,069.1	11.6	11.9	-0.91	222.2	397.3	349.3	330.5	18.76	18.614		
5,200.0	5,168.1	5,207.6	5,169.1	11.7	12.1	-0.91	222.2	397.3	349.3	330.2	19.09	18.291		
5,300.0	5,268.1	5,307.6	5,269.1	11.9	12.2	-0.91	222.2	397.3	349.3	329.8	19.43	17.979		
5,400.0	5,368.1	5,407.6	5,369.1	12.0	12.3	-0.91	222.2	397.3	349.3	329.5	19.76	17.676		
5,500.0	5,468.1	5,507.6	5,469.1	12.1	12.5	-0.91	222.2	397.3	349.3	329.2	20.09	17.383		
5,600.0	5,568.1	5,607.6	5,569.1	12.3	12.6	-0.91	222.2	397.3	349.3	328.8	20.42	17.100		
5,700.0	5,668.1	5,707.6	5,669.1	12.4	12.7	-0.91	222.2	397.3	349.3	328.5	20.76	16.825		
5,800.0	5,768.1	5,807.6	5,769.1	12.6	12.9	-0.91	222.2	397.3	349.3	328.2	21.09	16.558		
5,900.0	5,868.1	5,907.6	5,869.1	12.7	13.0	-0.91	222.2	397.3	349.3	327.8	21.43	16.299		
6,000.0	5,968.1	6,007.6	5,969.1	12.8	13.1	-0.91	222.2	397.3	349.3	327.5	21.76	16.048		
6,100.0	6,068.1	6,107.6	6,069.1	13.0	13.3	-0.91	222.2	397.3	349.3	327.2	22.10	15.804		
6,200.0	6,168.1	6,207.6	6,169.1	13.1	13.4	-0.91	222.2	397.3	349.3	326.8	22.43	15.568		
6,300.0	6,268.1	6,307.6	6,269.1	13.3	13.6	-0.91	222.2	397.3	349.3	326.5	22.77	15.338		
6,400.0	6,368.1	6,407.6	6,369.1	13.4	13.7	89.36	222.2	397.3	349.2	322.9	26.38	13.238		
6,440.6	6,408.5	6,448.0	6,409.5	13.4	13.8	90.00	222.2	397.3	349.2	322.8	26.43	13.214		
6,500.0	6,467.1	6,506.6	6,468.1	13.4	13.8	91.57	222.2	397.3	349.4	322.9	26.48	13.191		
6,600.0	6,563.2	6,603.9	6,565.5	13.3	14.0	95.71	222.2	396.9	351.1	324.7	26.40	13.300		
6,700.0	6,654.6	6,706.6	6,667.5	13.1	14.0	100.40	222.2	386.0	355.6	329.6	26.06	13.648		
6,800.0	6,739.4	6,814.5	6,771.8	12.8	13.9	104.90	222.2	359.1	362.5	337.0	25.51	14.208		
6,900.0	6,816.1	6,928.0	6,875.9	12.7	13.7	109.09	222.2	314.1	371.2	346.3	24.88	14.917		
7,000.0	6,883.1	7,047.8	6,976.6	12.6	13.5	112.85	222.2	249.5	380.9	356.5	24.34	15.650		
7,100.0	6,939.2	7,173.9	7,069.4	12.8	13.3	116.10	222.2	164.3	390.7	366.5	24.13	16.193		
7,200.0	6,983.2	7,306.3	7,149.2	13.4	13.3	118.73	222.2	59.0	399.6	375.1	24.52	16.297		
7,300.0	7,014.3	7,444.0	7,210.2	14.5	14.1	120.67	222.2	-64.3	406.8	381.0	25.77	15.785		
7,400.0	7,031.9	7,585.9	7,247.2	15.9	15.7	121.84	222.2	-201.0	411.4	383.4	27.99	14.697		
7,500.0	7,036.0	7,722.1	7,257.0	17.5	17.8	122.20	222.3	-336.6	412.8	381.8	30.99	13.322		
7,600.0	7,036.0	7,822.1	7,257.0	19.3	19.6	122.20	222.3	-436.6	412.8	378.8	33.99	12.146		
7,700.0	7,036.0	7,922.1	7,257.0	21.2	21.5	122.20	222.3	-536.6	412.8	375.6	37.22	11.092		
7,800.0	7,036.0	8,022.1	7,257.0	23.3	23.5	122.20	222.3	-636.6	412.8	372.2	40.63	10.162		
7,900.0	7,036.0	8,122.1	7,257.0	25.4	25.6	122.20	222.3	-736.6	412.8	368.7	44.17	9.347		
8,000.0	7,036.0	8,222.1	7,257.0	27.6	27.8	122.20	222.3	-836.6	412.8	365.0	47.82	8.634		
8,100.0	7,036.0	8,322.1	7,257.0	29.8	30.0	122.20	222.3	-936.6	412.9	361.3	51.55	8.009		
8,200.0	7,036.0	8,422.1	7,257.0	32.1	32.2	122.20	222.3	-1,036.6	412.9	357.5	55.35	7.459		
8,300.0	7,036.0	8,522.1	7,257.0	34.4	34.5	122.20	222.3	-1,136.6	412.9	353.7	59.20	6.974		
8,400.0	7,036.0	8,622.1	7,257.0	36.7	36.8	122.20	222.3	-1,236.6	412.9	349.8	63.09	6.544		
8,500.0	7,036.0	8,722.1	7,257.0	39.0	39.1	122.20	222.3	-1,336.6	412.9	345.9	67.03	6.160		
8,600.0	7,036.0	8,822.1	7,257.0	41.4	41.5	122.20	222.3	-1,436.6	412.9	341.9	70.99	5.817		
8,700.0	7,036.0	8,922.1	7,257.0	43.7	43.8	122.19	222.4	-1,536.6	412.9	337.9	74.97	5.507		
8,800.0	7,036.0	9,022.1	7,257.0	46.1	46.2	122.19	222.4	-1,636.6	412.9	333.9	78.98	5.228		
8,900.0	7,036.0	9,122.1	7,257.0	48.5	48.6	122.19	222.4	-1,736.6	412.9	329.9	83.01	4.975		
9,000.0	7,036.0	9,222.1	7,257.0	50.9	51.0	122.19	222.4	-1,836.6	412.9	325.9	87.05	4.744		
9,100.0	7,036.0	9,322.1	7,257.0	53.3	53.3	122.19	222.4	-1,936.6	412.9	321.8	91.11	4.533		
9,200.0	7,036.0	9,422.1	7,257.0	55.7	55.7	122.19	222.4	-2,036.6	413.0	317.8	95.18	4.339		
9,300.0	7,036.0	9,522.1	7,257.0	58.1	58.2	122.19	222.4	-2,136.6	413.0	313.7	99.25	4.161		
9,400.0	7,036.0	9,622.1	7,257.0	60.5	60.6	122.19	222.4	-2,236.6	413.0	309.6	103.34	3.996		
9,500.0	7,036.0	9,722.1	7,257.0	62.9	63.0	122.19	222.4	-2,336.6	413.0	305.5	107.44	3.844		
9,600.0	7,036.0	9,822.1	7,257.0	65.4	65.4	122.19	222.4	-2,436.6	413.0	301.5	111.54	3.703		
9,700.0	7,036.0	9,922.1	7,257.0	67.8	67.8	122.19	222.4	-2,536.6	413.0	297.3	115.65	3.571		
9,800.0	7,036.0	10,022.1	7,257.0	70.2	70.3	122.19	222.5	-2,636.6	413.0	293.2	119.77	3.448		
9,900.0	7,036.0	10,122.1	7,257.0	72.7	72.7	122.19	222.5	-2,736.6	413.0	289.1	123.89	3.334		
10,000.0	7,036.0	10,222.1	7,257.0	75.1	75.1	122.18	222.5	-2,836.6	413.0	285.0	128.02	3.226		
10,100.0	7,036.0	10,322.1	7,257.0	77.5	77.6	122.18	222.5	-2,936.6	413.0	280.9	132.15	3.126		

CC - Min centre to center distance or convergent point, SF - min separation factor, ES - min ellipse separation

Anticollision Report

Company:	EnCana Oil & Gas (USA) Inc	Local Co-ordinate Reference:	Well Drieth 1C-6H-A368
Project:	DJ Wattenberg	TVD Reference:	WELL @ 5099.0ft (Original Well Elev)
Reference Site:	S6-T3N-R68W (Zisch/Drieth 1)	MD Reference:	WELL @ 5099.0ft (Original Well Elev)
Site Error:	0.0ft	North Reference:	True
Reference Well:	Drieth 1C-6H-A368	Survey Calculation Method:	Minimum Curvature
Well Error:	0.0ft	Output errors are at	2.00 sigma
Reference Wellbore	Hz	Database:	USA EDM 5000 Multi Users DB
Reference Design:	Plan #1	Offset TVD Reference:	Offset Datum

Offset Design													S6-T3N-R68W (Zisch/Drieth 1) - Drieth 1B-6H-A368 - Hz - Plan #1		Offset Site Error:		0.0 ft			
Survey Program:				0-MWD														Offset Well Error:		0.0 ft
Reference		Offset		Semi Major Axis			Distance													
Measured Depth (ft)	Vertical Depth (ft)	Measured Depth (ft)	Vertical Depth (ft)	Reference (ft)	Offset (ft)	Highside Toolface (°)	Offset Wellbore Centre +N/-S (ft)	+E/-W (ft)	Between Centres (ft)	Between Ellipses (ft)	Total Uncertainty Axis	Separation Factor	Warning							
10,200.0	7,036.0	10,422.1	7,257.0	80.0	80.0	122.18	222.5	-3,036.6	413.0	276.8	136.28	3.031								
10,300.0	7,036.0	10,522.1	7,257.0	82.4	82.4	122.18	222.5	-3,136.6	413.1	272.6	140.42	2.942								
10,400.0	7,036.0	10,622.1	7,257.0	84.9	84.9	122.18	222.5	-3,236.6	413.1	268.5	144.56	2.857								
10,500.0	7,036.0	10,722.1	7,257.0	87.3	87.3	122.18	222.5	-3,336.6	413.1	264.4	148.71	2.778								
10,600.0	7,036.0	10,822.1	7,257.0	89.8	89.8	122.18	222.5	-3,436.6	413.1	260.2	152.85	2.702								
10,700.0	7,036.0	10,922.1	7,257.0	92.2	92.2	122.18	222.5	-3,536.6	413.1	256.1	157.00	2.631								
10,800.0	7,036.0	11,022.1	7,257.0	94.7	94.7	122.18	222.5	-3,636.6	413.1	251.9	161.16	2.563								
10,900.0	7,036.0	11,122.1	7,257.0	97.1	97.1	122.18	222.5	-3,736.6	413.1	247.8	165.31	2.499								
11,000.0	7,036.0	11,222.1	7,257.0	99.6	99.6	122.18	222.6	-3,836.6	413.1	243.7	169.47	2.438								
11,100.0	7,036.0	11,322.1	7,257.0	102.0	102.0	122.18	222.6	-3,936.6	413.1	239.5	173.63	2.379								
11,200.0	7,036.0	11,422.1	7,257.0	104.5	104.5	122.18	222.6	-4,036.6	413.1	235.4	177.79	2.324								
11,300.0	7,036.0	11,522.1	7,257.0	106.9	106.9	122.17	222.6	-4,136.6	413.1	231.2	181.95	2.271								
11,400.0	7,036.0	11,622.1	7,257.0	109.4	109.4	122.17	222.6	-4,236.6	413.2	227.0	186.11	2.220								
11,433.4	7,036.0	11,655.4	7,257.0	110.2	110.2	122.17	222.6	-4,270.0	413.2	225.7	187.50	2.203 SF								

Anticollision Report

Company:	EnCana Oil & Gas (USA) Inc	Local Co-ordinate Reference:	Well Drieth 1C-6H-A368
Project:	DJ Wattenberg	TVD Reference:	WELL @ 5099.0ft (Original Well Elev)
Reference Site:	S6-T3N-R68W (Zisch/Drieth 1)	MD Reference:	WELL @ 5099.0ft (Original Well Elev)
Site Error:	0.0ft	North Reference:	True
Reference Well:	Drieth 1C-6H-A368	Survey Calculation Method:	Minimum Curvature
Well Error:	0.0ft	Output errors are at	2.00 sigma
Reference Wellbore	Hz	Database:	USA EDM 5000 Multi Users DB
Reference Design:	Plan #1	Offset TVD Reference:	Offset Datum

Offset Design S6-T3N-R68W (Zisch/Drieth 1) - Drieth 1D-6H-A368 - Hz - Plan #1													Offset Site Error:	0.0 ft
Survey Program: 0-MWD													Offset Well Error:	0.0 ft
Reference		Offset		Semi Major Axis		Distance		Total		Separation		Warning		
Measured Depth (ft)	Vertical Depth (ft)	Measured Depth (ft)	Vertical Depth (ft)	Reference (ft)	Offset (ft)	Highside Toolface (°)	Offset Wellbore Centre +N/-S (ft)	+E/-W (ft)	Between Centres (ft)	Between Ellipses (ft)	Uncertainty Axis			
0.0	0.0	0.0	0.0	0.0	0.0	180.00	-10.9	0.0	10.9					
100.0	100.0	100.0	100.0	0.2	0.2	180.00	-10.9	0.0	10.9	10.6	0.30	35.986		
200.0	200.0	200.0	200.0	0.3	0.3	180.00	-10.9	0.0	10.9	10.3	0.65	16.742		
300.0	300.0	300.0	300.0	0.5	0.5	180.00	-10.9	0.0	10.9	9.9	1.00	10.909 CC, ES		
400.0	400.0	399.8	399.8	0.7	0.7	177.18	-11.6	0.6	11.6	10.2	1.35	8.585		
500.0	500.0	499.7	499.6	0.9	0.9	66.25	-13.6	2.3	13.4	11.7	1.70	7.862		
600.0	600.0	599.4	599.3	1.0	1.0	65.92	-16.8	5.1	15.9	13.8	2.06	7.731		
700.0	699.9	699.1	698.8	1.2	1.2	67.49	-21.4	9.1	19.2	16.7	2.42	7.910		
800.0	799.7	798.7	798.1	1.4	1.4	70.01	-27.3	14.2	23.2	20.4	2.80	8.266		
900.0	899.4	898.3	897.2	1.6	1.7	72.84	-34.5	20.5	28.0	24.8	3.21	8.726		
1,000.0	998.9	997.7	996.0	1.8	1.9	75.65	-42.9	27.8	33.7	30.1	3.65	9.237		
1,100.0	1,098.3	1,097.0	1,094.5	2.1	2.2	78.26	-52.7	36.3	40.3	36.2	4.13	9.763		
1,200.0	1,197.4	1,196.2	1,192.6	2.3	2.5	80.60	-63.7	45.9	47.8	43.1	4.65	10.279		
1,300.0	1,296.3	1,295.3	1,290.3	2.6	2.8	82.67	-76.0	56.6	56.2	50.9	5.21	10.769		
1,400.0	1,394.9	1,394.2	1,387.5	2.9	3.1	84.49	-89.5	68.3	65.5	59.6	5.83	11.224		
1,500.0	1,493.4	1,492.9	1,484.3	3.3	3.5	85.51	-104.3	81.2	75.8	69.3	6.48	11.699		
1,600.0	1,591.9	1,592.3	1,581.5	3.6	3.9	85.77	-119.9	94.7	86.6	79.5	7.12	12.159		
1,700.0	1,690.4	1,691.7	1,678.8	3.9	4.3	85.96	-135.5	108.3	97.5	89.7	7.78	12.528		
1,800.0	1,788.9	1,791.1	1,776.0	4.3	4.6	86.12	-151.1	121.8	108.4	99.9	8.45	12.829		
1,900.0	1,887.3	1,890.5	1,873.2	4.6	5.0	86.24	-166.7	135.4	119.2	110.1	9.12	13.078		
2,000.0	1,985.8	1,989.9	1,970.5	4.9	5.4	86.35	-182.3	149.0	130.1	120.3	9.79	13.288		
2,100.0	2,084.3	2,089.3	2,067.7	5.3	5.8	86.44	-197.9	162.5	141.0	130.5	10.47	13.465		
2,200.0	2,182.8	2,188.7	2,164.9	5.6	6.2	86.51	-213.5	176.1	151.8	140.7	11.15	13.618		
2,300.0	2,281.3	2,288.1	2,262.2	6.0	6.6	86.58	-229.1	189.6	162.7	150.9	11.83	13.751		
2,400.0	2,379.7	2,387.5	2,359.4	6.3	7.0	86.64	-244.7	203.2	173.6	161.1	12.52	13.866		
2,500.0	2,478.2	2,487.0	2,456.6	6.7	7.4	86.69	-260.3	216.8	184.5	171.3	13.21	13.968		
2,600.0	2,576.7	2,586.4	2,553.9	7.0	7.8	86.74	-275.9	230.3	195.3	181.4	13.89	14.059		
2,700.0	2,675.2	2,685.8	2,651.1	7.4	8.2	86.78	-291.5	243.9	206.2	191.6	14.58	14.140		
2,800.0	2,773.7	2,785.2	2,748.3	7.7	8.6	86.81	-307.1	257.4	217.1	201.8	15.27	14.212		
2,900.0	2,872.2	2,884.6	2,845.6	8.0	9.0	86.81	-322.7	271.0	228.0	212.0	15.95	14.292		
3,000.0	2,971.0	2,983.9	2,942.8	8.4	9.4	86.46	-338.3	284.6	239.0	222.4	16.58	14.417		
3,100.0	3,070.1	3,083.3	3,039.9	8.6	9.8	85.74	-353.9	298.1	250.1	233.0	17.15	14.585		
3,200.0	3,169.4	3,182.5	3,137.0	8.9	10.2	84.71	-369.4	311.6	261.4	243.8	17.67	14.799		
3,300.0	3,268.9	3,282.1	3,234.4	9.1	10.6	83.42	-385.0	325.2	273.1	254.9	18.13	15.063		
3,400.0	3,368.5	3,384.3	3,334.6	9.3	11.0	82.03	-400.2	338.4	284.3	265.8	18.53	15.344		
3,500.0	3,468.3	3,486.8	3,435.5	9.5	11.3	80.67	-414.0	350.4	294.9	276.0	18.88	15.618		
3,600.0	3,568.2	3,589.7	3,537.0	9.7	11.6	79.32	-426.5	361.3	304.8	285.6	19.18	15.889		
3,700.0	3,668.1	3,692.8	3,639.0	9.8	11.9	77.99	-437.7	370.9	313.9	294.5	19.43	16.156		
3,800.0	3,768.1	3,796.1	3,741.6	10.0	12.2	76.64	-447.4	379.4	322.4	302.8	19.63	16.421		
3,900.0	3,868.1	3,899.8	3,844.6	10.1	12.5	-177.20	-455.8	386.8	330.1	312.9	17.16	19.231		
4,000.0	3,968.1	4,003.8	3,948.2	10.2	12.7	-178.30	-462.9	392.9	336.6	318.9	17.67	19.045		
4,100.0	4,068.1	4,108.1	4,052.3	10.3	12.9	-179.14	-468.5	397.7	341.9	323.7	18.13	18.853		
4,200.0	4,168.1	4,212.7	4,156.7	10.4	13.0	-179.76	-472.7	401.4	345.8	327.3	18.55	18.647		
4,300.0	4,268.1	4,317.4	4,261.3	10.6	13.2	179.85	-475.4	403.8	348.5	329.6	18.91	18.424		
4,400.0	4,368.1	4,422.2	4,366.2	10.7	13.3	179.66	-476.7	404.9	349.7	330.5	19.24	18.178		
4,500.0	4,468.1	4,524.2	4,468.1	10.8	13.4	179.64	-476.9	405.0	349.9	330.3	19.53	17.912		
4,600.0	4,568.1	4,624.2	4,568.1	10.9	13.5	179.64	-476.9	405.0	349.9	330.0	19.82	17.651		
4,700.0	4,668.1	4,724.2	4,668.1	11.1	13.6	179.64	-476.9	405.0	349.9	329.7	20.11	17.396		
4,800.0	4,768.1	4,824.2	4,768.1	11.2	13.7	179.64	-476.9	405.0	349.9	329.4	20.40	17.146		
4,900.0	4,868.1	4,924.2	4,868.1	11.3	13.8	179.64	-476.9	405.0	349.9	329.2	20.70	16.903		
5,000.0	4,968.1	5,024.2	4,968.1	11.5	13.9	179.64	-476.9	405.0	349.9	328.9	20.99	16.665		
5,100.0	5,068.1	5,124.2	5,068.1	11.6	14.1	179.64	-476.9	405.0	349.9	328.6	21.29	16.432		

CC - Min centre to center distance or convergent point, SF - min separation factor, ES - min ellipse separation

Anticollision Report

Company:	EnCana Oil & Gas (USA) Inc	Local Co-ordinate Reference:	Well Drieth 1C-6H-A368
Project:	DJ Wattenberg	TVD Reference:	WELL @ 5099.0ft (Original Well Elev)
Reference Site:	S6-T3N-R68W (Zisch/Drieth 1)	MD Reference:	WELL @ 5099.0ft (Original Well Elev)
Site Error:	0.0ft	North Reference:	True
Reference Well:	Drieth 1C-6H-A368	Survey Calculation Method:	Minimum Curvature
Well Error:	0.0ft	Output errors are at	2.00 sigma
Reference Wellbore	Hz	Database:	USA EDM 5000 Multi Users DB
Reference Design:	Plan #1	Offset TVD Reference:	Offset Datum

Offset Design S6-T3N-R68W (Zisch/Drieth 1) - Drieth 1D-6H-A368 - Hz - Plan #1													Offset Site Error:	0.0 ft
Survey Program: O-MWD													Offset Well Error:	0.0 ft
Reference		Offset		Semi Major Axis		Distance		Total		Separation		Warning		
Measured Depth (ft)	Vertical Depth (ft)	Measured Depth (ft)	Vertical Depth (ft)	Reference (ft)	Offset (ft)	Highside Toolface (°)	Offset Wellbore Centre +N/-S (ft)	+E/-W (ft)	Between Centres (ft)	Between Ellipses (ft)	Uncertainty Axis			
5,200.0	5,168.1	5,224.2	5,168.1	11.7	14.2	179.64	-476.9	405.0	349.9	328.3	21.59	16.205		
5,300.0	5,268.1	5,324.2	5,268.1	11.9	14.3	179.64	-476.9	405.0	349.9	328.0	21.89	15.984		
5,400.0	5,368.1	5,424.2	5,368.1	12.0	14.4	179.64	-476.9	405.0	349.9	327.7	22.19	15.767		
5,500.0	5,468.1	5,524.2	5,468.1	12.1	14.5	179.64	-476.9	405.0	349.9	327.4	22.49	15.555		
5,600.0	5,568.1	5,624.2	5,568.1	12.3	14.6	179.64	-476.9	405.0	349.9	327.1	22.79	15.348		
5,700.0	5,668.1	5,724.2	5,668.1	12.4	14.7	179.64	-476.9	405.0	349.9	326.8	23.10	15.146		
5,800.0	5,768.1	5,824.2	5,768.1	12.6	14.9	179.64	-476.9	405.0	349.9	326.4	23.40	14.949		
5,900.0	5,868.1	5,924.2	5,868.1	12.7	15.0	179.64	-476.9	405.0	349.9	326.1	23.71	14.755		
6,000.0	5,968.1	6,024.2	5,968.1	12.8	15.1	179.64	-476.9	405.0	349.9	325.8	24.02	14.566		
6,100.0	6,068.1	6,124.2	6,068.1	13.0	15.2	179.64	-476.9	405.0	349.9	325.5	24.33	14.382		
6,200.0	6,168.1	6,224.2	6,168.1	13.1	15.3	179.64	-476.9	405.0	349.9	325.2	24.64	14.201		
6,300.0	6,268.1	6,324.2	6,268.1	13.3	15.5	179.64	-476.9	405.0	349.9	324.9	24.95	14.024		
6,340.7	6,308.8	6,364.9	6,308.8	13.3	15.5	-90.45	-476.9	405.0	349.9	323.6	26.24	13.331		
6,400.0	6,368.1	6,424.2	6,368.1	13.4	15.6	-90.62	-476.9	405.0	349.9	323.5	26.38	13.262		
6,500.0	6,467.1	6,523.2	6,467.1	13.4	15.7	-92.80	-476.9	405.0	350.3	324.0	26.30	13.316		
6,600.0	6,563.2	6,620.8	6,564.7	13.3	15.8	-96.89	-476.9	404.6	352.7	326.7	25.92	13.604		
6,700.0	6,654.6	6,724.7	6,668.0	13.1	15.8	-101.53	-476.9	393.5	357.8	332.4	25.35	14.116		
6,800.0	6,739.4	6,834.0	6,773.5	12.8	15.8	-105.95	-476.9	365.8	365.1	340.4	24.71	14.773		
6,900.0	6,816.1	6,949.0	6,878.8	12.7	15.6	-110.04	-476.9	319.7	374.1	349.9	24.15	15.491		
7,000.0	6,883.1	7,070.4	6,980.4	12.6	15.4	-113.68	-476.9	253.5	383.9	360.1	23.80	16.131		
7,100.0	6,939.2	7,198.1	7,073.5	12.8	15.2	-116.77	-476.9	166.4	393.5	369.7	23.83	16.512		
7,200.0	6,983.2	7,331.9	7,153.0	13.4	15.2	-119.24	-476.9	58.9	402.1	377.6	24.50	16.411		
7,300.0	7,014.3	7,470.9	7,212.8	14.5	15.6	-120.99	-476.9	-66.2	408.7	382.8	25.87	15.795		
7,400.0	7,031.9	7,613.5	7,248.0	15.9	16.9	-121.97	-476.9	-204.2	412.5	384.4	28.09	14.684		
7,500.0	7,036.0	7,746.4	7,256.0	17.5	18.8	-122.17	-476.9	-336.7	413.3	382.3	30.96	13.349		
7,600.0	7,036.0	7,846.4	7,256.0	19.3	20.5	-122.17	-476.9	-436.7	413.3	379.3	33.99	12.157		
7,700.0	7,036.0	7,946.4	7,256.0	21.2	22.4	-122.17	-476.9	-536.7	413.2	376.0	37.25	11.094		
7,800.0	7,036.0	8,046.4	7,256.0	23.3	24.4	-122.17	-476.9	-636.7	413.2	372.6	40.68	10.159		
7,900.0	7,036.0	8,146.4	7,256.0	25.4	26.4	-122.17	-476.9	-736.7	413.2	369.0	44.24	9.342		
8,000.0	7,036.0	8,246.4	7,256.0	27.6	28.5	-122.17	-476.9	-836.7	413.2	365.3	47.90	8.627		
8,100.0	7,036.0	8,346.4	7,256.0	29.8	30.7	-122.17	-476.9	-936.7	413.2	361.6	51.64	8.002		
8,200.0	7,036.0	8,446.4	7,256.0	32.1	32.9	-122.17	-476.9	-1,036.7	413.2	357.8	55.45	7.452		
8,300.0	7,036.0	8,546.4	7,256.0	34.4	35.2	-122.17	-476.9	-1,136.7	413.2	353.9	59.31	6.967		
8,400.0	7,036.0	8,646.4	7,256.0	36.7	37.5	-122.17	-476.9	-1,236.7	413.2	350.0	63.22	6.537		
8,500.0	7,036.0	8,746.4	7,256.0	39.0	39.8	-122.17	-476.9	-1,336.7	413.2	346.1	67.16	6.153		
8,600.0	7,036.0	8,846.4	7,256.0	41.4	42.1	-122.17	-476.9	-1,436.7	413.2	342.1	71.12	5.810		
8,700.0	7,036.0	8,946.4	7,256.0	43.7	44.4	-122.17	-476.9	-1,536.7	413.2	338.1	75.12	5.501		
8,800.0	7,036.0	9,046.4	7,256.0	46.1	46.8	-122.17	-476.9	-1,636.7	413.2	334.1	79.13	5.222		
8,900.0	7,036.0	9,146.4	7,256.0	48.5	49.1	-122.17	-476.9	-1,736.7	413.2	330.1	83.16	4.969		
9,000.0	7,036.0	9,246.4	7,256.0	50.9	51.5	-122.17	-476.9	-1,836.7	413.2	326.0	87.21	4.738		
9,100.0	7,036.0	9,346.4	7,256.0	53.3	53.9	-122.17	-476.9	-1,936.7	413.2	321.9	91.27	4.528		
9,200.0	7,036.0	9,446.4	7,256.0	55.7	56.3	-122.17	-476.9	-2,036.7	413.2	317.9	95.34	4.334		
9,300.0	7,036.0	9,546.4	7,256.0	58.1	58.7	-122.17	-476.9	-2,136.7	413.2	313.8	99.42	4.156		
9,400.0	7,036.0	9,646.4	7,256.0	60.5	61.1	-122.17	-476.9	-2,236.7	413.2	309.7	103.51	3.992		
9,500.0	7,036.0	9,746.4	7,256.0	62.9	63.5	-122.17	-476.9	-2,336.7	413.2	305.6	107.61	3.840		
9,600.0	7,036.0	9,846.4	7,256.0	65.4	65.9	-122.17	-476.9	-2,436.7	413.2	301.5	111.71	3.699		
9,700.0	7,036.0	9,946.4	7,256.0	67.8	68.3	-122.17	-476.8	-2,536.7	413.2	297.4	115.83	3.567		
9,800.0	7,036.0	10,046.4	7,256.0	70.2	70.7	-122.17	-476.8	-2,636.7	413.2	293.3	119.94	3.445		
9,900.0	7,036.0	10,146.4	7,256.0	72.7	73.2	-122.17	-476.8	-2,736.7	413.2	289.1	124.07	3.330		
10,000.0	7,036.0	10,246.4	7,256.0	75.1	75.6	-122.17	-476.8	-2,836.7	413.2	285.0	128.19	3.223		
10,100.0	7,036.0	10,346.4	7,256.0	77.5	78.0	-122.17	-476.8	-2,936.7	413.2	280.9	132.32	3.123		
10,200.0	7,036.0	10,446.4	7,256.0	80.0	80.5	-122.17	-476.8	-3,036.7	413.2	276.7	136.46	3.028		

CC - Min centre to center distance or convergent point, SF - min separation factor, ES - min ellipse separation

Anticollision Report

Company:	EnCana Oil & Gas (USA) Inc	Local Co-ordinate Reference:	Well Drieth 1C-6H-A368
Project:	DJ Wattenberg	TVD Reference:	WELL @ 5099.0ft (Original Well Elev)
Reference Site:	S6-T3N-R68W (Zisch/Drieth 1)	MD Reference:	WELL @ 5099.0ft (Original Well Elev)
Site Error:	0.0ft	North Reference:	True
Reference Well:	Drieth 1C-6H-A368	Survey Calculation Method:	Minimum Curvature
Well Error:	0.0ft	Output errors are at	2.00 sigma
Reference Wellbore	Hz	Database:	USA EDM 5000 Multi Users DB
Reference Design:	Plan #1	Offset TVD Reference:	Offset Datum

Offset Design													S6-T3N-R68W (Zisch/Drieth 1) - Drieth 1D-6H-A368 - Hz - Plan #1		Offset Site Error:		0.0 ft
Survey Program:													0-MWD		Offset Well Error:		0.0 ft
Reference		Offset		Semi Major Axis			Distance							Warning			
Measured Depth (ft)	Vertical Depth (ft)	Measured Depth (ft)	Vertical Depth (ft)	Reference (ft)	Offset (ft)	Highside Toolface (°)	Offset Wellbore Centre +N/-S (ft)	+E/-W (ft)	Between Centres (ft)	Between Ellipses (ft)	Total Uncertainty Axis	Separation Factor					
10,300.0	7,036.0	10,546.4	7,256.0	82.4	82.9	-122.17	-476.8	-3,136.7	413.2	272.6	140.60	2.939					
10,400.0	7,036.0	10,646.4	7,256.0	84.9	85.3	-122.17	-476.8	-3,236.7	413.2	268.4	144.74	2.855					
10,500.0	7,036.0	10,746.4	7,256.0	87.3	87.8	-122.17	-476.8	-3,336.7	413.2	264.3	148.89	2.775					
10,600.0	7,036.0	10,846.4	7,256.0	89.8	90.2	-122.17	-476.8	-3,436.7	413.2	260.1	153.03	2.700					
10,700.0	7,036.0	10,946.4	7,256.0	92.2	92.7	-122.17	-476.8	-3,536.7	413.2	256.0	157.18	2.629					
10,800.0	7,036.0	11,046.4	7,256.0	94.7	95.1	-122.17	-476.8	-3,636.7	413.2	251.8	161.34	2.561					
10,900.0	7,036.0	11,146.4	7,256.0	97.1	97.5	-122.17	-476.8	-3,736.7	413.2	247.7	165.49	2.497					
11,000.0	7,036.0	11,246.4	7,256.0	99.6	100.0	-122.17	-476.8	-3,836.7	413.2	243.5	169.65	2.435					
11,100.0	7,036.0	11,346.4	7,256.0	102.0	102.4	-122.17	-476.8	-3,936.7	413.2	239.4	173.80	2.377					
11,200.0	7,036.0	11,446.4	7,256.0	104.5	104.9	-122.17	-476.8	-4,036.7	413.2	235.2	177.96	2.322					
11,300.0	7,036.0	11,546.4	7,256.0	106.9	107.3	-122.17	-476.8	-4,136.7	413.2	231.0	182.12	2.269					
11,400.0	7,036.0	11,646.4	7,256.0	109.4	109.8	-122.17	-476.8	-4,236.7	413.2	226.9	186.29	2.218					
11,433.4	7,036.0	11,679.7	7,256.0	110.2	110.6	-122.17	-476.8	-4,270.0	413.2	225.5	187.68	2.201 SF					

Anticollision Report

Company:	EnCana Oil & Gas (USA) Inc	Local Co-ordinate Reference:	Well Drieth 1C-6H-A368
Project:	DJ Wattenberg	TVD Reference:	WELL @ 5099.0ft (Original Well Elev)
Reference Site:	S6-T3N-R68W (Zisch/Drieth 1)	MD Reference:	WELL @ 5099.0ft (Original Well Elev)
Site Error:	0.0ft	North Reference:	True
Reference Well:	Drieth 1C-6H-A368	Survey Calculation Method:	Minimum Curvature
Well Error:	0.0ft	Output errors are at	2.00 sigma
Reference Wellbore	Hz	Database:	USA EDM 5000 Multi Users DB
Reference Design:	Plan #1	Offset TVD Reference:	Offset Datum

Offset Design S6-T3N-R68W (Zisch/Drieth 1) - Drieth 1E-6H-A368 - Hz - Plan #1													Offset Site Error:	0.0 ft
Survey Program: 0-MWD													Offset Well Error:	0.0 ft
Reference		Offset		Semi Major Axis		Highside Toolface (°)	Distance		Total Uncertainty Axis	Separation Factor	Warning			
Measured Depth (ft)	Vertical Depth (ft)	Measured Depth (ft)	Vertical Depth (ft)	Reference (ft)	Offset (ft)		Offset Wellbore Centre +N/-S (ft)	+E/-W (ft)						
0.0	0.0	0.0	0.0	0.0	0.0	-180.00	-21.9	0.0	21.9					
100.0	100.0	100.0	100.0	0.2	0.2	-180.00	-21.9	0.0	21.9	21.6	0.30	71.973		
200.0	200.0	200.0	200.0	0.3	0.3	-180.00	-21.9	0.0	21.9	21.2	0.65	33.485 CC, ES		
300.0	300.0	299.7	299.6	0.5	0.5	179.02	-22.6	0.4	22.6	21.6	1.00	22.590		
400.0	400.0	399.2	399.2	0.7	0.7	176.44	-25.0	1.6	25.0	23.7	1.36	18.453		
500.0	500.0	498.7	498.6	0.9	0.9	67.15	-28.8	3.5	28.7	27.0	1.70	16.883		
600.0	600.0	598.1	597.8	1.0	1.1	67.46	-34.2	6.2	33.4	31.3	2.06	16.233		
700.0	699.9	697.4	696.8	1.2	1.3	69.10	-41.1	9.7	39.0	36.6	2.42	16.111 SF		
800.0	799.7	796.5	795.4	1.4	1.5	71.45	-49.6	13.9	45.6	42.8	2.80	16.296		
900.0	899.4	895.4	893.7	1.6	1.8	74.12	-59.5	18.9	53.3	50.1	3.20	16.661		
1,000.0	998.9	994.1	991.6	1.8	2.0	76.83	-71.0	24.6	62.2	58.6	3.63	17.124		
1,100.0	1,098.3	1,092.6	1,089.0	2.1	2.3	79.43	-83.9	31.1	72.3	68.2	4.10	17.628		
1,200.0	1,197.4	1,190.8	1,185.8	2.3	2.6	81.84	-98.3	38.3	83.7	79.0	4.61	18.137		
1,300.0	1,296.3	1,288.7	1,282.2	2.6	3.0	84.04	-114.1	46.2	96.3	91.1	5.17	18.628		
1,400.0	1,394.9	1,386.3	1,377.8	2.9	3.3	86.01	-131.3	54.8	110.2	104.4	5.77	19.088		
1,500.0	1,493.4	1,483.6	1,472.9	3.3	3.7	87.53	-149.9	64.1	125.4	119.0	6.40	19.589		
1,600.0	1,591.9	1,580.6	1,567.2	3.6	4.1	88.25	-169.9	74.1	141.9	134.8	7.04	20.149		
1,700.0	1,690.4	1,677.1	1,660.8	3.9	4.6	88.41	-191.2	84.8	159.6	151.9	7.69	20.750		
1,800.0	1,788.9	1,774.9	1,755.3	4.3	5.0	88.28	-213.8	96.1	178.2	169.8	8.35	21.347		
1,900.0	1,887.3	1,873.2	1,850.2	4.6	5.5	88.16	-236.5	107.5	196.8	187.8	9.01	21.844		
2,000.0	1,985.8	1,971.4	1,945.1	4.9	6.0	88.06	-259.2	118.9	215.4	205.7	9.67	22.263		
2,100.0	2,084.3	2,069.7	2,040.0	5.3	6.4	87.98	-282.0	130.3	234.0	223.6	10.34	22.621		
2,200.0	2,182.8	2,167.9	2,134.9	5.6	6.9	87.91	-304.7	141.6	252.6	241.6	11.02	22.930		
2,300.0	2,281.3	2,266.2	2,229.8	6.0	7.4	87.85	-327.5	153.0	271.2	259.5	11.69	23.198		
2,400.0	2,379.7	2,364.4	2,324.7	6.3	7.8	87.80	-350.2	164.4	289.8	277.4	12.37	23.433		
2,500.0	2,478.2	2,462.7	2,419.6	6.7	8.3	87.75	-372.9	175.8	308.4	295.4	13.05	23.641		
2,600.0	2,576.7	2,560.9	2,514.5	7.0	8.8	87.71	-395.7	187.2	327.0	313.3	13.73	23.825		
2,700.0	2,675.2	2,659.2	2,609.4	7.4	9.2	87.67	-418.4	198.6	345.6	331.2	14.41	23.990		
2,800.0	2,773.7	2,757.4	2,704.3	7.7	9.7	87.64	-441.1	210.0	364.3	349.2	15.09	24.139		
2,900.0	2,872.2	2,855.7	2,799.2	8.0	10.2	87.68	-463.9	221.3	382.9	367.1	15.77	24.284		
3,000.0	2,971.0	2,953.9	2,894.1	8.4	10.7	87.54	-486.6	232.7	401.6	385.2	16.40	24.490		
3,100.0	3,070.1	3,052.0	2,988.9	8.6	11.1	87.19	-509.3	244.1	420.4	403.4	16.98	24.754		
3,200.0	3,169.4	3,150.1	3,083.6	8.9	11.6	86.66	-532.0	255.5	439.3	421.8	17.52	25.078		
3,300.0	3,268.9	3,248.0	3,178.2	9.1	12.1	85.97	-554.7	266.8	458.4	440.4	18.01	25.461		
3,400.0	3,368.5	3,345.8	3,272.6	9.3	12.6	85.14	-577.3	278.1	477.8	459.4	18.44	25.907		
3,500.0	3,468.3	3,443.3	3,366.9	9.5	13.0	84.20	-599.9	289.4	497.5	478.6	18.83	26.419		

Anticollision Report

Company:	EnCana Oil & Gas (USA) Inc	Local Co-ordinate Reference:	Well Drieth 1C-6H-A368
Project:	DJ Wattenberg	TVD Reference:	WELL @ 5099.0ft (Original Well Elev)
Reference Site:	S6-T3N-R68W (Zisch/Drieth 1)	MD Reference:	WELL @ 5099.0ft (Original Well Elev)
Site Error:	0.0ft	North Reference:	True
Reference Well:	Drieth 1C-6H-A368	Survey Calculation Method:	Minimum Curvature
Well Error:	0.0ft	Output errors are at	2.00 sigma
Reference Wellbore	Hz	Database:	USA EDM 5000 Multi Users DB
Reference Design:	Plan #1	Offset TVD Reference:	Offset Datum

Reference Depths are relative to WELL @ 5099.0ft (Original Well Elev)

Offset Depths are relative to Offset Datum

Central Meridian is -105.500000 °

Coordinates are relative to: Drieth 1C-6H-A368

Coordinate System is US State Plane 1983, Colorado Northern Zone

Grid Convergence at Surface is: 0.30°

