

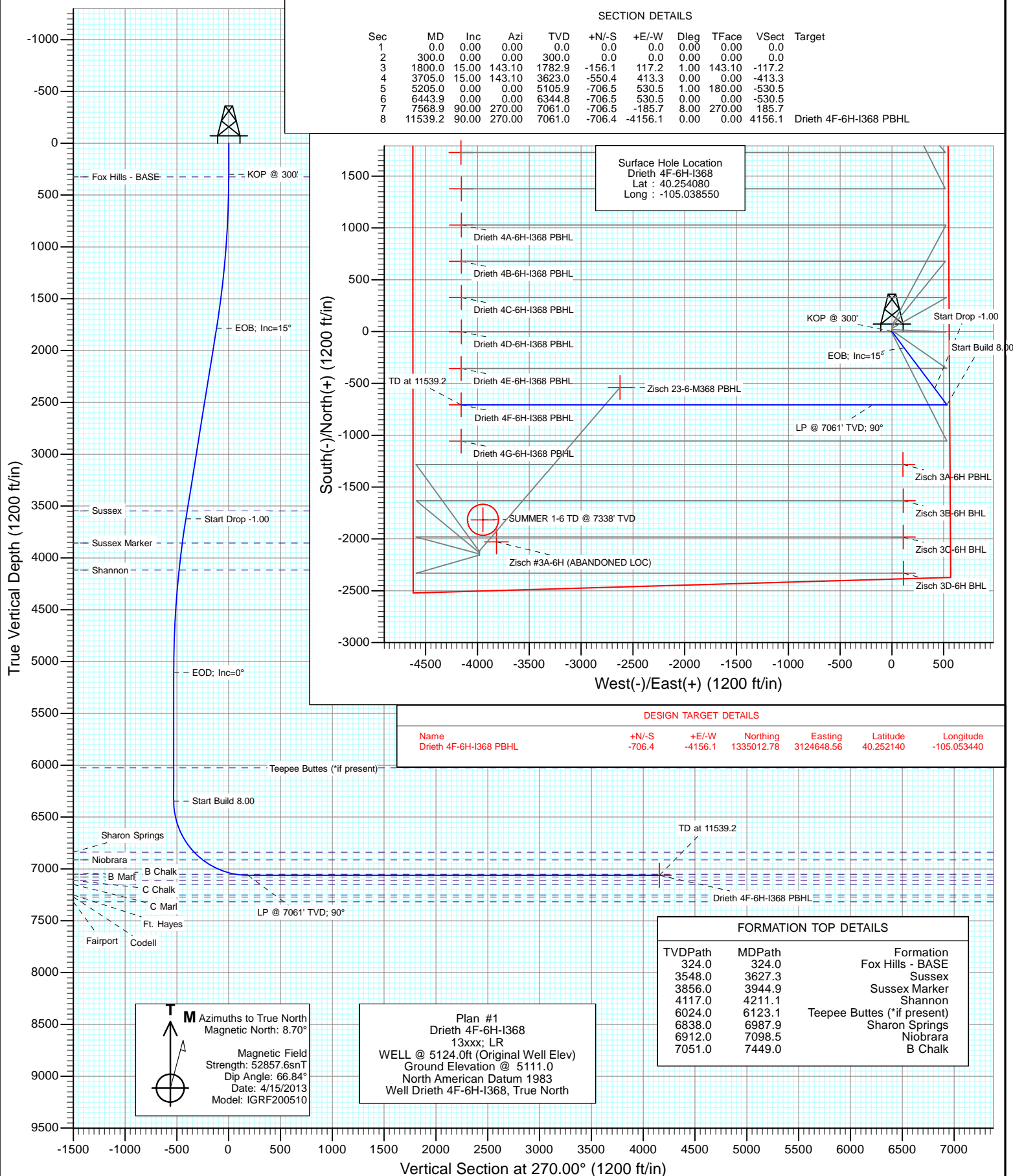

Project: DJ Wattenberg  
Site: S6-T3N-R68W (Zisch/Drieth)  
Well: Drieth 4F-6H-I368  
Design: Plan #1



## Planning Report

<b>Database:</b>	USA EDM 5000 Multi Users DB	<b>Local Co-ordinate Reference:</b>	Well Drieth 4F-6H-I368
<b>Company:</b>	EnCana Oil & Gas (USA) Inc	<b>TVD Reference:</b>	WELL @ 5124.0ft (Original Well Elev)
<b>Project:</b>	DJ Wattenberg	<b>MD Reference:</b>	WELL @ 5124.0ft (Original Well Elev)
<b>Site:</b>	S6-T3N-R68W (Zisch/Drieth)	<b>North Reference:</b>	True
<b>Well:</b>	Drieth 4F-6H-I368	<b>Survey Calculation Method:</b>	Minimum Curvature
<b>Wellbore:</b>	Hz		
<b>Design:</b>	Plan #1		

<b>Project</b>	DJ Wattenberg		
<b>Map System:</b>	US State Plane 1983	<b>System Datum:</b>	Mean Sea Level
<b>Geo Datum:</b>	North American Datum 1983		
<b>Map Zone:</b>	Colorado Northern Zone		

Site		S6-T3N-R68W (Zisch/Drieth)			
Site Position:		Northing:	1,333,692.14 ft	Latitude:	40.248510
From:	Lat/Long	Easting:	3,124,995.76 ft	Longitude:	-105.052220
Position Uncertainty:	0.0 ft	Slot Radius:	13.200 in	Grid Convergence:	0.29 °

Well	Drieth 4F-6H-I368					
Well Position	+N/-S	0.0 ft	Northing:	1,335,740.76 ft	Latitude:	40.254080
	+E/-W	0.0 ft	Easting:	3,128,800.90 ft	Longitude:	-105.038550
Position Uncertainty		0.0 ft	Wellhead Elevation:	ft	Ground Level:	5,111.0 ft

<b>Wellbore</b>	Hz				
<b>Magnetics</b>	<b>Model Name</b>	<b>Sample Date</b>	<b>Declination (°)</b>	<b>Dip Angle (°)</b>	<b>Field Strength (nT)</b>
	IGRF200510	4/15/2013	8.70	66.84	52,858

<b>Design</b>	Plan #1			
<b>Audit Notes:</b>				
<b>Version:</b>	<b>Phase:</b>	PLAN	<b>Tie On Depth:</b>	0.0
<b>Vertical Section:</b>	<b>Depth From (TVD) (ft)</b>	<b>+N/-S (ft)</b>	<b>+E/-W (ft)</b>	<b>Direction (°)</b>
	0.0	0.0	0.0	270.00

<b>Plan Sections</b>										
Measured Depth (ft)	Inclination (°)	Azimuth (°)	Vertical Depth (ft)	+N/-S (ft)	+E/-W (ft)	Dogleg Rate (°/100ft)	Build Rate (°/100ft)	Turn Rate (°/100ft)	TFO (°)	Target
0.0	0.00	0.00	0.0	0.0	0.0	0.00	0.00	0.00	0.00	
300.0	0.00	0.00	300.0	0.0	0.0	0.00	0.00	0.00	0.00	
1,800.0	15.00	143.10	1,782.9	-156.1	117.2	1.00	1.00	0.00	143.10	
3,705.0	15.00	143.10	3,623.0	-550.4	413.3	0.00	0.00	0.00	0.00	
5,205.0	0.00	0.00	5,105.9	-706.5	530.5	1.00	-1.00	0.00	180.00	
6,443.9	0.00	0.00	6,344.8	-706.5	530.5	0.00	0.00	0.00	0.00	
7,568.9	90.00	270.00	7,061.0	-706.5	-185.7	8.00	8.00	0.00	270.00	
11,539.2	90.00	270.00	7,061.0	-706.4	-4,156.1	0.00	0.00	0.00	0.00	Drieth 4F-6H-I368 PB

# Planning Report

<b>Database:</b>	USA EDM 5000 Multi Users DB	<b>Local Co-ordinate Reference:</b>	Well Drieth 4F-6H-I368
<b>Company:</b>	EnCana Oil & Gas (USA) Inc	<b>TVD Reference:</b>	WELL @ 5124.0ft (Original Well Elev)
<b>Project:</b>	DJ Wattenberg	<b>MD Reference:</b>	WELL @ 5124.0ft (Original Well Elev)
<b>Site:</b>	S6-T3N-R68W (Zisch/Drieth)	<b>North Reference:</b>	True
<b>Well:</b>	Drieth 4F-6H-I368	<b>Survey Calculation Method:</b>	Minimum Curvature
<b>Wellbore:</b>	Hz		
<b>Design:</b>	Plan #1		

## Planned Survey

Measured Depth (ft)	Inclination (°)	Azimuth (°)	Vertical Depth (ft)	+N/-S (ft)	+E/-W (ft)	Vertical Section (ft)	Dogleg Rate (°/100ft)	Build Rate (°/100ft)	Comments / Formations
0.0	0.00	0.00	0.0	0.0	0.0	0.0	0.00	0.00	
100.0	0.00	0.00	100.0	0.0	0.0	0.0	0.00	0.00	
200.0	0.00	0.00	200.0	0.0	0.0	0.0	0.00	0.00	
300.0	0.00	0.00	300.0	0.0	0.0	0.0	0.00	0.00	KOP @ 300'
324.0	0.24	143.10	324.0	0.0	0.0	0.0	1.00	1.00	Fox Hills - BASE
400.0	1.00	143.10	400.0	-0.7	0.5	-0.5	1.00	1.00	
500.0	2.00	143.10	500.0	-2.8	2.1	-2.1	1.00	1.00	
600.0	3.00	143.10	599.9	-6.3	4.7	-4.7	1.00	1.00	
700.0	4.00	143.10	699.7	-11.2	8.4	-8.4	1.00	1.00	
800.0	5.00	143.10	799.4	-17.4	13.1	-13.1	1.00	1.00	
900.0	6.00	143.10	898.9	-25.1	18.8	-18.8	1.00	1.00	
1,000.0	7.00	143.10	998.3	-34.2	25.6	-25.6	1.00	1.00	
1,100.0	8.00	143.10	1,097.4	-44.6	33.5	-33.5	1.00	1.00	
1,200.0	9.00	143.10	1,196.3	-56.4	42.4	-42.4	1.00	1.00	
1,300.0	10.00	143.10	1,294.9	-69.6	52.3	-52.3	1.00	1.00	
1,400.0	11.00	143.10	1,393.3	-84.2	63.2	-63.2	1.00	1.00	
1,500.0	12.00	143.10	1,491.2	-100.1	75.2	-75.2	1.00	1.00	
1,600.0	13.00	143.10	1,588.9	-117.4	88.2	-88.2	1.00	1.00	
1,700.0	14.00	143.10	1,686.1	-136.1	102.2	-102.2	1.00	1.00	
1,800.0	15.00	143.10	1,782.9	-156.1	117.2	-117.2	1.00	1.00	EOB; Inc=15°
1,900.0	15.00	143.10	1,879.5	-176.8	132.8	-132.8	0.00	0.00	
2,000.0	15.00	143.10	1,976.1	-197.5	148.3	-148.3	0.00	0.00	
2,100.0	15.00	143.10	2,072.7	-218.2	163.8	-163.8	0.00	0.00	
2,200.0	15.00	143.10	2,169.3	-238.9	179.4	-179.4	0.00	0.00	
2,300.0	15.00	143.10	2,265.9	-259.6	194.9	-194.9	0.00	0.00	
2,400.0	15.00	143.10	2,362.5	-280.3	210.5	-210.5	0.00	0.00	
2,500.0	15.00	143.10	2,459.1	-301.0	226.0	-226.0	0.00	0.00	
2,600.0	15.00	143.10	2,555.7	-321.7	241.5	-241.5	0.00	0.00	
2,700.0	15.00	143.10	2,652.3	-342.4	257.1	-257.1	0.00	0.00	
2,800.0	15.00	143.10	2,748.8	-363.1	272.6	-272.6	0.00	0.00	
2,900.0	15.00	143.10	2,845.4	-383.8	288.2	-288.2	0.00	0.00	
3,000.0	15.00	143.10	2,942.0	-404.5	303.7	-303.7	0.00	0.00	
3,100.0	15.00	143.10	3,038.6	-425.2	319.2	-319.2	0.00	0.00	
3,200.0	15.00	143.10	3,135.2	-445.9	334.8	-334.8	0.00	0.00	
3,300.0	15.00	143.10	3,231.8	-466.6	350.3	-350.3	0.00	0.00	
3,400.0	15.00	143.10	3,328.4	-487.3	365.9	-365.9	0.00	0.00	
3,500.0	15.00	143.10	3,425.0	-508.0	381.4	-381.4	0.00	0.00	
3,600.0	15.00	143.10	3,521.6	-528.7	396.9	-396.9	0.00	0.00	
3,627.3	15.00	143.10	3,548.0	-534.3	401.2	-401.2	0.00	0.00	Sussex
3,700.0	15.00	143.10	3,618.2	-549.4	412.5	-412.5	0.00	0.00	
3,705.0	15.00	143.10	3,623.0	-550.4	413.3	-413.3	0.00	0.00	Start Drop -1.00
3,800.0	14.05	143.10	3,715.0	-569.5	427.6	-427.6	1.00	-1.00	
3,900.0	13.05	143.10	3,812.2	-588.2	441.6	-441.6	1.00	-1.00	
3,944.9	12.60	143.10	3,856.0	-596.2	447.6	-447.6	1.00	-1.00	Sussex Marker
4,000.0	12.05	143.10	3,909.8	-605.6	454.7	-454.7	1.00	-1.00	
4,100.0	11.05	143.10	4,007.8	-621.6	466.7	-466.7	1.00	-1.00	
4,200.0	10.05	143.10	4,106.1	-636.2	477.7	-477.7	1.00	-1.00	
4,211.1	9.94	143.10	4,117.0	-637.8	478.8	-478.8	1.00	-1.00	Shannon
4,300.0	9.05	143.10	4,204.7	-649.5	487.7	-487.7	1.00	-1.00	
4,400.0	8.05	143.10	4,303.6	-661.4	496.6	-496.6	1.00	-1.00	
4,500.0	7.05	143.10	4,402.7	-671.9	504.5	-504.5	1.00	-1.00	
4,600.0	6.05	143.10	4,502.1	-681.0	511.3	-511.3	1.00	-1.00	

# Planning Report

<b>Database:</b>	USA EDM 5000 Multi Users DB	<b>Local Co-ordinate Reference:</b>	Well Drieth 4F-6H-I368
<b>Company:</b>	EnCana Oil & Gas (USA) Inc	<b>TVD Reference:</b>	WELL @ 5124.0ft (Original Well Elev)
<b>Project:</b>	DJ Wattenberg	<b>MD Reference:</b>	WELL @ 5124.0ft (Original Well Elev)
<b>Site:</b>	S6-T3N-R68W (Zisch/Drieth)	<b>North Reference:</b>	True
<b>Well:</b>	Drieth 4F-6H-I368	<b>Survey Calculation Method:</b>	Minimum Curvature
<b>Wellbore:</b>	Hz		
<b>Design:</b>	Plan #1		

Planned Survey									
Measured Depth (ft)	Inclination (°)	Azimuth (°)	Vertical Depth (ft)	+N/-S (ft)	+E/-W (ft)	Vertical Section (ft)	Dogleg Rate (°/100ft)	Build Rate (°/100ft)	Comments / Formations
4,700.0	5.05	143.10	4,601.6	-688.7	517.1	-517.1	1.00	-1.00	
4,800.0	4.05	143.10	4,701.3	-695.1	521.9	-521.9	1.00	-1.00	
4,900.0	3.05	143.10	4,801.1	-700.0	525.6	-525.6	1.00	-1.00	
5,000.0	2.05	143.10	4,901.0	-703.6	528.3	-528.3	1.00	-1.00	
5,100.0	1.05	143.10	5,000.9	-705.8	529.9	-529.9	1.00	-1.00	
5,200.0	0.05	143.10	5,100.9	-706.5	530.5	-530.5	1.00	-1.00	
5,205.0	0.00	0.00	5,105.9	-706.5	530.5	-530.5	1.00	-1.00	EOD; Inc=0°
5,300.0	0.00	0.00	5,200.9	-706.5	530.5	-530.5	0.00	0.00	
5,400.0	0.00	0.00	5,300.9	-706.5	530.5	-530.5	0.00	0.00	
5,500.0	0.00	0.00	5,400.9	-706.5	530.5	-530.5	0.00	0.00	
5,600.0	0.00	0.00	5,500.9	-706.5	530.5	-530.5	0.00	0.00	
5,700.0	0.00	0.00	5,600.9	-706.5	530.5	-530.5	0.00	0.00	
5,800.0	0.00	0.00	5,700.9	-706.5	530.5	-530.5	0.00	0.00	
5,900.0	0.00	0.00	5,800.9	-706.5	530.5	-530.5	0.00	0.00	
6,000.0	0.00	0.00	5,900.9	-706.5	530.5	-530.5	0.00	0.00	
6,100.0	0.00	0.00	6,000.9	-706.5	530.5	-530.5	0.00	0.00	
6,123.1	0.00	0.00	6,024.0	-706.5	530.5	-530.5	0.00	0.00	Teepee Buttes (*if present)
6,200.0	0.00	0.00	6,100.9	-706.5	530.5	-530.5	0.00	0.00	
6,300.0	0.00	0.00	6,200.9	-706.5	530.5	-530.5	0.00	0.00	
6,400.0	0.00	0.00	6,300.9	-706.5	530.5	-530.5	0.00	0.00	
6,443.9	0.00	0.00	6,344.8	-706.5	530.5	-530.5	0.00	0.00	Start Build 8.00
6,500.0	4.49	270.00	6,400.9	-706.5	528.3	-528.3	8.00	8.00	
6,600.0	12.49	270.00	6,499.7	-706.5	513.5	-513.5	8.00	8.00	
6,700.0	20.49	270.00	6,595.5	-706.5	485.2	-485.2	8.00	8.00	
6,800.0	28.49	270.00	6,686.4	-706.5	443.7	-443.7	8.00	8.00	
6,900.0	36.49	270.00	6,770.7	-706.5	390.1	-390.1	8.00	8.00	
6,987.9	43.52	270.00	6,838.0	-706.5	333.6	-333.6	8.00	8.00	Sharon Springs
7,000.0	44.49	270.00	6,846.7	-706.5	325.2	-325.2	8.00	8.00	
7,098.5	52.37	270.00	6,912.0	-706.5	251.6	-251.6	8.00	8.00	Niobrara
7,100.0	52.49	270.00	6,912.9	-706.5	250.4	-250.4	8.00	8.00	
7,200.0	60.49	270.00	6,968.1	-706.5	167.1	-167.1	8.00	8.00	
7,300.0	68.49	270.00	7,011.1	-706.5	76.9	-76.9	8.00	8.00	
7,400.0	76.49	270.00	7,041.2	-706.5	-18.4	18.4	8.00	8.00	
7,449.0	80.41	270.00	7,051.0	-706.5	-66.5	66.5	8.00	8.00	B Chalk
7,500.0	84.49	270.00	7,057.7	-706.5	-117.0	117.0	8.00	8.00	
7,568.9	90.00	270.00	7,061.0	-706.5	-185.7	185.7	8.00	8.00	LP @ 7061' TVD; 90°
7,600.0	90.00	270.00	7,061.0	-706.5	-216.9	216.9	0.00	0.00	
7,700.0	90.00	270.00	7,061.0	-706.5	-316.9	316.9	0.00	0.00	
7,800.0	90.00	270.00	7,061.0	-706.5	-416.9	416.9	0.00	0.00	
7,900.0	90.00	270.00	7,061.0	-706.5	-516.9	516.9	0.00	0.00	
8,000.0	90.00	270.00	7,061.0	-706.5	-616.9	616.9	0.00	0.00	
8,100.0	90.00	270.00	7,061.0	-706.5	-716.9	716.9	0.00	0.00	
8,200.0	90.00	270.00	7,061.0	-706.5	-816.9	816.9	0.00	0.00	
8,300.0	90.00	270.00	7,061.0	-706.5	-916.9	916.9	0.00	0.00	
8,400.0	90.00	270.00	7,061.0	-706.5	-1,016.9	1,016.9	0.00	0.00	
8,500.0	90.00	270.00	7,061.0	-706.5	-1,116.9	1,116.9	0.00	0.00	
8,600.0	90.00	270.00	7,061.0	-706.5	-1,216.9	1,216.9	0.00	0.00	
8,700.0	90.00	270.00	7,061.0	-706.5	-1,316.9	1,316.9	0.00	0.00	
8,800.0	90.00	270.00	7,061.0	-706.5	-1,416.9	1,416.9	0.00	0.00	
8,900.0	90.00	270.00	7,061.0	-706.5	-1,516.9	1,516.9	0.00	0.00	
9,000.0	90.00	270.00	7,061.0	-706.5	-1,616.9	1,616.9	0.00	0.00	
9,100.0	90.00	270.00	7,061.0	-706.4	-1,716.9	1,716.9	0.00	0.00	

# Planning Report

<b>Database:</b>	USA EDM 5000 Multi Users DB	<b>Local Co-ordinate Reference:</b>	Well Drieth 4F-6H-I368
<b>Company:</b>	EnCana Oil & Gas (USA) Inc	<b>TVD Reference:</b>	WELL @ 5124.0ft (Original Well Elev)
<b>Project:</b>	DJ Wattenberg	<b>MD Reference:</b>	WELL @ 5124.0ft (Original Well Elev)
<b>Site:</b>	S6-T3N-R68W (Zisch/Drieth)	<b>North Reference:</b>	True
<b>Well:</b>	Drieth 4F-6H-I368	<b>Survey Calculation Method:</b>	Minimum Curvature
<b>Wellbore:</b>	Hz		
<b>Design:</b>	Plan #1		

Planned Survey									
Measured Depth (ft)	Inclination (°)	Azimuth (°)	Vertical Depth (ft)	+N/-S (ft)	+E/-W (ft)	Vertical Section (ft)	Dogleg Rate (°/100ft)	Build Rate (°/100ft)	Comments / Formations
9,200.0	90.00	270.00	7,061.0	-706.4	-1,816.9	1,816.9	0.00	0.00	
9,300.0	90.00	270.00	7,061.0	-706.4	-1,916.9	1,916.9	0.00	0.00	
9,400.0	90.00	270.00	7,061.0	-706.4	-2,016.9	2,016.9	0.00	0.00	
9,500.0	90.00	270.00	7,061.0	-706.4	-2,116.9	2,116.9	0.00	0.00	
9,600.0	90.00	270.00	7,061.0	-706.4	-2,216.9	2,216.9	0.00	0.00	
9,700.0	90.00	270.00	7,061.0	-706.4	-2,316.9	2,316.9	0.00	0.00	
9,800.0	90.00	270.00	7,061.0	-706.4	-2,416.9	2,416.9	0.00	0.00	
9,900.0	90.00	270.00	7,061.0	-706.4	-2,516.9	2,516.9	0.00	0.00	
10,000.0	90.00	270.00	7,061.0	-706.4	-2,616.9	2,616.9	0.00	0.00	
10,100.0	90.00	270.00	7,061.0	-706.4	-2,716.9	2,716.9	0.00	0.00	
10,200.0	90.00	270.00	7,061.0	-706.4	-2,816.9	2,816.9	0.00	0.00	
10,300.0	90.00	270.00	7,061.0	-706.4	-2,916.9	2,916.9	0.00	0.00	
10,400.0	90.00	270.00	7,061.0	-706.4	-3,016.9	3,016.9	0.00	0.00	
10,500.0	90.00	270.00	7,061.0	-706.4	-3,116.9	3,116.9	0.00	0.00	
10,600.0	90.00	270.00	7,061.0	-706.4	-3,216.9	3,216.9	0.00	0.00	
10,700.0	90.00	270.00	7,061.0	-706.4	-3,316.9	3,316.9	0.00	0.00	
10,800.0	90.00	270.00	7,061.0	-706.4	-3,416.9	3,416.9	0.00	0.00	
10,900.0	90.00	270.00	7,061.0	-706.4	-3,516.9	3,516.9	0.00	0.00	
11,000.0	90.00	270.00	7,061.0	-706.4	-3,616.9	3,616.9	0.00	0.00	
11,100.0	90.00	270.00	7,061.0	-706.4	-3,716.9	3,716.9	0.00	0.00	
11,200.0	90.00	270.00	7,061.0	-706.4	-3,816.9	3,816.9	0.00	0.00	
11,300.0	90.00	270.00	7,061.0	-706.4	-3,916.9	3,916.9	0.00	0.00	
11,400.0	90.00	270.00	7,061.0	-706.4	-4,016.9	4,016.9	0.00	0.00	
11,500.0	90.00	270.00	7,061.0	-706.4	-4,116.9	4,116.9	0.00	0.00	
11,539.2	90.00	270.00	7,061.0	-706.4	-4,156.1	4,156.1	0.00	0.00	TD at 11539.2 - Drieth 4F-6H-I368 PBHL

Targets									
Target Name	Dip Angle (°)	Dip Dir. (°)	TVD (ft)	+N/-S (ft)	+E/-W (ft)	Northing (ft)	Easting (ft)	Latitude	Longitude
- hit/miss target									
- Shape									
Drieth 4F-6H-I368 PBHL	0.00	0.00	7,061.0	-706.4	-4,156.1	1,335,012.78	3,124,648.56	40.252140	-105.053440
- plan hits target center									
- Point									

Formations						
Measured Depth (ft)	Vertical Depth (ft)	Name	Lithology	Dip (°)	Dip Direction (°)	
324.0	324.0	Fox Hills - BASE				
3,627.3	3,548.0	Sussex				
3,944.9	3,856.0	Sussex Marker				
4,211.1	4,117.0	Shannon				
6,123.1	6,024.0	Teepee Buttes (*if present)				
6,987.9	6,838.0	Sharon Springs				
7,098.5	6,912.0	Niobrara				
7,449.0	7,051.0	B Chalk				

## Planning Report

<b>Database:</b>	USA EDM 5000 Multi Users DB	<b>Local Co-ordinate Reference:</b>	Well Drieth 4F-6H-I368
<b>Company:</b>	EnCana Oil & Gas (USA) Inc	<b>TVD Reference:</b>	WELL @ 5124.0ft (Original Well Elev)
<b>Project:</b>	DJ Wattenberg	<b>MD Reference:</b>	WELL @ 5124.0ft (Original Well Elev)
<b>Site:</b>	S6-T3N-R68W (Zisch/Drieth)	<b>North Reference:</b>	True
<b>Well:</b>	Drieth 4F-6H-I368	<b>Survey Calculation Method:</b>	Minimum Curvature
<b>Wellbore:</b>	Hz		
<b>Design:</b>	Plan #1		

### Plan Annotations

Measured Depth (ft)	Vertical Depth (ft)	Local Coordinates		Comment
		+N/-S (ft)	+E/-W (ft)	
300.0	300.0	0.0	0.0	KOP @ 300'
1,800.0	1,782.9	-156.1	117.2	EOB; Inc=15°
3,705.0	3,623.0	-550.4	413.3	Start Drop -1.00
5,205.0	5,105.9	-706.5	530.5	EOD; Inc=0°
6,443.9	6,344.8	-706.5	530.5	Start Build 8.00
7,568.9	7,061.0	-706.5	-185.7	LP @ 7061' TVD; 90°
11,539.2	7,061.0	-706.4	-4,156.1	TD at 11539.2

# **EnCana Oil & Gas (USA) Inc**

**DJ Wattenberg**

**S6-T3N-R68W (Zisch/Drieth)**

**Drieth 4F-6H-I368**

**Hz**

**Plan #1**

## **Anticollision Report**

**15 April, 2013**

## Anticollision Report

<b>Company:</b>	EnCana Oil & Gas (USA) Inc	<b>Local Co-ordinate Reference:</b>	Well Drieth 4F-6H-I368
<b>Project:</b>	DJ Wattenberg	<b>TVD Reference:</b>	WELL @ 5124.0ft (Original Well Elev)
<b>Reference Site:</b>	S6-T3N-R68W (Zisch/Drieth)	<b>MD Reference:</b>	WELL @ 5124.0ft (Original Well Elev)
<b>Site Error:</b>	0.0ft	<b>North Reference:</b>	True
<b>Reference Well:</b>	Drieth 4F-6H-I368	<b>Survey Calculation Method:</b>	Minimum Curvature
<b>Well Error:</b>	0.0ft	<b>Output errors are at</b>	2.00 sigma
<b>Reference Wellbore</b>	Hz	<b>Database:</b>	USA EDM 5000 Multi Users DB
<b>Reference Design:</b>	Plan #1	<b>Offset TVD Reference:</b>	Offset Datum

<b>Reference</b>	Plan #1		
<b>Filter type:</b>	NO GLOBAL FILTER: Using user defined selection & filtering criteria		
<b>Interpolation Method:</b>	MD Interval 100.0ft	<b>Error Model:</b>	Systematic Ellipse
<b>Depth Range:</b>	Unlimited	<b>Scan Method:</b>	Closest Approach 3D
<b>Results Limited by:</b>	Maximum center-center distance of 500.0ft	<b>Error Surface:</b>	Elliptical Conic
<b>Warning Levels Evaluated at:</b>	2.00 Sigma		

<b>Survey Tool Program</b>	<b>Date</b>	4/15/2013		
<b>From (ft)</b>	<b>To (ft)</b>	<b>Survey (Wellbore)</b>	<b>Tool Name</b>	<b>Description</b>
0.0	11,539.2	Plan #1 (Hz)	MWD	Geolink MWD

Summary						
Site Name	Reference Measured Depth (ft)	Offset Measured Depth (ft)	Distance Between Centres (ft)	Distance Between Ellipses (ft)	Separation Factor	Warning
<b>Offset Well - Wellbore - Design</b>						
S6-T3N-R68W (Zisch/Drieth)						
Breakneck Properties 21-6 - DD - Plan #1						Out of range
Drieth 1A-6H-A368 - Hz - Plan #1						Out of range
Drieth 1B-6H-A368 - Hz - Plan #1						Out of range
Drieth 1C-6H-A368 - Hz - Plan #1						Out of range
Drieth 1D-6H-A368 - Hz - Plan #1						Out of range
Drieth 1E-6H-A368 - Hz - Plan #1						Out of range
Drieth 4A-6H-I368 - Hz - Plan #1	200.0	199.0	51.1	50.4	78.458	CC, ES
Drieth 4A-6H-I368 - Hz - Plan #1	700.0	693.2	81.1	78.7	33.568	SF
Drieth 4B-6H-I368 - Hz - Plan #1	300.0	299.0	40.2	39.2	40.166	CC, ES
Drieth 4B-6H-I368 - Hz - Plan #1	600.0	597.0	52.4	50.4	25.517	SF
Drieth 4C-6H-I368 - Hz - Plan #1	300.0	299.0	29.3	28.3	29.274	CC, ES
Drieth 4C-6H-I368 - Hz - Plan #1	600.0	598.4	37.4	35.3	18.217	SF
Drieth 4D-6H-I368 - Hz - Plan #1	300.0	299.0	18.2	17.2	18.213	CC, ES
Drieth 4D-6H-I368 - Hz - Plan #1	600.0	598.9	24.9	22.9	12.174	SF
Drieth 4E-6H-I368 - Hz - Plan #1	300.0	299.0	10.9	9.9	10.928	CC, ES
Drieth 4E-6H-I368 - Hz - Plan #1	11,539.2	11,715.7	413.2	227.8	2.229	SF
Drieth 4G-6H-I368 - Hz - Plan #1	200.0	200.0	10.9	10.3	16.742	CC, ES
Drieth 4G-6H-I368 - Hz - Plan #1	11,539.2	11,803.4	413.2	227.7	2.228	SF
SUMMER 6-1 (EXISTING) - NO SURVEYS						Out of range
Zisch 23-6-M368 - DD - Plan #1	10,007.2	7,484.7	167.3	68.2	1.689	CC, ES, SF
Zisch 3A-6H-M368 - HZ - Plan #1						Out of range
Zisch 3B-6H-M368 - HZ - Plan #1						Out of range
Zisch 3C-6H-M368 - HZ - Plan #1						Out of range
Zisch 3D-6H-M368 - HZ - Plan #1						Out of range



# Anticollision Report

<b>Company:</b>	EnCana Oil & Gas (USA) Inc	<b>Local Co-ordinate Reference:</b>	Well Drieth 4F-6H-I368
<b>Project:</b>	DJ Wattenberg	<b>TVD Reference:</b>	WELL @ 5124.0ft (Original Well Elev)
<b>Reference Site:</b>	S6-T3N-R68W (Zisch/Drieth)	<b>MD Reference:</b>	WELL @ 5124.0ft (Original Well Elev)
<b>Site Error:</b>	0.0ft	<b>North Reference:</b>	True
<b>Reference Well:</b>	Drieth 4F-6H-I368	<b>Survey Calculation Method:</b>	Minimum Curvature
<b>Well Error:</b>	0.0ft	<b>Output errors are at</b>	2.00 sigma
<b>Reference Wellbore</b>	Hz	<b>Database:</b>	USA EDM 5000 Multi Users DB
<b>Reference Design:</b>	Plan #1	<b>Offset TVD Reference:</b>	Offset Datum

Offset Design S6-T3N-R68W (Zisch/Drieth) - Drieth 4A-6H-I368 - Hz - Plan #1													Offset Site Error:	0.0 ft
Survey Program: 0-MWD													Offset Well Error:	0.0 ft
Reference		Offset		Semi Major Axis		Highside Toolface (°)	Distance		Total Uncertainty Axis	Separation Factor	Warning			
Measured Depth (ft)	Vertical Depth (ft)	Measured Depth (ft)	Vertical Depth (ft)	Reference (ft)	Offset (ft)		Offset Wellbore Centre +N/-S (ft)	+E/-W (ft)						
0.0	0.0	0.0	0.0	0.0	0.0	-3.13	51.0	-2.8	51.1					
100.0	100.0	99.0	99.0	0.2	0.2	-3.13	51.0	-2.8	51.1	50.8	0.30	169.033		
200.0	200.0	199.0	199.0	0.3	0.3	-3.13	51.0	-2.8	51.1	50.4	0.65	78.458 CC, ES		
300.0	300.0	298.2	298.2	0.5	0.5	-2.65	51.7	-2.4	51.8	50.8	1.00	51.867		
400.0	400.0	397.4	397.4	0.7	0.7	-144.87	54.0	-1.2	54.7	53.4	1.35	40.614		
500.0	500.0	496.4	496.2	0.9	0.9	-144.23	57.8	0.8	60.6	58.9	1.70	35.673		
600.0	599.9	595.0	594.7	1.0	1.1	-143.84	63.0	3.6	69.4	67.4	2.05	33.781		
700.0	699.7	693.2	692.6	1.2	1.3	-143.67	69.7	7.2	81.1	78.7	2.42	33.568 SF		
800.0	799.4	790.8	789.8	1.4	1.5	-143.63	77.8	11.6	95.7	92.9	2.78	34.353		
900.0	898.9	887.7	886.1	1.7	1.7	-143.67	87.3	16.7	113.1	109.9	3.16	35.758		
1,000.0	998.3	983.9	981.4	1.9	2.0	-143.76	98.2	22.5	133.3	129.8	3.55	37.551		
1,100.0	1,097.4	1,079.1	1,075.6	2.2	2.3	-143.85	110.3	29.0	156.4	152.4	3.95	39.587		
1,200.0	1,196.3	1,173.3	1,168.6	2.5	2.6	-143.94	123.7	36.2	182.2	177.8	4.36	41.765		
1,300.0	1,294.9	1,266.3	1,260.2	2.8	2.9	-144.02	138.2	44.0	210.7	205.9	4.79	44.018		
1,400.0	1,393.3	1,358.2	1,350.3	3.1	3.2	-144.07	153.8	52.3	241.9	236.7	5.23	46.297		
1,500.0	1,491.2	1,448.8	1,438.9	3.5	3.6	-144.11	170.5	61.3	275.8	270.1	5.68	48.569		
1,600.0	1,588.9	1,537.9	1,525.8	3.9	4.0	-144.13	188.0	70.7	312.2	306.1	6.14	50.812		
1,700.0	1,686.1	1,625.6	1,611.0	4.3	4.3	-144.12	206.5	80.6	351.2	344.6	6.63	53.008		
1,800.0	1,782.9	1,712.5	1,695.0	4.8	4.7	-144.09	225.9	91.0	392.7	385.6	7.12	55.140		
1,900.0	1,879.5	1,803.0	1,782.4	5.3	5.2	-144.33	246.6	102.1	435.2	427.6	7.65	56.919		
2,000.0	1,976.1	1,893.5	1,869.8	5.7	5.6	-144.53	267.2	113.1	477.8	469.6	8.18	58.436		

# Anticollision Report

<b>Company:</b>	EnCana Oil & Gas (USA) Inc	<b>Local Co-ordinate Reference:</b>	Well Drieth 4F-6H-I368
<b>Project:</b>	DJ Wattenberg	<b>TVD Reference:</b>	WELL @ 5124.0ft (Original Well Elev)
<b>Reference Site:</b>	S6-T3N-R68W (Zisch/Drieth)	<b>MD Reference:</b>	WELL @ 5124.0ft (Original Well Elev)
<b>Site Error:</b>	0.0ft	<b>North Reference:</b>	True
<b>Reference Well:</b>	Drieth 4F-6H-I368	<b>Survey Calculation Method:</b>	Minimum Curvature
<b>Well Error:</b>	0.0ft	<b>Output errors are at</b>	2.00 sigma
<b>Reference Wellbore</b>	Hz	<b>Database:</b>	USA EDM 5000 Multi Users DB
<b>Reference Design:</b>	Plan #1	<b>Offset TVD Reference:</b>	Offset Datum

Offset Design S6-T3N-R68W (Zisch/Drieth) - Drieth 4B-6H-I368 - Hz - Plan #1													Offset Site Error:	0.0 ft
Survey Program: 0-MWD													Offset Well Error:	0.0 ft
Reference		Offset		Semi Major Axis			Distance				Total		Warning	
Measured Depth (ft)	Vertical Depth (ft)	Measured Depth (ft)	Vertical Depth (ft)	Reference (ft)	Offset (ft)	Highside Toolface (°)	Offset Wellbore Centre +N/-S (ft)	+E/-W (ft)	Between Centres (ft)	Between Ellipses (ft)	Uncertainty Axis	Separation Factor		
0.0	0.0	0.0	0.0	0.0	0.0	-3.98	40.1	-2.8	40.2					
100.0	100.0	99.0	99.0	0.2	0.2	-3.98	40.1	-2.8	40.2	39.9	0.30	132.934		
200.0	200.0	199.0	199.0	0.3	0.3	-3.98	40.1	-2.8	40.2	39.5	0.65	61.702		
300.0	300.0	299.0	299.0	0.5	0.5	-3.98	40.1	-2.8	40.2	39.2	1.00	40.166 CC, ES		
400.0	400.0	398.5	398.5	0.7	0.7	-146.93	40.7	-2.3	41.5	40.2	1.35	30.788		
500.0	500.0	497.8	497.8	0.9	0.9	-146.49	42.7	-0.6	45.6	43.9	1.70	26.839		
600.0	599.9	597.0	596.8	1.0	1.0	-145.90	46.0	2.1	52.4	50.4	2.05	25.517 SF		
700.0	699.7	695.8	695.5	1.2	1.2	-145.28	50.7	5.8	62.0	59.6	2.42	25.642		
800.0	799.4	794.1	793.5	1.4	1.4	-144.71	56.6	10.6	74.2	71.4	2.79	26.623		
900.0	898.9	892.0	890.9	1.7	1.7	-144.20	63.8	16.5	89.2	86.0	3.17	28.125		
1,000.0	998.3	989.1	987.5	1.9	1.9	-143.77	72.2	23.3	106.8	103.3	3.57	29.945		
1,100.0	1,097.4	1,085.5	1,083.1	2.2	2.2	-143.40	81.8	31.1	127.1	123.1	3.98	31.950		
1,200.0	1,196.3	1,181.1	1,177.6	2.5	2.4	-143.08	92.5	39.9	150.0	145.6	4.41	34.049		
1,300.0	1,294.9	1,275.7	1,271.0	2.8	2.7	-142.80	104.4	49.5	175.5	170.7	4.85	36.182		
1,400.0	1,393.3	1,369.3	1,363.1	3.1	3.0	-142.54	117.3	60.0	203.6	198.3	5.31	38.305		
1,500.0	1,491.2	1,461.8	1,453.9	3.5	3.4	-142.31	131.2	71.2	234.2	228.4	5.80	40.391		
1,600.0	1,588.9	1,555.0	1,545.0	3.9	3.7	-142.12	146.1	83.4	267.0	260.7	6.30	42.390		
1,700.0	1,686.1	1,648.9	1,636.9	4.3	4.1	-142.12	161.3	95.7	301.3	294.5	6.82	44.195		
1,800.0	1,782.9	1,742.4	1,728.3	4.8	4.4	-142.26	176.3	108.0	336.9	329.5	7.35	45.846		
1,900.0	1,879.5	1,835.6	1,819.5	5.3	4.8	-142.64	191.4	120.2	373.1	365.2	7.90	47.257		
2,000.0	1,976.1	1,928.7	1,910.6	5.7	5.2	-142.96	206.4	132.4	409.4	400.9	8.45	48.463		
2,100.0	2,072.7	2,021.9	2,001.8	6.2	5.5	-143.23	221.4	144.6	445.6	436.6	9.00	49.503		
2,200.0	2,169.3	2,115.1	2,092.9	6.7	5.9	-143.46	236.5	156.8	481.9	472.3	9.56	50.408		

# Anticollision Report

<b>Company:</b>	EnCana Oil & Gas (USA) Inc	<b>Local Co-ordinate Reference:</b>	Well Drieth 4F-6H-I368
<b>Project:</b>	DJ Wattenberg	<b>TVD Reference:</b>	WELL @ 5124.0ft (Original Well Elev)
<b>Reference Site:</b>	S6-T3N-R68W (Zisch/Drieth)	<b>MD Reference:</b>	WELL @ 5124.0ft (Original Well Elev)
<b>Site Error:</b>	0.0ft	<b>North Reference:</b>	True
<b>Reference Well:</b>	Drieth 4F-6H-I368	<b>Survey Calculation Method:</b>	Minimum Curvature
<b>Well Error:</b>	0.0ft	<b>Output errors are at</b>	2.00 sigma
<b>Reference Wellbore</b>	Hz	<b>Database:</b>	USA EDM 5000 Multi Users DB
<b>Reference Design:</b>	Plan #1	<b>Offset TVD Reference:</b>	Offset Datum

Offset Design S6-T3N-R68W (Zisch/Drieth) - Drieth 4C-6H-I368 - Hz - Plan #1													Offset Site Error:	0.0 ft
Survey Program: 0-MWD													Offset Well Error:	0.0 ft
Reference		Offset		Semi Major Axis		Highside Toolface (°)	Distance		Total Uncertainty Axis	Separation Factor	Warning			
Measured Depth (ft)	Vertical Depth (ft)	Measured Depth (ft)	Vertical Depth (ft)	Reference (ft)	Offset (ft)		Offset Wellbore Centre +N/-S (ft)	+E/-W (ft)						
0.0	0.0	0.0	0.0	0.0	0.0	-5.47	29.1	-2.8	29.3					
100.0	100.0	99.0	99.0	0.2	0.2	-5.47	29.1	-2.8	29.3	29.0	0.30	96.887		
200.0	200.0	199.0	199.0	0.3	0.3	-5.47	29.1	-2.8	29.3	28.6	0.65	44.971		
300.0	300.0	299.0	299.0	0.5	0.5	-5.47	29.1	-2.8	29.3	28.3	1.00	29.274 CC, ES		
400.0	400.0	399.0	399.0	0.7	0.7	-149.44	29.1	-2.8	30.0	28.7	1.35	22.253		
500.0	500.0	498.8	498.7	0.9	0.8	-150.38	29.6	-2.1	32.6	30.9	1.70	19.199		
600.0	599.9	598.4	598.4	1.0	1.0	-149.98	30.8	0.2	37.4	35.3	2.05	18.217 SF		
700.0	699.7	697.9	697.7	1.2	1.2	-148.73	33.0	3.9	44.3	41.9	2.41	18.373		
800.0	799.4	797.1	796.8	1.4	1.4	-147.11	35.9	9.2	53.5	50.7	2.79	19.203		
900.0	898.9	896.0	895.4	1.7	1.6	-145.44	39.7	15.9	64.9	61.7	3.18	20.442		
1,000.0	998.3	994.4	993.4	1.9	1.8	-143.87	44.3	24.0	78.6	75.0	3.58	21.922		
1,100.0	1,097.4	1,092.4	1,090.8	2.2	2.1	-142.48	49.7	33.6	94.5	90.5	4.02	23.529		
1,200.0	1,196.3	1,189.9	1,187.4	2.5	2.3	-141.25	55.9	44.5	112.6	108.1	4.47	25.186		
1,300.0	1,294.9	1,286.7	1,283.1	2.8	2.6	-140.18	62.9	56.8	133.0	128.0	4.95	26.839		
1,400.0	1,393.3	1,382.8	1,378.0	3.1	2.9	-139.25	70.5	70.4	155.6	150.1	5.47	28.453		
1,500.0	1,491.2	1,479.5	1,473.2	3.5	3.2	-138.58	78.8	85.0	180.0	174.0	6.00	29.995		
1,600.0	1,588.9	1,576.1	1,568.4	3.9	3.5	-138.34	87.1	99.6	205.7	199.2	6.55	31.403		
1,700.0	1,686.1	1,672.4	1,663.2	4.3	3.8	-138.41	95.3	114.1	232.7	225.6	7.12	32.705		
1,800.0	1,782.9	1,768.3	1,757.6	4.8	4.2	-138.67	103.5	128.6	261.0	253.3	7.69	33.924		
1,900.0	1,879.5	1,864.0	1,851.9	5.3	4.5	-139.16	111.7	143.1	289.9	281.6	8.28	34.997		
2,000.0	1,976.1	1,959.7	1,946.1	5.7	4.8	-139.56	119.9	157.6	318.8	310.0	8.88	35.913		
2,100.0	2,072.7	2,055.4	2,040.4	6.2	5.1	-139.89	128.0	172.0	347.8	338.3	9.48	36.702		
2,200.0	2,169.3	2,151.1	2,134.6	6.7	5.5	-140.18	136.2	186.5	376.7	366.6	10.08	37.389		
2,300.0	2,265.9	2,246.8	2,228.9	7.2	5.8	-140.42	144.4	201.0	405.7	395.0	10.68	37.990		
2,400.0	2,362.5	2,342.5	2,323.1	7.6	6.1	-140.63	152.6	215.4	434.6	423.3	11.28	38.521		
2,500.0	2,459.1	2,438.2	2,417.4	8.1	6.4	-140.81	160.8	229.9	463.6	451.7	11.89	38.994		
2,600.0	2,555.7	2,533.9	2,511.6	8.6	6.8	-140.97	169.0	244.3	492.6	480.1	12.50	39.416		

# Anticollision Report

<b>Company:</b>	EnCana Oil & Gas (USA) Inc	<b>Local Co-ordinate Reference:</b>	Well Drieth 4F-6H-I368
<b>Project:</b>	DJ Wattenberg	<b>TVD Reference:</b>	WELL @ 5124.0ft (Original Well Elev)
<b>Reference Site:</b>	S6-T3N-R68W (Zisch/Drieth)	<b>MD Reference:</b>	WELL @ 5124.0ft (Original Well Elev)
<b>Site Error:</b>	0.0ft	<b>North Reference:</b>	True
<b>Reference Well:</b>	Drieth 4F-6H-I368	<b>Survey Calculation Method:</b>	Minimum Curvature
<b>Well Error:</b>	0.0ft	<b>Output errors are at</b>	2.00 sigma
<b>Reference Wellbore</b>	Hz	<b>Database:</b>	USA EDM 5000 Multi Users DB
<b>Reference Design:</b>	Plan #1	<b>Offset TVD Reference:</b>	Offset Datum

Offset Design S6-T3N-R68W (Zisch/Drieth) - Drieth 4D-6H-I368 - Hz - Plan #1													Offset Site Error: 0.0 ft	
Survey Program: 0-MWD													Offset Well Error: 0.0 ft	
Reference		Offset		Semi Major Axis			Distance				Total Uncertainty Axis	Separation Factor	Warning	
Measured Depth (ft)	Vertical Depth (ft)	Measured Depth (ft)	Vertical Depth (ft)	Reference (ft)	Offset (ft)	Highside Toolface (°)	Offset Wellbore Centre +N/-S (ft)	+E/-W (ft)	Between Centres (ft)	Between Ellipses (ft)				
0.0	0.0	0.0	0.0	0.0	0.0	0.00	18.2	0.0	18.2					
100.0	100.0	99.0	99.0	0.2	0.2	0.00	18.2	0.0	18.2	17.9	0.30	60.279		
200.0	200.0	199.0	199.0	0.3	0.3	0.00	18.2	0.0	18.2	17.6	0.65	27.979		
300.0	300.0	299.0	299.0	0.5	0.5	0.00	18.2	0.0	18.2	17.2	1.00	18.213	CC, ES	
400.0	400.0	399.0	399.0	0.7	0.7	-144.68	18.2	0.0	18.9	17.6	1.35	14.022		
500.0	500.0	499.0	499.0	0.9	0.8	-148.78	18.2	0.0	21.1	19.4	1.70	12.425		
600.0	599.9	598.9	598.9	1.0	1.0	-153.96	18.2	0.0	24.9	22.9	2.05	12.174	SF	
700.0	699.7	698.8	698.8	1.2	1.2	-157.45	18.2	0.9	30.3	27.9	2.40	12.623		
800.0	799.4	798.8	798.8	1.4	1.4	-158.24	18.1	3.4	36.8	34.0	2.75	13.361		
900.0	898.9	898.7	898.6	1.7	1.6	-157.46	17.9	7.8	44.4	41.3	3.12	14.246		
1,000.0	998.3	998.6	998.2	1.9	1.7	-155.83	17.6	13.8	53.1	49.6	3.49	15.209		
1,100.0	1,097.4	1,098.3	1,097.7	2.2	1.9	-153.78	17.3	21.6	63.0	59.1	3.89	16.203		
1,200.0	1,196.3	1,197.9	1,196.8	2.5	2.2	-151.59	16.9	31.1	74.2	69.9	4.31	17.193		
1,300.0	1,294.9	1,297.3	1,295.6	2.8	2.4	-149.39	16.4	42.3	86.6	81.9	4.77	18.150		
1,400.0	1,393.3	1,396.5	1,394.0	3.1	2.7	-147.28	15.9	55.2	100.4	95.1	5.27	19.050		
1,500.0	1,491.2	1,495.5	1,491.9	3.5	2.9	-145.28	15.3	69.8	115.6	109.7	5.81	19.881		
1,600.0	1,588.9	1,594.2	1,589.2	3.9	3.2	-143.43	14.6	86.0	132.1	125.7	6.40	20.634		
1,700.0	1,686.1	1,692.5	1,686.1	4.3	3.5	-142.00	13.9	103.0	150.0	143.0	7.01	21.386		
1,800.0	1,782.9	1,790.6	1,782.7	4.8	3.8	-141.22	13.2	120.0	169.3	161.7	7.64	22.161		
1,900.0	1,879.5	1,888.6	1,879.2	5.3	4.2	-140.87	12.5	137.0	189.3	181.1	8.28	22.870		
2,000.0	1,976.1	1,986.6	1,975.6	5.7	4.5	-140.58	11.8	154.0	209.4	200.4	8.93	23.457		
2,100.0	2,072.7	2,084.6	2,072.1	6.2	4.8	-140.35	11.0	171.0	229.4	219.8	9.58	23.948		
2,200.0	2,169.3	2,182.5	2,168.6	6.7	5.1	-140.15	10.3	188.0	249.4	239.2	10.24	24.365		
2,300.0	2,265.9	2,280.5	2,265.1	7.2	5.5	-139.98	9.6	205.0	269.4	258.5	10.90	24.721		
2,400.0	2,362.5	2,378.5	2,361.6	7.6	5.8	-139.84	8.9	222.0	289.4	277.9	11.56	25.029		
2,500.0	2,459.1	2,476.4	2,458.1	8.1	6.1	-139.71	8.2	239.0	309.5	297.2	12.23	25.298		
2,600.0	2,555.7	2,574.4	2,554.5	8.6	6.5	-139.60	7.5	256.0	329.5	316.6	12.90	25.533		
2,700.0	2,652.3	2,672.4	2,651.0	9.1	6.8	-139.50	6.8	273.0	349.5	336.0	13.58	25.742		
2,800.0	2,748.8	2,770.4	2,747.5	9.6	7.1	-139.41	6.1	290.0	369.6	355.3	14.25	25.927		
2,900.0	2,845.4	2,868.3	2,844.0	10.0	7.5	-139.34	5.3	307.0	389.6	374.7	14.93	26.093		
3,000.0	2,942.0	2,966.3	2,940.5	10.5	7.8	-139.26	4.6	324.0	409.6	394.0	15.61	26.242		
3,100.0	3,038.6	3,064.3	3,037.0	11.0	8.2	-139.20	3.9	341.0	429.7	413.4	16.29	26.377		
3,200.0	3,135.2	3,162.2	3,133.4	11.5	8.5	-139.14	3.2	358.0	449.7	432.7	16.97	26.499		
3,300.0	3,231.8	3,260.2	3,229.9	12.0	8.8	-139.09	2.5	375.0	469.7	452.1	17.65	26.611		
3,400.0	3,328.4	3,358.2	3,326.4	12.5	9.2	-139.04	1.8	392.0	489.8	471.4	18.33	26.713		

# Anticollision Report

<b>Company:</b>	EnCana Oil & Gas (USA) Inc	<b>Local Co-ordinate Reference:</b>	Well Drieth 4F-6H-I368
<b>Project:</b>	DJ Wattenberg	<b>TVD Reference:</b>	WELL @ 5124.0ft (Original Well Elev)
<b>Reference Site:</b>	S6-T3N-R68W (Zisch/Drieth)	<b>MD Reference:</b>	WELL @ 5124.0ft (Original Well Elev)
<b>Site Error:</b>	0.0ft	<b>North Reference:</b>	True
<b>Reference Well:</b>	Drieth 4F-6H-I368	<b>Survey Calculation Method:</b>	Minimum Curvature
<b>Well Error:</b>	0.0ft	<b>Output errors are at</b>	2.00 sigma
<b>Reference Wellbore</b>	Hz	<b>Database:</b>	USA EDM 5000 Multi Users DB
<b>Reference Design:</b>	Plan #1	<b>Offset TVD Reference:</b>	Offset Datum

Offset Design S6-T3N-R68W (Zisch/Drieth) - Drieth 4E-6H-I368 - Hz - Plan #1													Offset Site Error:	0.0 ft
Survey Program:		0-MWD											Offset Well Error:	0.0 ft
Reference		Offset		Semi Major Axis			Distance				Total Uncertainty Axis	Separation Factor	Warning	
Measured Depth (ft)	Vertical Depth (ft)	Measured Depth (ft)	Vertical Depth (ft)	Reference (ft)	Offset (ft)	Highside Toolface (°)	Offset Wellbore Centre +N/-S (ft)	+E/-W (ft)	Between Centres (ft)	Between Ellipses (ft)				
0.0	0.0	0.0	0.0	0.0	0.0	0.00	10.9	0.0	11.0					
100.0	100.0	99.0	99.0	0.2	0.2	0.00	10.9	0.0	10.9	10.6	0.30	36.167		
200.0	200.0	199.0	199.0	0.3	0.3	0.00	10.9	0.0	10.9	10.3	0.65	16.787		
300.0	300.0	299.0	299.0	0.5	0.5	0.00	10.9	0.0	10.9	9.9	1.00	10.928	CC, ES	
400.0	400.0	399.0	399.0	0.7	0.7	-145.68	10.9	0.0	11.6	10.3	1.35	8.626		
500.0	500.0	499.1	499.1	0.9	0.8	-149.10	10.4	0.7	13.3	11.6	1.70	7.828		
600.0	599.9	599.3	599.2	1.0	1.0	-150.10	9.0	2.8	15.3	13.3	2.05	7.476		
700.0	699.7	699.4	699.3	1.2	1.2	-149.44	6.5	6.4	17.7	15.3	2.41	7.354		
800.0	799.4	799.6	799.3	1.4	1.4	-147.75	3.0	11.4	20.5	17.7	2.78	7.362		
900.0	898.9	899.8	899.2	1.7	1.6	-145.46	-1.5	17.9	23.6	20.5	3.18	7.447		
1,000.0	998.3	1,000.0	998.9	1.9	1.8	-142.87	-7.0	25.8	27.2	23.6	3.59	7.574		
1,100.0	1,097.4	1,100.2	1,098.4	2.2	2.1	-140.20	-13.5	35.1	31.2	27.2	4.05	7.720		
1,200.0	1,196.3	1,200.4	1,197.8	2.5	2.3	-137.57	-20.9	45.8	35.7	31.2	4.54	7.868		
1,300.0	1,294.9	1,300.5	1,296.8	2.8	2.6	-135.06	-29.4	58.0	40.7	35.7	5.09	8.008		
1,400.0	1,393.3	1,400.7	1,395.6	3.1	2.9	-132.71	-38.8	71.6	46.3	40.6	5.69	8.133		
1,500.0	1,491.2	1,500.8	1,494.1	3.5	3.3	-130.52	-49.2	86.6	52.3	45.9	6.34	8.242		
1,600.0	1,588.9	1,601.0	1,592.2	3.9	3.7	-128.51	-60.6	103.0	58.8	51.8	7.06	8.335		
1,700.0	1,686.1	1,700.7	1,689.7	4.3	4.0	-127.41	-72.5	120.0	66.2	58.4	7.79	8.499		
1,800.0	1,782.9	1,800.3	1,787.2	4.8	4.4	-127.58	-84.3	137.0	74.7	66.2	8.51	8.772		
1,900.0	1,879.5	1,899.9	1,884.6	5.3	4.8	-128.24	-96.1	154.0	83.7	74.5	9.22	9.071		
2,000.0	1,976.1	1,999.5	1,982.0	5.7	5.2	-128.78	-107.9	171.0	92.7	82.7	9.94	9.324		
2,100.0	2,072.7	2,099.1	2,079.4	6.2	5.6	-129.22	-119.7	188.0	101.7	91.0	10.66	9.540		
2,200.0	2,169.3	2,198.7	2,176.8	6.7	6.0	-129.59	-131.6	205.0	110.7	99.3	11.38	9.726		
2,300.0	2,265.9	2,298.3	2,274.3	7.2	6.4	-129.90	-143.4	222.0	119.7	107.6	12.11	9.888		
2,400.0	2,362.5	2,397.9	2,371.7	7.6	6.8	-130.17	-155.2	239.0	128.7	115.9	12.84	10.030		
2,500.0	2,459.1	2,497.4	2,469.1	8.1	7.2	-130.41	-167.0	256.0	137.8	124.2	13.56	10.155		
2,600.0	2,555.7	2,597.0	2,566.5	8.6	7.5	-130.61	-178.8	273.0	146.8	132.5	14.30	10.267		
2,700.0	2,652.3	2,696.6	2,663.9	9.1	7.9	-130.80	-190.7	290.0	155.8	140.8	15.03	10.367		
2,800.0	2,748.8	2,796.2	2,761.3	9.6	8.3	-130.96	-202.5	307.0	164.8	149.1	15.76	10.457		
2,900.0	2,845.4	2,895.8	2,858.7	10.0	8.7	-131.10	-214.3	324.0	173.9	157.4	16.50	10.538		
3,000.0	2,942.0	2,995.4	2,956.2	10.5	9.1	-131.23	-226.1	341.0	182.9	165.6	17.23	10.612		
3,100.0	3,038.6	3,095.0	3,053.6	11.0	9.5	-131.35	-237.9	358.0	191.9	173.9	17.97	10.680		
3,200.0	3,135.2	3,194.6	3,151.0	11.5	9.9	-131.46	-249.7	375.0	200.9	182.2	18.71	10.742		
3,300.0	3,231.8	3,294.2	3,248.4	12.0	10.3	-131.56	-261.6	392.1	210.0	190.5	19.44	10.798		
3,400.0	3,328.4	3,393.8	3,345.8	12.5	10.7	-131.65	-273.4	409.1	219.0	198.8	20.18	10.851		
3,500.0	3,425.0	3,493.3	3,443.2	12.9	11.2	-131.73	-285.2	426.0	228.0	207.1	20.92	10.899		
3,600.0	3,521.6	3,591.2	3,539.1	13.4	11.5	-132.01	-296.3	442.0	237.4	215.8	21.60	10.993		
3,700.0	3,618.2	3,689.0	3,635.2	13.9	11.9	-132.61	-306.5	456.7	247.6	225.4	22.19	11.157		
3,800.0	3,715.0	3,786.5	3,731.5	14.4	12.2	-133.45	-315.7	469.9	257.9	235.2	22.70	11.360		
3,900.0	3,812.2	3,884.0	3,827.9	14.8	12.5	-134.29	-323.9	481.8	267.8	244.6	23.16	11.563		
4,000.0	3,909.8	3,981.4	3,924.4	15.2	12.7	-135.12	-331.3	492.4	277.3	253.7	23.57	11.766		
4,100.0	4,007.8	4,078.7	4,021.1	15.6	13.0	-135.95	-337.7	501.5	286.4	262.5	23.93	11.969		
4,200.0	4,106.1	4,175.9	4,117.8	15.9	13.2	-136.79	-343.1	509.4	295.1	270.9	24.24	12.174		
4,300.0	4,204.7	4,273.0	4,214.6	16.3	13.4	-137.63	-347.6	515.8	303.4	278.9	24.50	12.382		
4,400.0	4,303.6	4,370.0	4,311.4	16.6	13.6	-138.48	-351.1	521.0	311.3	286.6	24.72	12.592		
4,500.0	4,402.7	4,466.9	4,408.1	16.8	13.7	-139.33	-353.8	524.7	318.8	293.9	24.90	12.806		
4,600.0	4,502.1	4,563.7	4,504.9	17.1	13.8	-140.20	-355.5	527.2	326.0	300.9	25.03	13.024		
4,700.0	4,601.6	4,660.3	4,601.5	17.3	14.0	-141.09	-356.2	528.2	332.7	307.6	25.12	13.245		
4,800.0	4,701.3	4,759.1	4,700.3	17.5	14.1	-141.95	-356.2	528.3	338.9	313.7	25.20	13.450		
4,900.0	4,801.1	4,858.9	4,800.1	17.7	14.2	-142.61	-356.2	528.3	343.8	318.5	25.31	13.585		
5,000.0	4,901.0	4,958.8	4,900.0	17.8	14.3	-143.08	-356.2	528.3	347.4	321.9	25.45	13.647		
5,100.0	5,000.9	5,058.8	4,999.9	17.9	14.4	-143.36	-356.2	528.3	349.5	323.9	25.63	13.638		

CC - Min centre to center distance or convergent point, SF - min separation factor, ES - min ellipse separation

# Anticollision Report

<b>Company:</b>	EnCana Oil & Gas (USA) Inc	<b>Local Co-ordinate Reference:</b>	Well Drieth 4F-6H-I368
<b>Project:</b>	DJ Wattenberg	<b>TVD Reference:</b>	WELL @ 5124.0ft (Original Well Elev)
<b>Reference Site:</b>	S6-T3N-R68W (Zisch/Drieth)	<b>MD Reference:</b>	WELL @ 5124.0ft (Original Well Elev)
<b>Site Error:</b>	0.0ft	<b>North Reference:</b>	True
<b>Reference Well:</b>	Drieth 4F-6H-I368	<b>Survey Calculation Method:</b>	Minimum Curvature
<b>Well Error:</b>	0.0ft	<b>Output errors are at</b>	2.00 sigma
<b>Reference Wellbore</b>	Hz	<b>Database:</b>	USA EDM 5000 Multi Users DB
<b>Reference Design:</b>	Plan #1	<b>Offset TVD Reference:</b>	Offset Datum

Offset Design S6-T3N-R68W (Zisch/Drieth) - Drieth 4E-6H-I368 - Hz - Plan #1													Offset Site Error:	0.0 ft
Survey Program: O-MWD													Offset Well Error:	0.0 ft
Reference		Offset		Semi Major Axis		Distance		Total		Separation		Warning		
Measured Depth (ft)	Vertical Depth (ft)	Measured Depth (ft)	Vertical Depth (ft)	Reference (ft)	Offset (ft)	Highside Toolface (°)	Offset Wellbore Centre +N/-S (ft)	+E/-W (ft)	Between Centres (ft)	Between Ellipses (ft)	Uncertainty Axis			
5,200.0	5,100.9	5,158.7	5,099.9	18.0	14.5	-143.46	-356.2	528.3	350.3	324.5	25.84	13.558		
5,300.0	5,200.9	5,258.7	5,199.9	18.1	14.6	-0.36	-356.2	528.3	350.3	323.5	26.76	13.091		
5,400.0	5,300.9	5,358.7	5,299.9	18.2	14.7	-0.36	-356.2	528.3	350.3	323.3	27.01	12.971		
5,500.0	5,400.9	5,458.7	5,399.9	18.3	14.8	-0.36	-356.2	528.3	350.3	323.0	27.25	12.853		
5,600.0	5,500.9	5,558.7	5,499.9	18.4	14.9	-0.36	-356.2	528.3	350.3	322.8	27.51	12.735		
5,700.0	5,600.9	5,658.7	5,599.9	18.5	15.0	-0.36	-356.2	528.3	350.3	322.5	27.76	12.619		
5,800.0	5,700.9	5,758.7	5,699.9	18.5	15.1	-0.36	-356.2	528.3	350.3	322.3	28.01	12.504		
5,900.0	5,800.9	5,858.7	5,799.9	18.6	15.3	-0.36	-356.2	528.3	350.3	322.0	28.27	12.390		
6,000.0	5,900.9	5,958.7	5,899.9	18.7	15.4	-0.36	-356.2	528.3	350.3	321.8	28.53	12.278		
6,100.0	6,000.9	6,058.7	5,999.9	18.8	15.5	-0.36	-356.2	528.3	350.3	321.5	28.79	12.167		
6,200.0	6,100.9	6,158.7	6,099.9	18.9	15.6	-0.36	-356.2	528.3	350.3	321.2	29.05	12.057		
6,300.0	6,200.9	6,258.7	6,199.9	19.0	15.7	-0.36	-356.2	528.3	350.3	321.0	29.32	11.948		
6,400.0	6,300.9	6,358.7	6,299.9	19.1	15.9	-0.36	-356.2	528.3	350.3	320.7	29.58	11.841		
6,499.7	6,400.6	6,458.4	6,399.6	19.2	16.0	90.28	-356.2	528.3	350.3	321.0	29.27	11.966		
6,500.0	6,400.9	6,458.7	6,399.9	19.2	16.0	90.00	-356.2	528.3	350.3	321.1	29.22	11.989		
6,600.0	6,499.7	6,557.5	6,498.7	19.2	16.1	92.36	-356.2	528.3	350.6	320.8	29.76	11.780		
6,700.0	6,595.5	6,655.3	6,596.4	19.0	16.2	96.57	-356.2	527.6	352.8	322.4	30.41	11.601		
6,800.0	6,686.4	6,758.9	6,699.2	18.8	16.2	101.23	-356.2	515.4	357.8	327.2	30.64	11.679		
6,900.0	6,770.7	6,867.7	6,804.2	18.5	16.0	105.66	-356.3	486.8	365.0	334.7	30.25	12.064		
7,000.0	6,846.7	6,982.4	6,908.7	18.2	15.7	109.77	-356.3	439.8	373.9	344.6	29.32	12.750		
7,100.0	6,912.9	7,103.4	7,009.3	18.0	15.3	113.43	-356.3	372.9	383.6	355.6	28.03	13.688		
7,200.0	6,968.1	7,230.7	7,101.4	17.8	14.9	116.57	-356.3	285.3	393.3	366.6	26.71	14.723		
7,300.0	7,011.1	7,364.2	7,179.8	17.8	14.6	119.07	-356.3	177.5	402.0	376.1	25.90	15.522		
7,400.0	7,041.2	7,502.8	7,238.6	18.0	14.6	120.87	-356.3	52.1	408.6	382.5	26.14	15.636		
7,500.0	7,057.7	7,645.3	7,272.7	18.5	15.7	121.90	-356.3	-85.9	412.6	384.8	27.82	14.834		
7,600.0	7,061.0	7,776.6	7,280.0	19.5	17.5	122.14	-356.3	-216.9	413.6	383.0	30.60	13.516		
7,700.0	7,061.0	7,876.6	7,280.0	20.8	19.1	122.14	-356.3	-316.9	413.6	380.2	33.32	12.411		
7,800.0	7,061.0	7,976.6	7,280.0	22.3	20.9	122.14	-356.3	-416.9	413.5	377.2	36.32	11.387		
7,900.0	7,061.0	8,076.6	7,280.0	24.1	22.8	122.14	-356.3	-516.9	413.5	374.0	39.53	10.460		
8,000.0	7,061.0	8,176.6	7,280.0	26.0	24.8	122.14	-356.3	-616.9	413.5	370.6	42.92	9.635		
8,100.0	7,061.0	8,276.6	7,280.0	28.0	26.9	122.14	-356.4	-716.9	413.5	367.1	46.44	8.905		
8,200.0	7,061.0	8,376.6	7,280.0	30.1	29.1	122.14	-356.4	-816.9	413.5	363.4	50.06	8.260		
8,300.0	7,061.0	8,476.6	7,280.0	32.2	31.3	122.14	-356.4	-916.9	413.5	359.7	53.76	7.691		
8,400.0	7,061.0	8,576.6	7,280.0	34.4	33.5	122.15	-356.4	-1,016.9	413.5	355.9	57.54	7.186		
8,500.0	7,061.0	8,676.6	7,280.0	36.6	35.7	122.15	-356.4	-1,116.9	413.5	352.1	61.36	6.738		
8,600.0	7,061.0	8,776.6	7,280.0	38.9	38.0	122.15	-356.4	-1,216.9	413.5	348.2	65.24	6.338		
8,700.0	7,061.0	8,876.6	7,280.0	41.1	40.3	122.15	-356.4	-1,316.9	413.5	344.3	69.15	5.979		
8,800.0	7,061.0	8,976.6	7,280.0	43.4	42.7	122.15	-356.4	-1,416.9	413.4	340.4	73.09	5.657		
8,900.0	7,061.0	9,076.6	7,280.0	45.7	45.0	122.15	-356.4	-1,516.9	413.4	336.4	77.06	5.365		
9,000.0	7,061.0	9,176.6	7,280.0	48.1	47.4	122.15	-356.4	-1,616.9	413.4	332.4	81.05	5.101		
9,100.0	7,061.0	9,276.6	7,280.0	50.4	49.7	122.15	-356.4	-1,716.9	413.4	328.4	85.06	4.860		
9,200.0	7,061.0	9,376.6	7,280.0	52.8	52.1	122.15	-356.4	-1,816.9	413.4	324.3	89.09	4.640		
9,300.0	7,061.0	9,476.6	7,280.0	55.1	54.5	122.15	-356.5	-1,916.9	413.4	320.3	93.13	4.439		
9,400.0	7,061.0	9,576.6	7,280.0	57.5	56.9	122.15	-356.5	-2,016.9	413.4	316.2	97.18	4.254		
9,500.0	7,061.0	9,676.6	7,280.0	59.9	59.3	122.16	-356.5	-2,116.9	413.4	312.1	101.25	4.083		
9,600.0	7,061.0	9,776.6	7,280.0	62.3	61.7	122.16	-356.5	-2,216.9	413.4	308.0	105.33	3.925		
9,700.0	7,061.0	9,876.6	7,280.0	64.7	64.1	122.16	-356.5	-2,316.9	413.3	303.9	109.41	3.778		
9,800.0	7,061.0	9,976.6	7,280.0	67.1	66.5	122.16	-356.5	-2,416.9	413.3	299.8	113.50	3.642		
9,900.0	7,061.0	10,076.6	7,280.0	69.5	68.9	122.16	-356.5	-2,516.9	413.3	295.7	117.60	3.515		
10,000.0	7,061.0	10,176.6	7,280.0	71.9	71.4	122.16	-356.5	-2,616.9	413.3	291.6	121.71	3.396		
10,100.0	7,061.0	10,276.6	7,280.0	74.3	73.8	122.16	-356.5	-2,716.9	413.3	287.5	125.82	3.285		
10,200.0	7,061.0	10,376.6	7,280.0	76.7	76.2	122.16	-356.5	-2,816.9	413.3	283.4	129.94	3.181		

CC - Min centre to center distance or convergent point, SF - min separation factor, ES - min ellipse separation

# Anticollision Report

<b>Company:</b>	EnCana Oil & Gas (USA) Inc	<b>Local Co-ordinate Reference:</b>	Well Drieth 4F-6H-I368
<b>Project:</b>	DJ Wattenberg	<b>TVD Reference:</b>	WELL @ 5124.0ft (Original Well Elev)
<b>Reference Site:</b>	S6-T3N-R68W (Zisch/Drieth)	<b>MD Reference:</b>	WELL @ 5124.0ft (Original Well Elev)
<b>Site Error:</b>	0.0ft	<b>North Reference:</b>	True
<b>Reference Well:</b>	Drieth 4F-6H-I368	<b>Survey Calculation Method:</b>	Minimum Curvature
<b>Well Error:</b>	0.0ft	<b>Output errors are at</b>	2.00 sigma
<b>Reference Wellbore</b>	Hz	<b>Database:</b>	USA EDM 5000 Multi Users DB
<b>Reference Design:</b>	Plan #1	<b>Offset TVD Reference:</b>	Offset Datum

Offset Design												S6-T3N-R68W (Zisch/Drieth) - Drieth 4E-6H-I368 - Hz - Plan #1		Offset Site Error:		0.0 ft	
Survey Program:												0-MWD		Offset Well Error:		0.0 ft	
Reference		Offset		Semi Major Axis			Distance										
Measured Depth	Vertical Depth	Measured Depth	Vertical Depth	Reference	Offset	Highside Toolface	Offset Wellbore Centre		Between Centres	Between Ellipses	Total Uncertainty Axis	Separation Factor	Warning				
(ft)	(ft)	(ft)	(ft)	(ft)	(ft)	(°)	+N/-S (ft)	+E/-W (ft)	(ft)	(ft)							
10,300.0	7,061.0	10,476.6	7,280.0	79.1	78.7	122.16	-356.5	-2,916.9	413.3	279.2	134.06	3.083					
10,400.0	7,061.0	10,576.6	7,280.0	81.6	81.1	122.16	-356.5	-3,016.9	413.3	275.1	138.19	2.991					
10,500.0	7,061.0	10,676.6	7,280.0	84.0	83.5	122.16	-356.6	-3,116.9	413.3	271.0	142.32	2.904					
10,600.0	7,061.0	10,776.6	7,280.0	86.4	86.0	122.16	-356.6	-3,216.9	413.3	266.8	146.45	2.822					
10,700.0	7,061.0	10,876.6	7,280.0	88.9	88.4	122.17	-356.6	-3,316.9	413.2	262.7	150.59	2.744					
10,800.0	7,061.0	10,976.6	7,280.0	91.3	90.9	122.17	-356.6	-3,416.9	413.2	258.5	154.73	2.671					
10,900.0	7,061.0	11,076.6	7,280.0	93.7	93.3	122.17	-356.6	-3,516.9	413.2	254.4	158.87	2.601					
11,000.0	7,061.0	11,176.6	7,280.0	96.2	95.7	122.17	-356.6	-3,616.9	413.2	250.2	163.01	2.535					
11,100.0	7,061.0	11,276.6	7,280.0	98.6	98.2	122.17	-356.6	-3,716.9	413.2	246.0	167.16	2.472					
11,200.0	7,061.0	11,376.6	7,280.0	101.0	100.6	122.17	-356.6	-3,816.9	413.2	241.9	171.31	2.412					
11,300.0	7,061.0	11,476.6	7,280.0	103.5	103.1	122.17	-356.6	-3,916.9	413.2	237.7	175.46	2.355					
11,400.0	7,061.0	11,576.6	7,280.0	105.9	105.5	122.17	-356.6	-4,016.9	413.2	233.6	179.61	2.300					
11,500.0	7,061.0	11,676.6	7,280.0	108.4	108.0	122.17	-356.6	-4,116.9	413.2	229.4	183.77	2.248					
11,533.5	7,061.0	11,710.1	7,280.0	109.2	108.8	122.17	-356.6	-4,150.4	413.2	228.0	185.16	2.231					
11,539.2	7,061.0	11,715.7	7,280.0	109.3	109.0	122.17	-356.6	-4,156.0	413.2	227.8	185.40	2.229 SF					

# Anticollision Report

<b>Company:</b>	EnCana Oil & Gas (USA) Inc	<b>Local Co-ordinate Reference:</b>	Well Drieth 4F-6H-I368
<b>Project:</b>	DJ Wattenberg	<b>TVD Reference:</b>	WELL @ 5124.0ft (Original Well Elev)
<b>Reference Site:</b>	S6-T3N-R68W (Zisch/Drieth)	<b>MD Reference:</b>	WELL @ 5124.0ft (Original Well Elev)
<b>Site Error:</b>	0.0ft	<b>North Reference:</b>	True
<b>Reference Well:</b>	Drieth 4F-6H-I368	<b>Survey Calculation Method:</b>	Minimum Curvature
<b>Well Error:</b>	0.0ft	<b>Output errors are at</b>	2.00 sigma
<b>Reference Wellbore</b>	Hz	<b>Database:</b>	USA EDM 5000 Multi Users DB
<b>Reference Design:</b>	Plan #1	<b>Offset TVD Reference:</b>	Offset Datum

Offset Design S6-T3N-R68W (Zisch/Drieth) - Drieth 4G-6H-I368 - Hz - Plan #1													Offset Site Error:	0.0 ft
Survey Program: 0-MWD													Offset Well Error:	0.0 ft
Reference		Offset		Semi Major Axis		Distance		Total		Separation		Warning		
Measured Depth (ft)	Vertical Depth (ft)	Measured Depth (ft)	Vertical Depth (ft)	Reference (ft)	Offset (ft)	Highside Toolface (°)	Offset Wellbore Centre +N/-S (ft)	+E/-W (ft)	Between Centres (ft)	Between Ellipses (ft)	Uncertainty Axis			
0.0	0.0	0.0	0.0	0.0	0.0	-180.00	-10.9	0.0	10.9					
100.0	100.0	100.0	100.0	0.2	0.2	-180.00	-10.9	0.0	10.9	10.6	0.30	35.986		
200.0	200.0	200.0	200.0	0.3	0.3	-180.00	-10.9	0.0	10.9	10.3	0.65	16.742 CC, ES		
300.0	300.0	299.8	299.8	0.5	0.5	178.07	-11.7	0.4	11.7	10.7	1.00	11.686		
400.0	400.0	399.6	399.6	0.7	0.7	32.39	-14.0	1.6	13.4	12.0	1.35	9.901		
500.0	500.0	499.4	499.2	0.9	0.9	31.41	-17.9	3.5	15.2	13.5	1.70	8.926		
600.0	599.9	599.1	598.8	1.0	1.1	31.57	-23.3	6.3	17.1	15.1	2.06	8.334		
700.0	699.7	698.8	698.1	1.2	1.3	32.50	-30.3	9.8	19.2	16.8	2.42	7.951		
800.0	799.4	798.4	797.3	1.4	1.5	33.96	-38.8	14.1	21.5	18.7	2.79	7.690		
900.0	898.9	898.0	896.3	1.7	1.8	35.77	-48.8	19.2	23.8	20.7	3.18	7.502		
1,000.0	998.3	997.6	995.0	1.9	2.0	37.81	-60.4	25.1	26.4	22.8	3.59	7.357		
1,100.0	1,097.4	1,097.1	1,093.5	2.2	2.3	39.98	-73.4	31.7	29.2	25.1	4.03	7.234		
1,200.0	1,196.3	1,196.6	1,191.6	2.5	2.7	42.20	-88.0	39.1	32.1	27.6	4.51	7.122		
1,300.0	1,294.9	1,296.1	1,289.4	2.8	3.0	44.42	-104.1	47.3	35.3	30.3	5.04	7.011		
1,400.0	1,393.3	1,395.5	1,386.8	3.1	3.4	46.61	-121.8	56.2	38.7	33.1	5.62	6.898		
1,500.0	1,491.2	1,494.9	1,483.9	3.5	3.8	48.73	-140.9	65.9	42.4	36.2	6.25	6.783		
1,600.0	1,588.9	1,594.2	1,580.5	3.9	4.2	50.77	-161.5	76.4	46.3	39.4	6.95	6.666		
1,700.0	1,686.1	1,693.4	1,676.6	4.3	4.7	52.72	-183.5	87.6	50.5	42.8	7.72	6.549		
1,800.0	1,782.9	1,792.7	1,772.2	4.8	5.1	54.57	-207.1	99.5	55.0	46.4	8.55	6.433		
1,900.0	1,879.5	1,892.5	1,868.2	5.3	5.6	56.18	-231.6	112.0	59.7	50.3	9.41	6.345		
2,000.0	1,976.1	1,992.4	1,964.2	5.7	6.1	57.56	-256.2	124.4	64.4	54.1	10.28	6.265		
2,100.0	2,072.7	2,092.3	2,060.2	6.2	6.6	58.75	-280.7	136.9	69.2	58.0	11.17	6.194		
2,200.0	2,169.3	2,192.1	2,156.2	6.7	7.1	59.79	-305.3	149.3	74.0	61.9	12.07	6.131		
2,300.0	2,265.9	2,292.0	2,252.2	7.2	7.6	60.69	-329.8	161.8	78.8	65.8	12.97	6.075		
2,400.0	2,362.5	2,391.9	2,348.2	7.6	8.1	61.50	-354.4	174.2	83.7	69.8	13.89	6.025		
2,500.0	2,459.1	2,491.8	2,444.3	8.1	8.6	62.21	-378.9	186.7	88.5	73.7	14.80	5.980		
2,600.0	2,555.7	2,591.6	2,540.3	8.6	9.1	62.85	-403.5	199.1	93.4	77.7	15.72	5.940		
2,700.0	2,652.3	2,691.5	2,636.3	9.1	9.7	63.43	-428.0	211.6	98.3	81.6	16.64	5.903		
2,800.0	2,748.8	2,791.4	2,732.3	9.6	10.2	63.96	-452.6	224.1	103.1	85.6	17.57	5.870		
2,900.0	2,845.4	2,891.3	2,828.3	10.0	10.7	64.43	-477.1	236.5	108.0	89.5	18.50	5.841		
3,000.0	2,942.0	2,991.1	2,924.3	10.5	11.2	64.87	-501.7	249.0	112.9	93.5	19.43	5.813		
3,100.0	3,038.6	3,091.0	3,020.3	11.0	11.7	65.26	-526.2	261.4	117.8	97.5	20.36	5.789		
3,200.0	3,135.2	3,190.9	3,116.3	11.5	12.2	65.63	-550.8	273.9	122.7	101.5	21.29	5.766		
3,300.0	3,231.8	3,290.8	3,212.3	12.0	12.7	65.97	-575.3	286.3	127.7	105.4	22.22	5.745		
3,400.0	3,328.4	3,390.6	3,308.3	12.5	13.2	66.28	-599.9	298.8	132.6	109.4	23.16	5.725		
3,500.0	3,425.0	3,490.5	3,404.3	12.9	13.7	66.57	-624.4	311.2	137.5	113.4	24.09	5.707		
3,600.0	3,521.6	3,590.4	3,500.3	13.4	14.2	66.84	-649.0	323.7	142.4	117.4	25.03	5.691		
3,700.0	3,618.2	3,690.3	3,596.3	13.9	14.8	67.10	-673.5	336.2	147.4	121.4	25.97	5.675		
3,800.0	3,715.0	3,790.1	3,692.3	14.4	15.3	67.10	-698.1	348.6	152.6	125.8	26.84	5.687		
3,900.0	3,812.2	3,889.9	3,788.3	14.8	15.8	66.54	-722.6	361.1	158.5	131.0	27.57	5.750		
4,000.0	3,909.8	3,989.7	3,884.1	15.2	16.3	65.48	-747.1	373.5	165.2	137.0	28.16	5.866		
4,100.0	4,007.8	4,089.3	3,979.9	15.6	16.8	63.99	-771.6	385.9	172.7	144.0	28.61	6.035		
4,200.0	4,106.1	4,188.8	4,075.5	15.9	17.3	62.14	-796.1	398.3	181.1	152.1	28.92	6.261		
4,300.0	4,204.7	4,288.1	4,171.0	16.3	17.8	60.03	-820.5	410.7	190.5	161.4	29.08	6.550		
4,400.0	4,303.6	4,387.1	4,266.2	16.6	18.3	57.71	-844.8	423.1	201.1	172.0	29.12	6.908		
4,500.0	4,402.7	4,487.2	4,362.5	16.8	18.8	55.26	-869.3	435.5	212.9	183.9	29.03	7.336		
4,600.0	4,502.1	4,588.9	4,460.7	17.1	19.3	52.95	-892.8	447.4	225.0	196.1	28.88	7.791		
4,700.0	4,601.6	4,690.9	4,559.6	17.3	19.8	50.84	-914.7	458.5	237.2	208.5	28.71	8.262		
4,800.0	4,701.3	4,793.1	4,659.2	17.5	20.2	48.89	-935.2	468.9	249.5	221.0	28.52	8.746		
4,900.0	4,801.1	4,895.6	4,759.5	17.7	20.6	47.08	-954.2	478.5	261.8	233.5	28.32	9.243		
5,000.0	4,901.0	4,998.4	4,860.5	17.8	21.0	45.38	-971.6	487.4	274.1	246.0	28.10	9.752		
5,100.0	5,000.9	5,101.5	4,962.0	17.9	21.3	43.80	-987.4	495.4	286.4	258.5	27.88	10.272		

CC - Min centre to center distance or convergent point, SF - min separation factor, ES - min ellipse separation



# Anticollision Report

<b>Company:</b>	EnCana Oil & Gas (USA) Inc	<b>Local Co-ordinate Reference:</b>	Well Drieth 4F-6H-I368
<b>Project:</b>	DJ Wattenberg	<b>TVD Reference:</b>	WELL @ 5124.0ft (Original Well Elev)
<b>Reference Site:</b>	S6-T3N-R68W (Zisch/Drieth)	<b>MD Reference:</b>	WELL @ 5124.0ft (Original Well Elev)
<b>Site Error:</b>	0.0ft	<b>North Reference:</b>	True
<b>Reference Well:</b>	Drieth 4F-6H-I368	<b>Survey Calculation Method:</b>	Minimum Curvature
<b>Well Error:</b>	0.0ft	<b>Output errors are at</b>	2.00 sigma
<b>Reference Wellbore</b>	Hz	<b>Database:</b>	USA EDM 5000 Multi Users DB
<b>Reference Design:</b>	Plan #1	<b>Offset TVD Reference:</b>	Offset Datum

Offset Design S6-T3N-R68W (Zisch/Drieth) - Drieth 4G-6H-I368 - Hz - Plan #1													Offset Site Error:	0.0 ft
Survey Program: 0-MWD													Offset Well Error:	0.0 ft
Reference		Offset		Semi Major Axis		Distance		Total		Separation		Warning		
Measured Depth (ft)	Vertical Depth (ft)	Measured Depth (ft)	Vertical Depth (ft)	Reference (ft)	Offset (ft)	Highside Toolface (°)	Offset Wellbore Centre +N/-S (ft)	+E/-W (ft)	Between Centres (ft)	Between Ellipses (ft)	Uncertainty Axis			
5,200.0	5,100.9	5,204.9	5,064.2	18.0	21.6	42.30	-1,001.6	502.6	298.6	271.0	27.64	10.803		
5,300.0	5,200.9	5,308.7	5,167.0	18.1	21.9	-176.00	-1,014.2	509.0	310.3	276.0	34.32	9.042		
5,400.0	5,300.9	5,412.9	5,270.5	18.2	22.2	-177.14	-1,025.2	514.6	320.5	285.5	35.00	9.158		
5,500.0	5,400.9	5,517.6	5,374.7	18.3	22.4	-178.05	-1,034.5	519.3	329.2	293.7	35.58	9.253		
5,600.0	5,500.9	5,622.7	5,479.3	18.4	22.6	-178.76	-1,042.2	523.2	336.4	300.4	36.08	9.325		
5,700.0	5,600.9	5,728.0	5,584.4	18.5	22.8	-179.29	-1,048.2	526.2	342.1	305.6	36.50	9.371		
5,800.0	5,700.9	5,833.5	5,689.8	18.5	22.9	-179.65	-1,052.4	528.4	346.1	309.2	36.85	9.391		
5,900.0	5,800.9	5,939.2	5,795.5	18.6	23.0	-179.87	-1,055.0	529.7	348.5	311.3	37.14	9.383		
6,000.0	5,900.9	6,044.6	5,900.9	18.7	23.1	-179.93	-1,055.8	530.1	349.2	311.9	37.36	9.347		
6,100.0	6,000.9	6,144.6	6,000.9	18.8	23.2	-179.93	-1,055.8	530.1	349.2	311.7	37.56	9.297		
6,200.0	6,100.9	6,244.6	6,100.9	18.9	23.3	-179.93	-1,055.8	530.1	349.2	311.5	37.77	9.247		
6,300.0	6,200.9	6,344.6	6,200.9	19.0	23.4	-179.93	-1,055.8	530.1	349.2	311.2	37.97	9.197		
6,400.0	6,300.9	6,444.6	6,300.9	19.1	23.4	-179.93	-1,055.8	530.1	349.2	311.0	38.18	9.147		
6,451.8	6,352.7	6,496.4	6,352.7	19.2	23.5	-90.11	-1,055.8	530.1	349.2	320.1	29.13	11.987		
6,500.0	6,400.9	6,544.6	6,400.9	19.2	23.5	-90.29	-1,055.8	530.1	349.2	320.0	29.18	11.968		
6,600.0	6,499.7	6,643.4	6,499.7	19.2	23.6	-92.65	-1,055.8	530.1	349.6	321.1	28.47	12.279		
6,700.0	6,595.5	6,741.2	6,597.5	19.0	23.7	-96.87	-1,055.8	529.3	352.0	324.9	27.14	12.968		
6,800.0	6,686.4	6,845.1	6,700.6	18.8	23.7	-101.53	-1,055.8	517.1	357.1	331.3	25.77	13.857		
6,900.0	6,770.7	6,954.3	6,805.8	18.5	23.5	-105.96	-1,055.8	488.3	364.5	339.8	24.67	14.773		
7,000.0	6,846.7	7,069.4	6,910.6	18.2	23.3	-110.05	-1,055.8	441.1	373.5	349.5	23.93	15.606		
7,100.0	6,912.9	7,190.7	7,011.4	18.0	23.1	-113.69	-1,055.8	373.8	383.3	359.7	23.59	16.248		
7,200.0	6,968.1	7,318.3	7,103.6	17.8	22.8	-116.79	-1,055.8	285.7	393.0	369.3	23.69	16.590		
7,300.0	7,011.1	7,452.1	7,181.8	17.8	22.6	-119.26	-1,055.8	177.5	401.6	377.3	24.27	16.548		
7,400.0	7,041.2	7,591.0	7,240.3	18.0	22.6	-121.02	-1,055.8	51.7	408.1	382.7	25.43	16.052		
7,500.0	7,057.7	7,733.6	7,274.0	18.5	23.0	-122.00	-1,055.8	-86.6	412.0	384.8	27.20	15.146		
7,600.0	7,061.0	7,864.2	7,281.0	19.5	23.7	-122.20	-1,055.8	-216.8	412.8	383.2	29.58	13.955		
7,700.0	7,061.0	7,964.2	7,281.0	20.8	24.5	-122.20	-1,055.8	-316.8	412.8	380.4	32.41	12.736		
7,800.0	7,061.0	8,064.2	7,281.0	22.3	25.7	-122.20	-1,055.8	-416.8	412.8	377.3	35.51	11.627		
7,900.0	7,061.0	8,164.2	7,281.0	24.1	27.0	-122.20	-1,055.8	-516.8	412.8	374.0	38.81	10.638		
8,000.0	7,061.0	8,264.2	7,281.0	26.0	28.6	-122.20	-1,055.8	-616.8	412.8	370.6	42.27	9.767		
8,100.0	7,061.0	8,364.2	7,281.0	28.0	30.4	-122.20	-1,055.8	-716.8	412.9	367.0	45.85	9.004		
8,200.0	7,061.0	8,464.2	7,281.0	30.1	32.2	-122.20	-1,055.8	-816.8	412.9	363.3	49.53	8.336		
8,300.0	7,061.0	8,564.2	7,281.0	32.2	34.2	-122.20	-1,055.9	-916.8	412.9	359.6	53.28	7.749		
8,400.0	7,061.0	8,664.2	7,281.0	34.4	36.2	-122.20	-1,055.9	-1,016.8	412.9	355.8	57.10	7.231		
8,500.0	7,061.0	8,764.2	7,281.0	36.6	38.3	-122.20	-1,055.9	-1,116.8	412.9	351.9	60.97	6.772		
8,600.0	7,061.0	8,864.2	7,281.0	38.9	40.5	-122.20	-1,055.9	-1,216.8	412.9	348.0	64.87	6.365		
8,700.0	7,061.0	8,964.2	7,281.0	41.1	42.7	-122.20	-1,055.9	-1,316.8	412.9	344.1	68.81	6.000		
8,800.0	7,061.0	9,064.2	7,281.0	43.4	44.9	-122.19	-1,055.9	-1,416.8	412.9	340.1	72.78	5.673		
8,900.0	7,061.0	9,164.2	7,281.0	45.7	47.1	-122.19	-1,055.9	-1,516.8	412.9	336.1	76.77	5.378		
9,000.0	7,061.0	9,264.2	7,281.0	48.1	49.4	-122.19	-1,055.9	-1,616.8	412.9	332.1	80.79	5.111		
9,100.0	7,061.0	9,364.2	7,281.0	50.4	51.7	-122.19	-1,055.9	-1,716.8	412.9	328.1	84.82	4.868		
9,200.0	7,061.0	9,464.2	7,281.0	52.8	54.0	-122.19	-1,055.9	-1,816.8	413.0	324.1	88.87	4.647		
9,300.0	7,061.0	9,564.2	7,281.0	55.1	56.3	-122.19	-1,055.9	-1,916.8	413.0	320.0	92.92	4.444		
9,400.0	7,061.0	9,664.2	7,281.0	57.5	58.7	-122.19	-1,055.9	-2,016.8	413.0	316.0	97.00	4.258		
9,500.0	7,061.0	9,764.2	7,281.0	59.9	61.0	-122.19	-1,055.9	-2,116.8	413.0	311.9	101.08	4.086		
9,600.0	7,061.0	9,864.2	7,281.0	62.3	63.4	-122.19	-1,055.9	-2,216.8	413.0	307.8	105.17	3.927		
9,700.0	7,061.0	9,964.2	7,281.0	64.7	65.7	-122.19	-1,055.9	-2,316.8	413.0	303.7	109.26	3.780		
9,800.0	7,061.0	10,064.2	7,281.0	67.1	68.1	-122.19	-1,056.0	-2,416.8	413.0	299.6	113.37	3.643		
9,900.0	7,061.0	10,164.2	7,281.0	69.5	70.5	-122.19	-1,056.0	-2,516.8	413.0	295.5	117.48	3.516		
10,000.0	7,061.0	10,264.2	7,281.0	71.9	72.8	-122.19	-1,056.0	-2,616.8	413.0	291.4	121.60	3.397		
10,100.0	7,061.0	10,364.2	7,281.0	74.3	75.2	-122.18	-1,056.0	-2,716.8	413.0	287.3	125.72	3.285		
10,200.0	7,061.0	10,464.2	7,281.0	76.7	77.6	-122.18	-1,056.0	-2,816.8	413.0	283.2	129.85	3.181		

CC - Min centre to center distance or convergent point, SF - min separation factor, ES - min ellipse separation

# Anticollision Report

<b>Company:</b>	EnCana Oil & Gas (USA) Inc	<b>Local Co-ordinate Reference:</b>	Well Drieth 4F-6H-I368
<b>Project:</b>	DJ Wattenberg	<b>TVD Reference:</b>	WELL @ 5124.0ft (Original Well Elev)
<b>Reference Site:</b>	S6-T3N-R68W (Zisch/Drieth)	<b>MD Reference:</b>	WELL @ 5124.0ft (Original Well Elev)
<b>Site Error:</b>	0.0ft	<b>North Reference:</b>	True
<b>Reference Well:</b>	Drieth 4F-6H-I368	<b>Survey Calculation Method:</b>	Minimum Curvature
<b>Well Error:</b>	0.0ft	<b>Output errors are at</b>	2.00 sigma
<b>Reference Wellbore</b>	Hz	<b>Database:</b>	USA EDM 5000 Multi Users DB
<b>Reference Design:</b>	Plan #1	<b>Offset TVD Reference:</b>	Offset Datum

Offset Design S6-T3N-R68W (Zisch/Drieth) - Drieth 4G-6H-I368 - Hz - Plan #1													Offset Site Error:	0.0 ft
Survey Program: 0-MWD													Offset Well Error:	0.0 ft
Reference		Offset		Semi Major Axis		Distance		Total		Separation		Warning		
Measured Depth (ft)	Vertical Depth (ft)	Measured Depth (ft)	Vertical Depth (ft)	Reference (ft)	Offset (ft)	Highside Toolface (°)	Offset Wellbore Centre +N/-S (ft)	+E/-W (ft)	Between Centres (ft)	Between Ellipses (ft)	Uncertainty Axis			
10,300.0	7,061.0	10,564.2	7,281.0	79.1	80.0	-122.18	-1,056.0	-2,916.8	413.0	279.1	133.98	3.083		
10,400.0	7,061.0	10,664.2	7,281.0	81.6	82.4	-122.18	-1,056.0	-3,016.8	413.1	274.9	138.11	2.991		
10,500.0	7,061.0	10,764.2	7,281.0	84.0	84.8	-122.18	-1,056.0	-3,116.8	413.1	270.8	142.25	2.904		
10,600.0	7,061.0	10,864.2	7,281.0	86.4	87.3	-122.18	-1,056.0	-3,216.8	413.1	266.7	146.39	2.822		
10,700.0	7,061.0	10,964.2	7,281.0	88.9	89.7	-122.18	-1,056.0	-3,316.8	413.1	262.5	150.54	2.744		
10,800.0	7,061.0	11,064.2	7,281.0	91.3	92.1	-122.18	-1,056.0	-3,416.8	413.1	258.4	154.69	2.671		
10,900.0	7,061.0	11,164.2	7,281.0	93.7	94.5	-122.18	-1,056.0	-3,516.8	413.1	254.3	158.84	2.601		
11,000.0	7,061.0	11,264.2	7,281.0	96.2	96.9	-122.18	-1,056.0	-3,616.8	413.1	250.1	162.99	2.535		
11,100.0	7,061.0	11,364.2	7,281.0	98.6	99.4	-122.18	-1,056.0	-3,716.8	413.1	246.0	167.14	2.472		
11,200.0	7,061.0	11,464.2	7,281.0	101.0	101.8	-122.18	-1,056.1	-3,816.8	413.1	241.8	171.30	2.412		
11,300.0	7,061.0	11,564.2	7,281.0	103.5	104.2	-122.18	-1,056.1	-3,916.8	413.1	237.7	175.46	2.355		
11,400.0	7,061.0	11,664.2	7,281.0	105.9	106.7	-122.17	-1,056.1	-4,016.8	413.1	233.5	179.62	2.300		
11,500.0	7,061.0	11,764.2	7,281.0	108.4	109.1	-122.17	-1,056.1	-4,116.8	413.2	229.4	183.78	2.248		
11,539.2	7,061.0	11,803.4	7,281.0	109.3	110.0	-122.17	-1,056.1	-4,156.0	413.2	227.7	185.42	2.228 SF		

## Anticollision Report

<b>Company:</b>	EnCana Oil & Gas (USA) Inc	<b>Local Co-ordinate Reference:</b>	Well Drieth 4F-6H-I368
<b>Project:</b>	DJ Wattenberg	<b>TVD Reference:</b>	WELL @ 5124.0ft (Original Well Elev)
<b>Reference Site:</b>	S6-T3N-R68W (Zisch/Drieth)	<b>MD Reference:</b>	WELL @ 5124.0ft (Original Well Elev)
<b>Site Error:</b>	0.0ft	<b>North Reference:</b>	True
<b>Reference Well:</b>	Drieth 4F-6H-I368	<b>Survey Calculation Method:</b>	Minimum Curvature
<b>Well Error:</b>	0.0ft	<b>Output errors are at</b>	2.00 sigma
<b>Reference Wellbore</b>	Hz	<b>Database:</b>	USA EDM 5000 Multi Users DB
<b>Reference Design:</b>	Plan #1	<b>Offset TVD Reference:</b>	Offset Datum

<b>Offset Design</b> S6-T3N-R68W (Zisch/Drieth) - Zisch 23-6-M368 - DD - Plan #1												<b>Offset Site Error:</b>	0.0 ft
Survey Program: 0-MWD												<b>Offset Well Error:</b>	0.0 ft
Reference		Offset		Semi Major Axis		Distance							
Measured Depth (ft)	Vertical Depth (ft)	Measured Depth (ft)	Vertical Depth (ft)	Reference (ft)	Offset (ft)	Highside Toolface (°)	Offset Wellbore Centre +N/-S (ft)	+E/-W (ft)	Between Centres (ft)	Between Ellipses (ft)	Total Uncertainty Axis	Separation Factor	Warning
9,600.0	7,061.0	7,484.7	7,061.0	62.3	39.7	90.00	-539.1	-2,624.0	440.2	351.0	89.17	4.937	
9,700.0	7,061.0	7,484.7	7,061.0	64.7	39.7	90.00	-539.1	-2,624.0	349.8	258.2	91.59	3.819	
9,800.0	7,061.0	7,484.7	7,061.0	67.1	39.7	90.00	-539.1	-2,624.0	266.3	172.3	94.01	2.832	
9,900.0	7,061.0	7,484.7	7,061.0	69.5	39.7	90.00	-539.1	-2,624.0	198.7	102.2	96.44	2.060	
10,000.0	7,061.0	7,484.7	7,061.0	71.9	39.7	90.00	-539.1	-2,624.0	167.4	68.6	98.87	1.694	
10,007.2	7,061.0	7,484.7	7,061.0	72.1	39.7	90.00	-539.1	-2,624.0	167.3	68.2	99.04	1.689 CC, ES, SF	
10,100.0	7,061.0	7,484.7	7,061.0	74.3	39.7	90.00	-539.1	-2,624.0	191.3	90.0	101.30	1.889	
10,200.0	7,061.0	7,484.7	7,061.0	76.7	39.7	90.00	-539.1	-2,624.0	255.3	151.6	103.74	2.461	
10,300.0	7,061.0	7,484.7	7,061.0	79.1	39.7	90.00	-539.1	-2,624.0	337.3	231.1	106.18	3.176	
10,400.0	7,061.0	7,484.7	7,061.0	81.6	39.7	90.00	-539.1	-2,624.0	427.0	318.4	108.62	3.931	

CC - Min centre to center distance or convergent point, SF - min separation factor, ES - min ellipse separation

## Anticollision Report

<b>Company:</b>	EnCana Oil & Gas (USA) Inc	<b>Local Co-ordinate Reference:</b>	Well Drieth 4F-6H-I368
<b>Project:</b>	DJ Wattenberg	<b>TVD Reference:</b>	WELL @ 5124.0ft (Original Well Elev)
<b>Reference Site:</b>	S6-T3N-R68W (Zisch/Drieth)	<b>MD Reference:</b>	WELL @ 5124.0ft (Original Well Elev)
<b>Site Error:</b>	0.0ft	<b>North Reference:</b>	True
<b>Reference Well:</b>	Drieth 4F-6H-I368	<b>Survey Calculation Method:</b>	Minimum Curvature
<b>Well Error:</b>	0.0ft	<b>Output errors are at</b>	2.00 sigma
<b>Reference Wellbore</b>	Hz	<b>Database:</b>	USA EDM 5000 Multi Users DB
<b>Reference Design:</b>	Plan #1	<b>Offset TVD Reference:</b>	Offset Datum

Reference Depths are relative to WELL @ 5124.0ft (Original Well Elev)

Offset Depths are relative to Offset Datum

Central Meridian is -105.500000 °

Coordinates are relative to: Drieth 4F-6H-I368

Coordinate System is US State Plane 1983, Colorado Northern Zone

Grid Convergence at Surface is: 0.30°

