

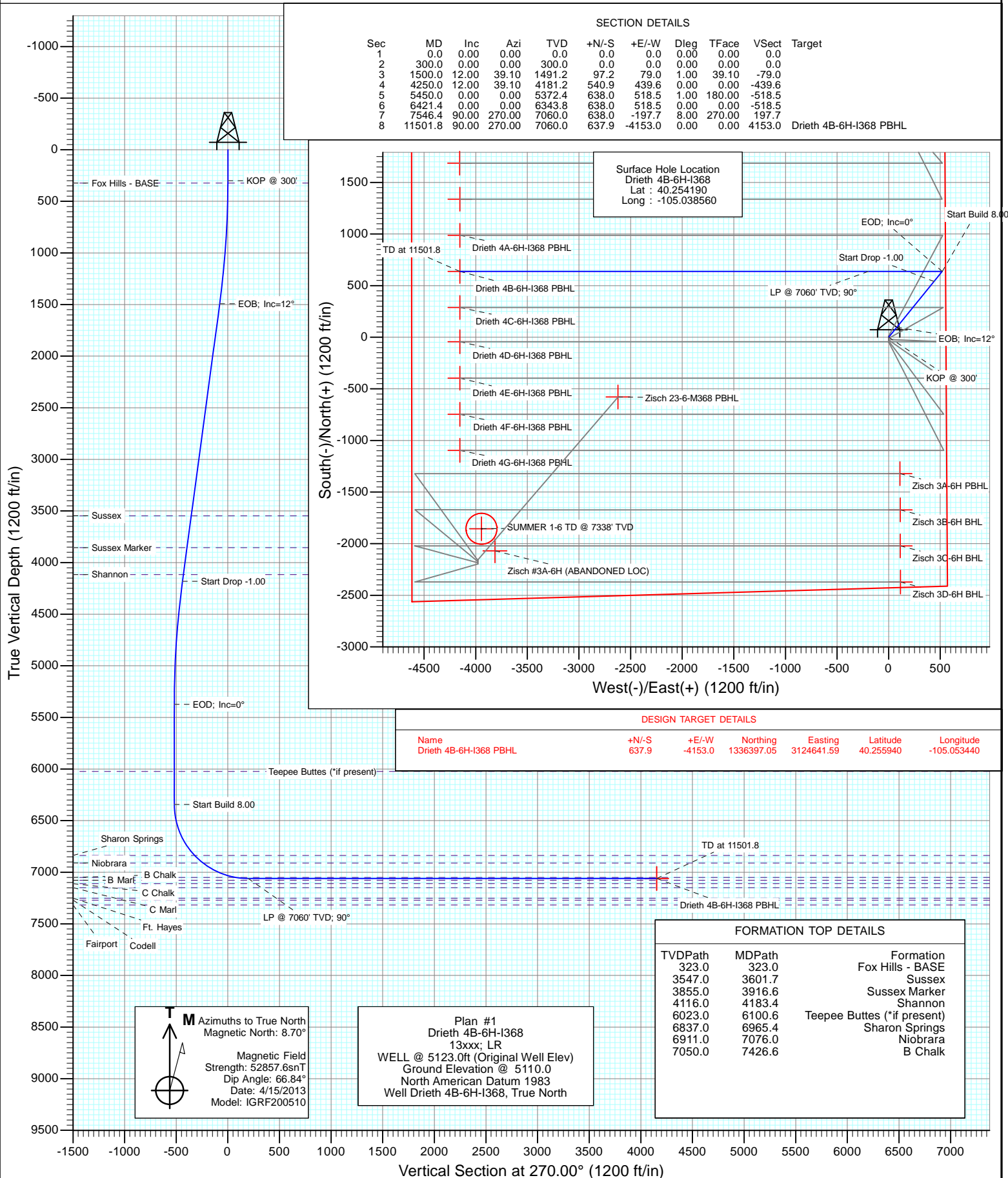

Project: DJ Wattenberg
Site: S6-T3N-R68W (Zisch/Drieth)
Well: Drieth 4B-6H-I368
Wellbore: Hz
Design: Plan #1



Planning Report

Database:	USA EDM 5000 Multi Users DB	Local Co-ordinate Reference:	Well Drieth 4B-6H-I368
Company:	EnCana Oil & Gas (USA) Inc	TVD Reference:	WELL @ 5123.0ft (Original Well Elev)
Project:	DJ Wattenberg	MD Reference:	WELL @ 5123.0ft (Original Well Elev)
Site:	S6-T3N-R68W (Zisch/Drieth)	North Reference:	True
Well:	Drieth 4B-6H-I368	Survey Calculation Method:	Minimum Curvature
Wellbore:	Hz		
Design:	Plan #1		

Project	DJ Wattenberg		
Map System:	US State Plane 1983	System Datum:	Mean Sea Level
Geo Datum:	North American Datum 1983		
Map Zone:	Colorado Northern Zone		

Site		S6-T3N-R68W (Zisch/Drieth)			
Site Position:		Northing:	1,333,692.14 ft	Latitude:	40.248510
From:	Lat/Long	Easting:	3,124,995.76 ft	Longitude:	-105.052220
Position Uncertainty:	0.0 ft	Slot Radius:	13.200 in	Grid Convergence:	0.29 °

Well	Drieth 4B-6H-I368					
Well Position	+N/-S	0.0 ft	Northing:	1,335,780.82 ft	Latitude:	40.254190
	+E/-W	0.0 ft	Easting:	3,128,797.90 ft	Longitude:	-105.038560
Position Uncertainty		0.0 ft	Wellhead Elevation:	ft	Ground Level:	5,110.0 ft

Wellbore	Hz				
Magnetics	Model Name	Sample Date	Declination (°)	Dip Angle (°)	Field Strength (nT)
	IGRF200510	4/15/2013	8.70	66.84	52,858

Design	Plan #1			
Audit Notes:				
Version:	Phase:	PLAN	Tie On Depth:	0.0
Vertical Section:	Depth From (TVD) (ft)	+N/-S (ft)	+E/-W (ft)	Direction (°)
	0.0	0.0	0.0	270.00

Plan Sections										
Measured Depth (ft)	Inclination (°)	Azimuth (°)	Vertical Depth (ft)	+N/-S (ft)	+E/-W (ft)	Dogleg Rate (°/100ft)	Build Rate (°/100ft)	Turn Rate (°/100ft)	TFO (°)	Target
0.0	0.00	0.00	0.0	0.0	0.0	0.00	0.00	0.00	0.00	
300.0	0.00	0.00	300.0	0.0	0.0	0.00	0.00	0.00	0.00	
1,500.0	12.00	39.10	1,491.2	97.2	79.0	1.00	1.00	0.00	39.10	
4,250.0	12.00	39.10	4,181.2	540.9	439.6	0.00	0.00	0.00	0.00	
5,450.0	0.00	0.00	5,372.4	638.0	518.5	1.00	-1.00	0.00	180.00	
6,421.4	0.00	0.00	6,343.8	638.0	518.5	0.00	0.00	0.00	0.00	
7,546.4	90.00	270.00	7,060.0	638.0	-197.7	8.00	8.00	0.00	270.00	
11,501.8	90.00	270.00	7,060.0	637.9	-4,153.0	0.00	0.00	0.00	0.00	Drieth 4B-6H-I368 PB

Planning Report

Database:	USA EDM 5000 Multi Users DB	Local Co-ordinate Reference:	Well Drieth 4B-6H-I368
Company:	EnCana Oil & Gas (USA) Inc	TVD Reference:	WELL @ 5123.0ft (Original Well Elev)
Project:	DJ Wattenberg	MD Reference:	WELL @ 5123.0ft (Original Well Elev)
Site:	S6-T3N-R68W (Zisch/Drieth)	North Reference:	True
Well:	Drieth 4B-6H-I368	Survey Calculation Method:	Minimum Curvature
Wellbore:	Hz		
Design:	Plan #1		

Planned Survey

Measured Depth (ft)	Inclination (°)	Azimuth (°)	Vertical Depth (ft)	+N/-S (ft)	+E/-W (ft)	Vertical Section (ft)	Dogleg Rate (°/100ft)	Build Rate (°/100ft)	Comments / Formations
0.0	0.00	0.00	0.0	0.0	0.0	0.0	0.00	0.00	
100.0	0.00	0.00	100.0	0.0	0.0	0.0	0.00	0.00	
200.0	0.00	0.00	200.0	0.0	0.0	0.0	0.00	0.00	
300.0	0.00	0.00	300.0	0.0	0.0	0.0	0.00	0.00	KOP @ 300'
323.0	0.23	39.10	323.0	0.0	0.0	0.0	1.00	1.00	Fox Hills - BASE
400.0	1.00	39.10	400.0	0.7	0.6	-0.6	1.00	1.00	
500.0	2.00	39.10	500.0	2.7	2.2	-2.2	1.00	1.00	
600.0	3.00	39.10	599.9	6.1	5.0	-5.0	1.00	1.00	
700.0	4.00	39.10	699.7	10.8	8.8	-8.8	1.00	1.00	
800.0	5.00	39.10	799.4	16.9	13.8	-13.8	1.00	1.00	
900.0	6.00	39.10	898.9	24.4	19.8	-19.8	1.00	1.00	
1,000.0	7.00	39.10	998.3	33.1	26.9	-26.9	1.00	1.00	
1,100.0	8.00	39.10	1,097.4	43.3	35.2	-35.2	1.00	1.00	
1,200.0	9.00	39.10	1,196.3	54.7	44.5	-44.5	1.00	1.00	
1,300.0	10.00	39.10	1,294.9	67.6	54.9	-54.9	1.00	1.00	
1,400.0	11.00	39.10	1,393.3	81.7	66.4	-66.4	1.00	1.00	
1,500.0	12.00	39.10	1,491.2	97.2	79.0	-79.0	1.00	1.00	EOB; Inc=12°
1,600.0	12.00	39.10	1,589.1	113.3	92.1	-92.1	0.00	0.00	
1,700.0	12.00	39.10	1,686.9	129.4	105.2	-105.2	0.00	0.00	
1,800.0	12.00	39.10	1,784.7	145.6	118.3	-118.3	0.00	0.00	
1,900.0	12.00	39.10	1,882.5	161.7	131.4	-131.4	0.00	0.00	
2,000.0	12.00	39.10	1,980.3	177.8	144.5	-144.5	0.00	0.00	
2,100.0	12.00	39.10	2,078.1	194.0	157.6	-157.6	0.00	0.00	
2,200.0	12.00	39.10	2,175.9	210.1	170.8	-170.8	0.00	0.00	
2,300.0	12.00	39.10	2,273.8	226.2	183.9	-183.9	0.00	0.00	
2,400.0	12.00	39.10	2,371.6	242.4	197.0	-197.0	0.00	0.00	
2,500.0	12.00	39.10	2,469.4	258.5	210.1	-210.1	0.00	0.00	
2,600.0	12.00	39.10	2,567.2	274.6	223.2	-223.2	0.00	0.00	
2,700.0	12.00	39.10	2,665.0	290.8	236.3	-236.3	0.00	0.00	
2,800.0	12.00	39.10	2,762.8	306.9	249.4	-249.4	0.00	0.00	
2,900.0	12.00	39.10	2,860.7	323.1	262.5	-262.5	0.00	0.00	
3,000.0	12.00	39.10	2,958.5	339.2	275.7	-275.7	0.00	0.00	
3,100.0	12.00	39.10	3,056.3	355.3	288.8	-288.8	0.00	0.00	
3,200.0	12.00	39.10	3,154.1	371.5	301.9	-301.9	0.00	0.00	
3,300.0	12.00	39.10	3,251.9	387.6	315.0	-315.0	0.00	0.00	
3,400.0	12.00	39.10	3,349.7	403.7	328.1	-328.1	0.00	0.00	
3,500.0	12.00	39.10	3,447.5	419.9	341.2	-341.2	0.00	0.00	
3,600.0	12.00	39.10	3,545.4	436.0	354.3	-354.3	0.00	0.00	
3,601.7	12.00	39.10	3,547.0	436.3	354.5	-354.5	0.00	0.00	Sussex
3,700.0	12.00	39.10	3,643.2	452.1	367.4	-367.4	0.00	0.00	
3,800.0	12.00	39.10	3,741.0	468.3	380.6	-380.6	0.00	0.00	
3,900.0	12.00	39.10	3,838.8	484.4	393.7	-393.7	0.00	0.00	
3,916.6	12.00	39.10	3,855.0	487.1	395.8	-395.8	0.00	0.00	Sussex Marker
4,000.0	12.00	39.10	3,936.6	500.5	406.8	-406.8	0.00	0.00	
4,100.0	12.00	39.10	4,034.4	516.7	419.9	-419.9	0.00	0.00	
4,183.4	12.00	39.10	4,116.0	530.1	430.8	-430.8	0.00	0.00	Shannon
4,200.0	12.00	39.10	4,132.2	532.8	433.0	-433.0	0.00	0.00	
4,250.0	12.00	39.10	4,181.2	540.9	439.6	-439.6	0.00	0.00	Start Drop -1.00
4,300.0	11.50	39.10	4,230.1	548.8	446.0	-446.0	1.00	-1.00	
4,400.0	10.50	39.10	4,328.3	563.6	458.0	-458.0	1.00	-1.00	
4,500.0	9.50	39.10	4,426.7	577.1	469.0	-469.0	1.00	-1.00	
4,600.0	8.50	39.10	4,525.5	589.2	478.8	-478.8	1.00	-1.00	

Planning Report

Database:	USA EDM 5000 Multi Users DB	Local Co-ordinate Reference:	Well Drieth 4B-6H-I368
Company:	EnCana Oil & Gas (USA) Inc	TVD Reference:	WELL @ 5123.0ft (Original Well Elev)
Project:	DJ Wattenberg	MD Reference:	WELL @ 5123.0ft (Original Well Elev)
Site:	S6-T3N-R68W (Zisch/Drieth)	North Reference:	True
Well:	Drieth 4B-6H-I368	Survey Calculation Method:	Minimum Curvature
Wellbore:	Hz		
Design:	Plan #1		

Planned Survey

Measured Depth (ft)	Inclination (°)	Azimuth (°)	Vertical Depth (ft)	+N/-S (ft)	+E/-W (ft)	Vertical Section (ft)	Dogleg Rate (°/100ft)	Build Rate (°/100ft)	Comments / Formations
4,700.0	7.50	39.10	4,624.5	600.0	487.6	-487.6	1.00	-1.00	
4,800.0	6.50	39.10	4,723.8	609.5	495.3	-495.3	1.00	-1.00	
4,900.0	5.50	39.10	4,823.2	617.6	501.9	-501.9	1.00	-1.00	
5,000.0	4.50	39.10	4,922.9	624.3	507.4	-507.4	1.00	-1.00	
5,100.0	3.50	39.10	5,022.6	629.7	511.8	-511.8	1.00	-1.00	
5,200.0	2.50	39.10	5,122.5	633.8	515.1	-515.1	1.00	-1.00	
5,300.0	1.50	39.10	5,222.4	636.5	517.3	-517.3	1.00	-1.00	
5,400.0	0.50	39.10	5,322.4	637.9	518.4	-518.4	1.00	-1.00	
5,450.0	0.00	0.00	5,372.4	638.0	518.5	-518.5	1.00	-1.00	EOD; Inc=0°
5,500.0	0.00	0.00	5,422.4	638.0	518.5	-518.5	0.00	0.00	
5,600.0	0.00	0.00	5,522.4	638.0	518.5	-518.5	0.00	0.00	
5,700.0	0.00	0.00	5,622.4	638.0	518.5	-518.5	0.00	0.00	
5,800.0	0.00	0.00	5,722.4	638.0	518.5	-518.5	0.00	0.00	
5,900.0	0.00	0.00	5,822.4	638.0	518.5	-518.5	0.00	0.00	
6,000.0	0.00	0.00	5,922.4	638.0	518.5	-518.5	0.00	0.00	
6,100.0	0.00	0.00	6,022.4	638.0	518.5	-518.5	0.00	0.00	
6,100.6	0.00	0.00	6,023.0	638.0	518.5	-518.5	0.00	0.00	Teepee Buttes (*if present)
6,200.0	0.00	0.00	6,122.4	638.0	518.5	-518.5	0.00	0.00	
6,300.0	0.00	0.00	6,222.4	638.0	518.5	-518.5	0.00	0.00	
6,400.0	0.00	0.00	6,322.4	638.0	518.5	-518.5	0.00	0.00	
6,421.4	0.00	0.00	6,343.8	638.0	518.5	-518.5	0.00	0.00	Start Build 8.00
6,500.0	6.29	270.00	6,422.2	638.0	514.2	-514.2	8.00	8.00	
6,600.0	14.29	270.00	6,520.6	638.0	496.4	-496.4	8.00	8.00	
6,700.0	22.29	270.00	6,615.4	638.0	465.0	-465.0	8.00	8.00	
6,800.0	30.29	270.00	6,705.0	638.0	420.8	-420.8	8.00	8.00	
6,900.0	38.29	270.00	6,787.6	638.0	364.5	-364.5	8.00	8.00	
6,965.4	43.52	270.00	6,837.0	638.0	321.6	-321.6	8.00	8.00	Sharon Springs
7,000.0	46.29	270.00	6,861.5	638.0	297.2	-297.2	8.00	8.00	
7,076.0	52.37	270.00	6,911.0	638.0	239.6	-239.6	8.00	8.00	Niobrara
7,100.0	54.29	270.00	6,925.3	638.0	220.4	-220.4	8.00	8.00	
7,200.0	62.29	270.00	6,977.8	638.0	135.4	-135.4	8.00	8.00	
7,300.0	70.29	270.00	7,018.0	638.0	43.9	-43.9	8.00	8.00	
7,400.0	78.29	270.00	7,045.1	638.0	-52.3	52.3	8.00	8.00	
7,426.6	80.41	270.00	7,050.0	638.0	-78.4	78.4	8.00	8.00	B Chalk
7,500.0	86.29	270.00	7,058.5	638.0	-151.3	151.3	8.00	8.00	
7,546.4	90.00	270.00	7,060.0	638.0	-197.7	197.7	8.00	8.00	LP @ 7060' TVD; 90°
7,600.0	90.00	270.00	7,060.0	638.0	-251.3	251.3	0.00	0.00	
7,700.0	90.00	270.00	7,060.0	638.0	-351.3	351.3	0.00	0.00	
7,800.0	90.00	270.00	7,060.0	638.0	-451.3	451.3	0.00	0.00	
7,900.0	90.00	270.00	7,060.0	638.0	-551.3	551.3	0.00	0.00	
8,000.0	90.00	270.00	7,060.0	638.0	-651.3	651.3	0.00	0.00	
8,100.0	90.00	270.00	7,060.0	638.0	-751.3	751.3	0.00	0.00	
8,200.0	90.00	270.00	7,060.0	638.0	-851.3	851.3	0.00	0.00	
8,300.0	90.00	270.00	7,060.0	638.0	-951.3	951.3	0.00	0.00	
8,400.0	90.00	270.00	7,060.0	638.0	-1,051.3	1,051.3	0.00	0.00	
8,500.0	90.00	270.00	7,060.0	638.0	-1,151.3	1,151.3	0.00	0.00	
8,600.0	90.00	270.00	7,060.0	638.0	-1,251.3	1,251.3	0.00	0.00	
8,700.0	90.00	270.00	7,060.0	638.0	-1,351.3	1,351.3	0.00	0.00	
8,800.0	90.00	270.00	7,060.0	638.0	-1,451.3	1,451.3	0.00	0.00	
8,900.0	90.00	270.00	7,060.0	638.0	-1,551.3	1,551.3	0.00	0.00	
9,000.0	90.00	270.00	7,060.0	638.0	-1,651.3	1,651.3	0.00	0.00	
9,100.0	90.00	270.00	7,060.0	638.0	-1,751.3	1,751.3	0.00	0.00	

Planning Report

Database:	USA EDM 5000 Multi Users DB	Local Co-ordinate Reference:	Well Drieth 4B-6H-I368
Company:	EnCana Oil & Gas (USA) Inc	TVD Reference:	WELL @ 5123.0ft (Original Well Elev)
Project:	DJ Wattenberg	MD Reference:	WELL @ 5123.0ft (Original Well Elev)
Site:	S6-T3N-R68W (Zisch/Drieth)	North Reference:	True
Well:	Drieth 4B-6H-I368	Survey Calculation Method:	Minimum Curvature
Wellbore:	Hz		
Design:	Plan #1		

Planned Survey									
Measured Depth (ft)	Inclination (°)	Azimuth (°)	Vertical Depth (ft)	+N/-S (ft)	+E/-W (ft)	Vertical Section (ft)	Dogleg Rate (°/100ft)	Build Rate (°/100ft)	Comments / Formations
9,200.0	90.00	270.00	7,060.0	637.9	-1,851.3	1,851.3	0.00	0.00	
9,300.0	90.00	270.00	7,060.0	637.9	-1,951.3	1,951.3	0.00	0.00	
9,400.0	90.00	270.00	7,060.0	637.9	-2,051.3	2,051.3	0.00	0.00	
9,500.0	90.00	270.00	7,060.0	637.9	-2,151.3	2,151.3	0.00	0.00	
9,600.0	90.00	270.00	7,060.0	637.9	-2,251.3	2,251.3	0.00	0.00	
9,700.0	90.00	270.00	7,060.0	637.9	-2,351.3	2,351.3	0.00	0.00	
9,800.0	90.00	270.00	7,060.0	637.9	-2,451.3	2,451.3	0.00	0.00	
9,900.0	90.00	270.00	7,060.0	637.9	-2,551.3	2,551.3	0.00	0.00	
10,000.0	90.00	270.00	7,060.0	637.9	-2,651.3	2,651.3	0.00	0.00	
10,100.0	90.00	270.00	7,060.0	637.9	-2,751.3	2,751.3	0.00	0.00	
10,200.0	90.00	270.00	7,060.0	637.9	-2,851.3	2,851.3	0.00	0.00	
10,300.0	90.00	270.00	7,060.0	637.9	-2,951.3	2,951.3	0.00	0.00	
10,400.0	90.00	270.00	7,060.0	637.9	-3,051.3	3,051.3	0.00	0.00	
10,500.0	90.00	270.00	7,060.0	637.9	-3,151.3	3,151.3	0.00	0.00	
10,600.0	90.00	270.00	7,060.0	637.9	-3,251.3	3,251.3	0.00	0.00	
10,700.0	90.00	270.00	7,060.0	637.9	-3,351.3	3,351.3	0.00	0.00	
10,800.0	90.00	270.00	7,060.0	637.9	-3,451.3	3,451.3	0.00	0.00	
10,900.0	90.00	270.00	7,060.0	637.9	-3,551.3	3,551.3	0.00	0.00	
11,000.0	90.00	270.00	7,060.0	637.9	-3,651.3	3,651.3	0.00	0.00	
11,100.0	90.00	270.00	7,060.0	637.9	-3,751.3	3,751.3	0.00	0.00	
11,200.0	90.00	270.00	7,060.0	637.9	-3,851.3	3,851.3	0.00	0.00	
11,300.0	90.00	270.00	7,060.0	637.9	-3,951.3	3,951.3	0.00	0.00	
11,400.0	90.00	270.00	7,060.0	637.9	-4,051.3	4,051.3	0.00	0.00	
11,500.0	90.00	270.00	7,060.0	637.9	-4,151.3	4,151.3	0.00	0.00	
11,501.8	90.00	270.00	7,060.0	637.9	-4,153.0	4,153.0	0.00	0.00	TD at 11501.8 - Drieth 4B-6H-I368 PBHL

Targets									
Target Name									
- hit/miss target	Dip Angle (°)	Dip Dir. (°)	TVD (ft)	+N/-S (ft)	+E/-W (ft)	Northing (ft)	Easting (ft)	Latitude	Longitude
- Shape									
Drieth 4B-6H-I368 PBHL	0.00	0.00	7,060.0	637.9	-4,153.0	1,336,397.05	3,124,641.59	40.255940	-105.053440
- plan hits target center									
- Point									

Formations						
Measured Depth (ft)	Vertical Depth (ft)	Name	Lithology	Dip (°)	Dip Direction (°)	
323.0	323.0	Fox Hills - BASE				
3,601.7	3,547.0	Sussex				
3,916.6	3,855.0	Sussex Marker				
4,183.4	4,116.0	Shannon				
6,100.6	6,023.0	Teepee Buttes (*if present)				
6,965.4	6,837.0	Sharon Springs				
7,076.0	6,911.0	Niobrara				
7,426.6	7,050.0	B Chalk				

Planning Report

Database:	USA EDM 5000 Multi Users DB	Local Co-ordinate Reference:	Well Drieth 4B-6H-I368
Company:	EnCana Oil & Gas (USA) Inc	TVD Reference:	WELL @ 5123.0ft (Original Well Elev)
Project:	DJ Wattenberg	MD Reference:	WELL @ 5123.0ft (Original Well Elev)
Site:	S6-T3N-R68W (Zisch/Drieth)	North Reference:	True
Well:	Drieth 4B-6H-I368	Survey Calculation Method:	Minimum Curvature
Wellbore:	Hz		
Design:	Plan #1		

Plan Annotations

Measured Depth (ft)	Vertical Depth (ft)	Local Coordinates		Comment
		+N/-S (ft)	+E/-W (ft)	
300.0	300.0	0.0	0.0	KOP @ 300'
1,500.0	1,491.2	97.2	79.0	EOB; Inc=12°
4,250.0	4,181.2	540.9	439.6	Start Drop -1.00
5,450.0	5,372.4	638.0	518.5	EOD; Inc=0°
6,421.4	6,343.8	638.0	518.5	Start Build 8.00
7,546.4	7,060.0	638.0	-197.7	LP @ 7060' TVD; 90°
11,501.8	7,060.0	637.9	-4,153.0	TD at 11501.8

EnCana Oil & Gas (USA) Inc

DJ Wattenberg

S6-T3N-R68W (Zisch/Drieth)

Drieth 4B-6H-I368

Hz

Plan #1

Anticollision Report

15 April, 2013

Anticollision Report

Company:	EnCana Oil & Gas (USA) Inc	Local Co-ordinate Reference:	Well Drieth 4B-6H-I368
Project:	DJ Wattenberg	TVD Reference:	WELL @ 5123.0ft (Original Well Elev)
Reference Site:	S6-T3N-R68W (Zisch/Drieth)	MD Reference:	WELL @ 5123.0ft (Original Well Elev)
Site Error:	0.0ft	North Reference:	True
Reference Well:	Drieth 4B-6H-I368	Survey Calculation Method:	Minimum Curvature
Well Error:	0.0ft	Output errors are at	2.00 sigma
Reference Wellbore	Hz	Database:	USA EDM 5000 Multi Users DB
Reference Design:	Plan #1	Offset TVD Reference:	Offset Datum

Reference	Plan #1		
Filter type:	NO GLOBAL FILTER: Using user defined selection & filtering criteria		
Interpolation Method:	MD Interval 100.0ft	Error Model:	Systematic Ellipse
Depth Range:	Unlimited	Scan Method:	Closest Approach 3D
Results Limited by:	Maximum center-center distance of 500.0ft	Error Surface:	Elliptical Conic
Warning Levels Evaluated at:	2.00 Sigma		

Survey Tool Program		Date	4/15/2013		
From (ft)	To (ft)	Survey (Wellbore)	Tool Name	Description	
0.0	11,501.8	Plan #1 (Hz)	MWD	Geolink MWD	

Summary						
Site Name	Reference Measured Depth (ft)	Offset Measured Depth (ft)	Distance Between Centres (ft)	Distance Between Ellipses (ft)	Separation Factor	Warning
Offset Well - Wellbore - Design						
S6-T3N-R68W (Zisch/Drieth)						
Breakneck Properties 21-6 - DD - Plan #1						Out of range
Drieth 1A-6H-A368 - Hz - Plan #1						Out of range
Drieth 1B-6H-A368 - Hz - Plan #1						Out of range
Drieth 1C-6H-A368 - Hz - Plan #1						Out of range
Drieth 1D-6H-A368 - Hz - Plan #1						Out of range
Drieth 1E-6H-A368 - Hz - Plan #1						Out of range
Drieth 4A-6H-I368 - Hz - Plan #1	200.0	200.0	10.9	10.3	16.742	CC, ES
Drieth 4A-6H-I368 - Hz - Plan #1	11,501.8	11,778.0	413.2	228.0	2.231	SF
Drieth 4C-6H-I368 - Hz - Plan #1	300.0	300.0	10.9	9.9	10.909	CC, ES
Drieth 4C-6H-I368 - Hz - Plan #1	11,501.8	11,702.3	413.2	227.9	2.230	SF
Drieth 4D-6H-I368 - Hz - Plan #1	300.0	300.0	22.0	21.0	21.995	CC, ES
Drieth 4D-6H-I368 - Hz - Plan #1	600.0	599.9	28.0	26.0	13.655	SF
Drieth 4E-6H-I368 - Hz - Plan #1	300.0	300.0	29.3	28.3	29.223	CC, ES
Drieth 4E-6H-I368 - Hz - Plan #1	600.0	599.1	37.2	35.2	18.106	SF
Drieth 4F-6H-I368 - Hz - Plan #1	266.3	267.3	40.2	39.3	45.335	CC
Drieth 4F-6H-I368 - Hz - Plan #1	300.0	301.0	40.2	39.2	40.026	ES
Drieth 4F-6H-I368 - Hz - Plan #1	600.0	598.7	52.5	50.4	25.510	SF
Drieth 4G-6H-I368 - Hz - Plan #1	166.3	167.3	51.1	50.5	95.120	CC
Drieth 4G-6H-I368 - Hz - Plan #1	200.0	201.0	51.1	50.4	78.040	ES
Drieth 4G-6H-I368 - Hz - Plan #1	700.0	694.9	81.2	78.8	33.594	SF
SUMMER 6-1 (EXISTING) - EXISTING - NO SURVEYS						Out of range
Zisch 23-6-M368 - DD - Plan #1						Out of range
Zisch 3A-6H-M368 - HZ - Plan #1						Out of range
Zisch 3B-6H-M368 - HZ - Plan #1						Out of range
Zisch 3C-6H-M368 - HZ - Plan #1						Out of range
Zisch 3D-6H-M368 - HZ - Plan #1						Out of range

Anticollision Report

Company:	EnCana Oil & Gas (USA) Inc	Local Co-ordinate Reference:	Well Drieth 4B-6H-I368
Project:	DJ Wattenberg	TVD Reference:	WELL @ 5123.0ft (Original Well Elev)
Reference Site:	S6-T3N-R68W (Zisch/Drieth)	MD Reference:	WELL @ 5123.0ft (Original Well Elev)
Site Error:	0.0ft	North Reference:	True
Reference Well:	Drieth 4B-6H-I368	Survey Calculation Method:	Minimum Curvature
Well Error:	0.0ft	Output errors are at	2.00 sigma
Reference Wellbore	Hz	Database:	USA EDM 5000 Multi Users DB
Reference Design:	Plan #1	Offset TVD Reference:	Offset Datum

Offset Design S6-T3N-R68W (Zisch/Drieth) - Drieth 4A-6H-I368 - Hz - Plan #1													Offset Site Error:	0.0 ft
Survey Program:		0-MWD										Offset Well Error:	0.0 ft	
Reference		Offset		Semi Major Axis			Distance							Warning
Measured Depth (ft)	Vertical Depth (ft)	Measured Depth (ft)	Vertical Depth (ft)	Reference (ft)	Offset (ft)	Highside Toolface (°)	Offset Wellbore Centre +N/-S (ft)	+E/-W (ft)	Between Centres (ft)	Between Ellipses (ft)	Total Uncertainty Axis	Separation Factor		
0.0	0.0	0.0	0.0	0.0	0.0	0.00	10.9	0.0	10.9					
100.0	100.0	100.0	100.0	0.2	0.2	0.00	10.9	0.0	10.9	10.6	0.30	35.986		
200.0	200.0	200.0	200.0	0.3	0.3	0.00	10.9	0.0	10.9	10.3	0.65	16.742 CC, ES		
300.0	300.0	299.8	299.8	0.5	0.5	2.01	11.7	0.4	11.7	10.7	1.00	11.677		
400.0	400.0	399.6	399.6	0.7	0.7	-34.40	14.0	1.6	13.4	12.0	1.35	9.891		
500.0	500.0	499.4	499.2	0.9	0.9	-33.42	17.8	3.7	15.2	13.5	1.70	8.927		
600.0	599.9	599.1	598.8	1.0	1.1	-33.63	23.2	6.6	17.2	15.1	2.06	8.350		
700.0	699.7	698.8	698.1	1.2	1.3	-34.67	30.0	10.3	19.3	16.9	2.42	7.984		
800.0	799.4	798.4	797.3	1.4	1.5	-36.26	38.4	14.8	21.6	18.8	2.80	7.740		
900.0	898.9	898.0	896.3	1.7	1.8	-38.20	48.4	20.1	24.1	21.0	3.19	7.569		
1,000.0	998.3	997.6	995.0	1.9	2.0	-40.36	59.8	26.2	26.8	23.2	3.61	7.441		
1,100.0	1,097.4	1,097.1	1,093.5	2.2	2.3	-42.63	72.7	33.1	29.8	25.7	4.06	7.333		
1,200.0	1,196.3	1,196.6	1,191.6	2.5	2.7	-44.93	87.1	40.9	32.9	28.4	4.55	7.235		
1,300.0	1,294.9	1,296.1	1,289.4	2.8	3.0	-47.22	103.0	49.4	36.3	31.2	5.09	7.138		
1,400.0	1,393.3	1,395.4	1,386.8	3.1	3.4	-49.45	120.4	58.7	40.0	34.3	5.69	7.039		
1,500.0	1,491.2	1,494.8	1,483.8	3.5	3.8	-51.60	139.3	68.8	44.0	37.6	6.34	6.938		
1,600.0	1,589.1	1,594.1	1,580.4	3.9	4.2	-52.86	159.7	79.7	48.8	41.7	7.01	6.956		
1,700.0	1,686.9	1,693.2	1,676.4	4.3	4.7	-52.66	181.4	91.4	54.8	47.2	7.64	7.172		
1,800.0	1,784.7	1,792.9	1,772.7	4.7	5.1	-51.89	204.2	103.6	61.6	53.4	8.25	7.468		
1,900.0	1,882.5	1,892.7	1,869.1	5.1	5.6	-51.27	226.9	115.8	68.4	59.5	8.86	7.722		
2,000.0	1,980.3	1,992.5	1,965.4	5.5	6.1	-50.76	249.7	128.0	75.2	65.7	9.47	7.942		
2,100.0	2,078.1	2,092.2	2,061.8	5.8	6.5	-50.34	272.5	140.2	82.0	71.9	10.08	8.134		
2,200.0	2,175.9	2,192.0	2,158.2	6.2	7.0	-49.98	295.2	152.4	88.8	78.1	10.70	8.303		
2,300.0	2,273.8	2,291.8	2,254.5	6.6	7.5	-49.68	318.0	164.6	95.7	84.4	11.32	8.453		
2,400.0	2,371.6	2,391.5	2,350.9	7.0	8.0	-49.41	340.7	176.8	102.5	90.6	11.94	8.587		
2,500.0	2,469.4	2,491.3	2,447.3	7.4	8.4	-49.18	363.5	189.0	109.3	96.8	12.56	8.707		
2,600.0	2,567.2	2,591.1	2,543.6	7.8	8.9	-48.98	386.2	201.2	116.1	103.0	13.18	8.815		
2,700.0	2,665.0	2,690.8	2,640.0	8.2	9.4	-48.79	409.0	213.4	123.0	109.2	13.80	8.913		
2,800.0	2,762.8	2,790.6	2,736.4	8.6	9.9	-48.63	431.8	225.6	129.8	115.4	14.42	9.003		
2,900.0	2,860.7	2,890.4	2,832.7	9.0	10.4	-48.48	454.5	237.8	136.6	121.6	15.04	9.084		
3,000.0	2,958.5	2,990.1	2,929.1	9.4	10.8	-48.35	477.3	250.0	143.5	127.8	15.66	9.159		
3,100.0	3,056.3	3,089.9	3,025.5	9.8	11.3	-48.23	500.0	262.2	150.3	134.0	16.29	9.228		
3,200.0	3,154.1	3,189.7	3,121.8	10.2	11.8	-48.12	522.8	274.5	157.1	140.2	16.91	9.292		
3,300.0	3,251.9	3,289.4	3,218.2	10.6	12.3	-48.02	545.5	286.7	164.0	146.4	17.53	9.351		
3,400.0	3,349.7	3,389.2	3,314.6	11.0	12.8	-47.93	568.3	298.9	170.8	152.6	18.16	9.406		
3,500.0	3,447.5	3,489.0	3,410.9	11.4	13.3	-47.84	591.0	311.1	177.6	158.8	18.78	9.457		
3,600.0	3,545.4	3,588.7	3,507.3	11.8	13.7	-47.76	613.8	323.3	184.5	165.1	19.41	9.505		
3,700.0	3,643.2	3,688.5	3,603.7	12.3	14.2	-47.69	636.6	335.5	191.3	171.3	20.03	9.549		
3,800.0	3,741.0	3,788.3	3,700.0	12.7	14.7	-47.62	659.3	347.7	198.1	177.5	20.66	9.591		
3,900.0	3,838.8	3,888.0	3,796.4	13.1	15.2	-47.55	682.1	359.9	205.0	183.7	21.28	9.630		
4,000.0	3,936.6	3,987.8	3,892.8	13.5	15.7	-47.49	704.8	372.1	211.8	189.9	21.91	9.667		
4,100.0	4,034.4	4,087.6	3,989.1	13.9	16.2	-47.44	727.6	384.3	218.6	196.1	22.54	9.702		
4,200.0	4,132.2	4,187.3	4,085.5	14.3	16.6	-47.38	750.3	396.5	225.5	202.3	23.16	9.735		
4,300.0	4,230.1	4,287.1	4,181.9	14.7	17.1	-47.32	773.1	408.7	232.5	208.7	23.78	9.777		
4,400.0	4,328.3	4,386.8	4,278.1	15.0	17.6	-47.03	795.8	420.9	240.5	216.2	24.30	9.897		
4,500.0	4,426.7	4,486.8	4,374.7	15.4	18.1	-46.47	818.6	433.1	249.7	225.0	24.72	10.102		
4,600.0	4,525.5	4,590.0	4,474.8	15.7	18.6	-45.81	841.2	445.2	259.2	234.2	25.07	10.340		
4,700.0	4,624.5	4,693.4	4,575.4	16.0	19.0	-45.14	862.2	456.4	268.5	243.2	25.38	10.580		
4,800.0	4,723.8	4,797.1	4,676.7	16.2	19.4	-44.47	881.6	466.8	277.6	252.0	25.65	10.822		
4,900.0	4,823.2	4,900.9	4,778.5	16.5	19.8	-43.80	899.4	476.4	286.5	260.6	25.89	11.068		
5,000.0	4,922.9	5,004.9	4,880.9	16.7	20.2	-43.12	915.7	485.1	295.2	269.1	26.08	11.318		
5,100.0	5,022.6	5,109.1	4,983.7	16.8	20.5	-42.43	930.3	492.9	303.6	277.4	26.24	11.571		

CC - Min centre to center distance or convergent point, SF - min separation factor, ES - min ellipse separation

Anticollision Report

Company:	EnCana Oil & Gas (USA) Inc	Local Co-ordinate Reference:	Well Drieth 4B-6H-I368
Project:	DJ Wattenberg	TVD Reference:	WELL @ 5123.0ft (Original Well Elev)
Reference Site:	S6-T3N-R68W (Zisch/Drieth)	MD Reference:	WELL @ 5123.0ft (Original Well Elev)
Site Error:	0.0ft	North Reference:	True
Reference Well:	Drieth 4B-6H-I368	Survey Calculation Method:	Minimum Curvature
Well Error:	0.0ft	Output errors are at	2.00 sigma
Reference Wellbore	Hz	Database:	USA EDM 5000 Multi Users DB
Reference Design:	Plan #1	Offset TVD Reference:	Offset Datum

Offset Design S6-T3N-R68W (Zisch/Drieth) - Drieth 4A-6H-I368 - Hz - Plan #1													Offset Site Error:	0.0 ft
Survey Program: O-MWD													Offset Well Error:	0.0 ft
Reference		Offset		Semi Major Axis		Distance		Total		Separation		Warning		
Measured Depth (ft)	Vertical Depth (ft)	Measured Depth (ft)	Vertical Depth (ft)	Reference (ft)	Offset (ft)	Highside Toolface (°)	Offset Wellbore Centre +N/-S (ft)	+E/-W (ft)	Between Centres (ft)	Between Ellipses (ft)	Uncertainty Axis			
5,200.0	5,122.5	5,213.5	5,087.1	17.0	20.8	-41.74	943.3	499.9	311.8	285.5	26.36	11.829		
5,300.0	5,222.4	5,318.1	5,190.8	17.1	21.0	-41.04	954.6	506.0	319.9	293.4	26.45	12.091		
5,400.0	5,322.4	5,422.8	5,295.0	17.2	21.3	-40.34	964.3	511.2	327.7	301.1	26.52	12.356		
5,500.0	5,422.4	5,527.8	5,399.6	17.3	21.5	-0.52	972.3	515.5	335.1	301.0	34.08	9.833		
5,600.0	5,522.4	5,633.0	5,504.6	17.4	21.7	0.06	978.7	518.9	341.1	306.6	34.52	9.882		
5,700.0	5,622.4	5,738.5	5,609.9	17.5	21.8	0.48	983.3	521.4	345.5	310.6	34.89	9.904		
5,800.0	5,722.4	5,844.1	5,715.4	17.6	21.9	0.73	986.3	523.0	348.3	313.1	35.20	9.897		
5,900.0	5,822.4	5,949.8	5,821.1	17.7	22.0	0.84	987.5	523.6	349.5	314.1	35.44	9.861		
6,000.0	5,922.4	6,051.0	5,922.4	17.8	22.1	0.84	987.6	523.7	349.6	313.9	35.65	9.804		
6,100.0	6,022.4	6,151.0	6,022.4	17.9	22.2	0.84	987.6	523.7	349.6	313.7	35.86	9.747		
6,200.0	6,122.4	6,251.0	6,122.4	18.0	22.3	0.84	987.6	523.7	349.6	313.5	36.08	9.690		
6,300.0	6,222.4	6,351.0	6,222.4	18.1	22.4	0.84	987.6	523.7	349.6	313.3	36.29	9.632		
6,400.0	6,322.4	6,451.0	6,322.4	18.3	22.5	0.84	987.6	523.7	349.6	313.1	36.51	9.575		
6,409.5	6,331.9	6,460.5	6,331.9	18.3	22.5	90.85	987.6	523.7	349.6	320.9	28.61	12.218		
6,500.0	6,422.2	6,550.9	6,422.2	18.3	22.6	91.54	987.6	523.7	349.6	321.1	28.58	12.235		
6,600.0	6,520.6	6,649.2	6,520.6	18.2	22.6	94.33	987.6	523.7	350.6	322.8	27.81	12.608		
6,700.0	6,615.4	6,748.6	6,619.9	18.1	22.7	98.77	987.6	521.5	354.1	327.5	26.55	13.335		
6,800.0	6,705.0	6,854.5	6,724.5	17.8	22.7	103.35	987.6	505.4	360.2	334.8	25.34	14.211		
6,900.0	6,787.6	6,966.0	6,830.8	17.5	22.5	107.65	987.6	472.0	368.2	343.9	24.39	15.099		
7,000.0	6,861.5	7,083.6	6,935.8	17.2	22.3	111.57	987.6	419.5	377.7	353.9	23.77	15.888		
7,100.0	6,925.3	7,207.5	7,035.6	17.0	22.0	115.01	987.6	346.3	387.5	364.0	23.54	16.464		
7,200.0	6,977.8	7,337.7	7,125.3	16.9	21.7	117.86	987.6	252.1	396.9	373.1	23.76	16.706		
7,300.0	7,018.0	7,473.7	7,199.1	17.0	21.6	120.05	987.6	138.1	404.8	380.3	24.52	16.510		
7,400.0	7,045.1	7,614.4	7,251.4	17.3	21.7	121.50	987.6	7.8	410.3	384.4	25.87	15.859		
7,500.0	7,058.5	7,757.9	7,277.5	18.0	22.2	122.16	987.6	-133.0	412.9	385.0	27.89	14.806		
7,600.0	7,060.0	7,876.2	7,280.0	19.2	23.0	122.19	987.6	-251.3	413.0	382.6	30.44	13.568		
7,700.0	7,060.0	7,976.2	7,280.0	20.7	24.0	122.19	987.6	-351.3	413.0	379.7	33.36	12.379		
7,800.0	7,060.0	8,076.2	7,280.0	22.4	25.3	122.18	987.6	-451.3	413.0	376.5	36.53	11.305		
7,900.0	7,060.0	8,176.2	7,280.0	24.3	26.9	122.18	987.6	-551.3	413.0	373.1	39.89	10.354		
8,000.0	7,060.0	8,276.2	7,280.0	26.3	28.6	122.18	987.6	-651.3	413.0	369.6	43.40	9.517		
8,100.0	7,060.0	8,376.2	7,280.0	28.3	30.4	122.18	987.6	-751.3	413.0	366.0	47.02	8.785		
8,200.0	7,060.0	8,476.2	7,280.0	30.4	32.4	122.18	987.6	-851.3	413.0	362.3	50.72	8.143		
8,300.0	7,060.0	8,576.2	7,280.0	32.6	34.4	122.18	987.6	-951.3	413.0	358.5	54.50	7.579		
8,400.0	7,060.0	8,676.2	7,280.0	34.8	36.5	122.18	987.6	-1,051.3	413.0	354.7	58.33	7.081		
8,500.0	7,060.0	8,776.2	7,280.0	37.1	38.7	122.18	987.6	-1,151.3	413.1	350.8	62.22	6.639		
8,600.0	7,060.0	8,876.2	7,280.0	39.3	40.8	122.18	987.6	-1,251.3	413.1	346.9	66.14	6.246		
8,700.0	7,060.0	8,976.2	7,280.0	41.6	43.1	122.18	987.6	-1,351.3	413.1	343.0	70.09	5.894		
8,800.0	7,060.0	9,076.2	7,280.0	44.0	45.3	122.18	987.6	-1,451.3	413.1	339.0	74.06	5.577		
8,900.0	7,060.0	9,176.2	7,280.0	46.3	47.6	122.18	987.6	-1,551.3	413.1	335.0	78.07	5.291		
9,000.0	7,060.0	9,276.2	7,280.0	48.6	49.9	122.18	987.6	-1,651.3	413.1	331.0	82.09	5.032		
9,100.0	7,060.0	9,376.2	7,280.0	51.0	52.2	122.18	987.6	-1,751.3	413.1	327.0	86.12	4.796		
9,200.0	7,060.0	9,476.2	7,280.0	53.3	54.5	122.18	987.6	-1,851.3	413.1	322.9	90.17	4.581		
9,300.0	7,060.0	9,576.2	7,280.0	55.7	56.8	122.18	987.6	-1,951.3	413.1	318.8	94.24	4.383		
9,400.0	7,060.0	9,676.2	7,280.0	58.1	59.2	122.18	987.6	-2,051.3	413.1	314.8	98.31	4.202		
9,500.0	7,060.0	9,776.2	7,280.0	60.5	61.5	122.18	987.6	-2,151.3	413.1	310.7	102.39	4.034		
9,600.0	7,060.0	9,876.2	7,280.0	62.9	63.9	122.18	987.6	-2,251.3	413.1	306.6	106.49	3.879		
9,700.0	7,060.0	9,976.2	7,280.0	65.3	66.3	122.18	987.6	-2,351.3	413.1	302.5	110.59	3.735		
9,800.0	7,060.0	10,076.2	7,280.0	67.7	68.6	122.18	987.6	-2,451.3	413.1	298.4	114.70	3.602		
9,900.0	7,060.0	10,176.2	7,280.0	70.1	71.0	122.18	987.6	-2,551.3	413.1	294.3	118.81	3.477		
10,000.0	7,060.0	10,276.2	7,280.0	72.5	73.4	122.18	987.6	-2,651.3	413.1	290.2	122.93	3.361		
10,100.0	7,060.0	10,376.2	7,280.0	75.0	75.8	122.18	987.6	-2,751.3	413.1	286.1	127.05	3.252		
10,200.0	7,060.0	10,476.2	7,280.0	77.4	78.2	122.18	987.6	-2,851.3	413.1	281.9	131.18	3.149		

CC - Min centre to center distance or convergent point, SF - min separation factor, ES - min ellipse separation

Anticollision Report

Company:	EnCana Oil & Gas (USA) Inc	Local Co-ordinate Reference:	Well Drieth 4B-6H-I368
Project:	DJ Wattenberg	TVD Reference:	WELL @ 5123.0ft (Original Well Elev)
Reference Site:	S6-T3N-R68W (Zisch/Drieth)	MD Reference:	WELL @ 5123.0ft (Original Well Elev)
Site Error:	0.0ft	North Reference:	True
Reference Well:	Drieth 4B-6H-I368	Survey Calculation Method:	Minimum Curvature
Well Error:	0.0ft	Output errors are at	2.00 sigma
Reference Wellbore	Hz	Database:	USA EDM 5000 Multi Users DB
Reference Design:	Plan #1	Offset TVD Reference:	Offset Datum

Offset Design S6-T3N-R68W (Zisch/Drieth) - Drieth 4A-6H-I368 - Hz - Plan #1													Offset Site Error:	0.0 ft
Survey Program: 0-MWD													Offset Well Error:	0.0 ft
Reference		Offset		Semi Major Axis			Distance						Warning	
Measured Depth (ft)	Vertical Depth (ft)	Measured Depth (ft)	Vertical Depth (ft)	Reference (ft)	Offset (ft)	Highside Toolface (°)	Offset Wellbore Centre +N/-S (ft)	+E/-W (ft)	Between Centres (ft)	Between Ellipses (ft)	Total Uncertainty Axis	Separation Factor		
10,300.0	7,060.0	10,576.2	7,280.0	79.8	80.6	122.18	987.6	-2,951.3	413.1	277.8	135.31	3.053		
10,400.0	7,060.0	10,676.2	7,280.0	82.2	83.0	122.18	987.6	-3,051.3	413.1	273.7	139.45	2.963		
10,500.0	7,060.0	10,776.2	7,280.0	84.7	85.5	122.18	987.6	-3,151.3	413.1	269.5	143.59	2.877		
10,600.0	7,060.0	10,876.2	7,280.0	87.1	87.9	122.18	987.6	-3,251.3	413.1	265.4	147.73	2.797		
10,700.0	7,060.0	10,976.2	7,280.0	89.5	90.3	122.18	987.6	-3,351.3	413.1	261.3	151.88	2.720		
10,800.0	7,060.0	11,076.2	7,280.0	92.0	92.7	122.18	987.6	-3,451.3	413.1	257.1	156.02	2.648		
10,900.0	7,060.0	11,176.2	7,280.0	94.4	95.1	122.18	987.6	-3,551.3	413.1	253.0	160.17	2.579		
11,000.0	7,060.0	11,276.2	7,280.0	96.9	97.6	122.17	987.6	-3,651.3	413.1	248.8	164.33	2.514		
11,100.0	7,060.0	11,376.2	7,280.0	99.3	100.0	122.17	987.6	-3,751.3	413.1	244.7	168.48	2.452		
11,200.0	7,060.0	11,476.2	7,280.0	101.7	102.4	122.17	987.6	-3,851.3	413.1	240.5	172.64	2.393		
11,300.0	7,060.0	11,576.2	7,280.0	104.2	104.9	122.17	987.6	-3,951.3	413.2	236.4	176.80	2.337		
11,400.0	7,060.0	11,676.2	7,280.0	106.6	107.3	122.17	987.6	-4,051.3	413.2	232.2	180.96	2.283		
11,500.0	7,060.0	11,776.2	7,280.0	109.1	109.7	122.17	987.6	-4,151.3	413.2	228.0	185.12	2.232		
11,501.8	7,060.0	11,778.0	7,280.0	109.1	109.8	122.17	987.6	-4,153.0	413.2	228.0	185.19	2.231 SF		

Anticollision Report

Company:	EnCana Oil & Gas (USA) Inc	Local Co-ordinate Reference:	Well Drieth 4B-6H-I368
Project:	DJ Wattenberg	TVD Reference:	WELL @ 5123.0ft (Original Well Elev)
Reference Site:	S6-T3N-R68W (Zisch/Drieth)	MD Reference:	WELL @ 5123.0ft (Original Well Elev)
Site Error:	0.0ft	North Reference:	True
Reference Well:	Drieth 4B-6H-I368	Survey Calculation Method:	Minimum Curvature
Well Error:	0.0ft	Output errors are at	2.00 sigma
Reference Wellbore	Hz	Database:	USA EDM 5000 Multi Users DB
Reference Design:	Plan #1	Offset TVD Reference:	Offset Datum

Offset Design S6-T3N-R68W (Zisch/Drieth) - Drieth 4C-6H-I368 - Hz - Plan #1													Offset Site Error:	0.0 ft
Survey Program: 0-MWD													Offset Well Error:	0.0 ft
Reference		Offset		Semi Major Axis		Distance		Total		Separation		Warning		
Measured Depth (ft)	Vertical Depth (ft)	Measured Depth (ft)	Vertical Depth (ft)	Reference (ft)	Offset (ft)	Highside Toolface (°)	Offset Wellbore Centre +N/-S (ft)	+E/-W (ft)	Between Centres (ft)	Between Ellipses (ft)	Uncertainty Axis	Factor		
0.0	0.0	0.0	0.0	0.0	0.0	180.00	-10.9	0.0	10.9					
100.0	100.0	100.0	100.0	0.2	0.2	180.00	-10.9	0.0	10.9	10.6	0.30	35.986		
200.0	200.0	200.0	200.0	0.3	0.3	180.00	-10.9	0.0	10.9	10.3	0.65	16.742		
300.0	300.0	300.0	300.0	0.5	0.5	180.00	-10.9	0.0	10.9	9.9	1.00	10.909 CC, ES		
400.0	400.0	400.0	400.0	0.7	0.7	143.61	-10.9	0.0	11.6	10.3	1.35	8.600		
500.0	500.0	500.1	500.1	0.9	0.9	147.12	-10.5	0.8	13.3	11.6	1.70	7.808		
600.0	599.9	600.2	600.2	1.0	1.0	148.00	-9.2	3.0	15.4	13.4	2.06	7.502		
700.0	699.7	700.4	700.2	1.2	1.2	147.13	-7.1	6.9	18.0	15.6	2.42	7.445		
800.0	799.4	800.5	800.2	1.4	1.4	145.20	-4.0	12.2	21.0	18.2	2.79	7.531		
900.0	898.9	900.7	900.0	1.7	1.6	142.71	-0.2	19.0	24.6	21.4	3.19	7.700		
1,000.0	998.3	1,000.8	999.7	1.9	1.8	140.00	4.6	27.4	28.6	25.0	3.62	7.913		
1,100.0	1,097.4	1,100.9	1,099.2	2.2	2.1	137.28	10.2	37.3	33.2	29.1	4.08	8.145		
1,200.0	1,196.3	1,201.0	1,198.4	2.5	2.3	134.66	16.6	48.7	38.4	33.8	4.59	8.377		
1,300.0	1,294.9	1,301.1	1,297.4	2.8	2.6	132.22	23.9	61.5	44.2	39.1	5.15	8.596		
1,400.0	1,393.3	1,401.2	1,396.1	3.1	3.0	129.97	32.0	75.9	50.6	44.9	5.76	8.798		
1,500.0	1,491.2	1,500.9	1,494.3	3.5	3.3	128.76	40.6	91.0	58.0	51.6	6.39	9.072		
1,600.0	1,589.1	1,600.6	1,592.5	3.9	3.6	128.47	49.1	106.1	65.8	58.8	7.02	9.375		
1,700.0	1,686.9	1,700.3	1,690.7	4.3	3.9	128.25	57.6	121.1	73.7	66.0	7.66	9.616		
1,800.0	1,784.7	1,800.0	1,788.8	4.7	4.3	128.06	66.1	136.2	81.5	73.2	8.31	9.813		
1,900.0	1,882.5	1,899.7	1,887.0	5.1	4.6	127.91	74.7	151.3	89.4	80.4	8.96	9.975		
2,000.0	1,980.3	1,999.4	1,985.2	5.5	4.9	127.78	83.2	166.3	97.3	87.6	9.62	10.111		
2,100.0	2,078.1	2,099.1	2,083.4	5.8	5.3	127.67	91.7	181.4	105.1	94.8	10.28	10.225		
2,200.0	2,175.9	2,198.7	2,181.5	6.2	5.6	127.58	100.2	196.5	113.0	102.0	10.94	10.324		
2,300.0	2,273.8	2,298.4	2,279.7	6.6	6.0	127.50	108.8	211.5	120.8	109.2	11.61	10.409		
2,400.0	2,371.6	2,398.1	2,377.9	7.0	6.3	127.43	117.3	226.6	128.7	116.4	12.28	10.483		
2,500.0	2,469.4	2,497.8	2,476.1	7.4	6.7	127.37	125.8	241.7	136.6	123.6	12.95	10.548		
2,600.0	2,567.2	2,597.5	2,574.2	7.8	7.0	127.31	134.3	256.7	144.4	130.8	13.62	10.606		
2,700.0	2,665.0	2,697.2	2,672.4	8.2	7.3	127.26	142.9	271.8	152.3	138.0	14.29	10.657		
2,800.0	2,762.8	2,796.9	2,770.6	8.6	7.7	127.22	151.4	286.9	160.2	145.2	14.97	10.703		
2,900.0	2,860.7	2,896.6	2,868.8	9.0	8.0	127.17	159.9	301.9	168.0	152.4	15.64	10.744		
3,000.0	2,958.5	2,996.3	2,966.9	9.4	8.4	127.14	168.4	317.0	175.9	159.6	16.31	10.782		
3,100.0	3,056.3	3,096.0	3,065.1	9.8	8.7	127.10	177.0	332.1	183.8	166.8	16.99	10.816		
3,200.0	3,154.1	3,195.6	3,163.3	10.2	9.1	127.07	185.5	347.1	191.6	174.0	17.67	10.847		
3,300.0	3,251.9	3,295.3	3,261.5	10.6	9.4	127.04	194.0	362.2	199.5	181.2	18.34	10.875		
3,400.0	3,349.7	3,395.0	3,359.6	11.0	9.8	127.02	202.5	377.3	207.4	188.3	19.02	10.901		
3,500.0	3,447.5	3,494.7	3,457.8	11.4	10.1	126.99	211.1	392.3	215.2	195.5	19.70	10.925		
3,600.0	3,545.4	3,594.4	3,556.0	11.8	10.5	126.97	219.6	407.4	223.1	202.7	20.38	10.948		
3,700.0	3,643.2	3,694.1	3,654.2	12.3	10.8	126.95	228.1	422.5	231.0	209.9	21.06	10.968		
3,800.0	3,741.0	3,793.8	3,752.4	12.7	11.2	126.93	236.6	437.5	238.8	217.1	21.74	10.987		
3,900.0	3,838.8	3,893.5	3,850.5	13.1	11.5	126.91	245.1	452.6	246.7	224.3	22.42	11.005		
4,000.0	3,936.6	3,992.0	3,947.7	13.5	11.8	127.07	253.2	466.8	254.8	231.7	23.04	11.056		
4,100.0	4,034.4	4,090.3	4,044.9	13.9	12.1	127.57	260.4	479.5	263.4	239.8	23.60	11.159		
4,200.0	4,132.2	4,188.5	4,142.3	14.3	12.4	128.39	266.7	490.7	272.5	248.4	24.08	11.313		
4,300.0	4,230.1	4,286.5	4,239.6	14.7	12.7	129.47	272.2	500.5	282.0	257.5	24.49	11.515		
4,400.0	4,328.3	4,384.3	4,336.9	15.0	12.9	130.61	276.9	508.8	291.2	266.4	24.84	11.725		
4,500.0	4,426.7	4,482.0	4,434.3	15.4	13.1	131.73	280.8	515.7	300.0	274.9	25.14	11.935		
4,600.0	4,525.5	4,579.7	4,531.8	15.7	13.3	132.84	283.9	521.1	308.3	282.9	25.38	12.145		
4,700.0	4,624.5	4,677.2	4,629.2	16.0	13.4	133.94	286.1	525.0	316.2	290.6	25.58	12.357		
4,800.0	4,723.8	4,774.6	4,726.5	16.2	13.5	135.04	287.5	527.5	323.6	297.8	25.74	12.571		
4,900.0	4,823.2	4,871.8	4,823.8	16.5	13.7	136.14	288.1	528.6	330.5	304.7	25.85	12.786		
5,000.0	4,922.9	4,970.9	4,922.9	16.7	13.8	137.20	288.1	528.6	336.9	310.9	25.95	12.982		
5,100.0	5,022.6	5,070.7	5,022.6	16.8	13.9	138.03	288.1	528.6	342.0	315.9	26.07	13.118		

CC - Min centre to center distance or convergent point, SF - min separation factor, ES - min ellipse separation

Anticollision Report

Company:	EnCana Oil & Gas (USA) Inc	Local Co-ordinate Reference:	Well Drieth 4B-6H-I368
Project:	DJ Wattenberg	TVD Reference:	WELL @ 5123.0ft (Original Well Elev)
Reference Site:	S6-T3N-R68W (Zisch/Drieth)	MD Reference:	WELL @ 5123.0ft (Original Well Elev)
Site Error:	0.0ft	North Reference:	True
Reference Well:	Drieth 4B-6H-I368	Survey Calculation Method:	Minimum Curvature
Well Error:	0.0ft	Output errors are at	2.00 sigma
Reference Wellbore	Hz	Database:	USA EDM 5000 Multi Users DB
Reference Design:	Plan #1	Offset TVD Reference:	Offset Datum

Offset Design S6-T3N-R68W (Zisch/Drieth) - Drieth 4C-6H-I368 - Hz - Plan #1													Offset Site Error:	0.0 ft
Survey Program: 0-MWD													Offset Well Error:	0.0 ft
Reference		Offset		Semi Major Axis		Distance		Total		Separation		Warning		
Measured Depth (ft)	Vertical Depth (ft)	Measured Depth (ft)	Vertical Depth (ft)	Reference (ft)	Offset (ft)	Highside Toolface (°)	Offset Wellbore Centre +N/-S (ft)	+E/-W (ft)	Between Centres (ft)	Between Ellipses (ft)	Uncertainty Axis			
5,200.0	5,122.5	5,170.5	5,122.5	17.0	14.0	138.63	288.1	528.6	345.9	319.7	26.23	13.191		
5,300.0	5,222.4	5,270.5	5,222.4	17.1	14.1	139.03	288.1	528.6	348.6	322.2	26.40	13.201		
5,400.0	5,322.4	5,370.4	5,322.4	17.2	14.2	139.22	288.1	528.6	349.9	323.3	26.61	13.149		
5,500.0	5,422.4	5,470.4	5,422.4	17.3	14.3	178.35	288.1	528.6	350.0	324.8	25.28	13.849		
5,600.0	5,522.4	5,570.4	5,522.4	17.4	14.4	178.35	288.1	528.6	350.0	324.5	25.55	13.703		
5,700.0	5,622.4	5,670.4	5,622.4	17.5	14.6	178.35	288.1	528.6	350.0	324.2	25.82	13.558		
5,800.0	5,722.4	5,770.4	5,722.4	17.6	14.7	178.35	288.1	528.6	350.0	324.0	26.09	13.416		
5,900.0	5,822.4	5,870.4	5,822.4	17.7	14.8	178.35	288.1	528.6	350.0	323.7	26.37	13.275		
6,000.0	5,922.4	5,970.4	5,922.4	17.8	14.9	178.35	288.1	528.6	350.0	323.4	26.65	13.137		
6,100.0	6,022.4	6,070.4	6,022.4	17.9	15.0	178.35	288.1	528.6	350.0	323.1	26.92	13.001		
6,200.0	6,122.4	6,170.4	6,122.4	18.0	15.2	178.35	288.1	528.6	350.0	322.8	27.20	12.867		
6,300.0	6,222.4	6,270.4	6,222.4	18.1	15.3	178.35	288.1	528.6	350.0	322.6	27.49	12.735		
6,400.0	6,322.4	6,370.4	6,322.4	18.3	15.4	178.35	288.1	528.6	350.0	322.3	27.77	12.605		
6,500.0	6,422.2	6,470.3	6,422.2	18.3	15.5	-92.34	288.1	528.6	350.2	320.7	29.48	11.878		
6,600.0	6,520.6	6,568.6	6,520.6	18.2	15.7	-95.10	288.1	528.6	351.4	321.4	29.96	11.726		
6,700.0	6,615.4	6,668.4	6,620.3	18.1	15.7	-99.51	288.1	526.4	355.3	324.9	30.39	11.689		
6,800.0	6,705.0	6,775.2	6,725.7	17.8	15.7	-104.05	288.1	510.1	361.7	331.4	30.31	11.932		
6,900.0	6,787.6	6,887.6	6,832.8	17.5	15.5	-108.30	288.1	476.2	370.1	340.4	29.67	12.472		
7,000.0	6,861.5	7,006.2	6,938.5	17.2	15.1	-112.15	288.1	422.7	379.6	351.1	28.56	13.290		
7,100.0	6,925.3	7,131.2	7,038.8	17.0	14.7	-115.50	288.1	348.4	389.5	362.2	27.23	14.301		
7,200.0	6,977.8	7,262.4	7,128.5	16.9	14.3	-118.25	288.1	252.9	398.7	372.6	26.08	15.285		
7,300.0	7,018.0	7,399.3	7,201.9	17.0	14.1	-120.33	288.1	137.6	406.2	380.6	25.63	15.851		
7,400.0	7,045.1	7,540.6	7,253.3	17.3	14.4	-121.66	288.1	6.2	411.3	384.9	26.40	15.581		
7,500.0	7,058.5	7,684.4	7,278.1	18.0	16.1	-122.18	288.1	-135.2	413.4	384.8	28.60	14.455		
7,600.0	7,060.0	7,800.5	7,280.0	19.2	17.9	-122.16	288.1	-251.3	413.3	381.9	31.39	13.166		
7,700.0	7,060.0	7,900.5	7,280.0	20.7	19.6	-122.16	288.1	-351.3	413.3	379.1	34.22	12.076		
7,800.0	7,060.0	8,000.5	7,280.0	22.4	21.4	-122.16	288.1	-451.3	413.3	376.0	37.31	11.076		
7,900.0	7,060.0	8,100.5	7,280.0	24.3	23.4	-122.16	288.1	-551.3	413.3	372.7	40.60	10.179		
8,000.0	7,060.0	8,200.5	7,280.0	26.3	25.5	-122.16	288.1	-651.3	413.3	369.2	44.05	9.383		
8,100.0	7,060.0	8,300.5	7,280.0	28.3	27.6	-122.16	288.1	-751.3	413.3	365.7	47.61	8.681		
8,200.0	7,060.0	8,400.5	7,280.0	30.4	29.7	-122.16	288.1	-851.3	413.3	362.0	51.27	8.061		
8,300.0	7,060.0	8,500.5	7,280.0	32.6	32.0	-122.16	288.1	-951.3	413.3	358.3	55.00	7.514		
8,400.0	7,060.0	8,600.5	7,280.0	34.8	34.2	-122.16	288.1	-1,051.3	413.3	354.5	58.80	7.028		
8,500.0	7,060.0	8,700.5	7,280.0	37.1	36.5	-122.16	288.1	-1,151.3	413.3	350.6	62.65	6.597		
8,600.0	7,060.0	8,800.5	7,280.0	39.3	38.8	-122.16	288.1	-1,251.3	413.3	346.7	66.54	6.211		
8,700.0	7,060.0	8,900.5	7,280.0	41.6	41.1	-122.17	288.1	-1,351.3	413.3	342.8	70.46	5.865		
8,800.0	7,060.0	9,000.5	7,280.0	44.0	43.5	-122.17	288.1	-1,451.3	413.2	338.8	74.42	5.553		
8,900.0	7,060.0	9,100.5	7,280.0	46.3	45.8	-122.17	288.1	-1,551.3	413.2	334.9	78.40	5.271		
9,000.0	7,060.0	9,200.5	7,280.0	48.6	48.2	-122.17	288.1	-1,651.3	413.2	330.8	82.40	5.015		
9,100.0	7,060.0	9,300.5	7,280.0	51.0	50.5	-122.17	288.1	-1,751.3	413.2	326.8	86.42	4.782		
9,200.0	7,060.0	9,400.5	7,280.0	53.3	52.9	-122.17	288.1	-1,851.3	413.2	322.8	90.45	4.569		
9,300.0	7,060.0	9,500.5	7,280.0	55.7	55.3	-122.17	288.1	-1,951.3	413.2	318.7	94.50	4.373		
9,400.0	7,060.0	9,600.5	7,280.0	58.1	57.7	-122.17	288.1	-2,051.3	413.2	314.7	98.56	4.193		
9,500.0	7,060.0	9,700.5	7,280.0	60.5	60.1	-122.17	288.1	-2,151.3	413.2	310.6	102.63	4.026		
9,600.0	7,060.0	9,800.5	7,280.0	62.9	62.5	-122.17	288.1	-2,251.3	413.2	306.5	106.71	3.872		
9,700.0	7,060.0	9,900.5	7,280.0	65.3	65.0	-122.17	288.1	-2,351.3	413.2	302.4	110.80	3.729		
9,800.0	7,060.0	10,000.5	7,280.0	67.7	67.4	-122.17	288.1	-2,451.3	413.2	298.3	114.90	3.596		
9,900.0	7,060.0	10,100.5	7,280.0	70.1	69.8	-122.17	288.1	-2,551.3	413.2	294.2	119.00	3.472		
10,000.0	7,060.0	10,200.5	7,280.0	72.5	72.2	-122.17	288.1	-2,651.3	413.2	290.1	123.11	3.356		
10,100.0	7,060.0	10,300.5	7,280.0	75.0	74.7	-122.17	288.1	-2,751.3	413.2	286.0	127.23	3.248		
10,200.0	7,060.0	10,400.5	7,280.0	77.4	77.1	-122.17	288.1	-2,851.3	413.2	281.9	131.35	3.146		
10,300.0	7,060.0	10,500.5	7,280.0	79.8	79.5	-122.17	288.1	-2,951.3	413.2	277.7	135.47	3.050		

CC - Min centre to center distance or convergent point, SF - min separation factor, ES - min ellipse separation

Anticollision Report

Company:	EnCana Oil & Gas (USA) Inc	Local Co-ordinate Reference:	Well Drieth 4B-6H-I368
Project:	DJ Wattenberg	TVD Reference:	WELL @ 5123.0ft (Original Well Elev)
Reference Site:	S6-T3N-R68W (Zisch/Drieth)	MD Reference:	WELL @ 5123.0ft (Original Well Elev)
Site Error:	0.0ft	North Reference:	True
Reference Well:	Drieth 4B-6H-I368	Survey Calculation Method:	Minimum Curvature
Well Error:	0.0ft	Output errors are at	2.00 sigma
Reference Wellbore	Hz	Database:	USA EDM 5000 Multi Users DB
Reference Design:	Plan #1	Offset TVD Reference:	Offset Datum

Offset Design S6-T3N-R68W (Zisch/Drieth) - Drieth 4C-6H-I368 - Hz - Plan #1													Offset Site Error:	0.0 ft
Survey Program: 0-MWD													Offset Well Error:	0.0 ft
Reference		Offset		Semi Major Axis			Distance							Warning
Measured Depth (ft)	Vertical Depth (ft)	Measured Depth (ft)	Vertical Depth (ft)	Reference (ft)	Offset (ft)	Highside Toolface (°)	Offset Wellbore Centre +N/-S (ft)	+E/-W (ft)	Between Centres (ft)	Between Ellipses (ft)	Total Uncertainty Axis	Separation Factor		
10,400.0	7,060.0	10,600.5	7,280.0	82.2	82.0	-122.17	288.1	-3,051.3	413.2	273.6	139.60	2.960		
10,500.0	7,060.0	10,700.5	7,280.0	84.7	84.4	-122.17	288.1	-3,151.3	413.2	269.5	143.73	2.875		
10,600.0	7,060.0	10,800.5	7,280.0	87.1	86.8	-122.17	288.1	-3,251.3	413.2	265.3	147.87	2.794		
10,700.0	7,060.0	10,900.5	7,280.0	89.5	89.3	-122.17	288.1	-3,351.3	413.2	261.2	152.01	2.718		
10,800.0	7,060.0	11,000.5	7,280.0	92.0	91.7	-122.17	288.1	-3,451.3	413.2	257.0	156.15	2.646		
10,900.0	7,060.0	11,100.5	7,280.0	94.4	94.2	-122.17	288.1	-3,551.3	413.2	252.9	160.29	2.578		
11,000.0	7,060.0	11,200.5	7,280.0	96.9	96.6	-122.17	288.1	-3,651.3	413.2	248.7	164.44	2.513		
11,100.0	7,060.0	11,300.5	7,280.0	99.3	99.1	-122.17	288.1	-3,751.3	413.2	244.6	168.59	2.451		
11,200.0	7,060.0	11,400.5	7,280.0	101.7	101.5	-122.17	288.1	-3,851.3	413.2	240.4	172.74	2.392		
11,300.0	7,060.0	11,500.5	7,280.0	104.2	104.0	-122.17	288.1	-3,951.3	413.2	236.3	176.89	2.336		
11,400.0	7,060.0	11,600.5	7,280.0	106.6	106.4	-122.17	288.1	-4,051.3	413.2	232.1	181.05	2.282		
11,500.0	7,060.0	11,700.5	7,280.0	109.1	108.9	-122.17	288.1	-4,151.3	413.2	228.0	185.21	2.231		
11,501.8	7,060.0	11,702.3	7,280.0	109.1	108.9	-122.17	288.1	-4,153.0	413.2	227.9	185.28	2.230 SF		

Anticollision Report

Company:	EnCana Oil & Gas (USA) Inc	Local Co-ordinate Reference:	Well Drieth 4B-6H-I368
Project:	DJ Wattenberg	TVD Reference:	WELL @ 5123.0ft (Original Well Elev)
Reference Site:	S6-T3N-R68W (Zisch/Drieth)	MD Reference:	WELL @ 5123.0ft (Original Well Elev)
Site Error:	0.0ft	North Reference:	True
Reference Well:	Drieth 4B-6H-I368	Survey Calculation Method:	Minimum Curvature
Well Error:	0.0ft	Output errors are at	2.00 sigma
Reference Wellbore	Hz	Database:	USA EDM 5000 Multi Users DB
Reference Design:	Plan #1	Offset TVD Reference:	Offset Datum

Offset Design S6-T3N-R68W (Zisch/Drieth) - Drieth 4D-6H-I368 - Hz - Plan #1													Offset Site Error:	0.0 ft
Survey Program: 0-MWD													Offset Well Error:	0.0 ft
Reference		Offset		Semi Major Axis		Distance		Total		Separation		Warning		
Measured Depth (ft)	Vertical Depth (ft)	Measured Depth (ft)	Vertical Depth (ft)	Reference (ft)	Offset (ft)	Highside Toolface (°)	Offset Wellbore Centre +N/-S (ft)	+E/-W (ft)	Between Centres (ft)	Between Ellipses (ft)	Uncertainty Axis			
0.0	0.0	0.0	0.0	0.0	0.0	172.72	-21.9	2.8	22.0					
100.0	100.0	100.0	100.0	0.2	0.2	172.72	-21.9	2.8	22.0	21.7	0.30	72.557		
200.0	200.0	200.0	200.0	0.3	0.3	172.72	-21.9	2.8	22.0	21.4	0.65	33.757		
300.0	300.0	300.0	300.0	0.5	0.5	172.72	-21.9	2.8	22.0	21.0	1.00	21.995 CC, ES		
400.0	400.0	400.0	400.0	0.7	0.7	135.22	-21.9	2.8	22.6	21.3	1.35	16.760		
500.0	500.0	500.0	500.0	0.9	0.8	139.51	-21.9	2.8	24.6	22.9	1.70	14.441		
600.0	599.9	599.9	599.9	1.0	1.0	145.28	-21.9	2.8	28.0	26.0	2.05	13.655 SF		
700.0	699.7	699.7	699.7	1.2	1.2	149.78	-21.9	3.7	33.1	30.7	2.41	13.771		
800.0	799.4	799.6	799.6	1.4	1.4	151.71	-22.0	6.3	39.6	36.9	2.76	14.348		
900.0	898.9	899.4	899.3	1.7	1.6	151.96	-22.2	10.6	47.4	44.3	3.13	15.165		
1,000.0	998.3	999.1	998.8	1.9	1.7	151.21	-22.4	16.7	56.5	53.0	3.51	16.108		
1,100.0	1,097.4	1,098.7	1,098.1	2.2	1.9	149.90	-22.8	24.5	66.9	63.0	3.91	17.107		
1,200.0	1,196.3	1,198.1	1,197.1	2.5	2.2	148.33	-23.2	34.0	78.6	74.3	4.34	18.115		
1,300.0	1,294.9	1,297.4	1,295.7	2.8	2.4	146.65	-23.6	45.1	91.7	86.9	4.80	19.097		
1,400.0	1,393.3	1,396.4	1,393.8	3.1	2.6	144.97	-24.2	58.0	106.2	100.9	5.30	20.028		
1,500.0	1,491.2	1,495.1	1,491.5	3.5	2.9	143.34	-24.8	72.5	122.1	116.3	5.84	20.893		
1,600.0	1,589.1	1,593.6	1,588.6	3.9	3.2	141.68	-25.5	88.7	138.8	132.4	6.43	21.576		
1,700.0	1,686.9	1,692.1	1,685.6	4.3	3.5	140.01	-26.2	105.7	155.6	148.6	7.04	22.089		
1,800.0	1,784.7	1,790.6	1,782.6	4.7	3.8	138.68	-26.9	122.8	172.5	164.9	7.67	22.499		
1,900.0	1,882.5	1,889.1	1,879.6	5.1	4.2	137.58	-27.6	139.9	189.5	181.2	8.30	22.833		
2,000.0	1,980.3	1,987.6	1,976.6	5.5	4.5	136.66	-28.3	157.0	206.6	197.6	8.94	23.108		
2,100.0	2,078.1	2,086.0	2,073.6	5.8	4.8	135.88	-29.0	174.1	223.7	214.1	9.58	23.337		
2,200.0	2,175.9	2,184.5	2,170.6	6.2	5.1	135.21	-29.8	191.2	240.8	230.6	10.23	23.532		
2,300.0	2,273.8	2,283.0	2,267.6	6.6	5.5	134.63	-30.5	208.3	257.9	247.1	10.88	23.698		
2,400.0	2,371.6	2,381.5	2,364.6	7.0	5.8	134.13	-31.2	225.3	275.1	263.6	11.54	23.841		
2,500.0	2,469.4	2,480.0	2,461.6	7.4	6.1	133.68	-31.9	242.4	292.3	280.1	12.20	23.966		
2,600.0	2,567.2	2,578.5	2,558.5	7.8	6.5	133.28	-32.6	259.5	309.5	296.7	12.86	24.076		
2,700.0	2,665.0	2,677.0	2,655.5	8.2	6.8	132.93	-33.3	276.6	326.8	313.2	13.52	24.173		
2,800.0	2,762.8	2,775.4	2,752.5	8.6	7.2	132.60	-34.0	293.7	344.0	329.8	14.18	24.259		
2,900.0	2,860.7	2,873.9	2,849.5	9.0	7.5	132.32	-34.8	310.8	361.2	346.4	14.84	24.336		
3,000.0	2,958.5	2,972.4	2,946.5	9.4	7.8	132.05	-35.5	327.9	378.5	363.0	15.51	24.405		
3,100.0	3,056.3	3,070.9	3,043.5	9.8	8.2	131.81	-36.2	345.0	395.7	379.6	16.17	24.468		
3,200.0	3,154.1	3,169.4	3,140.5	10.2	8.5	131.59	-36.9	362.0	413.0	396.2	16.84	24.525		
3,300.0	3,251.9	3,267.9	3,237.5	10.6	8.9	131.39	-37.6	379.1	430.3	412.8	17.51	24.576		
3,400.0	3,349.7	3,366.4	3,334.5	11.0	9.2	131.20	-38.3	396.2	447.6	429.4	18.18	24.624		
3,500.0	3,447.5	3,464.9	3,431.5	11.4	9.6	131.03	-39.1	413.3	464.8	446.0	18.84	24.667		
3,600.0	3,545.4	3,563.3	3,528.4	11.8	9.9	130.87	-39.8	430.4	482.1	462.6	19.51	24.707		
3,700.0	3,643.2	3,662.9	3,626.6	12.3	10.2	130.76	-40.5	447.3	499.3	479.2	20.17	24.758		

Anticollision Report

Company:	EnCana Oil & Gas (USA) Inc	Local Co-ordinate Reference:	Well Drieth 4B-6H-I368
Project:	DJ Wattenberg	TVD Reference:	WELL @ 5123.0ft (Original Well Elev)
Reference Site:	S6-T3N-R68W (Zisch/Drieth)	MD Reference:	WELL @ 5123.0ft (Original Well Elev)
Site Error:	0.0ft	North Reference:	True
Reference Well:	Drieth 4B-6H-I368	Survey Calculation Method:	Minimum Curvature
Well Error:	0.0ft	Output errors are at	2.00 sigma
Reference Wellbore	Hz	Database:	USA EDM 5000 Multi Users DB
Reference Design:	Plan #1	Offset TVD Reference:	Offset Datum

Offset Design S6-T3N-R68W (Zisch/Drieth) - Drieth 4E-6H-I368 - Hz - Plan #1													Offset Site Error:	0.0 ft
Survey Program: 0-MWD													Offset Well Error:	0.0 ft
Reference		Offset		Semi Major Axis		Distance		Total		Separation		Warning		
Measured Depth (ft)	Vertical Depth (ft)	Measured Depth (ft)	Vertical Depth (ft)	Reference (ft)	Offset (ft)	Highside Toolface (°)	Offset Wellbore Centre +N/-S (ft)	+E/-W (ft)	Between Centres (ft)	Between Ellipses (ft)	Uncertainty Axis			
0.0	0.0	0.0	0.0	0.0	0.0	174.53	-29.1	2.8	29.3					
100.0	100.0	100.0	100.0	0.2	0.2	174.53	-29.1	2.8	29.3	29.0	0.30	96.403		
200.0	200.0	200.0	200.0	0.3	0.3	174.53	-29.1	2.8	29.3	28.6	0.65	44.851		
300.0	300.0	300.0	300.0	0.5	0.5	174.53	-29.1	2.8	29.3	28.3	1.00	29.223 CC, ES		
400.0	400.0	400.0	400.0	0.7	0.7	136.60	-29.1	2.8	29.9	28.6	1.35	22.133		
500.0	500.0	499.6	499.6	0.9	0.8	138.57	-29.6	3.5	32.4	30.7	1.70	19.027		
600.0	599.9	599.1	599.1	1.0	1.0	139.77	-31.1	5.6	37.2	35.2	2.06	18.106 SF		
700.0	699.7	698.5	698.3	1.2	1.2	140.28	-33.6	9.2	44.4	42.0	2.42	18.374		
800.0	799.4	797.5	797.2	1.4	1.4	140.28	-37.0	14.1	54.0	51.2	2.79	19.333		
900.0	898.9	896.2	895.6	1.7	1.6	140.00	-41.4	20.4	65.8	62.7	3.18	20.703		
1,000.0	998.3	994.5	993.4	1.9	1.8	139.58	-46.7	28.1	80.0	76.4	3.59	22.310		
1,100.0	1,097.4	1,092.2	1,090.5	2.2	2.1	139.11	-53.0	37.1	96.5	92.5	4.01	24.040		
1,200.0	1,196.3	1,189.4	1,186.9	2.5	2.3	138.62	-60.1	47.4	115.3	110.8	4.47	25.815		
1,300.0	1,294.9	1,285.9	1,282.3	2.8	2.6	138.15	-68.1	58.9	136.3	131.4	4.94	27.583		
1,400.0	1,393.3	1,381.6	1,376.8	3.1	2.9	137.70	-77.0	71.7	159.6	154.2	5.45	29.310		
1,500.0	1,491.2	1,476.6	1,470.3	3.5	3.2	137.27	-86.7	85.6	185.2	179.2	5.98	30.971		
1,600.0	1,589.1	1,570.8	1,562.7	3.9	3.5	136.90	-97.2	100.7	212.3	205.8	6.54	32.472		
1,700.0	1,686.9	1,666.2	1,656.0	4.3	3.9	136.37	-108.5	116.9	240.2	233.1	7.11	33.764		
1,800.0	1,784.7	1,762.2	1,749.9	4.7	4.3	135.94	-119.8	133.3	268.1	260.4	7.70	34.829		
1,900.0	1,882.5	1,858.2	1,843.8	5.1	4.6	135.59	-131.2	149.7	296.1	287.8	8.29	35.721		
2,000.0	1,980.3	1,954.2	1,937.7	5.5	5.0	135.30	-142.6	166.1	324.0	315.1	8.88	36.478		
2,100.0	2,078.1	2,050.2	2,031.6	5.8	5.4	135.05	-154.0	182.5	352.0	342.5	9.48	37.126		
2,200.0	2,175.9	2,146.2	2,125.5	6.2	5.8	134.84	-165.4	198.9	379.9	369.9	10.08	37.687		
2,300.0	2,273.8	2,242.2	2,219.4	6.6	6.1	134.66	-176.8	215.2	407.9	397.2	10.68	38.176		
2,400.0	2,371.6	2,338.2	2,313.3	7.0	6.5	134.51	-188.2	231.6	435.9	424.6	11.29	38.606		
2,500.0	2,469.4	2,434.2	2,407.2	7.4	6.9	134.37	-199.6	248.0	463.9	452.0	11.90	38.987		
2,600.0	2,567.2	2,530.2	2,501.1	7.8	7.3	134.25	-211.0	264.4	491.8	479.3	12.51	39.326		

Anticollision Report

Company:	EnCana Oil & Gas (USA) Inc	Local Co-ordinate Reference:	Well Drieth 4B-6H-I368
Project:	DJ Wattenberg	TVD Reference:	WELL @ 5123.0ft (Original Well Elev)
Reference Site:	S6-T3N-R68W (Zisch/Drieth)	MD Reference:	WELL @ 5123.0ft (Original Well Elev)
Site Error:	0.0ft	North Reference:	True
Reference Well:	Drieth 4B-6H-I368	Survey Calculation Method:	Minimum Curvature
Well Error:	0.0ft	Output errors are at	2.00 sigma
Reference Wellbore	Hz	Database:	USA EDM 5000 Multi Users DB
Reference Design:	Plan #1	Offset TVD Reference:	Offset Datum

Offset Design S6-T3N-R68W (Zisch/Drieth) - Drieth 4F-6H-I368 - Hz - Plan #1													Offset Site Error:	0.0 ft
Survey Program: 0-MWD													Offset Well Error:	0.0 ft
Reference		Offset		Semi Major Axis			Distance				Total Uncertainty Axis	Separation Factor	Warning	
Measured Depth (ft)	Vertical Depth (ft)	Measured Depth (ft)	Vertical Depth (ft)	Reference (ft)	Offset (ft)	Highside Toolface (°)	Offset Wellbore Centre +N/-S (ft)	+E/-W (ft)	Between Centres (ft)	Between Ellipses (ft)				
0.0	0.0	1.0	1.0	0.0	0.0	176.02	-40.1	2.8	40.2					
100.0	100.0	101.0	101.0	0.2	0.2	176.02	-40.1	2.8	40.2	39.9	0.31	131.514		
200.0	200.0	201.0	201.0	0.3	0.3	176.02	-40.1	2.8	40.2	39.5	0.65	61.373		
266.3	266.3	267.3	267.3	0.4	0.4	176.02	-40.1	2.8	40.2	39.3	0.89	45.335 CC		
300.0	300.0	301.0	301.0	0.5	0.5	176.02	-40.1	2.8	40.2	39.2	1.00	40.026 ES		
400.0	400.0	400.4	400.4	0.7	0.7	137.06	-40.8	3.3	41.5	40.2	1.35	30.731		
500.0	500.0	500.0	500.0	0.9	0.9	137.48	-42.9	4.9	45.7	44.0	1.70	26.807		
600.0	599.9	598.7	598.6	1.0	1.0	138.03	-46.3	7.5	52.5	50.4	2.06	25.510 SF		
700.0	699.7	697.5	697.1	1.2	1.2	138.59	-51.1	11.1	62.1	59.6	2.42	25.643		
800.0	799.4	795.7	795.1	1.4	1.4	139.08	-57.2	15.7	74.3	71.5	2.79	26.627		
900.0	898.9	893.5	892.4	1.7	1.7	139.49	-64.6	21.2	89.3	86.1	3.18	28.130		
1,000.0	998.3	990.6	988.9	1.9	1.9	139.81	-73.3	27.7	107.0	103.4	3.57	29.948		
1,100.0	1,097.4	1,086.9	1,084.4	2.2	2.2	140.05	-83.2	35.2	127.3	123.3	3.98	31.949		
1,200.0	1,196.3	1,182.4	1,178.9	2.5	2.4	140.22	-94.3	43.5	150.2	145.8	4.41	34.044		
1,300.0	1,294.9	1,276.9	1,272.2	2.8	2.7	140.33	-106.5	52.7	175.7	170.8	4.86	36.172		
1,400.0	1,393.3	1,370.4	1,364.2	3.1	3.0	140.39	-119.8	62.7	203.8	198.4	5.32	38.290		
1,500.0	1,491.2	1,462.8	1,454.9	3.5	3.4	140.42	-134.1	73.4	234.3	228.5	5.80	40.370		
1,600.0	1,589.1	1,554.3	1,544.3	3.9	3.7	140.52	-149.4	84.9	266.8	260.5	6.31	42.289		
1,700.0	1,686.9	1,644.9	1,632.6	4.3	4.1	140.41	-165.7	97.1	300.4	293.6	6.82	44.020		
1,800.0	1,784.7	1,734.7	1,719.8	4.7	4.5	140.17	-183.0	110.1	335.2	327.8	7.35	45.598		
1,900.0	1,882.5	1,824.9	1,806.9	5.1	4.9	139.83	-201.3	123.9	371.1	363.2	7.89	47.040		
2,000.0	1,980.3	1,918.0	1,896.9	5.5	5.4	139.51	-220.6	138.4	407.3	398.9	8.44	48.263		
2,100.0	2,078.1	2,011.2	1,986.9	5.8	5.8	139.24	-239.9	152.8	443.6	434.6	8.99	49.318		
2,200.0	2,175.9	2,104.4	2,076.9	6.2	6.2	139.01	-259.2	167.3	479.9	470.3	9.55	50.236		

Anticollision Report

Company:	EnCana Oil & Gas (USA) Inc	Local Co-ordinate Reference:	Well Drieth 4B-6H-I368
Project:	DJ Wattenberg	TVD Reference:	WELL @ 5123.0ft (Original Well Elev)
Reference Site:	S6-T3N-R68W (Zisch/Drieth)	MD Reference:	WELL @ 5123.0ft (Original Well Elev)
Site Error:	0.0ft	North Reference:	True
Reference Well:	Drieth 4B-6H-I368	Survey Calculation Method:	Minimum Curvature
Well Error:	0.0ft	Output errors are at	2.00 sigma
Reference Wellbore	Hz	Database:	USA EDM 5000 Multi Users DB
Reference Design:	Plan #1	Offset TVD Reference:	Offset Datum

Offset Design S6-T3N-R68W (Zisch/Drieth) - Drieth 4G-6H-I368 - Hz - Plan #1													Offset Site Error:	0.0 ft
Survey Program: 0-MWD													Offset Well Error:	0.0 ft
Reference		Offset		Semi Major Axis			Distance						Warning	
Measured Depth (ft)	Vertical Depth (ft)	Measured Depth (ft)	Vertical Depth (ft)	Reference (ft)	Offset (ft)	Highside Toolface (°)	Offset Wellbore Centre +N/-S (ft)	+E/-W (ft)	Between Centres (ft)	Between Ellipses (ft)	Total Uncertainty Axis	Separation Factor		
0.0	0.0	1.0	1.0	0.0	0.0	176.87	-51.0	2.8	51.1					
100.0	100.0	101.0	101.0	0.2	0.2	176.87	-51.0	2.8	51.1	50.8	0.31	167.227		
166.3	166.3	167.3	167.3	0.3	0.3	176.87	-51.0	2.8	51.1	50.5	0.54	95.120 CC		
200.0	200.0	201.0	201.0	0.3	0.3	176.87	-51.0	2.8	51.1	50.4	0.65	78.040 ES		
300.0	300.0	300.0	300.0	0.5	0.5	176.48	-51.8	3.2	51.9	50.9	1.00	51.788		
400.0	400.0	399.3	399.2	0.7	0.7	136.90	-54.1	4.4	54.9	53.6	1.35	40.664		
500.0	500.0	498.2	498.0	0.9	0.9	136.95	-57.9	6.3	60.8	59.1	1.70	35.753		
600.0	599.9	596.8	596.4	1.0	1.1	137.39	-63.2	9.0	69.6	67.5	2.06	33.844		
700.0	699.7	694.9	694.3	1.2	1.3	138.03	-70.0	12.5	81.2	78.8	2.42	33.594 SF		
800.0	799.4	792.5	791.4	1.4	1.5	138.74	-78.3	16.6	95.7	92.9	2.79	34.336		
900.0	898.9	889.4	887.7	1.7	1.7	139.43	-87.9	21.5	113.0	109.8	3.16	35.695		
1,000.0	998.3	985.5	983.0	1.9	2.0	140.06	-98.9	27.1	133.1	129.5	3.55	37.442		
1,100.0	1,097.4	1,080.6	1,077.2	2.2	2.3	140.60	-111.2	33.4	156.0	152.0	3.96	39.430		
1,200.0	1,196.3	1,174.8	1,170.1	2.5	2.6	141.06	-124.8	40.2	181.6	177.2	4.37	41.561		
1,300.0	1,294.9	1,267.9	1,261.7	2.8	2.9	141.44	-139.5	47.7	210.0	205.2	4.80	43.765		
1,400.0	1,393.3	1,359.8	1,351.9	3.1	3.2	141.75	-155.3	55.7	241.0	235.8	5.24	45.994		
1,500.0	1,491.2	1,450.4	1,440.5	3.5	3.6	141.99	-172.2	64.3	274.7	269.0	5.70	48.217		
1,600.0	1,589.1	1,539.8	1,527.6	3.9	4.0	142.31	-190.1	73.3	310.3	304.1	6.17	50.286		
1,700.0	1,686.9	1,628.4	1,613.6	4.3	4.4	142.45	-209.0	82.9	347.2	340.5	6.65	52.188		
1,800.0	1,784.7	1,716.0	1,698.3	4.7	4.8	142.45	-228.8	93.0	385.3	378.1	7.14	53.952		
1,900.0	1,882.5	1,802.8	1,781.9	5.1	5.2	142.36	-249.6	103.6	424.6	417.0	7.64	55.600		
2,000.0	1,980.3	1,894.5	1,870.1	5.5	5.6	142.23	-272.2	115.0	464.5	456.3	8.15	57.004		

Anticollision Report

Company:	EnCana Oil & Gas (USA) Inc	Local Co-ordinate Reference:	Well Drieth 4B-6H-I368
Project:	DJ Wattenberg	TVD Reference:	WELL @ 5123.0ft (Original Well Elev)
Reference Site:	S6-T3N-R68W (Zisch/Drieth)	MD Reference:	WELL @ 5123.0ft (Original Well Elev)
Site Error:	0.0ft	North Reference:	True
Reference Well:	Drieth 4B-6H-I368	Survey Calculation Method:	Minimum Curvature
Well Error:	0.0ft	Output errors are at	2.00 sigma
Reference Wellbore	Hz	Database:	USA EDM 5000 Multi Users DB
Reference Design:	Plan #1	Offset TVD Reference:	Offset Datum

Reference Depths are relative to WELL @ 5123.0ft (Original Well Elev)

Offset Depths are relative to Offset Datum

Central Meridian is -105.500000 °

Coordinates are relative to: Drieth 4B-6H-I368

Coordinate System is US State Plane 1983, Colorado Northern Zone

Grid Convergence at Surface is: 0.30°

