

TEKTON WINDSOR, LLC

Location	Windsor, CO, USA(Imported)	Slot	Slot #5
Field	Windsor Project	Well	Pavistma South 5 #1-8-32-090-4-NH
Installation	Pavistma South	Wellbore	Pavistma South 5 #1-8-32-090-4-NH (PWB)

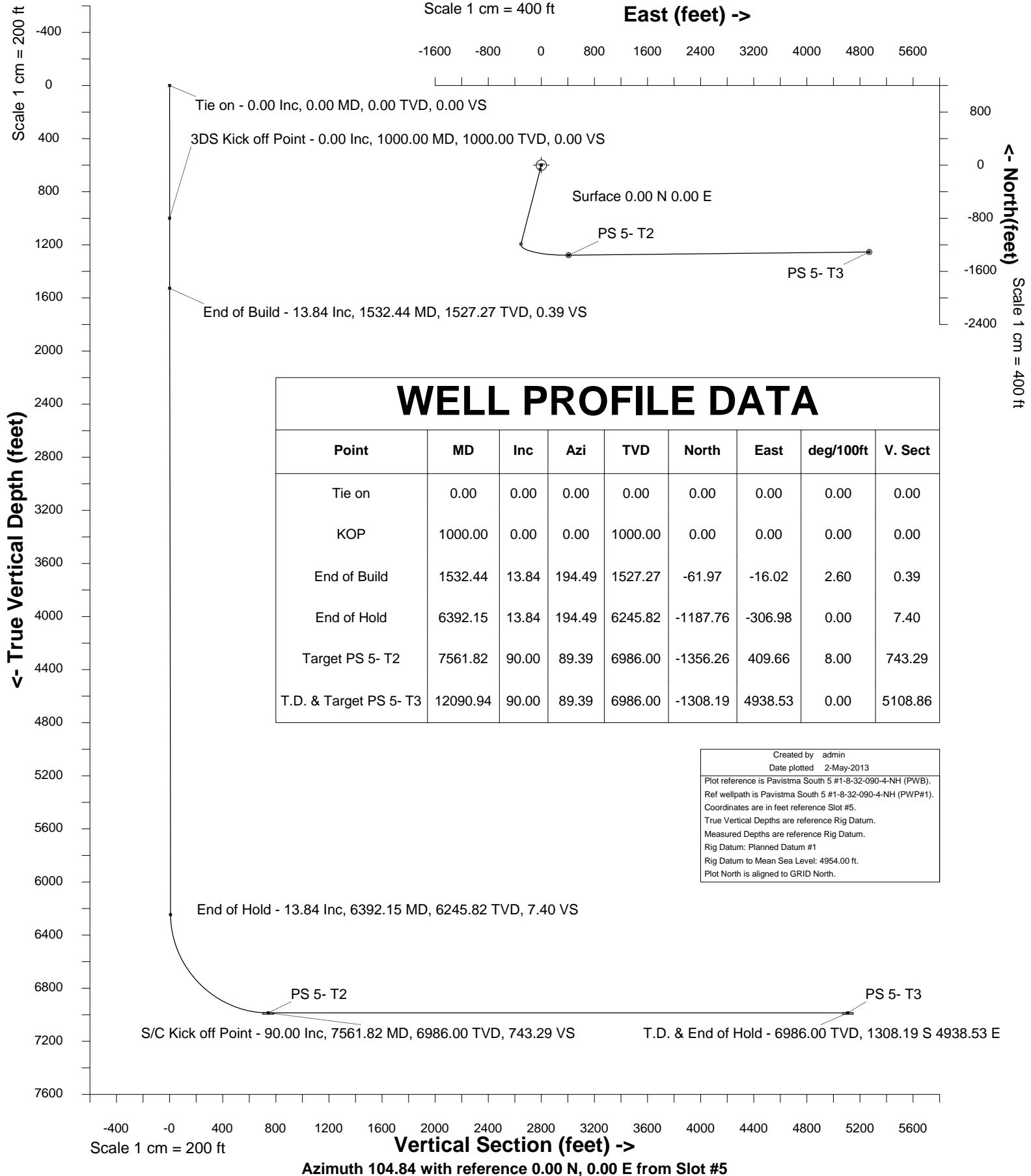



INTEGRATED PETROLEUM TECHNOLOGIES, INC
SYSDRILL
Well Design Combined Report
Wellbore: Pavistma South 5 #1-8-32-090-4-NH (PWB)
Wellpath: Pavistma South 5 #1-8-32-090-4-NH (PWP#1)

Wellhead Details							
Name	Northing	Easting	Latitude	Longitude	North	East	Slot Elevation Above Installation
Slot #5	1403793.4552	3160069.1894	N40 26 25.4040	W104 55 29.7120	51.24S	35.85W	1.00

Declination		
Date	Source	Time
8-Mar-2013	IGRF Model [1900.0-2015.0]	16:01

Site Details				
Name	Northing	Easting	Coord System Name	North Alignment
Pavistma South	1403844.6909	3160105.0426	CO83-NF on NORTH AMERICAN DATUM 1983 datum	Grid

Summary Wellpath									
MD[ft]	Inc[deg]	Azi[deg]	TVD[ft]	North[ft]	East[ft]	Dogleg [deg/100ft]	Vertical Section[ft]	Northing	Easting
0.00	0.00	0.000	0.00	0.00N	0.00E		0.00	1403793.46	3160069.19
1000.00	0.00	0.000	1000.00	0.00N	0.00E	==>	0.00	1403793.46	3160069.19
1532.44	13.84	194.490	1527.27	61.97S	16.02W	2.60	0.39	1403731.48	3160053.17
6392.15	13.84	194.490	6245.82	1187.76S	306.98W	==>	7.40	1402605.74	3159762.23
7561.82	90.00	89.390	6986.00	1356.26S	409.66E	8.00	743.29	1402437.25	3160478.83
12090.94	90.00	89.390	6986.00	1308.19S	4938.53E	==>	5108.86	1402485.32	3165007.52

Interpolated Wellpath									
MD[ft]	Inc[deg]	Azi[deg]	TVD[ft]	North[ft]	East[ft]	Dogleg [deg/100ft]	Vertical Section[ft]	Northing	Easting
0.00	0.00	0.000	0.00	0.00N	0.00E		0.00	1403793.46	3160069.19
100.00	0.00	0.000	100.00	0.00N	0.00E	==>	0.00	1403793.46	3160069.19
200.00	0.00	0.000	200.00	0.00N	0.00E	==>	0.00	1403793.46	3160069.19
300.00	0.00	0.000	300.00	0.00N	0.00E	==>	0.00	1403793.46	3160069.19
400.00	0.00	0.000	400.00	0.00N	0.00E	==>	0.00	1403793.46	3160069.19
500.00	0.00	0.000	500.00	0.00N	0.00E	==>	0.00	1403793.46	3160069.19
600.00	0.00	0.000	600.00	0.00N	0.00E	==>	0.00	1403793.46	3160069.19
700.00	0.00	0.000	700.00	0.00N	0.00E	==>	0.00	1403793.46	3160069.19
800.00	0.00	0.000	800.00	0.00N	0.00E	==>	0.00	1403793.46	3160069.19
900.00	0.00	0.000	900.00	0.00N	0.00E	==>	0.00	1403793.46	3160069.19
1000.00	0.00	0.000	1000.00	0.00N	0.00E	==>	0.00	1403793.46	3160069.19
1100.00	2.60	194.490	1099.97	2.20S	0.57W	2.60	0.01	1403791.26	3160068.62
1200.00	5.20	194.490	1199.73	8.78S	2.27W	2.60	0.05	1403784.67	3160066.92
1300.00	7.80	194.490	1299.07	19.74S	5.10W	2.60	0.12	1403773.72	3160064.09
1400.00	10.40	194.490	1397.81	35.05S	9.06W	2.60	0.22	1403758.41	3160060.13
1500.00	13.00	194.490	1495.72	54.68S	14.13W	2.60	0.34	1403738.77	3160055.06
1532.44	13.84	194.490	1527.27	61.97S	16.02W	2.60	0.39	1403731.48	3160053.17
1600.00	13.84	194.490	1592.87	77.62S	20.06W	==>	0.48	1403715.83	3160049.13
1700.00	13.84	194.490	1689.97	100.79S	26.05W	==>	0.63	1403692.67	3160043.14
1800.00	13.84	194.490	1787.06	123.96S	32.04W	==>	0.77	1403669.50	3160037.15
1900.00	13.84	194.490	1884.16	147.12S	38.02W	==>	0.92	1403646.34	3160031.17
2000.00	13.84	194.490	1981.25	170.29S	44.01W	==>	1.06	1403623.17	3160025.18
2100.00	13.84	194.490	2078.35	193.45S	50.00W	==>	1.21	1403600.01	3160019.19
2200.00	13.84	194.490	2175.44	216.62S	55.98W	==>	1.35	1403576.85	3160013.21
2300.00	13.84	194.490	2272.54	239.78S	61.97W	==>	1.49	1403553.68	3160007.22
2400.00	13.84	194.490	2369.64	262.95S	67.96W	==>	1.64	1403530.52	3160001.23
2500.00	13.84	194.490	2466.73	286.12S	73.95W	==>	1.78	1403507.35	3159995.25
2600.00	13.84	194.490	2563.83	309.28S	79.93W	==>	1.93	1403484.19	3159989.26
2700.00	13.84	194.490	2660.92	332.45S	85.92W	==>	2.07	1403461.02	3159983.27
2800.00	13.84	194.490	2758.02	355.61S	91.91W	==>	2.22	1403437.86	3159977.29
2900.00	13.84	194.490	2855.11	378.78S	97.90W	==>	2.36	1403414.69	3159971.30
3000.00	13.84	194.490	2952.21	401.94S	103.88W	==>	2.50	1403391.53	3159965.31
3100.00	13.84	194.490	3049.30	425.11S	109.87W	==>	2.65	1403368.36	3159959.32
3200.00	13.84	194.490	3146.40	448.28S	115.86W	==>	2.79	1403345.20	3159953.34
3300.00	13.84	194.490	3243.49	471.44S	121.84W	==>	2.94	1403322.03	3159947.35

All data is in Feet unless otherwise stated
Coordinates are from Slot MD's are from Rig and TVD's are from Rig (Planned Datum #1 4954.0ft above Mean Sea Level)
Vertical Section is from 0.00N 0.00E on azimuth 104.840 degrees
Bottom hole distance is 5108.86 Feet on azimuth 104.84 degrees from Wellhead
Calculation method uses Minimum Curvature method
Prepared by Peterson Energy
Date Printed: 2-May-2013



INTEGRATED PETROLEUM TECHNOLOGIES, INC
SYSDRILL
Well Design Combined Report
Wellbore: Pavistma South 5 #1-8-32-090-4-NH (PWB)
Wellpath: Pavistma South 5 #1-8-32-090-4-NH (PWP#1)

Interpolated Wellpath									
MD[ft]	Inc[deg]	Azi[deg]	TVD[ft]	North[ft]	East[ft]	Dogleg [deg/100ft]	Vertical Section[ft]	Northing	Easting
3400.00	13.84	194.490	3340.59	494.61S	127.83W	==>	3.08	1403298.87	3159941.36
3500.00	13.84	194.490	3437.68	517.77S	133.82W	==>	3.23	1403275.70	3159935.38
3600.00	13.84	194.490	3534.78	540.94S	139.81W	==>	3.37	1403252.54	3159929.39
3700.00	13.84	194.490	3631.87	564.10S	145.79W	==>	3.51	1403229.37	3159923.40
3800.00	13.84	194.490	3728.97	587.27S	151.78W	==>	3.66	1403206.21	3159917.42
3900.00	13.84	194.490	3826.07	610.43S	157.77W	==>	3.80	1403183.04	3159911.43
4000.00	13.84	194.490	3923.16	633.60S	163.75W	==>	3.95	1403159.88	3159905.44
4100.00	13.84	194.490	4020.26	656.77S	169.74W	==>	4.09	1403136.72	3159899.46
4200.00	13.84	194.490	4117.35	679.93S	175.73W	==>	4.24	1403113.55	3159893.47
4300.00	13.84	194.490	4214.45	703.10S	181.72W	==>	4.38	1403090.39	3159887.48
4400.00	13.84	194.490	4311.54	726.26S	187.70W	==>	4.52	1403067.22	3159881.49
4500.00	13.84	194.490	4408.64	749.43S	193.69W	==>	4.67	1403044.06	3159875.51
4600.00	13.84	194.490	4505.73	772.59S	199.68W	==>	4.81	1403020.89	3159869.52
4700.00	13.84	194.490	4602.83	795.76S	205.66W	==>	4.96	1402997.73	3159863.53
4800.00	13.84	194.490	4699.92	818.93S	211.65W	==>	5.10	1402974.56	3159857.55
4900.00	13.84	194.490	4797.02	842.09S	217.64W	==>	5.25	1402951.40	3159851.56
5000.00	13.84	194.490	4894.11	865.26S	223.63W	==>	5.39	1402928.23	3159845.57
5100.00	13.84	194.490	4991.21	888.42S	229.61W	==>	5.53	1402905.07	3159839.59
5200.00	13.84	194.490	5088.30	911.59S	235.60W	==>	5.68	1402881.90	3159833.60
5300.00	13.84	194.490	5185.40	934.75S	241.59W	==>	5.82	1402858.74	3159827.61
5400.00	13.84	194.490	5282.50	957.92S	247.57W	==>	5.97	1402835.57	3159821.63
5500.00	13.84	194.490	5379.59	981.09S	253.56W	==>	6.11	1402812.41	3159815.64
5600.00	13.84	194.490	5476.69	1004.25S	259.55W	==>	6.26	1402789.24	3159809.65
5700.00	13.84	194.490	5573.78	1027.42S	265.54W	==>	6.40	1402766.08	3159803.66
5800.00	13.84	194.490	5670.88	1050.58S	271.52W	==>	6.54	1402742.91	3159797.68
5900.00	13.84	194.490	5767.97	1073.75S	277.51W	==>	6.69	1402719.75	3159791.69
6000.00	13.84	194.490	5865.07	1096.91S	283.50W	==>	6.83	1402696.58	3159785.70
6100.00	13.84	194.490	5962.16	1120.08S	289.48W	==>	6.98	1402673.42	3159779.72
6200.00	13.84	194.490	6059.26	1143.25S	295.47W	==>	7.12	1402650.26	3159773.73
6300.00	13.84	194.490	6156.35	1166.41S	301.46W	==>	7.27	1402627.09	3159767.74
6392.15	13.84	194.490	6245.82	1187.76S	306.98W	==>	7.40	1402605.74	3159762.23
6400.00	13.70	191.920	6253.45	1189.58S	307.40W	8.00	7.45	1402603.93	3159761.80
6500.00	14.29	158.480	6350.64	1212.68S	305.32W	8.00	15.38	1402580.82	3159763.88
6600.00	18.61	134.340	6446.63	1235.35S	289.35W	8.00	36.62	1402558.15	3159779.85
6700.00	24.78	120.410	6539.57	1257.15S	259.81W	8.00	70.76	1402536.36	3159809.39
6800.00	31.74	112.010	6627.62	1277.65S	217.28W	8.00	117.12	1402515.86	3159851.92
6900.00	39.07	106.430	6709.10	1296.45S	162.58W	8.00	174.82	1402497.05	3159906.62
7000.00	46.59	102.400	6782.40	1313.19S	96.77W	8.00	242.71	1402480.31	3159972.42
7100.00	54.22	99.270	6846.10	1327.55S	21.14W	8.00	319.50	1402465.96	3160048.05
7200.00	61.91	96.690	6898.96	1339.23S	62.84E	8.00	403.67	1402454.27	3160132.02
7300.00	69.65	94.450	6939.96	1348.03S	153.53E	8.00	493.59	1402445.48	3160222.72
7400.00	77.41	92.440	6968.29	1353.75S	249.18E	8.00	587.52	1402439.76	3160318.36
7500.00	85.19	90.540	6983.41	1356.30S	347.92E	8.00	683.61	1402437.21	3160417.09
7561.82	90.00	89.390	6986.00	1356.26S	409.66E	8.00	743.29	1402437.25	3160478.83
7600.00	90.00	89.390	6986.00	1355.86S	447.84E	==>	780.09	1402437.65	3160517.01
7700.00	90.00	89.390	6986.00	1354.79S	547.84E	==>	876.48	1402438.71	3160617.00
7800.00	90.00	89.390	6986.00	1353.73S	647.83E	==>	972.87	1402439.78	3160716.99
7900.00	90.00	89.390	6986.00	1352.67S	747.82E	==>	1069.26	1402440.84	3160816.98
8000.00	90.00	89.390	6986.00	1351.61S	847.82E	==>	1165.65	1402441.90	3160916.97
8100.00	90.00	89.390	6986.00	1350.55S	947.81E	==>	1262.04	1402442.96	3161016.96
8200.00	90.00	89.390	6986.00	1349.49S	1047.81E	==>	1358.43	1402444.02	3161116.95
8300.00	90.00	89.390	6986.00	1348.43S	1147.80E	==>	1454.81	1402445.08	3161216.95
8400.00	90.00	89.390	6986.00	1347.36S	1247.80E	==>	1551.20	1402446.14	3161316.94
8500.00	90.00	89.390	6986.00	1346.30S	1347.79E	==>	1647.59	1402447.21	3161416.93
8600.00	90.00	89.390	6986.00	1345.24S	1447.78E	==>	1743.98	1402448.27	3161516.92
8700.00	90.00	89.390	6986.00	1344.18S	1547.78E	==>	1840.37	1402449.33	3161616.91
8800.00	90.00	89.390	6986.00	1343.12S	1647.77E	==>	1936.76	1402450.39	3161716.90
8900.00	90.00	89.390	6986.00	1342.06S	1747.77E	==>	2033.15	1402451.45	3161816.89
9000.00	90.00	89.390	6986.00	1341.00S	1847.76E	==>	2129.54	1402452.51	3161916.88
9100.00	90.00	89.390	6986.00	1339.93S	1947.76E	==>	2225.92	1402453.57	3162016.87
9200.00	90.00	89.390	6986.00	1338.87S	2047.75E	==>	2322.31	1402454.64	3162116.86

All data is in Feet unless otherwise stated
Coordinates are from Slot MD's are from Rig and TVD's are from Rig (Planned Datum #1 4954.0ft above Mean Sea Level)
Vertical Section is from 0.00N 0.00E on azimuth 104.840 degrees
Bottom hole distance is 5108.86 Feet on azimuth 104.84 degrees from Wellhead
Calculation method uses Minimum Curvature method
Prepared by Peterson Energy
Date Printed: 2-May-2013



INTEGRATED PETROLEUM TECHNOLOGIES, INC
 SYSDRILL
 Well Design Combined Report
 Wellbore: Pavistma South 5 #1-8-32-090-4-NH (PWB)
 Wellpath: Pavistma South 5 #1-8-32-090-4-NH (PWP#1)

Interpolated Wellpath									
MD[ft]	Inc[deg]	Azi[deg]	TVD[ft]	North[ft]	East[ft]	Dogleg [deg/100ft]	Vertical Section[ft]	Northing	Easting
9300.00	90.00	89.390	6986.00	1337.81S	2147.74E	==>	2418.70	1402455.70	3162216.85
9400.00	90.00	89.390	6986.00	1336.75S	2247.74E	==>	2515.09	1402456.76	3162316.84
9500.00	90.00	89.390	6986.00	1335.69S	2347.73E	==>	2611.48	1402457.82	3162416.83
9600.00	90.00	89.390	6986.00	1334.63S	2447.73E	==>	2707.87	1402458.88	3162516.82
9700.00	90.00	89.390	6986.00	1333.56S	2547.72E	==>	2804.26	1402459.94	3162616.81
9800.00	90.00	89.390	6986.00	1332.50S	2647.72E	==>	2900.65	1402461.00	3162716.80
9900.00	90.00	89.390	6986.00	1331.44S	2747.71E	==>	2997.04	1402462.07	3162816.79
10000.00	90.00	89.390	6986.00	1330.38S	2847.71E	==>	3093.42	1402463.13	3162916.78
10100.00	90.00	89.390	6986.00	1329.32S	2947.70E	==>	3189.81	1402464.19	3163016.77
10200.00	90.00	89.390	6986.00	1328.26S	3047.69E	==>	3286.20	1402465.25	3163116.76
10300.00	90.00	89.390	6986.00	1327.20S	3147.69E	==>	3382.59	1402466.31	3163216.75
10400.00	90.00	89.390	6986.00	1326.13S	3247.68E	==>	3478.98	1402467.37	3163316.74
10500.00	90.00	89.390	6986.00	1325.07S	3347.68E	==>	3575.37	1402468.43	3163416.73
10600.00	90.00	89.390	6986.00	1324.01S	3447.67E	==>	3671.76	1402469.50	3163516.72
10700.00	90.00	89.390	6986.00	1322.95S	3547.67E	==>	3768.15	1402470.56	3163616.71
10800.00	90.00	89.390	6986.00	1321.89S	3647.66E	==>	3864.53	1402471.62	3163716.70
10900.00	90.00	89.390	6986.00	1320.83S	3747.65E	==>	3960.92	1402472.68	3163816.70
11000.00	90.00	89.390	6986.00	1319.77S	3847.65E	==>	4057.31	1402473.74	3163916.69
11100.00	90.00	89.390	6986.00	1318.70S	3947.64E	==>	4153.70	1402474.80	3164016.68
11200.00	90.00	89.390	6986.00	1317.64S	4047.64E	==>	4250.09	1402475.87	3164116.67
11300.00	90.00	89.390	6986.00	1316.58S	4147.63E	==>	4346.48	1402476.93	3164216.66
11400.00	90.00	89.390	6986.00	1315.52S	4247.63E	==>	4442.87	1402477.99	3164316.65
11500.00	90.00	89.390	6986.00	1314.46S	4347.62E	==>	4539.26	1402479.05	3164416.64
11600.00	90.00	89.390	6986.00	1313.40S	4447.62E	==>	4635.64	1402480.11	3164516.63
11700.00	90.00	89.390	6986.00	1312.33S	4547.61E	==>	4732.03	1402481.17	3164616.62
11800.00	90.00	89.390	6986.00	1311.27S	4647.60E	==>	4828.42	1402482.23	3164716.61
11900.00	90.00	89.390	6986.00	1310.21S	4747.60E	==>	4924.81	1402483.30	3164816.60
12000.00	90.00	89.390	6986.00	1309.15S	4847.59E	==>	5021.20	1402484.36	3164916.59
12090.94	90.00	89.390	6986.00	1308.19S	4938.53E	==>	5108.86	1402485.32	3165007.52

All data is in Feet unless otherwise stated
 Coordinates are from Slot MD's are from Rig and TVD's are from Rig (Planned Datum #1 4954.0ft above Mean Sea Level)
 Vertical Section is from 0.00N 0.00E on azimuth 104.840 degrees
 Bottom hole distance is 5108.86 Feet on azimuth 104.84 degrees from Wellhead
 Calculation method uses Minimum Curvature method
 Prepared by Peterson Energy
 Date Printed: 2-May-2013



INTEGRATED PETROLEUM TECHNOLOGIES, INC
 SYSDRILL
 Well Design Combined Report
 Wellbore: Pavistma South 5 #1-8-32-090-4-NH (PWB)
 Wellpath: Pavistma South 5 #1-8-32-090-4-NH (PWP#1)

Hole Sections								
Diameter	Start	Start	Start	Start	End	End	End	End
[in]	MD[ft]	TVD[ft]	North[ft]	East[ft]	MD[ft]	TVD[ft]	North[ft]	East[ft]
12 1/4	0.00	0.00	0.00N	0.00E	850.00	850.00	0.00N	0.00E
8 3/4	850.00	850.00	0.00N	0.00E	7562.00	6986.00	1356.26S	409.84E
6 1/8	7562.00	6986.00	1356.26S	409.84E	12090.94	6986.00	1308.19S	4938.53E

Casings								
Name	Top	Top	Top	Top	Shoe	Shoe	Shoe	Shoe
	MD[ft]	TVD[ft]	North[ft]	East[ft]	MD[ft]	TVD[ft]	North[ft]	East[ft]
9 5/8in Surface Casing	0.00	0.00	0.00N	0.00E	850.00	850.00	0.00N	0.00E
7.0in Intermediate Casing	0.00	0.00	0.00N	0.00E	7562.00	6986.00	1356.26S	409.84E
4 1/2in Production Liner	6400.00	6253.45	1189.58S	307.40W	12090.94	6986.00	1308.19S	4938.53E

Targets								
Name	North[ft]	East[ft]	TVD[ft]	Latitude	Longitude	Northing	Easting	Last Revised
PS 5- T2	1356.26S	409.66E	6986.00	N40 26 11.9760	W104 55 24.5280	1402437.25	3160478.83	8-Mar-2013
PS 5- T3	1308.19S	4938.53E	6986.00	N40 26 12.1560	W104 54 25.9560	1402485.32	3165007.52	8-Mar-2013

Survey Tool Program					
Reference	Survey Name	MD[ft]	TVD[ft]	Survey Tool	Error Model
5442	Planned	12090.94	6986.00	WdW Rate Gyro	Standard

Notes

All data is in Feet unless otherwise stated
 Coordinates are from Slot MD's are from Rig and TVD's are from Rig (Planned Datum #1 4954.0ft above Mean Sea Level)
 Vertical Section is from 0.00N 0.00E on azimuth 104.840 degrees
 Bottom hole distance is 5108.86 Feet on azimuth 104.84 degrees from Wellhead
 Calculation method uses Minimum Curvature method
 Prepared by Peterson Energy
 Date Printed: 2-May-2013



SYSDRILL
Closest Approach + Clearance Factor Summary Report
Wellbore: Pavistma South 5 #1-8-32-090-4-NH (PWB)
Wellpath: Pavistma South 5 #1-8-32-090-4-NH (PWP#1)

Ellipse separations are reported ONLY if BOTH wells have uncertainty data
Only Depth and Magnetic Reference Field error terms are correlated across tie points
Cutoff is calculated on CENTRE to CENTRE distance

Summary data uses Closest Approach clearance calculation for all minima
Hole size/Casings ARE included
Hole size/Casings are NOT subtracted from Centre-Centre distance
Confidence limit of 95.00% / 2.80 SD.

Wellbore		
Name	Created	Last Revised
Pavistma South 5 #1-8-32-090-4-NH (PWB)	8-Mar-2013	2-May-2013

Well		
Name	Government ID	Last Revised
Pavistma South 5 #1-8-32-090-4-NH		8-Mar-2013

Slot						
Name	Grid Northing	Grid Easting	Latitude	Longitude	North	East
Slot #5	1403793.4552	3160069.1894	N40 26 25.4040	W104 55 29.7120	51.24S	35.85W

Installation					
Name	Easting	Northing	Coord System Name	North Alignment	
Pavistma South	3160105.0426	1403844.6909	CO83-NF on NORTH AMERICAN DATUM 1983 datum	Grid	

Field					
Name	Easting	Northing	Coord System Name	North Alignment	
Windsor Project	3162710.0707	1407271.6545	CO83-NF on NORTH AMERICAN DATUM 1983 datum	Grid	

Clearance Summary										
Offset WellName	Offset Wellbore	Offset Slot	Offset Structure	Separation [ft]	MD[ft]	Diverging From[ft]	Ellipse Separation [ft]	Ellipse MD[ft]	Clearance Factor	Clearance MD[ft]
Pavistma South 4 #1-7-32-09 0-4-CH	Pavistma South 4 #1-7-32-090-4 -CH (PWB)	Slot #4	Pavistma South	13.70	1017.06	7561.82	11.37	1082.68	4.51	12024.28
Pavistma South 3 #1-6-32-09 0-4-NH	Pavistma South 3 #1-6-32-090-4 -NH (PWB)	Slot #3	Pavistma South	30.16	1213.91	1213.91	27.54	1213.91	9.89	11893.04
Pavistma South 2 #1-5-32-09 0-4-CH	Pavistma South 2 #1-5-32-090-4 -CH (PWB)	Slot #2	Pavistma South	48.79	1017.06	1017.06	46.49	1017.06	17.20	11761.81
Pavistma South 1 #1-5-32-09 0-4-NH	Pavistma South 1 #1-5-32-090-4 -NH (PWB)	Slot #1	Pavistma South	62.54	1000.66	1000.66	60.27	1017.06	19.36	11745.41
RANCHO WATER VALLEY 7 #7-8-33-27 0-5-CH	RANCHO WATER VALLEY 7 #7-8-33-270-5 -CH (PWB)	Slot #07	Rancho Water Valley	181.62	12090.94	12090.94	98.07	12078.93	2.17	12078.93
FRYE FARMS #9-7-32	FRYE FARMS #9-7-32 (AWB)	FRYE FARMS #9-7-32	Frye Farms	199.06	11227.56	11227.56	149.79	11236.88	3.88	11286.09
FRYE FARMS #9-5-32	FRYE FARMS #9-5-32 (AWB)	FRYE FARMS #9-5-32	Frye Farms	205.28	9917.74	9917.74	144.98	9908.14	3.39	9900.00
PAVISTMA	PAVISTMA	PAVISTMA	Pavistma	275.13	1066.27	8285.36	270.88	1066.27	25.44	8070.87

All data is in Feet unless otherwise stated
Coordinates are from Slot MD's are from Rig and TVD's are from Rig (Planned Datum #1 4954.0ft above Mean Sea Level)
Vertical Section is from 0.00N 0.00E on azimuth 104.840 degrees
Prepared by Peterson Energy
Date Printed: 2-May-2013



SYSDRILL
Closest Approach + Clearance Factor Summary Report
Wellbore: Pavistma South 5 #1-8-32-090-4-NH (PWB)
Wellpath: Pavistma South 5 #1-8-32-090-4-NH (PWP#1)

Clearance Summary										
Offset WellName	Offset Wellbore	Offset Slot	Offset Structure	Separation [ft]	MD[ft]	Diverging From[ft]	Ellipse Separation [ft]	Ellipse MD[ft]	Clearance Factor	Clearance MD[ft]
19-32	19-32 (AWB)	19-32	(Anadarko)							
PAVISTMA 11-32	PAVISTMA 11-32 (AWB)	PAVISTMA 11-32	Pavistma (Anadarko)	310.16	1033.46	8942.34	306.09	1033.46	26.21	9005.91
CENTER POINT 5 #8-1-32-18 0-4-NH	CENTER POINT 5 #8-1-32-180-4 -NH (PWB)	Slot #5	Center Point	329.53	12090.94	12090.94	257.24	12090.94	4.56	12090.94
RANCHO WATER VALLEY 6 #0-7-4-270 -5-NH	RANCHO WATER VALLEY 6 #0-7-4-270-5- NH (PWB)	Slot #06	Rancho Water Valley	330.15	12090.94	12090.94	238.44	12090.94	3.60	12047.82
PAVISTMA 12-32	PAVISTMA 12-32 (AWB)	PAVISTMA 12-32	Pavistma (Anadarko)	340.75	1017.06	7620.04	336.63	1017.06	80.73	1197.51
Lind #13-32	Lind #13-32 (AWB)	Lind #13-32	Lind (Anadarko)	405.94	7776.26	7776.26	370.11	7791.99	10.66	7906.82
PAVISTMA 5-3-32	PAVISTMA 5-3-32 (AWB)	PAVISTMA 5-3-32	Pavistma	513.67	0.00	8261.77	512.40	633.12	56.13	8841.86
PAVISTMA 4-2-32	PAVISTMA 4-2-32 (AWB)	PAVISTMA 4-2-32	Pavistma	531.48	0.00	7681.51	530.23	82.02	89.52	9465.22
PAVISTMA 5-1-32	PAVISTMA 5-1-32 (AWB)	PAVISTMA 5-1-32	Pavistma	545.56	154.99	154.99	544.01	180.45	136.91	4000.00
PAVISTMA 6 #1-4-32-09 0-4-NH	PAVISTMA 6 #1-4-32-090-4 -NH (PWB)	Slot #6	Pavistma	595.32	1000.66	1000.66	593.05	1000.66	27.88	11696.19
PAVISTMA 7 #1-4-32-09 0-8-CH	PAVISTMA 7 #1-4-32-090-8 -CH (PWB)	Slot #7	Pavistma	611.16	1000.66	12090.94	608.90	1000.66	28.09	12090.94
PAVISTMA 8 #1-3-32-09 0-4-NH	PAVISTMA 8 #1-3-32-090-4 -NH (PWB)	Slot #8	Pavistma	627.02	1000.66	11516.06	624.75	1000.66	33.07	11811.02
CENTER POINT 7 #0-1-33-18 0-4-NH	CENTER POINT 7 #0-1-33-180-4 -NH (PWB)	Slot #7	Center Point	628.60	12090.94	12090.94	555.31	12090.94	8.58	12090.94
PAVISTMA 9 #1-3-32-09 0-4-NH	PAVISTMA 9 #1-3-32-090-4 -NH (PWB)	Slot #9	Pavistma	642.88	1000.66	1000.66	640.61	1000.66	36.90	11942.26
Anderson #1	Anderson #1 (AWB)	Anderson #1	Anderson (J.K. Wadley)	657.55	5367.39	5367.39	647.75	5367.39	66.74	5413.39
PAVISTMA 10 #1-3-32-09 0-8-CH	PAVISTMA 10 #1-3-32-090-8 -CH (PWB)	Slot #10	Pavistma	658.75	1000.66	12090.94	656.48	1000.66	35.25	12090.94
PAVISTMA 11 #1-3-32-09 0-4-NH	PAVISTMA 11 #1-3-32-090-4 -NH (PWB)	Slot #11	Pavistma	674.62	1000.66	11505.43	672.35	1000.66	40.59	12089.90
PAVISTMA 12 #1-2-32-09 0-4-NH	PAVISTMA 12 #1-2-32-090-4 -NH (PWB)	Slot #12	Pavistma	690.50	1000.66	11500.12	688.23	1000.66	44.19	12090.94

All data is in Feet unless otherwise stated
Coordinates are from Slot MD's are from Rig and TVD's are from Rig (Planned Datum #1 4954.0ft above Mean Sea Level)
Vertical Section is from 0.00N 0.00E on azimuth 104.840 degrees
Prepared by Peterson Energy
Date Printed: 2-May-2013



SYSDRILL
Closest Approach + Clearance Factor Summary Report
Wellbore: Pavistma South 5 #1-8-32-090-4-NH (PWB)
Wellpath: Pavistma South 5 #1-8-32-090-4-NH (PWP#1)

Clearance Summary										
Offset WellName	Offset Wellbore	Offset Slot	Offset Structure	Separation [ft]	MD[ft]	Diverging From[ft]	Ellipse Separation [ft]	Ellipse MD[ft]	Clearance Factor	Clearance MD[ft]
RANCHO WATER VALLEY 10 #7-8-33-27 0-4-NH	RANCHO WATER VALLEY 10 #7-8-33-270-4 -NH (PWB)	Slot #10	Rancho Water Valley	920.70	12090.94	12090.94	876.83	12090.94	20.99	12090.94
RANCHO WATER VALLEY 11 #7-7-33-27 0-6-CH	RANCHO WATER VALLEY 11 #7-7-33-270-6 -CH (PWB)	Slot #11	Rancho Water Valley	946.15	12090.94	12090.94	889.46	12090.94	16.69	12090.94
FRYE FARMS 6 #1-6-33-09 0-4-NH	FRYE FARMS 6 #1-6-33-090-4 -NH (PWB)	Slot #6	Frye Farms	974.18	12090.94	12090.94	917.44	12090.94	17.17	12090.94
RANCHO WATER VALLEY 12 #7-7-33-27 0-4-NH	RANCHO WATER VALLEY 12 #7-7-33-270-4 -NH (PWB)	Slot #12	Rancho Water Valley	990.57	12090.94	12090.94	837.18	12090.94	6.46	12090.94
RANCHO WATER VALLEY 11 #7-7-33-27 0-6-CH	RANCHO WATER VALLEY 11 #7-7-33-270-6 -CH (AWB)	Slot #11	Rancho Water Valley	998.31	12090.94	12090.94	878.79	12090.94	8.35	12090.94
FRYE FARM 7-5-32	FRYE FARM 7-5-32 (AWB)	FRYE FARMS #7-5-32	Frye Farms	1139.61	9749.90	9749.90	1077.31	9744.09	18.25	9694.88
RANCHO WATER VALLEY 4 #7-1-4-270 -4-NH	RANCHO WATER VALLEY 4 #7-1-4-270-4- NH (PWB)	Slot #04	Rancho Water Valley	1159.73	12090.94	12090.94	1038.78	12090.94	9.59	12090.94
FRYE FARMS 7 #1-6-33-09 0-4-NH	FRYE FARMS 7 #1-6-33-090-4 -NH (PWB)	Slot #7	Frye Farms	1257.86	12090.94	12090.94	1201.33	12090.94	22.25	12090.94
RANCHO WATER VALLEY 13 #7-6-33-27 0-6-CH	RANCHO WATER VALLEY 13 #7-6-33-270-6 -CH (PWB)	Slot #13	Rancho Water Valley	1273.55	12090.94	12090.94	1187.53	12090.94	14.80	12090.94
FRYE FARMS 8 #1-5-33-09 0-4-NH	FRYE FARMS 8 #1-5-33-090-4 -NH (PWB)	Slot #8	Frye Farms	1558.16	12090.94	12090.94	1502.60	12090.94	28.05	12090.94
RANCHO WATER VALLEY 5 #7-2-4-270 -4-NH	RANCHO WATER VALLEY 5 #7-2-4-270-4- NH (PWB)	Slot #05	Rancho Water Valley	1587.87	12090.94	12090.94	1402.40	12090.94	8.56	12090.94
FRYE FARMS 13 #5-5-32-09 0-6-CH	FRYE FARMS 13 #5-5-32-090-6 -CH (PWB)	Slot #13	Frye Farms	1694.82	9590.61	9590.61	1657.50	9590.61	30.69	12090.94
FRYE FARMS 9 #1-5-33-09 0-4-NH	FRYE FARMS 9 #1-5-33-090-4 -NH (PWB)	Slot #9	Frye Farms	1865.16	12063.01	12063.01	1810.98	12090.94	34.32	12090.94
FRYE FARMS 10	FRYE FARMS 10	Slot #10	Frye Farms	2163.72	11929.60	11929.60	2111.98	11942.26	41.12	12090.94

All data is in Feet unless otherwise stated
Coordinates are from Slot MD's are from Rig and TVD's are from Rig (Planned Datum #1 4954.0ft above Mean Sea Level)
Vertical Section is from 0.00N 0.00E on azimuth 104.840 degrees
Prepared by Peterson Energy
Date Printed: 2-May-2013



SYSDRILL
Closest Approach + Clearance Factor Summary Report
Wellbore: Pavistma South 5 #1-8-32-090-4-NH (PWB)
Wellpath: Pavistma South 5 #1-8-32-090-4-NH (PWP#1)

Clearance Summary										
Offset WellName	Offset Wellbore	Offset Slot	Offset Structure	Separation [ft]	MD[ft]	Diverging From[ft]	Ellipse Separation [ft]	Ellipse MD[ft]	Clearance Factor	Clearance MD[ft]
#1-4-33-09 0-4-NH	#1-4-33-090-4 -NH (PWB)									
FRYE FARMS 11 #1-4-33-09 0-4-NH	FRYE FARMS 11 #1-4-33-090-4 -NH (PWB)	Slot #11	Frye Farms	2513.04	11827.43	11827.43	2463.39	11843.83	49.08	12090.94
FRYE FARMS 12 #1-3-33-09 0-4-NH	FRYE FARMS 12 #1-3-33-090-4 -NH (PWB)	Slot #12	Frye Farms	2772.08	11781.11	11781.11	2723.60	11800.00	54.97	12090.94
HILLSIDE 17 #3-1-33-09 0-4-NH	HILLSIDE 17 #3-1-33-090-4 -NH (PWB)	Slot #17	Hillside	3304.65	12090.94	12090.94	3236.31	12090.94	48.36	12090.94
RAINDAN CE 6 #1-2-32-09 0-4-CH	RAINDANCE 6 #1-2-32-090-4 -CH (PWB)	Slot #6	Raindance	3591.20	5446.19	11488.34	3539.60	11482.94	16.38	11450.13
HILLSIDE 18 #2-1-33-09 0-4-NH	HILLSIDE 18 #2-1-33-090-4 -NH (PWB)	Slot #18	Hillside	3630.36	12090.94	12090.94	3562.83	12090.94	53.76	12090.94
RAINDAN CE 5 #1-2-32-09 0-4-NH	RAINDANCE 5 #1-2-32-090-4 -NH (PWB)	Slot #5	Raindance	3706.16	5216.54	11488.04	3683.03	5216.54	17.04	11450.13
RANCHO WATER VALLEY #2-6-4	RANCHO WATER VALLEY #2-6-4 (AWB)	Slot #03	Rancho Water Valley	3778.53	12090.94	12090.94	3741.52	12090.94	102.10	12090.94
HILLSIDE 15 #2-1-33-09 0-4-CH	HILLSIDE 15 #2-1-33-090-4 -CH (PWB)	Slot #15	Hillside	3804.67	12090.94	12090.94	3737.76	12090.94	56.85	12090.94
HILLSIDE 14 #2-1-33-09 0-4-NH	HILLSIDE 14 #2-1-33-090-4 -NH (PWB)	Slot #14	Hillside	3960.12	12090.94	12090.94	3892.91	12090.94	58.92	12090.94
RAINDAN CE 4 #1-1-32-09 0-4-NH	RAINDANCE 4 #1-1-32-090-4 -NH (PWB)	Slot #4	Raindance	4024.80	5118.11	11483.75	4004.62	5167.32	18.49	11532.15
RAINDAN CE 2 #1-1-32-09 0-4-NH	RAINDANCE 2 #1-1-32-090-4 -NH	Slot #2	Raindance	4049.01	1000.66	11482.94	4046.50	836.61	19.96	11614.17
RAINDAN CE 3 #1-1-32-09 0-4-CH	RAINDANCE 3 #1-1-32-090-4 -CH (PWB)	Slot #3	Raindance	4049.07	1000.66	11483.41	4046.56	836.61	19.31	11564.96
RAINDAN CE 1 #1-1-32	RAINDANCE 1 #1-1-32 (PWB)	Slot #1	Raindance	4053.17	1000.66	1000.66	4050.88	1000.66	244.29	11433.73
RAINDAN CE 9 #1-0-32-09 0-4-NH	RAINDANCE 9 #1-0-32-090-4 -NH (PWB)	Slot #9	Raindance	4062.31	1000.66	11482.94	4060.03	1000.66	55.04	12090.94
RAINDAN CE 8	RAINDANCE 8	Slot #8	Raindance	4063.58	1000.66	11482.94	4061.29	1000.66	56.91	12090.94

All data is in Feet unless otherwise stated
Coordinates are from Slot MD's are from Rig and TVD's are from Rig (Planned Datum #1 4954.0ft above Mean Sea Level)
Vertical Section is from 0.00N 0.00E on azimuth 104.840 degrees
Prepared by Peterson Energy
Date Printed: 2-May-2013



SYSDRILL
Closest Approach + Clearance Factor Summary Report
Wellbore: Pavistma South 5 #1-8-32-090-4-NH (PWB)
Wellpath: Pavistma South 5 #1-8-32-090-4-NH (PWP#1)

Clearance Summary										
Offset WellName	Offset Wellbore	Offset Slot	Offset Structure	Separation [ft]	MD[ft]	Diverging From[ft]	Ellipse Separation [ft]	Ellipse MD[ft]	Clearance Factor	Clearance MD[ft]
#1-0-32-09 0-4-CH	#1-0-32-090-4 -CH (PWB)									
RAINDAN CE 7 #1-0-32-09 0-4-NH	RAINDANCE 7 #1-0-32-090-4 -NH (PWB)	Slot #7	Raindance	4064.90	1000.66	11475.84	4062.62	1000.66	57.48	12090.94
CENTER POINT 2 #1-1-33-09 0-4-NH	CENTER POINT 2 #1-1-33-090-4 -NH (PWB)	Slot #2	Center Point	4292.95	12090.94	12090.94	4237.47	12090.94	77.39	12090.94
HILLSIDE 2-4-32	HILLSIDE 2-4-32 (PWB)	HILLSIDE 2-4-32	Hillside	4302.48	1410.76	8776.25	4297.10	1410.76	89.13	10433.07
HILLSIDE 9 #7-7-29-00 0-4-NH	HILLSIDE 9 #7-7-29-000-4 -NH (PWB)	Slot #9	Hillside	4338.50	1000.66	11352.30	4336.08	836.61	61.38	12090.94
HILLSIDE 8 #7-7-29-00 0-4-NH	HILLSIDE 8 #7-7-29-000-4 -NH (PWB)	Slot #8	Hillside	4346.50	1000.66	11065.26	4344.08	836.61	70.17	12090.94
HILLSIDE 11 #0-7-28-00 0-4-CH	HILLSIDE 11 #0-7-28-000-4 -CH (PWB)	Slot #11	Hillside	4346.66	918.64	11800.00	4344.24	836.61	51.36	12090.94
HILLSIDE 5 #6-7-29-00 0-4-NH	HILLSIDE 5 #6-7-29-000-4 -NH (PWB)	Slot #5	Hillside	4352.83	1000.66	10777.56	4350.40	836.61	81.03	12090.94
HILLSIDE 10 #8-7-29-00 0-4-NH	HILLSIDE 10 #8-7-29-000-4 -NH (PWB)	Slot #10	Hillside	4352.86	967.85	11672.69	4350.43	836.61	54.98	12090.94
HILLSIDE 4 #5-7-29-00 0-4-NH	HILLSIDE 4 #5-7-29-000-4 -NH (PWB)	Slot #4	Hillside	4359.21	1000.66	9763.24	4356.78	836.61	140.61	12090.94
HILLSIDE 7 #7-7-29-00 0-4-CH	HILLSIDE 7 #7-7-29-000-4 -CH (PWB)	Slot #7	Hillside	4360.83	967.85	11220.47	4358.67	836.61	91.68	12090.94
HILLSIDE 6 #6-7-29-00 0-4-CH	HILLSIDE 6 #6-7-29-000-4 -CH (PWB)	Slot #6	Hillside	4367.14	967.85	10458.72	4364.71	836.61	96.04	12090.94
HILLSIDE 3 #5-7-29-00 0-4-NH	HILLSIDE 3 #5-7-29-000-4 -NH (PWB)	Slot #3	Hillside	4373.49	918.64	10318.24	4371.07	836.61	104.87	12090.94
HILLSIDE 2 #5-7-29-00 0-4-CH	HILLSIDE 2 #5-7-29-000-4 -CH (PWB)	Slot #2	Hillside	4381.60	918.64	9842.52	4379.18	836.61	137.89	12090.94
CENTER POINT 1 #1-1-33-09 0-4-CH	CENTER POINT 1 #1-1-33-090-4 -CH (PWB)	Slot #1	Center Point	4464.68	12090.94	12090.94	4409.10	12090.94	80.33	12090.94
CENTER POINT 3 #1-1-33-09	CENTER POINT 3 #1-1-33-090-4	Slot #3	Center Point	4621.53	12090.94	12090.94	4566.12	12090.94	83.40	12090.94

All data is in Feet unless otherwise stated
Coordinates are from Slot MD's are from Rig and TVD's are from Rig (Planned Datum #1 4954.0ft above Mean Sea Level)
Vertical Section is from 0.00N 0.00E on azimuth 104.840 degrees
Prepared by Peterson Energy
Date Printed: 2-May-2013



SYSDRILL
Closest Approach + Clearance Factor Summary Report
Wellbore: Pavistma South 5 #1-8-32-090-4-NH (PWB)
Wellpath: Pavistma South 5 #1-8-32-090-4-NH (PWP#1)

Clearance Summary										
Offset WellName	Offset Wellbore	Offset Slot	Offset Structure	Separation [ft]	MD[ft]	Diverging From[ft]	Ellipse Separation [ft]	Ellipse MD[ft]	Clearance Factor	Clearance MD[ft]
0-4-NH	-NH (PWB)									
CENTER POINT 4 #1-0-33-09 0-4-NH	CENTER POINT 4 #1-0-33-090-4 -NH (PWB)	Slot #4	Center Point	4860.30	12090.94	12090.94	4804.99	12090.94	87.89	12090.94
CENTER POINT 6 #1-0-33-09 0-4-CH	CENTER POINT 6 #1-0-33-090-4 -CH (PWB)	Slot #6	Center Point	4973.79	12090.94	12090.94	4918.31	12090.94	89.65	12090.94
RANCHO WATER VALLEY #2-8-4	RANCHO WATER VALLEY 2-8-4 (AWB)	Slot #02	Rancho Water Valley	4997.94	12090.94	12090.94	4972.92	12090.94	199.75	12090.94
CENTER POINT 8 #1-0-33-09 0-4-NH	CENTER POINT 8 #1-0-33-090-4 -NH (PWB)	Slot #8	Center Point	5039.14	12090.94	12090.94	4983.73	12090.94	90.95	12090.94
RANCHO WATER VALLEY 9 #8-7-33-00 0-4-CH	RANCHO WATER VALLEY 9 #8-7-33-000-4 -CH (PWB)	Slot #09	Rancho Water Valley	5267.84	12090.94	12090.94	5203.00	12090.94	81.24	12090.94
RANCHO WATER VALLEY 8 #8-7-33-00 0-4-NH	RANCHO WATER VALLEY 8 #8-7-33-000-4 -NH (PWB)	Slot #08	Rancho Water Valley	5365.14	12090.94	12090.94	5326.53	12090.94	138.95	12090.94
RANCHO WATER VALLEY #3-9-4	RANCHO WATER VALLEY #3-9-4 (AWB)	Slot #01	Rancho Water Valley	5605.74	12090.94	12090.94	5569.01	12090.94	152.62	12090.94
Poudre #36-28	Poudre #36-28 (AWB)	Poudre #36-28	Poudre (Kerr-McGee Oil & Gas)	5738.88	12090.94	12090.94	5671.34	12090.94	84.97	12090.94
Poudre #14-28	Poudre #14-28 (AWB)	Poudre #14-28	Poudre (Kerr-McGee Oil & Gas)	5974.97	12090.94	12090.94	5923.59	12090.94	116.30	12090.94
Poudre #15-28	Poudre #15-28 (AWB)	Poudre #15-28	Poudre (Kerr-McGee Oil & Gas)	6522.36	12090.94	12090.94	6449.74	12090.94	89.81	12090.94
Poudre #19-28	Poudre #19-28 (AWB)	Poudre #19-28	Poudre (Kerr-McGee Oil & Gas)	6541.36	12090.94	12090.94	6473.93	12090.94	97.01	12090.94
Poudre #23-28	Poudre #23-28 (AWB)	Poudre #23-28	Poudre (Kerr-McGee Oil & Gas)	6847.42	12090.94	12090.94	6793.00	12090.94	125.82	12090.94
Poudre #11-28	Poudre #11-28 (AWB)	Poudre #11-28	Poudre (Kerr-McGee Oil & Gas)	7308.74	12090.94	12090.94	7248.82	12090.94	121.96	12090.94
Kodak 15 #7-4-28-27 0-4-NH	Kodak 15 #7-4-28-270-4 -NH (PWB)	Slot #15	Kodak	7631.35	12090.94	12090.94	7534.71	12090.94	78.97	12090.94
Poudre #10-28	Poudre #10-28 (AWB)	Poudre #10-28	Poudre (Kerr-McGee Oil & Gas)	7692.65	12090.94	12090.94	7626.26	12090.94	115.87	12090.94
Kodak 14 #7-4-28-27 0-4-CH	Kodak 14 #7-4-28-270-4 -CH (PWB)	Slot #14	Kodak	7801.93	12090.94	12090.94	7705.27	12090.94	80.72	12090.94

All data is in Feet unless otherwise stated
Coordinates are from Slot MD's are from Rig and TVD's are from Rig (Planned Datum #1 4954.0ft above Mean Sea Level)
Vertical Section is from 0.00N 0.00E on azimuth 104.840 degrees
Prepared by Peterson Energy
Date Printed: 2-May-2013



SYSDRILL
Closest Approach + Clearance Factor Summary Report
Wellbore: Pavistma South 5 #1-8-32-090-4-NH (PWB)
Wellpath: Pavistma South 5 #1-8-32-090-4-NH (PWP#1)

Clearance Summary										
Offset WellName	Offset Wellbore	Offset Slot	Offset Structure	Separation [ft]	MD[ft]	Diverging From[ft]	Ellipse Separation [ft]	Ellipse MD[ft]	Clearance Factor	Clearance MD[ft]
Kodak 13 #7-4-28-27 0-4-NH	Kodak 13 #7-4-28-270-4 -NH (PWB)	Slot #13	Kodak	7961.02	12090.94	12090.94	7864.35	12090.94	82.35	12090.94
Poudre #25-28	Poudre #25-28 (AWB)	Poudre #25-28	Poudre (Kerr-McGee Oil & Gas)	7992.17	12090.94	12090.94	7930.00	12090.94	128.55	12090.94
W Great Western #27-14	W Great Western #27-14 (AWB)	Great Western #27-14	Great Western (Great Western Oil & Gas)	8037.35	12090.94	12090.94	7996.60	12090.94	197.21	12090.94
Kodak 12 #7-3-28-27 0-4-NH	Kodak 12 #7-3-28-270-4 -NH (PWB)	Slot #12	Kodak	8290.72	12090.94	12090.94	8194.01	12090.94	85.72	12090.94
Kodak 11 #7-3-28-27 0-4-CH	Kodak 11 #7-3-28-270-4 -CH (PWB)	Slot #11	Kodak	8460.85	12090.94	12090.94	8364.12	12090.94	87.47	12090.94
Kodak 10 #7-3-28-27 0-4-NH	Kodak 10 #7-3-28-270-4 -NH (PWB)	Slot #10	Kodak	8620.45	12090.94	12090.94	8523.70	12090.94	89.10	12090.94
Kodak 9 #7-2-28-27 0-4-NH	Kodak 9 #7-2-28-270-4 -NH (PWB)	Slot #9	Kodak	8950.19	12090.94	12090.94	8853.38	12090.94	92.45	12090.94
W Great Western # 27-53	W Great Western # 27-53 (AWB)	Great Western # 27-53	Great Western (Great Western Oil & Gas)	8973.76	12090.94	12090.94	8932.97	12090.94	219.95	12090.94
Great Western 27-13	W #12 Great Western 27-13 (AWB)	Great Western #27-13	Great Western (Great Western Oil & Gas)	9057.55	12090.94	12090.94	9014.74	12090.94	211.61	12090.94
Kodak 8 #7-2-28-27 0-4-CH	Kodak 8 #7-2-28-270-4 -CH (PWB)	Slot #8	Kodak	9119.91	12090.94	12090.94	9023.08	12090.94	94.18	12090.94
Kodak 7 #7-2-28-27 0-4-NH	Kodak 7 #7-2-28-270-4 -NH (PWB)	Slot #7	Kodak	9279.91	12090.94	12090.94	9183.05	12090.94	95.81	12090.94
W Great Western #27-23	W Great Western #27-23 (AWB)	Great Western #27-23	Great Western (Great Western Oil & Gas)	9512.76	12090.94	12090.94	9473.44	12090.94	241.92	12090.94
Kodak 6 #7-1-28-27 0-4-NH	Kodak 6 #7-1-28-270-4 -NH (PWB)	Slot #6	Kodak	9609.65	12090.94	12090.94	9512.72	12090.94	99.14	12090.94
Kodak 5 #7-1-28-27 0-4-CH	Kodak 5 #7-1-28-270-4 -CH (PWB)	Slot #5	Kodak	9779.08	12090.94	12090.94	9682.12	12090.94	100.86	12090.94
Kodak 4 #7-1-28-27 0-4-NH	Kodak 4 #7-1-28-270-4 -NH (PWB)	Slot #4	Kodak	9939.44	12090.94	12090.94	9842.44	12090.94	102.47	12090.94
W Great Western #27-12	W Great Western #27-12 (AWB)	Great Western #27-12	Great Western 66N67W	10115.91	12090.94	12090.94	10071.76	12090.94	229.15	12090.94
Kodak 3 #7-0-28-27	Kodak 3 #7-0-28-270-4	Slot #3	Kodak	10269.22	12090.94	12090.94	10172.14	12090.94	105.78	12090.94

All data is in Feet unless otherwise stated
Coordinates are from Slot MD's are from Rig and TVD's are from Rig (Planned Datum #1 4954.0ft above Mean Sea Level)
Vertical Section is from 0.00N 0.00E on azimuth 104.840 degrees
Prepared by Peterson Energy
Date Printed: 2-May-2013



SYSDRILL
Closest Approach + Clearance Factor Summary Report
Wellbore: Pavistma South 5 #1-8-32-090-4-NH (PWB)
Wellpath: Pavistma South 5 #1-8-32-090-4-NH (PWP#1)

Clearance Summary										
Offset WellName	Offset Wellbore	Offset Slot	Offset Structure	Separation [ft]	MD[ft]	Diverging From[ft]	Ellipse Separation [ft]	Ellipse MD[ft]	Clearance Factor	Clearance MD[ft]
0-4-NH	-NH (PWB)									
Kodak 2 #7-0-28-27 0-4-CH	Kodak 2 #7-0-28-270-4 -CH (PWB)	Slot #2	Kodak	10438.37	12090.94	12090.94	10341.25	12090.94	107.48	12090.94
Kodak 1 #7-8-21-27 0-4-NH	Kodak 1 #7-8-21-270-4 -NH (PWB)	Slot #1	Kodak	10599.00	12090.94	12090.94	10501.83	12090.94	109.07	12090.94
W Great Western #27-22	W Great Western #27-22 (AWB)	Great Western #27-22	Great Western 66N67W	10769.07	12090.94	12090.94	10727.20	12090.94	257.19	12090.94
DIAMOND VALLEY SW 9-5-22	DIAMOND VALLEY SW 1 #4-7-22-270-6 -NH (PWB #2)	Slot #1	Diamond Valley SW	10928.76	12090.94	12090.94	10822.16	12090.94	102.53	12090.94
W Great Western #27-52	W Great Western #27-52 (AWB)	Great Western #27-52	Great Western 66N67W	11030.41	12090.94	12090.94	10986.49	12090.94	251.14	12090.94
DIAMOND VALLEY SW 2	DIAMOND VALLEY SW 2 #4-7-22-270-6 -CH (PWB #2)	Slot #2	Diamond Valley SW	11096.71	12090.94	12090.94	10990.08	12090.94	104.07	12090.94
DIAMOND VALLEY SW 9-5-22	DIAMOND VALLEY SW 1 #4-7-22-270-6 -NH (PWB)	Slot #1	Diamond Valley SW	11132.25	12090.94	12090.94	11025.65	12090.94	104.43	12090.94
W Great Western #27-11	W Great Western #27-11 (AWB)	Great Western #27-11	Great Western 66N67W	11230.78	12090.94	12090.94	11185.77	12090.94	249.53	12090.94
DIAMOND VALLEY SW 3	DIAMOND VALLEY SW 3 #4-7-22-270-6 -NH (PWB #2)	Slot #3	Diamond Valley SW	11258.21	12090.94	12090.94	11151.57	12090.94	105.57	12090.94
DIAMOND VALLEY SW 2	DIAMOND VALLEY SW 2 #3-7-22-270-6 -CH (PWB)	Slot #2	Diamond Valley SW	11303.14	12090.94	12090.94	11196.61	12090.94	106.10	12090.94
DIAMOND VALLEY SW 3	DIAMOND VALLEY SW 3 #3-6-22-270-6 -NH (PWB)	Slot #3	Diamond Valley SW	11463.60	12090.94	12090.94	11356.93	12090.94	107.47	12090.94
DIAMOND VALLEY SW 4	DIAMOND VALLEY SW 4 #4-6-22-270-6 -NH (PWB #2)	Slot #4	Diamond Valley SW	11588.09	12090.94	12090.94	11481.40	12090.94	108.62	12090.94
DIAMOND VALLEY SW 8-2-22	DIAMOND VALLEY SW 5 #4-6-22-270-6 -CH (PWB)	Slot #5	Diamond Valley SW	11756.70	12090.94	12090.94	11649.99	12090.94	110.17	12090.94

All data is in Feet unless otherwise stated
Coordinates are from Slot MD's are from Rig and TVD's are from Rig (Planned Datum #1 4954.0ft above Mean Sea Level)
Vertical Section is from 0.00N 0.00E on azimuth 104.840 degrees
Prepared by Peterson Energy
Date Printed: 2-May-2013



SYSDRILL
Closest Approach + Clearance Factor Summary Report
Wellbore: Pavistma South 5 #1-8-32-090-4-NH (PWB)
Wellpath: Pavistma South 5 #1-8-32-090-4-NH (PWP#1)

Clearance Summary										
Offset WellName	Offset Wellbore	Offset Slot	Offset Structure	Separation [ft]	MD[ft]	Diverging From[ft]	Ellipse Separation [ft]	Ellipse MD[ft]	Clearance Factor	Clearance MD[ft]
	#2)									
DIAMOND VALLEY SW 4	DIAMOND VALLEY SW 4 #3-6-22-270-6-NH (PWB)	Slot #4	Diamond Valley SW	11791.31	12090.94	12090.94	11684.59	12090.94	110.49	12090.94
Great Western 27-31-8	Great Western 27-31-8 (AWB)	Great Western 27-31-8	Great Western Diamond Valley	11849.14	12090.94	12090.94	11806.77	12090.94	279.60	12090.94
W Great Western #27-21	W Great Western #27-21 (AWB)	Great Western #27-21	Great Western 66N67W	11852.07	12090.94	12090.94	11810.78	12090.94	287.07	12090.94
DIAMOND VALLEY SW 6	DIAMOND VALLEY SW 6 #4-6-22-270-6-NH (PWB #2)	Slot #6	Diamond Valley SW	11917.87	12090.94	12090.94	11811.14	12090.94	111.66	12090.94
DIAMOND VALLEY SW 8-2-22	DIAMOND VALLEY SW 5 #3-6-22-270-6-CH (PWB)	Slot #5	Diamond Valley SW	11962.48	12090.94	12090.94	11855.77	12090.94	112.10	12090.94
DIAMOND VALLEY SW 6	DIAMOND VALLEY SW 6 (PWB)	Slot #6	Diamond Valley SW	12122.68	12090.94	12090.94	12015.88	12090.94	113.51	12090.94
DIAMOND VALLEY SW 7	DIAMOND VALLEY SW 7 #4-5-22-270-6-NH (PWB #2)	Slot #7	Diamond Valley SW	12247.71	12090.94	12090.94	12140.87	12090.94	114.64	12090.94
DIAMOND VALLEY SW 8-2-22	DIAMOND VALLEY SW 8-2-22 (PWB)	Slot #5	Diamond Valley SW	12398.24	12090.94	12090.94	12320.31	12090.94	159.10	12090.94
DIAMOND VALLEY SW 8	DIAMOND VALLEY SW 8 #4-5-22-270-6-CH (PWB #2)	Slot #8	Diamond Valley SW	12416.10	12090.94	12090.94	12309.22	12090.94	116.17	12090.94
DIAMOND VALLEY SW 7	DIAMOND VALLEY SW 7 #3-5-22-270-6-NH (PWB)	Slot #7	Diamond Valley SW	12454.14	12090.94	12090.94	12347.35	12090.94	116.62	12090.94
DIAMOND VALLEY SW 8	DIAMOND VALLEY SW 8 #3-5-22-270-6-CH PWB)	Slot #8	Diamond Valley SW	12566.85	12090.94	12090.94	12460.03	12090.94	117.65	12090.94
DIAMOND VALLEY SW 9	DIAMOND VALLEY SW 9 #4-5-22-270-6-NH (PWB #2)	Slot #9	Diamond Valley SW	12577.51	12090.94	12090.94	12470.59	12090.94	117.63	12090.94
DIAMOND VALLEY	DIAMOND VALLEY SW 9	Slot #9	Diamond Valley SW	12781.88	12090.94	12090.94	12674.92	12090.94	119.49	12090.94

All data is in Feet unless otherwise stated
Coordinates are from Slot MD's are from Rig and TVD's are from Rig (Planned Datum #1 4954.0ft above Mean Sea Level)
Vertical Section is from 0.00N 0.00E on azimuth 104.840 degrees
Prepared by Peterson Energy
Date Printed: 2-May-2013



SYSDRILL
Closest Approach + Clearance Factor Summary Report
Wellbore: Pavistma South 5 #1-8-32-090-4-NH (PWB)
Wellpath: Pavistma South 5 #1-8-32-090-4-NH (PWP#1)

Clearance Summary										
Offset WellName	Offset Wellbore	Offset Slot	Offset Structure	Separation [ft]	MD[ft]	Diverging From[ft]	Ellipse Separation [ft]	Ellipse MD[ft]	Clearance Factor	Clearance MD[ft]
SW 9	#3-4-22-270-6 -NH (PWB)									
Great Western 27-21-3	Great Western 27-21-3 (AWB)	Great Western 27-21-3	Great Western Diamond Valley	12873.18	12090.94	12090.94	12829.67	12090.94	295.86	12090.94
DIAMOND VALLEY SW 2	DIAMOND VALLEY SW 8-4-22 (PWB)	Slot #2	Diamond Valley SW	13061.11	12090.94	12090.94	13012.61	12090.94	269.27	12090.94
DIAMOND VALLEY SW 10	DIAMOND VALLEY SW 10 #3-4-22-270-6 -NH (PWB)	Slot #10	Diamond Valley SW	13113.48	12090.94	12090.94	13006.54	12090.94	122.62	12090.94
DIAMOND VALLEY SW 7	DIAMOND VALLEY SW 7-3-22 (PWB)	Slot #7	Diamond Valley SW	13290.58	12090.94	12090.94	13222.11	12090.94	194.11	12090.94
DIAMOND VALLEY SW 8	DIAMOND VALLEY SW 6-2-22 (PWB)	Slot #8	Diamond Valley SW	13506.22	12090.94	12090.94	13419.29	12090.94	155.37	12090.94
Great Western 27-41-10	Great Western 27-41-10 (AWB)	Great Western 27-41-10	Great Western Diamond Valley	13684.51	12090.94	12090.94	13645.24	12090.94	348.48	12090.94
Great Western 27-31-2	Great Western 27-31-2 (AWB)	Great Western 27-31-2	Great Western Diamond Valley	13685.74	12090.94	12090.94	13643.53	12090.94	324.23	12090.94
Diamond Valley 22-34	Diamond Valley 22-34 (AWB)	Diamond Valley 22-34	Great Western Diamond Valley	13726.30	12090.94	12090.94	13683.01	12090.94	317.08	12090.94
Diamond Valley 22-23-18	Diamond Valley 22-23-18 (AWB)	Diamond Valley 22-23-18	Great Western Diamond Valley	13971.42	12090.94	12090.94	13927.08	12090.94	315.06	12090.94
DIAMOND VALLEY SW 10	DIAMOND VALLEY SW 6-4-22 (PWB)	Slot #10	Diamond Valley SW	14090.97	12090.94	12090.94	14033.79	12090.94	246.45	12090.94
Diamond Valley 22-54	Diamond Valley 22-54 (AWB)	Diamond Valley 22-54	Great Western Diamond Valley	14540.71	12090.94	12090.94	14498.88	12090.94	347.62	12090.94
Diamond Valley 22-22-13	Diamond Valley 22-22-13 (AWB)	Diamond Valley 22-22-13	Great Western Diamond Valley	14548.96	12090.94	12090.94	14508.24	12090.94	357.22	12090.94
Great Western 27-41-1	Great Western 27-41-1 (AWB)	Great Western 27-41-1	Great Western Diamond Valley	14551.72	12090.94	12090.94	14511.29	12090.94	359.91	12090.94
Diamond Valley 22-44	Diamond Valley 22-44 (AWB)	Diamond Valley 22-44	Great Western Diamond Valley	14575.37	12090.94	12090.94	14534.10	12090.94	353.18	12090.94
Diamond Valley 22-33	Diamond Valley 22-33 (AWB)	Diamond Valley 22-33	Great Western Diamond Valley	14620.93	12090.94	12090.94	14580.32	12090.94	360.01	12090.94

All data is in Feet unless otherwise stated
Coordinates are from Slot MD's are from Rig and TVD's are from Rig (Planned Datum #1 4954.0ft above Mean Sea Level)
Vertical Section is from 0.00N 0.00E on azimuth 104.840 degrees
Prepared by Peterson Energy
Date Printed: 2-May-2013



SYSDRILL
Closest Approach + Clearance Factor Summary Report
Wellbore: Pavistma South 5 #1-8-32-090-4-NH (PWB)
Wellpath: Pavistma South 5 #1-8-32-090-4-NH (PWP#1)

Clearance Summary										
Offset WellName	Offset Wellbore	Offset Slot	Offset Structure	Separation [ft]	MD[ft]	Diverging From[ft]	Ellipse Separation [ft]	Ellipse MD[ft]	Clearance Factor	Clearance MD[ft]
Diamond Valley 22-32-12	Diamond Valley 22-32-12 (AWB)	Diamond Valley 22-32-12	Great Western Diamond Valley	14735.06	12090.94	12090.94	14695.19	12090.94	369.57	12090.94
Diamond Valley 22-43	Diamond Valley 22-43 (AWB)	Diamond Valley 22-43	Great Western Diamond Valley	14795.37	12090.94	12090.94	14755.78	12090.94	373.79	12090.94