

# TEKTON WINDSOR, LLC

Location	Windsor, CO, USA(Imported)	Slot	Slot #2
Field	Windsor Project	Well	Pavistma South 2 #1-5-32-090-4-CH
Installation	Pavistma South	Wellbore	Pavistma South 2 #1-5-32-090-4-CH (PWB)

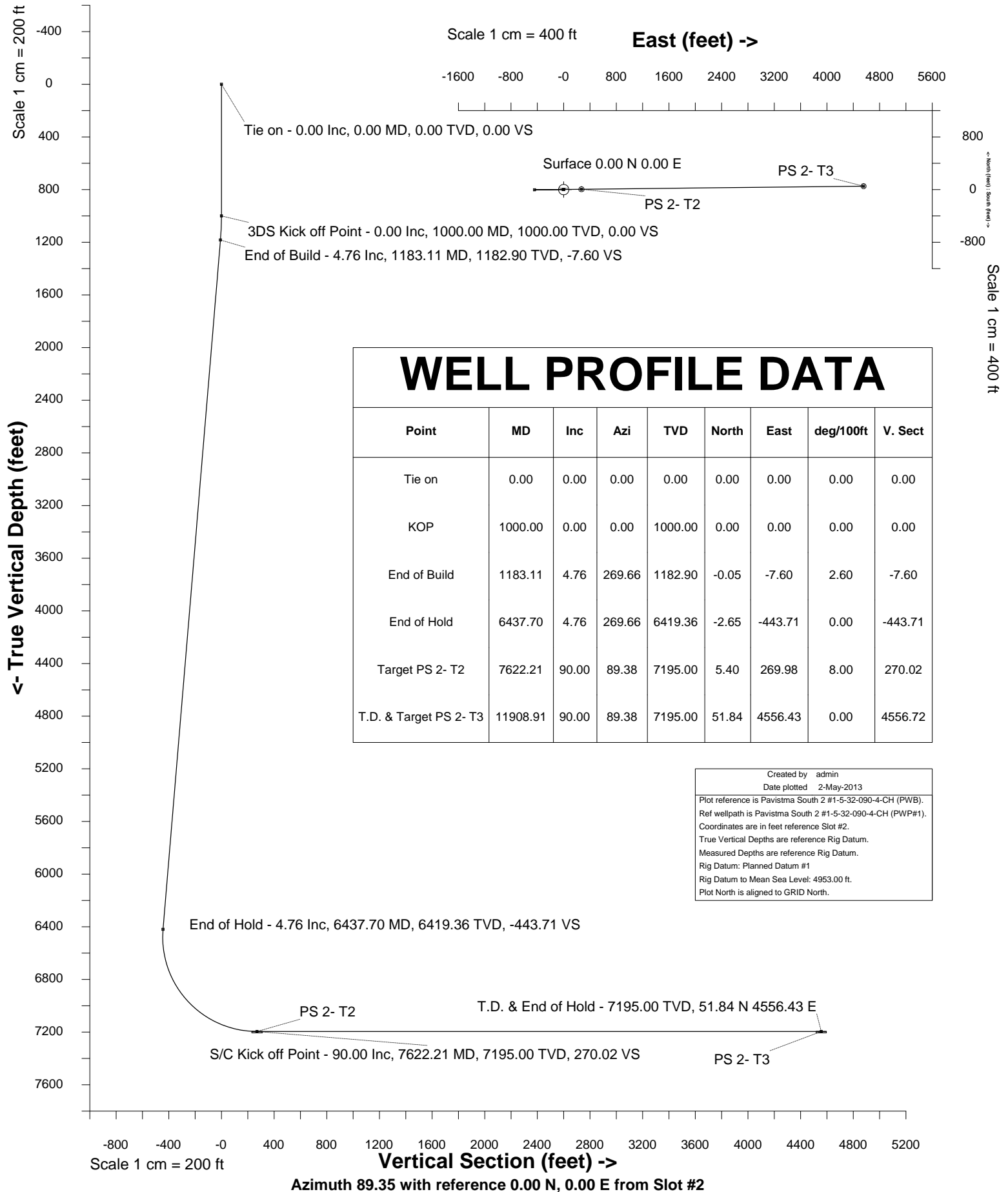



INTEGRATED PETROLEUM TECHNOLOGIES, INC  
 SYSDRILL  
 Well Design Combined Report  
 Wellbore: Pavistma South 2 #1-5-32-090-4-CH (PWB)  
 Wellpath: Pavistma South 2 #1-5-32-090-4-CH (PWP#1)

Wellhead Details							
Name	Northing	Easting	Latitude	Longitude	North	East	Slot Elevation Above Installation
Slot #2	1403833.7079	3160096.7633	N40 26 25.8000	W104 55 29.3520	10.98S	8.28W	-0.00

Declination		
Date	Source	Time
8-Mar-2013	IGRF Model [1900.0-2015.0]	16:01

Site Details				
Name	Northing	Easting	Coord System Name	North Alignment
Pavistma South	1403844.6909	3160105.0426	CO83-NF on NORTH AMERICAN DATUM 1983 datum	Grid

Summary Wellpath									
MD[ft]	Inc[deg]	Azi[deg]	TVD[ft]	North[ft]	East[ft]	Dogleg [deg/100ft]	Vertical Section[ft]	Northing	Easting
0.00	0.00	0.000	0.00	0.00N	0.00E		0.00	1403833.71	3160096.76
1000.00	0.00	0.000	1000.00	0.00N	0.00E	==>	0.00	1403833.71	3160096.76
1183.11	4.76	269.660	1182.90	0.05S	7.60W	2.60	-7.60	1403833.66	3160089.16
6437.70	4.76	269.660	6419.36	2.65S	443.71W	==>	-443.71	1403831.06	3159653.07
7622.21	90.00	89.380	7195.00	5.40N	269.98E	8.00	270.02	1403839.10	3160366.73
11908.91	90.00	89.380	7195.00	51.84N	4556.43E	==>	4556.72	1403885.54	3164653.01

Interpolated Wellpath									
MD[ft]	Inc[deg]	Azi[deg]	TVD[ft]	North[ft]	East[ft]	Dogleg [deg/100ft]	Vertical Section[ft]	Northing	Easting
0.00	0.00	0.000	0.00	0.00N	0.00E		0.00	1403833.71	3160096.76
100.00	0.00	0.000	100.00	0.00N	0.00E	==>	0.00	1403833.71	3160096.76
200.00	0.00	0.000	200.00	0.00N	0.00E	==>	0.00	1403833.71	3160096.76
300.00	0.00	0.000	300.00	0.00N	0.00E	==>	0.00	1403833.71	3160096.76
400.00	0.00	0.000	400.00	0.00N	0.00E	==>	0.00	1403833.71	3160096.76
500.00	0.00	0.000	500.00	0.00N	0.00E	==>	0.00	1403833.71	3160096.76
600.00	0.00	0.000	600.00	0.00N	0.00E	==>	0.00	1403833.71	3160096.76
700.00	0.00	0.000	700.00	0.00N	0.00E	==>	0.00	1403833.71	3160096.76
800.00	0.00	0.000	800.00	0.00N	0.00E	==>	0.00	1403833.71	3160096.76
900.00	0.00	0.000	900.00	0.00N	0.00E	==>	0.00	1403833.71	3160096.76
1000.00	0.00	0.000	1000.00	0.00N	0.00E	==>	0.00	1403833.71	3160096.76
1100.00	2.60	269.660	1099.97	0.01S	2.27W	2.60	-2.27	1403833.69	3160094.49
1183.11	4.76	269.660	1182.90	0.05S	7.60W	2.60	-7.60	1403833.66	3160089.16
1200.00	4.76	269.660	1199.73	0.05S	9.00W	==>	-9.00	1403833.65	3160087.76
1300.00	4.76	269.660	1299.39	0.10S	17.30W	==>	-17.30	1403833.60	3160079.46
1400.00	4.76	269.660	1399.04	0.15S	25.60W	==>	-25.60	1403833.56	3160071.16
1500.00	4.76	269.660	1498.70	0.20S	33.90W	==>	-33.90	1403833.51	3160062.86
1600.00	4.76	269.660	1598.35	0.25S	42.20W	==>	-42.20	1403833.46	3160054.56
1700.00	4.76	269.660	1698.01	0.30S	50.50W	==>	-50.50	1403833.41	3160046.26
1800.00	4.76	269.660	1797.66	0.35S	58.80W	==>	-58.80	1403833.36	3160037.96
1900.00	4.76	269.660	1897.32	0.40S	67.10W	==>	-67.10	1403833.31	3160029.66
2000.00	4.76	269.660	1996.97	0.45S	75.40W	==>	-75.40	1403833.26	3160021.37
2100.00	4.76	269.660	2096.63	0.50S	83.70W	==>	-83.70	1403833.21	3160013.07
2200.00	4.76	269.660	2196.28	0.55S	92.00W	==>	-92.00	1403833.16	3160004.77
2300.00	4.76	269.660	2295.94	0.60S	100.30W	==>	-100.30	1403833.11	3159996.47
2400.00	4.76	269.660	2395.59	0.65S	108.60W	==>	-108.60	1403833.06	3159988.17
2500.00	4.76	269.660	2495.25	0.70S	116.90W	==>	-116.90	1403833.01	3159979.87
2600.00	4.76	269.660	2594.90	0.75S	125.20W	==>	-125.20	1403832.96	3159971.57
2700.00	4.76	269.660	2694.56	0.80S	133.50W	==>	-133.50	1403832.91	3159963.27
2800.00	4.76	269.660	2794.21	0.85S	141.80W	==>	-141.80	1403832.86	3159954.97
2900.00	4.76	269.660	2893.87	0.90S	150.10W	==>	-150.10	1403832.81	3159946.67
3000.00	4.76	269.660	2993.52	0.95S	158.40W	==>	-158.40	1403832.76	3159938.37
3100.00	4.76	269.660	3093.18	1.00S	166.69W	==>	-166.70	1403832.71	3159930.08
3200.00	4.76	269.660	3192.83	1.05S	174.99W	==>	-174.99	1403832.66	3159921.78
3300.00	4.76	269.660	3292.49	1.09S	183.29W	==>	-183.29	1403832.61	3159913.48

All data is in Feet unless otherwise stated  
 Coordinates are from Slot MD's are from Rig and TVD's are from Rig ( Planned Datum #1 4953.0ft above Mean Sea Level )  
 Vertical Section is from 0.00N 0.00E on azimuth 89.350 degrees  
 Bottom hole distance is 4556.72 Feet on azimuth 89.35 degrees from Wellhead  
 Calculation method uses Minimum Curvature method  
 Prepared by Peterson Energy  
 Date Printed: 2-May-2013



INTEGRATED PETROLEUM TECHNOLOGIES, INC  
 SYSDRILL  
 Well Design Combined Report  
 Wellbore: Pavistma South 2 #1-5-32-090-4-CH (PWB)  
 Wellpath: Pavistma South 2 #1-5-32-090-4-CH (PWP#1)

Interpolated Wellpath									
MD[ft]	Inc[deg]	Azi[deg]	TVD[ft]	North[ft]	East[ft]	Dogleg [deg/100ft]	Vertical Section[ft]	Northing	Easting
3400.00	4.76	269.660	3392.14	1.14S	191.59W	==>	-191.59	1403832.56	3159905.18
3500.00	4.76	269.660	3491.80	1.19S	199.89W	==>	-199.89	1403832.51	3159896.88
3600.00	4.76	269.660	3591.45	1.24S	208.19W	==>	-208.19	1403832.46	3159888.58
3700.00	4.76	269.660	3691.11	1.29S	216.49W	==>	-216.49	1403832.41	3159880.28
3800.00	4.76	269.660	3790.76	1.34S	224.79W	==>	-224.79	1403832.37	3159871.98
3900.00	4.76	269.660	3890.42	1.39S	233.09W	==>	-233.09	1403832.32	3159863.68
4000.00	4.76	269.660	3990.07	1.44S	241.39W	==>	-241.39	1403832.27	3159855.38
4100.00	4.76	269.660	4089.73	1.49S	249.69W	==>	-249.69	1403832.22	3159847.08
4200.00	4.76	269.660	4189.38	1.54S	257.99W	==>	-257.99	1403832.17	3159838.78
4300.00	4.76	269.660	4289.04	1.59S	266.29W	==>	-266.29	1403832.12	3159830.49
4400.00	4.76	269.660	4388.69	1.64S	274.59W	==>	-274.59	1403832.07	3159822.19
4500.00	4.76	269.660	4488.35	1.69S	282.89W	==>	-282.89	1403832.02	3159813.89
4600.00	4.76	269.660	4588.00	1.74S	291.19W	==>	-291.19	1403831.97	3159805.59
4700.00	4.76	269.660	4687.66	1.79S	299.49W	==>	-299.49	1403831.92	3159797.29
4800.00	4.76	269.660	4787.31	1.84S	307.79W	==>	-307.79	1403831.87	3159788.99
4900.00	4.76	269.660	4886.97	1.89S	316.09W	==>	-316.09	1403831.82	3159780.69
5000.00	4.76	269.660	4986.62	1.94S	324.38W	==>	-324.38	1403831.77	3159772.39
5100.00	4.76	269.660	5086.28	1.99S	332.68W	==>	-332.69	1403831.72	3159764.09
5200.00	4.76	269.660	5185.93	2.04S	340.98W	==>	-340.98	1403831.67	3159755.79
5300.00	4.76	269.660	5285.59	2.09S	349.28W	==>	-349.28	1403831.62	3159747.49
5400.00	4.76	269.660	5385.24	2.14S	357.58W	==>	-357.58	1403831.57	3159739.20
5500.00	4.76	269.660	5484.90	2.19S	365.88W	==>	-365.88	1403831.52	3159730.90
5600.00	4.76	269.660	5584.55	2.23S	374.18W	==>	-374.18	1403831.47	3159722.60
5700.00	4.76	269.660	5684.21	2.28S	382.48W	==>	-382.48	1403831.42	3159714.30
5800.00	4.76	269.660	5783.86	2.33S	390.78W	==>	-390.78	1403831.37	3159706.00
5900.00	4.76	269.660	5883.52	2.38S	399.08W	==>	-399.08	1403831.32	3159697.70
6000.00	4.76	269.660	5983.17	2.43S	407.38W	==>	-407.38	1403831.27	3159689.40
6100.00	4.76	269.660	6082.83	2.48S	415.68W	==>	-415.68	1403831.23	3159681.10
6200.00	4.76	269.660	6182.48	2.53S	423.98W	==>	-423.98	1403831.18	3159672.80
6300.00	4.76	269.660	6282.14	2.58S	432.28W	==>	-432.28	1403831.13	3159664.50
6400.00	4.76	269.660	6381.79	2.63S	440.58W	==>	-440.58	1403831.08	3159656.20
6437.70	4.76	269.660	6419.36	2.65S	443.71W	==>	-443.71	1403831.06	3159653.07
6500.00	0.22	83.440	6481.59	2.65S	446.17W	8.00	-446.17	1403831.06	3159650.61
6600.00	8.22	89.220	6581.24	2.53S	438.81W	8.00	-438.81	1403831.18	3159657.97
6700.00	16.22	89.300	6678.89	2.26S	417.66W	8.00	-417.66	1403831.45	3159679.12
6800.00	24.22	89.330	6772.65	1.85S	383.12W	8.00	-383.12	1403831.86	3159713.65
6900.00	32.22	89.340	6860.69	1.30S	335.88W	8.00	-335.87	1403832.40	3159760.90
7000.00	40.22	89.350	6941.30	0.63S	276.83W	8.00	-276.82	1403833.08	3159819.94
7100.00	48.22	89.360	7012.90	0.15N	207.15W	8.00	-207.13	1403833.86	3159889.62
7200.00	56.22	89.360	7074.11	1.03N	128.18W	8.00	-128.16	1403834.74	3159968.59
7300.00	64.22	89.370	7123.73	1.99N	41.46W	8.00	-41.43	1403835.70	3160055.31
7400.00	72.22	89.370	7160.80	3.01N	51.33E	8.00	51.36	1403836.72	3160148.09
7500.00	80.22	89.380	7184.60	4.07N	148.36E	8.00	148.40	1403837.78	3160245.12
7600.00	88.22	89.380	7194.66	5.16N	247.77E	8.00	247.81	1403838.86	3160344.52
7622.21	90.00	89.380	7195.00	5.40N	269.98E	8.00	270.02	1403839.10	3160366.73
7700.00	90.00	89.380	7195.00	6.24N	347.76E	==>	347.81	1403839.95	3160444.51
7800.00	90.00	89.380	7195.00	7.32N	447.75E	==>	447.81	1403841.03	3160544.50
7900.00	90.00	89.380	7195.00	8.41N	547.75E	==>	547.81	1403842.11	3160644.49
8000.00	90.00	89.380	7195.00	9.49N	647.74E	==>	647.81	1403843.20	3160744.48
8100.00	90.00	89.380	7195.00	10.57N	747.74E	==>	747.81	1403844.28	3160844.47
8200.00	90.00	89.380	7195.00	11.66N	847.73E	==>	847.81	1403845.36	3160944.46
8300.00	90.00	89.380	7195.00	12.74N	947.72E	==>	947.81	1403846.45	3161044.45
8400.00	90.00	89.380	7195.00	13.82N	1047.72E	==>	1047.81	1403847.53	3161144.44
8500.00	90.00	89.380	7195.00	14.91N	1147.71E	==>	1147.81	1403848.61	3161244.43
8600.00	90.00	89.380	7195.00	15.99N	1247.71E	==>	1247.81	1403849.70	3161344.42
8700.00	90.00	89.380	7195.00	17.07N	1347.70E	==>	1347.81	1403850.78	3161444.41
8800.00	90.00	89.380	7195.00	18.16N	1447.69E	==>	1447.81	1403851.86	3161544.40
8900.00	90.00	89.380	7195.00	19.24N	1547.69E	==>	1547.81	1403852.95	3161644.39
9000.00	90.00	89.380	7195.00	20.32N	1647.68E	==>	1647.81	1403854.03	3161744.38
9100.00	90.00	89.380	7195.00	21.41N	1747.68E	==>	1747.81	1403855.11	3161844.37
9200.00	90.00	89.380	7195.00	22.49N	1847.67E	==>	1847.81	1403856.20	3161944.36

All data is in Feet unless otherwise stated  
 Coordinates are from Slot MD's are from Rig and TVD's are from Rig ( Planned Datum #1 4953.0ft above Mean Sea Level )  
 Vertical Section is from 0.00N 0.00E on azimuth 89.350 degrees  
 Bottom hole distance is 4556.72 Feet on azimuth 89.35 degrees from Wellhead  
 Calculation method uses Minimum Curvature method  
 Prepared by Peterson Energy  
 Date Printed: 2-May-2013



INTEGRATED PETROLEUM TECHNOLOGIES, INC  
SYSDRILL  
Well Design Combined Report  
Wellbore: Pavistma South 2 #1-5-32-090-4-CH (PWB)  
Wellpath: Pavistma South 2 #1-5-32-090-4-CH (PWP#1)

Interpolated Wellpath									
MD[ft]	Inc[deg]	Azi[deg]	TVD[ft]	North[ft]	East[ft]	Dogleg [deg/100ft]	Vertical Section[ft]	Northing	Easting
9300.00	90.00	89.380	7195.00	23.57N	1947.67E	==>	1947.81	1403857.28	3162044.35
9400.00	90.00	89.380	7195.00	24.66N	2047.66E	==>	2047.81	1403858.36	3162144.34
9500.00	90.00	89.380	7195.00	25.74N	2147.65E	==>	2147.81	1403859.45	3162244.33
9600.00	90.00	89.380	7195.00	26.82N	2247.65E	==>	2247.81	1403860.53	3162344.32
9700.00	90.00	89.380	7195.00	27.91N	2347.64E	==>	2347.81	1403861.61	3162444.31
9800.00	90.00	89.380	7195.00	28.99N	2447.64E	==>	2447.81	1403862.70	3162544.30
9900.00	90.00	89.380	7195.00	30.07N	2547.63E	==>	2547.81	1403863.78	3162644.29
10000.00	90.00	89.380	7195.00	31.16N	2647.62E	==>	2647.81	1403864.86	3162744.28
10100.00	90.00	89.380	7195.00	32.24N	2747.62E	==>	2747.81	1403865.95	3162844.27
10200.00	90.00	89.380	7195.00	33.32N	2847.61E	==>	2847.81	1403867.03	3162944.26
10300.00	90.00	89.380	7195.00	34.41N	2947.61E	==>	2947.81	1403868.11	3163044.25
10400.00	90.00	89.380	7195.00	35.49N	3047.60E	==>	3047.81	1403869.20	3163144.24
10500.00	90.00	89.380	7195.00	36.57N	3147.60E	==>	3147.81	1403870.28	3163244.23
10600.00	90.00	89.380	7195.00	37.66N	3247.59E	==>	3247.81	1403871.36	3163344.22
10700.00	90.00	89.380	7195.00	38.74N	3347.58E	==>	3347.81	1403872.44	3163444.21
10800.00	90.00	89.380	7195.00	39.82N	3447.58E	==>	3447.81	1403873.53	3163544.20
10900.00	90.00	89.380	7195.00	40.91N	3547.57E	==>	3547.81	1403874.61	3163644.19
11000.00	90.00	89.380	7195.00	41.99N	3647.57E	==>	3647.81	1403875.69	3163744.18
11100.00	90.00	89.380	7195.00	43.07N	3747.56E	==>	3747.81	1403876.78	3163844.17
11200.00	90.00	89.380	7195.00	44.16N	3847.55E	==>	3847.81	1403877.86	3163944.16
11300.00	90.00	89.380	7195.00	45.24N	3947.55E	==>	3947.81	1403878.94	3164044.15
11400.00	90.00	89.380	7195.00	46.32N	4047.54E	==>	4047.81	1403880.03	3164144.15
11500.00	90.00	89.380	7195.00	47.41N	4147.54E	==>	4147.81	1403881.11	3164244.14
11600.00	90.00	89.380	7195.00	48.49N	4247.53E	==>	4247.81	1403882.19	3164344.13
11700.00	90.00	89.380	7195.00	49.57N	4347.52E	==>	4347.81	1403883.28	3164444.12
11800.00	90.00	89.380	7195.00	50.66N	4447.52E	==>	4447.81	1403884.36	3164544.11
11900.00	90.00	89.380	7195.00	51.74N	4547.51E	==>	4547.81	1403885.44	3164644.10
11908.91	90.00	89.380	7195.00	51.84N	4556.43E	==>	4556.72	1403885.54	3164653.01

All data is in Feet unless otherwise stated  
Coordinates are from Slot MD's are from Rig and TVD's are from Rig ( Planned Datum #1 4953.0ft above Mean Sea Level )  
Vertical Section is from 0.00N 0.00E on azimuth 89.350 degrees  
Bottom hole distance is 4556.72 Feet on azimuth 89.35 degrees from Wellhead  
Calculation method uses Minimum Curvature method  
Prepared by Peterson Energy  
Date Printed: 2-May-2013



INTEGRATED PETROLEUM TECHNOLOGIES, INC  
 SYSDRILL  
 Well Design Combined Report  
 Wellbore: Pavistma South 2 #1-5-32-090-4-CH (PWB)  
 Wellpath: Pavistma South 2 #1-5-32-090-4-CH (PWP#1)

Hole Sections								
Diameter	Start	Start	Start	Start	End	End	End	End
[in]	MD[ft]	TVD[ft]	North[ft]	East[ft]	MD[ft]	TVD[ft]	North[ft]	East[ft]
12 1/4	0.00	0.00	0.00N	0.00E	850.00	850.00	0.00N	0.00E
8 3/4	850.00	850.00	0.00N	0.00E	7622.00	7195.00	5.39N	269.76E
6 1/8	7622.00	7195.00	5.39N	269.76E	11908.91	7195.00	51.84N	4556.43E

Casings								
Name	Top	Top	Top	Top	Shoe	Shoe	Shoe	Shoe
	MD[ft]	TVD[ft]	North[ft]	East[ft]	MD[ft]	TVD[ft]	North[ft]	East[ft]
9 5/8in Surface Casing	0.00	0.00	0.00N	0.00E	850.00	850.00	0.00N	0.00E
7.0in Intermediate Casing	0.00	0.00	0.00N	0.00E	7622.00	7195.00	5.39N	269.76E
4 1/2in Production Liner	6500.00	6481.59	2.65S	446.17W	11908.91	7195.00	51.84N	4556.43E

Targets								
Name	North[ft]	East[ft]	TVD[ft]	Latitude	Longitude	Northing	Easting	Last Revised
PS 2- T2	5.40N	269.98E	7195.00	N40 26 25.8360	W104 55 25.8600	1403839.10	3160366.73	8-Mar-2013
PS 2- T3	51.84N	4556.43E	7195.00	N40 26 26.0160	W104 54 30.4200	1403885.54	3164653.01	8-Mar-2013

Survey Tool Program					
Reference	Survey Name	MD[ft]	TVD[ft]	Survey Tool	Error Model
5360	Planned	11908.91	7195.00	WdW Rate Gyro	Standard

Notes

All data is in Feet unless otherwise stated  
 Coordinates are from Slot MD's are from Rig and TVD's are from Rig ( Planned Datum #1 4953.0ft above Mean Sea Level )  
 Vertical Section is from 0.00N 0.00E on azimuth 89.350 degrees  
 Bottom hole distance is 4556.72 Feet on azimuth 89.35 degrees from Wellhead  
 Calculation method uses Minimum Curvature method  
 Prepared by Peterson Energy  
 Date Printed: 2-May-2013



SYSDRILL  
Closest Approach + Clearance Factor Summary Report  
Wellbore: Pavistma South 2 #1-5-32-090-4-CH (PWB)  
Wellpath: Pavistma South 2 #1-5-32-090-4-CH (PWP#1)

Ellipse separations are reported ONLY if BOTH wells have uncertainty data  
Only Depth and Magnetic Reference Field error terms are correlated across tie points  
Cutoff is calculated on CENTRE to CENTRE distance

Summary data uses Closest Approach clearance calculation for all minima  
Hole size/Casings ARE included  
Hole size/Casings are NOT subtracted from Centre-Centre distance  
Confidence limit of 95.00% / 2.80 SD.

Wellbore		
Name	Created	Last Revised
Pavistma South 2 #1-5-32-090-4-CH (PWB)	8-Mar-2013	2-May-2013

Well		
Name	Government ID	Last Revised
Pavistma South 2 #1-5-32-090-4-CH		8-Mar-2013

Slot						
Name	Grid Northing	Grid Easting	Latitude	Longitude	North	East
Slot #2	1403833.7079	3160096.7633	N40 26 25.8000	W104 55 29.3520	10.98S	8.28W

Installation				
Name	Easting	Northing	Coord System Name	North Alignment
Pavistma South	3160105.0426	1403844.6909	CO83-NF on NORTH AMERICAN DATUM 1983 datum	Grid

Field				
Name	Easting	Northing	Coord System Name	North Alignment
Windsor Project	3162710.0707	1407271.6545	CO83-NF on NORTH AMERICAN DATUM 1983 datum	Grid

Clearance Summary										
Offset WellName	Offset Wellbore	Offset Slot	Offset Structure	Separation [ft]	MD[ft]	Diverging From[ft]	Ellipse Separation [ft]	Ellipse MD[ft]	Clearance Factor	Clearance MD[ft]
Pavistma South 1 #1-5-32-090-4-NH	Pavistma South 1 #1-5-32-090-4-NH (PWB)	Slot #1	Pavistma South	13.75	1017.06	1017.06	11.46	1017.06	4.74	11876.64
Pavistma South 3 #1-6-32-090-4-NH	Pavistma South 3 #1-6-32-090-4-NH (PWB)	Slot #3	Pavistma South	18.34	984.25	7677.17	16.08	1000.00	7.60	11908.91
Pavistma South 4 #1-7-32-090-4-CH	Pavistma South 4 #1-7-32-090-4-CH (PWB)	Slot #4	Pavistma South	35.06	984.25	984.25	32.80	1000.66	13.95	11908.91
Pavistma South 5 #1-8-32-090-4-NH	Pavistma South 5 #1-8-32-090-4-NH (PWB)	Slot #5	Pavistma South	48.79	984.25	984.25	46.53	1000.00	17.20	11908.91
PAVISTMA 19-32	PAVISTMA 19-32 (AWB)	PAVISTMA 19-32	Pavistma (Anadarko)	225.06	1287.79	8444.43	220.61	1295.93	8.18	8513.78
PAVISTMA 11-32	PAVISTMA 11-32 (AWB)	PAVISTMA 11-32	Pavistma (Anadarko)	265.10	1109.19	9101.64	239.38	9104.33	4.70	9104.33
FRYE FARM 7-5-32	FRYE FARM 7-5-32 (AWB)	FRYE FARMS #7-5-32	Frye Farms	269.08	9910.26	9910.26	207.25	9910.26	4.34	9924.54
PAVISTMA 12-32	PAVISTMA 12-32 (AWB)	PAVISTMA 12-32	Pavistma (Anadarko)	296.34	1155.42	7774.02	292.07	1155.42	17.93	7800.00
CENTER POINT 5 #8-1-32-180-4-NH	CENTER POINT 5 #8-1-32-180-4-NH (PWB)	Slot #5	Center Point	302.98	11908.91	11908.91	261.15	11908.91	7.24	11908.91

All data is in Feet unless otherwise stated  
Coordinates are from Slot MD's are from Rig and TVD's are from Rig ( Planned Datum #1 4953.0ft above Mean Sea Level )  
Vertical Section is from 0.00N 0.00E on azimuth 89.350 degrees  
Prepared by Peterson Energy  
Date Printed: 2-May-2013



SYSDRILL  
Closest Approach + Clearance Factor Summary Report  
Wellbore: Pavistma South 2 #1-5-32-090-4-CH (PWB)  
Wellpath: Pavistma South 2 #1-5-32-090-4-CH (PWP#1)

Clearance Summary										
Offset WellName	Offset Wellbore	Offset Slot	Offset Structure	Separation [ft]	MD[ft]	Diverging From[ft]	Ellipse Separation [ft]	Ellipse MD[ft]	Clearance Factor	Clearance MD[ft]
FRYE FARMS 13 #5-5-32-09 0-6-CH	FRYE FARMS 13 #5-5-32-090-6 -CH (PWB)	Slot #13	Frye Farms	327.31	10269.15	10269.15	276.77	11908.91	6.41	11908.91
PAVISTMA 5-3-32	PAVISTMA 5-3-32 (AWB)	PAVISTMA 5-3-32	Pavistma	471.13	0.00	8417.87	469.69	632.12	22.97	8645.01
PAVISTMA 4-2-32	PAVISTMA 4-2-32 (AWB)	PAVISTMA 4-2-32	Pavistma	489.14	0.00	7841.21	487.90	82.02	48.62	8792.65
PAVISTMA 5-1-32	PAVISTMA 5-1-32 (AWB)	PAVISTMA 5-1-32	Pavistma	503.34	153.99	7113.98	501.80	153.99	59.28	6600.00
PAVISTMA 6 #1-4-32-09 0-4-NH	PAVISTMA 6 #1-4-32-090-4 -NH (PWB)	Slot #6	Pavistma	553.30	1000.66	11712.60	551.03	1000.66	10.75	11761.81
PAVISTMA 7 #1-4-32-09 0-8-CH	PAVISTMA 7 #1-4-32-090-8 -CH (PWB)	Slot #7	Pavistma	569.22	1000.66	11908.91	566.96	1000.66	13.20	11908.91
CENTER POINT 7 #0-1-33-18 0-4-NH	CENTER POINT 7 #0-1-33-180-4 -NH (PWB)	Slot #7	Center Point	575.78	11908.91	11908.91	528.28	11908.91	12.12	11908.91
PAVISTMA 8 #1-3-32-09 0-4-NH	PAVISTMA 8 #1-3-32-090-4 -NH (PWB)	Slot #8	Pavistma	585.15	1000.66	11679.79	582.88	1000.66	15.75	11811.02
PAVISTMA 9 #1-3-32-09 0-4-NH	PAVISTMA 9 #1-3-32-090-4 -NH (PWB)	Slot #9	Pavistma	601.08	1000.66	1000.66	598.82	1000.66	19.67	11893.04
PAVISTMA 10 #1-3-32-09 0-8-CH	PAVISTMA 10 #1-3-32-090-8 -CH (PWB)	Slot #10	Pavistma	617.02	1000.66	11908.91	614.75	1000.66	20.86	11908.91
FRYE FARMS 8 #1-5-33-09 0-4-NH	FRYE FARMS 8 #1-5-33-090-4 -NH (PWB)	Slot #8	Frye Farms	631.29	11908.91	11908.91	609.74	11908.91	29.30	11908.91
PAVISTMA 11 #1-3-32-09 0-4-NH	PAVISTMA 11 #1-3-32-090-4 -NH (PWB)	Slot #11	Pavistma	632.96	1000.66	11663.46	630.69	1000.66	23.54	11908.91
PAVISTMA 12 #1-2-32-09 0-4-NH	PAVISTMA 12 #1-2-32-090-4 -NH (PWB)	Slot #12	Pavistma	648.90	1000.66	11663.39	646.63	1000.66	27.44	11908.91
FRYE FARMS 7 #1-6-33-09 0-4-NH	FRYE FARMS 7 #1-6-33-090-4 -NH (PWB)	Slot #7	Frye Farms	709.80	11908.91	11908.91	686.51	11908.91	30.47	11908.91
FRYE FARMS 9 #1-5-33-09 0-4-NH	FRYE FARMS 9 #1-5-33-090-4 -NH (PWB)	Slot #9	Frye Farms	713.96	11908.91	11908.91	679.04	11908.91	20.45	11908.91
FRYE FARMS 6 #1-6-33-09 0-4-NH	FRYE FARMS 6 #1-6-33-090-4 -NH (PWB)	Slot #6	Frye Farms	905.84	11908.91	11908.91	872.61	11908.91	27.26	11908.91

All data is in Feet unless otherwise stated  
Coordinates are from Slot MD's are from Rig and TVD's are from Rig ( Planned Datum #1 4953.0ft above Mean Sea Level )  
Vertical Section is from 0.00N 0.00E on azimuth 89.350 degrees  
Prepared by Peterson Energy  
Date Printed: 2-May-2013



SYSDRILL  
Closest Approach + Clearance Factor Summary Report  
Wellbore: Pavistma South 2 #1-5-32-090-4-CH (PWB)  
Wellpath: Pavistma South 2 #1-5-32-090-4-CH (PWP#1)

Clearance Summary										
Offset WellName	Offset Wellbore	Offset Slot	Offset Structure	Separation [ft]	MD[ft]	Diverging From[ft]	Ellipse Separation [ft]	Ellipse MD[ft]	Clearance Factor	Clearance MD[ft]
FRYE FARMS 10 #1-4-33-09 0-4-NH	FRYE FARMS 10 #1-4-33-090-4 -NH (PWB)	Slot #10	Frye Farms	913.56	11908.91	11908.91	870.18	11908.91	21.06	11908.91
Lind #13-32	Lind #13-32 (AWB)	Lind #13-32	Lind (Anadarko)	997.85	7929.65	7929.65	962.99	7923.23	26.75	7611.55
RANCHO WATER VALLEY 13 #7-6-33-27 0-6-CH	RANCHO WATER VALLEY 13 #7-6-33-270-6 -CH (PWB)	Slot #13	Rancho Water Valley	1085.11	11908.91	11908.91	1059.92	11908.91	43.07	11908.91
FRYE FARMS 11 #1-4-33-09 0-4-NH	FRYE FARMS 11 #1-4-33-090-4 -NH (PWB)	Slot #11	Frye Farms	1242.61	11908.91	11908.91	1195.34	11908.91	26.29	11908.91
Anderson #1	Anderson #1 (AWB)	Anderson #1	Anderson (J.K. Wadley)	1398.29	1000.66	1000.66	1396.70	836.61	251.71	9465.22
RANCHO WATER VALLEY 12 #7-7-33-27 0-4-NH	RANCHO WATER VALLEY 12 #7-7-33-270-4 -NH (PWB)	Slot #12	Rancho Water Valley	1440.21	11908.91	11908.91	1324.67	11908.91	12.47	11908.91
FRYE FARMS 12 #1-3-33-09 0-4-NH	FRYE FARMS 12 #1-3-33-090-4 -NH (PWB)	Slot #12	Frye Farms	1525.18	11908.91	11908.91	1477.17	11908.91	31.76	11908.91
RANCHO WATER VALLEY 11 #7-7-33-27 0-6-CH	RANCHO WATER VALLEY 11 #7-7-33-270-6 -CH (AWB)	Slot #11	Rancho Water Valley	1540.02	11908.91	11908.91	1414.88	11908.91	12.31	11908.91
RANCHO WATER VALLEY 11 #7-7-33-27 0-6-CH	RANCHO WATER VALLEY 11 #7-7-33-270-6 -CH (PWB)	Slot #11	Rancho Water Valley	1553.67	11908.91	11908.91	1504.99	11908.91	31.91	11908.91
RANCHO WATER VALLEY 7 #7-8-33-27 0-5-CH	RANCHO WATER VALLEY 7 #7-8-33-270-5 -CH (PWB)	Slot #07	Rancho Water Valley	1571.51	11908.91	11908.91	1479.64	11908.91	17.11	11849.50
FRYE FARMS #9-7-32	FRYE FARMS #9-7-32 (AWB)	FRYE FARMS #9-7-32	Frye Farms	1603.22	11385.55	11385.55	1554.69	11400.92	31.34	11876.64
FRYE FARMS #9-5-32	FRYE FARMS #9-5-32 (AWB)	FRYE FARMS #9-5-32	Frye Farms	1612.86	10075.04	10075.04	1553.13	10072.18	26.82	9924.54
RANCHO WATER VALLEY 10 #7-8-33-27 0-4-NH	RANCHO WATER VALLEY 10 #7-8-33-270-4 -NH (PWB)	Slot #10	Rancho Water Valley	1707.68	11908.91	11908.91	1655.07	11908.91	32.46	11908.91
RANCHO WATER VALLEY 6 #0-7-4-270 -5-NH	RANCHO WATER VALLEY 6 #0-7-4-270-5-NH (PWB)	Slot #06	Rancho Water Valley	1749.98	11908.91	11908.91	1658.63	11905.05	19.16	11854.39

All data is in Feet unless otherwise stated  
Coordinates are from Slot MD's are from Rig and TVD's are from Rig ( Planned Datum #1 4953.0ft above Mean Sea Level )  
Vertical Section is from 0.00N 0.00E on azimuth 89.350 degrees  
Prepared by Peterson Energy  
Date Printed: 2-May-2013





SYSDRILL  
Closest Approach + Clearance Factor Summary Report  
Wellbore: Pavistma South 2 #1-5-32-090-4-CH (PWB)  
Wellpath: Pavistma South 2 #1-5-32-090-4-CH (PWP#1)

Clearance Summary										
Offset WellName	Offset Wellbore	Offset Slot	Offset Structure	Separation [ft]	MD[ft]	Diverging From[ft]	Ellipse Separation [ft]	Ellipse MD[ft]	Clearance Factor	Clearance MD[ft]
HILLSIDE 17 #3-1-33-09 0-4-NH	HILLSIDE 17 #3-1-33-090-4 -NH (PWB)	Slot #17	Hillside	1955.47	11908.91	11908.91	1892.19	11908.91	30.90	11908.91
HILLSIDE 18 #2-1-33-09 0-4-NH	HILLSIDE 18 #2-1-33-090-4 -NH (PWB)	Slot #18	Hillside	2270.65	11908.91	11908.91	2208.10	11908.91	36.30	11908.91
RAINDAN CE 6 #1-2-32-09 0-4-CH	RAINDANCE 6 #1-2-32-090-4 -CH (PWB)	Slot #6	Raindance	2355.07	11646.98	11646.98	2124.97	11630.58	10.23	11630.58
HILLSIDE 15 #2-1-33-09 0-4-CH	HILLSIDE 15 #2-1-33-090-4 -CH (PWB)	Slot #15	Hillside	2423.32	11908.91	11908.91	2361.30	11908.91	39.08	11908.91
RANCHO WATER VALLEY 4 #7-1-4-270 -4-NH	RANCHO WATER VALLEY 4 #7-1-4-270-4- NH (PWB)	Slot #04	Rancho Water Valley	2446.99	11908.91	11908.91	2260.71	11908.91	13.14	11908.91
RAINDAN CE 5 #1-2-32-09 0-4-NH	RAINDANCE 5 #1-2-32-090-4 -NH (PWB)	Slot #5	Raindance	2522.39	11646.98	11646.98	2292.76	11646.98	10.98	11630.58
HILLSIDE 14 #2-1-33-09 0-4-NH	HILLSIDE 14 #2-1-33-090-4 -NH (PWB)	Slot #14	Hillside	2592.52	11908.91	11908.91	2530.41	11908.91	41.74	11908.91
RAINDAN CE 4 #1-1-32-09 0-4-NH	RAINDANCE 4 #1-1-32-090-4 -NH (PWB)	Slot #4	Raindance	2849.95	11641.99	11641.99	2620.50	11646.98	12.42	11663.39
CENTER POINT 2 #1-1-33-09 0-4-NH	CENTER POINT 2 #1-1-33-090-4 -NH (PWB)	Slot #2	Center Point	2926.16	11908.91	11908.91	2875.20	11908.91	57.42	11908.91
RANCHO WATER VALLEY 5 #7-2-4-270 -4-NH	RANCHO WATER VALLEY 5 #7-2-4-270-4- NH (PWB)	Slot #05	Rancho Water Valley	2994.95	11908.91	11908.91	2790.42	11908.91	14.64	11908.91
RAINDAN CE 3 #1-1-32-09 0-4-CH	RAINDANCE 3 #1-1-32-090-4 -CH (PWB)	Slot #3	Raindance	3015.40	11641.68	11641.68	2786.15	11646.98	13.15	11696.19
HILLSIDE 2-4-32	HILLSIDE 2-4-32 (PWB)	HILLSIDE 2-4-32	Hillside	3051.98	8933.03	8933.03	3008.46	8973.10	61.74	10055.77
CENTER POINT 1 #1-1-33-09 0-4-CH	CENTER POINT 1 #1-1-33-090-4 -CH (PWB)	Slot #1	Center Point	3081.75	11908.91	11908.91	3029.85	11908.91	59.38	11908.91
RAINDAN CE 2 #1-1-32-09 0-4-NH	RAINDANCE 2 #1-1-32-090-4 -NH	Slot #2	Raindance	3177.68	11638.78	11638.78	2948.82	11646.98	13.87	11729.00
CENTER POINT 3 #1-1-33-09	CENTER POINT 3 #1-1-33-090-4	Slot #3	Center Point	3249.24	11908.91	11908.91	3197.90	11908.91	63.29	11908.91

All data is in Feet unless otherwise stated  
Coordinates are from Slot MD's are from Rig and TVD's are from Rig ( Planned Datum #1 4953.0ft above Mean Sea Level )  
Vertical Section is from 0.00N 0.00E on azimuth 89.350 degrees  
Prepared by Peterson Energy  
Date Printed: 2-May-2013



SYSDRILL  
Closest Approach + Clearance Factor Summary Report  
Wellbore: Pavistma South 2 #1-5-32-090-4-CH (PWB)  
Wellpath: Pavistma South 2 #1-5-32-090-4-CH (PWP#1)

Clearance Summary										
Offset WellName	Offset Wellbore	Offset Slot	Offset Structure	Separation [ft]	MD[ft]	Diverging From[ft]	Ellipse Separation [ft]	Ellipse MD[ft]	Clearance Factor	Clearance MD[ft]
0-4-NH	-NH (PWB)									
RAINDANCE 9 #1-0-32-090-4-0-4-NH	RAINDANCE 9 #1-0-32-090-4-0-4-NH (PWB)	Slot #9	Raindance	3452.57	11638.69	11638.69	3366.59	11663.39	39.50	11908.91
CENTER POINT 4 #1-0-33-090-4-0-4-NH	CENTER POINT 4 #1-0-33-090-4-0-4-NH (PWB)	Slot #4	Center Point	3483.75	11908.91	11908.91	3432.14	11908.91	67.51	11908.91
HILLSIDE 11 #0-7-28-000-4-0-4-CH	HILLSIDE 11 #0-7-28-000-4-0-4-CH (PWB)	Slot #11	Hillside	3490.12	11908.91	11908.91	3398.01	11908.91	37.89	11908.91
CENTER POINT 6 #1-0-33-090-4-0-4-CH	CENTER POINT 6 #1-0-33-090-4-0-4-CH (PWB)	Slot #6	Center Point	3589.30	11908.91	11908.91	3537.37	11908.91	69.11	11908.91
HILLSIDE 9 #7-7-29-000-4-0-4-NH	HILLSIDE 9 #7-7-29-000-4-0-4-NH (PWB)	Slot #9	Hillside	3589.95	11527.07	11527.07	3513.34	11564.96	45.14	11908.91
RAINDANCE 8 #1-0-32-090-4-0-4-CH	RAINDANCE 8 #1-0-32-090-4-0-4-CH (PWB)	Slot #8	Raindance	3617.16	11636.07	11636.07	3531.29	11663.39	41.36	11908.91
HILLSIDE 7 #7-7-29-000-4-0-4-CH	HILLSIDE 7 #7-7-29-000-4-0-4-CH (PWB)	Slot #7	Hillside	3622.00	11386.40	11386.40	3571.97	11417.32	67.49	11908.91
HILLSIDE 2 #5-7-29-000-4-0-4-CH	HILLSIDE 2 #5-7-29-000-4-0-4-CH (PWB)	Slot #2	Hillside	3628.49	10000.74	10000.74	3600.00	10039.37	100.63	11811.02
HILLSIDE 10 #8-7-29-000-4-0-4-NH	HILLSIDE 10 #8-7-29-000-4-0-4-NH (PWB)	Slot #10	Hillside	3641.48	11846.06	11846.06	3553.16	11876.64	41.03	11908.91
HILLSIDE 8 #7-7-29-000-4-0-4-NH	HILLSIDE 8 #7-7-29-000-4-0-4-NH (PWB)	Slot #8	Hillside	3645.72	11236.88	11236.88	3579.39	11269.69	51.51	11908.91
HILLSIDE 3 #5-7-29-000-4-0-4-NH	HILLSIDE 3 #5-7-29-000-4-0-4-NH (PWB)	Slot #3	Hillside	3649.99	10474.86	10474.86	3609.37	10515.09	76.73	11908.91
HILLSIDE 4 #5-7-29-000-4-0-4-NH	HILLSIDE 4 #5-7-29-000-4-0-4-NH (PWB)	Slot #4	Hillside	3652.15	9924.54	9924.54	3623.64	9957.35	103.12	11712.60
CENTER POINT 8 #1-0-33-090-4-0-4-NH	CENTER POINT 8 #1-0-33-090-4-0-4-NH (PWB)	Slot #8	Center Point	3657.85	11908.91	11908.91	3605.77	11908.91	70.22	11908.91
HILLSIDE 6 #6-7-29-000-4-0-4-CH	HILLSIDE 6 #6-7-29-000-4-0-4-CH (PWB)	Slot #6	Hillside	3663.64	10622.10	10622.10	3618.16	10662.73	70.08	11908.91
RAINDANCE 7 #1-0-32-090-4-0-4-CH	RAINDANCE 7 #1-0-32-090-4-0-4-CH (PWB)	Slot #7	Raindance	3672.46	11634.26	11634.26	3586.80	11663.39	42.07	11908.91

All data is in Feet unless otherwise stated  
Coordinates are from Slot MD's are from Rig and TVD's are from Rig ( Planned Datum #1 4953.0ft above Mean Sea Level )  
Vertical Section is from 0.00N 0.00E on azimuth 89.350 degrees  
Prepared by Peterson Energy  
Date Printed: 2-May-2013



SYSDRILL  
Closest Approach + Clearance Factor Summary Report  
Wellbore: Pavistma South 2 #1-5-32-090-4-CH (PWB)  
Wellpath: Pavistma South 2 #1-5-32-090-4-CH (PWP#1)

Clearance Summary										
Offset WellName	Offset Wellbore	Offset Slot	Offset Structure	Separation [ft]	MD[ft]	Diverging From[ft]	Ellipse Separation [ft]	Ellipse MD[ft]	Clearance Factor	Clearance MD[ft]
#1-0-32-09 0-4-NH	#1-0-32-090-4 -NH (PWB)									
HILLSIDE 5 #6-7-29-00 0-4-NH	HILLSIDE 5 #6-7-29-000-4 -NH (PWB)	Slot #5	Hillside	3675.09	10941.60	10941.60	3618.86	10974.41	59.33	11908.91
RAINDANCE CE 1 #1-1-32	RAINDANCE 1 #1-1-32 (PWB)	Slot #1	Raindance	3680.51	6808.98	6808.98	3666.68	6808.98	181.22	10334.65
RANCHO WATER VALLEY #2-6-4	RANCHO WATER VALLEY #2-6-4 (AWB)	Slot #03	Rancho Water Valley	4628.66	11908.91	11908.91	4571.03	11908.91	80.32	11908.91
Poudre #36-28	Poudre #36-28 (AWB)	Poudre #36-28	Poudre (Kerr-McGee Oil & Gas)	4714.50	11908.91	11908.91	4657.09	11908.91	82.11	11908.91
Poudre #14-28	Poudre #14-28 (AWB)	Poudre #14-28	Poudre (Kerr-McGee Oil & Gas)	4797.36	11908.91	11908.91	4755.18	11908.91	113.73	11908.91
Poudre #19-28	Poudre #19-28 (AWB)	Poudre #19-28	Poudre (Kerr-McGee Oil & Gas)	5253.42	11908.91	11908.91	5192.08	11908.91	85.65	11908.91
RANCHO WATER VALLEY 9 #8-7-33-00 0-4-CH	RANCHO WATER VALLEY 9 #8-7-33-000-4 -CH (PWB)	Slot #09	Rancho Water Valley	5299.73	11908.91	11908.91	5208.82	11908.91	58.30	11908.91
RANCHO WATER VALLEY 8 #8-7-33-00 0-4-NH	RANCHO WATER VALLEY 8 #8-7-33-000-4 -NH (PWB)	Slot #08	Rancho Water Valley	5407.97	11908.91	11908.91	5368.24	11908.91	136.12	11908.91
Poudre #15-28	Poudre #15-28 (AWB)	Poudre #15-28	Poudre (Kerr-McGee Oil & Gas)	5530.04	11908.91	11908.91	5470.62	11908.91	93.07	11908.91
Poudre #23-28	Poudre #23-28 (AWB)	Poudre #23-28	Poudre (Kerr-McGee Oil & Gas)	5704.48	11908.91	11908.91	5660.49	11908.91	129.66	11908.91
RANCHO WATER VALLEY #2-8-4	RANCHO WATER VALLEY 2-8-4 (AWB)	Slot #02	Rancho Water Valley	5746.82	11908.91	11908.91	5711.73	11908.91	163.78	11908.91
Poudre #11-28	Poudre #11-28 (AWB)	Poudre #11-28	Poudre (Kerr-McGee Oil & Gas)	6069.05	11908.91	11908.91	6015.02	11908.91	112.33	11908.91
Kodak 15 #7-4-28-27 0-4-NH	Kodak 15 #7-4-28-270-4 -NH (PWB)	Slot #15	Kodak	6254.56	11908.91	11908.91	6162.89	11908.91	68.23	11908.91
Kodak 14 #7-4-28-27 0-4-CH	Kodak 14 #7-4-28-270-4 -CH (PWB)	Slot #14	Kodak	6420.20	11908.91	11908.91	6328.35	11908.91	69.90	11908.91
RANCHO WATER VALLEY #3-9-4	RANCHO WATER VALLEY #3-9-4 (AWB)	Slot #01	Rancho Water Valley	6451.41	11908.91	11908.91	6404.98	11908.91	138.96	11908.91
Kodak 13 #7-4-28-27 0-4-NH	Kodak 13 #7-4-28-270-4 -NH (PWB)	Slot #13	Kodak	6583.06	11908.91	11908.91	6491.11	11908.91	71.59	11908.91

All data is in Feet unless otherwise stated  
Coordinates are from Slot MD's are from Rig and TVD's are from Rig ( Planned Datum #1 4953.0ft above Mean Sea Level )  
Vertical Section is from 0.00N 0.00E on azimuth 89.350 degrees  
Prepared by Peterson Energy  
Date Printed: 2-May-2013



SYSDRILL  
Closest Approach + Clearance Factor Summary Report  
Wellbore: Pavistma South 2 #1-5-32-090-4-CH (PWB)  
Wellpath: Pavistma South 2 #1-5-32-090-4-CH (PWP#1)

Clearance Summary										
Offset WellName	Offset Wellbore	Offset Slot	Offset Structure	Separation [ft]	MD[ft]	Diverging From[ft]	Ellipse Separation [ft]	Ellipse MD[ft]	Clearance Factor	Clearance MD[ft]
Poudre #10-28	Poudre #10-28 (AWB)	Poudre #10-28	Poudre (Kerr-McGee Oil & Gas)	6602.46	11908.91	11908.91	6548.82	11908.91	123.07	11908.91
Poudre #25-28	Poudre #25-28 (AWB)	Poudre #25-28	Poudre (Kerr-McGee Oil & Gas)	6789.87	11908.91	11908.91	6735.02	11908.91	123.79	11908.91
Kodak 12 #7-3-28-27 0-4-NH	Kodak 12 #7-3-28-270-4 -NH (PWB)	Slot #12	Kodak	6911.67	11908.91	11908.91	6819.44	11908.91	74.94	11908.91
Kodak 11 #7-3-28-27 0-4-CH	Kodak 11 #7-3-28-270-4 -CH (PWB)	Slot #11	Kodak	7077.28	11908.91	11908.91	6984.91	11908.91	76.62	11908.91
Kodak 10 #7-3-28-27 0-4-NH	Kodak 10 #7-3-28-270-4 -NH (PWB)	Slot #10	Kodak	7240.42	11908.91	11908.91	7147.95	11908.91	78.30	11908.91
W Great Western #27-14	W Great Western #27-14 (AWB)	Great Western #27-14	Great Western (Great Western Oil & Gas)	7385.87	11908.91	11908.91	7360.41	11908.91	290.10	11908.91
Kodak 9 #7-2-28-27 0-4-NH	Kodak 9 #7-2-28-270-4 -NH (PWB)	Slot #9	Kodak	7569.25	11908.91	11908.91	7476.54	11908.91	81.64	11908.91
Kodak 8 #7-2-28-27 0-4-CH	Kodak 8 #7-2-28-270-4 -CH (PWB)	Slot #8	Kodak	7734.82	11908.91	11908.91	7641.98	11908.91	83.31	11908.91
Kodak 7 #7-2-28-27 0-4-NH	Kodak 7 #7-2-28-270-4 -NH (PWB)	Slot #7	Kodak	7898.16	11908.91	11908.91	7805.23	11908.91	84.98	11908.91
Kodak 6 #7-1-28-27 0-4-NH	Kodak 6 #7-1-28-270-4 -NH (PWB)	Slot #6	Kodak	8227.17	11908.91	11908.91	8134.01	11908.91	88.31	11908.91
Great Western 27-13	W #12 Great Western 27-13 (AWB)	Great Western #27-13	Great Western (Great Western Oil & Gas)	8262.74	11908.91	11908.91	8233.39	11908.91	281.59	11908.91
W Great Western # 27-53	W Great Western # 27-53 (AWB)	Great Western # 27-53	Great Western (Great Western Oil & Gas)	8312.73	11908.91	11908.91	8286.62	11908.91	318.34	11908.91
Kodak 5 #7-1-28-27 0-4-CH	Kodak 5 #7-1-28-270-4 -CH (PWB)	Slot #5	Kodak	8392.74	11908.91	11908.91	8299.47	11908.91	89.98	11908.91
Kodak 4 #7-1-28-27 0-4-NH	Kodak 4 #7-1-28-270-4 -NH (PWB)	Slot #4	Kodak	8556.27	11908.91	11908.91	8462.89	11908.91	91.64	11908.91
Kodak 3 #7-0-28-27 0-4-NH	Kodak 3 #7-0-28-270-4 -NH (PWB)	Slot #3	Kodak	8885.40	11908.91	11908.91	8791.82	11908.91	94.94	11908.91
W Great Western #27-23	W Great Western #27-23 (AWB)	Great Western #27-23	Great Western (Great Western Oil & Gas)	8920.60	11908.91	11908.91	8894.64	11908.91	343.67	11908.91
Kodak 2 #7-0-28-27	Kodak 2 #7-0-28-270-4	Slot #2	Kodak	9050.96	11908.91	11908.91	8957.27	11908.91	96.60	11908.91

All data is in Feet unless otherwise stated  
Coordinates are from Slot MD's are from Rig and TVD's are from Rig ( Planned Datum #1 4953.0ft above Mean Sea Level )  
Vertical Section is from 0.00N 0.00E on azimuth 89.350 degrees  
Prepared by Peterson Energy  
Date Printed: 2-May-2013



SYSDRILL  
Closest Approach + Clearance Factor Summary Report  
Wellbore: Pavistma South 2 #1-5-32-090-4-CH (PWB)  
Wellpath: Pavistma South 2 #1-5-32-090-4-CH (PWP#1)

Clearance Summary										
Offset WellName	Offset Wellbore	Offset Slot	Offset Structure	Separation [ft]	MD[ft]	Diverging From[ft]	Ellipse Separation [ft]	Ellipse MD[ft]	Clearance Factor	Clearance MD[ft]
0-4-CH	-CH (PWB)									
W Great Western #27-12	W Great Western #27-12 (AWB)	Great Western #27-12	Great Western 66N67W	9207.31	11908.91	11908.91	9175.15	11908.91	286.29	11908.91
Kodak 1 #7-8-21-27 0-4-NH	Kodak 1 #7-8-21-270-4 -NH (PWB)	Slot #1	Kodak	9214.56	11908.91	11908.91	9120.77	11908.91	98.24	11908.91
DIAMOND VALLEY SW 9-5-22	DIAMOND VALLEY SW 1 #4-7-22-270-6 -NH (PWB #2)	Slot #1	Diamond Valley SW	9543.73	11908.91	11908.91	9441.15	11908.91	93.03	11908.91
DIAMOND VALLEY SW 2	DIAMOND VALLEY SW 2 #4-7-22-270-6 -CH (PWB #2)	Slot #2	Diamond Valley SW	9708.71	11908.91	11908.91	9606.01	11908.91	94.54	11908.91
DIAMOND VALLEY SW 9-5-22	DIAMOND VALLEY SW 1 #4-7-22-270-6 -NH (PWB)	Slot #1	Diamond Valley SW	9747.22	11908.91	11908.91	9644.54	11908.91	94.93	11908.91
DIAMOND VALLEY SW 3	DIAMOND VALLEY SW 3 #4-7-22-270-6 -NH (PWB #2)	Slot #3	Diamond Valley SW	9872.91	11908.91	11908.91	9770.14	11908.91	96.07	11908.91
DIAMOND VALLEY SW 2	DIAMOND VALLEY SW 2 #3-7-22-270-6 -CH (PWB)	Slot #2	Diamond Valley SW	9914.87	11908.91	11908.91	9812.18	11908.91	96.55	11908.91
W Great Western #27-22	W Great Western #27-22 (AWB)	Great Western #27-22	Great Western 66N67W	10022.27	11908.91	11908.91	9993.77	11908.91	351.66	11908.91
DIAMOND VALLEY SW 3	DIAMOND VALLEY SW 3 #3-6-22-270-6 -NH (PWB)	Slot #3	Diamond Valley SW	10077.97	11908.91	11908.91	9975.09	11908.91	97.96	11908.91
W Great Western #27-52	W Great Western #27-52 (AWB)	Great Western #27-52	Great Western 66N67W	10134.12	11908.91	11908.91	10102.12	11908.91	316.70	11908.91
DIAMOND VALLEY SW 4	DIAMOND VALLEY SW 4 #4-6-22-270-6 -NH (PWB #2)	Slot #4	Diamond Valley SW	10202.25	11908.91	11908.91	10099.31	11908.91	99.11	11908.91
W Great Western #27-11	W Great Western #27-11 (AWB)	Great Western #27-11	Great Western 66N67W	10237.75	11908.91	11908.91	10203.55	11908.91	299.33	11908.91
DIAMOND VALLEY SW 8-2-22	DIAMOND VALLEY SW 5 #4-6-22-270-6 -CH (PWB)	Slot #5	Diamond Valley SW	10367.49	11908.91	11908.91	10264.46	11908.91	100.63	11908.91

All data is in Feet unless otherwise stated  
Coordinates are from Slot MD's are from Rig and TVD's are from Rig ( Planned Datum #1 4953.0ft above Mean Sea Level )  
Vertical Section is from 0.00N 0.00E on azimuth 89.350 degrees  
Prepared by Peterson Energy  
Date Printed: 2-May-2013



SYSDRILL  
Closest Approach + Clearance Factor Summary Report  
Wellbore: Pavistma South 2 #1-5-32-090-4-CH (PWB)  
Wellpath: Pavistma South 2 #1-5-32-090-4-CH (PWP#1)

Clearance Summary										
Offset WellName	Offset Wellbore	Offset Slot	Offset Structure	Separation [ft]	MD[ft]	Diverging From[ft]	Ellipse Separation [ft]	Ellipse MD[ft]	Clearance Factor	Clearance MD[ft]
#2)										
DIAMOND VALLEY SW 4	DIAMOND VALLEY SW 4 #3-6-22-270-6 -NH (PWB)	Slot #4	Diamond Valley SW	10405.14	11908.91	11908.91	10302.09	11908.91	100.97	11908.91
DIAMOND VALLEY SW 6	DIAMOND VALLEY SW 6 #4-6-22-270-6 -NH (PWB #2)	Slot #6	Diamond Valley SW	10531.52	11908.91	11908.91	10428.42	11908.91	102.15	11908.91
DIAMOND VALLEY SW 8-2-22	DIAMOND VALLEY SW 5 #3-6-22-270-6 -CH (PWB)	Slot #5	Diamond Valley SW	10572.98	11908.91	11908.91	10469.87	11908.91	102.55	11908.91
DIAMOND VALLEY SW 6	DIAMOND VALLEY SW 6 (PWB)	Slot #6	Diamond Valley SW	10735.98	11908.91	11908.91	10632.74	11908.91	103.99	11908.91
DIAMOND VALLEY SW 7	DIAMOND VALLEY SW 7 #4-5-22-270-6 -NH (PWB #2)	Slot #7	Diamond Valley SW	10860.87	11908.91	11908.91	10757.56	11908.91	105.12	11908.91
DIAMOND VALLEY SW 8	DIAMOND VALLEY SW 8 #4-5-22-270-6 -CH (PWB #2)	Slot #8	Diamond Valley SW	11026.10	11908.91	11908.91	10922.69	11908.91	106.62	11908.91
Great Western 27-31-8	Great Western 27-31-8 (AWB)	Great Western 27-31-8	Great Western Diamond Valley	11061.93	11908.91	11908.91	11032.32	11908.91	373.53	11908.91
DIAMOND VALLEY SW 7	DIAMOND VALLEY SW 7 #3-5-22-270-6 -NH (PWB)	Slot #7	Diamond Valley SW	11067.04	11908.91	11908.91	10963.70	11908.91	107.10	11908.91
W Great Western #27-21	W Great Western #27-21 (AWB)	Great Western #27-21	Great Western 66N67W	11091.31	11908.91	11908.91	11059.40	11908.91	347.58	11908.91
DIAMOND VALLEY SW 8	DIAMOND VALLEY SW 8 #3-5-22-270-6 -CH PWB)	Slot #8	Diamond Valley SW	11176.69	11908.91	11908.91	11073.29	11908.91	108.09	11908.91
DIAMOND VALLEY SW 9	DIAMOND VALLEY SW 9 #4-5-22-270-6 -NH (PWB #2)	Slot #9	Diamond Valley SW	11190.22	11908.91	11908.91	11086.72	11908.91	108.12	11908.91
DIAMOND VALLEY SW 8-2-22	DIAMOND VALLEY SW 8-2-22 (PWB)	Slot #5	Diamond Valley SW	11350.49	11908.91	11908.91	11284.18	11908.91	171.17	11908.91
DIAMOND VALLEY	DIAMOND VALLEY SW 9	Slot #9	Diamond Valley SW	11394.32	11908.91	11908.91	11290.71	11908.91	109.98	11908.91

All data is in Feet unless otherwise stated  
Coordinates are from Slot MD's are from Rig and TVD's are from Rig ( Planned Datum #1 4953.0ft above Mean Sea Level )  
Vertical Section is from 0.00N 0.00E on azimuth 89.350 degrees  
Prepared by Peterson Energy  
Date Printed: 2-May-2013



SYSDRILL  
Closest Approach + Clearance Factor Summary Report  
Wellbore: Pavistma South 2 #1-5-32-090-4-CH (PWB)  
Wellpath: Pavistma South 2 #1-5-32-090-4-CH (PWP#1)

Clearance Summary										
Offset WellName	Offset Wellbore	Offset Slot	Offset Structure	Separation [ft]	MD[ft]	Diverging From[ft]	Ellipse Separation [ft]	Ellipse MD[ft]	Clearance Factor	Clearance MD[ft]
SW 9	#3-4-22-270-6 -NH (PWB)									
DIAMOND VALLEY SW 10	DIAMOND VALLEY SW 10 #3-4-22-270-6 -NH (PWB)	Slot #10	Diamond Valley SW	11725.21	11908.91	11908.91	11621.54	11908.91	113.10	11908.91
Great Western 27-21-3	Great Western 27-21-3 (AWB)	Great Western 27-21-3	Great Western Diamond Valley	12000.75	11908.91	11908.91	11969.04	11908.91	378.47	11908.91
DIAMOND VALLEY SW 2	DIAMOND VALLEY SW 8-4-22 (PWB)	Slot #2	Diamond Valley SW	12106.50	11908.91	11908.91	12069.03	11908.91	323.14	11908.91
DIAMOND VALLEY SW 7	DIAMOND VALLEY SW 7-3-22 (PWB)	Slot #7	Diamond Valley SW	12261.02	11908.91	11908.91	12202.78	11908.91	210.54	11908.91
DIAMOND VALLEY SW 8	DIAMOND VALLEY SW 6-2-22 (PWB)	Slot #8	Diamond Valley SW	12424.22	11908.91	11908.91	12346.46	11908.91	159.77	11908.91
Diamond Valley 22-34	Diamond Valley 22-34 (AWB)	Diamond Valley 22-34	Great Western Diamond Valley	12866.76	11908.91	11908.91	12835.26	11908.91	408.56	11908.91
Great Western 27-31-2	Great Western 27-31-2 (AWB)	Great Western 27-31-2	Great Western Diamond Valley	12900.93	11908.91	11908.91	12871.17	11908.91	433.42	11908.91
Diamond Valley 22-23-18	Diamond Valley 22-23-18 (AWB)	Diamond Valley 22-23-18	Great Western Diamond Valley	13029.32	11908.91	11908.91	12995.94	11908.91	390.31	11908.91
Great Western 27-41-10	Great Western 27-41-10 (AWB)	Great Western 27-41-10	Great Western Diamond Valley	13076.81	11908.91	11908.91	13051.19	11908.91	510.42	11908.91
DIAMOND VALLEY SW 10	DIAMOND VALLEY SW 6-4-22 (PWB)	Slot #10	Diamond Valley SW	13126.87	11908.91	11908.91	13077.48	11908.91	265.80	11908.91
Diamond Valley 22-54	Diamond Valley 22-54 (AWB)	Diamond Valley 22-54	Great Western Diamond Valley	13768.21	11908.91	11908.91	13737.57	11908.91	449.45	11908.91
Diamond Valley 22-22-13	Diamond Valley 22-22-13 (AWB)	Diamond Valley 22-22-13	Great Western Diamond Valley	13832.98	11908.91	11908.91	13803.25	11908.91	465.18	11908.91
Diamond Valley 22-44	Diamond Valley 22-44 (AWB)	Diamond Valley 22-44	Great Western Diamond Valley	13851.28	11908.91	11908.91	13821.51	11908.91	465.14	11908.91
Great Western 27-41-1	Great Western 27-41-1 (AWB)	Great Western 27-41-1	Great Western Diamond Valley	13886.70	11908.91	11908.91	13858.85	11908.91	498.67	11908.91
Diamond Valley 22-33	Diamond Valley 22-33 (AWB)	Diamond Valley 22-33	Great Western Diamond Valley	13891.41	11908.91	11908.91	13861.10	11908.91	458.41	11908.91

All data is in Feet unless otherwise stated  
Coordinates are from Slot MD's are from Rig and TVD's are from Rig ( Planned Datum #1 4953.0ft above Mean Sea Level )  
Vertical Section is from 0.00N 0.00E on azimuth 89.350 degrees  
Prepared by Peterson Energy  
Date Printed: 2-May-2013



SYSDRILL  
Closest Approach + Clearance Factor Summary Report  
Wellbore: Pavistma South 2 #1-5-32-090-4-CH (PWB)  
Wellpath: Pavistma South 2 #1-5-32-090-4-CH (PWP#1)

Clearance Summary										
Offset WellName	Offset Wellbore	Offset Slot	Offset Structure	Separation [ft]	MD[ft]	Diverging From[ft]	Ellipse Separation [ft]	Ellipse MD[ft]	Clearance Factor	Clearance MD[ft]
Diamond Valley 22-32-12	Diamond Valley 22-32-12 (AWB)	Diamond Valley 22-32-12	Great Western Diamond Valley	14071.88	11908.91	11908.91	14043.43	11908.91	494.51	11908.91
Diamond Valley 22-43	Diamond Valley 22-43 (AWB)	Diamond Valley 22-43	Great Western Diamond Valley	14149.53	11908.91	11908.91	14121.49	11908.91	504.55	11908.91