

KERR-MCGEE OIL AND GAS ONSHORE LP
THOMSEN 35N-18HZ
SW NW 7 2N 65W 2,398' FNL 550' FWL
WELD,COLORADO
04/17/2013

AREA: S4 ROUTE: S43 Spud: 03/17/2013 WINS No.: H0558 AFE/WO#: 2084228 API#: 0512336863

GL: 4947 KB: 4953 MTD: TVD: LOG MD: PBMD: PBTVD:

Directions: WCR 22 & WCR 37, N 5/10, E 5/10,N 1/10 INTO

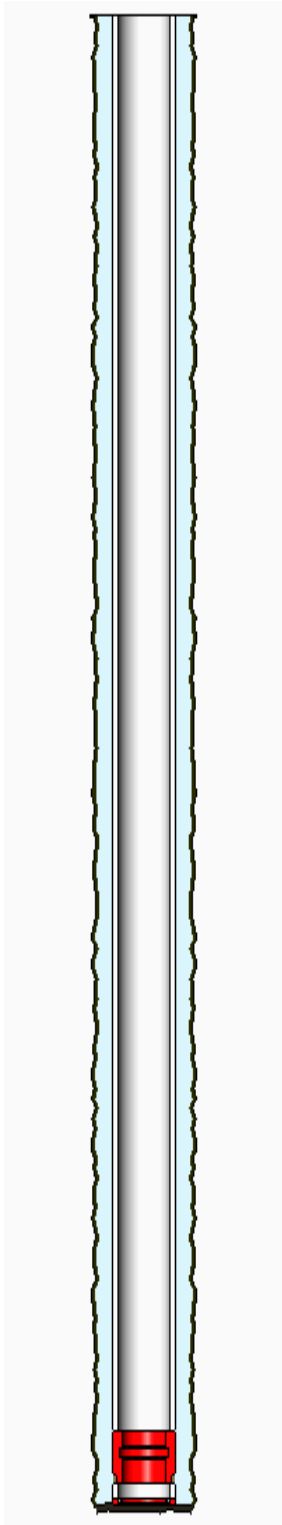

<u>HOLE SECTIONS</u>		<u>Size</u>	<u>Top</u>	<u>Btm</u>	<u>TD Date</u>				
SURFACE		13.50	6	939	03/18/2013				
<u>TUBULARS</u>	<u>Tool Type</u>	<u>Joints</u>	<u>Size</u>	<u>Weight</u>	<u>Grade</u>	<u>Thread</u>	<u>Top D</u>	<u>Bottom D</u>	
SURFACE CASING		Casing	21	9.63	36.00	J55	LT&C	6	892
		Casing Float Collar	1	9.63		J55		892	893
		Casing	1	9.63	36.00	J55	LT&C	893	936
		Casing Guide Shoe	1	9.63		J55		936	936
<u>CEMENT JOBS</u>	<u>Stage</u>	<u>Sacks</u>	<u>Cement Jobs</u>			<u>Top D</u>	<u>Btm D</u>	<u>cbl</u>	
SURFACE CASING			350	TAIL	TYPE 3		6	936	No
<u>PERFORATIONS</u>									
<u>Formation</u>	<u>Zone</u>	<u>Top</u>	<u>Btm</u>	<u>Date</u>	<u>Reason</u>	<u>Comments</u>			

Comments: