

Azimuths to True North  
Magnetic North: 8.74°

Magnetic Field  
Strength: 52844.0snT  
Dip Angle: 66.75°  
Date: 7/7/2012  
Model: IGRF2010

FINAL						
Lambrecht 24-2						
125444; 177555 DN						
WELL @ 4954.0ft (Xtreme 11)						
GL @ 4939.0						
North American Datum 1983						
Well Lambrecht 24-2, True North						
Type	Target	Azimuth	Origin Type	N/S	E/W	From TVD
Target	Lambrecht 24-2 PBHL	202.27	Slot	N/S	0.0	0.0
Lambrecht 24-2 PBHL		TVD 8109.0	+N/-S -2143.7	+E/-W -878.1	Latitude 40.079869	Longitude -104.853475

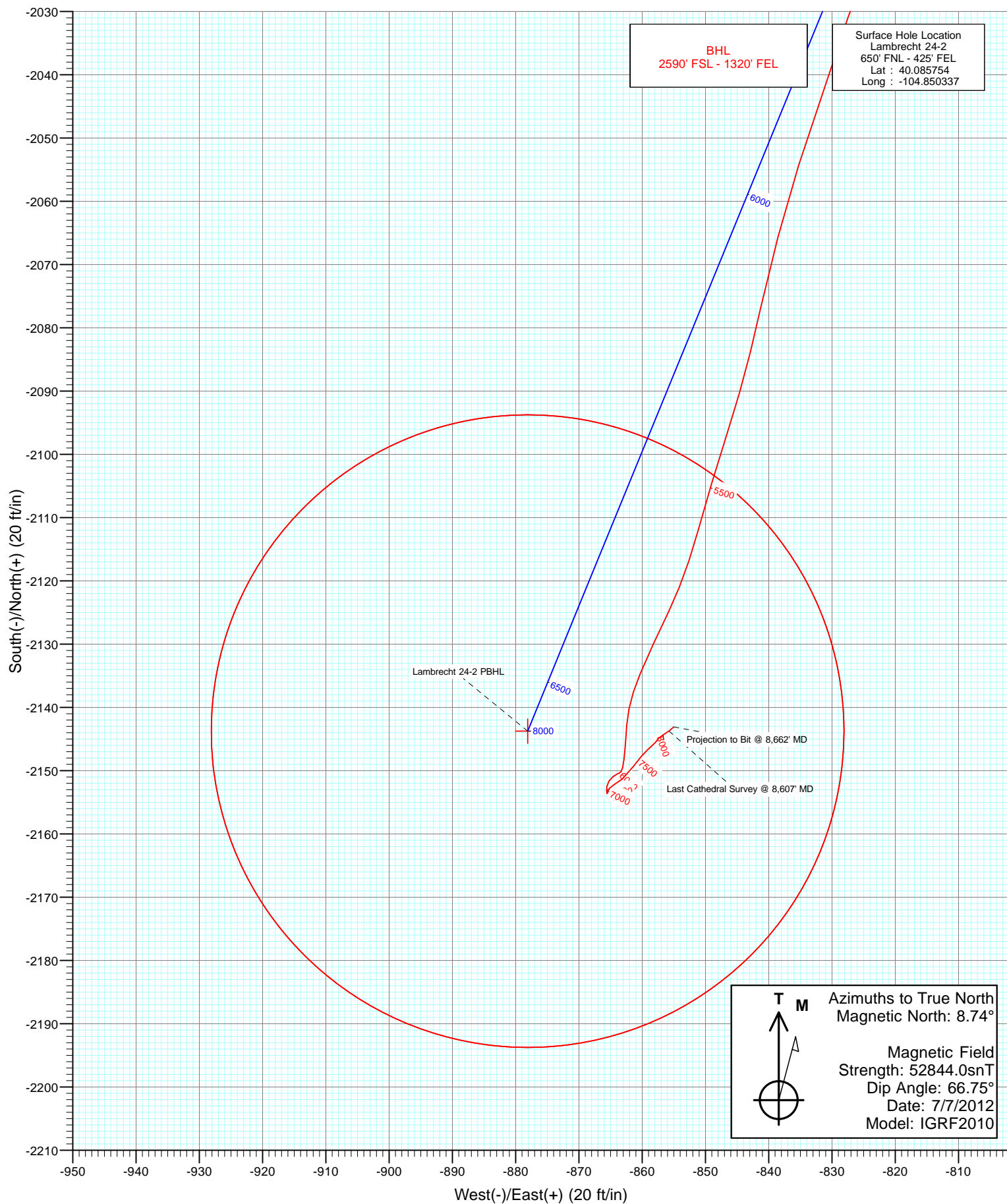

# Cathedral Energy Services

## Survey Report

<b>Company:</b>	Anadarko Petroleum Corporation	<b>Local Co-ordinate Reference:</b>	Well Lambrecht 24-2
<b>Project:</b>	DJ Wattenberg	<b>TVD Reference:</b>	WELL @ 4954.0ft (Xtreme 11)
<b>Site:</b>	S2-T1N-R67W (Lambrecht)	<b>MD Reference:</b>	WELL @ 4954.0ft (Xtreme 11)
<b>Well:</b>	Lambrecht 24-2	<b>North Reference:</b>	True
<b>Wellbore:</b>	DD	<b>Survey Calculation Method:</b>	Minimum Curvature
<b>Design:</b>	FINAL	<b>Database:</b>	USA EDM 5000 Multi Users DB

<b>Project</b>	DJ Wattenberg		
<b>Map System:</b>	US State Plane 1983	<b>System Datum:</b>	Mean Sea Level
<b>Geo Datum:</b>	North American Datum 1983		
<b>Map Zone:</b>	Colorado Northern Zone		

Site		S2-T1N-R67W (Lambrecht)			
Site Position:		Northing:	1,274,774.66 ft	Latitude:	40.085813
From:	Lat/Long	Easting:	3,181,757.64 ft	Longitude:	-104.850421
Position Uncertainty:	0.0 ft	Slot Radius:	13.200 in	Grid Convergence:	0.42 °

Well	Lambrecht 24-2					
Well Position	+N/-S	0.0 ft	Northing:	1,274,753.32 ft	Latitude:	40.085754
	+E/-W	0.0 ft	Easting:	3,181,781.30 ft	Longitude:	-104.850337
Position Uncertainty		0.0 ft	Wellhead Elevation:	ft	Ground Level:	4,939.0 ft

<b>Wellbore</b>	DD				
<b>Magnetics</b>	<b>Model Name</b>	<b>Sample Date</b>	<b>Declination (°)</b>	<b>Dip Angle (°)</b>	<b>Field Strength (nT)</b>
	IGRF2010	7/7/2012	8.74	66.75	52,844

Design	FINAL			
Audit Notes:				
Version:	1.0	Phase:	ACTUAL	Tie On Depth: 0.0
Vertical Section:	Depth From (TVD) (ft)	+N/-S (ft)	+E/-W (ft)	Direction (°)
	0.0	0.0	0.0	202.27

<b>Survey Program</b>	<b>Date</b>	7/13/2012			
<b>From (ft)</b>	<b>To (ft)</b>	<b>Survey (Wellbore)</b>	<b>Tool Name</b>	<b>Description</b>	
105.0	8,662.0	Survey #1 (DD)	MWD	Geolink MWD	

<b>Survey</b>									
<b>Measured Depth (ft)</b>	<b>Inclination (°)</b>	<b>Azimuth (°)</b>	<b>Vertical Depth (ft)</b>	<b>+N/-S (ft)</b>	<b>+E/-W (ft)</b>	<b>Vertical Section (ft)</b>	<b>Dogleg Rate (°/100ft)</b>	<b>Build Rate (°/100ft)</b>	<b>Formations / Comments</b>
0.0	0.00	0.00	0.0	0.0	0.0	0.0	0.00	0.00	
105.0	1.40	330.20	105.0	1.1	-0.6	-0.8	1.33	1.33	
194.0	1.20	270.50	194.0	2.1	-2.1	-1.1	1.47	-0.22	
282.0	2.20	246.30	281.9	1.4	-4.6	0.4	1.37	1.14	
369.0	4.20	237.20	368.8	-1.0	-8.8	4.3	2.36	2.30	
462.0	5.80	219.30	461.4	-6.5	-14.6	11.5	2.38	1.72	
553.0	7.00	207.80	551.9	-14.9	-20.1	21.5	1.92	1.32	
644.0	8.50	198.90	642.0	-26.2	-24.9	33.7	2.11	1.65	
734.0	11.60	197.70	730.7	-41.1	-29.8	49.4	3.45	3.44	
825.0	14.10	194.50	819.4	-60.6	-35.4	69.5	2.86	2.75	
908.0	15.90	198.50	899.5	-81.2	-41.5	90.8	2.50	2.17	
974.0	16.30	198.80	963.0	-98.5	-47.3	109.1	0.62	0.61	
1,064.0	17.70	199.70	1,049.0	-123.3	-56.0	135.4	1.58	1.56	

# Cathedral Energy Services

## Survey Report

<b>Company:</b>	Anadarko Petroleum Corporation	<b>Local Co-ordinate Reference:</b>	Well Lambrecht 24-2
<b>Project:</b>	DJ Wattenberg	<b>TVD Reference:</b>	WELL @ 4954.0ft (Xtreme 11)
<b>Site:</b>	S2-T1N-R67W (Lambrecht)	<b>MD Reference:</b>	WELL @ 4954.0ft (Xtreme 11)
<b>Well:</b>	Lambrecht 24-2	<b>North Reference:</b>	True
<b>Wellbore:</b>	DD	<b>Survey Calculation Method:</b>	Minimum Curvature
<b>Design:</b>	FINAL	<b>Database:</b>	USA EDM 5000 Multi Users DB

Survey									
Measured Depth (ft)	Inclination (°)	Azimuth (°)	Vertical Depth (ft)	+N/-S (ft)	+E/-W (ft)	Vertical Section (ft)	Dogleg Rate (°/100ft)	Build Rate (°/100ft)	Formations / Comments
1,155.0	20.30	201.80	1,135.1	-151.0	-66.6	165.0	2.95	2.86	
1,246.0	21.40	200.90	1,220.1	-181.2	-78.3	197.4	1.26	1.21	
1,336.0	22.60	202.30	1,303.5	-212.5	-90.8	231.1	1.46	1.33	
1,427.0	24.60	201.70	1,386.9	-246.3	-104.4	267.5	2.21	2.20	
1,518.0	25.50	198.50	1,469.4	-282.5	-117.6	306.0	1.79	0.99	
1,609.0	27.80	200.50	1,550.7	-320.9	-131.3	346.8	2.71	2.53	
1,700.0	28.70	201.90	1,630.9	-361.1	-146.9	389.8	1.23	0.99	
1,791.0	29.00	202.00	1,710.6	-401.8	-163.3	433.7	0.33	0.33	
1,882.0	28.20	201.60	1,790.5	-442.3	-179.4	477.3	0.90	-0.88	
1,972.0	28.00	200.30	1,869.8	-481.9	-194.6	519.7	0.72	-0.22	
2,063.0	28.30	203.40	1,950.1	-521.7	-210.6	562.6	1.64	0.33	
2,154.0	28.70	207.30	2,030.1	-560.9	-229.2	605.9	2.09	0.44	
2,244.0	29.30	205.70	2,108.8	-600.0	-248.6	649.4	1.09	0.67	
2,335.0	27.90	205.70	2,188.7	-639.2	-267.5	692.9	1.54	-1.54	
2,426.0	27.90	201.50	2,269.1	-678.2	-284.6	735.5	2.16	0.00	
2,517.0	28.50	203.80	2,349.3	-717.9	-301.1	778.4	1.36	0.66	
2,607.0	28.60	200.00	2,428.4	-757.8	-317.2	821.4	2.02	0.11	
2,698.0	26.90	199.10	2,508.9	-797.7	-331.3	863.8	1.92	-1.87	
2,789.0	27.00	204.20	2,590.0	-836.0	-346.6	905.0	2.54	0.11	
2,880.0	27.60	202.50	2,670.9	-874.3	-363.1	946.7	1.08	0.66	
2,971.0	28.30	204.90	2,751.3	-913.3	-380.2	989.3	1.46	0.77	
3,061.0	29.00	205.30	2,830.3	-952.4	-398.5	1,032.4	0.81	0.78	
3,152.0	29.00	202.50	2,909.9	-992.7	-416.4	1,076.5	1.49	0.00	
3,242.0	27.80	203.10	2,989.0	-1,032.2	-433.0	1,119.3	1.37	-1.33	
3,333.0	27.70	203.60	3,069.6	-1,071.1	-449.8	1,161.7	0.28	-0.11	
3,424.0	27.90	199.50	3,150.1	-1,110.6	-465.4	1,204.1	2.11	0.22	
3,515.0	27.80	199.40	3,230.5	-1,150.7	-479.5	1,246.5	0.12	-0.11	
3,605.0	28.00	200.30	3,310.1	-1,190.3	-493.8	1,288.6	0.52	0.22	
3,696.0	27.10	202.30	3,390.7	-1,229.5	-509.1	1,330.7	1.42	-0.99	
3,787.0	27.10	202.60	3,471.8	-1,267.8	-524.9	1,372.2	0.15	0.00	
3,877.0	28.00	200.20	3,551.6	-1,306.5	-540.1	1,413.8	1.59	1.00	
3,968.0	27.60	202.20	3,632.1	-1,346.1	-555.4	1,456.2	1.12	-0.44	
4,059.0	28.50	202.50	3,712.4	-1,385.7	-571.7	1,499.0	1.00	0.99	
4,149.0	28.20	202.80	3,791.6	-1,425.1	-588.2	1,541.7	0.37	-0.33	
4,240.0	27.70	200.00	3,872.0	-1,464.8	-603.7	1,584.4	1.54	-0.55	
4,331.0	27.40	199.90	3,952.6	-1,504.4	-618.1	1,626.4	0.33	-0.33	
4,421.0	27.90	199.60	4,032.4	-1,543.7	-632.2	1,668.1	0.58	0.56	
4,512.0	28.50	200.50	4,112.6	-1,584.1	-647.0	1,711.1	0.81	0.66	
4,603.0	28.30	204.50	4,192.6	-1,624.1	-663.5	1,754.4	2.10	-0.22	
4,693.0	26.70	202.80	4,272.4	-1,662.1	-680.2	1,795.9	1.98	-1.78	
4,784.0	26.70	203.60	4,353.7	-1,699.7	-696.3	1,836.8	0.40	0.00	
4,875.0	26.20	204.70	4,435.2	-1,736.7	-712.9	1,877.3	0.77	-0.55	
4,966.0	26.50	205.70	4,516.8	-1,773.2	-730.1	1,917.6	0.59	0.33	
5,056.0	27.60	201.00	4,596.9	-1,810.8	-746.3	1,958.5	2.67	1.22	
5,147.0	25.20	201.40	4,678.4	-1,848.5	-760.9	1,999.0	2.64	-2.64	
5,238.0	23.70	201.10	4,761.3	-1,883.6	-774.5	2,036.6	1.65	-1.65	
5,329.0	23.70	199.10	4,844.6	-1,918.0	-787.1	2,073.2	0.88	0.00	
5,420.0	21.20	200.90	4,928.7	-1,950.6	-799.0	2,107.9	2.85	-2.75	
5,511.0	18.90	199.20	5,014.2	-1,979.9	-809.7	2,139.1	2.61	-2.53	
5,601.0	17.30	199.00	5,099.7	-2,006.3	-818.8	2,167.0	1.78	-1.78	
5,692.0	16.00	199.60	5,186.9	-2,030.9	-827.4	2,193.0	1.44	-1.43	
5,783.0	15.40	197.30	5,274.5	-2,054.3	-835.2	2,217.6	0.95	-0.66	
5,874.0	14.20	192.40	5,362.5	-2,076.7	-841.2	2,240.6	1.90	-1.32	

# Cathedral Energy Services

## Survey Report

<b>Company:</b>	Anadarko Petroleum Corporation	<b>Local Co-ordinate Reference:</b>	Well Lambrecht 24-2
<b>Project:</b>	DJ Wattenberg	<b>TVD Reference:</b>	WELL @ 4954.0ft (Xtreme 11)
<b>Site:</b>	S2-T1N-R67W (Lambrecht)	<b>MD Reference:</b>	WELL @ 4954.0ft (Xtreme 11)
<b>Well:</b>	Lambrecht 24-2	<b>North Reference:</b>	True
<b>Wellbore:</b>	DD	<b>Survey Calculation Method:</b>	Minimum Curvature
<b>Design:</b>	FINAL	<b>Database:</b>	USA EDM 5000 Multi Users DB

Survey									
Measured Depth (ft)	Inclination (°)	Azimuth (°)	Vertical Depth (ft)	+N/-S (ft)	+E/-W (ft)	Vertical Section (ft)	Dogleg Rate (°/100ft)	Build Rate (°/100ft)	Formations / Comments
5,965.0	11.50	197.90	5,451.2	-2,096.3	-846.4	2,260.7	3.25	-2.97	
6,056.0	9.60	195.30	5,540.7	-2,112.2	-851.2	2,277.2	2.15	-2.09	
6,146.0	7.60	205.90	5,629.6	-2,124.8	-855.8	2,290.6	2.83	-2.22	
6,237.0	6.10	203.00	5,720.0	-2,134.7	-860.3	2,301.5	1.69	-1.65	
6,328.0	4.70	183.60	5,810.6	-2,142.8	-862.4	2,309.8	2.51	-1.54	
6,419.0	2.10	187.10	5,901.4	-2,148.2	-862.9	2,315.0	2.86	-2.86	
6,510.0	0.40	224.70	5,992.4	-2,150.1	-863.3	2,316.9	1.98	-1.87	
6,600.0	0.00	278.70	6,082.4	-2,150.3	-863.5	2,317.2	0.44	-0.44	
6,691.0	0.50	246.70	6,173.4	-2,150.5	-863.9	2,317.5	0.55	0.55	
6,782.0	0.60	229.90	6,264.4	-2,150.9	-864.6	2,318.2	0.21	0.11	
6,873.0	0.60	212.50	6,355.4	-2,151.7	-865.2	2,319.1	0.20	0.00	
6,964.0	0.60	190.80	6,446.4	-2,152.5	-865.6	2,320.0	0.25	0.00	
7,054.0	0.40	166.60	6,536.4	-2,153.3	-865.6	2,320.7	0.32	-0.22	
7,145.0	0.10	0.60	6,627.4	-2,153.5	-865.5	2,320.9	0.55	-0.33	
7,235.0	0.10	98.70	6,717.4	-2,153.5	-865.4	2,320.8	0.17	0.00	
7,326.0	0.20	239.00	6,808.4	-2,153.6	-865.5	2,320.9	0.31	0.11	
7,417.0	0.10	30.20	6,899.4	-2,153.6	-865.6	2,321.0	0.32	-0.11	
7,508.0	0.30	21.40	6,990.4	-2,153.3	-865.5	2,320.6	0.22	0.22	
7,598.0	0.40	40.30	7,080.4	-2,152.8	-865.2	2,320.1	0.17	0.11	
7,689.0	0.70	55.60	7,171.4	-2,152.3	-864.5	2,319.3	0.36	0.33	
7,825.0	0.70	55.60	7,307.4	-2,151.3	-863.2	2,318.0	0.00	0.00	
7,961.0	1.60	35.30	7,443.3	-2,149.3	-861.4	2,315.4	0.72	0.66	
8,052.0	1.00	42.70	7,534.3	-2,147.7	-860.1	2,313.4	0.68	-0.66	
8,143.0	0.70	45.80	7,625.3	-2,146.7	-859.2	2,312.2	0.33	-0.33	
8,233.0	0.50	49.50	7,715.3	-2,146.1	-858.5	2,311.3	0.23	-0.22	
8,324.0	0.50	41.60	7,806.3	-2,145.5	-857.9	2,310.6	0.08	0.00	
8,415.0	0.60	37.10	7,897.3	-2,144.8	-857.3	2,309.8	0.12	0.11	
8,506.0	0.40	77.60	7,988.3	-2,144.4	-856.8	2,309.1	0.43	-0.22	
8,607.0	1.00	47.70	8,089.3	-2,143.7	-855.8	2,308.1	0.68	0.59	Last Cathedral Survey @ 8,607' MD - Lambrecht
8,662.0	1.10	50.74	8,144.3	-2,143.1	-855.0	2,307.2	0.21	0.18	Projection to Bit @ 8,662' MD

Targets									
Target Name	Dip Angle (°)	Dip Dir. (°)	TVD (ft)	+N/-S (ft)	+E/-W (ft)	Northing (ft)	Easting (ft)	Latitude	Longitude
Lambrecht 24-2 PBHL	0.00	0.00	8,109.0	-2,143.7	-878.1	1,272,603.20	3,180,918.93	40.079869	-104.853475
- hit/miss target									
- Shape									
- actual wellpath misses target center by 29.8ft at 8607.0ft MD (8089.3 TVD, -2143.7 N, -855.8 E)									
- Circle (radius 50.0)									

Design Annotations					
Measured Depth (ft)	Vertical Depth (ft)	Local Coordinates		Comment	
		+N/-S (ft)	+E/-W (ft)		
8,607.0	8,089.3	-2,143.7	-855.8	Last Cathedral Survey @ 8,607' MD	
8,662.0	8,144.3	-2,143.1	-855.0	Projection to Bit @ 8,662' MD	

Checked By: \_\_\_\_\_ Approved By: \_\_\_\_\_ Date: \_\_\_\_\_