

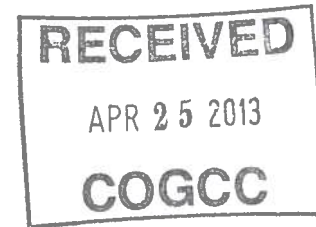

April 25, 2013



Colorado Oil & Gas Conservation Commission
Attention: Mr. Greg Deranleau
1120 Lincoln Street, Suite 1700
Denver, CO 80203

Dear Mr. Deranleau:

Subject: Divide Road Water Facility – Garfield County Approvals

Enclosed are the approved Garfield County Land Use Change Permit and the Limited Impact Review for Encana's Divide Road Water Facility Form 2A.

Please contact me at 720-876-5890 or Julia Carter at 720-876-5240 with any questions.

Sincerely,

ENCANA CORPORATION

Jennifer Lind
Regulatory Analyst

Encl.



Reception#: 832585
03/14/2013 08:49:41 AM Jean Alberico
1 of 3 Rec Fee:\$0.00 Doc Fee:0 00 GARFIELD COUNTY CO

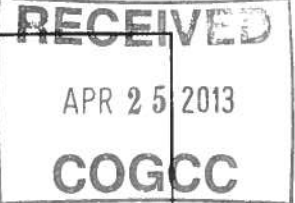

LAND USE CHANGE PERMIT

FOR

A PRODUCED WATER STORAGE FACILITY ON 24.4-ACRES WITHIN A 15,800-ACRE PARCEL OWNED BY ENCAN A OIL & GAS (USA), INC. THE SITE IS LOCATED NORTH OF THE TOWN OF PARACHUTE IN SECTION 26, TOWNSHIP 4 SOUTH, RANGE 96 WEST OF THE 6TH PM, GARFIELD COUNTY.

PARCEL NO# 1917-274-00-012

In accordance with and pursuant to the provisions of the Garfield County Unified Land Use Resolution of 2008, as amended, and **Resolution No. 2013-14** of the Board of County Commissioners of Garfield County, State of Colorado, hereby authorizes, by Land Use Change Permit, the following activity:

MATERIAL HANDLING, FOUR (4) 206,000 BBLs WATER STORAGE TANKS, VARIOUS STORAGE TANKS FOR OFF-LOAD AND CONDENSATE, AND ACCESSORY USES AS SHOWN ON THE SITE PLAN ATTACHED AS EXHIBIT A. TRANSPORT OF THE FLUID IS PRIMARILY VIA EXISTING PIPELINES.

The Land Use Change Permit is issued subject to the conditions set forth in the above-mentioned resolution, and shall be valid only during compliance with such conditions and other applicable provisions of the Garfield County Unified Land Use Resolution of 2008, as amended, Building Code, and other regulations of the Board of County Commissioners of Garfield County, Colorado.

ATTEST:



Jean M Alberico
Clerk of the Board

BOARD OF COMMISSIONERS,
GARFIELD COUNTY, COLORADO

Chairman

Reception #: 832385
03/14/2013 08:49:41 AM Jean Alberico
2 of 3 Rec Fee: \$0.00 Doc Fee: 0.00 GARFIELD COUNTY CO



REVIEWS		REVISIONS
1	2	3
4	5	6
7	8	9
10	11	12
13	14	15
16	17	18
19	20	21
22	23	24
25	26	27
28	29	30
31	32	33
34	35	36
37	38	39
40	41	42
43	44	45
46	47	48
49	50	51
52	53	54
55	56	57
58	59	60
61	62	63
64	65	66
67	68	69
70	71	72
73	74	75
76	77	78
79	80	81
82	83	84
85	86	87
88	89	90
91	92	93
94	95	96
97	98	99
100	101	102
103	104	105
106	107	108
109	110	111
112	113	114
115	116	117
118	119	120
121	122	123
124	125	126
127	128	129
130	131	132
133	134	135
136	137	138
139	140	141
142	143	144
145	146	147
148	149	150
151	152	153
154	155	156
157	158	159
160	161	162
163	164	165
166	167	168
169	170	171
172	173	174
175	176	177
178	179	180
181	182	183
184	185	186
187	188	189
190	191	192
193	194	195
196	197	198
199	200	201
202	203	204
205	206	207
208	209	210
211	212	213
214	215	216
217	218	219
220	221	222
223	224	225
226	227	228
229	230	231
232	233	234
235	236	237
238	239	240
241	242	243
244	245	246
247	248	249
250	251	252
253	254	255
256	257	258
259	260	261
262	263	264
265	266	267
268	269	270
271	272	273
274	275	276
277	278	279
280	281	282
283	284	285
286	287	288
289	290	291
292	293	294
295	296	297
298	299	300
301	302	303
304	305	306
307	308	309
310	311	312
313	314	315
316	317	318
319	320	321
322	323	324
325	326	327
328	329	330
331	332	333
334	335	336
337	338	339
340	341	342
343	344	345
346	347	348
349	350	351
352	353	354
355	356	357
358	359	360
361	362	363
364	365	366
367		

1987, 1988, 1989, 1990, 1991, 1992, 1993, 1994, 1995, 1996, 1997, 1998, 1999, 2000, 2001, 2002, 2003, 2004, 2005, 2006, 2007, 2008, 2009, 2010, 2011, 2012, 2013, 2014, 2015, 2016, 2017, 2018, 2019, 2020, 2021, 2022, 2023, 2024, 2025, 2026, 2027, 2028, 2029, 2030, 2031, 2032, 2033, 2034, 2035, 2036, 2037, 2038, 2039, 2040, 2041, 2042, 2043, 2044, 2045, 2046, 2047, 2048, 2049, 2050, 2051, 2052, 2053, 2054, 2055, 2056, 2057, 2058, 2059, 2060, 2061, 2062, 2063, 2064, 2065, 2066, 2067, 2068, 2069, 2070, 2071, 2072, 2073, 2074, 2075, 2076, 2077, 2078, 2079, 2080, 2081, 2082, 2083, 2084, 2085, 2086, 2087, 2088, 2089, 2090, 2091, 2092, 2093, 2094, 2095, 2096, 2097, 2098, 2099, 2100, 2101, 2102, 2103, 2104, 2105, 2106, 2107, 2108, 2109, 2110, 2111, 2112, 2113, 2114, 2115, 2116, 2117, 2118, 2119, 2120, 2121, 2122, 2123, 2124, 2125, 2126, 2127, 2128, 2129, 2130, 2131, 2132, 2133, 2134, 2135, 2136, 2137, 2138, 2139, 2140, 2141, 2142, 2143, 2144, 2145, 2146, 2147, 2148, 2149, 2150, 2151, 2152, 2153, 2154, 2155, 2156, 2157, 2158, 2159, 2160, 2161, 2162, 2163, 2164, 2165, 2166, 2167, 2168, 2169, 2170, 2171, 2172, 2173, 2174, 2175, 2176, 2177, 2178, 2179, 2180, 2181, 2182, 2183, 2184, 2185, 2186, 2187, 2188, 2189, 2190, 2191, 2192, 2193, 2194, 2195, 2196, 2197, 2198, 2199, 2200, 2201, 2202, 2203, 2204, 2205, 2206, 2207, 2208, 2209, 2210, 2211, 2212, 2213, 2214, 2215, 2216, 2217, 2218, 2219, 2220, 2221, 2222, 2223, 2224, 2225, 2226, 2227, 2228, 2229, 2230, 2231, 2232, 2233, 2234, 2235, 2236, 2237, 2238, 2239, 2240, 2241, 2242, 2243, 2244, 2245, 2246, 2247, 2248, 2249, 2250, 2251, 2252, 2253, 2254, 2255, 2256, 2257, 2258, 2259, 2260, 2261, 2262, 2263, 2264, 2265, 2266, 2267, 2268, 2269, 2270, 2271, 2272, 2273, 2274, 2275, 2276, 2277, 2278, 2279, 2280, 2281, 2282, 2283, 2284, 2285, 2286, 2287, 2288, 2289, 2290, 2291, 2292, 2293, 2294, 2295, 2296, 2297, 2298, 2299, 2300, 2301, 2302, 2303, 2304, 2305, 2306, 2307, 2308, 2309, 2310, 2311, 2312, 2313, 2314, 2315, 2316, 2317, 2318, 2319, 2320, 2321, 2322, 2323, 2324, 2325, 2326, 2327, 2328, 2329, 2330, 2331, 2332, 2333, 2334, 2335, 2336, 2337, 2338, 2339, 2340, 2341, 2342, 2343, 2344, 2345, 2346, 2347, 2348, 2349, 2350, 2351, 2352, 2353, 2354, 2355, 2356, 2357, 2358, 2359, 2360, 2361, 2362, 2363, 2364, 2365, 2366, 2367, 2368, 2369, 2370, 2371, 2372, 2373, 2374, 2375, 2376, 2377, 2378, 2379, 2380, 2381, 2382, 2383, 2384, 2385, 2386, 2387, 2388, 2389, 2390, 2391, 2392, 2393, 2394, 2395, 2396, 2397, 2398, 2399, 2400, 2401, 2402, 2403, 2404, 2405, 2406, 2407, 2408, 2409, 2410, 2411, 2412, 2413, 2414, 2415, 2416, 2417, 2418, 2419, 2420, 2421, 2422, 2423, 2424, 2425, 2426, 2427, 2428, 2429, 2430, 2431, 2432, 2433, 2434, 2435, 2436, 2437, 2438, 2439, 2440, 2441, 2442, 2443, 2444, 2445, 2446, 2447, 2448, 2449, 2450, 2451, 2452, 2453, 2454, 2455, 2456, 2457, 2458, 2459, 2460, 2461, 2462, 2463, 2464, 2465, 2466, 2467, 2468, 2469, 2470, 2471, 2472, 2473, 2474, 2475, 2476, 2477, 2478, 2479, 2480, 2481, 2482, 2483, 2484, 2485, 2486, 2487, 2488, 2489, 2490, 2491, 2492, 2493, 2494, 2495, 2496, 2497, 2498, 2499, 2500, 2501, 2502, 2503, 2504, 2505, 2506, 2507, 2508, 2509, 2510, 2511, 2512, 2513, 2514, 2515, 2516, 2517, 2518, 2519, 2520, 2521, 2522, 2523, 2524, 2525, 2526, 2527, 2528, 2529, 2530, 2531, 2532, 2533, 2534, 2535, 2536, 2537, 2538, 2539, 2540, 2541, 2542, 2543, 2544, 2545, 2546, 2547, 2548, 2549, 2550, 2551, 2552, 2553, 2554, 2555, 2556, 2557, 2558, 2559, 2560, 2561, 2562, 2563, 2564, 2565, 2566, 2567, 2568, 2569, 2570, 2571, 2572, 2573, 2574, 2575, 2576, 2577, 2578, 2579, 2580, 2581, 2582, 2583, 2584, 2585, 2586, 2587, 2588, 2589, 2590, 2591, 2592, 2593, 2594, 2595, 2596, 2597, 2598, 2599, 2600, 2601, 2602, 2603, 2604, 2605, 2606, 2607, 2608, 2609, 2610, 2611, 2612, 2613, 2614, 2615, 2616, 2617, 2618, 2619, 2620, 2621, 2622, 2623, 2624, 2625, 2626, 2627, 2628, 2629, 2630, 2631, 2632, 2633, 2634, 2635, 2636, 2637, 2638, 2639, 2640, 2641, 2642, 2643, 2644, 2645, 2646, 2647, 2648, 2649, 2650, 2651, 2652, 2653, 2654, 2655, 2656, 2657, 2658, 2659, 2660, 2661, 2662, 2663, 2664, 2665, 2666, 2667, 2668, 26

encana.
natural gas

ATM RIVER CITY
CONSULTANT

700 Hudson Street, Suite 1200
New York, NY 10014
Tel: 212 512 2000
Fax: 212 512 2001
www.atmrc.com

Encana Oil & Gas (USA) Inc
 Divide Road Water Facility
 Site Eng
 Street 1 - Victory Way
 DATE ORDER: 08/01/13

ENCLOSURE 4/15/84 400		DATE	DATE RECEIVED ORDER 13	Ct
QUANTITY	100	PRICE	SHEET NO. 1 OF 2 SHEETS	
QUANTITY	100	PRICE	DATE	
QUANTITY	100	PRICE	DATE	

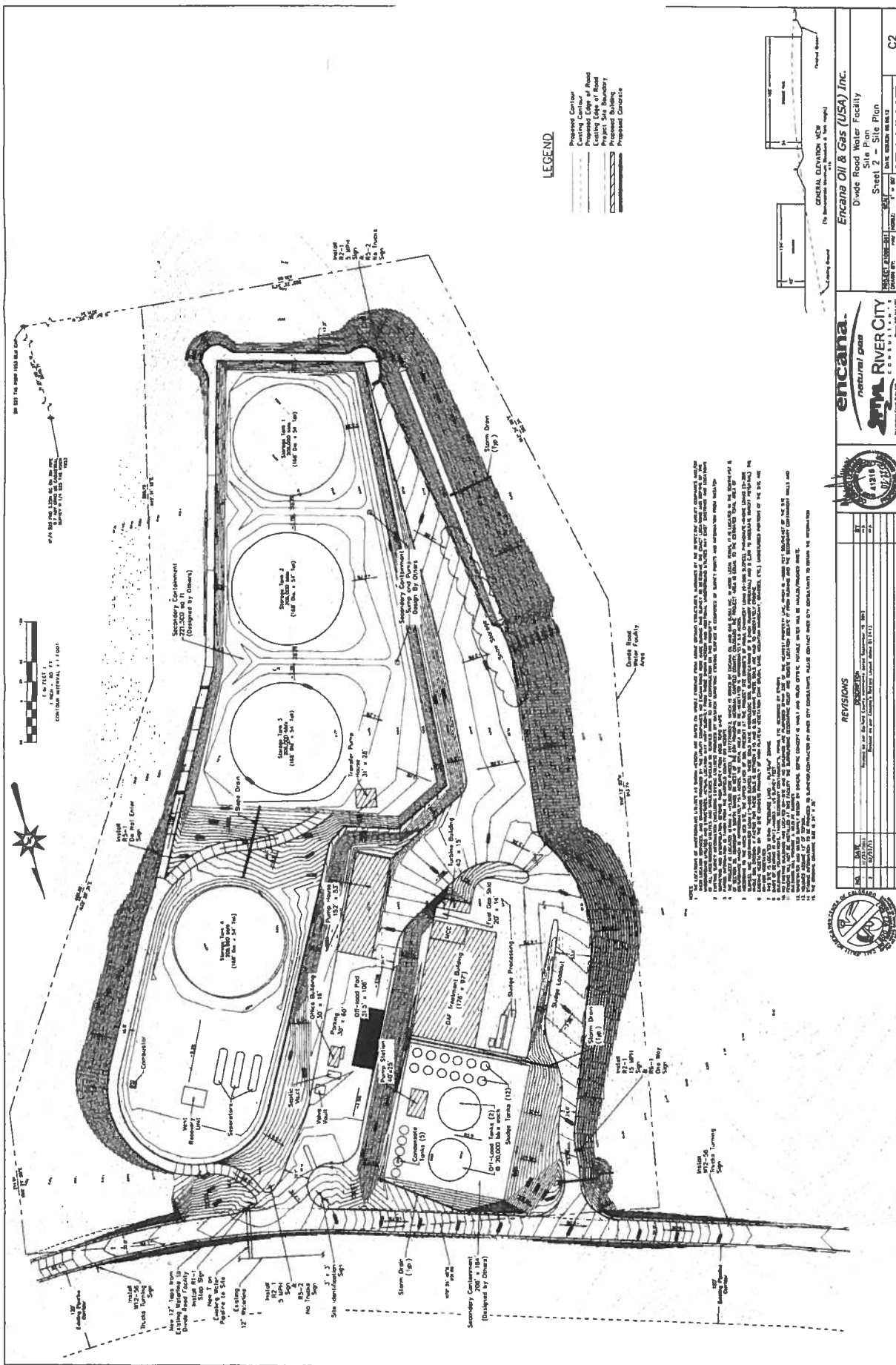

LEGEND

- Proposed Contour
 Existing Contour
 Proposed Edge of Road
 Existing Edge of Road
 Project Site Boundary
 Proposed Building
 Proposed Concrete

encana.
natural gas

ATM RIVER CITY
CONSULTING

PO BOX 100000
MEMPHIS, TN 38110-0000
Phone: 901.511.1732
Fax: 901.511.1730

REVISIONS

NO.	DATE	APPROVED BY
2	02/01/13	



Age Group	Total	Female	Male	Unknown
18-24	100	55	45	0
25-34	100	45	55	0
35-44	100	55	45	0
45-54	100	45	55	0
55-64	100	55	45	0
65+	100	45	55	0